



Filing Receipt

Filing Date - 2023-07-28 02:31:00 PM

Control Number - 53936

Item Number - 47

DOCKET NO. 53936

APPLICATION OF STONETOWN	§	PUBLIC UTILITY COMMISSION
SPRING OAKS UTILITIES, LLC AND	§	
TRINITY SO PTN LP FOR SALE,	§	OF TEXAS
TRANSFER, OR MERGER OF	§	
FACILITIES AND CERTIFICATE	§	
RIGHTS IN HARRIS COUNTY	§	

CORRECTED NOTICE OF APPROVAL

This Notice of Approval addresses the application of Stonetown Spring Oaks Utilities, LLC and Trinity SO PTN LP for approval of the sale, transfer, or merger of facilities and certificate rights in Harris County. The Commission approves the following: (1) the sale and transfer of Trinity's facilities and service areas within certificate of convenience and necessity (CCN) numbers 13240 and 21089 to Stonetown; (2) the cancellation of Trinity's CCN numbers 13240 and 21089; and (3) the issuance of new CCN numbers 13306 and 21134 to Stonetown, which include the area previously within Trinity's CCN numbers 13240 and 21089.

I. Findings of Fact

The Commission makes the following findings of fact.

Applicants

1. Trinity is a Texas limited partnership registered with the Texas secretary of state under filing number 801012636.
2. Trinity holds CCN number 13240 which obligates it to provide retail water service in its certificated service area in Harris County.
3. Trinity owns a public water system that is registered with the Texas Commission on Environmental Quality (TCEQ) under identification number 1012090.
4. Trinity holds CCN number 21089 which obligates it to provide retail sewer service in its certificated service area in Harris County.
5. Trinity owns a sewer system that is permitted with the TCEQ under Texas Pollutant Discharge Elimination System permit number WQ0012650001.

6. On January 13, 2023, Trinity's TPDES permit number WQ0012650001 was transferred to Stonetown.
7. Stonetown is a Delaware limited liability company registered with the Texas secretary of state under filing number 804516540.

Application

8. On August 5, 2022, Stonetown and Trinity filed the application at issue in this proceeding.
9. The applicants amended the application on August 31, 2022.
10. The applicants filed supplemental information on August 30 and September 22 and 26, 2022, and January 11, 2023.
11. In the application, the applicants seek approval of the following: (1) the sale and transfer of the facilities and service areas under Trinity's CCN numbers 13240 and 21089 to Stonetown; (2) the cancellation of Trinity's CCN numbers 13240 and 21089; and (3) the issuance of new CCNs to Stonetown.
12. The requested water service and sewer service areas (collectively, the requested area) are identical in acreage and boundaries.
13. The requested area includes 21 acres and 137 current customer connections.
14. The requested area is located approximately four miles west of downtown Spring, Texas, and is generally bounded on the north by Crosley Field Drive, on the east by Mossy Oaks Road, on the south by Spring Stuebner Road, and on the west by Frassati Way.
15. In Order No. 4 filed on September 30, 2022, the ALJ found the application, as supplemented, administratively complete.

Notice

16. On November 3, 2022, Stonetown filed the affidavits of Roy Lapidus and Donna Brown Willis, Stonetown's authorized representatives, attesting that notice of the application was provided to current customers, neighboring utilities, and affected parties on October 18 and 19, 2022.
17. In Order No. 5 filed on December 14, 2022, the ALJ found the notice sufficient.

18. On May 30, 2023, Stonetown filed the affidavit of Adam Minnick, Stonetown MRE Texas, LLC's authorized representative, the immediate parent company of Stonetown, attesting that Stonetown MRE Texas is the sole landowner in the requested area and there is no other owner of a tract of land that is at least 25 acres and is wholly or partially included in the area proposed to be certified according to the most current tax appraisal rolls of the applicable central appraisal district at the time the Commission received the application.
19. In Order No. 13 filed on July 28, 2023, the ALJ found the notice, as supplemented, sufficient.

Evidentiary Record

20. In Order No. 7 filed on February 8, 2023, the ALJ admitted the following evidence into the record of this proceeding:
 - a. the application and all attachments filed on August 5, 2022;
 - b. the revised maps filed on August 30, 2022;
 - c. the amendment to the application filed on August 31, 2022;
 - d. the confidential supplemental information filed on September 22 and 26, 2022;
 - e. Commission Staff's recommendation on administrative completeness and all attachments filed on September 30, 2022;
 - f. Stonetown's proof of notice filed on November 3, 2022;
 - g. Commission Staff's recommendation on sufficiency of the notice filed on November 30, 2022;
 - h. the third supplement to the application and confidential attachments filed on January 11, 2023;
 - i. Commission Staff's recommendation on approval of the sale and all attachments filed on January 13, 2023;
 - j. Stonetown's response to Commission Staff's recommendation on approval of the sale filed on January 20, 2023; and

- k. the TCEQ's order approving the transfer of water quality permit WQ0012650001 from Trinity to Springs Oaks, attached to the joint motion to admit evidence and proposed order approving sale to proceed, filed on February 2, 2023.
21. In Order No. 13 filed on July 28, 2023, the ALJ admitted the following additional evidence into the record of this proceeding:
- a. the applicants' proof of completed transaction filed March 10, 2023;
 - b. the applicants' supplemental affidavit regarding notice filed on May 30, 2023;
 - c. Commission Staff's recommendation on sufficiency of closing documents filed on March 27, 2023;
 - d. the applicants' consent forms filed on May 5, 2023;
 - e. the map, certificate, and tariff attached to the joint supplemental motion to admit and joint proposed notice of approval filed on June 2, 2023; and
 - f. the executed agreement for a licensed operator attached to the second supplemental motion to admit evidence filed on June 16, 2023.

Sale

22. In Order No. 8 filed on February 8, 2023, the ALJ approved the sale and transaction to proceed and required the applicants to file proof that the transaction had been completed and that customer deposits, if any, had been addressed.
23. On March 10, 2023, Stonetown filed proof that the sale had closed, effective March 10, 2023, and confirmed that there were no customer deposits to be addressed.
24. In Order No. 9 filed on March 28, 2023, the ALJ found the closing documents sufficient.

Purchaser's Compliance History

25. Stonetown does not have any unaddressed violations in the TCEQ database.
26. Stonetown has not been under an enforcement action by the Commission, Texas Health and Human Services, the Office of the Texas Attorney General, or the United States Environmental Protection Agency in the past five years for non-compliance with rules, orders, or state statutes.

27. Stonetown does not have a history of continuing mismanagement or misuse of revenues as a utility service provider.
28. Stonetown demonstrated a compliance status that is adequate for approval of the transaction.

Adequacy of Existing Service

29. There are currently 137 connections in the requested area that are being through public water system number 1012090 and sewer system TPDES permit number WQ0012650001 and such service has been continuous and adequate.
30. Trinity's public water system and sewer system do not have any unaddressed violations in the TCEQ's database.
31. The Commission's complaint records, which date back to 2017, show no complaints against Trinity.
32. There is no evidence in the record that Trinity has failed to comply with any Commission or TCEQ order.

Need for Additional Service

33. There are 137 existing water and sewer customers in the requested area that are receiving service and have an ongoing need for service.
34. This application is to transfer only existing facilities, customers, and service area.
35. There is no evidence of specific requests for additional water or sewer service within the requested area.

Effect of Approving the Transaction

36. All retail public utilities in the proximate area were provided notice of the transaction taking place in this application and did none filed a protest or motion to intervene.
37. There is no evidence that approval of the transaction will have any adverse affect on any other retail public utility providing service in the proximate area.
38. Trinity is the only utility affected by this transfer.
39. There will be no adverse effect on landowners in the requested area because the requested area is already certificated.

40. Transferring the facilities and service areas under CCN numbers 13240 and 21089 to Stonetown will obligate Stonetown to provide continuous and adequate water and sewer service to current and future customers in the requested area.

Ability to Serve: Managerial and Technical

41. Stonetown will employ or contract with a TCEQ-licensed operator who will be responsible for the operation of the public water system and sewer system being transferred.
42. Stonetown has the managerial and technical capability to provide continuous and adequate service to the requested area.

Feasibility of Obtaining: Service from Adjacent Retail Public Utility

43. Trinity is currently serving customers throughout the requested area, and such service has been continuous and adequate.
44. Obtaining service from an adjacent retail public utility would likely increase costs to customers because new facilities will need to be constructed. At a minimum, an interconnect would need to be installed in order to connect to a neighboring retail public utility.
45. It is not feasible to obtain service from an adjacent retail public utility.

Regionalization or Consolidation

46. It will not be necessary for Stonetown to construct a physically separate public water system or sewer system to serve the requested area.
47. Because the requested area will not require construction of a physically separate public water system or sewer system, consideration of regionalization or consolidation with another retail public utility is not required.

Ability to Serve: Financial Ability and Stability

48. No construction or capital improvements are required for Stonetown to provide service to the requested area.
49. Stonetown MRE Texas, LLC, the immediate parent company of Stonetown, is capable, available, and willing to cover temporary cash shortages and has a debt service coverage ratio that is greater than 1.25, satisfying the leverage test.

50. Stonetown's affiliate, Stonetown MRE Texas, LLC provided a written guarantee of coverage of temporary cash shortages and demonstrated sufficient cash available to cover any projected operations and maintenance shortages in the first five years of operations. Therefore, Stonetown satisfies the operations test.
51. Stonetown demonstrated the financial capability and stability to pay for the facilities necessary to provide continuous and adequate service to the requested area.

Financial Assurance

52. There is no need to require Stonetown to provide a bond or other financial assurance to ensure continuous and adequate service.

Environmental Integrity and Effect on the Land

53. The requested area will continue to be served with existing infrastructure and no additional construction is needed to provide service to the requested area.
54. There will be no effect on environmental integrity or the land as a result of the transaction.

Improvement in Service or Lowering Cost to Consumers

55. Stonetown will continue to provide water and sewer service to existing and future customers in the requested area.
56. Reliability and quality of water and sewer service is expected to improve under Stonetown's management.
57. The rates charged to customers in the requested area will not change as a result of approving the transaction because Stonetown will adopt Trinity's current water and sewer tariffs.

Maps, Tariffs, and Certificates

58. On April 28, 2023, Commission Staff emailed Stonetown and Trinity the final proposed maps, tariffs, and certificates related to this docket.
59. On May 5, 2023, Stonetown and Trinity filed their consents to the proposed final maps, tariffs, and certificates.
60. On June 2, 2023, the parties filed the proposed final maps, certificates, and tariffs as attachments to the joint supplemental motion to admit evidence and proposed notice of approval.

Informal Disposition

61. More than 15 days have passed since the completion of notice provided in this docket.
62. No person filed a protest or motion to intervene.
63. Stonetown, Trinity, and Commission Staff are the only parties to this proceeding.
64. No party requested a hearing and no hearing is needed.
65. Commission Staff recommended approval of the application.
66. This decision is not adverse to any party.

II. Conclusions of Law

The Commission makes the following conclusions of law.

1. The Commission has authority over this proceeding under Texas Water Code (TWC) §§ 13.241, 13.242, 13.244, 13.246, 13.251, and 13.301.
2. Trinity and Stonetown are retail public utilities as defined by TWC § 13.002(19) and 16 Texas Administrative Code (TAC) § 24.3(31).
3. Trinity and Stonetown provided notice of the application that complies with TWC §§ 13.246 and 13.301(a)(2), and 16 TAC § 24.239(b).
4. Trinity and Stonetown's application meets the requirements of TWC § 13.244 and 16 TAC § 24.233.
5. The Commission processed this application as required by the TWC, the Administrative Procedure Act,¹ and Commission rules.
6. Trinity and Stonetown have complied with the requirements of 16 TAC § 24.239(k) and (l) with respect to customer deposits.
7. Trinity and Stonetown completed the sale and transfer within the time required by 16 TAC § 24.239(m).

¹ Tex. Gov't Code §§ 2001.001–.903.

8. After consideration of the factors in TWC § 13.246(c), Stonetown demonstrated that it is capable of rendering continuous and adequate service to every customer within the requested area, as required by TWC §§ 13.251.
9. Stonetown demonstrated adequate financial, managerial, and technical capability for providing continuous and adequate service in the requested area as required by TWC §§ 13.241(a) and 13.301(b).
10. Regionalization and consolidation concerns under TWC § 13.241(d) do not apply in this proceeding because construction of a physically separate water or sewer system is not required.
11. It is not necessary for Stonetown to provide bond or other financial assurance under TWC §§ 13.246(d) and 13.301(c).
12. Stonetown and Trinity demonstrated that the sale and transfer of Trinity's water and sewer facilities and service areas within CCN numbers 13240 and 21089 to Stonetown, the cancellation of Trinity's CCN numbers 13240 and 21089, and the issuance of new CCN numbers 13306 and 21134 to Stonetown will serve the public interest and is necessary for the service, accommodation, convenience, or safety of the public under TWC §§ 13.246(b) and 13.301(d).
13. Under TWC § 13.257(r) and (s), Stonetown must record a certified copy of the certificates and the maps approved by this Notice of Approval, along with a boundary description of the service area, in the real property records of Harris County within 31 days of receiving this Notice of Approval and submit to the Commission evidence of the recording.
14. The requirements for informal disposition under 16 TAC § 22.35 have been met in this proceeding.

III. Ordering Paragraphs

In accordance with these findings of fact and conclusions of law, the Commission issues the following orders.

1. The Commission approves the sale and the transfer of all Trinity's facilities, customers, and service areas under CCN numbers 13240 and 21089 to Stonetown, as shown on the attached maps.

2. The Commission issues CCN numbers 13306 and 21134 to Stonetown, which include the facilities and service areas previously included in Trinity's CCN numbers 13240 and 21089, as shown on the attached maps.
3. The Commission cancels Trinity's CCN numbers 13240 and 21089.
4. The Commission approves the maps and tariffs attached to this Notice of Approval.
5. The Commission issues the certificates attached to this Notice of Approval.
6. Stonetown must provide service to every customer or qualified applicant for service within the approved area under CCN number 13306 that requests water service and meets the terms of Stonetown's water service policies, and such service must be continuous and adequate.
7. Stonetown must provide service to every customer or qualified applicant for service within the approved area under CCN number 21134 that requests sewer service and meets the terms of Stonetown sewer service policies, and such service must be continuous and adequate.
8. Stonetown must comply with the recording requirements in TWC § 13.257(r) and (s) for the area in Harris County affected by the application and file in this docket proof of the recording no later than 45 days after receipt of the Notice of Approval.
9. Within ten days of the date this Notice of Approval is filed, Commission Staff must provide the Commission with a clean copy of Stonetown's water and sewer tariffs to be stamped *Approved* and retained by Central Records.
10. The Commission denies all other motions and any other requests for general or specific relief, if not expressly granted.

Signed at Austin, Texas the 28th day of July 2023.

PUBLIC UTILITY COMMISSION OF TEXAS



**ISAAC TA
ADMINISTRATIVE LAW JUDGE**

Stonetown Spring Oaks Utilities, LLC
Water CCN No. 13306
PUC Docket No. 53936
Transferred all of Trinity SO PTN, LP, CCN No. 13240 in Harris County

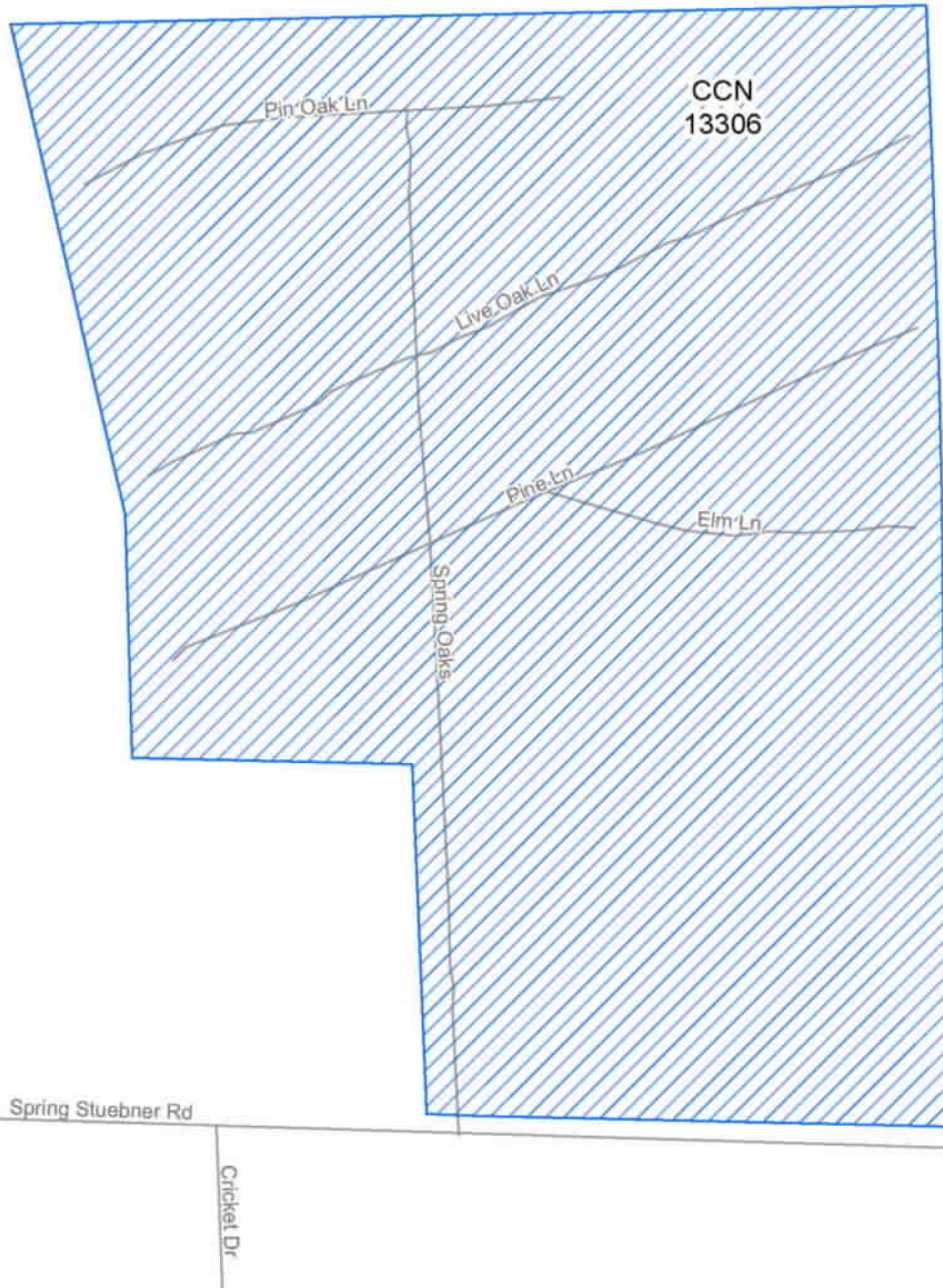

Water CCN



13306 - Stonetown Spring Oaks Utilities LLC

0 100 200
Feet



Stonetown Spring Oaks Utilities, LLC
Sewer CCN No. 21134
PUC Docket No. 53936
Transferred all of Trinity SO PTN, LP, CCN No. 21089 in Harris County

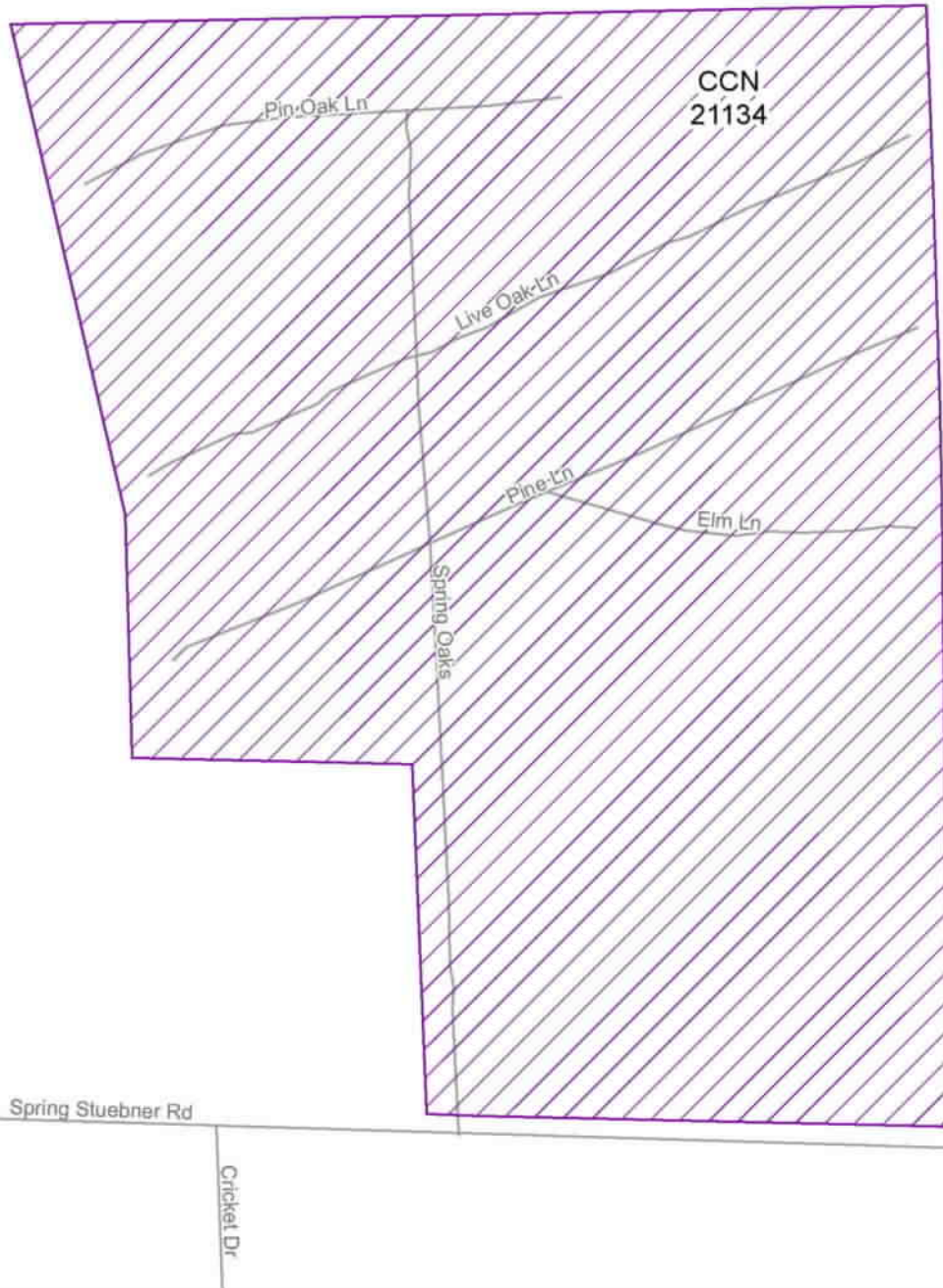

Sewer CCN

 21134 - Stonetown Spring Oaks Utilities LLC

0 100 200
Feet





WATER UTILITY TARIFF
Docket No. 53936

Stonetown Spring Oaks Utilities, LLC.
(Utility Name)

211 E. 7th Street, Suite 620
(Business Address)

Austin, Texas 78701
(City, State, Zip Code)

(303) 407-3009
(Area Code/Telephone)

This tariff is effective for utility operations under the following Certificate of Convenience and Necessity:

13306

This tariff is effective in the following county:

Harris

This tariff is effective in the following cities or unincorporated towns (if any):

n/a

This tariff is effective in the following subdivisions or systems:

Trinity Spring Oaks Mobile Home Park (PWS #1012090)

TABLE OF CONTENTS

The above utility lists the following sections of its tariff (if additional pages are needed for a section, all pages should be numbered consecutively):

SECTION 1.0 -- RATE SCHEDULE	2
SECTION 2.0 -- SERVICE RULES AND POLICIES	6
SECTION 3.0 -- EXTENSION POLICY	12

APPENDIX A -- DROUGHT CONTINGENCY PLAN
APPENDIX B -- SAMPLE SERVICE AGREEMENT
APPENDIX C -- APPLICATION FOR SERVICE

SECTION 1.0 -- RATE SCHEDULE

Section 1.01 - Rates

<u>Meter Size</u>	<u>Monthly Minimum Charge</u> (Includes 0 gallons all meters)	<u>Gallage Charge</u>
5/8" or 3/4"	<u>\$20.00</u>	<u>\$2.00</u> per 1,000 gallons
1"	<u>\$50.00</u>	
1½"	<u>\$100.00</u>	
2"	<u>\$160.00</u>	
3"	<u>\$300.00</u>	
4"	<u>\$500.00</u>	

North Harris County Regional Water Authority Fee

Pass Through Fee Applied to Gallage Charge \$5.00 per 1,000 gallons*Tariff Control No. 50633*

FORM OF PAYMENT: The utility will accept the following forms of payment:

Cash , Check X, Money Order X, MasterCard X, Visa X, Electronic Fund Transfer
 THE UTILITY MAY REQUIRE EXACT CHANGE FOR PAYMENTS AND MAY REFUSE TO ACCEPT PAYMENTS
 MADE USING MORE THAN \$1.00 IN SMALL COINS. A WRITTEN RECEIPT WILL BE GIVEN FOR CASH
 PAYMENTS. AT THE CUSTOMER'S OPTION, ANY BILLING TRANSACTION OR COMMUNICATION MAY BE
 PERFORMED ON THE INTERNET. THIS INCLUDES THE UTILITY SENDING PAPERLESS BILLS BY EMAIL.

REGULATORY ASSESSMENT 1.0%
 PUC RULES REQUIRE THE UTILITY TO COLLECT A FEE OF ONE PERCENT OF THE RETAIL MONTHLY BILL
 AND TO REMIT FEE TO THE TEXAS COMMISSION ON ENVIRONMENTAL QUALITY (TCEQ).

Section 1.02 – Miscellaneous Fees

TAP FEE \$650.00
 TAP FEE IS BASED ON THE AVERAGE OF THE UTILITY'S ACTUAL COST FOR MATERIALS AND LABOR FOR
 STANDARD RESIDENTIAL CONNECTION OF 5/8" METER PLUS UNIQUE COSTS AS PERMITTED BY PUC RULE
 AT COST.

TAP FEE (Unique costs) Actual Cost
 FOR EXAMPLE, A ROAD BORE FOR CUSTOMERS OUTSIDE OF SUBDIVISIONS OR RESIDENTIAL AREAS.

LARGE METER TAP FEE Actual Cost
 TAP FEE IS BASED ON THE UTILITY'S ACTUAL COST FOR MATERIALS AND LABOR FOR METERS LARGER
 THAN STANDARD 5/8" METERS.

METER TEST FEE (actual cost of testing the meter up to) \$25.00
 THIS FEE MAY BE CHARGED IF A CUSTOMER REQUESTS A SECOND METER TEST WITHIN A TWO-YEAR
 PERIOD AND THE TEST INDICATES THAT THE METER IS RECORDING ACCURATELY.

METER RELOCATION FEE Actual Relocation Cost
 THIS FEE MAY BE CHARGED IF A CUSTOMER REQUESTS RELOCATION OF AN EXISTING METER.

METER CONVERSION FEE Actual Cost to Convert Meter
 THIS FEE MAY BE CHARGED IF A CUSTOMER REQUESTS CHANGE OF SIZE OF AN EXISTING METER OR
 CHANGE IS REQUIRED BY MATERIAL CHANGE IN CUSTOMERS SERVICE DEMAND.

METER TAMPERING, DAMAGE OR DIVERSION FEE:

ONE TIME PENALTY PER OCCURRENCE FOR TAMPERING WITH OR DAMAGING A WATER METER OR ANY
 APPURTENANCE THERE TO INCLUDING LOCKS AND METER BOXES OR SERVICE DIVERSION OF ONE
 HUNDRED DOLLARS (\$100.00).

Docket No. 53936

SECTION 1.0 -- RATE SCHEDULE (Continued)

RECONNECTION FEE

THE RECONNECT FEE WILL BE CHARGED BEFORE SERVICE CAN BE RESTORED TO A CUSTOMER WHO HAS BEEN DISCONNECTED FOR THE FOLLOWING REASONS:

- a) Non-payment of bill (Maximum \$25.00) \$25.00
 - b) Customer's request \$50.00
- or other reasons listed under Section 2.0 of this tariff

SEASONAL RECONNECTION FEE:

BASE RATE FOR METER SIZE TIMES NUMBER OF MONTHS OFF THE SYSTEM NOT TO EXCEED SIX MONTHS WHEN LEAVE AND RETURN WITHIN A TWELVE-MONTH PERIOD.

TRANSFER FEE \$35.00

THE TRANSFER FEE WILL BE CHARGED FOR CHANGING AN ACCOUNT NAME AT THE SAME SERVICE LOCATION WHEN THE SERVICE IS NOT DISCONNECTED.

LATE CHARGE 10%

A ONE-TIME PENALTY MAY BE MADE ON DELINQUENT BILLS BUT MAY NOT BE APPLIED TO ANY BALANCE TO WHICH THE PENALTY WAS APPLIED IN A PREVIOUS BILLING.

RETURNED CHECK CHARGE \$30.00

CUSTOMER DEPOSIT RESIDENTIAL (Maximum \$50) \$50.00

COMMERCIAL AND NON-RESIDENTIAL DEPOSIT 1/6TH EST. ANNUAL BILL

LINE EXTENSION AND CONSTRUCTION CHARGES:

REFER TO SECTION 2.12 SPECIFIC UTILITY SERVICE RULES AND SECTION 3.02 UTILITY SPECIFIC EXTENSION POLICY FOR TERMS, CONDITIONS, AND CHARGES.

GOVERNMENTAL TESTING, INSPECTION AND COSTS SURCHARGE CLAUSE:

INCREASES IN INSPECTION FEES AND WATER TESTING COSTS IMPOSED BY STATE OR FEDERAL LAW MAY BE PASSED THROUGH AS AN ADJUSTMENT TO THE MONTHLY BASE RATE CHARGE UNDER THE TERMS AND CONDITIONS OF [16 TAC 24.25(b)(2)(G)] AFTER NOTICE TO CUSTOMERS AND UPON WRITTEN APPROVAL BY THE PUC.

SUPPLEMENTAL EMERGENCY SERVICE FEE

APPLICABLE TO NONRESIDENTIAL WATER SERVICE CUSTOMERS WHO REQUIRE SUPPLEMENTAL SERVICE OVER AND ABOVE THEIR EXISTING WATER SERVICE FROM TIME TO TIME. USAGE IS TO BE DETERMINED BY CUSTOMER. THE MINIMUM DIAMETER FOR SUPPLEMENTAL SERVICE METER SHALL BE 2 INCHES.

SECTION 1.0 -- RATE SCHEDULE (Continued)

TEMPORARY WATER RATE:

Unless otherwise superseded by PUC order or rule, if the Utility is ordered by a court or governmental body of competent jurisdiction to reduce its pumpage, production or water sales, the Utility shall be authorized to increase its approved gallonage charge according to the formula:

$$TGC = cgc + \frac{(pr)(cgc)(r)}{(1.0-r)}$$

Where:

- TGC = temporary gallonage charge
- cgc = current gallonage charge
- r = water use reduction expressed as a decimal fraction (the pumping restriction)
- pr = percentage of revenues to be recovered expressed as a decimal fraction, for this tariff pr shall equal 0.5.

To implement the Temporary Water Rate, the utility must comply with all notice and other requirements of 16 TAC § 24.25(j)(1).

PURCHASED WATER AND/OR DISTRICT FEE PASS THROUGH CLAUSE - ALL WATER SUBJECT TO FEE:

Changes in fees imposed by any non-affiliated third-party water supplier or underground water district having jurisdiction over the Utility shall be passed through as an adjustment to the water gallonage charge according to the following formula:

$$R = G / (1-L),$$

Where:

- R = the proposed pass-through rate;
- G = the new gallonage charge (per 1,000 gallons);
- B = change in purchased water/district gallonage charge (per 1,000 gallons);
- L = system average line loss for the preceding 12 months not to exceed 0.15

SECTION 1.0 -- RATE SCHEDULE (Continued)

Section 1.02 – Miscellaneous Fees (Continued)**PURCHASED WATER AND/OR DISTRICT FEE PASS THROUGH CLAUSE –
PORTION OF WATER SUBJECT TO FEE:**

Upon notice from a water supplier of either an increase or a decrease in the cost of purchased water, the utility shall provide notice to customers and the Commission of its intent to implement rates imposed by any non-affiliated third party water supplier or underground water district having jurisdiction over the Utility shall be passed through as an adjustment to the water gallonage charge according to the following formula:

$$\text{Adjustment to the gallonage rate: } AG = (CP/GB) \times 1,000$$

$$\text{Adjustment to the minimum bill: } AMB = GMB \times AG$$

Where:

CP: $CP1 - CP0$ = Change in cost of purchased water

CP1: Cost of purchased water during the most recent 12-month period at the new rates;

CP0: Cost of purchased water during the most recent 12-month period at the previous rates;

GMB: Number of gallons in the minimum bill, divided by 1,000; and

GB: Number of gallons billed to customers in excess of the amount included in the monthly minimum bill for the 12 Month period used above.

FRANCHISE FEE PASS THROUGH CLAUSE:

Charges a municipality makes for use of streets and alleys pursuant to Tax Code §182.025 or other applicable state law shall be passed through as an adjustment to the water gallonage charge according to the following formula:

$$AG = G + B$$

Where:

AG = adjusted gallonage charge, rounded to the nearest one cent;

G = approved gallonage charge (per 1,000 gallons) and

B = projected franchise fees payable (per 1,000 gallons).

SECTION 2.0 - SERVICE RULES AND REGULATIONS

The utility will have the most current Public Utility Commission of Texas (PUCT or commission) rules relating to Water and Wastewater Utility regulations, available at its office for reference purposes. The Rules and this tariff shall be available for public inspection and reproduction at a reasonable cost. The latest Rules or commission approved changes to the Rules supersede any rules or requirements in this tariff.

Section 2.01 - Application for Water Service

All applications for service will be made on the utility's standard application or contract form (attached in the Appendix to this tariff), will be signed by the applicant, any required fees (deposits, reconnect, tap, extension fees, etc. as applicable) will be paid and easements, if required, will be granted before service is provided by the utility. A separate application or contract will be made for each service location.

Section 2.02 - Refusal of Service

The utility may decline to serve an applicant until the applicant has complied with the regulations of the regulatory agencies (state and municipal regulations) and for the reasons outlined in the PUCT Rules. In the event that the utility refuses to serve an applicant, the utility will inform the applicant in writing of the basis of its refusal. The utility is also required to inform the applicant that a complaint may be filed with the commission.

Section 2.03 - Fees and Charges & Easements Required Before Service Can Be Connected

(A) Customer Deposits

If a residential applicant cannot establish credit to the satisfaction of the utility, the applicant may be required to pay a deposit as provided for in Section 1.02 - Miscellaneous Fees of this tariff. The utility will keep records of the deposit and credit interest in accordance with PUCT Rules.

Residential applicants 65 years of age or older may not be required to pay deposits unless the applicant has an outstanding account balance with the utility or another water or sewer utility which accrued within the last two years.

Nonresidential applicants who cannot establish credit to the satisfaction of the utility may be required to make a deposit that does not exceed an amount equivalent to one-sixth of the estimated annual billings.

Refund of deposit - If service is not connected, or after disconnection of service, the Utility will promptly refund the customer's deposit plus accrued interest or the balance, if any, in excess of the unpaid bills for service furnished. The Utility may refund the deposit at any time prior to termination of utility service but must refund the deposit plus interest for any residential customer who has paid 18 consecutive billings without being delinquent. Deposits from non-residential customers may be held as long as that customer takes service.

SECTION 2.0 - SERVICE RULES AND REGULATIONS (CONTINUED)

(B) Tap or Reconnect Fees

A new customer requesting service at a location where service has not previously been provided must pay a tap fee as provided in Section 1. A customer requesting service where service has previously been provided must pay a reconnect fee as provided in Section 1. Any applicant or existing customer required to pay for any costs not specifically set forth in the rate schedule pages of this tariff shall be given a written explanation of such costs prior to request for payment and/or commencement of construction. If the applicant or existing customer does not believe that these costs are reasonable or necessary, the applicant or existing customer shall be informed of their right to appeal such costs to the PUCT or such other regulatory authority having jurisdiction over the utility's rates in that portion of the utility's service area in which the applicant's or existing customer's property(ies) is located.

Fees in addition to the regular tap fee may be charged if listed specifically in Section 1 to cover unique costs not normally incurred as permitted by 16 TAC § 24.163(a)(1)(C). For example, a road bore for customers outside a subdivision or residential area could be considered a unique cost.

(C) Easement Requirement

Where recorded public utility easements on the service applicant's property do not exist or public road right-of-way easements are not available to access the applicant's property, the utility may require the applicant to provide it with a permanent recorded public utility easement on and across the applicant's real property sufficient to provide service to that applicant. Such easement(s) shall not be used for the construction of production, storage, transmission or pressure facilities unless they are needed for adequate service to that applicant.

Section 2.04 - Utility Response to Applications for Service

After the applicant has met all the requirements, conditions and regulations for service, the utility will install tap, meter and utility cut-off valve and/or take all necessary actions to initiate service. The utility will serve each qualified applicant for service within 5 working days unless line extensions or new facilities are required. If construction is required to fill the order and if it cannot be completed within 30 days, the utility will provide the applicant with a written explanation of the construction required and an expected date of service.

Except for good cause where service has previously been provided, service will be reconnected within one working day after the applicant has met the requirements for reconnection.

Section 2.05 - Customer Responsibility

The customer will be responsible for furnishing and laying the necessary customer service pipe from the meter location to the place of consumption. Customers will not be allowed to use the utility's cutoff valve on the utility's side of the meter. Existing customers may install cutoff valves on their side of the meter and are encouraged to do so. All new customers may be required to install and maintain a cutoff valve on their side of the meter.

No direct connection between a public water supply system and any potential source of contamination or between a public water supply system and a private water source (ex. private well) will be allowed. A customer shall not connect, or allow any other person or party to connect, onto any water lines on his premises.

SECTION 2.0 - SERVICE RULES AND REGULATIONS (CONTINUED)

Section 2.06 - Customer Service Inspections

Applicants for new service connections or facilities which have undergone extensive plumbing modifications are required to furnish the utility a completed customer service inspection certificate. The inspection certificate shall certify that the establishment is in compliance with the Texas Commission on Environmental Quality (TCEQ) Rules and Regulations for Public Water Systems, Title 30 TAC § 290.46(j). The utility is not required to perform these inspections for the applicant/customer, but will assist the applicant/customer in locating and obtaining the services of a certified inspector.

Section 2.07 - Back Flow Prevention Devices

No water connection shall be allowed to any residence or establishment where an actual or potential contamination hazard exists unless the public water facilities are protected from contamination by either an approved air gap, backflow prevention assembly, or other approved device. The type of device or backflow prevention assembly required shall be determined by the specific potential hazard identified in 30 TAC § 290.47(f) Appendix F, Assessment of Hazards and Selection of Assemblies of the TCEQ Rules and Regulations for Public Water Systems.

The use of a backflow prevention assembly at the service connection shall be considered as additional backflow protection and shall not negate the use of backflow protection on internal hazards as outlined and enforced by local plumbing codes. When a customer service inspection certificate indicates that an adequate internal cross-connection control program is in effect, backflow protection at the water service entrance or meter is not required.

At any residence or establishment where it has been determined by a customer service inspection, that there is no actual or potential contamination hazard, as referenced in 30 TAC § 290.47(f) Appendix F, Assessment of Hazards and Selection of Assemblies of the TCEQ Rules and Regulations for Public Water Systems, then a backflow prevention assembly or device is not required. Outside hose bibs do require, at a minimum, the installation and maintenance of a working atmospheric vacuum breaker.

All backflow prevention assemblies or devices shall be tested upon installation by a TCEQ certified backflow prevention assembly tester and certified to be operating within specifications. Backflow prevention assemblies which are installed to provide protection against health hazards must also be tested and certified to be operating within specifications at least annually by a certified backflow prevention assembly tester.

If the utility determines that a backflow prevention assembly or device is required, the utility will provide the customer or applicant with a list of TCEQ certified backflow prevention assembly testers. The customer will be responsible for the cost of installation and testing, if any, of backflow prevention assembly or device. The customer should contact several qualified installers to compare prices before installation. The customer must pay for any required maintenance and annual testing and must furnish a copy of the test results demonstrating that the assembly is functioning properly to the utility within 30 days after the anniversary date of the installation unless a different date is agreed upon.

SECTION 2.0 - SERVICE RULES AND REGULATIONS (CONTINUED)

Section 2.08 - Access to Customer's Premises

The utility will have the right of access to the customer's premises at all reasonable times for the purpose of installing, testing, inspecting or repairing water mains or other equipment used in connection with its provision of water service, or for the purpose of removing its property and disconnecting lines, and for all other purposes necessary to the operation of the utility system including inspecting the customer's plumbing for code, plumbing or tariff violations. The customer shall allow the utility and its personnel access to the customer's property to conduct any water quality tests or inspections required by law. Unless necessary to respond to equipment failure, leak or other condition creating an immediate threat to public health and safety or the continued provision of adequate utility service to others, such entry upon the customer's property shall be during normal business hours and the utility personnel will attempt to notify the customer that they will be working on the customer's property. The customer may require any utility representative, employee, contractor, or agent seeking to make such entry identify themselves, their affiliation with the utility, and the purpose of their entry.

All customers or service applicants shall provide access to meters and utility cutoff valves at all times reasonably necessary to conduct ordinary utility business and after normal business hours as needed to protect and preserve the integrity of the public drinking water supply.

Section 2.09 - Meter Requirements, Readings, and Testing

One meter is required for each residential, commercial, or industrial connection. All water sold by the utility will be billed based on meter measurements. The utility will provide, install, own and maintain meters to measure amounts of water consumed by its customers.

Meters will be read at monthly intervals and as nearly as possible on the corresponding day of each monthly meter reading period unless otherwise authorized by the Commission.

Meter tests. The utility will, upon the request of a customer, and, if the customer so desires, in his or her presence or in that of his or her authorized representative, make without charge a test of the accuracy of the customer's meter. If the customer asks to observe the test, the test will be made during the utility's normal working hours at a time convenient to the customer. Whenever possible, the test will be made on the customer's premises, but may, at the utility's discretion, be made at the utility's testing facility. If within a period of two years the customer requests a new test, the utility will make the test, but if the meter is found to be within the accuracy standards established by the American Water Works Association, the utility will charge the customer a fee which reflects the cost to test the meter up to a maximum \$25 for a residential customer. Following the completion of any requested test, the utility will promptly advise the customer of the date of removal of the meter, the date of the test, the result of the test, and who made the test.

SECTION 2.0 - SERVICE RULES AND REGULATIONS (CONTINUED)

Section 2.10 - Billing

(A) Regular Billing

Bills from the utility will be mailed monthly unless otherwise authorized by the Commission. The due date of bills for utility service will be at least sixteen (16) days from the date of issuance. The postmark on the bill or, if there is no postmark on the bill, the recorded date of mailing by the utility will constitute proof of the date of issuance. Payment for utility service is delinquent if full payment, including late fees and the regulatory assessment, is not received at the utility or the utility's authorized payment agency by 5:00 p.m. on the due date. If the due date falls on a holiday or weekend, the due date for payment purposes will be the next workday after the due date.

(B) Late Fees

A late penalty of either \$5.00 or 10.0% will be charged on bills received after the due date. The penalty on delinquent bills will not be applied to any balance to which the penalty was applied in a previous billing. The utility must maintain a record of the date of mailing to charge the late penalty.

(C) Information on Bill

Each bill will provide all information required by the PUCT Rules. For each of the systems it operates, the utility will maintain and note on the monthly bill a local or toll-free telephone number (or numbers) to which customers can direct questions about their utility service.

(D) Prorated Bills

If service is interrupted or seriously impaired for 24 consecutive hours or more, the utility will prorate the monthly base bill in proportion to the time service was not available to reflect this loss of service.

Section 2.11- Payments

All payments for utility service shall be delivered or mailed to the utility's business office. If the business office fails to receive payment prior to the time of noticed disconnection for non-payment of a delinquent account, service will be terminated as scheduled. Utility service crews shall not be allowed to collect payments on customer accounts in the field.

Payment of an account by any means that has been dishonored and returned by the payor or payee's bank, shall be deemed to be delinquent. All returned payments must be redeemed with cash or valid money order. If a customer has two returned payments within a twelve month period, the customer shall be required to pay a deposit if one has not already been paid.

Section 2.12 - Service Disconnection

(A) With Notice

Utility service may be disconnected if the bill has not been paid in full by the date listed on the termination notice. The termination date must be at least 10 days after the notice is mailed or hand delivered.

The utility is encouraged to offer a deferred payment plan to a customer who cannot pay an outstanding bill in full and is willing to pay the balance in reasonable installments. However, a customer's utility service may be disconnected if a bill has not been paid or a deferred payment agreement entered into within 26 days from the date of issuance of a bill and if proper notice of termination has been given.

SECTION 2.0 - SERVICE RULES AND REGULATIONS (CONTINUED)

Notice of termination must be a separate mailing or hand delivery in accordance with the PUCT Rules.

B) Without Notice

Utility service may also be disconnected without notice for reasons as described in the PUCT Rules.

Section 2.13 - Reconnection of Service

Utility personnel must be available during normal business hours to accept payments on the day service is disconnected and the following day unless service was disconnected at the customer's request or due to a hazardous condition.

Service will be reconnected within 36 hours after the past due bill, reconnect fees and any other outstanding charges are paid or the conditions which caused service to be disconnected are corrected.

Section 2.14 - Service Interruptions

The utility will make all reasonable efforts to prevent interruptions of service. If interruptions occur, the utility will re-establish service within the shortest possible time. Except for momentary interruptions due to automatic equipment operations, the utility will keep a complete record of all interruptions, both emergency and scheduled and will notify the commission in writing of any service interruptions affecting the entire system or any major division of the system lasting more than four hours. The notice will explain the cause of the interruptions.

Section 2.15 - Quality of Service

The utility will plan, furnish, and maintain production, treatment, storage, transmission, and distribution facilities of sufficient size and capacity to provide a continuous and adequate supply of water for all reasonable consumer uses. Unless otherwise authorized by the TCEQ, the utility will maintain facilities as described in the TCEQ Rules and Regulations for Public Water Systems.

Section 2.16 - Customer Complaints and Disputes

If a customer or applicant for service lodges a complaint, the utility will promptly make a suitable investigation and advise the complainant of the results. Service will not be disconnected pending completion of the investigation. If the complainant is dissatisfied with the utility's response, the utility must advise the complainant that he has recourse through either the TCEQ or PUCT complaint process, depending on the nature of the complaint. Pending resolution of a complaint, the commission may require continuation or restoration of service.

The utility will maintain a record of all complaints which shows the name and address of the complainant, the date and nature of the complaint and the adjustment or disposition thereof, for a period of two years after the final settlement of the complaint.

In the event of a dispute between a customer and a utility regarding any bill for utility service, the utility will conduct an investigation and report the results to the customer. If the dispute is not resolved, the utility will inform the customer that a complaint may be filed with the commission.

Section 2.17 - Customer Liability

Customer shall be liable for any damage or injury to utility-owned property shown to be caused by the customer.

SECTION 3.0--EXTENSION POLICY

Section 3.01 - Standard Extension Requirements

LINE EXTENSION AND CONSTRUCTION CHARGES: NO CONTRIBUTION IN AID OF CONSTRUCTION MAY BE REQUIRED OF ANY CUSTOMER EXCEPT AS PROVIDED FOR IN THIS APPROVED EXTENSION POLICY.

The utility is not required to extend service to any applicant outside of its certified service area and will only do so under terms and conditions mutually agreeable to the utility and the applicant, in compliance with PUCT rules and policies, and upon extension of the utility's certified service area boundaries by the PUCT.

The applicant for service will be given an itemized statement of the costs, options such as rebates to the customer, sharing of construction costs between the utility and the customer, or sharing of costs between the customer and other applicants prior to beginning construction.

Section 3.02 - Costs Utilities and Service Applicants Shall Bear

Within its certified area, the utility will pay the cost of the first 200 feet of any water main or distribution line necessary to extend service to an individual residential customer within a platted subdivision.

However, if the residential customer requesting service purchased the property after the developer was notified in writing of the need to provide facilities to the utility, the utility may charge for the first 200 feet. The utility must also be able to document that the developer of the subdivision refused to provide facilities compatible with the utility's facilities in accordance with the utility's approved extension policy after receiving a written request from the utility.

Residential customers will be charged the equivalent of the costs of extending service to their property from the nearest transmission or distribution line even if that line does not have adequate capacity to serve the customer. However, if the customer places unique, non-standard service demands upon the system, the customer may be charged the additional cost of extending service to and throughout their property, including the cost of all necessary transmission and storage facilities necessary to meet the service demands anticipated to be created by that property.

Unless an exception is granted by the PUCT, the residential service applicant shall not be required to pay for costs of main extensions greater than 2" in diameter for water distribution and pressure wastewater collection lines and 6" in diameter for gravity wastewater lines.

Exceptions may be granted by the PUCT if:

- adequate service cannot be provided to the applicant using the maximum line sizes listed due to distance or elevation, in which case, it shall be the utility's burden to justify that a larger diameter pipe is required for adequate service;
- or larger minimum line sizes are required under subdivision platting requirements or building codes of municipalities within whose corporate limits or extraterritorial jurisdiction the point of use is located; or the residential service applicant is located outside the CCN service area.

SECTION 3.0--EXTENSION POLICY (CONTINUED)

If an exception is granted by the PUCT, the utility shall establish a proportional cost plan for the specific extension or a rebate plan which may be limited to seven years to return the portion of the applicant's costs for oversizing as new customers are added to ensure that future applicants for service on the line pay at least as much as the initial service applicant.

For purposes of determining the costs that service applicants shall pay, commercial customers with service demands greater than residential customer demands in the certified area, industrial, and wholesale customers shall be treated as developers. A service applicant requesting a one inch meter for a lawn sprinkler system to service a residential lot is not considered nonstandard service.

If an applicant requires service other than the standard service provided by the utility, such applicant will be required to pay all expenses incurred by the utility in excess of the expenses that would be incurred in providing the standard service and connection beyond 200 feet and throughout his property including the cost of all necessary transmission facilities.

The utility will bear the full cost of any over-sizing of water mains necessary to serve other customers in the immediate area. The individual residential customer shall not be charged for any additional production, storage, or treatment facilities. Contributions in aid of construction may not be required of individual residential customers for production, storage, treatment or transmission facilities unless otherwise approved by the Commission under this specific extension policy.

Section 3.03 - Contributions in Aid of Construction

Developers may be required to provide contributions in aid of construction in amounts sufficient to furnish the development with all facilities necessary to provide for reasonable local demand requirements and to comply with TCEQ minimum design criteria for facilities used in the production, transmission, pumping, or treatment of water or TCEQ minimum requirements. For purposes of this subsection, a developer is one who subdivides or requests more than two meters on a piece of property. Commercial, industrial, and wholesale customers will be treated as developers.

Any applicant who places unique or non-standard service demands on the system may be required to provide contributions in aid of construction for the actual costs of any additional facilities required to maintain compliance with the TCEQ minimum design criteria for water production, treatment, pumping, storage and transmission.

Any service extension to a subdivision (recorded or unrecorded) may be subject to the provisions and restrictions of 16 TAC § 24.163(d). When a developer wishes to extend the system to prepare to service multiple new connections, the charge shall be the cost of such extension, plus a pro-rata charge for facilities which must be committed to such extension compliant with the TCEQ minimum design criteria. As provided by 16 TAC § 24.163(d)(4), for purposes of this section, commercial, industrial, and wholesale customers shall be treated as developers.

A utility may only charge a developer standby fees for unrecovered costs of facilities committed to a developer's property under the following circumstances:

- Under a contract and only in accordance with the terms of the contract; or

SECTION 3.0--EXTENSION POLICY (CONTINUED)

- if service is not being provided to a lot or lots within two years after installation of facilities necessary to provide service to the lots has been completed and if the standby fees are included on the utilities approved tariff after a rate change application has been filed. The fees cannot be billed to the developer or collected until the standby fees have been approved by the commission or executive director.

for purposes of this section, a manufactured housing rental community can only be charged standby fees under a contract or if the utility installs the facilities necessary to provide individually metered service to each of the rental lots or spaces in the community.

Section 3.04 - Appealing Connection Costs

The imposition of additional extension costs or charges as provided by Sections 3.0 - Extension Policy of this tariff shall be subject to appeal as provided in this tariff, PUCT rules, or the rules of such other regulatory authority as may have jurisdiction over the utility's rates and services. Any applicant required to pay for any costs not specifically set forth in the rate schedule pages of this tariff shall be given a written explanation of such costs prior to payment and/or commencement of construction. If the applicant does not believe that these costs are reasonable or necessary, the applicant shall be informed of the right to appeal such costs to the PUCT or such other regulatory authority having jurisdiction over the utility's rates in that portion of the utility's service area in which the applicant's property(ies) is located.

Section 3.05 - Applying for Service

The utility will provide a written service application form to the applicant for each request for service received by the utility's business offices. A separate application shall be required for each potential service location if more than one service connection is desired by any individual applicant. Service application forms will be available at the utility's business office during normal weekday business hours. Service applications will be sent by prepaid first class United States mail to the address provided by the applicant upon request. Completed applications should be returned by hand delivery in case there are questions which might delay fulfilling the service request. Completed service applications may be submitted by mail if hand delivery is not possible.

Where a new tap or service connection is required, the service applicant shall be required to submit a written service application and request that a tap be made. A diagram, map, plat, or written metes and bounds description of precisely where the applicant desires each tap or service connection is to be made and, if necessary, where the meter is to be installed, along the applicant's property line may also be required with the tap request. The actual point of connection and meter installation must be readily accessible to utility personnel for inspection, servicing, and meter reading while being reasonably secure from damage by vehicles and mowers. If the utility has more than one main adjacent to the service applicant's property, the tap or service connection will be made to the utility's nearest service main with adequate capacity to service the applicant's full potential service demand. Beyond the initial 200 feet, the customer shall bear only the equivalent cost of extending from the nearest main. If the tap or service connection cannot be made at the applicant's desired location, it will be made at another location mutually acceptable to the applicant and the utility. If no agreement on location can be made, the applicant may refer the matter to the PUCT for resolution.

SECTION 3.0--EXTENSION POLICY (CONTINUED)

Section 3.06 - Qualified Service Applicant

A "qualified service applicant" is an applicant who has: (1) met all of the utility's requirements for service contained in this tariff, PUCT rules and/or PUCT order, (2) has made payment or made arrangement for payment of tap fees, (3) has provided all easements and rights-of-way required to provide service to the requested location, (4) delivered an executed customer service inspection certificate to the utility, if applicable, and (5) has executed a customer service application for each location to which service is being requested.

The utility shall serve each qualified service applicant within its certified service area as soon as practical after receiving a completed service application. All service requests will be fulfilled within the time limits prescribed by PUCT rules once the applicant has met all conditions precedent to achieving "qualified service applicant" status. If a service request cannot be fulfilled within the required period, the applicant shall be notified in writing of the delay, its cause and the anticipated date that service will be available. The PUCT service dates shall not become applicable until the service applicant has met all conditions precedent to becoming a qualified service applicant as defined by PUCT rules.

Section 3.07 - Developer Requirements

As a condition of service to a new subdivision, the utility shall require a developer (as defined by PUCT rule) to provide permanent recorded public utility easements as a condition of service to any location within the developer's property.

APPENDIX A - DROUGHT CONTINGENCY PLAN

(This page incorporates by reference the utility's Drought Contingency Plan, as approved and periodically amended by the Texas Commission on Environmental Quality.)

APPENDIX B -- SAMPLE SERVICE AGREEMENT
From 30 TAC Chapter 290.47(b), Appendix B
SERVICE AGREEMENT

- I. **PURPOSE.** The NAME OF WATER SYSTEM is responsible for protecting the drinking water supply from contamination or pollution which could result from improper private water distribution system construction or configuration. The purpose of this service agreement is to notify each customer of the restrictions which are in place to provide this protection. The utility enforces these restrictions to ensure the public health and welfare. Each customer must sign this agreement before the NAME OF WATER SYSTEM will begin service. In addition, when service to an existing connection has been suspended or terminated, the water system will not re-establish service unless it has a signed copy of this agreement.
- II. **RESTRICTIONS.** The following unacceptable practices are prohibited by State regulations.
- A. No direct connection between the public drinking water supply and a potential source of contamination is permitted. Potential sources of contamination shall be isolated from the public water system by an air-gap or an appropriate backflow prevention device.
 - B. No cross-connection between the public drinking water supply and a private water system is permitted. These potential threats to the public drinking water supply shall be eliminated at the service connection by the installation of an air-gap or a reduced pressure-zone backflow prevention device.
 - C. No connection which allows water to be returned to the public drinking water supply is permitted.
 - D. No pipe or pipe fitting which contains more than 0.25% lead may be used for the installation or repair of plumbing at any connection which provides water for human use.
 - E. No solder or flux which contains more than 0.2% lead can be used for the installation or repair of plumbing at any connection which provides water for human use.
- III. **SERVICE AGREEMENT.** The following are the terms of the service agreement between the NAME OF WATER SYSTEM (the Water System) and NAME OF CUSTOMER (the Customer).
- A. The Water System will maintain a copy of this agreement as long as the Customer and/or the premises is connected to the Water System.
 - B. The Customer shall allow his property to be inspected for possible cross-connections and other potential contamination hazards. These inspections shall be conducted by the Water System or its designated agent prior to initiating new water service; when there is reason to believe that cross-connections or other potential contamination hazards exist; or after any major changes to the private water distribution facilities. The inspections shall be conducted during the Water System's normal business hours.
 - C. The Water System shall notify the Customer in writing of any cross-connection or other potential contamination hazard which has been identified during the initial inspection or the periodic reinspection.
 - D. The Customer shall immediately remove or adequately isolate any potential cross-connections or other potential contamination hazards on his premises.
 - E. The Customer shall, at his expense, properly install, test, and maintain any backflow prevention device required by the Water System. Copies of all testing and maintenance records shall be provided to the Water System.
- IV. **ENFORCEMENT.** If the Customer fails to comply with the terms of the Service Agreement, the Water System shall, at its option, either terminate service or properly install, test, and maintain an appropriate backflow prevention device at the service connection. Any expenses associated with the enforcement of this agreement shall be billed to the Customer.

CUSTOMER'S SIGNATURE: _____

DATE: _____

APPENDIX C -- APPLICATION FOR SERVICE
(Utility Must Attach Blank Copy)



SEWER UTILITY TARIFF
Docket No. 53936

Stonctown Spring Oaks Utilities, LLC.
(Utility Name)

211 E. 7th Street, Suite 620
(Business Address)

Austin, Texas 78701
(City, State, Zip Code)

(303) 407-3009
(Area Code/Telephone)

This tariff is effective for utility operations under the following Certificate of Convenience and Necessity:

21134

This tariff is effective in the following county(ies):

Harris

This tariff is effective in the following cities or unincorporated towns (if any):

n/a

This tariff is effective in the following subdivisions or systems:

Trinity Spring Oaks Mobile Home Park WQ0012650001

TABLE OF CONTENTS

The above utility lists the following sections of its tariff (if additional pages are needed for a section, all pages should be numbered consecutively):

SECTION 1.0 -- RATE SCHEDULE	2
SECTION 2.0 -- SERVICE RULES AND POLICIES	4
SECTION 3.0 -- EXTENSION POLICY	12

SECTION 1.0 -- RATE SCHEDULE**Section 1.01 - Rates**

<u>Meter Size</u>	<u>Monthly Minimum Charge</u> (Includes 0 gallons all meters)	<u>Gallonage Charge</u>
5/8" or 3/4"	<u>\$20.00</u>	<u>\$2.00</u> per 1,000 gallons over
1"	<u>\$20.00</u>	
1½"	<u>\$20.00</u>	
2"	<u>\$20.00</u>	
3"	<u>\$20.00</u>	
4"	<u>\$20.00</u>	

Volume charges are determined based on average consumption for winter period which includes the following months: December through January

FORM OF PAYMENT: The utility will accept the following forms of payment:

Cash___, Check X, Money Order X, MasterCard X, Visa X, Electronic Fund Transfer ___

THE UTILITY MAY REQUIRE EXACT CHANGE FOR PAYMENTS AND MAY REFUSE TO ACCEPT PAYMENTS MADE USING MORE THAN \$1.00 IN SMALL COINS. A WRITTEN RECEIPT WILL BE GIVEN FOR CASH PAYMENTS. AT THE CUSTOMER'S OPTION, ANY BILLING TRANSACTION OR COMMUNICATION MAY BE PERFORMED ON THE INTERNET. THIS INCLUDES THE UTILITY SENDING PAPERLESS BILLS BY EMAIL.

REGULATORY ASSESSMENT..... 1.0%

PUBLIC UTILITY COMMISSION (PUC) RULES REQUIRE THE UTILITY TO COLLECT A FEE OF ONE PERCENT OF THE RETAIL MONTHLY BILL AND TO REMIT FEE TO THE TEXAS COMMISSION ON ENVIRONMENTAL QUALITY (TCEQ).

SECTION 1.0 -- RATE SCHEDULE (CONTINUED)**Section 1.02 – Miscellaneous Fees**

TAP FEE \$650.00

TAP FEE IS BASED ON THE AVERAGE OF THE UTILITY'S ACTUAL COST FOR MATERIALS AND LABOR FOR STANDARD RESIDENTIAL CONNECTION OF 5/8" METER PLUS UNIQUE COSTS AS PERMITTED BY PUC RULE AT COST.

TAP FEE (Unique costs) Actual Cost

FOR EXAMPLE, A ROAD BORE FOR CUSTOMERS OUTSIDE OF SUBDIVISIONS OR RESIDENTIAL AREAS.

LARGE METER TAP FEE Actual Cost

TAP FEE IS BASED ON THE UTILITY'S ACTUAL COST FOR MATERIALS AND LABOR FOR METERS LARGER THAN STANDARD 5/8" METERS.

RECONNECTION FEE

THE RECONNECT FEE MUST BE PAID BEFORE SERVICE CAN BE RESTORED TO A CUSTOMER WHO HAS BEEN DISCONNECTED FOR THE FOLLOWING REASONS (OR OTHER REASONS LISTED UNDER SECTION 2.0 OF THIS TARIFF):

- a) Non-payment of bill (Maximum \$25.00) \$25.00
- b) Customer's request that service be disconnected \$50.00
or other reasons listed under Section 2.0 of this tariff

TRANSFER FEE \$35.00

THE TRANSFER FEE WILL BE CHARGED FOR CHANGING AN ACCOUNT NAME AT THE SAME SERVICE LOCATION WHEN THE SERVICE IS NOT DISCONNECTED.

LATE CHARGE 10 %

COMMISSION RULES ALLOW A ONE-TIME PENALTY TO BE CHARGED ON DELINQUENT BILLS. A LATE CHARGE MAY NOT BE APPLIED TO ANY BALANCE TO WHICH THE PENALTY WAS APPLIED IN A PREVIOUS BILLING.

RETURNED CHECK CHARGE \$30.00

RETURNED CHECK CHARGES MUST BE BASED ON THE UTILITY'S DOCUMENTABLE COST.

CUSTOMER DEPOSIT RESIDENTIAL (Maximum \$50) \$50.00

COMMERCIAL AND NON-RESIDENTIAL DEPOSIT 1/6TH EST. ANNUAL BILL

GOVERNMENTAL TESTING, INSPECTION AND COSTS SURCHARGE CLAUSE:

WHEN AUTHORIZED IN WRITING BY THE COMMISSION AND AFTER NOTICE TO CUSTOMERS, THE UTILITY MAY INCREASE RATES TO RECOVER INCREASED COSTS FOR INSPECTION FEES AND WATER TESTING. [16 TAC 24.21(k)(2)]

LINE EXTENSION AND CONSTRUCTION CHARGES:

REFER TO SECTION 3.0--EXTENSION POLICY FOR TERMS, CONDITIONS, AND CHARGES WHEN NEW CONSTRUCTION IS NECESSARY TO PROVIDE SERVICE.

SECTION 2.0 - SERVICE RULES AND REGULATIONS

The Utility will have the most current Public Utility Commission of Texas (PUC or Commission) Rules relating to sewer utilities available at its office for reference purposes. The Rules and this tariff shall be available for public inspection and reproduction at a reasonable cost. The latest Rules or Commission approved changes to the Rules supersede any rules or requirements in this tariff.

Section 2.01 - Application for Sewer Service

All applications for service will be made on the utility's standard application or contract form (attached in the Appendix to this tariff), will be signed by the applicant, any required fees (deposits, reconnect, tap, extension fees, etc. as applicable) will be paid and easements, if required, will be granted before service is provided by the utility. A separate application or contract will be made for each service location.

Section 2.02 – Refusal of Service

The Utility may decline to serve an applicant until the applicant has complied with the regulations of the regulatory agencies (state and municipal regulations) and for the reasons outlined in the commission rules. In the event that the Utility refuses to serve an applicant, the Utility will inform the applicant in writing of the basis of its refusal. The Utility is also required to inform the applicant that a complaint may be filed with the Commission.

Section 2.03 – Fees and Charges and Easements Required Before Service Can Be Connected

(A) Customer Deposits

If a residential applicant cannot establish credit to the satisfaction of the Utility, the applicant may be required to pay a deposit as provided for in Section 1.02 – Miscellaneous Fees of this tariff. The Utility will keep records of the deposit and credit interest in accordance with commission rules.

Residential applicants 65 years of age or older may not be required to pay deposits unless the applicant has an outstanding account balance with the Utility or another water or sewer utility that accrued within the last two years.

Nonresidential applicants who cannot establish credit to the satisfaction of the Utility may be required to make a deposit that does not exceed an amount equivalent to one-sixth of the estimated annual billings.

SECTION 2.0 - SERVICE RULES AND REGULATIONS (CONTINUED)

Section 2.04 - Customer Deposits (Continued)

Refund of deposit. If service is not connected, or after disconnection of service, the Utility will promptly refund the customer's deposit plus accrued interest or the balance, if any, in excess of the unpaid bills for service furnished. The Utility may refund the deposit at any time prior to termination of utility service but must refund the deposit plus interest for any residential customer who has paid 18 consecutive billings without being delinquent. Deposits from non-residential customers may be held as long as that customer takes service.

Section 2.05 - Meter Requirements, Readings, and Testing

All water sold by the Utility will be billed based on meter measurements. The Utility will provide, install, own, and maintain meters to measure amounts of water consumed by its customers. One meter is required for each residential, commercial, or industrial facility in accordance with the PUC Rules.

Service meters will be read at monthly intervals and as nearly as possible on the corresponding day of each monthly meter reading period unless otherwise authorized by the Commission.

Meter tests. The Utility will, upon the request of a customer, and, if the customer so desires, in his or her presence or in that of his or her authorized representative, make without charge a test of the accuracy of the customer's meter. If the customer asks to observe the test, the test will be made during the Utility's normal working hours at a time convenient to the customer. Whenever possible, the test will be made on the customer's premises, but may, at the Utility's discretion, be made at the Utility's testing facility. If within a period of two years the customer requests a new test, the Utility will make the test, but if the meter is found to be within the accuracy standards established by the American Water Works Association, the Utility will charge the customer a fee that reflects the cost to test the meter up to a maximum \$25 for a residential customer. Following the completion of any requested test, the Utility will promptly advise the customer of the date of removal of the meter, the date of the test, the result of the test, and who made the test.

Section 2.06 - Billing

Bills from the Utility will be mailed monthly unless otherwise authorized by the Commission. The due date of the bills for utility service will be at least sixteen (16) days from the date of issuance. If the customer is a state agency, the due date for the bill may not be less than 30 days after issuance, unless otherwise agreed to by the agency. The postmark on the bill or, if there is no postmark on the bill, the recorded date of mailing by the Utility will constitute proof of the date of issuance. At the customer's option, bills may be sent in a paperless, electronic form by email. The date of the email will constitute the date of issuance. Payment for utility service is delinquent if full payment, including late fees and the regulatory assessment, is not received at the Utility or the Utility's authorized payment agency by 5:00 p.m. on the due date. If the due date falls on a holiday or weekend, the due date for payment purposes will be the next workday after the due date.

A late penalty of 10% of the delinquent bill will be charged on bills received after the due date. The penalty on delinquent bills will not be applied to any balance to which the penalty was applied in a previous billing. The Utility must maintain a record of the date of mailing to charge the late penalty.

SECTION 2.0 - SERVICE RULES AND REGULATIONS (CONTINUED)

Section 2.06 - Billing (Continued)

Each bill will provide all information required by the PUC Rules. For each of the systems it operates, the Utility will maintain and note on the monthly bill a telephone number (or numbers) which may be reached by a local call by customers. At the Utility's option, a toll-free telephone number or the equivalent may be provided.

In the event of a dispute between a customer and the Utility regarding any bill for utility service, the Utility will conduct an investigation and report the results to the customer. If the dispute is not resolved, the Utility will inform the customer that a complaint may be filed with the Commission.

Section 2.07 - Service Disconnection

Utility service may be disconnected if the bill has not been paid in full by the date listed on the termination notice. The termination date must be at least 10 days after the notice is mailed or hand delivered.

The Utility may offer a deferred payment plan to a customer who cannot pay an outstanding bill in full and is willing to pay the balance in reasonable installments. However, a customer's utility service may be disconnected if a bill has not been paid or a deferred payment agreement has not been entered into within 30 days from the date of issuance of a bill and if proper notice of termination has been given.

Notice of termination must be a separate mailing or hand delivery in accordance with the PUC Rules.

Section 2.08 - Reconnection of Service

Utility service may also be disconnected without notice for reasons as described in the PUC Rules.

Utility personnel must be available to collect payments and to reconnect service on the day of and the day after any disconnection of service unless service was disconnected at the customer's request or due to a hazardous condition.

Service will be reconnected within 36 hours after the past due bill and any other outstanding charges are paid or correction of the conditions which caused service to be disconnected.

Section 2.09 - Service Interruptions

The Utility will make all reasonable efforts to prevent interruptions of service. If interruptions occur, the Utility will re-establish service within the shortest possible time. Except for momentary interruptions due to automatic equipment operations, the Utility will keep a complete record of all interruptions, both emergency and scheduled and will notify the Commission in writing of any service interruptions affecting the entire system or any major division of the system lasting more than four hours. The notice will explain the cause of the interruptions.

SECTION 2.0 - SERVICE RULES AND REGULATIONS (CONTINUED)

Prorated Bills. If service is interrupted or seriously impaired for 24 consecutive hours or more, the Utility will prorate the monthly base bill in proportion to the time service was not available to reflect this loss of service.

Section 2.10 - Quality of Service

The Utility will plan, furnish, and maintain production, treatment, storage, transmission, and distribution facilities of sufficient size and capacity to provide a continuous and adequate supply of water for all reasonable consumer uses. Unless otherwise authorized by the Commission, the Utility will maintain facilities as described in the TCEQ Rules and Regulations for Public Water Systems.

Section 2.11 - Customer Complaints and Disputes

If a customer or applicant for service lodges a complaint, the Utility will promptly make a suitable investigation and advise the complainant of the results. Service will not be disconnected pending completion of the investigation. If the complainant is dissatisfied with the Utility's response, the Utility must advise the complainant that he has recourse through the PUC complaint process. Pending resolution of a complaint, the Commission may require continuation or restoration of service.

The Utility will maintain a record of all complaints which shows the name and address of the complainant, the date and nature of the complaint and the adjustment or disposition thereof, for a period of two years after the final settlement of the complaint.

SECTION 2.12 - SPECIFIC UTILITY SERVICE RULES AND REGULATIONS

This section contains specific utility service rules in addition to the rules previously listed under Section 2.0. It must be reviewed and approved by the Commission and in compliance with PUC Rules to be effective.

The Utility adopts the administrative rules of the PUC, as the same may be amended from time to time, as its Company specific service rules and regulations. These rules will be kept on file at the Utility's offices for customer inspection during regular business hours. In the event of a conflict between the PUC's amended rules and the provisions of this tariff, the amended rules shall prevail. Where necessary, any conflicting provision of this tariff shall be deemed to have been superseded by the PUC rule in question to the degree that the Utility may conduct its lawful business in conformance with all requirements of said rule.

All references in Utility's tariff, service contracts, or PUC rules shall mean the Utility's offices at 21089 4783 County Road 302, Navasota, Texas 77358. Customers may make payments, apply for service, and report service problems at the office. Use of the term "business office" shall refer to this office.

All payments for utility service shall be delivered or mailed to the Utility's business office. If the business office fails to receive payment before the time of noticed disconnection for non-payment of a delinquent account, service will be terminated as scheduled. Utility service crews shall not be allowed to collect payments on customer accounts in the field.

Payment of an account by any means that has been dishonored and returned by the payor or payee's bank shall be deemed to be delinquent. All returned payments must be redeemed with a valid money order. If a customer has two returned payments within a twelve-month period, the customer shall be required to pay a deposit if one has not already been paid.

Customers shall not be allowed to use the Utility's cutoff valve on the Utility's side of the meter. Existing customers may install cutoff valves on their side of the meter and are encouraged to do so. All new customers must install customer-owned and -maintained cutoff valves on their side of the meter.

No water connection from any public drinking water supply system shall be made to any establishment where an actual or potential contamination or system hazard exists without an air gap separation between the drinking water supply and the source of potential contamination. The containment air gap is sometimes impractical and, instead, reliance must be placed on individual "internal" air gaps or mechanical backflow prevention devices.

Under these conditions, additional protection shall be required at the meter in the form of a backflow prevention device (in accordance with AWWA Standards C510 and C511, and AWWA Manual M14) on those establishments handling substances deleterious or hazardous to the public health. The water purveyor need not require backflow protection at the water service entrance if an adequate cross-connection control program is in effect that includes an annual inspection and testing by a certified backflow prevention device tester. It will be the responsibility of the water purveyor to ensure that these requirements are met.

Customer shall be liable for any damage or injury to utility-owned property or personnel shown to be caused by the customer, his invitees, his agents, his employees, or others directly under his control.

SECTION 2.12 - SERVICE RULES AND REGULATIONS (CONTINUED)Section 2.12 - Specific Utility Service Rules and Regulations (Continued)

Limitation on Product/Service Liability. Public water utilities are required to deliver water to the customer's side of the meter or service connection that meets the potability and pressure standards of the TCEQ. The Utility will not accept liability for any injury or damage to individuals or their property occurring on the customer's side of the meter when the water delivered meets these state standards. The Utility makes no representations or warranties (expressed or implied) that customer's appliances will not be damaged by disruptions of or fluctuations in water service whatever the cause. The Utility will not accept liability for injuries or damages to persons or property due to disruption of water service caused by: (1) acts of God, (2) acts of third parties not subject to the control of the Utility if the Utility has undertaken such preventive measures as are required by PUC rules, (3) electrical power failures in water systems not required by TCEQ rule to have auxiliary power supplies, or (4) termination of water service pursuant to the Utility's tariff and the PUC's rules. The Utility is not required by law and does not provide fire prevention or firefighting services. The Utility therefore does not accept liability for fire-related injuries or damages to persons or property caused or aggravated by the availability (or lack thereof) of water or water pressure (or lack thereof) during fire emergencies. The Utility will accept liability for any injury or damage to individuals or their property directly caused by defective utility plant (leaking water lines or meters) or the repairs to or construction of the Utility's facilities.

If the services of a registered professional engineer are required as a result of an application for service received by the Utility for service to that applicant's service extension only, the Utility and the applicant will select such engineer, and the applicant shall bear all expenses incurred therein.

If an applicant requires service other than the standard service provided by the Utility, such applicant will be required to pay all expenses incurred by the Utility in excess of the expenses that would be incurred in providing the standard service and connection. Any applicant who places unique or non-standard service demands on the system may be required to provide contributions in aid of construction (as may be allowed by PUC rule) for the actual costs of any additional facilities required to maintain compliance with the TCEQ minimum design criteria for water production, treatment, pumping storage and transmission.

Any applicant or existing customer required to pay for any costs not specifically set forth in the rate schedule pages of this tariff shall be entitled to a written explanation of such costs before payment and/or commencement of construction. If the applicant or existing customer does not believe that these costs are reasonable or necessary, the applicant, or existing customer, shall have the right to appeal such costs to the PUC or such other regulatory authority having jurisdiction over the Utility's rates in that portion of the Utility's service area in which the applicant's or existing customer's property(ies) is located.

Tap fees may be increased by unique costs not normally incurred as may be permitted by 16 TAC 24.86(a)(1)(C).

The Utility adopts the Uniform Plumbing Code pursuant to TCEQ Rule in 30 TAC 290.46(i). The piping and other equipment on the premises furnished by the customer will be maintained by the customer at all times in conformity with the requirements of the TCEQ, the Uniform Plumbing Code and with the service rules and regulations of the Utility.

SECTION 2.12 - SERVICE RULES AND REGULATIONS (CONTINUED)

Section 2.12 - Specific Utility Service Rules and Regulations (Continued)

The customer will bring out his service line to his property line at the point on the customer's property mutually acceptable to the customer and the Utility subject to such requirements as may exist by PUC rule. No water service smaller than 5/8" will be connected. No pipe or pipe fitting which contains more than 8.0% lead can be used for the installation or repair of plumbing at any connection, which provides water for human use. No solder or flux, which contains more than 0.2% lead, can be used at any connection that provides water for human use.

The Utility will have the right of access to the customer's premises at all times reasonable for the purpose of installing, testing, inspecting or repairing water mains or other equipment used in connection with its provision of water service, or for the purpose of removing its property and disconnecting lines, and for all other purposes necessary to the operation of the Utility system including inspecting the customer's plumbing for code, plumbing or tariff violations. The customer shall allow the Utility and its personnel access to the customer's property to conduct any water quality tests or inspections required by law. Unless necessary to respond to equipment failure, leak or other condition creating an immediate threat to public health and safety or the continued provision of adequate utility service to others, such entry upon the customer's property shall be during normal business hours. The customer may require any Utility representative, employee, contractor, or agent seeking to make such entry identify themselves, their affiliation with the Utility, and the purpose of their entry.

Threats to or assaults upon Utility personnel shall result in criminal prosecution.

Except in cases where the customer has a contract with the Utility for reserve or auxiliary service, no other water service will be used by the customer on the same installation in conjunction with the Utility's service, either by means of a crossover valve or any other connection. Customer shall not connect, or allow any other person or party to connect, onto any water lines on his premises. Two places shall not be permitted to be supplied with one service pipe where there is a water main abutting the premises.

No connection shall be allowed which allows water to be returned to the public drinking water supply. No backflow prevention device shall be permitted to be installed in the customer's plumbing without notice to and written permission from the Utility. Any backflow prevention devices so installed shall be inspected annually by a licensed backflow prevention device inspector or appropriately licensed plumber and a written report of such inspection delivered to the Utility.

No application, agreement, or contract for service may be assigned or transferred without the written consent of the Utility.

It is agreed and understood that any and all meters, water lines, and other equipment furnished by the Utility (excepting the customer's individual service lines from the point of connection to customer's structures on customer's premises) are and shall remain the sole property of the Utility, and nothing contained herein or in a contract/application for service shall be construed to reflect a sale or transfer of any such meters, lines, or equipment to any customer. All tap and extension charges shall be for the privilege of connecting to said water lines and for installation, not purchase, of said meters and lines.

SECTION 2.12 - SERVICE RULES AND REGULATIONS (CONTINUED)

Section 2.12 - Specific Utility Service Rules and Regulations (Continued)

Applicants for service at new consuming facilities or facilities which have undergone extensive plumbing modifications are required to deliver to the Utility a certificate that their facilities have been inspected by a state-licensed inspector and that they are in compliance with all applicable plumbing codes and are free of potential hazards to public health and safety. Service may be denied until the certificate is received or any identified violations or hazards are remedied. The Utility is not required to perform these inspections for the applicant/customer, but will assist the applicant/customer to locate and obtain the services of a licensed inspector in a timely manner. When potential sources of contamination are identified which, in the opinion of the inspector or the Utility, require the installation of a state-approved backflow prevention device, such backflow prevention device shall be installed on the customer's service line or other necessary plumbing facilities by an appropriately licensed plumber/backflow prevention device specialist at the customer's expense. The backflow prevention device shall be maintained by the customer at his expense and inspected annually by a licensed inspector. Copies of the annual inspection report must be provided to the Utility. Failure to comply with this requirement may constitute grounds for termination of water service with notice.

All customers or service applicants shall provide access to meters and Utility cutoff valves at all times reasonably necessary to conduct ordinary utility business and after normal business hours as needed to protect and preserve the integrity of the public drinking water supply. Access to meters and cutoff valves shall be controlled by the provisions of 16 TAC 24.89(c).

Where necessary to serve an applicant's property, the Utility may require the applicant to provide it a permanent recorded public utility easement on and across the applicant's real property sufficient to provide service to that applicant.

Service applicants may be required to comply with any pre-condition to receiving service not printed herein as may exist under PUC rule, TCEQ rule (customer service, health and safety, water conservation, or environmental), USEPA rule, TWDB rule, local water or conservation district rule or health department rule. Existing customers shall be required to comply with such rules, including modification of their plumbing and/or consumption patterns, after notice.

SECTION 3.0 - EXTENSION POLICY

Section 3.01 - Standard Extension Requirements

LINE EXTENSION AND CONSTRUCTION CHARGES. No contribution in aid of construction may be required of any customer except as provided for in this approved extension policy.

The customer will be given an itemized statement of the costs, options such as rebates to the customer, sharing of construction costs between the Utility and the customer, or sharing of costs between the customer and other applicants before beginning construction.

The Utility will bear the full cost of any oversizing of water mains necessary to serve other customers in the immediate area. The individual residential customer shall not be charged for any additional production, storage, or treatment facilities. Contributions in aid of construction may not be required of individual residential customers for production, storage, treatment or transmission facilities unless otherwise approved by the Commission under this specific extension policy.

COST UTILITIES SHALL BEAR. Within its certificate area, the Utility will pay the cost of the first 200 feet of any water main or distribution line necessary to extend service to an individual residential customer within a platted subdivision. However, if the residential customer requesting service purchased the property after the developer was notified of the need to provide facilities to the Utility, the Utility may charge for the first 200 feet. The Utility must also be able to document that the developer of the subdivision refused to provide facilities compatible with the Utility's facilities in accordance with the Utility's approved extension policy after receiving a written request from the Utility.

Developers may be required to provide contributions in aid of construction in amounts to furnish the system with all facilities necessary to comply with the PUC's Rules.

SECTION 3.02 - SPECIFIC UTILITY EXTENSION POLICY

This section contains the Utility's specific extension policy that complies with the requirements already stated under Section 3.01. It must be reviewed and approved by the Commission and in compliance with PUC Rules to be effective.

Residential customers not covered under Section 3.01 will be charged the equivalent of the costs of extending service to their property from the nearest transmission or distribution line even if that line does not have adequate capacity to serve the customer. However, if the customer places unique, non-standard service demands upon the system, the customer may be charged the full cost of extending service to and throughout their property, including the cost of all necessary transmission and storage facilities necessary to meet the service demands anticipated to be created by that property.

Developers may be required to provide contributions in aid of construction in amounts sufficient to furnish the development with all facilities necessary to provide for reasonable local demand requirements and to comply with TCEQ minimum design criteria for facilities used in the production, transmission, pumping, or treatment of water or TCEQ minimum requirements. For purposes of this subsection, a developer is one who subdivides or requests more than two meters on a piece of property. Commercial, industrial, and wholesale customers will be treated as developers.

The Utility adopts the administrative rules of the PUC, as amended from time to time, as its Company specific extension policy. These rules will be kept on file at the Company's business office for customer inspection during normal business hours. In the event of a conflict between the PUC's amended rules and the provisions of this tariff, the amended rules shall prevail. Where necessary, any conflicting provision of this tariff shall be deemed to have been superseded by the PUC rule in question to the degree that the Utility may conduct its lawful business in conformance with all requirements of said rule.

When an individual residential applicant requires an extension of a main line beyond 200 feet, the charge to that applicant shall be the actual cost of such extension in excess of 200 feet, plus the applicable tap fee plus such other approved costs as may be provided in this tariff and/or PUC rules.

Residential tap fees may be increased by other unique costs not normally incurred as permitted by PUC rule. Larger meter taps shall be made at actual cost associated with that tap which shall include such extraordinary expenses.

Any service extension to a subdivision (recorded or unrecorded) may be subject to the provisions and restrictions of 16 TAC 24.86(d) and this tariff. When a developer wishes to extend the system to prepare to service multiple new connections, the charge shall be the cost of such extension, plus a pro-rata charge based upon the capacities of production, transmission, storage, pumping and treatment facilities, compliant with the TCEQ minimum design criteria, which must be committed to such extension. As provided by 16 TAC 24.86(d)(4), for purposes of this section, commercial, industrial, and wholesale customers shall be treated as developers.

Any applicant who places unique or non-standard service demands on the system may be required to provide contributions in aid of construction for the actual costs of any additional facilities required to maintain compliance with the TCEQ minimum design criteria for water production, treatment, pumping, storage and transmission.

SECTION 3.02 – SPECIFIC EXTENSION POLICY (CONTINUED)

Unless expressly exempted by PUC rule or order, each point of use (as defined by 16 TAC 24.3) must be individually metered.

The imposition of additional extension costs or charges as provided by Sections 2.12 and 3.02 of this tariff shall be subject to appeal as provided in this tariff, PUC rules, or the rules of such other regulatory authority as may have jurisdiction over the Utility's rates and services. Any applicant required to pay for any costs not specifically set forth in the rate schedule pages of this tariff shall be entitled to a written explanation of such costs before payment and/or commencement of construction. If the applicant does not believe that these costs are reasonable or necessary, the applicant shall have the right to appeal such costs to the PUC or such other regulatory authority having jurisdiction over the Utility's rates in that portion of the Utility's service area in which the applicant's property(ies) is located. Unless the PUC or other regulatory authority enters interlocutory orders to the contrary, service to the applicant may be delayed until such appeal is resolved.

The Utility will provide a written service application form to the applicant for each request for service received by the Utility's business offices. A separate application shall be required for each potential service location if more than any individual applicant desires one service connection. Service application forms will be available for applicant pick up at the Utility's business office during normal weekday business hours. Service applications will be sent by prepaid first class United States mail to the address provided by the applicant upon request. Completed applications should be returned by hand delivery in case there are questions that might delay fulfilling the service request. Completed service applications may be submitted by mail if hand delivery is not possible.

The Utility shall serve each qualified service applicant within its certificated service area as soon as practical after receiving a completed service application. All service requests will be fulfilled within the time limits prescribed by PUC rules once the applicant has met all conditions precedent to achieving "qualified service applicant" status. If a service request cannot be fulfilled within the required period, the applicant shall be notified in writing of the delay, its cause, and the anticipated date that service will be available. The PUC service dates shall not become applicable until the service applicant has met all conditions precedent to becoming a "qualified service applicant" as defined herein or by PUC rules.

The Utility is not required to extend service to any applicant outside of its certificated service area and will only do so, at the Utility's sole option, under terms and conditions mutually agreeable to the Utility and the applicant and upon extension of the Utility's certificated service area boundaries by the PUC. Service applicants may be required to bear the cost of the service area amendment.

A "qualified service applicant" is an applicant who has: (1) met all of the Utility's requirements of service contained in this tariff, PUC rules and/or PUC order, (2) has made all payments for tap fees and extension charges, (3) has provided all necessary easements and rights-of-way necessary to provide service to the requested location, including staking said easements or rights-of-way where necessary, (4) delivered an executed customer service inspection certificate to the Utility and (5) has executed a customer service application for each location to which service is being requested.

SECTION 3.02 – SPECIFIC EXTENSION POLICY (CONTINUED)

Where a new tap or service connection is required, the service applicant shall be required to submit a written service application and request that a tap is made. The tap request must be accompanied with a plat, map, diagram, or written metes and bounds description of precisely where the applicant desires each tap or service connection is to be made and, if necessary, where the meter is to be installed along the applicant's property line. The actual point of connection and meter installation must be readily accessible to Utility personnel for inspection, servicing, and meter reading while being reasonably secure from damage by vehicles and mowers. If the Utility has more than one main adjacent to the service applicant's property, the tap or service connection will be made to the Utility's near service main with adequate capacity to service the applicant's full potential service demand. If the tap or service connection cannot be made at the applicant's desired location, it will be made at another location mutually acceptable to the applicant and the Utility. If no agreement on location can be made, applicant may refer the matter to the TCEQ for resolution. Unless otherwise ordered by the PUC, the tap or service connection will not be made until the location dispute is resolved.

The Utility shall require a developer (as defined by PUC rule) to provide permanent recorded public utility easements as a condition of service to any location within the developer's property. The Developer shall be required to obtain all necessary easements and rights-of-way required to extend the Utility's existing service facilities from their nearest point with adequate service capacity (as prescribed by PUC rules and local service conditions) to and throughout the Developer's property. The easements shall be sufficient to allow the construction, installation, repair, maintenance, testing, and replacement of any and all utility plant necessary to provide continuous and adequate service to each and every potential service location within the property at full occupancy. Unless otherwise restricted by law, well plant sites shall convey with unrestricted rights to produce water for public drinking water supply. Developers shall be required to provide sanitary control easements acceptable to the TCEQ for each water well site to be located within their property or otherwise being obtained to serve their property. Unless otherwise agreed to by the Utility, pipeline right-of-way easements must be at least 15 feet wide to allow adequate room to facilitate backhoe and other heavy equipment operation and meters. Easements must be provided for all production, storage, treatment, pressurization, and disposal sites that are sufficient to construct and maintain all weather roads as prescribed by TCEQ rules. All easements shall be evidenced, at Developer's expense, by recorded county-approved subdivision plat or by specific assignment supported by metes and bounds survey from a surveyor licensed by the State of Texas.

Before the extension of utility service to developers (as defined by PUC rules) or new subdivisions, the Developer shall comply with the following:

(a) The Developer shall make a written request for service to property that is to be subdivided and developed. The Developer shall submit to the Utility a proposed plat on a scale of one inch (1") to two hundred feet (200') for review and determination of required easements, utility plant, and plant location. If sewer service is requested, the plat must contain elevation data. A reconcilable deposit in an amount set by the Utility may be required to cover preliminary engineering, legal, and copy cost to be incurred by the Utility in reviewing and planning to meet this service request. The plat and/or accompanying information shall identify the type, location, and number of houses and other planned structures that will be requiring utility service. If other than residential structures are to be located on the property, all other types of anticipated businesses and their service demands shall be identified with specificity. All areas requiring special irrigation and/or other unique water demands must be identified. To the extent reasonably possible, this information must be precise so that adequate facilities can be designed and constructed to meet all future service demands without hazard to the public, other utility customers, and/or the environment.

SECTION 3.02 – SPECIFIC EXTENSION POLICY (CONTINUED)

(b) After the requirements of easements and rights-of-way have been determined, a red line copy will be returned by the Utility to the Developer for final plat preparation.

(c) Copies of all proposed plats and plans must be submitted to the Utility before their submission to the County for approval to insure that they are compatible with the adequate long-term utility needs of potential service customers. Copies will be returned after review by the Utility so that necessary changes may be incorporated into the Developer's final submitted plat(s) and plans.

(d) The Utility shall be provided with three (3) certified copies of the final plat(s) approved by the County Commissioners Court. At this time, the Utility will begin engineering the facilities necessary to serve the property. Plans and specifications will be prepared and submitted to the TCEQ by the Utility if required by law. If further plat or plans changes are necessary to accommodate the specific service needs of the property and the anticipated customer demands, the Developer will be so notified. Plat amendments must be obtained by the Developer. The Developer shall be notified when all required PUC, TCEQ or other governmental approvals or permits have been received. No construction of utility plant that requires prior TCEQ plans approval shall be commenced until that approval has been received by the Utility and any conditions imposed by the PUC or TCEQ in association with its approvals have been satisfied.

(e) The Developer shall be required to post bond or escrow the funds necessary to construct all required Utility system extensions, except individual taps, meters, and water connections, required to serve the property. Construction shall not commence until funds are available. If the construction is to be done in coordination with the phased development of the property, funds must be provided in advance which are sufficient to complete each phase. No phase or facilities for any phase shall be constructed before the bonding or escrowing of all funds associated with that phase.

(f) At the sole option of the Utility, the Developer may be required to execute a Developer Extension Agreement setting forth all terms and conditions of extending service to their property including all contributions in aid of construction and developer reimbursements, if any.

(g) The Utility may require the Developer to commence construction of subdivision improvements within three (3) months of utility plans approval or the Utility may abate its construction activities until full development construction begins. If the Developer stops construction of subdivision improvements for any purpose, the Utility may abate its construction for a similar period.

(h) As soon as the roads are rough cut and before paving, extension lines will need to be constructed at each road crossing. The Developer must notify the Utility sufficiently in advance of this development stage to allow for the necessary Utility construction without disruption to other service operations of the Utility. Failure to provide adequate advance notice and cooperation in the construction of necessary utility plant may result in additional delays in obtaining service to the property. The Developer shall be required to pay for all additional costs of road boring or other remedial construction necessary to install adequate utility plant throughout the affected property.

SECTION 3.02 – SPECIFIC EXTENSION POLICY (CONTINUED)

(i) The Developer, not the Utility, shall insure that Developer's employees, agents, contractors, and others under its control coordinate their work or construction throughout the property with the Utility to insure the orderly and timely construction of all utility plant necessary to serve the public.

Within its certificated area, the Utility shall bear the cost of the first 200 feet of any water main or sewer collection line necessary to extend service to an individual residential service applicant within a platted subdivision unless the Utility can document:

(a) That the developer of the subdivision refused to provide facilities compatible with the Utility's facilities in accordance with the Utility's approved extension policy after receiving a written request from the Utility; or,

(b) That the Developer defaulted on the terms and conditions of a written agreement or contract existing between the Utility and the developer or the terms of this tariff regarding payment for services, extensions, or other requirements; or in the event the Developer declared bankruptcy and was therefore unable to meet obligations; and

(c) That the residential service applicant purchased the property from the Developer after the Developer was notified of the need to provide facilities to the Utility. A residential service applicant may be charged the remaining costs of extending service to his property; provided, however, that the residential service applicant may only be required to pay the cost equivalent to the cost of extending the nearest water main, whether or not that line has adequate capacity to serve that residential service applicant. The following criteria shall be considered to determine the residential service applicant's cost for extending service:

1) The residential service applicant shall not be required to pay for costs of main extensions greater than 2" in diameter for water distribution.

2) Exceptions may be granted by the PUC if:

i. Adequate service cannot be provided to the applicant using the maximum line sizes listed due to distance or elevation, in which case, it shall be the Utility's burden to justify that a larger diameter pipe is required for adequate service;

ii. Larger minimum line sizes are required under subdivision platting requirements or applicable building codes.

3) If an exception is granted, the Utility shall establish a proportional cost plan for the specific extension or a rebate plan which may be limited to seven years to return the portion of the applicant's costs for oversizing as new customers are added to ensure that future applicants for service on the line pay at least as much as the initial service applicant.

For purposes of determining the costs that service applicants shall pay, commercial customers with service demands greater than residential customer demands in the certificated area, industrial, and wholesale customers shall be treated as developers.

A service applicant requesting a one-inch meter for a lawn sprinkler system to service a residential lot is not considered nonstandard service.



Public Utility Commission of Texas

By These Presents Be It Known To All That

Stonetown Spring Oaks Utilities, LLC

having obtained certification to provide water utility service for the convenience and necessity of the public, and it having been determined by this Commission that the public convenience and necessity would in fact be advanced by the provision of such service, Stonetown Spring Oaks Utilities, LLC is entitled to this

Certificate of Convenience and Necessity No. 13306

to provide continuous and adequate water utility service to that service area or those service areas in Harris County as by final Order or Orders duly entered by this Commission, which Order or Orders resulting from Docket No. 53936 are on file at the Commission offices in Austin, Texas; and are matters of official record available for public inspection; and be it known further that these presents do evidence the authority and the duty of the Stonetown Spring Oaks Utilities, LLC to provide such utility service in accordance with the laws of this State and Rules of this Commission, subject only to any power and responsibility of this Commission to revoke or amend this Certificate in whole or in part upon a subsequent showing that the public convenience and necessity would be better served thereby.



Public Utility Commission of Texas

By These Presents Be It Known To All That

Stonetown Spring Oaks Utilities, LLC

having obtained certification to provide sewer utility service for the convenience and necessity of the public, and it having been determined by this Commission that the public convenience and necessity would in fact be advanced by the provision of such service, Stonetown Spring Oaks Utilities, LLC is entitled to this

Certificate of Convenience and Necessity No. 21134

to provide continuous and adequate sewer utility service to that service area or those service areas in Harris County as by final Order or Orders duly entered by this Commission, which Order or Orders resulting from Docket No. 53936 are on file at the Commission offices in Austin, Texas; and are matters of official record available for public inspection; and be it known further that these presents do evidence the authority and the duty of the Stonetown Spring Oaks Utilities, LLC to provide such utility service in accordance with the laws of this State and Rules of this Commission, subject only to any power and responsibility of this Commission to revoke or amend this Certificate in whole or in part upon a subsequent showing that the public convenience and necessity would be better served thereby.