



Filing Receipt

Received - 2022-03-17 12:12:06 PM

Control Number - 53215

ItemNumber - 8

PUC DOCKET NO. 53215

APPLICATION OF MONARCH UTILITIES I L.P. TO AMEND ITS CERTIFICATES OF CONVENIENCE AND NECESSITY IN HARRIS, LIBERTY, AND MONTGOMERY COUNTIES	§ § § § § §	PUBLIC UTILITY COMMISSION OF TEXAS
---	--	--

MONARCH UTILITIES I L.P.'S RESPONSE TO COMMISSION STAFF'S FIRST REQUEST FOR INFORMATION

To: Public Utility Commission of Texas (Commission), by and through its attorney of record, Merritt Lander, Legal Division, 1701 N. Congress Avenue, P.O. Box 13326, Austin, Texas 78701.

Monarch Utilities I L.P. (Monarch) files its Responses to Public Utility Commission Staff's First Request for Information (RFI) to Monarch received on March 10, 2022. This response is timely filed. Pursuant to 16 Tex. Admin. Code (TAC) § 22.144(c)(2)(F), Monarch agrees and stipulates that all parties may treat the responses as if the answers were filed under oath.

Respectfully submitted,

/s/ Brian Bahr

Director, Rates & Regulatory
Monarch Utilities I L.P.
(646) 599-2415
bbahr@swwc.com

CERTIFICATE OF SERVICE

I hereby certify that, unless otherwise ordered by the presiding officer, notice of the filing of this document was provided to all parties of record via electronic mail on March 17, 2022, in accordance with the Order Suspending Rules, issued in Project No. 50664.



BRIAN D. BAHR

PUC DOCKET NO. 53215

**MONARCH'S RESPONSE TO
COMMISSION STAFF'S FIRST RFI**

Staff 1-1 The application indicates that the requested area will be developed in phases. Please provide the following:

1. A map showing the location of each phase.
2. The connection count expected for each phase.
3. The facilities that will provide service to each phase. all calculations, assumptions, and studies supporting the normalizations proposed affecting purchased water.

RESPONSE: The requested information is found in Attachment 9 included with the Application, which is also provided here for convenience.

Prepared by: Brian Bahr

The Trails Phasing Exhibit (Updated 11-9-21)

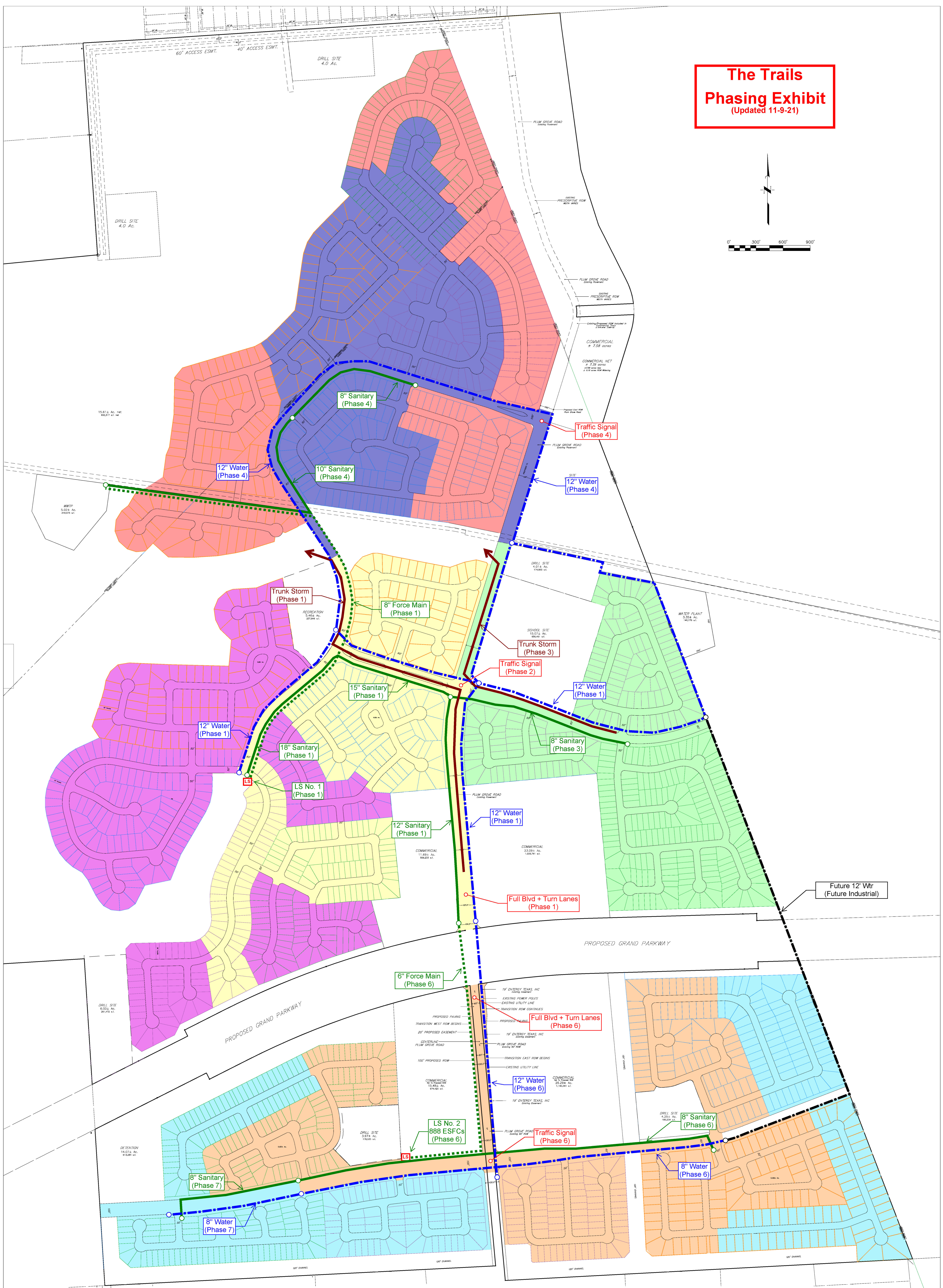
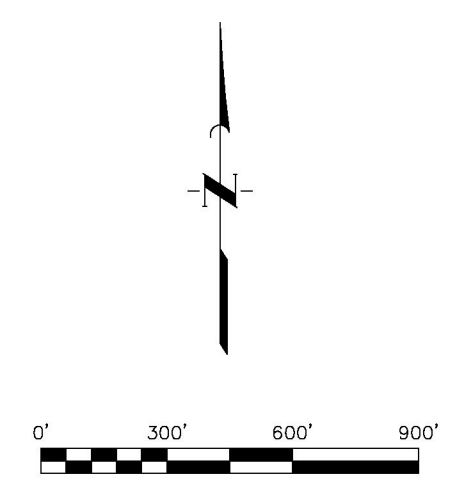

	PHASE 1		PHASE 2		PHASE 3		PHASE 4		PHASE 5		PHASE 6		PHASE 7		TOTAL	
Lot Size	# Lots	%	# Lots	%	# Lots	%	# Lots	%	# Lots	%	# Lots	%	# Lots	%	# Lots	%
40'x120'	66	26.1%	61	17.7%	171	56.3%	69	23.6%	82	27.0%	92	28.6%	142	40.5%	683	31.5%
45'x120'	62	24.5%	47	13.7%	133	43.8%	76	26.0%	60	19.7%	79	24.5%	73	20.8%	530	24.4%
50'x125'	73	28.9%	155	45.1%	0	0.0%	83	28.4%	67	22.0%	75	23.3%	69	19.7%	522	24.1%
60'x125'	52	20.6%	81	23.5%	0	0.0%	64	21.9%	95	31.3%	76	23.6%	67	19.1%	435	20.0%
TOTAL	253	100%	344	100%	304	100%	292	100%	304	100%	322	100%	351	100%	2170	100%