



## Filing Receipt

**Received - 2022-05-10 04:54:03 PM**  
**Control Number - 53184**  
**ItemNumber - 19**

**DOCKET NO. 53184**

<b>JACOB AND JENNIE HILBIG'S</b>	<b>§</b>	<b>PUBLIC UTILITY COMMISSION</b>
<b>APPEAL OF THE COST OF</b>	<b>§</b>	
<b>OBTAINING SERVICE FROM AQUA</b>	<b>§</b>	<b>OF TEXAS</b>
<b>WATER SUPPLY CORPORATION</b>	<b>§</b>	
	<b>§</b>	

**AQUA WATER SUPPLY CORPORATION'S RESPONSE TO  
COMMISSION STAFF'S SECOND REQUEST FOR INFORMATION**

Pursuant to 16 Texas Administrative Code ("TAC") § 22.144, comes now Aqua Water Supply Corporation ("Aqua WSC"), and files this Response to the Staff of the Public Utility Commission of Texas' ("Commission Staff") Second Request for Information ("RFI"). Aqua WSC received the RFI on April 20, 2022. Therefore, this Response is timely filed. Pursuant to 16 TAC §22.144(c)(2)(F), Aqua WSC stipulates that this Response may be treated by all parties as if the answers were filed under oath.

Respectfully submitted,

/s/ Ty H. Embrey  
Ty H. Embrey  
State Bar No. 24025346  
Lloyd, Gosselink, Rochelle & Townsend, P.C.  
816 Congress Avenue, Suite 1900  
Austin, Texas 78701  
(512) 322-5800 phone  
(512) 472-0532 facsimile  
[tembrey@lglawfirm.com](mailto:tembrey@lglawfirm.com)

**ATTORNEY FOR AQUA WATER  
SUPPLY CORPORATION**

**CERTIFICATE OF SERVICE**

I certify that, unless otherwise ordered by the presiding officer, notice of the filing of this document was provided to all parties of record via electronic mail on May 10, 2022, in accordance with the Order Suspending Rules, issued in Project No. 50664.

/s/ Ty H. Embrey \_\_\_\_\_  
Ty H. Embrey

**AQUA WSC'S RESPONSE TO COMMISSION STAFF'S SECOND RFI**  
**QUESTION NOS. STAFF 2-1 THROUGH 2-9**

**STAFF 2-1:** Please provide a detailed list, with prices, of all fees the Hilbig's are required to pay for water service.

**RESPONSE:** Please see the attached preliminary cost summary for a detailed list of the estimated costs and fees associated with providing water service to the Hilbigs' property, attached hereto as **Attachment A**.

**STAFF 2-2** Please provide a detailed list of what fees for water service the Hilbig's have paid for.

**RESPONSE:** On May 11, 2021, Mr. Dustin Wilhelm submitted payment to Aqua WSC for the \$1,200.00 feasibility study fee for the Wilhelm and Hilbig properties located at 714 Lee Road and 704 Lee Road in Bastrop, Texas. On December 8, 2021, Mr. Jacob Hilbig submitted \$150 to Aqua WSC as payment for the research of real property records fee along with the Hilbigs' Water Service Application. The payment of this \$150 fee is reflected in the December 20, 2021 preliminary cost summary (**Attachment A**). To date no other fees for water service have been paid by Jacob and Jennie Hilbig.

**STAFF 2-3** Please provide a list of all requirements of the Rules and Regulations Concerning Aqua's Service to Subdivisions that the Hilbigs have and have not complied with.

**RESPONSE:** The Hilbigs have complied with Section III (A) of Appendix B of Aqua WSC's Tariff which requires the payment of a \$1,200.00 fee to request that Aqua WSC prepare a Feasibility Study for the subdivision of property to be served by Aqua WSC. Mr. Dustin Wilhelm submitted payment to Aqua WSC on May 11, 2021 in the amount of \$1,200.00 to pay for the Feasibility Study for the Wilhelm/Hilbig Subdivision. The Hilbigs also complied with Section 2.03 (p) of Aqua WSC's Tariff with the \$150 payment to pay for Aqua WSC to research the real property records of Bastrop County.

The Hilbigs have not complied with the following sections of Appendix B of Aqua WSC's Tariff:

- Section III (G) – The Hilbigs have not executed a Reserve Capacity Agreement with Aqua WSC or paid any fees in full for the capacity reservations fees associated with the Hilbigs' subdivision.

- Section IV A (1); (2), and (3) – The Hilbigs did not pay Aqua WSC to reserve any LUEs nor did the Hilbigs pay Aqua WSC for any costs of construction necessary to provide service.
- Section VI. – The Hilbigs did not take any action to comply with Aqua WSC’s Construction Rules and Regulations.

**STAFF 2-4**

Please provide a copy of the simulated hydraulic analysis discussed in the “Water Feasibility Study Wilhelm – Hilbig Development” from Steger Bizzell on July 8, 2021.

**RESPONSE:**

Please see the attached pressure graph prepared by Aqua WSC’s consultants at Steger Bizzell, which shows the pressure in PSI over time if meters for the Hilbig and Wilhelm properties were set on the existing 8” water line (**Attachment B**).

**STAFF 2-5**

Please provide a list of all water lines, with line sizes and number of connections per each line, on Lee Road and Watterson Road, for the following area of interest inside the red lines:

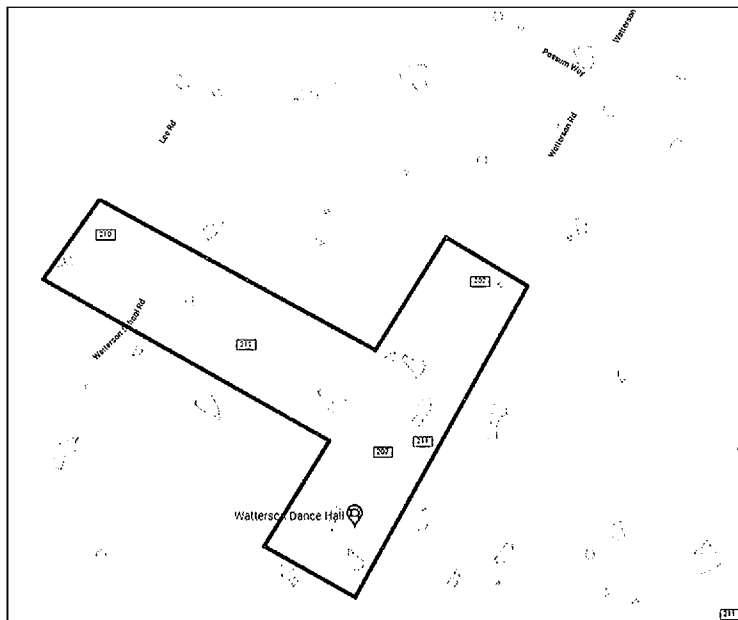

**RESPONSE:**

Aqua WSC has the following existing water lines along Lee Road and Watterson Road:

- Existing 8” water line on the southwest side of Lee Road, continued west of Watterson Road (no connections within the area of interest);

- Existing 4” water line on the north side of Lee Road, west of Watterson Road (two connections);
- Existing 2” water line on the east side of 210 (one connection within the area of interest);
- Existing 1” water line extending northwest of the intersection of 210 and Lee Road (one connection);
- Existing 5” water line on the west side of Watterson Road (three connections within the area of interest);
- Existing 2” water line on the south side of Lee Road, east of Watterson Road (two connections within the area of interest);
- Existing 2” service line on Watterson Road (three connections); and
- Existing 4” water line on Watterson School Road (no connections within the area of interest).

**STAFF 2-6**

Please provide a detailed explanation as to why a new 4” water line is necessary to provide the Hilbig’s with water service.

**RESPONSE:**

The applicant does not have a water line along the frontage of their property that can provide the state-mandated minimum pressure of 35 psi for retail water service. The 8” pipeline along the applicant’s property frontage is a dedicated “fill line” that sends water to Aqua WSC’s Watterson Standpipe. A standpipe is a type of elevated storage tank which pressurizes distribution lines. “Fill line” means that this pipe is on the suction side of the pumps that fill the tank. By contrast, other distribution lines in our system, like the 4” water line across the street, are pressurized by this standpipe to provide retail water service. A new 4” water line is necessary to connect the development to our pressurized distribution system which is able to provide a minimum of 35 psi to the proposed meter.

**STAFF 2-7**

Please provide a copy of the bill of materials and labor costs that support Aqua WSC’s proposed tap fee.

**RESPONSE:**

Please see the attached memorandum titled “Cost of Setting a New Meter” dated April 28, 2022, which provides a detailed outline of the material and labor costs associated with installing a new meter (**Attachment C**). In accordance with Aqua WSC’s Water Tariff, members must pay a system development fee which is used to fund system maintenance and operations.

**STAFF 2-8**

Please provide any invoices, receipts, and work orders that support these costs.

**RESPONSE:**

Please see the attached quote from HydroPro Solutions, LLC, with water meter pricing information (**Attachment D**). Additionally, please see the attached estimates and unit prices for improvements to Aqua WSC's Distribution System for 2022 (**Attachment E**).

**STAFF 2-9**

Please state if tap installations will be done by the utility's internal employees or by a contractor.

**RESPONSE:**

Meter installations are generally performed by Aqua WSC employees. However, Aqua WSC generally engages a contractor to complete water line extensions.

Prepared by:  
Sponsored by:

Ty Embrey  
David McMurry

**Attachment A**



Proposed Water System Improvements  
AQUA WATER SUPPLY CORPORATION  
Bastrop, Texas

**Jacob & Jennie Hilbig**  
Account #: 2200010895  
Bastrop County, Texas

**PRELIMINARY COST SUMMARY**  
(December 20, 2021)

Item/Description	Quantity	Unit Price	Estimated Cost
4" SDR-21 PVC	220 LF	\$18	\$3,960.00
4" Certa-Lok Yelomine Pipe	140 LF	\$30	\$4,200.00
Sand Bedding	260 LF	\$7	\$1,820.00
12-ga. Tracer Wire (taped to pipe twice per joint)	360 LF	\$0.65	\$234.00
M.J. SSB cl-350 D.I. Fittings w/ Restraint Glands	200 Lbs	\$5	\$1,000.00
Bore w/ 8" PVC Casing at Creek Crossing and Road Crossing	100 LF	\$165	\$16,500.00
4" Gate Valve w/ Valve Box and Restraint Glands	4 Ea	\$1,150	\$4,600.00
4" Wet Connection	1 Ea	\$4,000	\$4,000.00
2" Flush Valve w/ 2 1/2" Fire Hose Adapter	1 Ea	\$1,250	\$1,250.00
Erosion Control w/ Silt Fencing	260 LF	\$4	\$1,040.00
Clearing & Chipping	260 LF	\$2	\$520.00
Trench Safety	260 LF	\$2	\$520.00

<b>Construction Total:</b>	<b>\$39,644.00</b>
5/8" x 3/4" Meter	\$4,280.00
Contingencies (approx. 10% of const.)	\$3,960
Engineering (approx. 12% of const.)	\$4,760
Capacity Reservation Fee (\$600 x 1 LUE)	\$600
Membership Fee (\$100 per connection)	\$100
Customer Service Inspection Fee (\$70 per connection)	\$70
Surveying & Staking	\$3,900
Legal	\$2,000
Easements & Right-of-Way	By Developer
LESS \$150 none-refundable deposit paid 12/8/21	-\$150

<b>Grand Total:</b>	<b>\$59,164.00</b>
---------------------	--------------------

NOTE: This is a preliminary cost summary and not an actual contractual construction cost quote. It is not based on any prepared plans or on-site inspections by this office. After surveying and plans are prepared and reviewed, a more accurate estimate can then be provided. This preliminary cost summary shall be valid for 90-days from the date listed above.

**Attachment B**

Pressure for Node Wilhelm-Hilbig

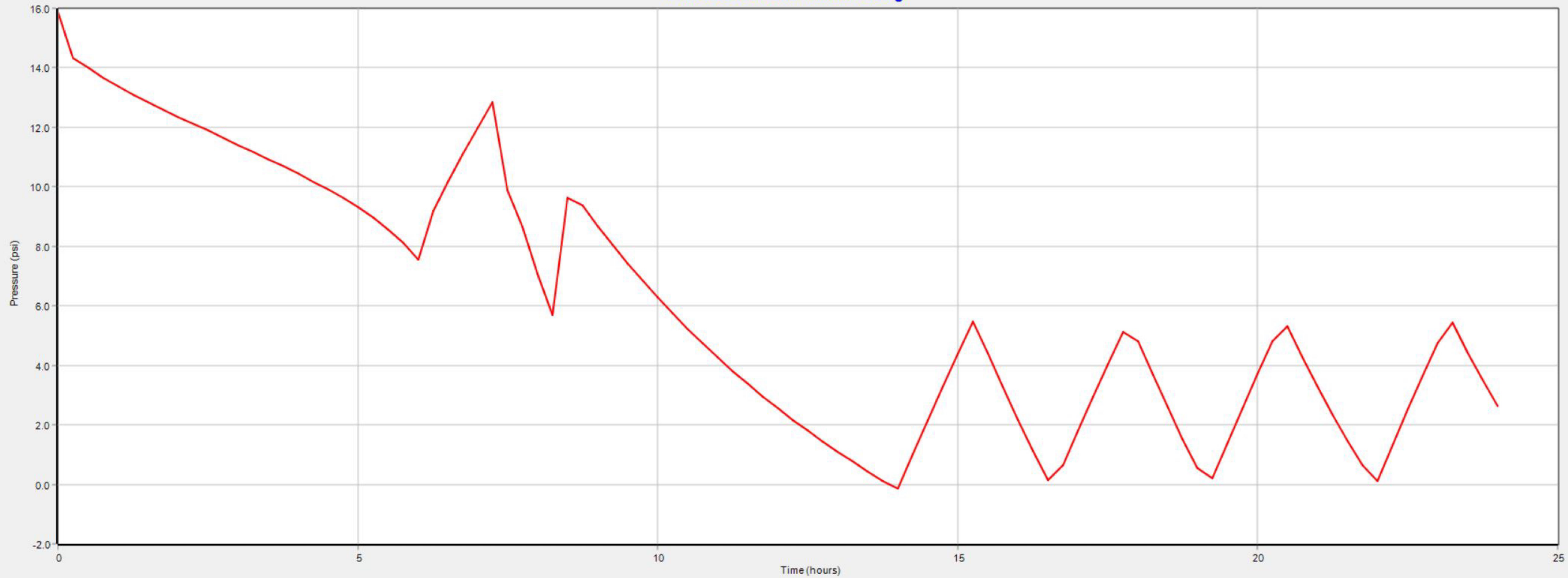

## **Attachment C**

Subject: Cost of Setting a New Meter

April 28, 2022

The purpose of this paper is to detail the cost of installing a new meter. Costs included in the analysis are the material cost of the meter itself with known specific parts, an average material cost for selected parts used in every installation, and the average labor cost (including benefits) to install a typical residential meter.

## MATERIAL COSTS

### **5/8" x 3/4" 3G Bronze Bottom Water Meter Set Without Saddle**

<u>Description</u>	<u>Quantity</u>	<u>Unit Cost</u>	<u>Total Cost</u>
5/8" x 3/4" 3G Electronic Lead-Free Master Meter	1	\$248.67	\$248.67
3/4" Corporation Stop, Lead Free	1	37.04	37.04
3/4" Angle Stop, Lead Free	1	50.29	50.29
3/4" Curb Stop, Lead Free	1	42.70	42.70
3/4" Meter Coupling, Lead Free	1	11.15	11.15
D1300 Series Domestic Meter Box	1	22.29	22.29
Water Meter Marking Pole, 36" Domestic	1	7.00	7.00
3/4" SDR9 Domestic Poly Tubing (Ft.)	12	0.32	3.84
Water Meter Gasket, Rubber, Domestic	2	0.22	0.44
<b>Total</b>			<b>\$423.42</b>

### **3/4" 3G Bronze Bottom Water Meter Set Without Saddle**

<u>Description</u>	<u>Quantity</u>	<u>Unit Cost</u>	<u>Total Cost</u>
3/4" Straight 3G Electronic Lead-Free Master Meter	1	\$265.04	\$265.04
3/4" Corporation Stop, Lead Free	1	37.04	37.04
3/4" Angle Stop, Lead Free	1	50.29	50.29
3/4" Curb Stop, Lead Free	1	42.70	42.70
3/4" Meter Coupling, Lead Free	1	11.15	11.15
D1300 Series Domestic Meter Box	1	22.29	22.29
Water Meter Marking Pole, 36" Domestic	1	7.00	7.00
3/4" SDR9 Domestic Poly Tubing (Ft.)	12	0.32	3.84
Water Meter Gasket, Rubber, Domestic	2	0.22	0.44
<b>Total</b>			<b>\$439.79</b>

### **1" 3G MJ Bronze Bottom Water Meter Set Without Saddle**

<u>Description</u>	<u>Quantity</u>	<u>Unit Cost</u>	<u>Total Cost</u>
1" 3G Electronic Lead-Free Master Meter	1	\$339.49	\$339.49
1" Corporation Stop, Lead Free	1	56.02	56.02
1" Angle Stop, Lead Free	1	128.96	128.96
1" Curb Stop, Lead Free	1	92.96	92.96
1" Meter Coupling, Lead Free	1	17.16	17.16
D1500 Series Domestic Meter Box	1	38.75	38.75
Water Meter Marking Pole, 36" Domestic	1	7.00	7.00
1" SDR9 Domestic Poly Tubing (Ft.)	12	0.50	6.00
Water Meter Gasket, Rubber, Domestic	2	0.32	0.64
<b>Total</b>			<b>\$686.98</b>

### Cost of Saddles

1.5" X 3/4"	\$22.07	4" X 3/4"	\$36.03
2" X 3/4"	\$23.20	5" X 3/4"	\$43.80
2.5" X 3/4"	\$29.00	6" X 3/4"	\$53.75
3" X 3/4"	\$30.62	8" X 3/4"	\$73.88

The size of the required saddle varies with each meter installation but the most commonly used saddle sizes are 2", 4", and 6". The average cost for these three saddles is **\$37.66**.

### LABOR COSTS

**Coordinator:** Identifies the approximate location of the proposed meter on maps and then travels to the site to evaluate location and identify potential problems. Sometimes required to make multiple trips to confirm location of the meter stake and identify issues with the installation of the meter set. The Coordinator then flags and paints immediate area where the installation will occur and notifies the Locator that it is ready.

**Locator:** Gathers information from Coordinator and travels to the location to determine what other utilities and entities are present in the area of the desired meter set location. Locator then initiates a utility locate request and receives confirmation of the other utility companies to be notified to perform a "locate" at the meter site. The locate request is normally completed within 48 business hours. Once locates are confirmed, the work order is turned over to that zone's Water Operator for actual installation of the meter.

**Water Operator and Equipment Crew:** Receive work order, gather necessary materials to complete the meter set, and build the meter assembly at the Warehouse before traveling to the site. The Water Operator and Equipment Crew travel to the meter set location and perform necessary excavation on existing water utilities to exposes the water main for installation of the tap. They then perform remaining excavation and assembly work necessary to install the meter at the desired location.

<b>Coordinator:</b>	1.0 hours
<b>Locator:</b>	1.5 hours
<b>Zone Water Operator:</b>	2.5 hours
<b>Equipment Operator:</b>	2.0 hours
<b>Equipment Operator Assistant:</b>	2.0 hours
<hr/>	
<b>Total</b>	<b>9.0 hours</b>

**TOTAL COSTS**

**5/8" x 3/4" 3G Bronze Bottom Water Meter Set Without Saddle**

Meter and Associated Parts	\$423.42
Saddle	37.66
Labor (9 Hours @ \$31.32/hour)	375.84
<hr/>	
<b>Total</b>	<b>\$836.92</b>

**3/4" 3G Bronze Bottom Water Meter Set Without Saddle**

Meter and Associated Parts	\$439.79
Saddle	37.66
Labor (9 Hours @ \$31.32/hour)	375.84
<hr/>	
<b>Total</b>	<b>\$853.29</b>

**1" 3G MJ Bronze Bottom Water Meter Set Without Saddle**

Meter and Associated Parts	\$686.98
Saddle	37.66
Labor (9 Hours @ \$31.32/hour)	375.84
<hr/>	
<b>Total</b>	<b>\$1,100.48</b>

**Attachment D**



# HydroPro Solutions, LLC

907 Rockmoor Dr.  
Georgetown, TX 78628



## This is not an invoice

Voice: 512.996.8944  
Fax: 512.996.8938

Order Number: 0019922  
Order Date: 4/28/2022  
Ship By: 5/28/2022  
Page: 1

## Quote

<b>To:</b>		<b>Ship To Code: BAST</b>
Aqua WSC 415 Old Austin Highway PO Drawer P Bastrop, TX 78602		Aqua WSC 386 Hwy 304 Route 1 R. Phillips @ (817) 917-2728 Bastrop, TX 78602
<b>CustomerID</b>	<b>PO Number</b>	<b>Sales Rep Name</b>
AQUA	Quote	Robin Phillips
<b>Customer Contact</b>	<b>Shipping Method</b>	<b>R. Phillips</b>
Nicholas Braddock	SP	<b>Terms</b> Net30

Quantity	Item	Description	Unit Price	Amount
1	B12-A31-A01-0101A-1	5/8x3/4 BB BL 3G USG UC39/ Turn On	248.67	248.67
1	B13-A31-A01-0101A-1	3/4" BB BL 3G USG UC39/ Turn On	265.04	265.04
1	B16-A31-A01-0101A-1	1" BB BL 3G USG UC39/ Turn On Approx. Lead Time: 5-7 business days (as of 04/28/22) Quoted by MJ	339.49	339.49

All transactions with HydroPro Solutions, LLC are subject to our Standard Terms and Conditions. Our Terms and Conditions are available for review at <http://hydroprosolutions.com/terms-conditions.php>. Damages or missing items must be reported within 15 days of receipted material. **Mjohnson**

Subtotal:	853.20
Sales Tax:	0.00
Freight:	0.00
<b>TOTAL ORDER AMOUNT:</b>	<b>853.20</b>

**Attachment E**

Apr 1st, 2022

2022 Unit Prices

Aqua Water Distribution System Improvements

Item Description	Unit Price
12" SDR-21 PVC w/tracer wire per lin. ft.	\$53.00
10" SDR-21 PVC w/tracer wire per lin. ft.	\$39.00
8" SDR-21 PVC w/tracer wire per lin. ft.	\$26.75
6" SDR-21 PVC w/tracer wire per lin. ft.	\$17.00
4" SDR-21 PVC w/tracer wire per lin. ft.	\$10.25
3" SDR-21 PVC w/tracer wire per lin. ft.	\$7.50
2" SDR-21 PVC w/tracer wire per lin. ft.	\$5.50
12" SDR-21 RESTRAINT JOINT PVC w/tracer wire per lin. ft.	\$53.00
10" SDR-21 RESTRAINT JOINT PVC w/tracer wire per lin. ft.	\$37.25
8" SDR-21 RESTRAINT JOINT PVC w/tracer wire per lin. ft.	\$29.00
6" SDR-21 RESTRAINT JOINT PVC w/tracer wire per lin. ft.	\$18.75
4" SDR-21 RESTRAINT JOINT PVC w/tracer wire per lin. ft.	\$12.25
3" SDR-21 RESTRAINT JOINT PVC w/tracer wire per lin. ft.	\$10.00
2" SDR-21 RESTRAINT JOINT PVC w/tracer wire per lin. ft.	\$7.00
12" Gate Valve w/valve box per each	\$3,210.00
10" Gate Valve w/valve box per each	\$2,667.00
8" Gate Valve w/valve box per each	\$1,969.00
6" Gate Valve w/valve box per each	\$1,464.00
4" Gate Valve w/valve box per each	\$1,128.00
3" Gate Valve w/valve box per each	\$975.00
2" Gate Valve w/valve box per each	\$860.00
2" Flush Valve w/ 2 1/2" Fire Hose Adapter per each	\$1,300.00
1" Air Release Valve	\$2,000.00
5 1/4" Fire Hydrant per each (gate valve & tee not included)	\$3,541.00
12" Steel or Poly Bore per lin. ft.	\$269.00
10" Steel or Poly Bore per lin. ft.	\$249.00
8" Steel or Poly Bore per lin. ft.	\$145.50
6" Steel or Poly Bore per lin. ft.	\$117.00
4" Steel or Poly Bore per lin. ft.	\$90.50
County Road Bore w/12" PVC casing 50 ft. max	\$6,500.00
County Road Bore w/12" PVC casing per lin. ft. after 50 ft.	\$130.00
County Road Bore w/10" PVC casing 50 ft. max	\$5,000.00
County Road Bore w/10" PVC casing per lin. ft. after 50 ft.	\$100.00
County Road Bore w/8" PVC casing 50 ft. max	\$3,700.00
County Road Bore w/8" PVC casing per lin. ft. after 50 ft.	\$74.00
County Road Bore w/6" PVC casing 50 ft. max	\$2,900.00
County Road Bore w/6" PVC casing per lin. ft. after 50 ft.	\$58.00
County Road Bore w/4" PVC casing 50 ft. max	\$2,250.00
County Road Bore w/4" PVC casing per lin. ft. after 50 ft.	\$45.00
Open Cut Road/Gas Crossing w/12" PVC casing per lin. ft.	\$65.00
Open Cut Road/Gas Crossing w/10" PVC casing per lin. ft.	\$55.00
Open Cut Road/Gas Crossing w/8" PVC casing per lin. ft.	\$40.00
Open Cut Road/Gas Crossing w/6" PVC casing per lin. ft.	\$30.00
Open Cut Road/Gas Crossing w/4" PVC casing per lin. ft.	\$25.00
Driveway Crossing w/o casing per lin. ft. (driveway width)	\$15.00

Cement Stabilization per lin. ft.	\$65.00
Straight Connection (12" or 10")	\$1,500.00
Straight Connection (8" or 6")	\$1,200.00
Straight Connection (3" or 4")	\$1,000.00
Straight Connection (2" or smaller)	\$800.00
Temporary Tie in	\$600.00
2" Hot Tap Tie In on the back side of Main	\$600.00
2" Hot Tap Tie In	\$500.00
Chipping & Clearing per day (3 men, brush chipper & chain saws)	\$2,500.00
Meter Set per each	\$400.00
Meter Relocate/Reset per each	\$550.00
Chlorine Injection Tap	\$400.00
Sand Bedding 2"	\$7.25
Sand Bedding 4"	\$7.75
Sand Bedding 6"	\$8.75
Sand Bedding 8"	\$9.75
Sand Bedding 10"	\$11.00
Sand Bedding 12"	\$13.50

\*\*\*\*\*THE ABOVE PRICES ARE FOR DIRT-----ROCK PRICES WILL VARY PER JOB\*\*\*\*\*

**Authorized Signature:**

Travis Hobbs, President

Travis Hobbs Construction, LLC

3/18/2022

Date

**P.O. DRAWER 489  
BASTROP, TEXAS 78602**

**Fax: 512/581-0417**

**CUSTOMER:** Aqua Water Supply Corporation  
**JOB NAME:** Dunbar Estates Subdivision Approach Main  
**PAY ESTIMATE #:** 1-Final

[illegible]

**BASTROP, TEXAS 78602**

**Fax: 512/581-0417**

### Dunbar Estates Subdivision Approach Main

[illegible]

# PAYMENT REQUEST NO. 1 & FINAL

Owner: Aqua WSC  
Contractor: Travis Hobbs Construction, LLC

Date: December 9, 2021

Project: No. 19970.422

Project: Behrend Ranch Subdivision Approach Main

## ITEMIZED SUMMARY

Item No.	Item Description	Unit Price	Contract Quantity	Units of Measure	Installed This Est.	Cost This Est.	Installed To Date	Total Cost To Date	Contract Total \$
1	Furnish & install 4" SDR-21 PVC as per plans & specs., complete in place:	9.00	4,645	LF	2,405	21,645.00	2,405	21,645.00	41,805.00
2	Furnish & install 12-ga. Tracer Wire (taped to top of pipe twice per joint) as per plans & specs., complete in place:	1.00	4,645	LF	2,405	2,405.00	2,405	2,405.00	4,645.00
3	Furnish & install Sand Bedding as per plans & specs., complete in place:	6.50	4,645	LF	2,405	15,632.50	2,405	15,632.50	30,192.50
4	Furnish & install M.J. 55B cl-350 D.I. Fittings w/ restraint glands as per plans & specs., complete in place:	1.00	1,500	Lbs	1,500	1,500.00	1,500	1,500.00	1,500.00
5	Furnish & install 4" Gate Valve w/ valve box & restraint glands as per plans & specs., complete in place:	1,000.00	4	Ea	3	3,000.00	3	3,000.00	4,000.00
6	Make 4" Wet Connection (including sleeve, tapping tee, and restraints) as per plans & specs., complete in place:	2,500.00	1	Ea	1	2,500.00	1	2,500.00	2,500.00
7	Furnish & install 2" Flush Valve w/ 201/2" Fire Hose Adapter Assembly w/ tee, valve, & restraint glands, as per plans & specs., complete in place:	1,250.00	1	Ea	1	1,250.00	1	1,250.00	1,250.00
8	Furnish & install 1" Automatic Air/Vacuum Release Valve w/ tapping saddle & vault, as per plans & specs., complete in place:	2,000.00	4	Ea	2	4,000.00	2	4,000.00	8,000.00
9	Furnish & install Silt Fencing for erosion control as per plans & specs., complete in place:	3.00	4,645	LF	-	-	-	-	13,935.00
10	Provide Trench & Shoring Safety as req'd as per plans & specs., complete in place:	1.00	4,645	LF	2,405	2,405.00	2,405	2,405.00	4,645.00
11	Provide Clearing & Chipping as req'd as per plans & specs., complete in place:	3.00	4,645	LF	4,645	13,935.00	4,645	13,935.00	13,935.00
Construction Total:						68,272.50		68,272.50	126,467.50
Materials On Hand:									
Retainage:									
AMOUNT DUE:						68,272.50		68,272.50	

The Contractor hereby certifies that all payments received from the Owner for this project have been or will be applied to discharge in full all obligations incurred by the Contractor in work included in this Pay Request and title to all material and equipment incorporated in said work, will pass to the Owner at time of payment, free and clear of all liens, claims, security interests and encumbrances, except as covered by Bond acceptable to the Owner.

Submitted By:   
Travis Hobbs Construction, LLC

Date: 12/9/2021

Recommended By: 

Date: 12/10/21

Approved By: 

Date: 12/14/21