



TCEQ Use Only

# TCEQ Core Data Form

For detailed instructions regarding completion of this form, please read the Core Data Form Instructions or call 512-239-5175.

## SECTION I: General Information

<b>1. Reason for Submission</b> (If other is checked please describe in space provided.) <input type="checkbox"/> New Permit, Registration or Authorization (Core Data Form should be submitted with the program application.) <input type="checkbox"/> Renewal (Core Data Form should be submitted with the renewal form)			<input checked="" type="checkbox"/> Other <b>Wastewater Permit Transfer</b>
<b>2. Customer Reference Number</b> (if issued)  CN 600678379	Follow this link to search for CN or RN numbers in Central Registry**	<b>3. Regulated Entity Reference Number</b> (if issued)  RN 102917291	

## SECTION II: Customer Information

<b>4. General Customer Information</b>		<b>5. Effective Date for Customer Information Updates</b> (mm/dd/yyyy)		4/18/2022	
<input type="checkbox"/> New Customer		<input type="checkbox"/> Update to Customer Information		<input checked="" type="checkbox"/> Change in Regulated Entity Ownership	
<input type="checkbox"/> Change in Legal Name (Verifiable with the Texas Secretary of State or Texas Comptroller of Public Accounts)					
<b>The Customer Name submitted here may be updated automatically based on what is current and active with the Texas Secretary of State (SOS) or Texas Comptroller of Public Accounts (CPA).</b>					
<b>6. Customer Legal Name</b> (If an individual, print last name first: eg: Doe, John)				If new Customer, enter previous Customer below:	
Undine Texas Environmental, LLC				Conroe Resort Utilities, LLC	
<b>7. TX SOS/CPA Filing Number</b>		<b>8. TX State Tax ID</b> (11 digits)		<b>9. Federal Tax ID</b> (9 digits)	
801768069		N/A		46-316881	
<b>10. DUNS Number</b> (if applicable)		N/A			
<b>11. Type of Customer:</b>		<input type="checkbox"/> Corporation		<input type="checkbox"/> Individual	
Partnership: <input type="checkbox"/> General <input type="checkbox"/> Limited		<input type="checkbox"/> Sole Proprietorship		<input checked="" type="checkbox"/> Other: LLC	
Government: <input type="checkbox"/> City <input type="checkbox"/> County <input type="checkbox"/> Federal <input type="checkbox"/> State <input type="checkbox"/> Other					
<b>12. Number of Employees</b>			<b>13. Independently Owned and Operated?</b>		
<input checked="" type="checkbox"/> 0-20 <input type="checkbox"/> 21-100 <input type="checkbox"/> 101-250 <input type="checkbox"/> 251-500 <input type="checkbox"/> 501 and higher			<input type="checkbox"/> Yes <input type="checkbox"/> No		
<b>14. Customer Role</b> (Proposed or Actual) – as it relates to the Regulated Entity listed on this form. Please check one of the following					
<input type="checkbox"/> Owner		<input type="checkbox"/> Operator		<input checked="" type="checkbox"/> Owner & Operator	
<input type="checkbox"/> Occupational Licensee		<input type="checkbox"/> Responsible Party		<input type="checkbox"/> Voluntary Cleanup Applicant <input type="checkbox"/> Other:	
<b>15. Mailing Address:</b>	17681 Telge Road				
	City	Cypress	State	TX	ZIP 77429
<b>16. Country Mailing Information</b> (if outside USA)			<b>17. E-Mail Address</b> (if applicable)		
			cthomas@undinellc.com		
<b>18. Telephone Number</b>		<b>19. Extension or Code</b>		<b>20. Fax Number</b> (if applicable)	
( 713 ) 574-5953				( 713 ) 647-0277	

## SECTION III: Regulated Entity Information

<b>21. General Regulated Entity Information</b> (If 'New Regulated Entity' is selected below this form should be accompanied by a permit application)	
<input type="checkbox"/> New Regulated Entity <input type="checkbox"/> Update to Regulated Entity Name <input checked="" type="checkbox"/> Update to Regulated Entity Information	
<b>The Regulated Entity Name submitted may be updated in order to meet TCEQ Agency Data Standards (removal of organizational endings such as Inc, LP, or LLC).</b>	
<b>22. Regulated Entity Name</b> (Enter name of the site where the regulated action is taking place.)	
Del Lago Wastewater Treatment Facility	

23. Street Address of the Regulated Entity: <i>(No PO Boxes)</i>	3443 Kingsboro Road N.E., Suite 2313						
	City	Atlanta	State	GA	ZIP	30326	ZIP + 4
24. County	Montgomery						

Enter Physical Location Description if no street address is provided.

25. Description to Physical Location:	3.5 miles east of the intersection of FM 149 and FM 1097							
26. Nearest City	Conroe			State	TX	Nearest ZIP Code		77356
27. Latitude (N) In Decimal:	30°23'49.81"N			28. Longitude (W) In Decimal:	95°38'20.09"W			
Degrees	Minutes	Seconds	Degrees	Minutes	Seconds			
29. Primary SIC Code (4 digits)	30. Secondary SIC Code (4 digits)	31. Primary NAICS Code (5 or 6 digits)	32. Secondary NAICS Code (5 or 6 digits)					
4952								
33. What is the Primary Business of this entity? <i>(Do not repeat the SIC or NAICS description.)</i>								
Wastewater Utilities								
34. Mailing Address:	17681 Telge Road							
	City	Cypress	State	TX	ZIP	77429	ZIP + 4	
35. E-Mail Address:	cthomas@undinellc.com							
36. Telephone Number	37. Extension or Code		38. Fax Number <i>(if applicable)</i>					
( 713 ) 574-5953			( 713 ) 647-277					

39. TCEQ Programs and ID Numbers Check all Programs and write in the permits/registration numbers that will be affected by the updates submitted on this form. See the Core Data Form instructions for additional guidance.

<input type="checkbox"/> Dam Safety	<input type="checkbox"/> Districts	<input type="checkbox"/> Edwards Aquifer	<input type="checkbox"/> Emissions Inventory Air	<input type="checkbox"/> Industrial Hazardous Waste
<input type="checkbox"/> Municipal Solid Waste	<input type="checkbox"/> New Source Review Air	<input type="checkbox"/> OSSF	<input type="checkbox"/> Petroleum Storage Tank	<input type="checkbox"/> PWS
<input type="checkbox"/> Sludge	<input type="checkbox"/> Storm Water	<input type="checkbox"/> Title V Air	<input type="checkbox"/> Tires	<input type="checkbox"/> Used Oil
<input type="checkbox"/> Voluntary Cleanup	<input checked="" type="checkbox"/> Waste Water	<input type="checkbox"/> Wastewater Agriculture	<input type="checkbox"/> Water Rights	<input type="checkbox"/> Other:

**SECTION IV: Preparer Information**

40. Name:	Jeff Goebel	41. Title:	Mgr. Business Development
42. Telephone Number	43. Ext./Code	44. Fax Number	45. E-Mail Address
( 713 ) 574-5953		( 713 ) 647-0277	jgoebel@undinellc.com

**SECTION V: Authorized Signature**

46. By my signature below, I certify, to the best of my knowledge, that the information provided in this form is true and complete, and that I have signature authority to submit this form on behalf of the entity specified in Section II, Field 6 and/or as required for the updates to the ID numbers identified in field 39.

Company:	Undine Development, LLC	Job Title:	Sr. Vice President
Name (In Print):	Carey A Thomas	Phone:	( 713 ) 574- 5953
Signature:		Date:	7/4/2021



TEXAS COMMISSION ON ENVIRONMENTAL QUALITY  
**APPLICATION TO TRANSFER A WASTEWATER PERMIT  
OR CAFO PERMIT**

---

If you have questions about completing this form please contact the Applications Review and Processing Team at 512-239-4671.

**SECTION 1. CURRENT PERMIT INFORMATION**

What is the Permit Number? WQ0012493001

What is the EPA I.D. Number? TX 0089630

What is the Current Name on the Permit?

Conroe Resort Utilities, LLC

What is the Customer Number (CN) for the current permittee? CN 603244377

What is the Regulated Entity Reference Number (RN): RN 101608396

For Publicly Owned Treatment Works (POTWs) Only:

- a) Does this permit require implementation of an approved pretreatment program by the POTW?      Yes       No
- b) Does this permit have a domestic reclaimed water authorization associated with it?  
NOTE: **The domestic reclaimed water authorization associated with this permit will be cancelled on the same date the transfer took place.** See instructions for more information.  
Yes       No

**SECTION 2. FACILITY OWNER (APPLICANT) INFORMATION**

**A.** What is the Legal Name of the facility owner?

Undine Texas Environmental, LLC

What is the Customer Number (CN) issued to this entity? CN 604519330

**B.** Complete and attach a Core Data Form (TCEQ-10400) for this customer.

**SECTION 3. CO-APPLICANT INFORMATION**

Complete this section only if another person or entity is required to apply as a co-permittee.

**A.** What is the Legal Name of the co-applicant applying for this permit?

N/A

**B.** What is the Customer Number (CN) issued to this entity? CN

**C.** Complete and attach a Core Data Form (TCEQ-10400) for this customer.

#### **SECTION 4. APPLICATION CONTACT INFORMATION**

This is the person TCEQ will contact if additional information is needed about this application.

Application Contact First and Last Name: Jeff Goebel

Title: Mgr. Business Development      Credentials:

Company Name: Undine Texas Environmental, LLC

Mailing Address: 17681 Telge Road

City, State, and Zip Code: Cypress, TX 77429

Phone Number: 713-574-5953 Fax Number: 713-647-0277

E-mail Address: jgoebel@undinellc.com

#### **SECTION 5. PERMIT CONTACT INFORMATION**

This is the person TCEQ will contact if additional information is needed during the term of the permit.

Permit Contact First and Last Name: Carey A. Thomas

Title: Sr. Vice President      Credentials:

Company Name: Undine Texas Environmental, LLC

Mailing Address: 17681 Telge Road

City, State, and Zip Code: Cypress, TX 77429

Phone Number: 713-574-5953 Fax Number: 713-647-0277

E-mail Address: cthomas@undinellc.com

#### **SECTION 6. SITE INFORMATION**

Site Name: De Lago Wastewater Treatment Facility

#### **SECTION 7. LEASE AND EASEMENT REQUIREMENTS**

**A.** Landowner where the facility is or will be located:

Landowner Name: Undine Texas Environmental, LLC

If this individual is not the same person as the facility owner or co-applicant, attach one of the following documents:

- A lease agreement or deed recorded easement, if the facility is NOT a fixture of the land, or
- A deed recorded easement if the facility IS a fixture of the land.

**B. Landowner of the effluent disposal site:**

Landowner Name: N/A

If this individual is not the same person as the facility owner or co-applicant, attach a lease agreement.

**C. For CAFOs: Attach the following records:**

- Warranty Deed or Property Tax Records
- Lease Agreement (for land management units that are not owned by the facility owner or co-applicant)

Facility Size on the proof of ownership, in acres: N/A

## **SECTION 8. TRANSFER DATE**

What is the date that the transfer of operator or ownership will occur? 5/5/2022

## **SECTION 9. REPORTING AND BILLING INFORMATION**

**A. Please identify the individual for receiving the reporting forms.**

First and Last Name: Carey A Thomas

Title: Sr. Vice President Credentials:

Company Name: Undine Texas Environmental, LLC

Mailing Address: 17681 Telge Road

City, State, and Zip Code: Cypress, TX 77429

Phone Number: 713-574-5953 Fax Number: 713-647-0277

E-mail Address: cthomas@undinellc.com

**B. Please identify the individual for receiving the annual fee invoices.**

First and Last Name: Carey A Thomas

Title: Sr. Vice President Credentials:

Company Name: Undine Texas Environmental, LLC

Mailing Address: 17681 Telge Road

City, State, and Zip Code: Cypress, TX 77249

Phone Number: 713-574-5953 Fax Number: 713-647-0277

E-mail Address: cthomas@undinellc.com

**SECTION 10. DELINQUENT FEES OR PENALTIES**

Do you owe fees to the TCEQ?    Yes             No

Do you owe any penalties to the TCEQ?    Yes             No

If you answered yes to either of the above questions, provide the amount owed, the type of fee or penalty, and an identifying number.

**TRANSFEROR SIGNATURE (Current Facility Owner)**

I consent to the transfer of the permit and I certify under penalty of law that this document and all attachments were prepared under my direction or supervision in accordance with a system designed to assure that qualified personnel properly gather and evaluate the information submitted. Based on my inquiry of the person or persons who manage the system, or those persons directly responsible for gathering the information, the information submitted is, to the best of my knowledge and belief, true, accurate, and complete. I am aware there are significant penalties for submitting false information, including the possibility of fine and imprisonment for knowing violations. I further certify that I am authorized under 30 Texas Administrative Code Section 305.44 to sign this document and can provide documentation in proof of such authorization upon request.

Facility Owner Name: Todd W. Nocerini

Title: Vice President, FQB GP, LLC

Signature: [Handwritten Signature] Date: 11/5/21

SUBSCRIBED AND SWORN to before me by the said Todd W Nocerini on

this 5th day of November, 20 21

My commission expires on the 3rd day of May, 20 22

(Seal)

[Handwritten Signature]  
Notary Public

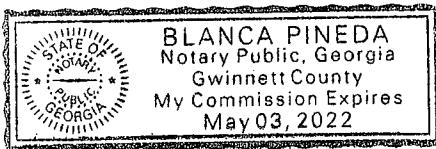

County, Texas

**TRANSFEROR SIGNATURE (Current Facility Co-Applicant)**

Complete if a co-applicant is on the current permit.

I consent to the transfer of the permit and I certify under penalty of law that this document and all attachments were prepared under my direction or supervision in accordance with a system designed to assure that qualified personnel properly gather and evaluate the information submitted. Based on my inquiry of the person or persons who manage the system, or those persons directly responsible for gathering the information, the information submitted is, to the best of my knowledge and belief, true, accurate, and complete. I am aware there are significant penalties for submitting false information, including the possibility of fine and imprisonment for knowing violations. I further certify that I am authorized under 30 Texas Administrative Code Section 305.44 to sign this document and can provide documentation in proof of such authorization upon request.

Facility Co-Applicant Name: N/A

Title: \_\_\_\_\_

Signature: \_\_\_\_\_ Date: \_\_\_\_\_

SUBSCRIBED AND SWORN to before me by the said \_\_\_\_\_ on

this \_\_\_\_\_ day of \_\_\_\_\_, 20\_\_\_\_\_

My commission expires on the \_\_\_\_\_ day of \_\_\_\_\_, 20\_\_\_\_\_

(Seal)

\_\_\_\_\_  
Notary Public

\_\_\_\_\_  
County, Texas



**TRANSFeree SIGNATURE (New Facility Owner)**

I certify that a change of ownership of the facility for the subject permit has been issued will occur as indicated in the application. As a condition of the transfer, I do hereby declare that:

The transferee will be the owner of the existing treatment facility from which wastewater is discharged, deposited or disposed or the facilities required to comply with the permit will be constructed as described in the application considered by the TCEQ prior to the issuance of the permit.

The transferee possesses a copy of the permit, understands the terms and conditions therein, and does accept and assume all obligations of the permit.

The transferee assumes financial responsibility for the proper maintenance and operation of all waste treatment and disposal facilities required by the permit or which may be required to comply with the permit terms and conditions. The transferee certifies that the transfer is not made for the purpose of avoiding liability for improper actions carried out prior to the date of transfer. Neither is the transfer made for the purpose of transferring responsibility for improper operations to an insolvent entity.

The transferee certifies under penalty of law that this document is, to the best of my knowledge and belief, true, accurate, and complete. I am aware there are significant penalties for submitting false information, including the possibility of fine and imprisonment for known violations and revocation of this permit.

New Facility Owner: Carey A. Thomas

Title: Sr. Vice President

Signature: Carey A. Thomas Date: Nov. 4, 2021

SUBSCRIBED AND SWORN to before me by the said Carey A. Thomas on

this 4<sup>th</sup> day of November, 2021

My commission expires on the 2<sup>nd</sup> day of August, 2023

(Seal)

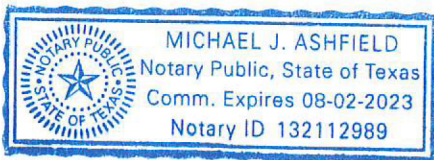

Michael J. Ashfield

Notary Public

Harris

County, Texas

## TRANSFeree SIGNATURE (New Facility Co-Applicant)

Complete if a co-applicant is required.

I certify that a change of ownership of the facility for the subject permit has been issued will occur as indicated in the application. As a condition of the transfer, I do hereby declare that:

The transferee will be the operator of the existing treatment facility from which wastewater is discharged, deposited or disposed or the facilities required to comply with the permit will be constructed as described in the application considered by the TCEQ prior to the issuance of the permit.

The transferee possesses a copy of the permit, understands the terms and conditions therein, and does accept and assume all obligations of the permit.

The transferee assumes financial responsibility for the proper maintenance and operation of all waste treatment and disposal facilities required by the permit or which may be required to comply with the permit terms and conditions. The transferee certifies that the transfer is not made for the purpose of avoiding liability for improper actions carried out prior to the date of transfer. Neither is the transfer made for the purpose of transferring responsibility for improper operations to an insolvent entity.

The transferee certifies under penalty of law that this document is, to the best of my knowledge and belief, true, accurate, and complete. I am aware there are significant penalties for submitting false information, including the possibility of fine and imprisonment for known violations and revocation of this permit.

New Facility Co-Applicant: N/A

Title:

Signature: \_\_\_\_\_ Date: \_\_\_\_\_

SUBSCRIBED AND SWORN to before me by the said \_\_\_\_\_ on

this \_\_\_\_\_ day of \_\_\_\_\_, 20\_\_\_\_\_

My commission expires on the \_\_\_\_\_ day of \_\_\_\_\_, 20\_\_\_\_\_

(Seal)

\_\_\_\_\_  
Notary Public

\_\_\_\_\_  
County, Texas

**SITE OPERATOR SIGNATURE**

Complete only for permits that include composting facilities, land application and/or disposal of sewage sludge **AND** the transferee does not own the land where the disposal activity is conducted.

I understand that I am responsible for operating the site described in the legal description in accordance with the Texas Commission on Environmental Quality requirements in 30 TAC, Chapter 332 and/or 312, the conditions set forth in the permit, and any additional conditions as required by the Texas Commission on Environmental Quality. I also certify under penalty of law that all information submitted is, to the best of my knowledge and belief, true, accurate, and complete. I am aware that there are significant penalties for submitting false information, including the possibility of fine, imprisonment for violations, and revocation of this permit.

Site Operator Name: N/A

Title:

Signature: \_\_\_\_\_ Date: \_\_\_\_\_

SUBSCRIBED AND SWORN to before me by the said \_\_\_\_\_ on

this \_\_\_\_\_ day of \_\_\_\_\_, 20 \_\_\_\_\_

My commission expires on the \_\_\_\_\_ day of \_\_\_\_\_, 20 \_\_\_\_\_

(Seal)

\_\_\_\_\_  
Notary Public

\_\_\_\_\_  
County, Texas

**LAND OWNER SIGNATURE**

Complete Only If Landowner Is Not the Site Operator

I certify that I am the owner of the land described in this application and have all rights and covenants to authorize the applicant for this permit, to use this site for the composting, disposal and/or land application. I understand that 30 Texas Administrative Code Chapters 332 and 312 require me to make a reasonable effort to see that the applicant complies with requirements in 30 Texas Administrative Code Chapters 332 and 312, the conditions set forth in this application, and any additional conditions as required by the Texas Commission on Environmental Quality. I also certify under penalty of law that all information submitted is, to the best of my knowledge and belief, true, accurate, and complete. I am aware that there are significant penalties for submitting false information, including the possibility of fine, imprisonment for violations, and revocation of this permit.

Landowner Name: N/A

Signature: \_\_\_\_\_ Date: \_\_\_\_\_

SUBSCRIBED AND SWORN to before me by the said \_\_\_\_\_ on

this \_\_\_\_\_ day of \_\_\_\_\_, 20\_\_\_\_\_

My commission expires on the \_\_\_\_\_ day of \_\_\_\_\_, 20\_\_\_\_\_

(Seal)

\_\_\_\_\_  
Notary Public

\_\_\_\_\_  
County, Texas

ATTACHMENT 1

INDIVIDUAL INFORMATION

---

**Section 1. Individual Information**

Complete this attachment if the facility applicant or co-applicant is an individual. Make additional copies of this attachment if both are individuals.

Prefix (Mr., Ms., Miss):

Full legal name (first, middle, last):

Driver's License or State Identification Number:

Date of Birth:

Mailing Address:

City, State, and Zip Code:

Phone Number:

Fax Number:

E-mail Address:

CN:

**For Commission Use Only:**

Customer Number:

Regulated Entity Number:

Permit Number:



TPDES PERMIT NO.  
WQ0012493001  
[For TCEQ office use only - EPA I.D.  
No. TX0089630]

TEXAS COMMISSION ON ENVIRONMENTAL QUALITY  
P.O. Box 13087  
Austin, Texas 78711-3087

This is a renewal that replaces TPDES  
Permit No. WQ0012493001 issued on  
September 5, 2012.

PERMIT TO DISCHARGE WASTES  
under provisions of  
Section 402 of the Clean Water Act  
and Chapter 26 of the Texas Water Code

Conroe Resort Utilities, LLC

whose mailing address is

3443 Kingsboro Road N.E., Suite 2313  
Atlanta, Georgia 30326

is authorized to treat and discharge wastes from the Del Lago Wastewater Treatment Facility, SIC Code  
4952

located approximately 3.5 miles east of the intersection of Farm-to-Market Road 149 and Farm-to-  
Market Road 1097, in Montgomery County, Texas 77356

directly to Lake Conroe in Segment No. 1012 of the San Jacinto River Basin

only according to effluent limitations, monitoring requirements, and other conditions set forth in this  
permit, as well as the rules of the Texas Commission on Environmental Quality (TCEQ), the laws of the  
State of Texas, and other orders of the TCEQ. The issuance of this permit does not grant to the  
permittee the right to use private or public property for conveyance of wastewater along the discharge  
route described in this permit. This includes, but is not limited to, property belonging to any individual,  
partnership, corporation or other entity. Neither does this permit authorize any invasion of personal  
rights nor any violation of federal, state, or local laws or regulations. It is the responsibility of the  
permittee to acquire property rights as may be necessary to use the discharge route.

This permit shall expire at midnight, **June 1, 2022**.

ISSUED DATE: September 26, 2017

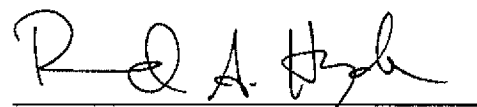
  
For the Commission

INTERIM EFFLUENT LIMITATIONS AND MONITORING REQUIREMENTS

Outfall Number 001

1. During the period beginning upon the date of issuance and lasting through the completion of expansion to the 0.50 million gallons per day (MGD) facility, the permittee is authorized to discharge subject to the following effluent limitations:

The daily average flow of effluent shall not exceed 0.22 MGD, nor shall the average discharge during any two-hour period (2-hour peak) exceed 510 gallons per minute (gpm).

<u>Effluent Characteristic</u>	<u>Discharge Limitations</u>				<u>Min. Self-Monitoring Requirements</u>	
	Daily Avg mg/l (lbs/day)	7-day Avg mg/l	Daily Max mg/l	Single Grab mg/l	Report Daily Avg. & Max. Single Grab Measurement Frequency	Sample Type
Flow, MGD	Report	N/A	Report	N/A	Five/week	Instantaneous
Carbonaceous Biochemical Oxygen Demand (5-day)	10 (18)	15	25	35	One/week	Grab
Total Suspended Solids	15 (28)	25	40	60	One/week	Grab
Ammonia Nitrogen	3 (5.5)	6	10	15	One/week	Grab
<i>E. coli</i> , colony-forming units or most probable number per 100 ml	126	N/A	N/A	399	One/month	Grab

2. The effluent shall contain a chlorine residual of at least 1.0 mg/l and shall not exceed a chlorine residual of 4.0 mg/l after a detention time of at least 20 minutes (based on peak flow), and shall be monitored five times per week by grab sample. An equivalent method of disinfection may be substituted only with prior approval of the Executive Director.
3. The pH shall not be less than 6.0 standard units nor greater than 9.0 standard units and shall be monitored once per month by grab sample.
4. There shall be no discharge of floating solids or visible foam in other than trace amounts and no discharge of visible oil.
5. Effluent monitoring samples shall be taken at the following location(s): Following the final treatment unit.
6. The effluent shall contain a minimum dissolved oxygen of 4.0 mg/l and shall be monitored once per week by grab sample.

FINAL EFFLUENT LIMITATIONS AND MONITORING REQUIREMENTS

Outfall Number 001

1. During the period beginning upon the completion of expansion to the 0.50 million gallons per day (MGD) facility and lasting through the date of expiration, the permittee is authorized to discharge subject to the following effluent limitations:

The daily average flow of effluent shall not exceed 0.50 MGD, nor shall the average discharge during any two-hour period (2-hour peak) exceed 1,042 gallons per minute (gpm).

<u>Effluent Characteristic</u>	<u>Discharge Limitations</u>				<u>Min. Self-Monitoring Requirements</u>	
	Daily Avg mg/l (lbs/day)	7-day Avg mg/l	Daily Max mg/l	Single Grab mg/l	Report Daily Avg. & Daily Max. Measurement Frequency	Sample Type
Flow, MGD	Report	N/A	Report	N/A	Continuous	Totalizing Meter
Carbonaceous Biochemical Oxygen Demand (5-day)	10 (42)	15	25	35	One/week	Composite
Total Suspended Solids	15 (63)	25	40	60	One/week	Composite
Ammonia Nitrogen	2 (8.3)	5	10	15	One/week	Composite
<i>E. coli</i> , colony-forming units or most probable number per 100 ml	126	N/A	399	N/A	One/month	Grab

2. The effluent shall contain a chlorine residual of at least 1.0 mg/l and shall not exceed a chlorine residual of 4.0 mg/l after a detention time of at least 20 minutes (based on peak flow), and shall be monitored daily by grab sample. An equivalent method of disinfection may be substituted only with prior approval of the Executive Director.
3. The pH shall not be less than 6.0 standard units nor greater than 9.0 standard units and shall be monitored twice per month by grab sample.
4. There shall be no discharge of floating solids or visible foam in other than trace amounts and no discharge of visible oil.
5. Effluent monitoring samples shall be taken at the following location(s): Following the final treatment unit.
6. The effluent shall contain minimum dissolved oxygen of 4.0 mg/l and shall be monitored once per week by grab sample.



## DEFINITIONS AND STANDARD PERMIT CONDITIONS

As required by Title 30 Texas Administrative Code (TAC) Chapter 305, certain regulations appear as standard conditions in waste discharge permits. 30 TAC § 305.121 - 305.129 (relating to Permit Characteristics and Conditions) as promulgated under the Texas Water Code (TWC) §§ 5.103 and 5.105, and the Texas Health and Safety Code (THSC) §§ 361.017 and 361.024(a), establish the characteristics and standards for waste discharge permits, including sewage sludge, and those sections of 40 Code of Federal Regulations (CFR) Part 122 adopted by reference by the Commission. The following text includes these conditions and incorporates them into this permit. All definitions in TWC § 26.001 and 30 TAC Chapter 305 shall apply to this permit and are incorporated by reference. Some specific definitions of words or phrases used in this permit are as follows:

### 1. Flow Measurements

- a. Annual average flow - the arithmetic average of all daily flow determinations taken within the preceding 12 consecutive calendar months. The annual average flow determination shall consist of daily flow volume determinations made by a totalizing meter, charted on a chart recorder and limited to major domestic wastewater discharge facilities with one million gallons per day or greater permitted flow.
- b. Daily average flow - the arithmetic average of all determinations of the daily flow within a period of one calendar month. The daily average flow determination shall consist of determinations made on at least four separate days. If instantaneous measurements are used to determine the daily flow, the determination shall be the arithmetic average of all instantaneous measurements taken during that month. Daily average flow determination for intermittent discharges shall consist of a minimum of three flow determinations on days of discharge.
- c. Daily maximum flow - the highest total flow for any 24-hour period in a calendar month.
- d. Instantaneous flow - the measured flow during the minimum time required to interpret the flow measuring device.
- e. 2-hour peak flow (domestic wastewater treatment plants) - the maximum flow sustained for a two-hour period during the period of daily discharge. The average of multiple measurements of instantaneous maximum flow within a two-hour period may be used to calculate the 2-hour peak flow.
- f. Maximum 2-hour peak flow (domestic wastewater treatment plants) - the highest 2-hour peak flow for any 24-hour period in a calendar month.

### 2. Concentration Measurements

- a. Daily average concentration - the arithmetic average of all effluent samples, composite or grab as required by this permit, within a period of one calendar month, consisting of at least four separate representative measurements.
  - i. For domestic wastewater treatment plants - When four samples are not available in a calendar month, the arithmetic average (weighted by flow) of all values in the previous four consecutive month period consisting of at least four measurements shall be utilized as the daily average concentration.

- ii. For all other wastewater treatment plants - When four samples are not available in a calendar month, the arithmetic average (weighted by flow) of all values taken during the month shall be utilized as the daily average concentration.
- b. 7-day average concentration - the arithmetic average of all effluent samples, composite or grab as required by this permit, within a period of one calendar week, Sunday through Saturday.
- c. Daily maximum concentration - the maximum concentration measured on a single day, by the sample type specified in the permit, within a period of one calendar month.
- d. Daily discharge - the discharge of a pollutant measured during a calendar day or any 24-hour period that reasonably represents the calendar day for purposes of sampling. For pollutants with limitations expressed in terms of mass, the daily discharge is calculated as the total mass of the pollutant discharged over the sampling day. For pollutants with limitations expressed in other units of measurement, the daily discharge is calculated as the average measurement of the pollutant over the sampling day.

The daily discharge determination of concentration made using a composite sample shall be the concentration of the composite sample. When grab samples are used, the daily discharge determination of concentration shall be the arithmetic average (weighted by flow value) of all samples collected during that day.

- e. Bacteria concentration (*E. coli* or Enterococci) - Colony Forming Units (CFU) or Most Probable Number (MPN) of bacteria per 100 milliliters effluent. The daily average bacteria concentration is a geometric mean of the values for the effluent samples collected in a calendar month. The geometric mean shall be determined by calculating the  $n$ th root of the product of all measurements made in a calendar month, where  $n$  equals the number of measurements made; or, computed as the antilogarithm of the arithmetic mean of the logarithms of all measurements made in a calendar month. For any measurement of bacteria equaling zero, a substituted value of one shall be made for input into either computation method. If specified, the 7-day average for bacteria is the geometric mean of the values for all effluent samples collected during a calendar week.
  - f. Daily average loading (lbs/day) - the arithmetic average of all daily discharge loading calculations during a period of one calendar month. These calculations must be made for each day of the month that a parameter is analyzed. The daily discharge, in terms of mass (lbs/day), is calculated as (Flow, MGD x Concentration, mg/l x 8.34).
  - g. Daily maximum loading (lbs/day) - the highest daily discharge, in terms of mass (lbs/day), within a period of one calendar month.
3. Sample Type
- a. Composite sample - For domestic wastewater, a composite sample is a sample made up of a minimum of three effluent portions collected in a continuous 24-hour period or during the period of daily discharge if less than 24 hours, and combined in volumes proportional to flow, and collected at the intervals required by 30 TAC § 319.9 (a). For industrial wastewater, a composite sample is a sample made up of a minimum of three effluent portions collected in a continuous 24-hour period or during the period of daily discharge if less than 24 hours, and combined in volumes proportional to flow, and collected at the intervals required by 30 TAC § 319.9 (b).

- b. Grab sample - an individual sample collected in less than 15 minutes.
4. Treatment Facility (facility) - wastewater facilities used in the conveyance, storage, treatment, recycling, reclamation and/or disposal of domestic sewage, industrial wastes, agricultural wastes, recreational wastes, or other wastes including sludge handling or disposal facilities under the jurisdiction of the Commission.
5. The term "sewage sludge" is defined as solid, semi-solid, or liquid residue generated during the treatment of domestic sewage in 30 TAC Chapter 312. This includes the solids that have not been classified as hazardous waste separated from wastewater by unit processes.
6. Bypass - the intentional diversion of a waste stream from any portion of a treatment facility.

## **MONITORING AND REPORTING REQUIREMENTS**

### **1. Self-Reporting**

Monitoring results shall be provided at the intervals specified in the permit. Unless otherwise specified in this permit or otherwise ordered by the Commission, the permittee shall conduct effluent sampling and reporting in accordance with 30 TAC §§ 319.4 - 319.12. Unless otherwise specified, effluent monitoring data shall be submitted each month, to the Enforcement Division (MC 224), by the 20<sup>th</sup> day of the following month for each discharge which is described by this permit whether or not a discharge is made for that month. Monitoring results must be submitted online using the NetDMR reporting system available through the TCEQ website unless the permittee requests and obtains an electronic reporting waiver. Monitoring results must be signed and certified as required by Monitoring and Reporting Requirements No. 10.

As provided by state law, the permittee is subject to administrative, civil and criminal penalties, as applicable, for negligently or knowingly violating the Clean Water Act (CWA); TWC §§ 26, 27, and 28; and THSC § 361, including but not limited to knowingly making any false statement, representation, or certification on any report, record, or other document submitted or required to be maintained under this permit, including monitoring reports or reports of compliance or noncompliance, or falsifying, tampering with or knowingly rendering inaccurate any monitoring device or method required by this permit or violating any other requirement imposed by state or federal regulations.

### **2. Test Procedures**

- a. Unless otherwise specified in this permit, test procedures for the analysis of pollutants shall comply with procedures specified in 30 TAC §§ 319.11 - 319.12. Measurements, tests, and calculations shall be accurately accomplished in a representative manner.
- b. All laboratory tests submitted to demonstrate compliance with this permit must meet the requirements of 30 TAC § 25, Environmental Testing Laboratory Accreditation and Certification.

### **3. Records of Results**

- a. Monitoring samples and measurements shall be taken at times and in a manner so as to be representative of the monitored activity.

- b. Except for records of monitoring information required by this permit related to the permittee's sewage sludge use and disposal activities, which shall be retained for a period of at least five years (or longer as required by 40 CFR Part 503), monitoring and reporting records, including strip charts and records of calibration and maintenance, copies of all records required by this permit, records of all data used to complete the application for this permit, and the certification required by 40 CFR § 264.73(b)(9) shall be retained at the facility site, or shall be readily available for review by a TCEQ representative for a period of three years from the date of the record or sample, measurement, report, application or certification. This period shall be extended at the request of the Executive Director.
- c. Records of monitoring activities shall include the following:
  - i. date, time and place of sample or measurement;
  - ii. identity of individual who collected the sample or made the measurement.
  - iii. date and time of analysis;
  - iv. identity of the individual and laboratory who performed the analysis;
  - v. the technique or method of analysis; and
  - vi. the results of the analysis or measurement and quality assurance/quality control records.

The period during which records are required to be kept shall be automatically extended to the date of the final disposition of any administrative or judicial enforcement action that may be instituted against the permittee.

#### 4. Additional Monitoring by Permittee

If the permittee monitors any pollutant at the location(s) designated herein more frequently than required by this permit using approved analytical methods as specified above, all results of such monitoring shall be included in the calculation and reporting of the values submitted on the approved self-report form. Increased frequency of sampling shall be indicated on the self-report form.

#### 5. Calibration of Instruments

All automatic flow measuring or recording devices and all totalizing meters for measuring flows shall be accurately calibrated by a trained person at plant start-up and as often thereafter as necessary to ensure accuracy, but not less often than annually unless authorized by the Executive Director for a longer period. Such person shall verify in writing that the device is operating properly and giving accurate results. Copies of the verification shall be retained at the facility site and/or shall be readily available for review by a TCEQ representative for a period of three years.

#### 6. Compliance Schedule Reports

Reports of compliance or noncompliance with, or any progress reports on, interim and final requirements contained in any compliance schedule of the permit shall be submitted no later

than 14 days following each schedule date to the Regional Office and the Enforcement Division (MC 224).

#### 7. Noncompliance Notification

- a. In accordance with 30 TAC § 305.125(9) any noncompliance which may endanger human health or safety, or the environment shall be reported by the permittee to the TCEQ. Except as allowed by 30 TAC § 305.132, report of such information shall be provided orally or by facsimile transmission (FAX) to the Regional Office within 24 hours of becoming aware of the noncompliance. A written submission of such information shall also be provided by the permittee to the Regional Office and the Enforcement Division (MC 224) within five working days of becoming aware of the noncompliance. For Publicly Owned Treatment Works (POTWs), effective September 1, 2020, the permittee must submit the written report for unauthorized discharges and unanticipated bypasses that exceed any effluent limit in the permit using the online electronic reporting system available through the TCEQ website unless the permittee requests and obtains an electronic reporting waiver. The written submission shall contain a description of the noncompliance and its cause; the potential danger to human health or safety, or the environment; the period of noncompliance, including exact dates and times; if the noncompliance has not been corrected, the time it is expected to continue; and steps taken or planned to reduce, eliminate, and prevent recurrence of the noncompliance, and to mitigate its adverse effects.
  - b. The following violations shall be reported under Monitoring and Reporting Requirement 7.a.:
    - i. Unauthorized discharges as defined in Permit Condition 2(g).
    - ii. Any unanticipated bypass that exceeds any effluent limitation in the permit.
    - iii. Violation of a permitted maximum daily discharge limitation for pollutants listed specifically in the Other Requirements section of an Industrial TPDES permit.
  - c. In addition to the above, any effluent violation which deviates from the permitted effluent limitation by more than 40% shall be reported by the permittee in writing to the Regional Office and the Enforcement Division (MC 224) within 5 working days of becoming aware of the noncompliance.
  - d. Any noncompliance other than that specified in this section, or any required information not submitted or submitted incorrectly, shall be reported to the Enforcement Division (MC 224) as promptly as possible. For effluent limitation violations, noncompliances shall be reported on the approved self-report form.
8. In accordance with the procedures described in 30 TAC §§ 35.301 - 35.303 (relating to Water Quality Emergency and Temporary Orders) if the permittee knows in advance of the need for a bypass, it shall submit prior notice by applying for such authorization.
9. Changes in Discharges of Toxic Substances

All existing manufacturing, commercial, mining, and silvicultural permittees shall notify the Regional Office, orally or by facsimile transmission within 24 hours, and both the Regional Office and the Enforcement Division (MC 224) in writing within five (5) working days, after becoming aware of or having reason to believe:

- a. That any activity has occurred or will occur which would result in the discharge, on a routine or frequent basis, of any toxic pollutant listed at 40 CFR Part 122, Appendix D, Tables II and III (excluding Total Phenols) which is not limited in the permit, if that discharge will exceed the highest of the following "notification levels":
  - i. One hundred micrograms per liter (100 µg/L);
  - ii. Two hundred micrograms per liter (200 µg/L) for acrolein and acrylonitrile; five hundred micrograms per liter (500 µg/L) for 2,4-dinitrophenol and for 2-methyl-4,6-dinitrophenol; and one milligram per liter (1 mg/L) for antimony;
  - iii. Five (5) times the maximum concentration value reported for that pollutant in the permit application; or
  - iv. The level established by the TCEQ.
- b. That any activity has occurred or will occur which would result in any discharge, on a nonroutine or infrequent basis, of a toxic pollutant which is not limited in the permit, if that discharge will exceed the highest of the following "notification levels":
  - i. Five hundred micrograms per liter (500 µg/L);
  - ii. One milligram per liter (1 mg/L) for antimony;
  - iii. Ten (10) times the maximum concentration value reported for that pollutant in the permit application; or
  - iv. The level established by the TCEQ.

#### 10. Signatories to Reports

All reports and other information requested by the Executive Director shall be signed by the person and in the manner required by 30 TAC § 305.128 (relating to Signatories to Reports).

#### 11. All POTWs must provide adequate notice to the Executive Director of the following:

- a. Any new introduction of pollutants into the POTW from an indirect discharger which would be subject to CWA § 301 or § 306 if it were directly discharging those pollutants;
- b. Any substantial change in the volume or character of pollutants being introduced into that POTW by a source introducing pollutants into the POTW at the time of issuance of the permit; and
- c. For the purpose of this paragraph, adequate notice shall include information on:
  - i. The quality and quantity of effluent introduced into the POTW; and
  - ii. Any anticipated impact of the change on the quantity or quality of effluent to be discharged from the POTW.

**PERMIT CONDITIONS**

## 1. General

- a. When the permittee becomes aware that it failed to submit any relevant facts in a permit application, or submitted incorrect information in an application or in any report to the Executive Director, it shall promptly submit such facts or information.
- b. This permit is granted on the basis of the information supplied and representations made by the permittee during action on an application, and relying upon the accuracy and completeness of that information and those representations. After notice and opportunity for a hearing, this permit may be modified, suspended, or revoked, in whole or in part, in accordance with 30 TAC Chapter 305, Subchapter D, during its term for good cause including, but not limited to, the following:
  - i. Violation of any terms or conditions of this permit;
  - ii. Obtaining this permit by misrepresentation or failure to disclose fully all relevant facts; or
  - iii. A change in any condition that requires either a temporary or permanent reduction or elimination of the authorized discharge.
- c. The permittee shall furnish to the Executive Director, upon request and within a reasonable time, any information to determine whether cause exists for amending, revoking, suspending or terminating the permit. The permittee shall also furnish to the Executive Director, upon request, copies of records required to be kept by the permit.

## 2. Compliance

- a. Acceptance of the permit by the person to whom it is issued constitutes acknowledgment and agreement that such person will comply with all the terms and conditions embodied in the permit, and the rules and other orders of the Commission.
- b. The permittee has a duty to comply with all conditions of the permit. Failure to comply with any permit condition constitutes a violation of the permit and the Texas Water Code or the Texas Health and Safety Code, and is grounds for enforcement action, for permit amendment, revocation, or suspension, or for denial of a permit renewal application or an application for a permit for another facility.
- c. It shall not be a defense for a permittee in an enforcement action that it would have been necessary to halt or reduce the permitted activity in order to maintain compliance with the conditions of the permit.
- d. The permittee shall take all reasonable steps to minimize or prevent any discharge or sludge use or disposal or other permit violation that has a reasonable likelihood of adversely affecting human health or the environment.
- e. Authorization from the Commission is required before beginning any change in the permitted facility or activity that may result in noncompliance with any permit requirements.

- f. A permit may be amended, suspended and reissued, or revoked for cause in accordance with 30 TAC §§ 305.62 and 305.66 and TWC§ 7.302. The filing of a request by the permittee for a permit amendment, suspension and reissuance, or termination, or a notification of planned changes or anticipated noncompliance, does not stay any permit condition.
- g. There shall be no unauthorized discharge of wastewater or any other waste. For the purpose of this permit, an unauthorized discharge is considered to be any discharge of wastewater into or adjacent to water in the state at any location not permitted as an outfall or otherwise defined in the Other Requirements section of this permit.
- h. In accordance with 30 TAC § 305.535(a), the permittee may allow any bypass to occur from a TPDES permitted facility which does not cause permitted effluent limitations to be exceeded or an unauthorized discharge to occur, but only if the bypass is also for essential maintenance to assure efficient operation.
- i. The permittee is subject to administrative, civil, and criminal penalties, as applicable, under TWC §§ 7.051 - 7.075 (relating to Administrative Penalties), 7.101 - 7.111 (relating to Civil Penalties), and 7.141 - 7.202 (relating to Criminal Offenses and Penalties) for violations including, but not limited to, negligently or knowingly violating the federal CWA §§ 301, 302, 306, 307, 308, 318, or 405, or any condition or limitation implementing any sections in a permit issued under the CWA § 402, or any requirement imposed in a pretreatment program approved under the CWA §§ 402 (a)(3) or 402 (b)(8).

### 3. Inspections and Entry

- a. Inspection and entry shall be allowed as prescribed in the TWC Chapters 26, 27, and 28, and THSC § 361.
- b. The members of the Commission and employees and agents of the Commission are entitled to enter any public or private property at any reasonable time for the purpose of inspecting and investigating conditions relating to the quality of water in the state or the compliance with any rule, regulation, permit or other order of the Commission. Members, employees, or agents of the Commission and Commission contractors are entitled to enter public or private property at any reasonable time to investigate or monitor or, if the responsible party is not responsive or there is an immediate danger to public health or the environment, to remove or remediate a condition related to the quality of water in the state. Members, employees, Commission contractors, or agents acting under this authority who enter private property shall observe the establishment's rules and regulations concerning safety, internal security, and fire protection, and if the property has management in residence, shall notify management or the person then in charge of his presence and shall exhibit proper credentials. If any member, employee, Commission contractor, or agent is refused the right to enter in or on public or private property under this authority, the Executive Director may invoke the remedies authorized in TWC § 7.002. The statement above, that Commission entry shall occur in accordance with an establishment's rules and regulations concerning safety, internal security, and fire protection, is not grounds for denial or restriction of entry to any part of the facility, but merely describes the Commission's duty to observe appropriate rules and regulations during an inspection.



#### 4. Permit Amendment and/or Renewal

- a. The permittee shall give notice to the Executive Director as soon as possible of any planned physical alterations or additions to the permitted facility if such alterations or additions would require a permit amendment or result in a violation of permit requirements. Notice shall also be required under this paragraph when:
  - i. The alteration or addition to a permitted facility may meet one of the criteria for determining whether a facility is a new source in accordance with 30 TAC § 305.534 (relating to New Sources and New Dischargers); or
  - ii. The alteration or addition could significantly change the nature or increase the quantity of pollutants discharged. This notification applies to pollutants that are subject neither to effluent limitations in the permit, nor to notification requirements in Monitoring and Reporting Requirements No. 9;
  - iii. The alteration or addition results in a significant change in the permittee's sludge use or disposal practices, and such alteration, addition, or change may justify the application of permit conditions that are different from or absent in the existing permit, including notification of additional use or disposal sites not reported during the permit application process or not reported pursuant to an approved land application plan.
- b. Prior to any facility modifications, additions, or expansions that will increase the plant capacity beyond the permitted flow, the permittee must apply for and obtain proper authorization from the Commission before commencing construction.
- c. The permittee must apply for an amendment or renewal at least 180 days prior to expiration of the existing permit in order to continue a permitted activity after the expiration date of the permit. If an application is submitted prior to the expiration date of the permit, the existing permit shall remain in effect until the application is approved, denied, or returned. If the application is returned or denied, authorization to continue such activity shall terminate upon the effective date of the action. If an application is not submitted prior to the expiration date of the permit, the permit shall expire and authorization to continue such activity shall terminate.
- d. Prior to accepting or generating wastes which are not described in the permit application or which would result in a significant change in the quantity or quality of the existing discharge, the permittee must report the proposed changes to the Commission. The permittee must apply for a permit amendment reflecting any necessary changes in permit conditions, including effluent limitations for pollutants not identified and limited by this permit.
- e. In accordance with the TWC § 26.029(b), after a public hearing, notice of which shall be given to the permittee, the Commission may require the permittee, from time to time, for good cause, in accordance with applicable laws, to conform to new or additional conditions.
- f. If any toxic effluent standard or prohibition (including any schedule of compliance specified in such effluent standard or prohibition) is promulgated under CWA § 307(a) for a toxic pollutant which is present in the discharge and that standard or prohibition is more stringent than any limitation on the pollutant in this permit, this permit shall be

modified or revoked and reissued to conform to the toxic effluent standard or prohibition. The permittee shall comply with effluent standards or prohibitions established under CWA § 307(a) for toxic pollutants within the time provided in the regulations that established those standards or prohibitions, even if the permit has not yet been modified to incorporate the requirement.

5. Permit Transfer

- a. Prior to any transfer of this permit, Commission approval must be obtained. The Commission shall be notified in writing of any change in control or ownership of facilities authorized by this permit. Such notification should be sent to the Applications Review and Processing Team (MC 148) of the Water Quality Division.
- b. A permit may be transferred only according to the provisions of 30 TAC § 305.64 (relating to Transfer of Permits) and 30 TAC § 50.133 (relating to Executive Director Action on Application or WQMP update).

6. Relationship to Hazardous Waste Activities

This permit does not authorize any activity of hazardous waste storage, processing, or disposal that requires a permit or other authorization pursuant to the Texas Health and Safety Code.

7. Relationship to Water Rights

Disposal of treated effluent by any means other than discharge directly to water in the state must be specifically authorized in this permit and may require a permit pursuant to TWC Chapter 11.

8. Property Rights

A permit does not convey any property rights of any sort, or any exclusive privilege.

9. Permit Enforceability

The conditions of this permit are severable, and if any provision of this permit, or the application of any provision of this permit to any circumstances, is held invalid, the application of such provision to other circumstances, and the remainder of this permit, shall not be affected thereby.

10. Relationship to Permit Application

The application pursuant to which the permit has been issued is incorporated herein; provided, however, that in the event of a conflict between the provisions of this permit and the application, the provisions of the permit shall control.

11. Notice of Bankruptcy

- a. Each permittee shall notify the Executive Director, in writing, immediately following the filing of a voluntary or involuntary petition for bankruptcy under any chapter of Title 11 Bankruptcy) of the United States Code (11 USC) by or against:
  - i. the permittee;

- ii. an entity (as that term is defined in 11 USC, § 101(14)) controlling the permittee or listing the permit or permittee as property of the estate; or
  - iii. an affiliate (as that term is defined in 11 USC, § 101(2)) of the permittee.
- b. This notification must indicate:
- i. the name of the permittee and the permit number(s);
  - ii. the bankruptcy court in which the petition for bankruptcy was filed; and
  - iii. the date of filing of the petition.

### **OPERATIONAL REQUIREMENTS**

1. The permittee shall at all times ensure that the facility and all of its systems of collection, treatment, and disposal are properly operated and maintained. This includes, but is not limited to, the regular, periodic examination of wastewater solids within the treatment plant by the operator in order to maintain an appropriate quantity and quality of solids inventory as described in the various operator training manuals and according to accepted industry standards for process control. Process control, maintenance, and operations records shall be retained at the facility site, or shall be readily available for review by a TCEQ representative, for a period of three years.
2. Upon request by the Executive Director, the permittee shall take appropriate samples and provide proper analysis in order to demonstrate compliance with Commission rules. Unless otherwise specified in this permit or otherwise ordered by the Commission, the permittee shall comply with all applicable provisions of 30 TAC Chapter 312 concerning sewage sludge use and disposal and 30 TAC §§ 319.21 - 319.29 concerning the discharge of certain hazardous metals.
3. Domestic wastewater treatment facilities shall comply with the following provisions:
  - a. The permittee shall notify the Municipal Permits Team, Wastewater Permitting Section (MC 148) of the Water Quality Division, in writing, of any facility expansion at least 90 days prior to conducting such activity.
  - b. The permittee shall submit a closure plan for review and approval to the Municipal Permits Team, Wastewater Permitting Section (MC 148) of the Water Quality Division, for any closure activity at least 90 days prior to conducting such activity. Closure is the act of permanently taking a waste management unit or treatment facility out of service and includes the permanent removal from service of any pit, tank, pond, lagoon, surface impoundment and/or other treatment unit regulated by this permit.
4. The permittee is responsible for installing prior to plant start-up, and subsequently maintaining, adequate safeguards to prevent the discharge of untreated or inadequately treated wastes during electrical power failures by means of alternate power sources, standby generators, and/or retention of inadequately treated wastewater.

5. Unless otherwise specified, the permittee shall provide a readily accessible sampling point and, where applicable, an effluent flow measuring device or other acceptable means by which effluent flow may be determined.
6. The permittee shall remit an annual water quality fee to the Commission as required by 30 TAC Chapter 21. Failure to pay the fee may result in revocation of this permit under TWC § 7.302(b)(6).
7. Documentation

For all written notifications to the Commission required of the permittee by this permit, the permittee shall keep and make available a copy of each such notification under the same conditions as self-monitoring data are required to be kept and made available. Except for information required for TPDES permit applications, effluent data, including effluent data in permits, draft permits and permit applications, and other information specified as not confidential in 30 TAC §§ 1.5(d), any information submitted pursuant to this permit may be claimed as confidential by the submitter. Any such claim must be asserted in the manner prescribed in the application form or by stamping the words confidential business information on each page containing such information. If no claim is made at the time of submission, information may be made available to the public without further notice. If the Commission or Executive Director agrees with the designation of confidentiality, the TCEQ will not provide the information for public inspection unless required by the Texas Attorney General or a court pursuant to an open records request. If the Executive Director does not agree with the designation of confidentiality, the person submitting the information will be notified.

8. Facilities that generate domestic wastewater shall comply with the following provisions; domestic wastewater treatment facilities at permitted industrial sites are excluded.
  - a. Whenever flow measurements for any domestic sewage treatment facility reach 75% of the permitted daily average or annual average flow for three consecutive months, the permittee must initiate engineering and financial planning for expansion and/or upgrading of the domestic wastewater treatment and/or collection facilities. Whenever the flow reaches 90% of the permitted daily average or annual average flow for three consecutive months, the permittee shall obtain necessary authorization from the Commission to commence construction of the necessary additional treatment and/or collection facilities. In the case of a domestic wastewater treatment facility which reaches 75% of the permitted daily average or annual average flow for three consecutive months, and the planned population to be served or the quantity of waste produced is not expected to exceed the design limitations of the treatment facility, the permittee shall submit an engineering report supporting this claim to the Executive Director of the Commission.

If in the judgment of the Executive Director the population to be served will not cause permit noncompliance, then the requirement of this section may be waived. To be effective, any waiver must be in writing and signed by the Director of the Enforcement Division (MC 169) of the Commission, and such waiver of these requirements will be reviewed upon expiration of the existing permit; however, any such waiver shall not be interpreted as condoning or excusing any violation of any permit parameter.

- b. The plans and specifications for domestic sewage collection and treatment works associated with any domestic permit must be approved by the Commission and failure to secure approval before commencing construction of such works or making a discharge is a violation of this permit and each day is an additional violation until approval has been secured.
  - c. Permits for domestic wastewater treatment plants are granted subject to the policy of the Commission to encourage the development of area-wide waste collection, treatment, and disposal systems. The Commission reserves the right to amend any domestic wastewater permit in accordance with applicable procedural requirements to require the system covered by this permit to be integrated into an area-wide system, should such be developed; to require the delivery of the wastes authorized to be collected in, treated by or discharged from said system, to such area-wide system; or to amend this permit in any other particular to effectuate the Commission's policy. Such amendments may be made when the changes required are advisable for water quality control purposes and are feasible on the basis of waste treatment technology, engineering, financial, and related considerations existing at the time the changes are required, exclusive of the loss of investment in or revenues from any then existing or proposed waste collection, treatment or disposal system.
9. Domestic wastewater treatment plants shall be operated and maintained by sewage plant operators holding a valid certificate of competency at the required level as defined in 30 TAC Chapter 30.
  10. For Publicly Owned Treatment Works (POTWs), the 30-day average (or monthly average) percent removal for BOD and TSS shall not be less than 85%, unless otherwise authorized by this permit.
  11. Facilities that generate industrial solid waste as defined in 30 TAC § 335.1 shall comply with these provisions:
    - a. Any solid waste, as defined in 30 TAC § 335.1 (including but not limited to such wastes as garbage, refuse, sludge from a waste treatment, water supply treatment plant or air pollution control facility, discarded materials, discarded materials to be recycled, whether the waste is solid, liquid, or semisolid), generated by the permittee during the management and treatment of wastewater, must be managed in accordance with all applicable provisions of 30 TAC Chapter 335, relating to Industrial Solid Waste Management.
    - b. Industrial wastewater that is being collected, accumulated, stored, or processed before discharge through any final discharge outfall, specified by this permit, is considered to be industrial solid waste until the wastewater passes through the actual point source discharge and must be managed in accordance with all applicable provisions of 30 TAC Chapter 335.
    - c. The permittee shall provide written notification, pursuant to the requirements of 30 TAC § 335.8(b)(1), to the Environmental Cleanup Section (MC 127) of the Remediation Division informing the Commission of any closure activity involving an Industrial Solid Waste Management Unit, at least 90 days prior to conducting such an activity.

- d. Construction of any industrial solid waste management unit requires the prior written notification of the proposed activity to the Registration and Reporting Section (MC 129) of the Registration, Review, and Reporting Division. No person shall dispose of industrial solid waste, including sludge or other solids from wastewater treatment processes, prior to fulfilling the deed recordation requirements of 30 TAC § 335.5.
- e. The term "industrial solid waste management unit" means a landfill, surface impoundment, waste-pile, industrial furnace, incinerator, cement kiln, injection well, container, drum, salt dome waste containment cavern, or any other structure vessel, appurtenance, or other improvement on land used to manage industrial solid waste.
- f. The permittee shall keep management records for all sludge (or other waste) removed from any wastewater treatment process. These records shall fulfill all applicable requirements of 30 TAC § 335 and must include the following, as it pertains to wastewater treatment and discharge:
  - i. Volume of waste and date(s) generated from treatment process;
  - ii. Volume of waste disposed of on-site or shipped off-site;
  - iii. Date(s) of disposal;
  - iv. Identity of hauler or transporter;
  - v. Location of disposal site; and
  - vi. Method of final disposal.

The above records shall be maintained on a monthly basis. The records shall be retained at the facility site, or shall be readily available for review by authorized representatives of the TCEQ for at least five years.

12. For industrial facilities to which the requirements of 30 TAC § 335 do not apply, sludge and solid wastes, including tank cleaning and contaminated solids for disposal, shall be disposed of in accordance with THSC § 361.

TCEQ Revision 08/2008

## SLUDGE PROVISIONS

The permittee is authorized to dispose of sludge only at a Texas Commission on Environmental Quality (TCEQ) authorized land application site, co-disposal landfill, wastewater treatment facility, or facility that further processes sludge. **The disposal of sludge by land application on property owned, leased or under the direct control of the permittee is a violation of the permit unless the site is authorized with the TCEQ. This provision does not authorize Distribution and Marketing of Class A or Class AB Sewage Sludge. This provision does not authorize the permittee to land apply sludge on property owned, leased or under the direct control of the permittee.**

### SECTION I. REQUIREMENTS APPLYING TO ALL SEWAGE SLUDGE LAND APPLICATION

#### A. General Requirements

1. The permittee shall handle and dispose of sewage sludge in accordance with 30 TAC § 312 and all other applicable state and federal regulations in a manner that protects public health and the environment from any reasonably anticipated adverse effects due to any toxic pollutants that may be present in the sludge.
2. In all cases, if the person (permit holder) who prepares the sewage sludge supplies the sewage sludge to another person for land application use or to the owner or lease holder of the land, the permit holder shall provide necessary information to the parties who receive the sludge to assure compliance with these regulations.
3. The permittee shall give 180 days prior notice to the Executive Director in care of the Wastewater Permitting Section (MC 148) of the Water Quality Division of any change planned in the sewage sludge disposal practice.

#### B. Testing Requirements

1. Sewage sludge shall be tested once during the term of this permit in accordance with the method specified in both 40 CFR Part 261, Appendix II and 40 CFR Part 268, Appendix I [Toxicity Characteristic Leaching Procedure (TCLP)] or other method that receives the prior approval of the TCEQ for the contaminants listed in 40 CFR Part 261.24, Table 1. Sewage sludge failing this test shall be managed according to RCRA standards for generators of hazardous waste, and the waste's disposition must be in accordance with all applicable requirements for hazardous waste processing, storage, or disposal. Following failure of any TCLP test, the management or disposal of sewage sludge at a facility other than an authorized hazardous waste processing, storage, or disposal facility shall be prohibited until such time as the permittee can demonstrate the sewage sludge no longer exhibits the hazardous waste toxicity characteristics (as demonstrated by the results of the TCLP tests). A written report shall be provided to both the TCEQ Registration and Reporting Section (MC 129) of the Permitting and Remediation Support Division and the Regional Director (MC Region 12) within seven (7) days after failing the TCLP Test.

The report shall contain test results, certification that unauthorized waste management has stopped and a summary of alternative disposal plans that comply with RCRA standards for the management of hazardous waste. The report shall be addressed to: Director, Registration, Review, and Reporting Division (MC 129), Texas Commission on Environmental Quality, P.O. Box 13087, Austin, Texas 78711-3087. In addition, the permittee shall prepare an annual report on the results of all sludge toxicity testing. This annual report shall be submitted to the TCEQ Regional Office (MC Region 12) and the Compliance Monitoring Team (MC 224) of the Enforcement Division by September 30<sup>th</sup> of each year. Effective September 1, 2020, the permittee must submit this annual report using the online electronic reporting system available through the TCEQ website unless the permittee requests and obtains an electronic reporting waiver.

2. Sewage sludge shall not be applied to the land if the concentration of the pollutants exceeds the pollutant concentration criteria in Table 1. The frequency of testing for pollutants in Table 1 is found in Section I.C.

TABLE 1

<u>Pollutant</u>	<u>Ceiling Concentration</u> <u>(Milligrams per kilogram)*</u>
Arsenic	75
Cadmium	85
Chromium	3000
Copper	4300
Lead	840
Mercury	57
Molybdenum	75
Nickel	420
PCBs	49
Selenium	100
Zinc	7500

\* Dry weight basis

3. Pathogen Control

All sewage sludge that is applied to agricultural land, forest, a public contact site, or a reclamation site must be treated by one of the following methods to ensure that the sludge meets either the Class A, Class AB or Class B pathogen requirements.

- a. For sewage sludge to be classified as Class A with respect to pathogens, the density of fecal coliform in the sewage sludge be less than 1,000 most probable number (MPN) per gram of total solids (dry weight basis), or the density of *Salmonella* sp. bacteria in the sewage sludge be less than three MPN per four grams of total solids (dry weight basis) at the time the sewage sludge is used or disposed. In addition, one of the alternatives listed below must be met.

Alternative 1 - The temperature of the sewage sludge that is used or disposed shall be maintained at or above a specific value for a period of time. See 30 TAC § 312.82(a)(2)(A) for specific information.



Alternative 5 (PFRP) - Sewage sludge that is used or disposed of must be treated in one of the Processes to Further Reduce Pathogens (PFRP) described in 40 CFR Part 503, Appendix B. PFRP include composting, heat drying, heat treatment, and thermophilic aerobic digestion.

Alternative 6 (PFRP Equivalent) - Sewage sludge that is used or disposed of must be treated in a process that has been approved by the U. S. Environmental Protection Agency as being equivalent to those in Alternative 5.

- b. For sewage sludge to be classified as Class AB with respect to pathogens, the density of fecal coliform in the sewage sludge be less than 1,000 MPN per gram of total solids (dry weight basis), or the density of *Salmonella* sp. bacteria in the sewage sludge be less than three MPN per four grams of total solids (dry weight basis) at the time the sewage sludge is used or disposed. In addition, one of the alternatives listed below must be met.

Alternative 2 - The pH of the sewage sludge that is used or disposed shall be raised to above 12 std. units and shall remain above 12 std. units for 72 hours.

The temperature of the sewage sludge shall be above 52° Celsius for 12 hours or longer during the period that the pH of the sewage sludge is above 12 std. units.

At the end of the 72-hour period during which the pH of the sewage sludge is above 12 std. units, the sewage sludge shall be air dried to achieve a percent solids in the sewage sludge greater than 50%.

Alternative 3 - The sewage sludge shall be analyzed for enteric viruses prior to pathogen treatment. The limit for enteric viruses is less than one Plaque-forming Unit per four grams of total solids (dry weight basis) either before or following pathogen treatment. See 30 TAC § 312.82(a)(2)(C)(i-iii) for specific information. The sewage sludge shall be analyzed for viable helminth ova prior to pathogen treatment. The limit for viable helminth ova is less than one per four grams of total solids (dry weight basis) either before or following pathogen treatment. See 30 TAC § 312.82(a)(2)(C)(iv-vi) for specific information.

Alternative 4 - The density of enteric viruses in the sewage sludge shall be less than one Plaque-forming Unit per four grams of total solids (dry weight basis) at the time the sewage sludge is used or disposed. The density of viable helminth ova in the sewage sludge shall be less than one per four grams of total solids (dry weight basis) at the time the sewage sludge is used or disposed.

- c. Sewage sludge that meets the requirements of Class AB sewage sludge may be classified a Class A sewage sludge if a variance request is submitted in writing that is supported by substantial documentation demonstrating equivalent methods for reducing odors and written approval is granted by the executive director. The executive director may deny the variance request or revoke that approved variance if it is determined that the variance may potentially endanger human health or the environment, or create nuisance odor conditions.

- d. Three alternatives are available to demonstrate compliance with Class B criteria for sewage sludge.

Alternative 1

- i. A minimum of seven random samples of the sewage sludge shall be collected within 48 hours of the time the sewage sludge is used or disposed of during each monitoring episode for the sewage sludge.
- ii. The geometric mean of the density of fecal coliform in the samples collected shall be less than either 2,000,000 MPN per gram of total solids (dry weight basis) or 2,000,000 Colony Forming Units per gram of total solids (dry weight basis).

Alternative 2 - Sewage sludge that is used or disposed of shall be treated in one of the Processes to Significantly Reduce Pathogens (PSRP) described in 40 CFR Part 503, Appendix B, so long as all of the following requirements are met by the generator of the sewage sludge.

- i. Prior to use or disposal, all the sewage sludge must have been generated from a single location, except as provided in paragraph v. below;
- ii. An independent Texas Licensed Professional Engineer must make a certification to the generator of a sewage sludge that the wastewater treatment facility generating the sewage sludge is designed to achieve one of the PSRP at the permitted design loading of the facility. The certification need only be repeated if the design loading of the facility is increased. The certification shall include a statement indicating the design meets all the applicable standards specified in Appendix B of 40 CFR Part 503;
- iii. Prior to any off-site transportation or on-site use or disposal of any sewage sludge generated at a wastewater treatment facility, the chief certified operator of the wastewater treatment facility or other responsible official who manages the processes to significantly reduce pathogens at the wastewater treatment facility for the permittee, shall certify that the sewage sludge underwent at least the minimum operational requirements necessary in order to meet one of the PSRP. The acceptable processes and the minimum operational and record keeping requirements shall be in accordance with established U.S. Environmental Protection Agency final guidance;
- iv. All certification records and operational records describing how the requirements of this paragraph were met shall be kept by the generator for a minimum of three years and be available for inspection by commission staff for review; and
- v. If the sewage sludge is generated from a mixture of sources, resulting from a person who prepares sewage sludge from more than one wastewater treatment facility, the resulting derived product shall meet one of the PSRP, and shall meet the certification, operation, and record keeping requirements of this paragraph.

Alternative 3 - Sewage sludge shall be treated in an equivalent process that has been approved by the U.S. Environmental Protection Agency, so long as all of the following requirements are met by the generator of the sewage sludge.

- i. Prior to use or disposal, all the sewage sludge must have been generated from a single location, except as provided in paragraph v. below;
- ii. Prior to any off-site transportation or on-site use or disposal of any sewage sludge generated at a wastewater treatment facility, the chief certified operator of the wastewater treatment facility or other responsible official who manages the processes to significantly reduce pathogens at the wastewater treatment facility for the permittee, shall certify that the sewage sludge underwent at least the minimum operational requirements necessary in order to meet one of the PSRP. The acceptable processes and the minimum operational and record keeping requirements shall be in accordance with established U.S. Environmental Protection Agency final guidance;
- iii. All certification records and operational records describing how the requirements of this paragraph were met shall be kept by the generator for a minimum of three years and be available for inspection by commission staff for review;
- iv. The Executive Director will accept from the U.S. Environmental Protection Agency a finding of equivalency to the defined PSRP; and
- v. If the sewage sludge is generated from a mixture of sources resulting from a person who prepares sewage sludge from more than one wastewater treatment facility, the resulting derived product shall meet one of the Processes to Significantly Reduce Pathogens, and shall meet the certification, operation, and record keeping requirements of this paragraph.

In addition, the following site restrictions must be met if Class B sludge is land applied:

- i. Food crops with harvested parts that touch the sewage sludge/soil mixture and are totally above the land surface shall not be harvested for 14 months after application of sewage sludge.
- ii. Food crops with harvested parts below the surface of the land shall not be harvested for 20 months after application of sewage sludge when the sewage sludge remains on the land surface for 4 months or longer prior to incorporation into the soil.
- iii. Food crops with harvested parts below the surface of the land shall not be harvested for 38 months after application of sewage sludge when the sewage sludge remains on the land surface for less than 4 months prior to incorporation into the soil.
- iv. Food crops, feed crops, and fiber crops shall not be harvested for 30 days after application of sewage sludge.
- v. Animals shall not be allowed to graze on the land for 30 days after application of sewage sludge.
- vi. Turf grown on land where sewage sludge is applied shall not be harvested for 1 year after application of the sewage sludge when the harvested turf is placed on either land with a high potential for public exposure or a lawn.

- vii. Public access to land with a high potential for public exposure shall be restricted for 1 year after application of sewage sludge.
- viii. Public access to land with a low potential for public exposure shall be restricted for 30 days after application of sewage sludge.
- ix. Land application of sludge shall be in accordance with the buffer zone requirements found in 30 TAC § 312.44.

#### 4. Vector Attraction Reduction Requirements

All bulk sewage sludge that is applied to agricultural land, forest, a public contact site, or a reclamation site shall be treated by one of the following Alternatives 1 through 10 for vector attraction reduction.

- Alternative 1 - The mass of volatile solids in the sewage sludge shall be reduced by a minimum of 38%.
- Alternative 2 - If Alternative 1 cannot be met for an anaerobically digested sludge, demonstration can be made by digesting a portion of the previously digested sludge anaerobically in the laboratory in a bench-scale unit for 40 additional days at a temperature between 30° and 37° Celsius. Volatile solids must be reduced by less than 17% to demonstrate compliance.
- Alternative 3 - If Alternative 1 cannot be met for an aerobically digested sludge, demonstration can be made by digesting a portion of the previously digested sludge with percent solids of two percent or less aerobically in the laboratory in a bench-scale unit for 30 additional days at 20° Celsius. Volatile solids must be reduced by less than 15% to demonstrate compliance.
- Alternative 4 - The specific oxygen uptake rate (SOUR) for sewage sludge treated in an aerobic process shall be equal to or less than 1.5 milligrams of oxygen per hour per gram of total solids (dry weight basis) at a temperature of 20° Celsius.
- Alternative 5 - Sewage sludge shall be treated in an aerobic process for 14 days or longer. During that time, the temperature of the sewage sludge shall be higher than 40° Celsius and the average temperature of the sewage sludge shall be higher than 45° Celsius.
- Alternative 6 - The pH of sewage sludge shall be raised to 12 or higher by alkali addition and, without the addition of more alkali shall remain at 12 or higher for two hours and then remain at a pH of 11.5 or higher for an additional 22 hours at the time the sewage sludge is prepared for sale or given away in a bag or other container.
- Alternative 7 - The percent solids of sewage sludge that does not contain unstabilized solids generated in a primary wastewater treatment process shall be equal to or greater than 75% based on the moisture content and total solids prior to mixing with other materials. Unstabilized solids are

defined as organic materials in sewage sludge that have not been treated in either an aerobic or anaerobic treatment process.

Alternative 8 - The percent solids of sewage sludge that contains unstabilized solids generated in a primary wastewater treatment process shall be equal to or greater than 90% based on the moisture content and total solids prior to mixing with other materials at the time the sludge is used. Unstabilized solids are defined as organic materials in sewage sludge that have not been treated in either an aerobic or anaerobic treatment process.

- Alternative 9 -
- i. Sewage sludge shall be injected below the surface of the land.
  - ii. No significant amount of the sewage sludge shall be present on the land surface within one hour after the sewage sludge is injected.
  - iii. When sewage sludge that is injected below the surface of the land is Class A or Class AB with respect to pathogens, the sewage sludge shall be injected below the land surface within eight hours after being discharged from the pathogen treatment process.

- Alternative 10-
- i. Sewage sludge applied to the land surface or placed on a surface disposal site shall be incorporated into the soil within six hours after application to or placement on the land.
  - ii. When sewage sludge that is incorporated into the soil is Class A or Class AB with respect to pathogens, the sewage sludge shall be applied to or placed on the land within eight hours after being discharged from the pathogen treatment process.

**C. Monitoring Requirements**

- Toxicity Characteristic Leaching Procedure (TCLP) Test - once during the term of this permit
- PCBs - once during the term of this permit

All metal constituents and fecal coliform or *Salmonella* sp. bacteria shall be monitored at the appropriate frequency shown below, pursuant to 30 TAC § 312.46(a)(1):

<u>Amount of sewage sludge (*) metric tons per 365-day period</u>	<u>Monitoring Frequency</u>
0 to less than 290	Once/Year
290 to less than 1,500	Once/Quarter
1,500 to less than 15,000	Once/Two Months
15,000 or greater	Once/Month

(\*) *The amount of bulk sewage sludge applied to the land (dry wt. basis).*

Representative samples of sewage sludge shall be collected and analyzed in accordance with

the methods referenced in 30 TAC § 312.7

Identify each of the analytic methods used by the facility to analyze enteric viruses, fecal coliforms, helminth ova, *Salmonella sp.*, and other regulated parameters.

Identify in the following categories (as applicable) the sewage sludge treatment process or processes at the facility: preliminary operations (*e.g.*, sludge grinding and degritting), thickening (concentration), stabilization, anaerobic digestion, aerobic digestion, composting, conditioning, disinfection (*e.g.*, beta ray irradiation, gamma ray irradiation, pasteurization), dewatering (*e.g.*, centrifugation, sludge drying beds, sludge lagoons), heat drying, thermal reduction, and methane or biogas capture and recovery.

Identify the nature of material generated by the facility (such as a biosolid for beneficial use or land-farming, or sewage sludge for disposal at a monofill) and whether the material is ultimately conveyed off-site in bulk or in bags.

**SECTION II. REQUIREMENTS SPECIFIC TO BULK SEWAGE SLUDGE FOR APPLICATION TO THE LAND MEETING CLASS A, CLASS AB or B PATHOGEN REDUCTION AND THE CUMULATIVE LOADING RATES IN TABLE 2, OR CLASS B PATHOGEN REDUCTION AND THE POLLUTANT CONCENTRATIONS IN TABLE 3**

For those permittees meeting Class A, Class AB or B pathogen reduction requirements and that meet the cumulative loading rates in Table 2 below, or the Class B pathogen reduction requirements and contain concentrations of pollutants below listed in Table 3, the following conditions apply:

**A. Pollutant Limits**

Table 2

<u>Pollutant</u>	<u>Cumulative Pollutant Loading Rate (pounds per acre)*</u>
Arsenic	36
Cadmium	35
Chromium	2677
Copper	1339
Lead	268
Mercury	15
Molybdenum	Report Only
Nickel	375
Selenium	89
Zinc	2500

Table 3

<u>Pollutant</u>	<u>Monthly Average Concentration (milligrams per kilogram)*</u>
Arsenic	41
Cadmium	39
Chromium	1200
Copper	1500
Lead	300
Mercury	17
Molybdenum	Report Only
Nickel	420
Selenium	36
Zinc	2800

\*Dry weight basis

**B. Pathogen Control**

All bulk sewage sludge that is applied to agricultural land, forest, a public contact site, a reclamation site, shall be treated by either Class A, Class AB or Class B pathogen reduction requirements as defined above in Section I.B.3.

**C. Management Practices**

1. Bulk sewage sludge shall not be applied to agricultural land, forest, a public contact site, or a reclamation site that is flooded, frozen, or snow-covered so that the bulk sewage sludge enters a wetland or other waters in the State.
2. Bulk sewage sludge not meeting Class A requirements shall be land applied in a manner which complies with Applicability in accordance with 30 TAC §312.41 and the Management Requirements in accordance with 30 TAC § 312.44.
3. Bulk sewage sludge shall be applied at or below the agronomic rate of the cover crop.
4. An information sheet shall be provided to the person who receives bulk sewage sludge sold or given away. The information sheet shall contain the following information:
  - a. The name and address of the person who prepared the sewage sludge that is sold or given away in a bag or other container for application to the land.
  - b. A statement that application of the sewage sludge to the land is prohibited except in accordance with the instruction on the label or information sheet.
  - c. The annual whole sludge application rate for the sewage sludge application rate for the sewage sludge that does not cause any of the cumulative pollutant loading rates in Table 2 above to be exceeded, unless the pollutant concentrations in Table 3 found in Section II above are met.

**D. Notification Requirements**

1. If bulk sewage sludge is applied to land in a State other than Texas, written notice shall be provided prior to the initial land application to the permitting authority for the State in which the bulk sewage sludge is proposed to be applied. The notice shall include:
  - a. The location, by street address, and specific latitude and longitude, of each land application site.
  - b. The approximate time period bulk sewage sludge will be applied to the site.
  - c. The name, address, telephone number, and National Pollutant Discharge Elimination System permit number (if appropriate) for the person who will apply the bulk sewage sludge.
2. The permittee shall give 180 days prior notice to the Executive Director in care of the Wastewater Permitting Section (MC 148) of the Water Quality Division of any change planned in the sewage sludge disposal practice.

**E. Record keeping Requirements**

The sludge documents will be retained at the facility site and/or shall be readily available for review by a TCEQ representative. The person who prepares bulk sewage sludge or a sewage sludge material shall develop the following information and shall retain the information at



the facility site and/or shall be readily available for review by a TCEQ representative for a period of five years. If the permittee supplies the sludge to another person who land applies the sludge, the permittee shall notify the land applier of the requirements for record keeping found in 30 TAC § 312.47 for persons who land apply.

1. The concentration (mg/kg) in the sludge of each pollutant listed in Table 3 above and the applicable pollutant concentration criteria (mg/kg), or the applicable cumulative pollutant loading rate and the applicable cumulative pollutant loading rate limit (lbs/ac) listed in Table 2 above.
2. A description of how the pathogen reduction requirements are met (including site restrictions for Class AB and Class B sludge, if applicable).
3. A description of how the vector attraction reduction requirements are met.
4. A description of how the management practices listed above in Section II.C are being met.
5. The following certification statement:

“I certify, under penalty of law, that the applicable pathogen requirements in 30 TAC § 312.82(a) or (b) and the vector attraction reduction requirements in 30 TAC § 312.83(b) have been met for each site on which bulk sewage sludge is applied. This determination has been made under my direction and supervision in accordance with the system designed to ensure that qualified personnel properly gather and evaluate the information used to determine that the management practices have been met. I am aware that there are significant penalties for false certification including fine and imprisonment.”

6. The recommended agronomic loading rate from the references listed in Section II.C.3. above, as well as the actual agronomic loading rate shall be retained. The person who applies bulk sewage sludge or a sewage sludge material shall develop the following information and shall retain the information at the facility site and/or shall be readily available for review by a TCEQ representative indefinitely. If the permittee supplies the sludge to another person who land applies the sludge, the permittee shall notify the land applier of the requirements for record keeping found in 30 TAC § 312.47 for persons who land apply:
  - a. A certification statement that all applicable requirements (specifically listed) have been met, and that the permittee understands that there are significant penalties for false certification including fine and imprisonment. See 30 TAC § 312.47(a)(4)(A)(ii) or 30 TAC § 312.47(a)(5)(A)(ii), as applicable, and to the permittee’s specific sludge treatment activities.
  - b. The location, by street address, and specific latitude and longitude, of each site on which sludge is applied.
  - c. The number of acres in each site on which bulk sludge is applied.
  - d. The date and time sludge is applied to each site.

- e. The cumulative amount of each pollutant in pounds/acre listed in Table 2 applied to each site.
- f. The total amount of sludge applied to each site in dry tons.

The above records shall be maintained on-site on a monthly basis and shall be made available to the Texas Commission on Environmental Quality upon request.

## F. Reporting Requirements

The permittee shall report annually to the TCEQ Regional Office (MC Region 12) and Compliance Monitoring Team (MC 224) of the Enforcement Division, by September 30<sup>th</sup> of each year the following information. Effective September 1, 2020, the permittee must submit this annual report using the online electronic reporting system available through the TCEQ website unless the permittee requests and obtains an electronic reporting waiver.

1. Identify in the following categories (as applicable) the sewage sludge treatment process or processes at the facility: preliminary operations (*e.g.*, sludge grinding and degritting), thickening (concentration), stabilization, anaerobic digestion, aerobic digestion, composting, conditioning, disinfection (*e.g.*, beta ray irradiation, gamma ray irradiation, pasteurization), dewatering (*e.g.*, centrifugation, sludge drying beds, sludge lagoons), heat drying, thermal reduction, and methane or biogas capture and recovery.
2. Identify the nature of material generated by the facility (such as a biosolid for beneficial use or land-farming, or sewage sludge for disposal at a monofill) and whether the material is ultimately conveyed off-site in bulk or in bags.
3. Results of tests performed for pollutants found in either Table 2 or 3 as appropriate for the permittee's land application practices.
4. The frequency of monitoring listed in Section I.C. that applies to the permittee.
5. Toxicity Characteristic Leaching Procedure (TCLP) results.
6. PCB concentration in sludge in mg/kg.
7. Identity of hauler(s) and TCEQ transporter number.
8. Date(s) of transport.
9. Texas Commission on Environmental Quality registration number, if applicable.
10. Amount of sludge disposal dry weight (lbs/acre) at each disposal site.
11. The concentration (mg/kg) in the sludge of each pollutant listed in Table 1 (defined as a monthly average) as well as the applicable pollutant concentration criteria (mg/kg) listed in Table 3 above, or the applicable pollutant loading rate limit (lbs/acre) listed in Table 2 above if it exceeds 90% of the limit.
12. Level of pathogen reduction achieved (Class A, Class AB or Class B).
13. Alternative used as listed in Section I.B.3.(a. or b.). Alternatives describe how the pathogen reduction requirements are met. If Class B sludge, include information on how site restrictions were met.

14. Identify each of the analytic methods used by the facility to analyze enteric viruses, fecal coliforms, helminth ova, *Salmonella sp.*, and other regulated parameters.
15. Vector attraction reduction alternative used as listed in Section I.B.4.
16. Amount of sludge transported in dry tons/year.
17. The certification statement listed in either 30 TAC § 312.47(a)(4)(A)(ii) or 30 TAC § 312.47(a)(5)(A)(ii) as applicable to the permittee's sludge treatment activities, shall be attached to the annual reporting form.
18. When the amount of any pollutant applied to the land exceeds 90% of the cumulative pollutant loading rate for that pollutant, as described in Table 2, the permittee shall report the following information as an attachment to the annual reporting form.
  - a. The location, by street address, and specific latitude and longitude.
  - b. The number of acres in each site on which bulk sewage sludge is applied.
  - c. The date and time bulk sewage sludge is applied to each site.
  - d. The cumulative amount of each pollutant (i.e., pounds/acre) listed in Table 2 in the bulk sewage sludge applied to each site.
  - e. The amount of sewage sludge (i.e., dry tons) applied to each site.

The above records shall be maintained on a monthly basis and shall be made available to the Texas Commission on Environmental Quality upon request.

**SECTION III. REQUIREMENTS APPLYING TO ALL SEWAGE SLUDGE  
DISPOSED IN A MUNICIPAL SOLID WASTE LANDFILL**

- A. The permittee shall handle and dispose of sewage sludge in accordance with 30 TAC § 330 and all other applicable state and federal regulations to protect public health and the environment from any reasonably anticipated adverse effects due to any toxic pollutants that may be present. The permittee shall ensure that the sewage sludge meets the requirements in 30 TAC § 330 concerning the quality of the sludge disposed in a municipal solid waste landfill.
- B. If the permittee generates sewage sludge and supplies that sewage sludge to the owner or operator of a municipal solid waste landfill (MSWLF) for disposal, the permittee shall provide to the owner or operator of the MSWLF appropriate information needed to be in compliance with the provisions of this permit.
- C. The permittee shall give 180 days prior notice to the Executive Director in care of the Wastewater Permitting Section (MC 148) of the Water Quality Division of any change planned in the sewage sludge disposal practice.
- D. Sewage sludge shall be tested once during the term of this permit in accordance with the method specified in both 40 CFR Part 261, Appendix II and 40 CFR Part 268, Appendix I (Toxicity Characteristic Leaching Procedure) or other method, which receives the prior approval of the TCEQ for contaminants listed in Table 1 of 40 CFR § 261.24. Sewage sludge failing this test shall be managed according to RCRA standards for generators of hazardous waste, and the waste's disposition must be in accordance with all applicable requirements for hazardous waste processing, storage, or disposal.

Following failure of any TCLP test, the management or disposal of sewage sludge at a facility other than an authorized hazardous waste processing, storage, or disposal facility shall be prohibited until such time as the permittee can demonstrate the sewage sludge no longer exhibits the hazardous waste toxicity characteristics (as demonstrated by the results of the TCLP tests). A written report shall be provided to both the TCEQ Registration and Reporting Section (MC 129) of the Permitting and Remediation Support Division and the Regional Director (MC Region 12) of the appropriate TCEQ field office within 7 days after failing the TCLP Test.

The report shall contain test results, certification that unauthorized waste management has stopped and a summary of alternative disposal plans that comply with RCRA standards for the management of hazardous waste. The report shall be addressed to: Director, Registration, Review, and Reporting Division (MC 129), Texas Commission on Environmental Quality, P. O. Box 13087, Austin, Texas 78711-3087. In addition, the permittee shall prepare an annual report on the results of all sludge toxicity testing. This annual report shall be submitted to the TCEQ Regional Office (MC Region 12) and the Compliance Monitoring Team (MC 224) of the Enforcement Division by September 30 of each year.

- E. Sewage sludge shall be tested as needed, in accordance with the requirements of 30 TAC Chapter 330.
- F. Record keeping Requirements

The permittee shall develop the following information and shall retain the information for five years.

1. The description (including procedures followed and the results) of all liquid Paint Filter Tests performed.
2. The description (including procedures followed and results) of all TCLP tests performed.

The above records shall be maintained on-site on a monthly basis and shall be made available to the Texas Commission on Environmental Quality upon request.

#### G. Reporting Requirements

The permittee shall report annually to the TCEQ Regional Office (MC Region 12) and Compliance Monitoring Team (MC 224) of the Enforcement Division by September 30<sup>th</sup> of each year the following information. Effective September 1, 2020, the permittee must submit this annual report using the online electronic reporting system available through the TCEQ website unless the permittee requests and obtains an electronic reporting waiver.

1. Identify in the following categories (as applicable) the sewage sludge treatment process or processes at the facility: preliminary operations (*e.g.*, sludge grinding and degritting), thickening (concentration), stabilization, anaerobic digestion, aerobic digestion, composting, conditioning, disinfection (*e.g.*, beta ray irradiation, gamma ray irradiation, pasteurization), dewatering (*e.g.*, centrifugation, sludge drying beds, sludge lagoons), heat drying, thermal reduction, and methane or biogas capture and recovery.
2. Toxicity Characteristic Leaching Procedure (TCLP) results.
3. Annual sludge production in dry tons/year.
4. Amount of sludge disposed in a municipal solid waste landfill in dry tons/year.
5. Amount of sludge transported interstate in dry tons/year.
6. A certification that the sewage sludge meets the requirements of 30 TAC § 330 concerning the quality of the sludge disposed in a municipal solid waste landfill.
7. Identity of hauler(s) and transporter registration number.
8. Owner of disposal site(s).
9. Location of disposal site(s).
10. Date(s) of disposal.

The above records shall be maintained on-site on a monthly basis and shall be made available to the Texas Commission on Environmental Quality upon request.

**SECTION IV. REQUIREMENTS APPLYING TO SLUDGE TRANSPORTED TO ANOTHER FACILITY FOR FURTHER PROCESSING**

These provisions apply to sludge that is transported to another wastewater treatment facility or facility that further processes sludge. These provisions are intended to allow transport of sludge to facilities that have been authorized to accept sludge. These provisions do not limit the ability of the receiving facility to determine whether to accept the sludge, nor do they limit the ability of the receiving facility to request additional testing or documentation.

**A. General Requirements**

1. The permittee shall handle and dispose of sewage sludge in accordance with 30 TAC Chapter 312 and all other applicable state and federal regulations in a manner that protects public health and the environment from any reasonably anticipated adverse effects due to any toxic pollutants that may be present in the sludge.
2. Sludge may only be transported using a registered transporter or using an approved pipeline.

**B. Record Keeping Requirements**

1. For sludge transported by an approved pipeline, the permittee must maintain records of the following:
  - a. the amount of sludge transported;
  - b. the date of transport;
  - c. the name and TCEQ permit number of the receiving facility or facilities;
  - d. the location of the receiving facility or facilities;
  - e. the name and TCEQ permit number of the facility that generated the waste; and
  - f. copy of the written agreement between the permittee and the receiving facility to accept sludge.
2. For sludge transported by a registered transporter, the permittee must maintain records of the completed trip tickets in accordance with 30 TAC § 312.145(a)(1)-(7) and amount of sludge transported.
3. The above records shall be maintained on-site on a monthly basis and shall be made available to the TCEQ upon request. These records shall be retained for at least five years.

### C. Reporting Requirements

The permittee shall report the following information annually to the TCEQ Regional Office (MC Region 12) and Compliance Monitoring Team (MC 224) of the Enforcement Division, by September 30<sup>th</sup> of each year. Effective September 1, 2020, the permittee must submit this annual report using the online electronic reporting system available through the TCEQ website unless the permittee requests and obtains an electronic reporting waiver.

1. Identify in the following categories (as applicable) the sewage sludge treatment process or processes at the facility: preliminary operations (*e.g.*, sludge grinding and degritting), thickening (concentration), stabilization, anaerobic digestion, aerobic digestion, composting, conditioning, disinfection (*e.g.*, beta ray irradiation, gamma ray irradiation, pasteurization), dewatering (*e.g.*, centrifugation, sludge drying beds, sludge lagoons), heat drying, thermal reduction, and methane or biogas capture and recovery.
2. the annual sludge production;
3. the amount of sludge transported;
4. the owner of each receiving facility;
5. the location of each receiving facility; and
6. the date(s) of disposal at each receiving facility.

TCEQ Revision 01/2016

**OTHER REQUIREMENTS**

1. The permittee shall employ or contract with one or more licensed wastewater treatment facility operators or wastewater system operations companies holding a valid license or registration according to the requirements of 30 TAC Chapter 30, Occupational Licenses and Registrations, and in particular 30 TAC Chapter 30, Subchapter J, Wastewater Operators and Operations Companies.

This Category C facility must be operated by a chief operator or an operator holding a Category C license or higher. The facility must be operated a minimum of five days per week by the licensed chief operator or an operator holding the required level of license or higher. The licensed chief operator or operator holding the required level of license or higher must be available by telephone or pager seven days per week. Where shift operation of the wastewater treatment facility is necessary, each shift which does not have the on-site supervision of the licensed chief operator must be supervised by an operator in charge who is licensed not less than one level below the category for the facility.

2. The facility is not located in the Coastal Management Program boundary.
3. The permittee shall provide nuisance odor prevention for the facility in accordance with 30 TAC Section 309.13(e)(2). The permittee shall implement the nuisance odor prevention plan as proposed in the permittee's engineering report dated December 11, 2006 and its amendments (on file), which was prepared and sealed by a licensed professional engineer, in support of the nuisance odor prevention request according to the requirements of 30 TAC Section 309.13(e)(2). The vegetative barrier, consisting of bamboos, *Bambusa textillus gracillus*, shall be well established at the south side and the west side of the facility within one year from permit issuance. If odor complaints are noted by or received by the TCEQ, the permittee may be required to revise the nuisance odor prevention plan and implement stricter odor control measures to address the complaints. In addition, by ownership of the required buffer zone area, the permittee shall comply with the requirements of 30 TAC Section 309.13(e) for the east and the north sides of the facility. The permittee shall comply with the requirements of 30 TAC Section 309.13(a) through (d). (See Attachment A.)
4. The permittee shall provide facilities for the protection of its wastewater treatment facility from a 100-year flood.
5. A certified operator shall inspect the facility daily and maintain at the plant site a record of these inspections. These records shall be available at the plant site for inspection by authorized representatives of the commission for at least three years.
6. A summary submittal letter (log # 1007/129) was submitted on October 17, 2007 requesting approval for a 0.25 million gallon per day wastewater treatment plant. The request was approved by TCEQ on January 14, 2008.
7. In accordance with 30 TAC § 319.9, a permittee that has at least twelve months of uninterrupted compliance with its bacteria limit may notify the commission in writing of its compliance and request a less frequent measurement schedule. To request a less frequent schedule, the permittee shall submit a written request to the TCEQ Wastewater Permitting Section (MC 148) for each phase that includes a different monitoring frequency. The request must contain all of the reported bacteria values (Daily Avg. and Daily Max/Single Grab) for the twelve consecutive months immediately prior to the request. If the Executive Director finds that a less frequent measurement schedule is protective of human health and the environment, the permittee may be given a less frequent measurement schedule. For this



permit, 1/month may be reduced to 1/quarter in the Interim and Final phase. **A violation of any bacteria limit by a facility that has been granted a less frequent measurement schedule will require the permittee to return to the standard frequency schedule and submit written notice to the TCEQ Wastewater Permitting Section (MC 148).** The permittee may not apply for another reduction in measurement frequency for at least 24 months from the date of the last violation. The Executive Director may establish a more frequent measurement schedule if necessary to protect human health or the environment.

8. Prior to construction of the Final phase treatment facilities, the permittee shall submit to the TCEQ Wastewater Permitting Section (MC 148) a summary transmittal letter in accordance with the requirements in 30 TAC § 217.6(d). If requested by the Wastewater Permitting Section, the permittee shall submit plans, specifications, and a final engineering design report which comply with 30 TAC Chapter 217, Design Criteria for Domestic Wastewater Systems. The permittee shall clearly show how the treatment system will meet the effluent limitations required on Page 2a of this permit. A copy of the summary transmittal letter shall be available at the plant site for inspection by authorized representatives of the TCEQ.
9. The permittee shall notify the TCEQ Regional Office (MC Region 12) and the Applications Review and Processing Team (MC 148) of the Water Quality Division, as well as the Harris County Public Health and Environmental Services Pollution Control Division, in writing at least forty-five (45) days prior to the completion of the 0.50 million gallons per day (MGD) Final phase on Notification of Completion Form 2007.

ATTACHMENT A

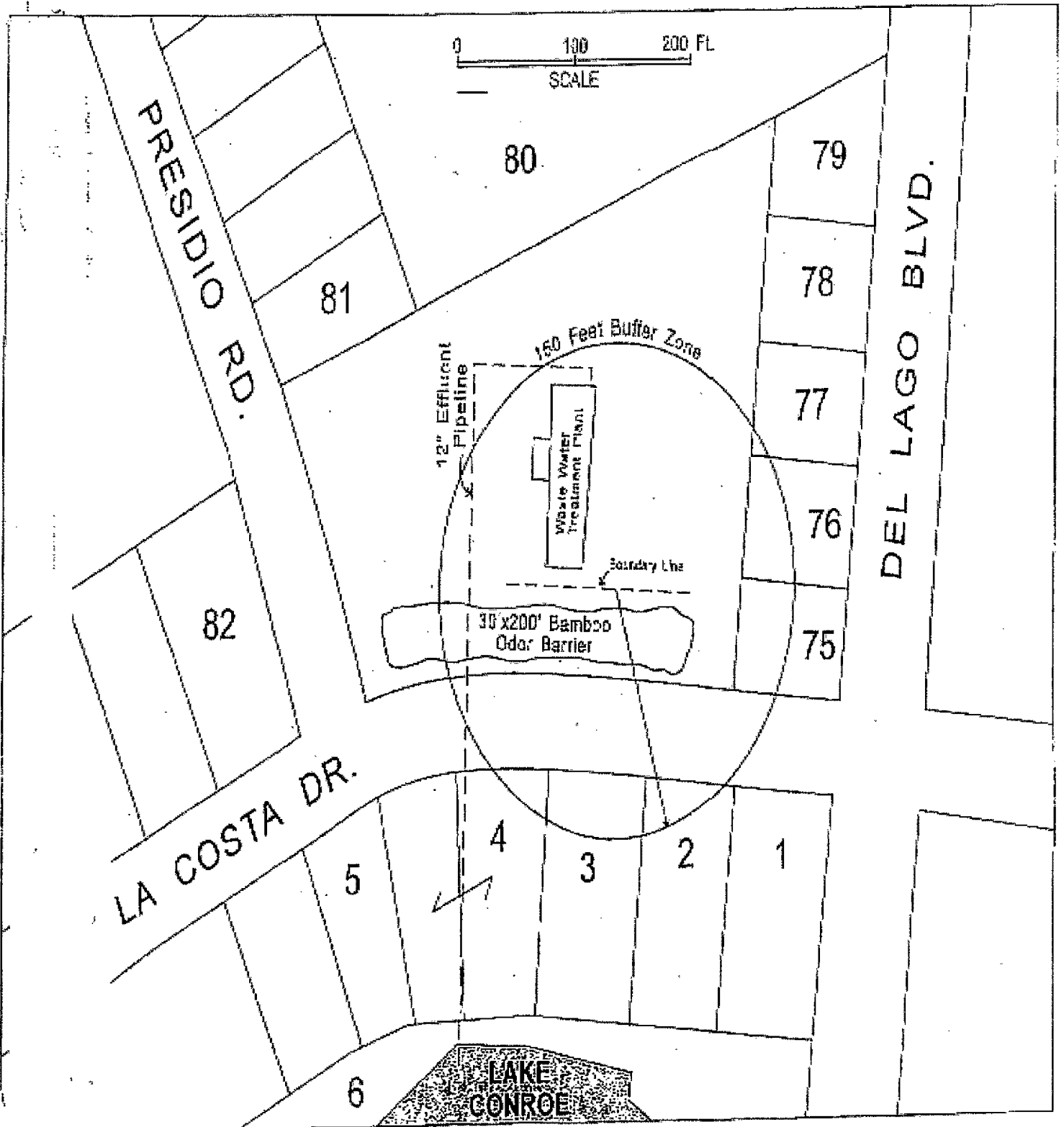

# **Attachment 'P'**

***Part D: Question 12***

***Confidential***

Future Planned Capital Improvements

# CONFIDENTIAL

**DOCKET NO.:** 52797

**STYLE:** Application of Conroe Resort Utilities, LLC, and Undine Texas Environmental, LLC for Sale, Transfer, or Merger of Facilities and Certificate Rights in Montgomery County, Texas

**SUBMITTING PARTY:** Undine Texas Environmental, LLC

**BRIEF DESCRIPTION OF CONTENTS:** Attachment P – Future Planned Capital Improvements

**BATE STAMP OR SEQUENTIAL PAGE NUMBER RANGE:** 185 to 188

**ENVELOPE #:** 1 OF 1

**ADDITIONAL INFORMATION REQUIRED BY PROTECTIVE ORDER:**

---

**DATE SUBMITTED TO COMMISSION:** August 30, 2022