



Filing Receipt

Received - 2021-11-09 08:13:45 AM
Control Number - 52653
ItemNumber - 7

COATS | ROSE

A PROFESSIONAL CORPORATION

NATALIE SCOTT
DIRECTOR

NSCOTT@COATSROSE.COM
DIRECT: (512) 541-3846
FAX: (512) 469-9408

November 09, 2021

Public Utility Commission of Texas
P.O Box 13326
Austin, Texas 78711-3326

Via Electronic Filing

Re: PUC Docket No. 52653; *Petition by Eland Energy, Inc. for Expedited Release from Water CCN No. 10150 Held by Marilee Special Utility District in Collin County*

Dear Sir or Madam:

Petitioner files the attached updated high-resolution and/or full-sized maps, legal description, as well as the corresponding digital data (polygon shapefiles) to cure its mapping deficiencies in the referenced docket, as follows:

1. General Location Map;
2. Detailed Map; and
3. Legal Description.

Please do not hesitate to contact me should you need anything further.

Very truly yours,



Natalie B. Scott

Cc (w/encl.):

Attorneys for Marilee Special Utility District:

John J. Carlton - Email: john@carltonlawaustin.com

Grayson E. McDaniel - Email: grayson@carltonlawaustin.com

Attorney for Commission Staff:

Kourtnee Jinks – Email: kourtnee.jinks@puc.texas.gov

TERRACE 2, 2700 VIA FORTUNA, SUITE 350, AUSTIN, TEXAS 78746
PHONE: (512) 469-7987 FAX: (512) 469-9408
coatsrose.com

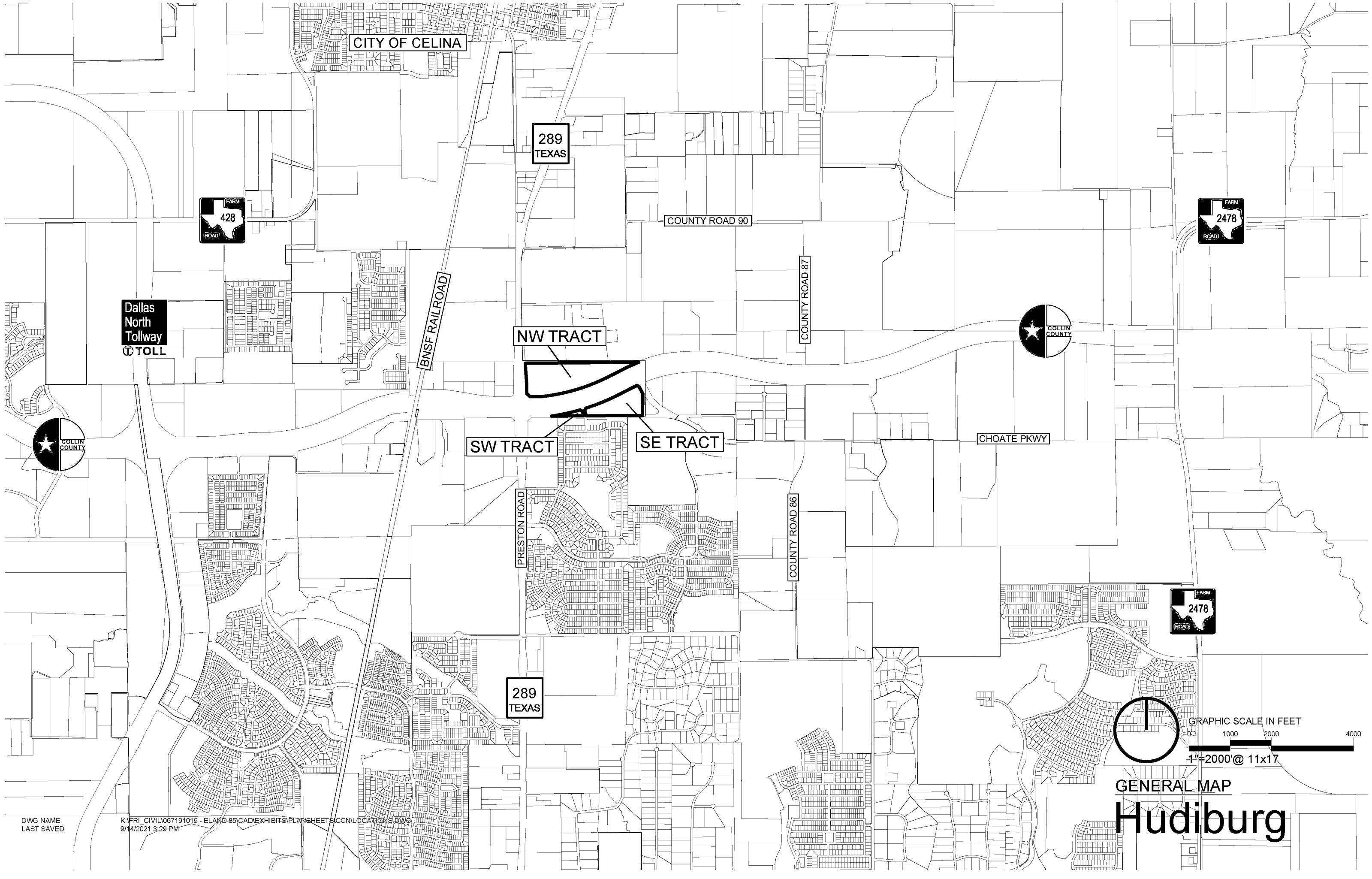

DWG NAME
LAST SAVED

K:\FRI_CIVIL\067191019 - ELAND 85\CAD\EXHIBITS\PLANS\SHEETS\CCN\LOCATIONS.DWG
9/14/2021 3:29 PM

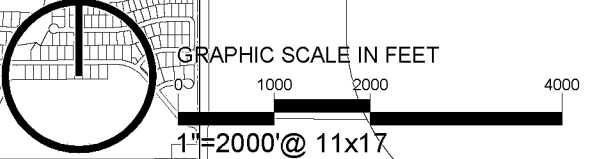

GENERAL MAP
Hudiburg

289
TEXAS

PRESTON ROAD

NW TRACT
±33.23 Acres
CALLED 85.89 ACRES
ELAND ENERGY, INC.
INST. NO. 20141002001081280
O.P.R.C.C.T.

T. M. ROWLAND SURVEY
ABSTRACT NO. 749

FEMA ZONE A
100-YR. FLOOD PLAIN
FIRM PANEL 48085C0120J
EFF. 6/2/2009

PARCEL 4
CITY OF CELINA
INST. NO. 20200730001212620
O.P.R.C.C.T.

COLLIN COUNTY
OUTER LOOP

PARCEL 23
COUNTY OF COLLIN
INST. NO. 202004290006182200
O.P.R.C.C.T.

APPROX. LOCATION
OF ABSTRACT LINE

SW TRACT
±1.24 Acres

SE TRACT
±14.60 Acres
CALLED 85.89 ACRES
ELAND ENERGY, INC.
INST. NO. 20141002001081280
O.P.R.C.C.T.

CHOATE PKWY

COUNTY ROAD 88

PARCEL 23A
CITY OF CELINA
INST. NO. 20200730001212630
O.P.R.C.C.T.

SHELBY GLASS SURVEY
ABSTRACT NO. 346

CLYDESDALE WAY

DOE BRANCH
TRIBUTARY G

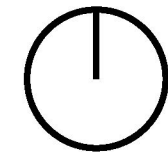

GRAPHIC SCALE IN FEET
0 100 200 400
1"=200' @ 11x17

DETAILED MAP
Hudiburg

BEING a tract of land situated in the T. M. Rowland Survey, Abstract No. 749, City of Celina, Collin County, Texas, and being a portion of a called 85.89-acre tract of land, described in a Warranty Deed to Eland Energy, Inc., as recorded in Instrument No. 20141002001801280 of the Official Public Records of Collin County, Texas, and being more particularly described by metes and bounds as follows:

BEGINNING at a 5/8-inch iron rod with a red plastic cap, stamped "LAMB STAR" found on the north line of said 85.89-acre tract for the westernmost, northeast corner of a called Parcel 23 as described in a deed to County of Collin, as recorded in Instrument No. 202004290006182200 of the Official Public Records of Collin County, Texas, same also being on the easterly right of way line of Preston Road (S. H. 289);

THENCE North 89°32'08" East, departing said Preston Road (S. H. 289) and along the north line of said 85.89-acre tract, a distance of 2758.88 feet to a 5/8-inch iron rod with a red plastic cap, stamped "LAMB STAR" found for the easternmost, northwest corner of said Parcel 23, same being on the northerly right of way line of Outer Loop, a 500' wide right of way, same also being at the beginning of a non-tangent curve to the left having a central angle of 5°34'31", a radius of 4044.50 feet, a chord bearing and distance of South 66°02'56" West, 393.39 feet;

THENCE in a southwesterly direction, departing the north line of said 85.89-acre tract, along the northerly line of said Parcel 23 and said Outer Loop, with said curve to the left, an arc distance of 393.55 feet to a point for corner;

THENCE South 63°15'41" West, continuing along the northerly line of said Parcel 23 and said Outer Loop, a distance of 434.52 feet to a point at the beginning of a tangent curve to the right having a central angle of 20°22'21", a radius of 4720.50 feet, a chord bearing and distance of South 73°26'51" West, 1669.62 feet;

THENCE in a southwesterly direction, continuing along the northerly line of said Parcel 23 and said Outer Loop, with said curve to the right, an arc distance of 1678.44 feet to a 5/8-inch iron rod with a red plastic cap, stamped "LAMB STAR" found for corner;

THENCE South 89°21'29" West, continuing along the northerly line of said Parcel 23 and said Outer Loop, a distance of 294.75 feet to a 5/8-inch iron rod with a red plastic cap, stamped "LAMB STAR" found for corner;

THENCE North 45°58'13" West, continuing along the northerly line of said Parcel 23 and said Outer Loop, a distance of 106.67 feet to a point for corner at the intersection of the northerly line of said Outer Loop with the easterly line of aforesaid Preston Road (S. H. 289);

THENCE North 1°17'55" West, along the westernmost, easterly line of said Parcel 23 and along the easterly line of said Preston Road (S. H. 289), a distance of 267.12 feet to a 5/8-inch iron rod with a red plastic cap, stamped "LAMB STAR" found for corner;

THENCE North 4°02'57" West, continuing along the westernmost, easterly line of said Parcel 23 and along the easterly line of said Preston Road (S. H. 289), a distance of 471.80 feet to the **POINT OF BEGINNING** and containing 33.229 acres of land, more or less.

Michael B. Marx

Michael B. Marx
Registered Professional Land Surveyor No. 5181
Kimley-Horn and Associates, Inc.
6160 Warren Pkwy., Suite 210
Frisco, Texas 75034
Ph. 972-335-3580
michael.marx@kimley-horn.com



BEING a tract of land situated in the T. M. Rowland Survey, Abstract No. 749, City of Celina, Collin County, Texas, and being a portion of a called 85.89-acre tract of land, described in a Warranty Deed to Eland Energy, Inc., as recorded in Instrument No. 20141002001801280 of the Official Public Records of Collin County, Texas, and being more particularly described by metes and bounds as follows:

BEGINNING at the southeast corner of said 85.89-acre tract, same being on the occupied north right of way line of County Road 88, an apparent public use roadway, no record found;

THENCE South 89°35'58" West, along the south line of said 85.89-acre tract and the northerly right of way line of County Road 88, a distance of 1364.98 feet to the southeast corner of a called Parcel 23A as described in a deed to the City of Celina for the Clydesdale Way extension, as recorded in Instrument No. 20200730001212630 of the Official Public Records of Collin County, Texas;

THENCE North 16°30'15" West, departing the south line of said 85.89-acre tract, the northerly right of way line of said County Road 88 and along the easterly line of said Parcel 23A, a distance of 136.52 feet to a 5/8-inch iron rod with a yellow plastic cap, stamped "JACOBS" found for corner;

THENCE North 28°01'55" East, continuing along the easterly line of said Parcel 23A, a distance of 64.20 feet to a 5/8-inch iron rod with a yellow plastic cap, stamped "JACOBS" found for the northeast corner of said Parcel 23A, same being on the southerly line of a called Parcel 23 as described in a deed to County of Collin, as recorded in Instrument No. 202004290006182200 of the Official Public Records of Collin County, Texas, same being the southerly line of the Outer Loop, a 500' wide right of way, and being at the beginning of a non-tangent curve to the left having a central angle of 9°01'37", a radius of 5220.50 feet, a chord bearing and distance of North 67°46'29" East, 821.65 feet;

THENCE in a northeasterly direction, along the southerly line of said Parcel 23 and said Outer Loop, with said curve to the left, an arc distance of 822.50 feet to a 1/2-inch iron rod found for corner;

THENCE North 63°15'41" East, continuing along the southerly line of said Parcel 23 and said Outer Loop, a distance of 434.52 feet to a 5/8-inch iron rod with a red plastic cap, stamped "LAMB STAR" found at the beginning of a tangent curve to the right having a central angle of 1°29'11", a radius of 3544.50 feet, a chord bearing and distance of North 64°00'16" East, 91.94 feet;

THENCE in a northeasterly direction, continuing along the southerly line of said Parcel 23 and said Outer Loop, with said curve to the right, an arc distance of 91.94 feet to a 1/2-inch iron rod with a yellow plastic cap, stamped "HALFF ASSOC" found for the northwest corner of a called Parcel 4 as described in a deed to the City of Celina, as recorded in Instrument No. 20200730001212620 of the Official Public Records of Collin County, Texas;

THENCE South 71°45'47" East, departing the southerly line of said Parcel 23 and said Outer Loop, along the westerly line of said Parcel 4, a distance of 57.34 feet to a 1/2-inch iron rod with a yellow plastic cap, stamped "HALFF ASSOC" found for corner;

THENCE South 28°34'23" East, continuing along the westerly line of said Parcel 4, a distance of 202.86 feet to a 1/2-inch iron rod with a yellow plastic cap, stamped "HALFF ASSOC" found for south corner of said Parcel 4, same being on the east line of aforesaid 85.89-acre tract;

THENCE South 00°59'59" West, along the east line of said 85.89-acre tract, a distance of 528.59 feet to the **POINT OF BEGINNING** and containing 14.598 acres of land, more or less.

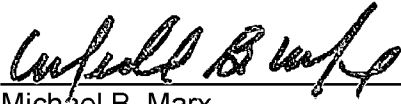

Michael B. Marx
Registered Professional Land Surveyor No. 5181
Kimley-Horn and Associates, Inc.
6160 Warren Pkwy., Suite 210
Frisco, Texas 75034
Ph. 972-335-3580
michael.marx@kimley-horn.com



BEING a tract of land situated in the T. M. Rowland Survey, Abstract No. 749, City of Celina, Collin County, Texas, and being a portion of a called 85.89-acre tract of land, described in a Warranty Deed to Eland Energy, Inc., as recorded in Instrument No. 20141002001801280 of the Official Public Records of Collin County, Texas, and being more particularly described by metes and bounds as follows:

BEGINNING at a 5/8-inch iron rod with a red plastic cap, stamped "LAMB STAR" found on the south line of said 85.89-acre tract and the occupied northerly right of way line of County Road 88, an apparent public use roadway, no record found, for the southerly, southeast corner of a called Parcel 23 as described in a deed to County of Collin, as recorded in Instrument No. 202004290006182200 of the Official Public Records of Collin County, Texas, same being the southerly line of the Outer Loop, a 500' wide right of way, and being at the beginning of non-tangent curve to the left having a central angle of 7°49'15", a radius of 5220.50 feet, a chord bearing and distance of North 77°50'42" East, 712.04 feet;

THENCE in a northeasterly direction, departing the south line of said 85.89-acre tract, along the southerly line of said Parcel 23 and said Outer Loop, with said curve to the left, an arc distance of 712.60 feet to a 5/8-inch iron rod with a yellow plastic cap, stamped "JACOBS" found for the northwest corner of a called Parcel 23A as described in a deed to the City of Celina for the Clydesdale Way extension, as recorded in Instrument No. 20200730001212630 of the Official Public Records of Collin County, Texas;

THENCE South 61°23'30" East, departing the southerly line of said Parcel 23 and said Outer Loop, along the westerly line of said Parcel 23A, a distance of 63.69 feet to a point for corner;

THENCE South 16°30'15" East, continuing along the westerly line of said Parcel 23A, a distance of 118.83 feet to a point for the southwest corner of said Parcel 23A, same being on the south line of said 85.89-acre tract and the occupied north right of way line of aforesaid County Road 88;

THENCE South 89°35'58" West, along the south line of said 85.89-acre tract and the north right of way line of said County Road 88, a distance of 785.77 feet to the **POINT OF BEGINNING** and containing 1.2372 acres or 53891 square feet of land.

Michael B. Marx
Registered Professional Land Surveyor No. 5181
Kimley-Horn and Associates, Inc.
6160 Warren Pkwy., Suite 210
Frisco, Texas 75034
Ph. 972-335-3580
michael.marx@kimley-horn.com



The following files are not convertible:

- 52653 - NW Tract.dbf
- 52653 - NW Tract.idx
- 52653 - NW Tract.prj
- 52653 - NW Tract.shp
- 52653 - NW Tract.shx
- 52653 - SE Tract.dbf
- 52653 - SE Tract.idx
- 52653 - SE Tract.prj
- 52653 - SE Tract.shp
- 52653 - SE Tract.shx
- 52653 - SW Tract.dbf
- 52653 - SW Tract.idx
- 52653 - SW Tract.prj
- 52653 - SW Tract.shp
- 52653 - SW Tract.shx
- 52653 - Hudiburg-Deed.cpg
- 52653 - Hudiburg-Deed.dbf
- 52653 - Hudiburg-Deed.idx
- 52653 - Hudiburg-Deed.prj
- 52653 - Hudiburg-Deed.shp
- 52653 - Hudiburg-Deed.shx

Please see the ZIP file for this Filing on the PUC Interchange in order to access these files.

Contact centralrecords@puc.texas.gov if you have any questions.