



Filing Receipt

Received - 2021-10-28 03:33:43 PM
Control Number - 52299
ItemNumber - 668

The Public Utility Commission of Texas
 Central Records
 1701 N. Congress P.O. Box 13326; Austin, Texas 782-3326

To Whom it May Concern:

RE: Project 52299 Confidential Filing

Affiliated/ Assumed Name(s): **Dean Water Supply Corporation**
 Dean Water Supply
 Dean WSC
 Dean Water

Per Senate Bill 3 (SB 3), 87th Texas Legislature which passed on June 8th, as an Affected Utility, Dean Water Supply Corporation provides water services for the Dean community is located southwest of Tyler, Texas..The following public water system is a member owned, board-controlled water supply corporation.

Name:		DEAN WSC WATER WELL #3
a. Address/Location of Utility		12683 Candleridge,Dr Tyler, TX 75709
b. Enter General Description of facility that qualify for Critical Load Status. (See Map 1, Appendix A)		Ground Water Well #3 GPS Lat: 32° 17.946 GPS Long: -95° 24.470
c. TDU Provider		Oncor
d. Retail Provider		Reliant
e. ESI ID		10443720002885518
-----	-----	-----
Name:		DEAN WSC WATER WELL #4
a. Address/Location of Utility		12002 Joni Dr, Tyler, TX 75709
b. Enter General Description of facility that qualify for Critical Load Status. (See Map 1, Appendix A)		Ground Water Well #4 GPS Lat: 32° 18.462 GPS Long: -95° 23.839
c. TDU Provider		Oncor
d. Retail Provider		Reliant
e. ESI ID		10443720002893578
-----	-----	-----
Name:		DEAN WATER WELL #5
a. Address/Location of Utility		14435 CR 1134, Tyler, TX 75709
b. Enter General Description of facility that qualify for Critical Load Status. (See Map 2, Appendix A)		Ground Water Well #4 GPS Lat: 32° 19.008 GPS Long: -95° 24.492
c. TDU Provider		Oncor
d. Retail Provider		Reliant
e. ESI ID		10443720009091222

For all questions or communications regarding **DEAN WATER SUPPLY CORPORATION** and/or emergency power at the above locations shall be addressed to:

Point of Contact: BILLY MCMILLAN (903) 352-9599

Alternative Point of Contact: TRACY HASTING (903) 597-2817

Dean Water Supply Corporation
14411 County Road 1134
PO Box 4695
Tyler, TX 75712

Population Served: 6,340
Total Number of Connections: 1,969
PWS ID: 21-20009

APPENDIX A
MAP OF WATER WELL FACILITY

MAP #1

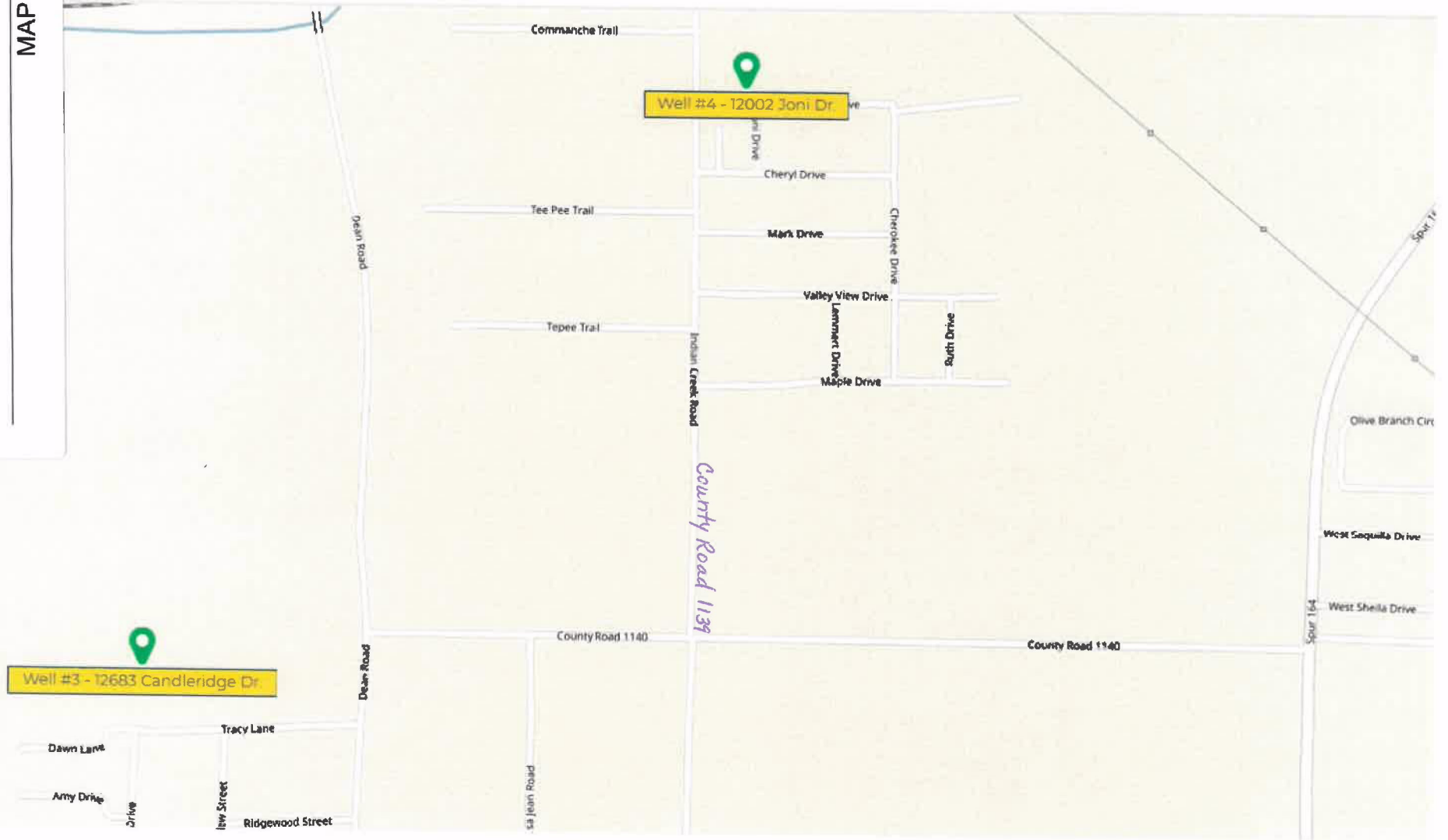

Dean Water Supply Corporation
Tyler, TX 75709

Well #3
12683 Candleridge Dr.

Well #4
12002 Joni Dr.

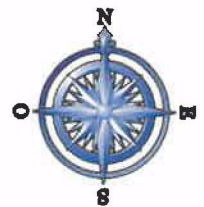

APPENDIX A
MAP OF WATER WELL FACILITY

MAP #2

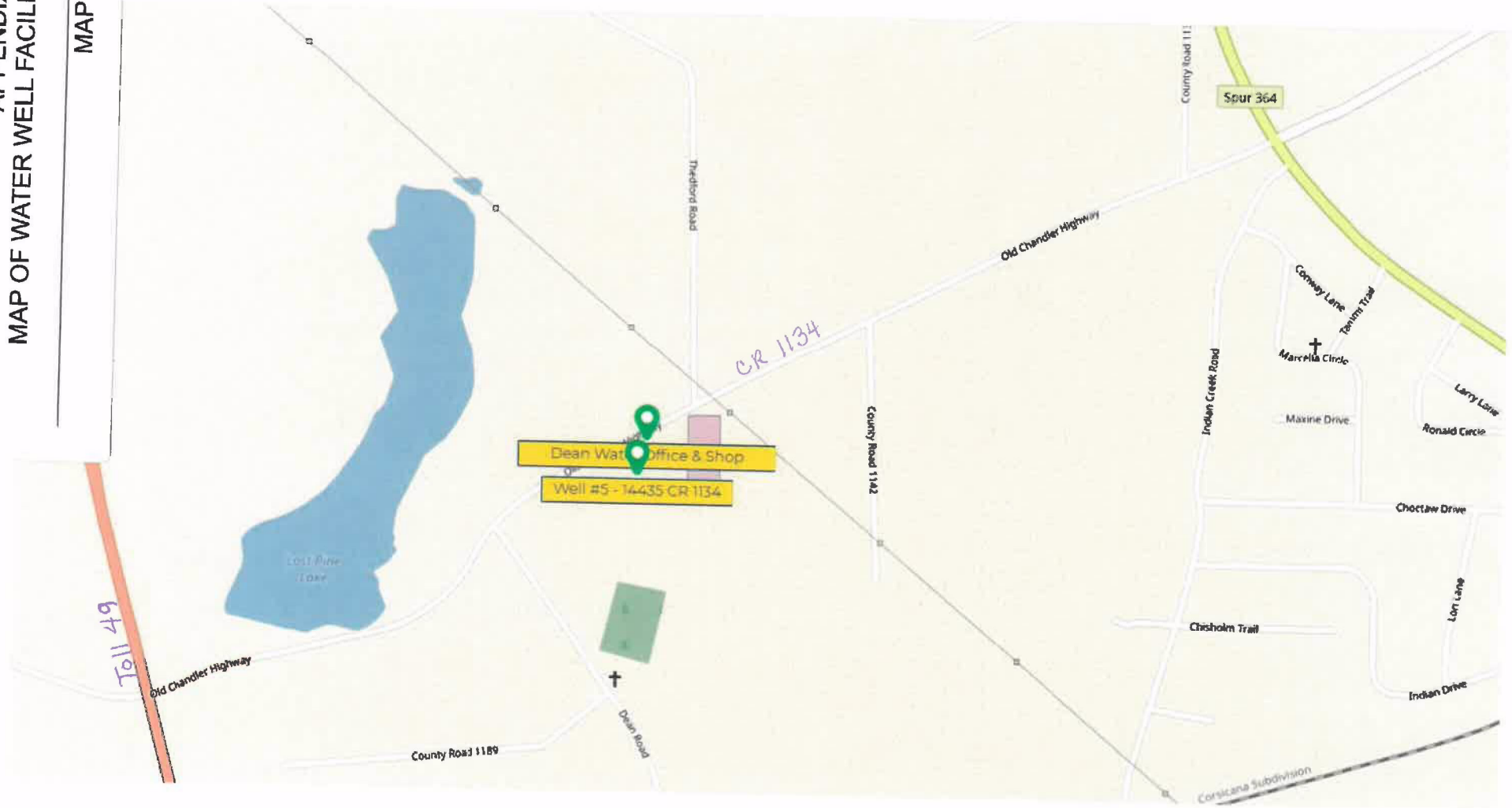

Dean Water Supply Corporation
Tyler, TX 75709

Well #5
14435 CR 1134

Dean Water Office & Shop
14411 CR 1134

