



## Filing Receipt

**Received - 2021-10-28 10:20:59 AM**  
**Control Number - 52299**  
**ItemNumber - 565**

The Public Utility Commission of Texas  
Central Records  
1701 N. Congress P.O. Box 13326  
Austin, Texas 782-3326

To Whom it May Concern:

RE: Project 52299 Confidential Filing

Affiliated/ Assumed Name(s) (if applicable):

Per Senate Bill 3 (SB 3), 87<sup>th</sup> Texas Legislature which passed on June 8<sup>th</sup>, as an Affected Utility, **City of Gladewater** provides **Water Services** and **Wastewater Seivces** for **City of Gladewater Area**. The following public water system(s) and sewer utility system(s) are owned by **City of Gladewater**:

Name:		Gladewater Water Treatment Plant
a. Address/Location of Utility		1409 West Lake, Gladewater Tx 75647
b. Enter General Description of facility that qualify for Critical Load Status. (Attach Maps if needed in Appendix A)		Raw water pump station, Water Plant and high service pumps all at this location.
c. TDU Provider		SWEPCO
d. Retail Provider		SWEPCO
Name:		Gladewater Waste Water Plant
a. Address/Location of Utility		1025 South Roden, Gladewater Tx 75647
b. Enter General Description of facility that qualify for Critical Load Status. (Attach Maps if needed in Appendix A)		Waste Water Treatment Plant.
c. TDU Provider		SWEPCO
d. Retail Provider		SWEPCO
Name:		
a. Address/Location of Utility		
b. Enter General Description of facility that qualify for Critical Load Status. (Attach Maps if needed in Appendix A)		
c. TDU Provider		SWEPCO
d. Retail Provider		SWEPCO

For all questions or communications regarding **City of Gladewater Water and Waste Water** and/or emergency power at the above locations shall be addressed to:

Point of Contact: **Ricky Tow** 903-845-2196 ext 9

Alternative Point of Contact: **John Choice** 903-720-4141

**City of Gladewater**  
**519 E. Broadway / P.O. Box 1725**  
**Gladewater Tx.75647**

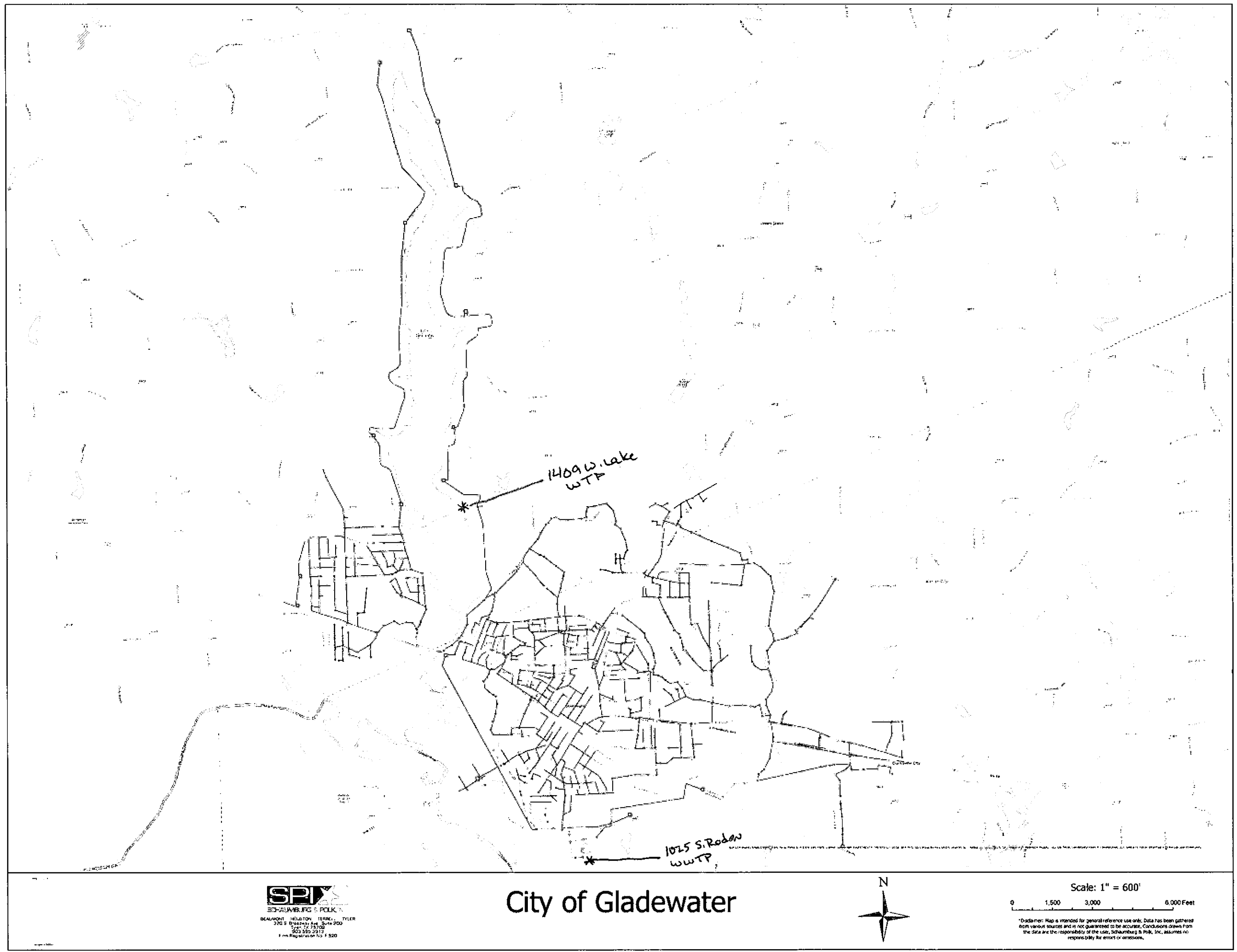

**SPX**  
SCHAUMBURG & POLK, INC.  
BEAUMONT, HOUSTON, TERRY, TYLER  
370 S. Broadway Ave., Suite 200  
Tyler, TX 75702  
936.335.2917  
EPA Registration No. F-520

# City of Gladewater



Scale: 1" = 600'  
0 1,500 3,000 6,000 Feet

\*Disclaimer: Map is intended for general reference use only. Data has been gathered from various sources and is not guaranteed to be accurate. Conclusions drawn from the data are the responsibility of the user. Schaumburg & Polk, Inc., assumes no responsibility for errors or omissions.