



## Filing Receipt

**Received - 2021-10-27 03:35:54 PM**

**Control Number - 52299**

**ItemNumber - 498**

**City of Converse**  
**Water Wells, Storage, & Lift Stations**

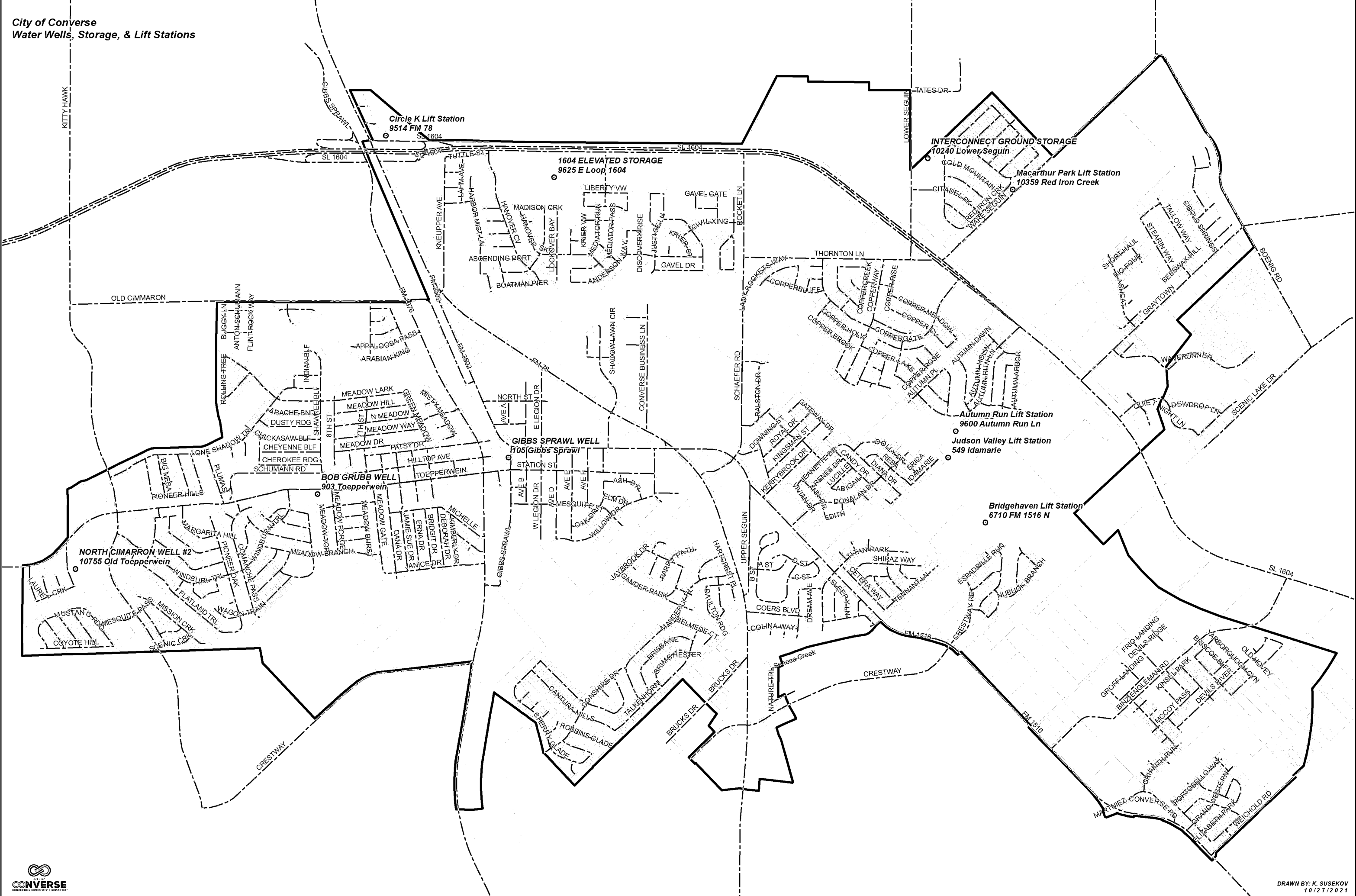



October 27, 2021

RE: Public Utility Commission of Texas (PUCT) in Project 52299

The water production facilities within the City of Converse that qualify for critical load status are as listed below:

North Cimarron #1 & #2	Wellsite	10755 Old Toepperwein Rd.
Bob Grubb	Wellsite	903 Toepperwein Rd.
Gibbs Sprawl	Wellsite	109 Gibbs Sprawl
1604 Storage Tank	Storage Tank	9625 E Loop 1604 N
Interconnect	Wellsite	10240 Lower Seguin Rd

The sewer collection facilities within the City of Converse that qualify for critical load status are as listed below:

Autumn Run	Lift Station	9600 Autumn Run
Judson Valley	Lift Station	549 Ida Marie
MacArthur Park	Lift Station	10359 Red Iron Creek
Bridgehaven	Lift Station	6710 FM 1516 N
Circle K	Lift Station	10410 Kneupper St.

Emergency Contact for all wellsites and lift Stations within the City of Converse:

Jonathan Smith, Director of Utilities	210-882-7964
Matt Scott, Utility Foreman	210-849-8734

Utility Department Facility Address:

9239 Converse Business Lane, Converse, Texas 78109

If you have any questions, please call.

Sincerely,

Jonathan Smith  
Director of Utilities  
City of Converse