



Control Number: 52233



Item Number: 1

Addendum StartPage: 0

# Coffin | Renner

June 10, 2021

2021 JUN 10 PM 2:32 52233  
PUBLIC UTILITY COMMISSION  
FILING CLERK

Central Records  
Public Utility Commission of Texas  
1701 N. Congress Avenue  
Austin, Texas 78701

Re: *CSWR-Texas Utility Operating Company, LLC's Notice of Extension Within Territory Already Served*

Pursuant to Texas Water Code § 13.243 and 16 Tex. Admin. Code (“TAC”) § 24.229(a), CSWR-Texas Utility Operating Company, LLC (“CSWR Texas”) submits this notice of an extension of water service to an area located contiguous to service territory it already serves under certificate of convenience and necessity (“CCN”) Number 13290. The affected area is located within the Council Creek Village and South Council Creek subdivisions, which CSWR Texas was approved to serve in Docket No. 51031. Following the acquisition and transfer of service obligations, CSWR Texas determined based on its customer list that the Public Utility Commission Texas’ (“Commission”) existing mapping does not reflect a portion of the subdivision that had been served by the former owners since at least the 1980s.

The subject area is located contiguous to CSWR Texas’s existing service territory: the point of ultimate use is within one quarter mile of the outer boundary of its existing certificated service area; the area is not receiving similar service from another retail public utility; and the area is not located inside another retail public utility’s certificated service area as the former owners of this system have been serving this area for decades. Accordingly, pursuant to Texas Water Code § 13.243 and 16 TAC § 24.229 (a)(1)(A), an amendment to CSWR Texas’s CCN is not necessary.

However, 16 TAC § 24.229(a)(2) requires that whenever an extension is made under 16 TAC § 24.229(a)(1)(A), the utility making the extension must inform the Commission of the extension by submitting, within 30 days of the date service is commenced, a copy of a map of the service area clearly showing the extension, accompanied by a written explanation of the extension.

This notice is being filed to comply with 16 TAC § 24.229(a)(2). Mapping files showing the corrected service area are attached to this notice as Attachment 1. Digital mapping files are also being provided for the Commission’s convenience.

Please do not hesitate to contact me if you have any questions.

Respectfully,

A handwritten signature in black ink that reads "Evan D. Johnson". The signature is fluid and cursive, with the first name "Evan" and last name "Johnson" clearly legible.

Evan D. Johnson  
State Bar No. 24065498  
evan.johnson@crtxlaw.com

Attorney for CSWR-Texas Utility  
Operating Company, LLC



SCALE 1" = 200'

FINAL SERVICE AREA MAP  
 COUNCIL CREEK VILLAGE - COUNCIL CREEK  
 (WATER)  
 BURNET, TX  
 EXISTING SERVICE AREA

ALL PLANS HAVE BEEN FIC'D OUTED FOR

**NOTICE TO READERS:**  
 The information shown on this map was prepared by the Engineering Division of the City of Burnet, Texas. It is intended to provide a general layout of the service area and does not constitute a legal description of any land. The information shown on this map is not to be used for any purpose other than that for which it was prepared.

**NOTICE TO CONTRACTORS:**  
 The information shown on this map is not to be used for any purpose other than that for which it was prepared. It is intended to provide a general layout of the service area and does not constitute a legal description of any land. The information shown on this map is not to be used for any purpose other than that for which it was prepared.

**NOTICE TO CONTRACTORS:**  
 The information shown on this map is not to be used for any purpose other than that for which it was prepared. It is intended to provide a general layout of the service area and does not constitute a legal description of any land. The information shown on this map is not to be used for any purpose other than that for which it was prepared.

**NOTICE TO CONTRACTORS:**  
 The information shown on this map is not to be used for any purpose other than that for which it was prepared. It is intended to provide a general layout of the service area and does not constitute a legal description of any land. The information shown on this map is not to be used for any purpose other than that for which it was prepared.

**NOTICE TO CONTRACTORS:**  
 The information shown on this map is not to be used for any purpose other than that for which it was prepared. It is intended to provide a general layout of the service area and does not constitute a legal description of any land. The information shown on this map is not to be used for any purpose other than that for which it was prepared.

**NOTICE TO CONTRACTORS:**  
 The information shown on this map is not to be used for any purpose other than that for which it was prepared. It is intended to provide a general layout of the service area and does not constitute a legal description of any land. The information shown on this map is not to be used for any purpose other than that for which it was prepared.

**NOTICE TO CONTRACTORS:**  
 The information shown on this map is not to be used for any purpose other than that for which it was prepared. It is intended to provide a general layout of the service area and does not constitute a legal description of any land. The information shown on this map is not to be used for any purpose other than that for which it was prepared.



MAP LEGEND

WELL SERVICE PER RECORD PLAN	[Symbol: Dashed line]
LOT LINE	[Symbol: Solid line]

**NOTICE TO CONTRACTORS:**

The information shown on this map is not to be used for any purpose other than that for which it was prepared. It is intended to provide a general layout of the service area and does not constitute a legal description of any land. The information shown on this map is not to be used for any purpose other than that for which it was prepared.

DATE: 12/22/20  
 PROJECT NO: 0834-19  
 DRAWN BY: K.A.S.  
 SCALE: 1"=200'  
 SHEET NAME:  
 SERVICE AREA MAP



FINAL SERVICE AREA MAP SOUTH  
COUNCIL CREEK (WATER)  
BURNET, TX  
PROPOSED SERVICE AREA  
EXTENSION



ALL DIMENSIONS ARE TO CENTER OF SERVICE AREA

PROJECT NO. 11370-01  
 PROJECT NO. 11370-01  
 SHEET NO. 11370-01  
 SCALE 1"=200'  
 SHEET NAME SERVICE AREA MAP

DATE: 11/30/10  
 DRAWN BY: JLR  
 CHECKED BY: JLR  
 PROJECT NO.: 11370-01  
 SHEET NO.: 11370-01  
 SCALE: 1"=200'  
 SHEET NAME: SERVICE AREA MAP

PROPERTY: UNIT 10, COUNCIL CREEK SOUTH, LOT 10  
 UNIT 11, COUNCIL CREEK SOUTH, LOT 11  
 UNIT 12, COUNCIL CREEK SOUTH, LOT 12  
 UNIT 13, COUNCIL CREEK SOUTH, LOT 13  
 UNIT 14, COUNCIL CREEK SOUTH, LOT 14  
 UNIT 15, COUNCIL CREEK SOUTH, LOT 15  
 UNIT 16, COUNCIL CREEK SOUTH, LOT 16  
 UNIT 17, COUNCIL CREEK SOUTH, LOT 17  
 UNIT 18, COUNCIL CREEK SOUTH, LOT 18  
 UNIT 19, COUNCIL CREEK SOUTH, LOT 19  
 UNIT 20, COUNCIL CREEK SOUTH, LOT 20  
 UNIT 21, COUNCIL CREEK SOUTH, LOT 21  
 UNIT 22, COUNCIL CREEK SOUTH, LOT 22  
 UNIT 23, COUNCIL CREEK SOUTH, LOT 23  
 UNIT 24, COUNCIL CREEK SOUTH, LOT 24  
 UNIT 25, COUNCIL CREEK SOUTH, LOT 25  
 UNIT 26, COUNCIL CREEK SOUTH, LOT 26  
 UNIT 27, COUNCIL CREEK SOUTH, LOT 27  
 UNIT 28, COUNCIL CREEK SOUTH, LOT 28  
 UNIT 29, COUNCIL CREEK SOUTH, LOT 29  
 UNIT 30, COUNCIL CREEK SOUTH, LOT 30  
 UNIT 31, COUNCIL CREEK SOUTH, LOT 31  
 UNIT 32, COUNCIL CREEK SOUTH, LOT 32  
 UNIT 33, COUNCIL CREEK SOUTH, LOT 33  
 UNIT 34, COUNCIL CREEK SOUTH, LOT 34  
 UNIT 35, COUNCIL CREEK SOUTH, LOT 35  
 UNIT 36, COUNCIL CREEK SOUTH, LOT 36  
 UNIT 37, COUNCIL CREEK SOUTH, LOT 37  
 UNIT 38, COUNCIL CREEK SOUTH, LOT 38  
 UNIT 39, COUNCIL CREEK SOUTH, LOT 39  
 UNIT 40, COUNCIL CREEK SOUTH, LOT 40  
 UNIT 41, COUNCIL CREEK SOUTH, LOT 41  
 UNIT 42, COUNCIL CREEK SOUTH, LOT 42  
 UNIT 43, COUNCIL CREEK SOUTH, LOT 43  
 UNIT 44, COUNCIL CREEK SOUTH, LOT 44  
 UNIT 45, COUNCIL CREEK SOUTH, LOT 45  
 UNIT 46, COUNCIL CREEK SOUTH, LOT 46  
 UNIT 47, COUNCIL CREEK SOUTH, LOT 47  
 UNIT 48, COUNCIL CREEK SOUTH, LOT 48  
 UNIT 49, COUNCIL CREEK SOUTH, LOT 49  
 UNIT 50, COUNCIL CREEK SOUTH, LOT 50  
 UNIT 51, COUNCIL CREEK SOUTH, LOT 51  
 UNIT 52, COUNCIL CREEK SOUTH, LOT 52  
 UNIT 53, COUNCIL CREEK SOUTH, LOT 53  
 UNIT 54, COUNCIL CREEK SOUTH, LOT 54  
 UNIT 55, COUNCIL CREEK SOUTH, LOT 55  
 UNIT 56, COUNCIL CREEK SOUTH, LOT 56  
 UNIT 57, COUNCIL CREEK SOUTH, LOT 57  
 UNIT 58, COUNCIL CREEK SOUTH, LOT 58  
 UNIT 59, COUNCIL CREEK SOUTH, LOT 59  
 UNIT 60, COUNCIL CREEK SOUTH, LOT 60  
 UNIT 61, COUNCIL CREEK SOUTH, LOT 61  
 UNIT 62, COUNCIL CREEK SOUTH, LOT 62  
 UNIT 63, COUNCIL CREEK SOUTH, LOT 63  
 UNIT 64, COUNCIL CREEK SOUTH, LOT 64  
 UNIT 65, COUNCIL CREEK SOUTH, LOT 65  
 UNIT 66, COUNCIL CREEK SOUTH, LOT 66  
 UNIT 67, COUNCIL CREEK SOUTH, LOT 67  
 UNIT 68, COUNCIL CREEK SOUTH, LOT 68  
 UNIT 69, COUNCIL CREEK SOUTH, LOT 69  
 UNIT 70, COUNCIL CREEK SOUTH, LOT 70  
 UNIT 71, COUNCIL CREEK SOUTH, LOT 71  
 UNIT 72, COUNCIL CREEK SOUTH, LOT 72  
 UNIT 73, COUNCIL CREEK SOUTH, LOT 73  
 UNIT 74, COUNCIL CREEK SOUTH, LOT 74  
 UNIT 75, COUNCIL CREEK SOUTH, LOT 75  
 UNIT 76, COUNCIL CREEK SOUTH, LOT 76  
 UNIT 77, COUNCIL CREEK SOUTH, LOT 77  
 UNIT 78, COUNCIL CREEK SOUTH, LOT 78  
 UNIT 79, COUNCIL CREEK SOUTH, LOT 79  
 UNIT 80, COUNCIL CREEK SOUTH, LOT 80  
 UNIT 81, COUNCIL CREEK SOUTH, LOT 81  
 UNIT 82, COUNCIL CREEK SOUTH, LOT 82  
 UNIT 83, COUNCIL CREEK SOUTH, LOT 83  
 UNIT 84, COUNCIL CREEK SOUTH, LOT 84  
 UNIT 85, COUNCIL CREEK SOUTH, LOT 85  
 UNIT 86, COUNCIL CREEK SOUTH, LOT 86  
 UNIT 87, COUNCIL CREEK SOUTH, LOT 87  
 UNIT 88, COUNCIL CREEK SOUTH, LOT 88  
 UNIT 89, COUNCIL CREEK SOUTH, LOT 89  
 UNIT 90, COUNCIL CREEK SOUTH, LOT 90  
 UNIT 91, COUNCIL CREEK SOUTH, LOT 91  
 UNIT 92, COUNCIL CREEK SOUTH, LOT 92  
 UNIT 93, COUNCIL CREEK SOUTH, LOT 93  
 UNIT 94, COUNCIL CREEK SOUTH, LOT 94  
 UNIT 95, COUNCIL CREEK SOUTH, LOT 95  
 UNIT 96, COUNCIL CREEK SOUTH, LOT 96  
 UNIT 97, COUNCIL CREEK SOUTH, LOT 97  
 UNIT 98, COUNCIL CREEK SOUTH, LOT 98  
 UNIT 99, COUNCIL CREEK SOUTH, LOT 99  
 UNIT 100, COUNCIL CREEK SOUTH, LOT 100

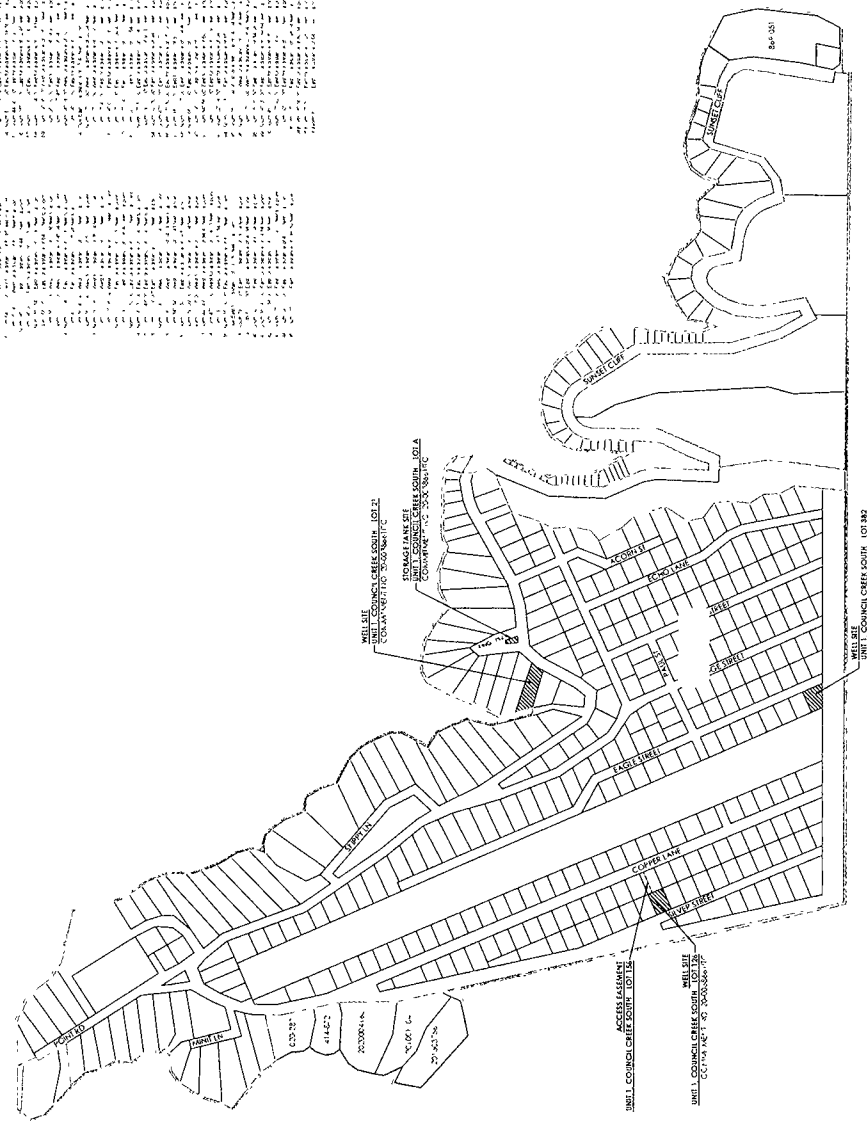

MAP LEGEND

PROPERTY	SOLID LINE
EXISTING	DASHED LINE
PROPOSED	DOTTED LINE

USE LEGEND FOR DETAILS

The City of Burnet is not responsible for the accuracy of the information shown on this map. The City of Burnet is not responsible for the accuracy of the information shown on this map. The City of Burnet is not responsible for the accuracy of the information shown on this map. The City of Burnet is not responsible for the accuracy of the information shown on this map.

DATE: 11/30/10  
 DRAWN BY: JLR  
 CHECKED BY: JLR  
 PROJECT NO.: 11370-01  
 SHEET NO.: 11370-01  
 SCALE: 1"=200'  
 SHEET NAME: SERVICE AREA MAP

**ROUGH SERVICE AREA MAP  
COUNCIL CREEK & SOUTH COUNCIL CREEK 2  
(WATER)  
BURNET, TX**



**Utility Note Disclaimer:**

The service area shown hereon are depicted based on the service area map provided by the system manager. 21 Design Group, Inc. performed no field verification of the layout and are unable to determine the exact location at this time. The location represents approximate location only and should not be construed as being 100% accurate. It is shown to provide general service area of the system to assist with ordering the work and preparation of scope for a Licensed Land Surveyor. This sketch should not be used to interpret encroachments.

DATE:	4/22/2020
PROJECT NO:	0558-18
DRAWN BY:	B.J.K
SCALE:	
SHEET NAME:	
SERVICE AREA MAP:	

**21**  
**DESIGN**  
**GROUP INC.**

11114  
Arlington, TX 76010  
PHONE: 817.437.9121  
F: 817.437.9120