



Control Number: 52090



Item Number: 15

Addendum StartPage: 0

2021 JUL -8 AM 9: 14

DOCKET NO. 52090

<b>PETITION OF REDBIRD</b>	§	<b>PUBLIC UTILITY COMMISSION</b>
<b>DEVELOPMENT, LLC TO AMEND</b>	§	
<b>DOBBIN PLANTERSVILLE WATER</b>	§	<b>OF TEXAS</b>
<b>SUPPLY CORPORATION'S</b>	§	
<b>CERTIFICATE OF CONVENIENCE</b>	§	
<b>AND NECESSITY IN MONTGOMERY</b>	§	
<b>COUNTY BY EXPEDITED RELEASE</b>	§	

**DOBBIN PLANTERSVILLE'S RESPONSE TO COMMISSION STAFF'S FIRST REQUEST FOR INFORMATION**

TO: The Public Utility Commission Staff, by and through its counsel of record, Phillip Lehrmann, 1701 N. Congress Avenue, P.O. Box 13326, Austin, Texas 78711-3326

Intervenor and CCN Holder Dobbin Plantersville Water Supply Corporation ("Intervenor") files this Response to the Commission Staff's First Request for Information. The Intervenor's written responses to Commission Staff's requests are attached and incorporated by reference. The Intervenor's responses and responsive documents are given in the spirit of cooperation without waiving the District's right to contest the admissibility of any of this information at hearing. Pursuant to 16 Texas Administrative Code section 22.144(c)(2)(A), each response lists the preparer or person under whose direct supervision the response was prepared and the sponsoring witness, if any. Pursuant to 16 Texas Administrative Code section 22.144(c)(2)(F), the Intervenor stipulates that its responses may be treated by all parties as if they were made under oath. For purposes of these responses, Intervenor uses the same definitions set out in Staff's First Request for Information.

Respectfully submitted,

**MARY K. SAHS, P.C.**

*Mary K. Sahs*

---

Mary K. Sahs  
State Bar No. 17522300  
P.O. Box 40970  
Austin, Texas 78704  
Telephone: (512) 585-1705  
Facsimile: (512) 597-2516  
Email: marysahs@sahslaw.com

**ATTORNEY FOR DOBBIN  
PLANTERSVILLE WATER  
SUPPLY CORPORATION**

**DOCKET NO. 52090**  
**CERTIFICATE OF SERVICE**

I certify that, unless otherwise ordered by the presiding officer, notice of the filing of this document was provided to all parties of record on July 7, 2021 in accordance with the Order Suspending Rules filed in Project No. 50664.

*Mary K. Sahs*

---

Mary K. Sahs

**DOCKET NO. 52090**

**INTERVENOR DOBBIN PLANTERSVILLE WSC'S RESPONSE TO COMMISSION  
STAFF'S FIRST REQUEST FOR INFORMATION**

**Staff 1-1 Provide any contracts for water service to the Redbird Development, LLC Tract executed in the last 12 months.**

**RESPONSE:** None

**Prepared by:** Janie Legge, General Manager

**Sponsored by:** Janie Legge, General Manager

**Staff 1-2 Provide any bills for water service to the Tract issued in the last 12 months.**

**RESPONSE:** None

**Prepared by:** Janie Legge, General Manager

**Sponsored by:** Janie Legge, General Manager

**Staff 1-3 Provide any other documents demonstrating that Dobbin-Plantersville Water Supply Corporation provided water service to the Tract in the last 12 months.**

**RESPONSE:** None

**Prepared by:** Janie Legge, General Manager

**Sponsored by:** Janie Legge, General Manager

**Staff 1-4 Describe any water or sewer meters located within the Tract and provide the date on which each meter was last active.**

**RESPONSE:** None

**Prepared by:** Janie Legge, General Manager

**Sponsored by:** Janie Legge, General Manager

**Staff 1-5 Describe any water or sewer lines located within the Tract, including the diameter of the line, the length of the portion of the line that is located within the Tract, and the date the line was put in service.**

**RESPONSE:** None

**Prepared by:** Janie Legge, General Manager

**Sponsored by:** Janie Legge, General Manager

**Staff 1-6** Describe any water or sewer lines that are located in close proximity to, but not within, the Tract. For each line described, include the diameter, the length of the portion of the line that is in close proximity to the Tract, and the date the line was placed into service.

**RESPONSE:** The Tract has frontage on Spring Branch Road for approximately sixty feet. Of this, the entire length is paralleled by both a 6" diameter and a 4" diameter line. Together these have a TCEQ combined capacity for 350 active connections and have been in service since prior to 2010.

**Prepared by:** Steve Duncan, Outside Engineering Consultant

**Sponsored by:** Steve Duncan, Outside Engineering Consultant

**Staff 1-7** Describe any water or sewer facilities located within the Tract, including the total capacity of the facility, the current unused capacity of the facility, and the date the facility was placed into service.

**RESPONSE:** None

**Prepared by:** Janie Legge, General Manager

**Sponsored by:** Janie Legge, General Manager

**Staff 1-8** Describe any water or sewer facilities that are located in close proximity to, but not within, the Tract. For each facility described, include the total capacity of the facility, the current unused capacity of the facility, and the date the facility was placed into service.

**RESPONSE:** Existing Water Plant 4 is located approximately 700 feet north of the Tract along Spring Branch Road. Dobbin Plantersville recently purchased an additional acre of land adjacent to the plant site for its expansion. It has the following major components with their respective TCEQ connection capacity noted. The water plant was put into service in 1983 and upgraded in 2001 and 2012.

Water Well, 180 gallons per minute, 300 connections

Ground Storage Tank, 84,000 gallons, 420 connections

Pressure Tank, 10,000 gallons, 500 connections

Booster Pumps, 600 gallons per minute total, 300 connections

Dobbin Plantersville currently has approximately 230 active connections for that portion of the Montgomery County interconnected system. Taken in isolation, water plant 4 has unused capacity to support 70 connections.

**Prepared by:** Steve Duncan, Outside Engineering Consultant

**Sponsored by:** Steve Duncan, Outside Engineering Consultant

**Staff 1-9 Provide a detailed map showing the location of all meters, lines, and facilities described in response to Question Nos. Staff 1-4 through 1-8.**

**RESPONSE:** See attached Exhibit A.

**Prepared by:** Steve Duncan, Outside Engineering Consultant

**Sponsored by:** Steve Duncan, Outside Engineering Consultant

**Staff 1-10 For each meter, line, or facility described in response to Question Nos. Staff 1-4 through 1-8, provide the distance of each meter, line, or facility from the outer boundary of the Tract.**

**RESPONSE:** See attached Exhibit A.

**Prepared by:** Steve Duncan, Outside Engineering Consultant

**Sponsored by:** Steve Duncan, Outside Engineering Consultant

**Staff 1-11 For each meter, line, or facility described in response to Question Nos. Staff 1-4 through 1-8, explain how the meter, line, or facility is committed to providing water service to the Tract.**

**RESPONSE:** The water lines discussed in Question No. Staff 1-6 are committed to providing water service to properties along Spring Branch Road. This includes the subject tract, as the water lines runs parallel and are adjacent to the tract and has excess capacity.

Dobbin Plantersville water plants are committed to providing water service to the CCN area. Water Plant 4 discussed in Question No. Staff 1-8 serves the area primarily south of State Highway 105 and east of Lake Creek which includes the subject tract. It is committed to providing water service to the subject tract as it is sited very near the tract and has excess capacity. Dobbin Plantersville has also recently purchased land for its expansion.

**Prepared by:** Steve Duncan, Outside Engineering Consultant

**Sponsored by:** Steve Duncan, Outside Engineering Consultant

ORIGINAL LAYOUT SIZE - 8.5X11

BA-DOBBIN-BRYAN-PROJECTS\12707\12707.DP-WSC-ON CALL\CAMMER-REDBIRD MEADOWS RANCH\FACILITY EXHIBIT.DWG

BLEYL ENGINEERING

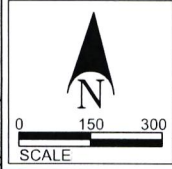
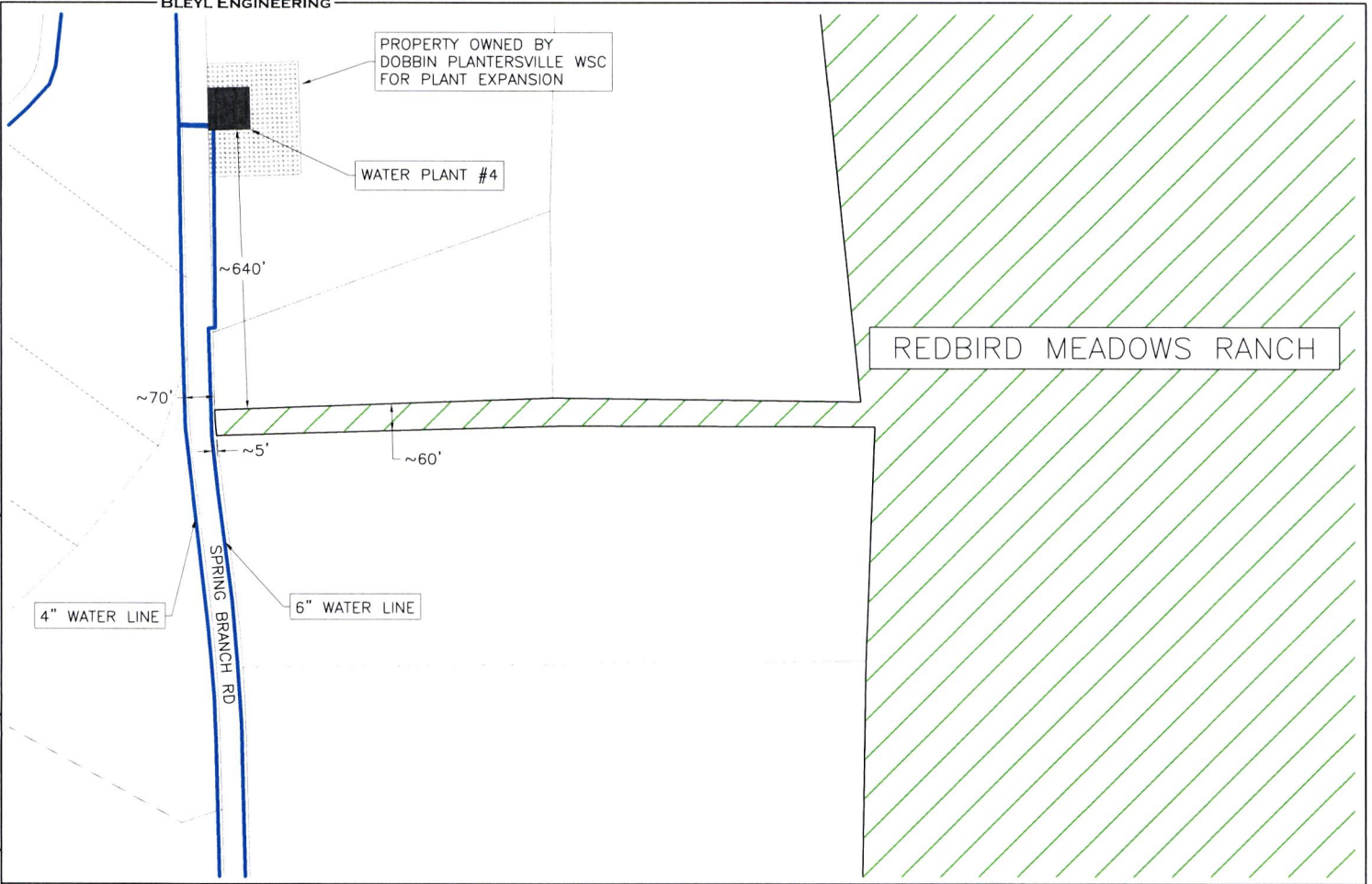

PROJECT NAME:	REDBIRD MEADOWS RANCH
PROJECT NUMBER:	12707
PREPARED FOR:	DOBBIN PLANTERSVILLE WSC
DATE:	JULY 07, 2021

<b>DOBBIN PLANTERSVILLE WSC FACILITIES</b>	
 <b>BLEYL ENGINEERING</b> TEXAS FIRM REGISTRATION NO. F-678 WWW.BLEYLENGINEERING.COM	1722 BROADMOOR, STE 210 BRYAN TEXAS 77802 PHONE 979-268-1125