



## Filing Receipt

**Received - 2022-01-28 11:44:21 AM**

**Control Number - 51981**

**ItemNumber - 37**

**DOCKET NO. 51981**

<b>APPLICATION OF LIVE OAK HILLS AND FLAG CREEK RANCH WATER SYSTEMS AND CSWR-TEXAS UTILITY OPERATING COMPANY, LLC FOR SALE, TRANSFER, OR MERGER OF FACILITIES AND CERTIFICATE RIGHTS IN LLANO AND MCCULLOCH COUNTIES</b>	<b>§ § § § § § § §</b>	<b>PUBLIC UTILITY COMMISSION  OF TEXAS</b>
--	--	--

**NOTICE OF APPROVAL**

This Order addresses the application of Live Oak Hills and Flag Creek Ranch Water Systems and CSWR-Texas Utility Operating Company, LLC (collectively, applicants) for the sale, transfer, or merger of facilities in Llano and McCulloch counties. The applicants seek the sale and transfer of all facilities and service area held under Live Oak and Flag Creek’s certificate of convenience and necessity (CCN) number 12463 to CSWR-Texas, the cancellation of Live Oak and Flag Creek’s CCN number 12463, and the amendment of CSWR-Texas’s CCN number 13290 to include the area previously included in Live Oak and Flag Creek’s CCN number 12463. The Commission approves the sale and transfer of all of Live Oak and Flag Creek’s facilities and service area under CCN number 12436 to CSWR-Texas under CCN number 13290, and the cancellation of Live Oak and Flag Creek’s CCN number 12463.

**I. Findings of Fact**

The Commission makes the following findings of fact.

**Applicants**

1. Live Oak and Flag Creek is a sole proprietorship that operates, maintains, and controls facilities for providing water service in McCulloch and Llano counties under CCN number 12463.
2. Live Oak and Flag Creek owns and operates two public water systems registered with the Texas Commission on Environmental Quality (TCEQ) under the following identification numbers: Flag Creek Ranch Water System, number 1500112; and Live Oak Hills Water System, number 1540012.

3. CSWR-Texas is a Texas limited liability company registered with the Texas secretary of state under file number 803367893.
4. CSWR-Texas operates, maintains, and controls facilities for providing water service in Aransas, Austin, Burlison, Burnet, Guadalupe, Harris, Hidalgo, Hood, Parker, Travis, Victoria, and Wilson counties under CCN number 13290.

**Application**

5. On April 1 and 5, 2021, the applicants filed the application at issue in this proceeding.
6. CSWR-Texas supplemented the application on May 5 and 6 and June 23 and 24, 2021.
7. In the application, the applicants seek approval of the following transaction: (a) CSWR-Texas will acquire all of Live Oak and Flag Creek's water facilities and water service area under CCN number 12463; (b) Live Oak and Flag Creek's CCN number 12463 will be cancelled; and (c) CSWR-Texas's CCN number 13290 will be amended to include the area previously included in Live Oak and Flag Creek's CCN number 12463.
8. The requested area served by Flag Creek comprises approximately 242 acres and includes 43 current customers and is located approximately 2 miles southwest of downtown Llano, Texas, and is generally bounded on the north by West Ranch Road 152; on the east by Ranch Road 2323; on the south by Ranch Road 2323; and on the west by County Road 116.
9. The requested area served by Live Oak is comprised of approximately 183 acres and includes 31 current customers and is located approximately 6 miles south-southeast of downtown Brady, Texas, and is generally bounded on the north by Private Road 652; on the east by United States Route 377; on the south by Private Road 670; and on the west by Private Road 650.
10. The total requested area is comprised of approximately 425 acres and 74 current customers.
11. In Order No. 2 filed on May 6, 2021, the ALJ found the application administratively complete.

**Notice**

12. On June 7, 2021, CSWR-Texas filed the affidavit of Josiah Cox, president of CSWR-Texas, attesting that notice was provided to all current customers of Live Oak and Flag Creek, neighboring utilities, and affected parties on June 4, 2021.
13. In Order No. 3 filed on June 18, 2021, the ALJ found the notice sufficient.

**Evidentiary Record**

14. On August 31, 2021, the parties filed a joint motion to admit evidence.
15. In Order No. 4 filed on September 15, 2021, the ALJ admitted the following evidence into the record of this proceeding: (a) the application, including confidential attachments, filed on April 1 and 5, 2021; (b) CSWR-Texas's first supplement to the application filed on May 5, 2021; (c) highly sensitive attachment G filed on May 5 and May 6, 2021; (d) CSWR-Texas's affidavit of notice to current customers, neighboring utilities, and affected parties, including confidential exhibit B, filed on June 7 and 8, 2021; (e) Commission Staff's recommendation on sufficiency of notice filed on June 16, 2021; (f) CSWR-Texas's second amended attachment G to the application filed on June 23 and 24, 2021; and (g) Commission Staff's recommendation on the transaction, including confidential attachments filed on August 3, 2021.
16. On January 4, 2022, the parties filed a supplemental joint motion to admit evidence.
17. In Order No. 7 filed on January 12, 2022, the ALJ admitted the following additional evidence in the record: (a) applicants' bill of sale filed on October 21, 2021; (c) Commission Staff's recommendation on the sufficiency of the closing documents filed November 2, 2021; (d) the applicants' consent forms filed on December 21, 2021; and (d) the map, certificate, and tariff attached to the joint supplemental motion to admit evidence and Notice of Approval filed on January 4, 2022.

**Sale**

18. In Order No. 5 filed on September 16, 2021, the ALJ approved the sale and transaction to proceed and required the applicants to file proof that the transaction had closed and customer deposits had been addressed.

19. On October 21, 2021, the applicants filed notice that the sale had closed on October 20, 2021 and confirmed that there were no outstanding customer deposits that needed to be addressed.
20. In Order No. 6 filed on November 2, 2021, the ALJ found the closing documents sufficient.

**Cumulative Recommendation**

21. On August 3, 2021, Commission Staff filed its recommendation regarding the transaction in this docket, recommending that CSWR-Texas has the financial, managerial, and technical capability to provide continuous and adequate service to all areas included in this docket and in Docket Nos. 50251,<sup>1</sup> 50276,<sup>2</sup> 50311,<sup>3</sup> 50989,<sup>4</sup> 51026,<sup>5</sup> 51065,<sup>6</sup> 51118,<sup>7</sup>

---

<sup>1</sup> *Application of JRM Water LLC and CSWR-Texas Utility Operating Company, LLC for Sale, Transfer, or Merger of Facilities and Certificate Rights in Victoria County, Docket No. 50251, Notice of Approval (Mar. 12, 2021).*

<sup>2</sup> *Application of North Victoria Utilities, Inc. and CSWR-Texas Utility Operating Company, LLC for Sale, Transfer, or Merger of Facilities and Certificate Rights in Victoria County, Docket No. 50276, Notice of Approval (Mar. 11, 2021).*

<sup>3</sup> *Application of Copano Heights Water Company and CSWR-Texas Utility Operating Company, LLC for Sale, Transfer, or Merger of Facilities and Certificate Rights in Aransas County, Docket No. 50311, Notice of Approval (Mar. 17, 2021).*

<sup>4</sup> *Application of Ranch Country of Texas Water Systems, Inc. and CSWR-Texas Utility Operating Company, LLC for Sale, Transfer, or Merger of Facilities and Certificate Rights in Austin County, Docket No. 50989, Notice of Approval (Apr. 23, 2021).*

<sup>5</sup> *Application of Tall Pines Utility, Inc. and CSWR-Texas Utility Operating Company, LLC for Sale, Transfer, or Merger of Facilities and Certificate Rights in Harris County, Docket No. 51026, Notice of Approval (Apr. 23, 2021).*

<sup>6</sup> *Application of Treetop Utilities, Inc. and CSWR-Texas Utility Operating Company, LLC for Sale, Transfer, or Merger of Facilities and Certificate Rights in Parker County, Docket No. 51065, Corrected Notice of Approval (Mar. 10, 2021).*

<sup>7</sup> *Application of Shady Oaks Water Supply Company, LLC and CSWR-Texas Utility Operating Company, LLC for Sale, Transfer, or Merger of Facilities and Certificate Rights in Wilson County, Docket No. 51118, Notice of Approval (Mar. 18, 2021).*

51031,<sup>8</sup> 51047,<sup>9</sup> 51130,<sup>10</sup> 51146,<sup>11</sup> 51089,<sup>12</sup> 51003,<sup>13</sup> 51036,<sup>14</sup> 51222,<sup>15</sup> 51642,<sup>16</sup> 51126,<sup>17</sup>  
51544,<sup>18</sup> 51928,<sup>19</sup> 51940,<sup>20</sup> and 51917.<sup>21</sup>

---

<sup>8</sup> *Application of Council Creek Village, Inc. dba Council Creek Village dba South Council Creek 2 and CSWR-Texas Utility Operating Company, LLC for Sale, Transfer, or Merger of Facilities and Certificate Rights in Burnet County, Docket No. 51031, Notice of Approval (Apr. 14, 2021).*

<sup>9</sup> *Application of Jones-Owen Company dba South Silver Creek I, II, and III and CSWR-Texas Utility Operating Company, LLC for Sale, Transfer, or Merger of Facilities and Certificate Rights in Burnet County, Docket No. 51047, Notice of Approval (Apr. 19, 2021).*

<sup>10</sup> *Application of Laguna Vista Limited and Laguna Tres, Inc. and CSWR-Texas Utility Operating Company, LLC for Sale, Transfer, or Merger of Facilities and Certificate Rights in Hood County, Docket No. 51130, Notice of Approval (Apr. 20, 2021).*

<sup>11</sup> *Application of Abraxas Corporation and CSWR-Texas Utility Operating Company, LLC for Sale, Transfer, or Merger of Facilities and Certificate Rights in Parker County, Docket No. 51146, Notice of Approval (Apr. 23, 2021).*

<sup>12</sup> *Application of Donald E. Wilson dba Quiet Village II dba QV Utility and CSWR-Texas Utility Operating Company, LLC for Sale, Transfer, or Merger of Facilities and Certificate Rights in Hidalgo County, Docket No. 51089, Notice of Approval (November 18, 2021).*

<sup>13</sup> *Application of Oak Hill Ranch Estates Water and CSWR-Texas Utility Operating Company, LLC for Sale, Transfer, or Merger of Facilities and Certificate Rights in Guadalupe and Wilson Counties, Docket No. 51003, Notice of Approval (Sep. 9, 2021).*

<sup>14</sup> *Application of Kathie Lou Daniels dba Woodlands West and CSWR-Texas Utility Operating Company, LLC for Sale, Transfer, or Merger of Facilities and Certificate Rights in Bureson County, Docket No. 51036, Notice of Approval (Aug. 23, 2021).*

<sup>15</sup> *Application of the Estate of Patetreen Petty McCoy dba Big Wood Springs Water Company and CSWR-Texas Utility Operating Company, LLC for Sale, Transfer, or Merger of Facilities and Certificate Rights in Wood County, Docket No. 51222 (pending).*

<sup>16</sup> *Application of James L. Nelson dba WaterCo and CSWR-Texas Utility Operating Company, LLC for Sale, Transfer, or Merger of Facilities and Certificate Rights in Montague County, Docket No. 51642 (pending).*

<sup>17</sup> *Application of Shawn M. Horvath dba Aero Valley Water Service and CSWR-Texas Utility Operating Company, LLC For Sale, Transfer, Or Merger of Facilities and to Amend CSWR-Texas Utility Operating Company, LLC's Certificate of Convenience and Necessity in Denton County, Docket No. 51126 (pending).*

<sup>18</sup> *Application of Franklin Water Service Co. LLC and CSWR-Texas Utility Operating Company, LLC For Sale, Transfer, Or Merger of Facilities and Certificate Rights in Lubbock County, Docket No. 51544 (pending).*

<sup>19</sup> *Application of Betty J. Dragoo and CSWR-Texas Utility Operating Company, LLC For Sale, Transfer, Or Merger of Facilities and Associated Acreage in Erath County, Docket No. 51928 (pending).*

<sup>20</sup> *Application of Walnut Bend Water Supply and CSWR-Texas Utility Operating Company, LLC For Sale, Transfer or Merger of Facilities and Certificate Rights in Angelina County, Docket No. 51940 (pending).*

<sup>21</sup> *Application of Rocket Water Company, Inc. and CSWR-Texas Utility Operating Company, LLC For Sale, Transfer, or Merger of Facilities and Certificate Rights in Hays County, Docket No. 51917 (pending).*

**System Compliance**

22. Flag Creek's public water system number 1500112 is currently in compliance with the rules of the TCEQ.
23. Live Oak's public water system number 1540012 currently has unresolved violations listed in the TCEQ database.
24. CSWR-Texas does not have any violations listed in the TCEQ database.
25. CSWR-Texas has not been subject to any unresolved enforcement action by the Commission, the TCEQ, the Texas Department of Health and Human Services, the Office of the Attorney General of Texas, or the United States Environmental Protection Agency in the past five years for non-compliance with rules, orders, or state statutes.
26. CSWR-Texas demonstrated a compliance history that is adequate for approval of the sale to proceed.

**Adequacy of Existing Service**

27. There are currently 74 connections in the requested area that is being served by Live Oak and Flag Creek through public water system numbers 1500112 and 1540012, and such service has been continuous.
28. The Live Oak public water system has several violations listed in the TCEQ database.
29. CSWR-Texas intends to invest the capital required to make the upgrades, renovations, and repairs necessary to bring the water system into compliance with TCEQ regulations and to ensure customers receive safe and reliable service.

**Need for Additional Service**

30. There is a continuing need for service because the Live Oak and Flag Creek public water systems are currently serving 74 connections in the requested area.
31. There have been no specific requests for additional service within the requested area.

**Effect of Approving the Transaction and Granting the Amendment**

32. Approving the sale and transfer to proceed and granting the CCN amendment will obligate CSWR-Texas to provide continuous and adequate water service to current and future customers in the requested area.

33. Because this application is to transfer only existing facilities, customers, and service area, there will be no effect on any other retail public utility servicing the proximate area.
34. There will be no effect on landowners in the requested area because they are currently certificated.
35. CSWR-Texas will adopt Live Oak and Flag Creek's current rates upon the consummation of the transaction.

**Ability to Serve: Managerial and Technical**

36. CSWR-Texas owns and operates 17 public water systems registered with the TCEQ and does not have any active violations listed in the TCEQ database.
37. CSWR-Texas employs or contracts with TCEQ-licensed water operators who will operate the public water system being transferred.
38. CSWR-Texas has access to an adequate supply of water and is capable of providing water that meets the requirements of chapter 341 of the Texas Health and Safety Code, chapter 13 of the Texas Water Code (TWC), and the TCEQ's rules.
39. CSWR-Texas has the technical and managerial capability to provide adequate and continuous service to the requested area.

**Ability to Serve: Financial Ability and Stability**

40. CSWR, LLC, the immediate parent company of CSWR-Texas, is capable, available, and willing to cover temporary cash shortages, and has a debt-to-equity ratio of less than one, satisfying the leverage test.
41. CSWR, LLC provided a written guarantee to cover temporary cash shortages, demonstrated that it has sufficient cash available to cover any projected operations and maintenance shortages in the first year five years of operations after completion of the transaction, and possesses the cash and leverage ability to pay for capital improvements and necessary equity investments, satisfying the operations test.
42. CSWR-Texas demonstrated the financial and managerial ability and stability to provide continuous and adequate service to the requested area.



**Financial Assurance**

43. There is no need to require CSWR-Texas to provide a bond or other financial assurance to ensure continuous and adequate service.

**Feasibility of Obtaining Service from Adjacent Retail Public Utility**

44. The requested area is currently being served by Live Oak and Flag Creek, and there will be no changes to land uses or existing CCN boundaries. Obtaining service from an adjacent retail public utility would likely increase costs to customers because new facilities will need to be constructed. Therefore, it is not feasible to obtain service from another utility.

**Environmental Integrity and Effect on the Land**

45. There will be minimal effects on environmental integrity and on the land as a result of CSWR-Texas's planned upgrades, renovations, and repairs to the public water systems.

**Improvement of Service or Lowering Cost to Consumers**

46. Water service to the requested areas will improve because CSWR-Texas intends to address and resolve regulatory compliance issues and improve the safety and reliability of service.
47. The rates charged to customers in the requested area will not change as a result of the proposed transaction because CSWR-Texas will adopt the currently in effect tariff for Live Oak and Flag Creek public water systems upon consummation of the transaction.

**Regionalization or Consolidation**

48. CSWR-Texas will not need to construct a physically separate water system to continue serving the requested area; therefore, concerns of regionalization or consolidation do not apply.

**Tariff, Maps, and Certificate**

49. On December 13, 2021, Commission Staff emailed to the applicants the final proposed maps, certificate, and tariff related to this docket.
50. On December 21, 2021, the applicants filed their consent forms concurring with the proposed final map, certificate, and tariff.
51. On January 4, 2022, the final maps, certificate, and tariff were included as attachments to the joint supplemental motion to admit evidence and proposed notice of approval.

**Informal Disposition**

52. More than 15 days have passed since the completion of notice provided in this docket.
53. No person filed a protest or motion to intervene.
54. Live Oak and Flag Creek, CSWR-Texas, and Commission Staff are the only parties to this proceeding.
55. No party requested a hearing, and no hearing is needed.
56. Commission Staff recommended approval of the application.
57. The decision is not adverse to any party.

**II. Conclusions of Law**

The Commission makes the following conclusions of law.

1. The Commission has authority over this proceeding under TWC §§ 13.041, 13.241, 13.244, 13.246, 13.251, and 13.301.
2. Live Oak and Flag Creek and CSWR-Texas are retail public utilities as defined by TWC § 13.002(19) and 16 TAC § 24.3(31).
3. Notice of the application was provided in compliance with TWC § 13.301(a) and 16 TAC § 24.239(a) through (c).
4. The Commission processed the application as required by the TWC, the Administrative Procedure Act,<sup>22</sup> and Commission Rules.
5. Live Oak and Flag Creek and CSWR-Texas have complied with the requirements of 16 TAC § 24.239(k) with respect to customer deposits.
6. Live Oak and Flag Creek and CSWR-Texas completed the sale within the time frame required by 16 TAC § 24.239(m).
7. After consideration of the factors in TWC § 13.246(c) and 16 TAC §§ 25.227(e) and 24.239(h)(5), CSWR-Texas has demonstrated adequate financial, managerial, and technical capability for providing continuous and adequate service to the requested area

---

<sup>22</sup> Tex. Gov't Code §§ 2001.001-.903.

- as required by TWC §§ 13.241, 13.251, and 13.301(b) and 16 TAC §§ 24.227(d) and 24.239(e).
8. Live Oak and Flag Creek and CSWR-Texas demonstrated that the sale of Live Oak and Flag Creek's water facilities and the amendment of CSWR-Texas's water CCN number 13290 to include the area formerly served by Live Oak and Flag Creek under CCN number 12463 will serve the public interest and is necessary for the for the service, accommodation, convenience, and safety of the public as required by TWC §§ 13.246(b) and 13.301(d) and (e).
  9. CSWR-Texas meets the requirements of TWC §§ 13.241(b) and 13.301(b) to provide water utility service.
  10. It is not necessary for CSWR-Texas to provide bond or other financial assurance under TWC §§ 13.246(d) and 13.301(c).
  11. CSWR-Texas must record a certified copy of its certificate granted and map approved by this Notice of Approval, along with a boundary description of the service area, in the real property records of Llano and McCulloch counties within 31 days of receiving this Notice of Approval and submit to the Commission evidence of the recording as required by TWC § 13.257(r), (s).
  12. The requirements for informal disposition under 16 TAC § 22.35 have been met in this proceeding.

### **III. Ordering Paragraphs**

In accordance with these findings of fact and conclusions of law, the Commission issues the following orders.

1. The Commission approves the sale and transfer of facilities and water service area under water CCN number 12463 from Live Oak and Flag Creek to CSWR-Texas to be held under water CCN number 13290, the cancellation of Live Oak and Flag Creek's water CCN number 12463, and the amendment of CSWR-Texas's water CCN number 13290 to include the facilities and service area previously included in Live Oak and Flag Creek water CCN number 12463, to the extent provided in this Notice of Approval.

2. The Commission approves the map, certificate, and tariff attached to the Notice of Approval.
3. CSWR-Texas must serve every customer and applicant for service within the approved area under water CCN number 13290 that requests service and meets the terms of CSWR-Texas's water service, and such service must be continuous and adequate.
4. CSWR-Texas must comply with the recording requirements in TWC § 13.257(r) and (s) for the area in Llano and McCulloch counties affected by the application and must submit to the Commission evidence of the recording no later than 31 days after receipt of the Notice of Approval.
5. Within ten days of the date of the Notice of Approval, Commission Staff must provide a clean copy of the tariff approved by this Notice of Approval to central records to be marked *Approved* and filed in the Commission's tariff books.
6. The Commission denies all other motions and any other requests for general or specific relief, if not expressly granted

**Signed at Austin, Texas the 28th day of January 2022.**

**PUBLIC UTILITY COMMISSION OF TEXAS**



---

**GREGORY R. SIEMANKOWSKI  
ADMINISTRATIVE LAW JUDGE**

CSWR-Texas Utility Operating Company, LLC  
Portion of Water CCN No. 13290  
PUC Docket No. 51981

Transferred all of Live Oak Hills and Flag Creek Ranch Water Systems, CCN No. 12463 in  
McCulloch County

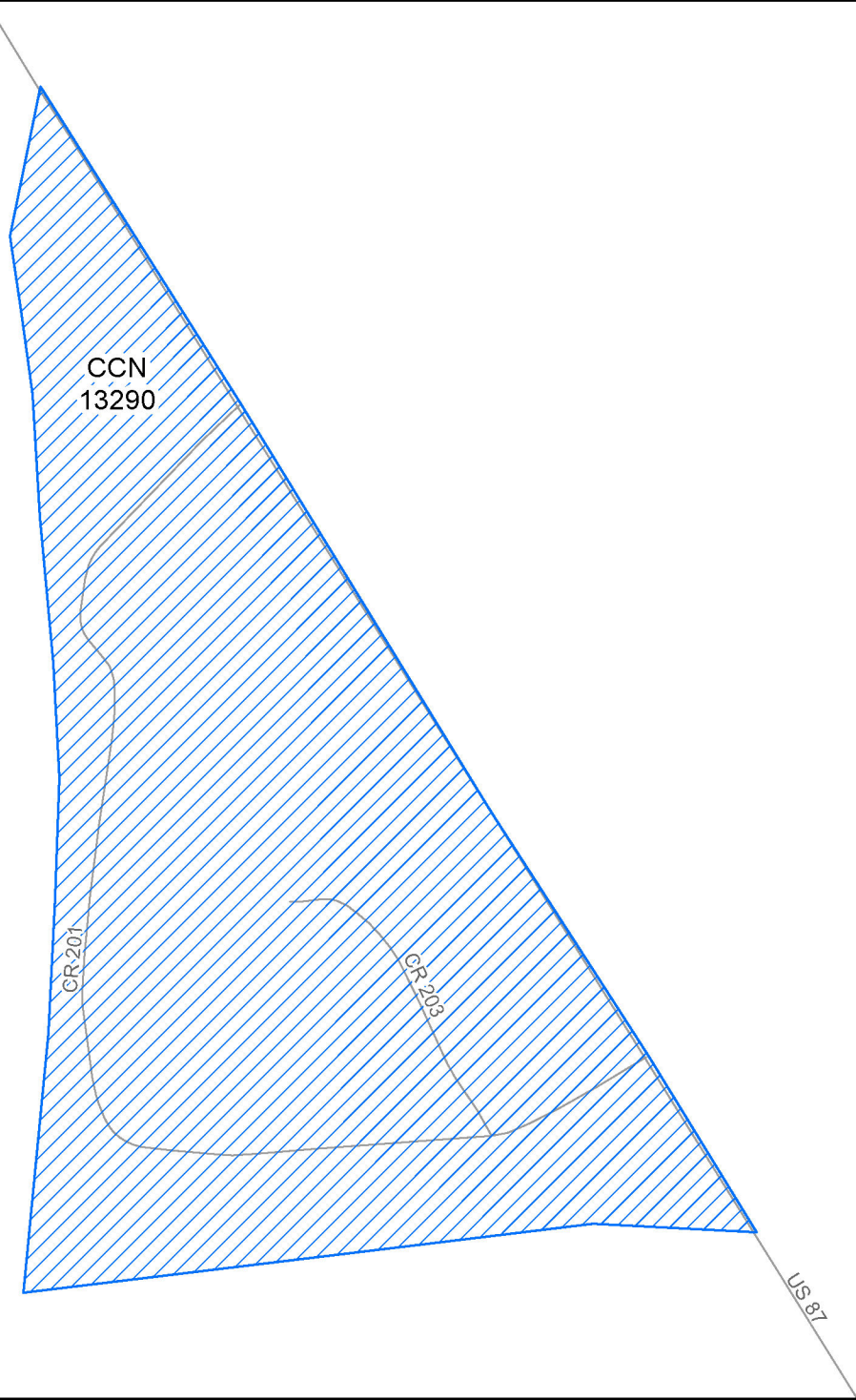

**Water CCN**



13290 - CSWR-Texas Utility Operating Company LLC



CSWR-Texas Utility Operating Company, LLC  
Portion of Water CCN No. 13290  
PUC Docket No. 51981

Transferred all of Live Oak Hills and Flag Creek Ranch Water Systems, CCN No. 12463 in  
Llano County

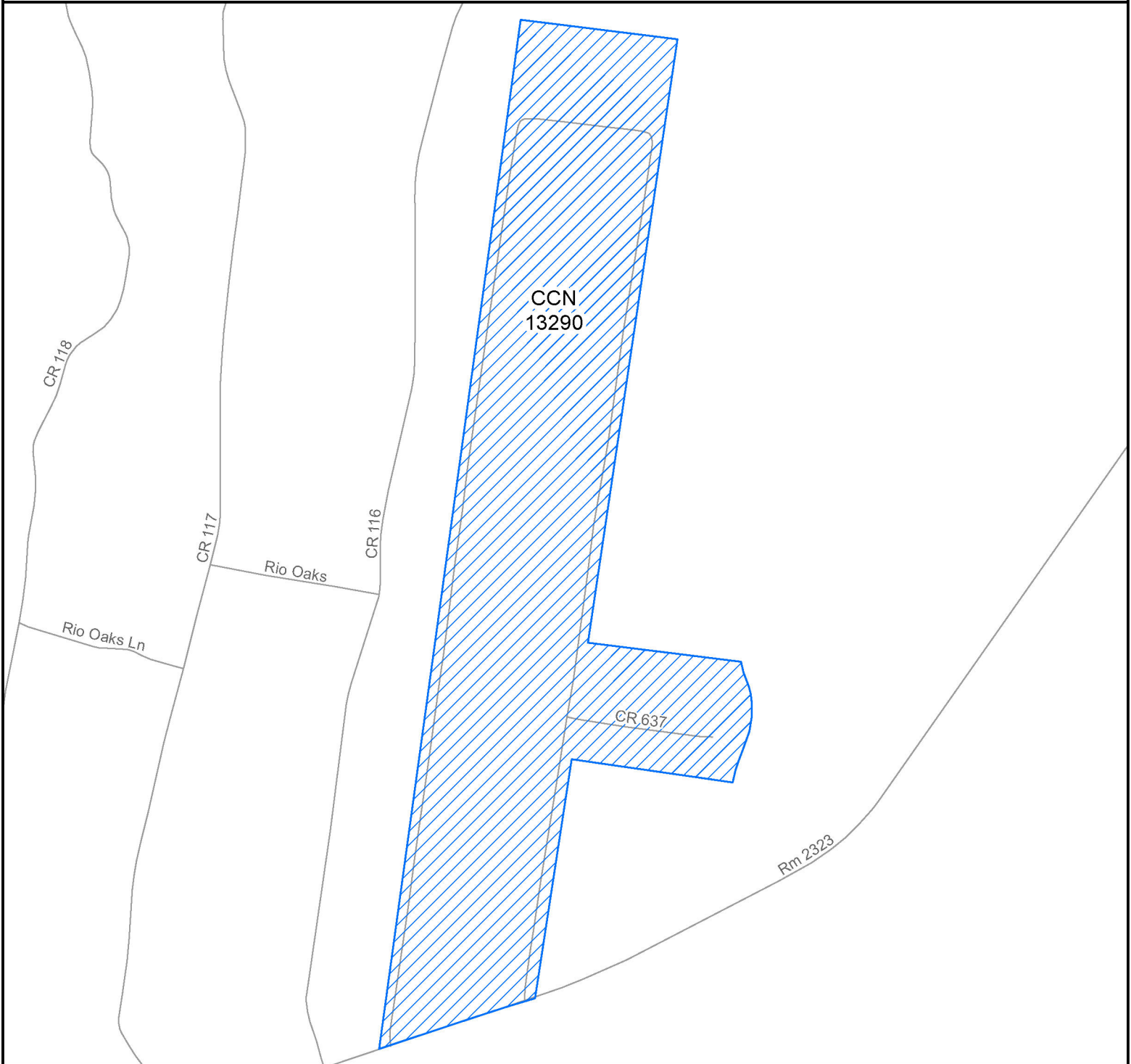

**Water CCN**



13290 - CSWR-Texas Utility Operating Company LLC

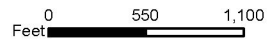



# **Public Utility Commission of Texas**

**By These Presents Be It Known To All That**

## **CSWR-Texas Utility Operating Company, LLC**

having obtained certification to provide water utility service for the convenience and necessity of the public, and it having been determined by this Commission that the public convenience and necessity would in fact be advanced by the provision of such service, CSWR-Texas Utility Operating Company, LLC is entitled to this

### **Certificate of Convenience and Necessity No. 13290**

to provide continuous and adequate water utility service to that service area or those service areas in Aransas, Austin, Burleson, Burnet, Guadalupe, Harris, Hays, Hidalgo, Hood, Llano, Lubbock, McCulloch, Navarro, Parker, Victoria, Wilson, and Wood Counties as by final Order or Orders duly entered by this Commission, which Order or Orders resulting from Docket No. 51981 are on file at the Commission offices in Austin, Texas; and are matters of official record available for public inspection; and be it known further that these presents do evidence the authority and the duty of the CSWR-Texas Utility Operating Company, LLC to provide such utility service in accordance with the laws of this State and Rules of this Commission, subject only to any power and responsibility of this Commission to revoke or amend this Certificate in whole or in part upon a subsequent showing that the public convenience and necessity would be better served thereby.



**WATER UTILITY TARIFF**  
**Docket Number: 51981**

CSWR – Texas Utility Operating Company, LLC  
(Utility Name)

1650 Des Peres Rd Suite 303  
(Business Address)

St. Louis, MO 63131  
(City, State, Zip Code)

(866) 301-7725  
(Area Code/Telephone)

This tariff is effective for utility operations under the following Certificate of Convenience and Necessity:

13290

This tariff is effective in the following counties:

Aransas, Austin, Burleson, Burnet, Guadalupe, Harris, Hidalgo, Hood, Llano, McCulloch, Parker, Victoria and Wilson

This tariff is effective in the following cities or unincorporated towns (if any):

None

This tariff is effective in the following subdivisions or public water systems:

See List

**TABLE OF CONTENTS**

The above utility lists the following sections of its tariff (if additional pages are needed for a section, all pages should be numbered consecutively):

SECTION 1.0 -- RATE SCHEDULE.....	2
SECTION 2.0 -- SERVICE RULES AND REGULATIONS .....	18
SECTION 3.0 -- EXTENSION POLICY .....	25
APPENDIX A -- DROUGHT CONTINGENCY PLAN	
APPENDIX B -- SAMPLE SERVICE AGREEMENT	



**LIST OF SUBDIVISIONS AND SYSTEMS**

SUBDIVISION	PWS	COUNTY
Arrowhead Water System	2470025	Wilson
Coletto Water Company,	2350036	Victoria
Copano Heights Unit 1 & 2, Water System	0040017	Aransas
Council Creek Village	0270014	Burnet
Flag Creek Ranch	1500112	Llano
Hickory Hill Water	2470018	Victoria
Hillside Estates Water System	0080049	Austin
Hilltop Home Addition	1840034	Parker
Hilltop Park	1840034	Parker
Laguna Vista	1110095	Hood
Laguna Tres	1110019	Hood
Live Oak Hills	1540012	Llano
Meadowview Estates	0080051	Austin
Meadowview Estates II	0080059	Austin
North Victoria Utilities	2350049	Victoria
Oak Hollow Estates, Oak Hollow Park	2470019	Wilson
Quiet Village II Subdivision, Quiet Village II	1080221	Hidalgo
Settlers Crossing Water System	0080058	Austin
Settlers Crossing Water System 2	0080060	Austin
Settlers Estates Sec II	0080056	Austin
Settlers Meadows Water System	0080055	Austin
Shady Oaks Subdivision	2350036	Victoria
Shady Oaks Water Company	2470017	Wilson
South Council Creek 1	0270079	Burnet
South Council Creek 2	0270080	Burnet
South Silver Creek I, II, III	0270041	Burnet

Tall Pines Utility	1010220	Harris
Treetops Phase 1	1840134	Parker

SECTION 1.0 -- RATE SCHEDULE

Section 1.01 - Rates

<u>Meter Size</u>	<u>Monthly Minimum Charge</u>	<u>Gallonge Charge</u>
5/8" or 3/4"	<u>\$28.00</u> (Includes 0 gallons)	<u>\$3.00</u> per 1000 gallons thereafter

FORM OF PAYMENT: The utility will accept the following forms of payment:

Cash  Check  Money Order Credit Card \_\_\_\_\_ Other (specify \_\_\_\_\_)

THE UTILITY MAY REQUIRE EXACT CHANGE FOR PAYMENTS AND MAY REFUSE TO ACCEPT PAYMENTS MADE USING MORE THAN \$1.00 IN SMALL COINS. A WRITTEN RECEIPT WILL BE GIVEN FOR CASH PAYMENTS.

REGULATORY ASSESSMENT..... 1.0%

PUC RULES REQUIRE THE UTILITY TO COLLECT A FEE OF ONE PERCENT OF THE RETAIL MONTHLY BILL AND TO REMIT THE FEE TO THE TCEQ.

Section 1.02 - Miscellaneous Fees

TAP FEE..... \$350.00

TAP FEE COVERS THE UTILITY'S COSTS FOR MATERIALS AND LABOR TO INSTALL A STANDARD RESIDENTIAL 5/8" or 3/4" METER. AN ADDITIONAL FEE TO COVER UNIQUE COSTS IS PERMITTED IF LISTED

TAP FEE (Unique costs) ..... Actual Cost

FOR EXAMPLE, A ROAD BORE FOR CUSTOMERS OUTSIDE OF SUBDIVISIONS OR RESIDENTIAL AREAS. ON THIS TARIFF.

TAP FEE (Large meter) ..... Actual Cost

TAP FEE IS THE UTILITY'S ACTUAL COST FOR MATERIALS AND LABOR FOR METER SIZE INSTALLED.

METER RELOCATION FEE ..... Actual Cost to Relocate Meter, Not to Exceed Tap Fee

THIS FEE MAY BE CHARGED IF A CUSTOMER REQUESTS THAT AN EXISTING METER BE RELOCATED.

METER TEST FEE ..... \$25.00

THIS FEE WHICH SHOULD REFLECT THE UTILITY'S COST MAY BE CHARGED IF A CUSTOMER REQUESTS A SECOND METER TEST WITHIN A TWO-YEAR PERIOD AND THE TEST INDICATES THAT THE METER IS RECORDING ACCURATELY. THE FEE MAY NOT EXCEED \$25.

SECTION 1.0 - RATE SCHEDULE (CONTINUED)

RECONNECTION FEE

THE RECONNECT FEE MUST BE PAID BEFORE SERVICE CAN BE RESTORED TO A CUSTOMER WHO HAS BEEN DISCONNECTED FOR THE FOLLOWING REASONS (OR OTHER REASONS LISTED UNDER SECTION 2.0 OF THIS TARIFF):

- a) Nonpayment of bill (Maximum \$25.00).....\$25.00
- b) Customer's request that service be disconnected .....\$25.00

TRANSFER FEE .....\$10.00

THE TRANSFER FEE WILL BE CHARGED FOR CHANGING AN ACCOUNT NAME AT THE SAME SERVICE LOCATION WHEN THE SERVICE IS NOT DISCONNECTED

LATE CHARGE (EITHER \$5.00 OR 10% OF THE BILL) ..... 10%

A ONE-TIME PENALTY MAY BE MADE ON DELINQUENT BILLS BUT MAY NOT BE APPLIED TO ANY BALANCE TO WHICH THE PENALTY WAS APPLIED IN A PREVIOUS BILLING.

RETURNED CHECK CHARGE .....\$35.00

RETURNED CHECK CHARGES MUST BE BASED ON THE UTILITY'S DOCUMENTABLE COST.

CUSTOMER DEPOSIT RESIDENTIAL (Maximum \$50).....\$50.00

COMMERCIAL & NON-RESIDENTIAL DEPOSIT .....1/6TH OF ESTIMATED ANNUAL BILL

GOVERNMENTAL TESTING, INSPECTION AND COSTS SURCHARGE

WHEN AUTHORIZED IN WRITING BY PUC AND AFTER NOTICE TO CUSTOMERS, THE UTILITY MAY INCREASE RATES TO RECOVER INCREASED COSTS FOR INSPECTION FEES AND WATER TESTING. [16 TAC § 24.25(b)(2)(G)]

LINE EXTENSION AND CONSTRUCTION CHARGES:

REFER TO SECTION 3.0--EXTENSION POLICY FOR TERMS, CONDITIONS, AND CHARGES WHEN NEW CONSTRUCTION IS NECESSARY TO PROVIDE SERVICE.

SECTION 1.0 -- RATE SCHEDULE

Section 1.01 - Rates

<u>Meter Size</u>	<u>Monthly Minimum Charge</u>	<u>Gallonage Charge</u>
5/8"	<u>\$44.81</u> (Includes 1,000 gallons)	<u>\$2.88</u> per 1000 gallons

FORM OF PAYMENT: The utility will accept the following forms of payment:

Cash , Check , Money Order , Credit Card , Other (specify)   
THE UTILITY MAY REQUIRE EXACT CHANGE FOR PAYMENTS AND MAY REFUSE TO ACCEPT PAYMENTS MADE USING MORE THAN \$1.00 IN SMALL COINS. A WRITTEN RECEIPT WILL BE GIVEN FOR CASH PAYMENTS.

REGULATORY ASSESSMENT..... 1.0%  
PUC RULES REQUIRE THE UTILITY TO COLLECT A FEE OF ONE PERCENT OF THE RETAIL MONTHLY BILL AND TO REMIT FEE TO THE TCEQ.

Section 1.02 - Miscellaneous Fees

TAP FEE..... \$600.00  
TAP FEE COVERS THE UTILITY'S COSTS FOR MATERIALS AND LABOR TO INSTALL A STANDARD RESIDENTIAL 5/8" or 3/4" METER. AN ADDITIONAL FEE TO COVER UNIQUE COSTS IS PERMITTED IF LISTED ON THIS TARIFF.

TAP FEE (Unique costs) ..... Actual Cost  
FOR EXAMPLE, A ROAD BORE FOR CUSTOMERS OUTSIDE OF SUBDIVISIONS OR RESIDENTIAL AREAS.

TAP FEE (Large meter) ..... Actual Cost  
TAP FEE IS THE UTILITY'S ACTUAL COST FOR MATERIALS AND LABOR FOR METER SIZE INSTALLED.

METER RELOCATION FEE ..... Actual Relocation Cost, Not to Exceed Tap Fee  
THIS FEE MAY BE CHARGED IF A CUSTOMER REQUESTS THAT AN EXISTING METER BE RELOCATED.

METER TEST FEE ..... \$25.00  
THIS FEE WHICH SHOULD REFLECT THE UTILITY'S COST MAY BE CHARGED IF A CUSTOMER REQUESTS A SECOND METER TEST WITHIN A TWO-YEAR PERIOD AND THE TEST INDICATES THAT THE METER IS RECORDING ACCURATELY. THE FEE MAY NOT EXCEED \$25.

SECTION 1.0 – RATE SCHEDULE (Continued)

RECONNECTION FEE

THE RECONNECT FEE MUST BE PAID BEFORE SERVICE CAN BE RESTORED TO A CUSTOMER WHO HAS BEEN DISCONNECTED FOR THE FOLLOWING REASONS (OR OTHER REASONS LISTED UNDER SECTION 2.0 OF THIS TARIFF):

- a) Nonpayment of bill (Maximum \$25.00).....\$25.00
- b) Customer’s request that service be disconnected.....\$45.00

TRANSFER FEE.....\$25.00

THE TRANSFER FEE WILL BE CHARGED FOR CHANGING AN ACCOUNT NAME AT THE SAME SERVICE LOCATION WHEN THE SERVICE IS NOT DISCONNECTED

LATE CHARGE (EITHER \$5.00 OR 10% OF THE BILL) .....\$5.00

A ONE-TIME PENALTY MAY BE MADE ON DELINQUENT BILLS BUT MAY NOT BE APPLIED TO ANY BALANCE TO WHICH THE PENALTY WAS APPLIED IN A PREVIOUS BILLING.

RETURNED CHECK CHARGE .....\$28.00

RETURNED CHECK CHARGES MUST BE BASED ON THE UTILITY’S DOCUMENTABLE COST.

CUSTOMER DEPOSIT RESIDENTIAL (Maximum \$50).....\$50.00

COMMERCIAL & NON-RESIDENTIAL DEPOSIT ..... 1/6TH OF ESTIMATED ANNUAL BILL

GOVERNMENTAL TESTING, INSPECTION AND COSTS SURCHARGE:

WHEN AUTHORIZED IN WRITING BY PUC AND AFTER NOTICE TO CUSTOMERS, THE UTILITY MAY INCREASE RATES TO RECOVER INCREASED COSTS FOR INSPECTION FEES AND WATER TESTING. [16 TAC § 24.25(b)(2)(G)]

LINE EXTENSION AND CONSTRUCTION CHARGES:

REFER TO SECTION 3.0--EXTENSION POLICY FOR TERMS, CONDITIONS, AND CHARGES WHEN NEW CONSTRUCTION IS NECESSARY TO PROVIDE SERVICE.

SECTION 1.0 -- RATE SCHEDULE

Section 1.01 - Rates

<u>Meter Size:</u>	<u>Monthly Minimum Charge</u>	<u>Gallonage Charge</u>
5/8" or 3/4"	\$31.91 (including 0 gallons)	\$6.60* per 1,000 gallons
3/4"	\$47.87	
1"	\$79.78	
1½"	\$159.55	
2"	\$255.28	
3"	\$478.65	
4"	\$797.75	

\*The above gallonage rate includes an increase of \$0.19 from \$6.41 to \$6.60 per 1,000 gallons for purchased water from the City of Rockport, adjusted for 9.22% water loss. **(Tariff Control No. 50483)**

FORM OF PAYMENT: The utility will accept the following forms of payment:

Cash , Check , Money Order , Credit Card , Other (specify) \_\_\_\_\_  
 THE UTILITY MAY REQUIRE EXACT CHANGE FOR PAYMENTS AND MAY REFUSE TO ACCEPT PAYMENTS MADE USING MORE THAN \$1.00 IN SMALL COINS. A WRITTEN RECEIPT WILL BE GIVEN FOR CASH PAYMENTS.

REGULATORY ASSESSMENT..... 1.0%  
 PUC RULES REQUIRE THE UTILITY TO COLLECT A FEE OF ONE PERCENT OF THE RETAIL MONTHLY BILL AND TO REMIT THE FEE TO THE TCEQ.

Section 1.02 - Miscellaneous Fee

TAP FEE..... \$950.00  
 TAP FEE COVERS THE UTILITY'S COSTS FOR MATERIALS AND LABOR TO INSTALL A STANDARD RESIDENTIAL 5/8" or 3/4" METER. AN ADDITIONAL FEE TO COVER UNIQUE COSTS IS PERMITTED IF LISTED ON THIS TARIFF.

TAP FEE (Unique Costs)..... Actual Cost  
 FOR EXAMPLE, A ROAD BORE FOR CUSTOMERS OUTSIDE OF SUBDIVISIONS OR RESIDENTIAL AREAS.

TAP FEE (Large Meter) ..... Actual Cost  
 TAP FEE COVERS THE UTILITY'S COSTS FOR MATERIALS AND LABOR FOR THE METER INSTALLED.

METER RELOCATION FEE ..... Actual Cost, not to exceed Tap Fee  
 THIS FEE MAY BE CHARGED IF A CUSTOMER REQUESTS THAT AN EXISTING METER BE RELOCATED.

METER TEST FEE ..... \$25.00  
 THIS FEE MAY BE CHARGED IF A CUSTOMER REQUESTS THAT AN EXISTING METER BE RELOCATED.

SECTION 1.0 -- RATE SCHEDULE (Continued)

RECONNECTION FEE ..... \$25.00

THE RECONNECTION FEE MUST BE PAID BEFORE SERVICE CAN BE RESTORED TO A CUSTOMER WHO HAS BEEN DISCONNECTED FOR THE FOLLOWING REASONS (OR OTHER REASONS LISTED UNDER SECTION 2.0 OF THIS TARIFF).

a) Nonpayment of bill (Maximum \$25)..... \$25.00

b) Customer’s request that service be disconnected..... \$25.00

TRANSFER FEE ..... \$25.00

THE TRANSFER FEE WILL BE CHARGED FOR CHANGING AN ACCOUNT NAME AT THE SAME SERVICE LOCATION WHEN THE SERVICE IS NOT DISCONNECTED.

LATE CHARGE (EITHER \$5.00 OR 10% OF THE BILL) ..... \$5.00

A ONE-TIME PENALTY MAY BE MADE ON DELINQUENT BILLS BUT MAY NOT BE APPLIED TO ANY BALANCE TO WHICH THE PENALTY WAS APPLIED IN A PREVIOUS BILLING.

RETURNED CHECK CHARGE ..... \$25.00

RETURNED CHECK CHARGES MUST BE BASED ON THE UTILITY’S DOCUMENTABLE COST.

CUSTOMER DEPOSIT RETURNED CHECK CHARGE ..... \$25.00

COMMERCIAL & NON-RESIDENTIAL DEPOSIT ..... 1/6 OF ESTIMATED ANNUAL BILL

GOVERNMENTAL TESTING, INSPECTION AND COSTS SURCHARGE:

WHEN AUTHORIZED IN WRITING BY PUC AND AFTER NOTICE TO CUSTOMERS, THE UTILITY MAY INCREASE RATES TO RECOVER INCREASED COSTS FOR INSPECTION FEES AND WATER TESTING. [16 TAC § 24.25(b)(2)(G)]

LINE EXTENSION AND CONSTRUCTION CHARGES:

REFER TO SECTION 3.0--EXTENSION POLICY FOR TERMS, CONDITIONS, AND CHARGES WHEN NEW CONSTRUCTION IS NECESSARY TO PROVIDE SERVICE.

PURCHASED WATER AND/OR DISTRICT FEE PASS THROUGH CLAUSE:

Changes in fees imposed by any non-affiliated third-party water supplier or underground water district having jurisdiction over the Utility shall be passed through as an adjustment to the water gallonage charge according to the following formula:

$R = G / (1 - L)$ , where

R = the proposed pass-through rate;

G = the new gallonage charge (per 1,000 gallons) by source supplier;

L = the actual line loss for the preceding 12 months.



**Treetops Phase 1**  
**(Formerly Treetops Utilities, Inc.)**

(Utility Name)

SECTION 1.0 -- RATE SCHEDULE

Section 1.01 - Rates

<u>Meter Size:</u>	<u>Monthly Minimum Charge</u>	<u>Gallonage Charge</u>
5/8" or 3/4"	\$22.00 (including 2,000 gallons)	\$2.15 per 1,000 gallons

FORM OF PAYMENT: The utility will accept the following forms of payment:

Cash , Check , Money Order , Credit Card , Other (specify)

THE UTILITY MAY REQUIRE EXACT CHANGE FOR PAYMENTS AND MAY REFUSE TO ACCEPT PAYMENTS MADE USING MORE THAN \$1.00 IN SMALL COINS. A WRITTEN RECEIPT WILL BE GIVEN FOR CASH PAYMENTS.

REGULATORY ASSESSMENT ..... 1.0%

PUC RULES REQUIRE THE UTILITY TO COLLECT A FEE OF ONE PERCENT OF THE RETAIL MONTHLY BILL AND TO REMIT THE FEE TO THE TCEQ.

Section 1.02 - Miscellaneous Fee

TAP FEE ..... \$500.00

TAP FEE COVERS THE UTILITY'S COSTS FOR MATERIALS AND LABOR TO INSTALL A STANDARD RESIDENTIAL 5/8" or 3/4" METER. AN ADDITIONAL FEE TO COVER UNIQUE COSTS IS PERMITTED IF LISTED ON THIS TARIFF.

METER TEST FEE ..... \$25.00

THIS FEE MAY BE CHARGED IF A CUSTOMER REQUESTS THAT AN EXISTING METER BE RELOCATED.

**Treetops Phase 1**  
**(Formerly Treetops Utilities, Inc.)**  
(Utility Name)

**SECTION 1.0 -- RATE SCHEDULE (Continued)**

**RECONNECTION FEE** ..... \$25.00

THE RECONNECTION FEE MUST BE PAID BEFORE SERVICE CAN BE RESTORED TO A CUSTOMER WHO HAS BEEN DISCONNECTED FOR THE FOLLOWING REASONS (OR OTHER REASONS LISTED UNDER SECTION 2.0 OF THIS TARIFF).

c) Nonpayment of bill (Maximum \$25)..... \$25.00

d) Customer’s request that service be disconnected..... \$25.00

**TRANSFER FEE** ..... \$25.00

THE TRANSFER FEE WILL BE CHARGED FOR CHANGING AN ACCOUNT NAME AT THE SAME SERVICE LOCATION WHEN THE SERVICE IS NOT DISCONNECTED.

**LATE CHARGE (EITHER \$5.00 OR 10% OF THE BILL)** ..... \$5.00

A ONE-TIME PENALTY MAY BE MADE ON DELINQUENT BILLS BUT MAY NOT BE APPLIED TO ANY BALANCE TO WHICH THE PENALTY WAS APPLIED IN A PREVIOUS BILLING.

**RETURNED CHECK CHARGE** ..... \$25.00

RETURNED CHECK CHARGES MUST BE BASED ON THE UTILITY’S DOCUMENTABLE COST.

**CUSTOMER DEPOSIT RETURNED CHECK CHARGE** ..... \$25.00

**COMMERCIAL & NON-RESIDENTIAL DEPOSIT** ..... 1/6 OF ESTIMATED ANNUAL BILL

**GOVERNMENTAL TESTING, INSPECTION AND COSTS SURCHARGE:**

WHEN AUTHORIZED IN WRITING BY PUC AND AFTER NOTICE TO CUSTOMERS, THE UTILITY MAY INCREASE RATES TO RECOVER INCREASED COSTS FOR INSPECTION FEES AND WATER TESTING. [16 TAC § 24.25(b)(2)(G)]

**LINE EXTENSION AND CONSTRUCTION CHARGES:**

REFER TO SECTION 3.0--EXTENSION POLICY FOR TERMS, CONDITIONS, AND CHARGES WHEN NEW CONSTRUCTION IS NECESSARY TO PROVIDE SERVICE.

SECTION 1.0 -- RATE SCHEDULE

Section 1.01 - Rates

<u>Meter Size</u>	<u>Monthly Minimum Charge</u>	<u>Gallonage Charge</u>
5/8" or 3/4"	<u>\$28.97</u> (Includes 1000 gallons)	<u>\$2.00</u> per 1000 gallons thereafter
1"	<u>\$72.42</u>	
1½"	<u>\$144.85</u>	
2"	<u>\$231.76</u>	
3"	<u>\$434.55</u>	
4"	<u>\$660.51</u>	

FORM OF PAYMENT: The utility will accept the following forms of payment:

Cash , Check , Money Order , Credit Card , Other (specify)   
 THE UTILITY MAY REQUIRE EXACT CHANGE FOR PAYMENTS AND MAY REFUSE TO ACCEPT PAYMENTS MADE USING MORE THAN \$1.00 IN SMALL COINS. A WRITTEN RECEIPT WILL BE GIVEN FOR CASH PAYMENTS.

REGULATORY ASSESSMENT ..... 1.0%  
 PUC RULES REQUIRE THE UTILITY TO COLLECT A FEE OF ONE PERCENT OF THE RETAIL MONTHLY BILL AND TO REMIT THE FEE TO THE TCEQ.

Section 1.02 - Miscellaneous Fees

TAP FEE ..... \$450.00  
 TAP FEE COVERS THE UTILITY'S COSTS FOR MATERIALS AND LABOR TO INSTALL A STANDARD RESIDENTIAL 5/8" or 3/4" METER. AN ADDITIONAL FEE TO COVER UNIQUE COSTS IS PERMITTED IF LISTED ON THIS TARIFF.

TAP FEE (Unique costs) ..... Actual Cost  
 FOR EXAMPLE, A ROAD BORE FOR CUSTOMERS OUTSIDE OF SUBDIVISIONS OR RESIDENTIAL AREAS.

TAP FEE (Large meter) ..... Actual Cost  
 TAP FEE IS THE UTILITY'S ACTUAL COST FOR MATERIALS AND LABOR FOR METER SIZE INSTALLED.

METER RELOCATION FEE ..... Actual Relocation Cost, Not to Exceed Tap Fee  
 THIS FEE MAY BE CHARGED IF A CUSTOMER REQUESTS THAT AN EXISTING METER BE RELOCATED.

METER TEST FEE ..... \$25.00  
 THIS FEE WHICH SHOULD REFLECT THE UTILITY'S COST MAY BE CHARGED IF A CUSTOMER REQUESTS A SECOND METER TEST WITHIN A TWO-YEAR PERIOD AND THE TEST INDICATES THAT THE METER IS RECORDING ACCURATELY. THE FEE MAY NOT EXCEED \$25.

**SECTION 1.0 -- RATE SCHEDULE (Continued)**

**RECONNECTION FEE**

THE RECONNECT FEE MUST BE PAID BEFORE SERVICE CAN BE RESTORED TO A CUSTOMER WHO HAS BEEN DISCONNECTED FOR THE FOLLOWING REASONS (OR OTHER REASONS LISTED UNDER SECTION 2.0 OF THIS TARIFF):

- a) Nonpayment of bill (Maximum \$25.00)..... \$25.00
- b) Customer's request that service be disconnected ..... \$35.00

**TRANSFER FEE ..... \$25.00**

THE TRANSFER FEE WILL BE CHARGED FOR CHANGING AN ACCOUNT NAME AT THE SAME SERVICE LOCATION WHEN THE SERVICE IS NOT DISCONNECTED.

**LATE CHARGE (EITHER \$5.00 OR 10% OF THE BILL) ..... \$5.00**

A ONE-TIME PENALTY MAY BE MADE ON DELINQUENT BILLS BUT MAY NOT BE APPLIED TO ANY BALANCE TO WHICH THE PENALTY WAS APPLIED IN A PREVIOUS BILLING.

**RETURNED CHECK CHARGE ..... \$20.00**

RETURNED CHECK CHARGES MUST BE BASED ON THE UTILITY'S DOCUMENTABLE COST.

**CUSTOMER DEPOSIT RESIDENTIAL (Maximum \$50)..... \$50.00**

**COMMERCIAL & NON-RESIDENTIAL DEPOSIT ..... 1/6TH OF ESTIMATED ANNUAL BILL**

**GOVERNMENTAL TESTING, INSPECTION AND COSTS SURCHARGE:**

WHEN AUTHORIZED IN WRITING BY PUC AND AFTER NOTICE TO CUSTOMERS, THE UTILITY MAY INCREASE RATES TO RECOVER INCREASED COSTS FOR INSPECTION FEES AND WATER TESTING. [16 TAC § 24.25(b)(2)(G)]

**LINE EXTENSION AND CONSTRUCTION CHARGES:**

REFER TO SECTION 3.0--EXTENSION POLICY FOR TERMS, CONDITIONS, AND CHARGES WHEN NEW CONSTRUCTION IS NECESSARY TO PROVIDE SERVICE.

SECTION 1.0 -- RATE SCHEDULE

Section 1.01 - Rates

<u>Meter Size</u>	<u>Monthly Minimum Charge</u>	<u>Gallonage Charge</u>
5/8" or 3/4"	<u>\$28.00</u> (Includes 0 gallons)	<u>\$2.75</u> per 1,000 gallons from 0 to 5,999 gallons
		<u>\$3.00</u> per 1,000 gallons from 6,000 to 15,999 gallons
		<u>\$3.25</u> per 1,000 gallons from 16,000 to 20,999 gallons
		<u>\$3.50</u> per 1,000 gallons from 21,000 gallons and thereafter

FORM OF PAYMENT: The utility will accept the following forms of payment:

Cash , Check , Money Order , Credit Card , Other (specify)   
 THE UTILITY MAY REQUIRE EXACT CHANGE FOR PAYMENTS AND MAY REFUSE TO ACCEPT PAYMENTS MADE USING MORE THAN \$1.00 IN SMALL COINS. A WRITTEN RECEIPT WILL BE GIVEN FOR CASH PAYMENTS.

REGULATORY ASSESSMENT ..... 1.0%  
 PUC RULES REQUIRE THE UTILITY TO COLLECT A FEE OF ONE PERCENT OF THE RETAIL MONTHLY BILL AND TO REMIT THE FEE TO THE TCEQ.

Section 1.02 - Miscellaneous Fees

TAP FEE ..... \$400.00  
 TAP FEE COVERS THE UTILITY'S COSTS FOR MATERIALS AND LABOR TO INSTALL A STANDARD RESIDENTIAL 5/8" or 3/4" METER. AN ADDITIONAL FEE TO COVER UNIQUE COSTS IS PERMITTED IF LISTED ON THIS TARIFF.

TAP FEE (Unique costs) ..... Actual Cost  
 FOR EXAMPLE, A ROAD BORE FOR CUSTOMERS OUTSIDE OF SUBDIVISIONS OR RESIDENTIAL AREAS.

TAP FEE (Large meter) ..... Actual Cost  
 TAP FEE IS THE UTILITY'S ACTUAL COST FOR MATERIALS AND LABOR FOR METER SIZE INSTALLED.

METER RELOCATION FEE ..... Actual Relocation Cost, Not to Exceed Tap Fee  
 THIS FEE MAY BE CHARGED IF A CUSTOMER REQUESTS THAT AN EXISTING METER BE RELOCATED.

METER TEST FEE ..... \$25.00  
 THIS FEE WHICH SHOULD REFLECT THE UTILITY'S COST MAY BE CHARGED IF A CUSTOMER REQUESTS A SECOND METER TEST WITHIN A TWO-YEAR PERIOD AND THE TEST INDICATES THAT THE METER IS RECORDING ACCURATELY. THE FEE MAY NOT EXCEED \$25.

SECTION 1.0 -- RATE SCHEDULE (Continued)

RECONNECTION FEE

THE RECONNECT FEE MUST BE PAID BEFORE SERVICE CAN BE RESTORED TO A CUSTOMER WHO HAS BEEN DISCONNECTED FOR THE FOLLOWING REASONS (OR OTHER REASONS LISTED UNDER SECTION 2.0 OF THIS TARIFF):

- a) Nonpayment of bill (Maximum \$25.00).....\$25.00
- b) Customer's request that service be disconnected .....\$35.00

TRANSFER FEE .....\$35.00

THE TRANSFER FEE WILL BE CHARGED FOR CHANGING AN ACCOUNT NAME AT THE SAME SERVICE LOCATION WHEN THE SERVICE IS NOT DISCONNECTED.

LATE CHARGE (EITHER \$5.00 OR 10% OF THE BILL) .....\$5.00

A ONE-TIME PENALTY MAY BE MADE ON DELINQUENT BILLS BUT MAY NOT BE APPLIED TO ANY BALANCE TO WHICH THE PENALTY WAS APPLIED IN A PREVIOUS BILLING.

RETURNED CHECK CHARGE .....\$25.00

RETURNED CHECK CHARGES MUST BE BASED ON THE UTILITY-S DOCUMENTABLE COST.

CUSTOMER DEPOSIT RESIDENTIAL (Maximum \$50).....\$50.00

COMMERCIAL & NON-RESIDENTIAL DEPOSIT ... 1/6TH OF ESTIMATED ANNUAL BILL

GOVERNMENTAL TESTING, INSPECTION AND COSTS SURCHARGE:

WHEN AUTHORIZED IN WRITING BY PUC AND AFTER NOTICE TO CUSTOMERS, THE UTILITY MAY INCREASE RATES TO RECOVER INCREASED COSTS FOR INSPECTION FEES AND WATER TESTING. [16 TAC § 24.25(b)(2)(G)]

LINE EXTENSION AND CONSTRUCTION CHARGES:

REFER TO SECTION 3.0--EXTENSION POLICY FOR TERMS, CONDITIONS, AND CHARGES WHEN NEW CONSTRUCTION IS NECESSARY TO PROVIDE SERVICE.

**Tall Pines Utility**

**(Formerly K & L Utility Service, Inc. dba Tall Pines Utility, Inc.)**

(Utility Name)

**SECTION 1.0 -- RATE SCHEDULE**

**Section 1.01 - Rates**

<u>Meter Size</u>	<u>Monthly Minimum Charge</u>	<u>Gallonage Charge</u>
5/8" or 3/4"	\$48.61 (Includes 0 gallons)	\$1.69 per 1000 gallons
1"	\$121.53	

North Harris County Regional Water Authority Fee ..... \$1.75 (per 1,000 gallons)

FORM OF PAYMENT: The utility will accept the following forms of payment:

Cash , Check , Money Order , Credit Card , Other (specify) \_\_\_\_\_  
 THE UTILITY MAY REQUIRE EXACT CHANGE FOR PAYMENTS AND MAY REFUSE TO ACCEPT PAYMENTS MADE USING MORE THAN \$1.00 IN SMALL COINS. A WRITTEN RECEIPT WILL BE GIVEN FOR CASH PAYMENTS.

REGULATORY ASSESSMENT ..... 1.0%  
 PUC RULES REQUIRE THE UTILITY TO COLLECT A FEE OF ONE PERCENT OF THE RETAIL MONTHLY BILL AND TO REMIT THE FEE TO THE TCEQ.

**Section 1.02 - Miscellaneous Fees**

TAP FEE ..... \$350.00  
 TAP FEE COVERS THE UTILITY'S COSTS FOR MATERIALS AND LABOR TO INSTALL A STANDARD RESIDENTIAL 5/8" or 3/4" METER. AN ADDITIONAL FEE TO COVER UNIQUE COSTS IS PERMITTED IF LISTED ON THIS TARIFF.

TAP FEE (Unique costs) ..... Actual Cost  
 FOR EXAMPLE, A ROAD BORE FOR CUSTOMERS OUTSIDE OF SUBDIVISIONS OR RESIDENTIAL AREAS.

TAP FEE (Large meter) ..... Actual Cost  
 TAP FEE IS THE UTILITY'S ACTUAL COST FOR MATERIALS AND LABOR FOR METER SIZE INSTALLED.

METER RELOCATION FEE ..... Actual Relocation Cost, Not to Exceed Tap Fee  
 THIS FEE MAY BE CHARGED IF A CUSTOMER REQUESTS THAT AN EXISTING METER BE RELOCATED.

METER TEST FEE ..... \$25.00  
 THIS FEE WHICH SHOULD REFLECT THE UTILITY'S COST MAY BE CHARGED IF A CUSTOMER REQUESTS A SECOND METER TEST WITHIN A TWO-YEAR PERIOD AND THE TEST INDICATES THAT THE METER IS RECORDING ACCURATELY. THE FEE MAY NOT EXCEED \$25.

**RECONNECTION FEE**

THE RECONNECT FEE MUST BE PAID BEFORE SERVICE CAN BE RESTORED TO A CUSTOMER WHO HAS BEEN DISCONNECTED FOR THE FOLLOWING REASONS (OR OTHER REASONS LISTED UNDER SECTION 2.0 OF THIS TARIFF):

- a) Non-payment of bill (Maximum \$25.00)..... \$25.00

**Tall Pines Utility**

**(Formerly K & L Utility Service, Inc. dba Tall Pines Utility, Inc.)**

(Utility Name)

SECTION 1.0 -- RATE SCHEDULE (Continued)

b) Customer's request that service be disconnected ..... \$25.00

TRANSFER FEE ..... \$15.00

THE TRANSFER FEE WILL BE CHARGED FOR CHANGING AN ACCOUNT NAME AT THE SAME SERVICE LOCATION WHEN THE SERVICE IS NOT DISCONNECTED.

LATE CHARGE (EITHER \$5.00 OR 10% OF THE BILL) ..... 10%

A ONE-TIME PENALTY MAY BE MADE ON DELINQUENT BILLS BUT MAY NOT BE APPLIED TO ANY BALANCE TO WHICH THE PENALTY WAS APPLIED IN A PREVIOUS BILLING.

RETURNED CHECK CHARGE ..... \$30.00

RETURNED CHECK CHARGES MUST BE BASED ON THE UTILITY'S DOCUMENTABLE COST.

CUSTOMER DEPOSIT RESIDENTIAL (Maximum \$50) ..... \$50.00

COMMERCIAL & NON-RESIDENTIAL DEPOSIT ... 1/6TH OF ESTIMATED ANNUAL BILL

**GOVERNMENTAL TESTING, INSPECTION AND COSTS SURCHARGE:**

WHEN AUTHORIZED IN WRITING BY PUC AND AFTER NOTICE TO CUSTOMERS, THE UTILITY MAY INCREASE RATES TO RECOVER INCREASED COSTS FOR INSPECTION FEES AND WATER TESTING. [16 TAC § 24.25(b)(2)(G)]

**LINE EXTENSION AND CONSTRUCTION CHARGES:**

REFER TO SECTION 3.0--EXTENSION POLICY FOR TERMS, CONDITIONS, AND CHARGES WHEN NEW CONSTRUCTION IS NECESSARY TO PROVIDE SERVICE.

**Pass Through Provision:**

For Utilities subject to changes in costs imposed by any non-affiliated provider of purchased water or sewer or a groundwater conservation district having jurisdiction over the Utility, these increases (decreases) shall be passed through as an adjustment to the gallonage charge according to the formula:

$AG = G + B/(1-L)$ , Where:

AG = adjusted gallonage charge, rounded to nearest one cent

G = approved gallonage charge, per 1,000 gallons

B = changed in fee (per 1,000 gallons)

L = water or sewer line loss for preceding 12 months, not to exceed 0.15 (15%)



SECTION 1.0 -- RATE SCHEDULE

Section 1.01 - Rates

<u>Meter Size</u>	<u>Monthly Minimum Charge</u>	<u>Gallonage Charge</u>
5/8" or 3/4"	<u>\$70.00</u> (Includes 0 gallons)	<u>\$4.00</u> per 1,000 gallons, 1 <sup>st</sup> 4,000 gallons <u>\$6.00</u> per 1,000 gallons, 4,001 gallons and thereafter

FORM OF PAYMENT: The utility will accept the following forms of payment:

Cash X, Check X, Money Order X, Credit Card    , Other (specify)      
THE UTILITY MAY REQUIRE EXACT CHANGE FOR PAYMENTS AND MAY REFUSE TO ACCEPT PAYMENTS MADE USING MORE THAN \$1.00 IN SMALL COINS. A WRITTEN RECEIPT WILL BE GIVEN FOR CASH PAYMENTS.

REGULATORY ASSESSMENT ..... 1.0%  
PUC RULES REQUIRE THE UTILITY TO COLLECT A FEE OF ONE PERCENT OF THE RETAIL MONTHLY BILL AND TO REMIT THE FEE TO THE TCEQ.

Section 1.02 - Miscellaneous Fees

TAP FEE ..... \$650.00  
TAP FEE COVERS THE UTILITY'S COSTS FOR MATERIALS AND LABOR TO INSTALL A STANDARD RESIDENTIAL 5/8" or 3/4" METER. AN ADDITIONAL FEE TO COVER UNIQUE COSTS IS PERMITTED IF LISTED ON THIS TARIFF.

TAP FEE (Unique costs) ..... Actual Cost  
FOR EXAMPLE, A ROAD BORE FOR CUSTOMERS OUTSIDE OF SUBDIVISIONS OR RESIDENTIAL AREAS.

TAP FEE (Large meter) ..... Actual Cost  
TAP FEE IS THE UTILITY'S ACTUAL COST FOR MATERIALS AND LABOR FOR METER SIZE INSTALLED.

METER RELOCATION FEE ..... Actual Relocation Cost, Not to Exceed Tap Fee  
THIS FEE MAY BE CHARGED IF A CUSTOMER REQUESTS THAT AN EXISTING METER BE RELOCATED.

METER TEST FEE ..... \$25.00  
THIS FEE WHICH SHOULD REFLECT THE UTILITY'S COST MAY BE CHARGED IF A CUSTOMER REQUESTS A SECOND METER TEST WITHIN A TWO-YEAR PERIOD AND THE TEST INDICATES THAT THE METER IS RECORDING ACCURATELY. THE FEE MAY NOT EXCEED \$25.

**SECTION 1.0 -- RATE SCHEDULE (Continued)**

**RECONNECTION FEE**

THE RECONNECT FEE MUST BE PAID BEFORE SERVICE CAN BE RESTORED TO A CUSTOMER WHO HAS BEEN DISCONNECTED FOR THE FOLLOWING REASONS (OR OTHER REASONS LISTED UNDER SECTION 2.0 OF THIS TARIFF):

- a) Nonpayment of bill (Maximum \$25.00) ..... \$25.00
- b) Customer's request that service be disconnected ..... \$50.00

**TRANSFER FEE** ..... \$50.00

THE TRANSFER FEE WILL BE CHARGED FOR CHANGING AN ACCOUNT NAME AT THE SAME SERVICE LOCATION WHEN THE SERVICE IS NOT DISCONNECTED.

**LATE CHARGE** (EITHER \$5.00 OR 10% OF THE BILL) ..... 10%

A ONE-TIME PENALTY MAY BE MADE ON DELINQUENT BILLS BUT MAY NOT BE APPLIED TO ANY BALANCE TO WHICH THE PENALTY WAS APPLIED IN A PREVIOUS BILLING.

**RETURNED CHECK CHARGE** ..... \$25.00

RETURNED CHECK CHARGES MUST BE BASED ON THE UTILITY'S DOCUMENTABLE COST.

**CUSTOMER DEPOSIT RESIDENTIAL (Maximum \$50)** ..... \$50.00

**COMMERCIAL & NON-RESIDENTIAL DEPOSIT** ..... 1/6TH OF ESTIMATED ANNUAL BILL

**GOVERNMENTAL TESTING, INSPECTION AND COSTS SURCHARGE:**

WHEN AUTHORIZED IN WRITING BY PUC AND AFTER NOTICE TO CUSTOMERS, THE UTILITY MAY INCREASE RATES TO RECOVER INCREASED COSTS FOR INSPECTION FEES AND WATER TESTING. [16 TAC § 24.25(b)(2)(G)]

**LINE EXTENSION AND CONSTRUCTION CHARGES:**

REFER TO SECTION 3.0--EXTENSION POLICY FOR TERMS, CONDITIONS, AND CHARGES WHEN NEW CONSTRUCTION IS NECESSARY TO PROVIDE SERVICE.

SECTION 1.0 -- RATE SCHEDULE

Section 1.01 - Rates

<u>Meter Size</u>	<u>Monthly Minimum Charge</u>	<u>Gallonage Charge</u>
-------------------	-------------------------------	-------------------------

Section 1.01 - Rates

<u>Meter Size</u>	<u>Monthly Minimum Charge</u>	<u>Gallonage Charge</u>
5/8" or 3/4"	\$70.00 (Includes 0 gallons)	\$4.00 per 1,000 gallons, 1 <sup>st</sup> 4,000 gallons \$6.00 per 1,000 gallons, 4,001 gallons and thereafter

FORM OF PAYMENT: The utility will accept the following forms of payment:

Cash , Check , Money Order , Credit Card , Other (specify)   
 THE UTILITY MAY REQUIRE EXACT CHANGE FOR PAYMENTS AND MAY REFUSE TO ACCEPT PAYMENTS MADE USING MORE THAN \$1.00 IN SMALL COINS. A WRITTEN RECEIPT WILL BE GIVEN FOR CASH PAYMENTS.

REGULATORY ASSESSMENT ..... 1.0%  
 PUC RULES REQUIRE THE UTILITY TO COLLECT A FEE OF ONE PERCENT OF THE RETAIL MONTHLY BILL AND TO REMIT THE FEE TO THE TCEQ.

Section 1.02 - Miscellaneous Fees

TAP FEE ..... \$650.00  
 TAP FEE COVERS THE UTILITY'S COSTS FOR MATERIALS AND LABOR TO INSTALL A STANDARD RESIDENTIAL 5/8" or 3/4" METER. AN ADDITIONAL FEE TO COVER UNIQUE COSTS IS PERMITTED IF LISTED ON THIS TARIFF.

TAP FEE (Unique costs) ..... Actual Cost  
 FOR EXAMPLE, A ROAD BORE FOR CUSTOMERS OUTSIDE OF SUBDIVISIONS OR RESIDENTIAL AREAS.

TAP FEE (Large meter) ..... Actual Cost  
 TAP FEE IS THE UTILITY'S ACTUAL COST FOR MATERIALS AND LABOR FOR METER SIZE INSTALLED.

METER RELOCATION FEE ..... Actual Relocation Cost, Not to Exceed Tap Fee  
 THIS FEE MAY BE CHARGED IF A CUSTOMER REQUESTS THAT AN EXISTING METER BE RELOCATED.

METER TEST FEE ..... \$25.00  
 THIS FEE WHICH SHOULD REFLECT THE UTILITY'S COST MAY BE CHARGED IF A CUSTOMER REQUESTS A SECOND METER TEST WITHIN A TWO-YEAR PERIOD AND THE TEST INDICATES THAT THE METER IS RECORDING ACCURATELY. THE FEE MAY NOT EXCEED \$25.

SECTION 1.0 -- RATE SCHEDULE (Continued)

**RECONNECTION FEE**

THE RECONNECT FEE MUST BE PAID BEFORE SERVICE CAN BE RESTORED TO A CUSTOMER WHO HAS BEEN DISCONNECTED FOR THE FOLLOWING REASONS (OR OTHER REASONS LISTED UNDER SECTION 2.0 OF THIS TARIFF):

- a) Nonpayment of bill (Maximum \$25.00) ..... \$25.00
- b) Customer's request that service be disconnected ..... \$50.00

**TRANSFER FEE** ..... \$50.00

THE TRANSFER FEE WILL BE CHARGED FOR CHANGING AN ACCOUNT NAME AT THE SAME SERVICE LOCATION WHEN THE SERVICE IS NOT DISCONNECTED.

**LATE CHARGE** (EITHER \$5.00 OR 10% OF THE BILL) ..... 10%

A ONE-TIME PENALTY MAY BE MADE ON DELINQUENT BILLS BUT MAY NOT BE APPLIED TO ANY BALANCE TO WHICH THE PENALTY WAS APPLIED IN A PREVIOUS BILLING.

**RETURNED CHECK CHARGE** ..... \$25.00

RETURNED CHECK CHARGES MUST BE BASED ON THE UTILITY'S DOCUMENTABLE COST.

**CUSTOMER DEPOSIT RESIDENTIAL (Maximum \$50)** ..... \$50.00

**COMMERCIAL & NON-RESIDENTIAL DEPOSIT** ..... 1/6TH OF ESTIMATED ANNUAL BILL

**GOVERNMENTAL TESTING, INSPECTION AND COSTS SURCHARGE:**

WHEN AUTHORIZED IN WRITING BY PUC AND AFTER NOTICE TO CUSTOMERS, THE UTILITY MAY INCREASE RATES TO RECOVER INCREASED COSTS FOR INSPECTION FEES AND WATER TESTING. [16 TAC § 24.25(b)(2)(G)]

**LINE EXTENSION AND CONSTRUCTION CHARGES:**

REFER TO SECTION 3.0--EXTENSION POLICY FOR TERMS, CONDITIONS, AND CHARGES WHEN NEW CONSTRUCTION IS NECESSARY TO PROVIDE SERVICE.

**Hillside Estates Water System, Meadowview Estates, Meadowview Estates II, Settlers Estates Sec II, Settlers Crossing Water System, Settlers Crossing Water System 2, Settlers Meadows Water System**

**(Formerly Ranch Country of Texas, Inc.)**

(Utility Name)

SECTION 1.0 -- RATE SCHEDULE

Section 1.01 - Rates

<u>Meter Size</u>	<u>Monthly Minimum Charge</u>	<u>Gallonage Charge</u>
5/8" or 3/4"	<u>\$25.00</u> (Includes <u>5,000</u> gallons)	<u>\$2.00</u> per 1,000 gallons thereafter

FORM OF PAYMENT: The utility will accept the following forms of payment:

Cash X, Check X, Money Order X, Credit Card     , Other (specify)     

THE UTILITY MAY REQUIRE EXACT CHANGE FOR PAYMENTS AND MAY REFUSE TO ACCEPT PAYMENTS MADE USING MORE THAN \$1.00 IN SMALL COINS. A WRITTEN RECEIPT WILL BE GIVEN FOR CASH PAYMENTS.

REGULATORY ASSESSMENT ..... 1.0%

PUC RULES REQUIRE THE UTILITY TO COLLECT A FEE OF ONE PERCENT OF THE RETAIL MONTHLY BILL AND TO REMIT THE FEE TO THE TCEQ.

Section 1.02 – Miscellaneous Fees

TAP FEE ..... \$500.00

TAP FEE IS BASED ON THE AVERAGE OF THE UTILITY'S ACTUAL COST FOR MATERIALS AND LABOR FOR STANDARD RESIDENTIAL CONNECTION OF 5/8" METER PLUS UNIQUE COSTS AS PERMITTED BY PUC RULE AT COST.

TAP FEE (Unique costs) ..... Actual Cost

FOR EXAMPLE, A ROAD BORE FOR CUSTOMERS OUTSIDE OF SUBDIVISIONS OR RESIDENTIAL AREAS.

TAP FEE (Large Meter) ..... Actual Cost

TAP FEE IS BASED ON THE UTILITY'S ACTUAL COST FOR MATERIALS AND LABOR FOR METERS LARGER THAN STANDARD 5/8" METERS.

METER RELOCATION FEE ..... Actual Relocation Cost, Not to Exceed Tap Fee

THIS FEE MAY BE CHARGED IF A CUSTOMER REQUESTS RELOCATION OF AN EXISTING METER.

METER TEST FEE ..... \$25.00

THIS FEE WHICH SHOULD REFLECT THE UTILITY'S COST MAY BE CHARGED IF A CUSTOMER REQUESTS A SECOND METER TEST WITHIN A TWO-YEAR PERIOD AND THE TEST INDICATES THAT THE METER IS

**Hillside Estates Water System, Meadowview Estates II,  
Settlers Estates Sec II, Settlers Crossing Water System, Settlers Crossing Water System 2,  
Settlers Meadows Water System**

**(Formerly Ranch Country of Texas, Inc.)**

(Utility Name)

SECTION 1.0 -- RATE SCHEDULE (Continued)

RECONNECTION FEE

THE RECONNECT FEE MUST BE PAID BEFORE SERVICE CAN BE RESTORED TO A CUSTOMER WHO HAS BEEN DISCONNECTED FOR THE FOLLOWING REASONS (OR OTHER REASONS LISTED UNDER SECTION 2.0 OF THIS TARIFF):

- a) Nonpayment of bill (Maximum \$25.00).....\$25.00
- b) Customer's request.....\$15.00

TRANSFER FEE .....\$20.00

THE TRANSFER FEE WILL BE CHARGED FOR CHANGING AN ACCOUNT NAME AT THE SAME SERVICE LOCATION WHEN THE SERVICE IS NOT DISCONNECTED.

LATE CHARGE (EITHER \$5.00 OR 10% OF THE BILL) .....\$5.00

A ONE-TIME PENALTY MAY BE MADE ON DELINQUENT BILLS BUT MAY NOT BE APPLIED TO ANY BALANCE TO WHICH THE PENALTY WAS APPLIED IN A PREVIOUS BILLING.

RETURNED CHECK CHARGE .....\$25.00

CUSTOMER DEPOSIT RESIDENTIAL (Maximum \$50).....\$50.00

COMMERCIAL & NON-RESIDENTIAL DEPOSIT ..... 1/6TH OF ESTIMATED ANNUAL BILL

GOVERNMENTAL TESTING, INSPECTION AND COSTS SURCHARGE:

WHEN AUTHORIZED IN WRITING BY PUC AND AFTER NOTICE TO CUSTOMERS, THE UTILITY MAY INCREASE RATES TO RECOVER INCREASED COSTS FOR INSPECTION FEES AND WATER TESTING. [16 TAC § 24.25(b)(2)(G)]

LINE EXTENSION AND CONSTRUCTION CHARGES:

REFER TO SECTION 3.0--EXTENSION POLICY FOR TERMS, CONDITIONS, AND CHARGES WHEN NEW CONSTRUCTION IS NECESSARY TO PROVIDE SERVICE.

SECTION 1.0 -- RATE SCHEDULE

Section 1.01 - Rates

<u>Meter Size</u>	<u>Monthly Minimum Charge</u>	<u>Gallonage Charge</u>
5/8" or 3/4"	\$ <u>29.91</u> (Includes 0 gallons)	\$ <u>2.30</u> per 1,000 gallons thereafter
1"	\$ <u>44.86</u>	
1½"	\$ <u>74.77</u>	
2"	\$ <u>149.55</u>	
3"	\$ <u>239.28</u>	

FORM OF PAYMENT: The utility will accept the following forms of payment:

Cash , Check , Money Order , Credit Card , Other (specify)   
 THE UTILITY MAY REQUIRE EXACT CHANGE FOR PAYMENTS AND MAY REFUSE TO ACCEPT PAYMENTS MADE USING MORE THAN \$1.00 IN SMALL COINS. A WRITTEN RECEIPT WILL BE GIVEN FOR CASH PAYMENTS.

REGULATORY ASSESSMENT ..... 1.0%  
 PUC RULES REQUIRE THE UTILITY TO COLLECT A FEE OF ONE PERCENT OF THE RETAIL MONTHLY BILL AND TO REMIT THE FEE TO THE TCEQ.

Section 1.02 – Miscellaneous Fees

TAP FEE ..... \$500.00  
 TAP FEE IS BASED ON THE AVERAGE OF THE UTILITY'S ACTUAL COST FOR MATERIALS AND LABOR FOR STANDARD RESIDENTIAL CONNECTION OF 5/8" METER PLUS UNIQUE COSTS AS PERMITTED BY PUC RULE AT COST.

TAP FEE (Unique costs) ..... Actual Cost  
 FOR EXAMPLE, A ROAD BORE FOR CUSTOMERS OUTSIDE OF SUBDIVISIONS OR RESIDENTIAL AREAS.

TAP FEE (Large Meter) ..... Actual Cost  
 TAP FEE IS BASED ON THE UTILITY'S ACTUAL COST FOR MATERIALS AND LABOR FOR METERS LARGER THAN STANDARD 5/8" METERS.

METER RELOCATION FEE ..... Actual Relocation Cost, Not to Exceed Tap Fee  
 THIS FEE MAY BE CHARGED IF A CUSTOMER REQUESTS RELOCATION OF AN EXISTING METER.

METER TEST FEE ..... \$25.00  
 THIS FEE WHICH SHOULD REFLECT THE UTILITY'S COST MAY BE CHARGED IF A CUSTOMER REQUESTS A SECOND METER TEST WITHIN A TWO-YEAR PERIOD AND THE TEST INDICATES THAT THE METER IS RECORDING ACCURATELY. THE FEE MAY NOT EXCEED \$25.

SECTION 1.0 -- RATE SCHEDULE (Continued)

RECONNECTION FEE

THE RECONNECT FEE MUST BE PAID BEFORE SERVICE CAN BE RESTORED TO A CUSTOMER WHO HAS BEEN DISCONNECTED FOR THE FOLLOWING REASONS (OR OTHER REASONS LISTED UNDER SECTION 2.0 OF THIS TARIFF):

- a) Nonpayment of bill (Maximum \$25.00).....\$25.00
- b) Customer's request.....\$35.00

TRANSFER FEE.....\$35.00

THE TRANSFER FEE WILL BE CHARGED FOR CHANGING AN ACCOUNT NAME AT THE SAME SERVICE LOCATION WHEN THE SERVICE IS NOT DISCONNECTED.

LATE CHARGE (EITHER \$5.00 OR 10% OF THE BILL) ..... 10%

A ONE-TIME PENALTY MAY BE MADE ON DELINQUENT BILLS BUT MAY NOT BE APPLIED TO ANY BALANCE TO WHICH THE PENALTY WAS APPLIED IN A PREVIOUS BILLING.

RETURNED CHECK CHARGE .....\$15.00

CUSTOMER DEPOSIT RESIDENTIAL (Maximum \$50).....\$50.00

COMMERCIAL & NON-RESIDENTIAL DEPOSIT ..... 1/6TH OF ESTIMATED ANNUAL BILL

GOVERNMENTAL TESTING, INSPECTION AND COSTS SURCHARGE:

WHEN AUTHORIZED IN WRITING BY PUC AND AFTER NOTICE TO CUSTOMERS, THE UTILITY MAY INCREASE RATES TO RECOVER INCREASED COSTS FOR INSPECTION FEES AND WATER TESTING. [16 TAC § 24.25(b)(2)(G)]

LINE EXTENSION AND CONSTRUCTION CHARGES:

REFER TO SECTION 3.0--EXTENSION POLICY FOR TERMS, CONDITIONS, AND CHARGES WHEN NEW CONSTRUCTION IS NECESSARY TO PROVIDE SERVICE.



SECTION 1.0 -- RATE SCHEDULE

Section 1.01 - Rates

<u>Meter Size</u>	<u>Monthly Minimum Charge</u>	<u>Gallonage Charge</u>
5/8" or 3/4"	\$ <u>29.91</u> (Includes 0 gallons)	\$ <u>2.30</u> per 1,000 gallons thereafter
1"	\$ <u>44.86</u>	
1½"	\$ <u>74.77</u>	
2"	\$ <u>149.55</u>	
3"	\$ <u>239.28</u>	

FORM OF PAYMENT: The utility will accept the following forms of payment:

Cash , Check , Money Order , Credit Card , Other (specify)   
 THE UTILITY MAY REQUIRE EXACT CHANGE FOR PAYMENTS AND MAY REFUSE TO ACCEPT PAYMENTS MADE USING MORE THAN \$1.00 IN SMALL COINS. A WRITTEN RECEIPT WILL BE GIVEN FOR CASH PAYMENTS.

REGULATORY ASSESSMENT ..... 1.0%  
 PUC RULES REQUIRE THE UTILITY TO COLLECT A FEE OF ONE PERCENT OF THE RETAIL MONTHLY BILL AND TO REMIT THE FEE TO THE TCEQ.

Section 1.02 – Miscellaneous Fees

TAP FEE ..... \$500.00  
 TAP FEE IS BASED ON THE AVERAGE OF THE UTILITY'S ACTUAL COST FOR MATERIALS AND LABOR FOR STANDARD RESIDENTIAL CONNECTION OF 5/8" METER PLUS UNIQUE COSTS AS PERMITTED BY PUC RULE AT COST.

TAP FEE (Unique costs) ..... Actual Cost  
 FOR EXAMPLE, A ROAD BORE FOR CUSTOMERS OUTSIDE OF SUBDIVISIONS OR RESIDENTIAL AREAS.

TAP FEE (Large Meter) ..... Actual Cost  
 TAP FEE IS BASED ON THE UTILITY'S ACTUAL COST FOR MATERIALS AND LABOR FOR METERS LARGER THAN STANDARD 5/8" METERS.

METER RELOCATION FEE ..... Actual Relocation Cost, Not to Exceed Tap Fee  
 THIS FEE MAY BE CHARGED IF A CUSTOMER REQUESTS RELOCATION OF AN EXISTING METER.

METER TEST FEE ..... \$25.00  
 THIS FEE WHICH SHOULD REFLECT THE UTILITY'S COST MAY BE CHARGED IF A CUSTOMER REQUESTS A SECOND METER TEST WITHIN A TWO-YEAR PERIOD AND THE TEST INDICATES THAT THE METER IS RECORDING ACCURATELY. THE FEE MAY NOT EXCEED \$25.

SECTION 1.0 -- RATE SCHEDULE (Continued)

RECONNECTION FEE

THE RECONNECT FEE MUST BE PAID BEFORE SERVICE CAN BE RESTORED TO A CUSTOMER WHO HAS BEEN DISCONNECTED FOR THE FOLLOWING REASONS (OR OTHER REASONS LISTED UNDER SECTION 2.0 OF THIS TARIFF):

- a) Nonpayment of bill (Maximum \$25.00).....\$25.00
- b) Customer's request.....\$35.00

TRANSFER FEE.....\$35.00

THE TRANSFER FEE WILL BE CHARGED FOR CHANGING AN ACCOUNT NAME AT THE SAME SERVICE LOCATION WHEN THE SERVICE IS NOT DISCONNECTED.

LATE CHARGE (EITHER \$5.00 OR 10% OF THE BILL) ..... 10%

A ONE-TIME PENALTY MAY BE MADE ON DELINQUENT BILLS BUT MAY NOT BE APPLIED TO ANY BALANCE TO WHICH THE PENALTY WAS APPLIED IN A PREVIOUS BILLING.

RETURNED CHECK CHARGE .....\$15.00

CUSTOMER DEPOSIT RESIDENTIAL (Maximum \$50).....\$50.00

COMMERCIAL & NON-RESIDENTIAL DEPOSIT ..... 1/6TH OF ESTIMATED ANNUAL BILL

GOVERNMENTAL TESTING, INSPECTION AND COSTS SURCHARGE:

WHEN AUTHORIZED IN WRITING BY PUC AND AFTER NOTICE TO CUSTOMERS, THE UTILITY MAY INCREASE RATES TO RECOVER INCREASED COSTS FOR INSPECTION FEES AND WATER TESTING. [16 TAC § 24.25(b)(2)(G)]

LINE EXTENSION AND CONSTRUCTION CHARGES:

REFER TO SECTION 3.0--EXTENSION POLICY FOR TERMS, CONDITIONS, AND CHARGES WHEN NEW CONSTRUCTION IS NECESSARY TO PROVIDE SERVICE.

SECTION 1.0 -- RATE SCHEDULE

Section 1.01 - Rates

<u>Meter Size</u>	<u>Monthly Minimum Charge</u>	<u>Gallonage Charge</u>
5/8" or 3/4"	<u>\$23.70</u> (Includes 0 gallons)	<u>\$3.30</u> per 1,000 over the minimum

FORM OF PAYMENT: The utility will accept the following forms of payment:

Cash X, Check X, Money Order X, Credit Card    , Other (specify)      
THE UTILITY MAY REQUIRE EXACT CHANGE FOR PAYMENTS AND MAY REFUSE TO ACCEPT PAYMENTS MADE USING MORE THAN \$1.00 IN SMALL COINS. A WRITTEN RECEIPT WILL BE GIVEN FOR CASH PAYMENTS.

REGULATORY ASSESSMENT ..... 1.0%  
PUC RULES REQUIRE THE UTILITY TO COLLECT A FEE OF ONE PERCENT OF THE RETAIL MONTHLY BILL AND TO REMIT THE FEE TO THE TCEQ.

Section 1.02 – Miscellaneous Fees

TAP FEE ..... \$700.00  
TAP FEE IS BASED ON THE AVERAGE OF THE UTILITY'S ACTUAL COST FOR MATERIALS AND LABOR FOR STANDARD RESIDENTIAL CONNECTION OF 5/8" METER PLUS UNIQUE COSTS AS PERMITTED BY PUC RULE AT COST.

TAP FEE (Unique costs) ..... Actual Cost  
FOR EXAMPLE, A ROAD BORE FOR CUSTOMERS OUTSIDE OF SUBDIVISIONS OR RESIDENTIAL AREAS.

TAP FEE (Large Meter) ..... Actual Cost  
TAP FEE IS BASED ON THE UTILITY'S ACTUAL COST FOR MATERIALS AND LABOR FOR METERS LARGER THAN STANDARD 5/8" METERS.

METER RELOCATION FEE ..... Actual Relocation Cost, Not to Exceed Tap Fee  
THIS FEE MAY BE CHARGED IF A CUSTOMER REQUESTS RELOCATION OF AN EXISTING METER.

METER TEST FEE ..... \$25.00  
THIS FEE WHICH SHOULD REFLECT THE UTILITY'S COST MAY BE CHARGED IF A CUSTOMER REQUESTS A SECOND METER TEST WITHIN A TWO-YEAR PERIOD AND THE TEST INDICATES THAT THE METER IS RECORDING ACCURATELY. THE FEE MAY NOT EXCEED \$25.

**SECTION 1.0 -- RATE SCHEDULE (Continued)**

**RECONNECTION FEE**

THE RECONNECT FEE MUST BE PAID BEFORE SERVICE CAN BE RESTORED TO A CUSTOMER WHO HAS BEEN DISCONNECTED FOR THE FOLLOWING REASONS (OR OTHER REASONS LISTED UNDER SECTION 2.0 OF THIS TARIFF):

- a) Nonpayment of bill (Maximum \$25.00).....\$25.00
- b) Customer's request.....\$35.00

**TRANSFER FEE**.....\$45.00

THE TRANSFER FEE WILL BE CHARGED FOR CHANGING AN ACCOUNT NAME AT THE SAME SERVICE LOCATION WHEN THE SERVICE IS NOT DISCONNECTED.

**LATE CHARGE (EITHER \$5.00 OR 10% OF THE BILL)** ..... 10%

A ONE-TIME PENALTY MAY BE MADE ON DELINQUENT BILLS BUT MAY NOT BE APPLIED TO ANY BALANCE TO WHICH THE PENALTY WAS APPLIED IN A PREVIOUS BILLING.

**RETURNED CHECK CHARGE** .....\$30.00

**CUSTOMER DEPOSIT RESIDENTIAL (Maximum \$50)**.....\$50.00

**COMMERCIAL & NON-RESIDENTIAL DEPOSIT** ..... 1/6TH OF ESTIMATED ANNUAL BILL

**GOVERNMENTAL TESTING, INSPECTION AND COSTS SURCHARGE:**

WHEN AUTHORIZED IN WRITING BY PUC AND AFTER NOTICE TO CUSTOMERS, THE UTILITY MAY INCREASE RATES TO RECOVER INCREASED COSTS FOR INSPECTION FEES AND WATER TESTING. [16 TAC § 24.25(b)(2)(G)]

**LINE EXTENSION AND CONSTRUCTION CHARGES:**

REFER TO SECTION 3.0--EXTENSION POLICY FOR TERMS, CONDITIONS, AND CHARGES WHEN NEW CONSTRUCTION IS NECESSARY TO PROVIDE SERVICE.

Section 1.01 - Rates  
**For Water and Sewer**

<u>Meter Size:</u> 5/8" or 3/4"	<u>Monthly Minimum Charge</u> \$12.62 (Includes 0 gallons)	<u>Gallonge Charge</u> \$3.84 per 1,000 gallons
------------------------------------	---	--

FORM OF PAYMENT: The utility will accept the following forms of payment:  
Cash , Check , Money Order , Credit Card , Other (specify)   
THE UTILITY MAY REQUIRE EXACT CHANGE FOR PAYMENTS AND MAY REFUSE TO ACCEPT PAYMENTS MADE USING MORE THAN \$1.00 IN SMALL COINS. A WRITTEN RECEIPT WILL BE GIVEN FOR CASH PAYMENTS.

REGULATORY ASSESSMENT..... 1.0%  
PUC RULES REQUIRE THE UTILITY TO COLLECT A FEE OF ONE PERCENT OF THE RETAIL MONTHLY BILL AND TO REMIT THE FEE TO THE TCEQ.

Section 1.02 – Miscellaneous Fees

TAP FEE..... \$275.00  
TAP FEE COVERS THE UTILITY'S COSTS FOR MATERIALS AND LABOR TO INSTALL A STANDARD RESIDENTIAL 5/8" or 3/4" METER. AN ADDITIONAL FEE TO COVER UNIQUE COSTS IS PERMITTED IF LISTED ON THIS TARIFF.

TAP FEE (Unique Costs)..... Actual Cost  
FOR EXAMPLE, A ROAD BORE FOR CUSTOMERS OUTSIDE OF SUBDIVISIONS OR RESIDENTIAL AREAS.

TAP FEE (Large Meter)..... Actual Cost  
TAP FEE IS THE UTILITY'S ACTUAL COST FOR MATERIALS AND LABOR FOR METER SIZE INSTALLED.

METER RELOCATION FEE ..... Actual Relocation Cost, Not to Exceed Tap Fee  
THIS FEE MAY BE CHARGED IF A CUSTOMER REQUESTS THAT AN EXISTING METER BE RELOCATED

METER TEST FEE ..... \$25.00  
THIS FEE WHICH SHOULD REFLECT THE UTILITY'S COST MAY BE CHARGED IF A CUSTOMER REQUESTS A SECOND METER TEST WITHIN A TWO-YEAR PERIOD AND THE TEST INDICATES THAT THE METER IS RECORDING ACCURATELY. THE FEE MAY NOT EXCEED \$25.

RECONNECTION FEE  
THE RECONNECT FEE MUST BE PAID BEFORE SERVICE CAN BE RESTORED TO A CUSTOMER WHO HAS BEEN DISCONNECTED FOR THE FOLLOWING REASONS (OR OTHER REASONS LISTED UNDER SECTION 2.0 OF THIS TARIFF):  
a) Nonpayment of bill (Maximum \$25.00)..... \$25.00  
b) Customer's request that service be disconnected ..... \$30.00

SECTION 1.0 -- RATE SCHEDULE (Continued)

TRANSFER FEE ..... \$30.00

THE TRANSFER FEE WILL BE CHARGED FOR CHANGING AN ACCOUNT NAME AT THE SAME SERVICE LOCATION WHEN THE SERVICE IS NOT DISCONNECTED

LATE CHARGE (EITHER \$5.00 OR 10% OF THE BILL) ..... \$5.00

PUC RULES ALLOW A ONE-TIME PENALTY TO BE CHARGED ON DELINQUENT BILLS. A LATE CHARGE MAY NOT BE APPLIED TO ANY BALANCE TO WHICH THE PENALTY WAS APPLIED IN A PREVIOUS BILLING.

RETURNED CHECK CHARGE ..... \$25.00

RETURNED CHECK CHARGES MUST BE BASED ON THE UTILITY'S DOCUMENTABLE COST.

CUSTOMER DEPOSIT RESIDENTIAL (Maximum \$50) ..... \$50.00

COMMERCIAL & NON-RESIDENTIAL DEPOSIT ..... 1/6TH OF ESTIMATED ANNUAL BILL

**GOVERNMENTAL TESTING, INSPECTION AND COSTS SURCHARGE:**

WHEN AUTHORIZED IN WRITING BY PUC AND AFTER NOTICE TO CUSTOMERS, THE UTILITY MAY INCREASE RATES TO RECOVER INCREASED COSTS FOR INSPECTION FEES AND WATER TESTING. [16 TAC § 24.25(b)(2)(G)]

**LINE EXTENSION AND CONSTRUCTION CHARGES:**

REFER TO SECTION 3.0--EXTENSION POLICY FOR TERMS, CONDITIONS, AND CHARGES WHEN NEW CONSTRUCTION IS NECESSARY TO PROVIDE SERVICE.

Section 1.03 – Purchased Water and Sewer Adjustment Clause

Upon a notice from the City of Donna of a change in price in the cost of purchased water or sewer service, the Utility may (after notice has been given to the ratepayers and the Commission) adjust its rates in accordance with the Tariff provisions.

The adjustment to the utility's rate structure will be calculated as set for the below:

I. Adjusted Monthly Minimum Charge – Current Monthly Minimum Charge + “A” + “B”

Where:

“A” = Change in Price of Purchase Water from the City of Donna---which is---{Change in the monthly minimum Price divided by the number of customers} + {2 times the Change in Price per 1,000 gallons of water}

“B” =Change in Price of Purchased Sewer Service from the City of Donna---which is---{Change in the monthly minimum Price of Purchases Sewer Service divided by

SECTION 1.0 -- RATE SCHEDULE (Continued)

the number of customers} + {2 times the Change in Price per 1,000 gallons of Purchased Sewer Service times 0.80}

II. Adjusted Gallonage Charge = Current Gallonage Charge + “X” + “Y”

Where:

“X” = Change in Price per 1,000 gallons of Purchased Water from the City of Donna

“Y” = Change in Price per 1,000 gallons of Purchased Sewer Service from the City of Donna times 0.80

Change as used above is the algebraic summation of the Price imposed by the City of Donna subsequent to the date of this Tariff (New Price) and the Price existing on the date this Tariff was approved (Old Price), i.e. New Price minus Old Price.

Number of customers as used above is the number existing customers at the beginning of the period in which a Change in Price becomes effective.

SECTION 1.0 -- RATE SCHEDULE

Section 1.01 - Rates

<u>Meter Size</u>	<u>Monthly Minimum Charge</u>	<u>Gallage Charge</u>
5/8" or 3/4"	<u>\$47.05</u> (Includes 3,000 gallons)	<u>\$3.68</u> per 1,000 gallons 3,001 – 10,000 gallons <u>\$4.73</u> per 1,000 gallons 10,001 – 20,000 gallons <u>\$5.78</u> per 1,000 gallons 20,001 gallons thereafter

FORM OF PAYMENT: The utility will accept the following forms of payment:

Cash , Check , Money Order , Credit Card \_\_\_\_\_, Other (specify)

\_\_\_\_\_ THE UTILITY MAY REQUIRE EXACT CHANGE FOR PAYMENTS AND MAY REFUSE TO ACCEPT PAYMENTS MADE USING MORE THAN \$1.00 IN SMALL COINS. A WRITTEN RECEIPT WILL BE GIVEN FOR CASH PAYMENTS.

REGULATORY ASSESSMENT ..... 1.0%  
 PUC RULES REQUIRE THE UTILITY TO COLLECT A FEE OF ONE PERCENT OF THE RETAIL MONTHLY BILL AND TO REMIT FEE TO THE TCEQ.

Section 1.02 - Miscellaneous Fees

TAP FEE ..... \$750.00  
 TAP FEE COVERS THE UTILITY'S COSTS FOR MATERIALS AND LABOR TO INSTALL A STANDARD RESIDENTIAL 5/8" or 3/4" METER. AN ADDITIONAL FEE TO COVER UNIQUE COSTS IS PERMITTED IF LISTED ON THIS TARIFF.

TAP FEE (Unique costs) ..... Actual Cost  
 FOR EXAMPLE, A ROAD BORE FOR CUSTOMERS OUTSIDE OF SUBDIVISIONS OR RESIDENTIAL AREAS.

TAP FEE (Large meter) ..... Actual Cost  
 TAP FEE IS THE UTILITY'S ACTUAL COST FOR MATERIALS AND LABOR FOR METER SIZE INSTALLED.

METER RELOCATION FEE ..... Actual Relocation Cost, Not to Exceed Tap Fee  
 THIS FEE MAY BE CHARGED IF A CUSTOMER REQUESTS THAT AN EXISTING METER BE RELOCATED.

METER TEST FEE ..... \$25.00  
 THIS FEE WHICH SHOULD REFLECT THE UTILITY'S COST MAY BE CHARGED IF A CUSTOMER REQUESTS A SECOND METER TEST WITHIN A TWO-YEAR PERIOD AND THE TEST INDICATES THAT THE METER IS RECORDING ACCURATELY. THE FEE MAY NOT EXCEED \$25.



**Live Oak Hills Subdivision**  
**(Formerly Bill J. Wootan dba Live Oak Hills and**  
**Flag Creek Ranch Water Systems)**  
(Utility Name)

SECTION 1.0 -- RATE SCHEDULE (Continued)

**RECONNECTION FEE**

THE RECONNECT FEE MUST BE PAID BEFORE SERVICE CAN BE RESTORED TO A CUSTOMER WHO HAS BEEN DISCONNECTED FOR THE FOLLOWING REASONS (OR OTHER REASONS LISTED UNDER SECTION 2.0 OF THIS TARIFF):

- a) Nonpayment of bill (Maximum \$25.00).....\$25.00
- b) Customer’s request that service be disconnected .....\$50.00

**TRANSFER FEE** ..... \$50.00

THE TRANSFER FEE WILL BE CHARGED FOR CHANGING AN ACCOUNT NAME AT THE SAME SERVICE LOCATION WHEN THE SERVICE IS NOT DISCONNECTED

**LATE CHARGE (EITHER \$5.00 OR 10% OF THE BILL)** ..... \$5.00

PUC RULES ALLOW A ONE-TIME PENALTY TO BE CHARGED ON DELINQUENT BILLS. A LATE CHARGE MAY NOT BE APPLIED TO ANY BALANCE TO WHICH THE PENALTY WAS APPLIED IN A PREVIOUS BILLING.

**RETURNED CHECK CHARGE** ..... \$25.00

RETURNED CHECK CHARGES MUST BE BASED ON THE UTILITY’S DOCUMENTABLE COST.

**CUSTOMER DEPOSIT RESIDENTIAL (Maximum \$50)**..... \$0.00

**COMMERCIAL & NON-RESIDENTIAL DEPOSIT** ..... 1/6TH OF ESTIMATED ANNUAL BILL

**GOVERNMENTAL TESTING, INSPECTION AND COSTS SURCHARGE:**

WHEN AUTHORIZED IN WRITING BY TCEQ AND AFTER NOTICE TO CUSTOMERS, THE UTILITY MAY INCREASE RATES TO RECOVER INCREASED COSTS FOR INSPECTION FEES AND WATER TESTING. [16 TAC § 24.25(b)(2)(G)]

**LINE EXTENSION AND CONSTRUCTION CHARGES:**

REFER TO SECTION 3.0--EXTENSION POLICY FOR TERMS, CONDITIONS, AND CHARGES WHEN NEW CONSTRUCTION IS NECESSARY TO PROVIDE SERVICE.

SECTION 1.0 -- RATE SCHEDULE

Section 1.01 - Rates

<u>Meter Size</u>	<u>Monthly Minimum Charge</u>	<u>Gallage Charge</u>
5/8" or 3/4"	\$33.68 (Includes 3,000 gallons)	\$3.68 per 1,000 gallons 3,001 – 10,000 gallons
1"	\$70.04 (Includes 3,000 gallons)	\$4.73 per 1,000 gallons 10,001 – 20,000 gallons
		\$5.78 per 1,000 gallons 20,001 gallons

thereafter

FORM OF PAYMENT: The utility will accept the following forms of payment:

Cash X, Check X, Money Order X, Credit Card \_\_\_\_\_, Other (specify)

\_\_\_\_\_ THE UTILITY MAY REQUIRE EXACT CHANGE FOR PAYMENTS AND MAY REFUSE TO ACCEPT PAYMENTS MADE USING MORE THAN \$1.00 IN SMALL COINS. A WRITTEN RECEIPT WILL BE GIVEN FOR CASH PAYMENTS.

REGULATORY ASSESSMENT ..... 1.0%  
 PUC RULES REQUIRE THE UTILITY TO COLLECT A FEE OF ONE PERCENT OF THE RETAIL MONTHLY BILL AND TO REMIT FEE TO THE TCEQ.

Section 1.02 - Miscellaneous Fees

TAP FEE ..... \$750.00  
 TAP FEE COVERS THE UTILITY'S COSTS FOR MATERIALS AND LABOR TO INSTALL A STANDARD RESIDENTIAL 5/8" or 3/4" METER. AN ADDITIONAL FEE TO COVER UNIQUE COSTS IS PERMITTED IF LISTED ON THIS TARIFF.

TAP FEE (Unique costs) ..... Actual Cost  
 FOR EXAMPLE, A ROAD BORE FOR CUSTOMERS OUTSIDE OF SUBDIVISIONS OR RESIDENTIAL AREAS.

TAP FEE (Large meter) ..... Actual Cost  
 TAP FEE IS THE UTILITY'S ACTUAL COST FOR MATERIALS AND LABOR FOR METER SIZE INSTALLED.

METER RELOCATION FEE ..... Actual Relocation Cost, Not to Exceed Tap Fee  
 THIS FEE MAY BE CHARGED IF A CUSTOMER REQUESTS THAT AN EXISTING METER BE RELOCATED.

METER TEST FEE ..... \$25.00  
 THIS FEE WHICH SHOULD REFLECT THE UTILITY'S COST MAY BE CHARGED IF A CUSTOMER REQUESTS A SECOND METER TEST WITHIN A TWO-YEAR PERIOD AND THE TEST INDICATES THAT THE METER IS RECORDING ACCURATELY. THE FEE MAY NOT EXCEED \$25.

SECTION 1.0 – RATE SCHEDULE (Continued)

**RECONNECTION FEE**

THE RECONNECT FEE MUST BE PAID BEFORE SERVICE CAN BE RESTORED TO A CUSTOMER WHO HAS BEEN DISCONNECTED FOR THE FOLLOWING REASONS (OR OTHER REASONS LISTED UNDER SECTION 2.0 OF THIS TARIFF):

- a) Nonpayment of bill (Maximum \$25.00).....\$25.00
- b) Customer’s request that service be disconnected .....\$50.00

**TRANSFER FEE .....\$50.00**

THE TRANSFER FEE WILL BE CHARGED FOR CHANGING AN ACCOUNT NAME AT THE SAME SERVICE LOCATION WHEN THE SERVICE IS NOT DISCONNECTED

**LATE CHARGE (EITHER \$5.00 OR 10% OF THE BILL) .....\$5.00**

PUC RULES ALLOW A ONE-TIME PENALTY TO BE CHARGED ON DELINQUENT BILLS. A LATE CHARGE MAY NOT BE APPLIED TO ANY BALANCE TO WHICH THE PENALTY WAS APPLIED IN A PREVIOUS BILLING.

**RETURNED CHECK CHARGE .....\$25.00**

RETURNED CHECK CHARGES MUST BE BASED ON THE UTILITY’S DOCUMENTABLE COST.

**CUSTOMER DEPOSIT RESIDENTIAL (Maximum \$50).....\$0.00**

**COMMERCIAL & NON-RESIDENTIAL DEPOSIT ..... 1/6TH OF ESTIMATED ANNUAL BILL**

**GOVERNMENTAL TESTING, INSPECTION AND COSTS SURCHARGE:**

WHEN AUTHORIZED IN WRITING BY TCEQ AND AFTER NOTICE TO CUSTOMERS, THE UTILITY MAY INCREASE RATES TO RECOVER INCREASED COSTS FOR INSPECTION FEES AND WATER TESTING. [16 TAC § 24.25(b)(2)(G)]

**LINE EXTENSION AND CONSTRUCTION CHARGES:**

REFER TO SECTION 3.0--EXTENSION POLICY FOR TERMS, CONDITIONS, AND CHARGES WHEN NEW CONSTRUCTION IS NECESSARY TO PROVIDE SERVICE.

(Utility Name)

## SECTION 2.0 - SERVICE RULES AND POLICIES

The utility will have the most current Public Utility Commission of Texas (PUC or Commission) rules relating to Water and Wastewater Utility regulations, available at its office for reference purposes. The Rules and this tariff shall be available for public inspection and reproduction at a reasonable cost. The latest Rules or commission approved changes to the Rules supersede any rules or requirements in this tariff.

### Section 2.01 - Application for Water Service

All applications for service will be made on the utility's standard application or contract form (attached in the Appendix to this tariff), will be signed by the applicant, any required fees (deposits, reconnect, tap, extension fees, etc. as applicable) will be paid and easements, if required, will be granted before service is provided by the utility. A separate application or contract will be made for each service location.

### Section 2.02 - Refusal of Service

The utility may decline to serve an applicant until the applicant has complied with the regulations of the regulatory agencies (state and municipal regulations) and for the reasons outlined in the PUC Rules. In the event the utility refuses to serve an applicant, the utility will inform the applicant in writing of the basis of its refusal. The utility is also required to inform the applicant that a complaint may be filed with the commission.

### Section 2.03 - Fees and Charges and Easements Required Before Service Can Be Connected

#### (A) Customer Deposits

If a residential applicant cannot establish credit to the satisfaction of the utility, the applicant may be required to pay a deposit as provided for in Section 1.02 - Miscellaneous Fees of this tariff. The utility will keep records of the deposit and credit interest in accordance with PUC Rules.

Residential applicants 65 years of age or older may not be required to pay deposits unless the applicant has an outstanding account balance with the utility or another water or sewer utility which accrued within the last two years.

Nonresidential applicants who cannot establish credit to the satisfaction of the utility may be required to make a deposit that does not exceed an amount equivalent to one-sixth of the estimated annual billings.

Refund of deposit - If service is not connected, or after disconnection of service, the utility will promptly refund the customer's deposit plus accrued interest or the balance, if any, in excess of the unpaid bills for service furnished. The utility may refund the deposit at any time prior to

**SECTION 2.0 - SERVICE RULES AND POLICIES (Continued)**

termination of utility service but must refund the deposit plus interest for any customer who has paid 18 consecutive billings without being delinquent.

**(B) Tap or Reconnect Fees**

A new customer requesting service at a location where service has not previously been provided must pay a tap fee as provided in Section 1. A customer requesting service where service has previously been provided must pay a reconnect fee as provided in Section 1. Any applicant or existing customer required to pay for any costs not specifically set forth in the rate schedule pages of this tariff shall be given a written explanation of such costs prior to request for payment and/or commencement of construction. If the applicant or existing customer does not believe that these costs are reasonable or necessary, the applicant or existing customer shall be informed of their right to appeal such costs to the PUC or such other regulatory authority having jurisdiction over the utility's rates in that portion of the utility's service area in which the applicant's or existing customer's property(ies) is located.

Fees in addition to the regular tap fee may be charged to cover unique costs not normally incurred as permitted by 16 TAC § 24.163(a)(1)(C) if they are listed on this approved tariff. For example, a road bore for customers outside a subdivision or residential area could be considered a unique cost.

**(C) Easement Requirement**

Where recorded public utility easements on the service applicant's property do not exist or public road right-of-way easements are not available to access the applicant's property, the Utility may require the applicant to provide it with a permanent recorded public utility easement on and across the applicant's real property sufficient to provide service to that applicant. Such easement(s) shall not be used for the construction of production, storage, transmission or pressure facilities unless they are needed for adequate service to that applicant.

**Section 2.04 - Utility Response to Applications for Service**

After the applicant has met all the requirements, conditions and regulations for service, the utility will install tap, meter and utility cut-off valve and/or take all necessary actions to initiate service. The utility will serve each qualified applicant for service within 5 working days unless line extensions or new facilities are required. If construction is required to fill the order and if it cannot be completed within 30 days, the utility will provide the applicant with a written explanation of the construction required and an expected date of service.

Except for good cause where service has previously been provided, service will be reconnected within one working day after the applicant has met the requirements for reconnection.

**Section 2.05 - Customer Responsibility**

The customer will be responsible for furnishing and laying the necessary customer service pipe from

## SECTION 2.0 - SERVICE RULES AND POLICIES (Continued)

the meter location to the place of consumption. Customers will not be allowed to use the utility's cutoff valve on the utility's side of the meter. Existing customers may install cutoff valves on their side of the meter and are encouraged to do so. All new customers must install and maintain a cutoff valve on their side of the meter.

No direct connection between a public water supply system and any potential source of contamination or between a public water supply system and a private water source (ex. private well) will be allowed. A customer shall not connect, or allow any other person or party to connect, onto any water lines on his premises.

### Section 2.06 - Customer Service Inspections

Applicants for new service connections or facilities which have undergone extensive plumbing modifications are required to furnish the utility a completed customer service inspection certificate. The inspection certificate shall certify that the establishment is in compliance with the Texas Commission on Environmental Quality (TCEQ) Rules and Regulations for Public Water Systems, 30 TAC § 290.46(j). The utility is not required to perform these inspections for the applicant/customer but will assist the applicant/customer in locating and obtaining the services of a certified inspector.

### Section 2.07 - Back Flow Prevention Devices

No water connection shall be allowed to any residence or establishment where an actual or potential contamination hazard exists unless the public water facilities are protected from contamination by either an approved air gap, backflow prevention assembly, or other approved device. The type of device or backflow prevention assembly required shall be determined by the specific potential hazard identified in 30 TAC § 290.47(f) Appendix F, Assessment of Hazards and Selection of Assemblies of the TCEQ Rules and Regulations for Public Water Systems.

The use of a backflow prevention assembly at the service connection shall be considered as additional backflow protection and shall not negate the use of backflow protection on internal hazards as outlined and enforced by local plumbing codes. When a customer service inspection certificate indicates that an adequate internal cross-connection control program is in effect, backflow protection at the water service entrance or meter is not required.

At any residence or establishment where it has been determined by a customer service inspection, that there is no actual or potential contamination hazard, as referenced in 30 TAC § 290.47(f) Appendix F, Assessment of Hazards and Selection of Assemblies of the TCEQ Rules and Regulations for Public Water Systems, then a backflow prevention assembly or device is not required. Outside hose bibs do require, at a minimum, the installation and maintenance of a working atmospheric vacuum breaker.

All backflow prevention assemblies or devices shall be tested upon installation by a TCEQ certified backflow prevention assembly tester and certified to be operating within specifications. Backflow

## SECTION 2.0 - SERVICE RULES AND POLICIES (Continued)

prevention assemblies which are installed to provide protection against health hazards must also be tested and certified to be operating within specifications at least annually by a certified backflow prevention assembly tester.

If the utility determines that a backflow prevention assembly or device is required, the utility will provide the customer or applicant with a list of TCEQ certified backflow prevention assembly testers. The customer will be responsible for the cost of installation and testing, if any, of backflow prevention assembly or device. The customer should contact several qualified installers to compare prices before installation. The customer must pay for any required maintenance and annual testing and must furnish a copy of the test results demonstrating that the assembly is functioning properly to the utility within 30 days after the anniversary date of the installation unless a different date is agreed upon.

### Section 2.08 - Access to Customer's Premises

The utility will have the right of access to the customer's premises at all reasonable times for the purpose of installing, testing, inspecting or repairing water mains or other equipment used in connection with its provision of water service, or for the purpose of removing its property and disconnecting lines, and for all other purposes necessary to the operation of the utility system including inspecting the customer's plumbing for code, plumbing or tariff violations. The customer shall allow the utility and its personnel access to the customer's property to conduct any water quality tests or inspections required by law. Unless necessary to respond to equipment failure, leak or other condition creating an immediate threat to public health and safety or the continued provision of adequate utility service to others, such entry upon the customer's property shall be during normal business hours and the utility personnel will attempt to notify the customer that they will be working on the customer's property. The customer may require any utility representative, employee, contractor, or agent seeking to make such entry identify themselves, their affiliation with the utility, and the purpose of their entry.

All customers or service applicants shall provide access to meters and utility cutoff valves at all times reasonably necessary to conduct ordinary utility business and after normal business hours as needed to protect and preserve the integrity of the public drinking water supply.

### Section 2.09 - Meter Requirements, Readings, and Testing

One meter is required for each residential, commercial, or industrial connection. All water sold by the utility will be billed based on meter measurements. The utility will provide, install, own and maintain meters to measure amounts of water consumed by its customers.

Meters will be read at monthly intervals and as nearly as possible on the corresponding day of each monthly meter reading period unless otherwise authorized by the Commission.

Meter tests. The utility will, upon the request of a customer, and, if the customer so desires, in his or her presence or in that of his or her authorized representative, make without charge a test of the

SECTION 2.0 - SERVICE RULES AND POLICIES (Continued)

accuracy of the customer's meter. If the customer asks to observe the test, the test will be made during the utility's normal working hours at a time convenient to the customer. Whenever possible, the test will be made on the customer's premises, but may, at the utility's discretion, be made at the utility's testing facility. If within a period of two years the customer requests a new test, the utility will make the test, but if the meter is found to be within the accuracy standards established by the American Water Works Association, the utility will charge the customer a fee which reflects the cost to test the meter up to a maximum \$25 for a residential customer. Following the completion of any requested test, the utility will promptly advise the customer of the date of removal of the meter, the date of the test, the result of the test, and who made the test.

Section 2.10 - Billing

(A) Regular Billing

Bills from the utility will be mailed monthly unless otherwise authorized by the Commission. The due date of bills for utility service will be at least sixteen (16) days from the date of issuance. The postmark on the bill or, if there is no postmark on the bill, the recorded date of mailing by the utility will constitute proof of the date of issuance.

Payment for utility service is delinquent if full payment, including late fees and the regulatory assessment, is not received at the utility or the utility's authorized payment agency by 5:00 p.m. on the due date. If the due date falls on a holiday or weekend, the due date for payment purposes will be the next workday after the due date.

(B) Late Fees

A late penalty of either \$5.00 or 10.0% will be charged on bills received after the due date. The penalty on delinquent bills will not be applied to any balance to which the penalty was applied in a previous billing. The utility must maintain a record of the date of mailing to charge the late penalty.

(C) Information on Bill

Each bill will provide all information required by the PUC Rules. For each of the systems it operates, the utility will maintain and note on the monthly bill a local or toll-free telephone number (or numbers) to which customers can direct questions about their utility service.

(D) Prorated Bills - If service is interrupted or seriously impaired for 24 consecutive hours or more, the utility will prorate the monthly base bill in proportion to the time service was not available to reflect this loss of service.

Section 2.11- Payments

All payments for utility service shall be delivered or mailed to the utility's business office. If the business office fails to receive payment prior to the time of noticed disconnection for non-payment of a delinquent account, service will be terminated as scheduled. Utility service crews shall not be allowed to collect payments on customer accounts in the field.



SECTION 2.0 - SERVICE RULES AND POLICIES (Continued)

Payment of an account by any means that has been dishonored and returned by the payor or payee's bank, shall be deemed to be delinquent. All returned payments must be redeemed with cash or valid money order. If a customer has two returned payments within a twelve-month period, the customer shall be required to pay a deposit if one has not already been paid.

Section 2.12 - Service Disconnection

(A) With Notice

Utility service may be disconnected if the bill has not been paid in full by the date listed on the termination notice. The termination date must be at least 10 days after the notice is mailed or hand delivered.

The utility is encouraged to offer a deferred payment plan to a customer who cannot pay an outstanding bill in full and is willing to pay the balance in reasonable installments. However, a customer's utility service may be disconnected if a bill has not been paid or a deferred payment agreement entered into within 26 days from the date of issuance of a bill and if proper notice of termination has been given.

Notice of termination must be a separate mailing or hand delivery in accordance with the PUC Rules.

(B) Without Notice

Utility service may also be disconnected without notice for reasons as described in the PUC Rules.

Section 2.13 - Reconnection of Service

Utility personnel must be available during normal business hours to accept payments on the day service is disconnected and the following day unless service was disconnected at the customer's request or due to a hazardous condition.

Service will be reconnected within 24 hours after the past due bill, reconnect fees and any other outstanding charges are paid or the conditions which caused service to be disconnected are corrected.

Section 2.14 - Service Interruptions

The utility will make all reasonable efforts to prevent interruptions of service. If interruptions occur, the utility will re-establish service within the shortest possible time. Except for momentary interruptions due to automatic equipment operations, the utility will keep a complete record of all interruptions, both emergency and scheduled and will notify the Commission in writing of any service interruptions affecting the entire system or any major division of the system lasting more than four hours. The notice will explain the cause of the interruptions.

SECTION 2.0 - SERVICE RULES AND POLICIES (Continued)

Section 2.15 - Quality of Service

The utility will plan, furnish, and maintain production, treatment, storage, transmission, and distribution facilities of sufficient size and capacity to provide a continuous and adequate supply of water for all reasonable consumer uses. Unless otherwise authorized by the PUC or TCEQ, the utility will maintain facilities as described in the TCEQ Rules and Regulations for Public Water Systems.

Section 2.16 - Customer Complaints and Disputes

If a customer or applicant for service lodges a complaint, the utility will promptly make a suitable investigation and advise the complainant of the results. Service will not be disconnected pending completion of the investigation. If the complainant is dissatisfied with the utility's response, the utility must advise the complainant that he has recourse through the PUC complaint process. Pending resolution of a complaint, the commission may require continuation or restoration of service.

The utility will maintain a record of all complaints which shows the name and address of the complainant, the date and nature of the complaint and the adjustment or disposition thereof, for a period of two years after the final settlement of the complaint.

In the event of a dispute between a customer and a utility regarding any bill for utility service, the utility will conduct an investigation and report the results to the customer. If the dispute is not resolved, the utility will inform the customer that a complaint may be filed with the Commission.

Section 2.17 - Customer Liability

Customer shall be liable for any damage or injury to utility-owned property shown to be caused by the customer.

## SECTION 3.0 - EXTENSION POLICY

### Section 3.01 - Standard Extension Requirements

Line Extension and Construction Charges: No Contribution in Aid of Construction may be required of any customer except as provided for in this approved extension policy.

The customer will be given an itemized statement of the costs, options such as rebates to the customer, sharing of construction costs between the utility and the customer, or sharing of costs between the customer and other applicants prior to beginning construction.

Unless an exception is granted by the PUC, the residential service applicant shall not be required to pay for costs of main extensions greater than 2" in diameter for water distribution and pressure wastewater collection lines and 6" in diameter for gravity wastewater lines.

Exceptions may be granted by the PUC if:

- a) adequate service cannot be provided to the applicant using the maximum line sizes listed due to distance or elevation, in which case, it shall be the utility's burden to justify that a larger diameter pipe is required for adequate service;
- b) or larger minimum line sizes are required under subdivision platting requirements or building codes of municipalities within whose corporate limits or extraterritorial jurisdiction the point of use is located; or the residential service applicant is located outside the CCN service area.

If an exception is granted, the Utility shall establish a proportional cost plan for the specific extension or a rebate plan which may be limited to seven years to return the portion of the applicant's costs for oversizing as new customers are added to ensure that future applicants for service on the line pay at least as much as the initial service applicant.

The utility shall bear the cost of any over-sizing of water distribution lines or wastewater collection lines necessary to serve other potential service applicants for customers in the immediate area.

For purposes of determining the costs that service applicants shall pay, commercial customers with service demands greater than residential customer demands in the certificated area, industrial, and wholesale customers shall be treated as developers. A service applicant requesting a one-inch meter for a lawn sprinkler system to service a residential lot is not considered nonstandard service.

If an applicant requires service other than the standard service provided by the utility, such applicant will be required to pay all expenses incurred by the utility in excess of the expenses that would be incurred in providing the standard service and connection beyond 200 feet and throughout his property including the cost of all necessary transmission facilities.

Residential customers will be charged the equivalent of the costs of extending service to their property from the nearest transmission or distribution line even if that line does not have adequate

### SECTION 3.0 - EXTENSION POLICY (Continued)

capacity to serve the customer. However, if the customer places unique, non-standard service demands upon the system, the customer may be charged the additional cost of extending service to and throughout their property, including the cost of all necessary transmission and storage facilities necessary to meet the service demands anticipated to be created by that property.

#### Section 3.02 - Costs Utilities Shall Bear

The utility will bear the full cost of any oversizing of water mains necessary to serve other customers in the immediate area. The individual residential customer shall not be charged for any additional production, storage, or treatment facilities. Contributions in aid of construction may not be required of individual residential customers for production, storage, treatment or transmission facilities unless otherwise approved by the Commission under this specific extension policy.

Within its certificate area, the utility will pay the cost of the first 200 feet of any water main or distribution line necessary to extend service to an individual residential customer within a platted subdivision. However, if the residential customer requesting service purchased the property after the developer was notified of the need to provide facilities to the utility, the utility may charge for the first 200 feet. The utility must also be able to document that the developer of the subdivision refused to provide facilities compatible with the utility's facilities in accordance with the utility's approved extension policy after receiving a written request from the utility.

The Utility is not required to extend service to any applicant outside of its certificated service area and will only do so under terms and conditions mutually agreeable to the Utility and the applicant, in compliance with PUC rules and policies, and upon extension of the Utility's certificated service area boundaries by the PUC.

#### Section 3.03 - Contributions in Aid of Construction

Developers may be required to provide contributions in aid of construction in amounts sufficient to furnish the development with all facilities necessary to provide for reasonable local demand requirements and to comply with TCEQ minimum design criteria for facilities used in the production, transmission, pumping, or treatment of water or TCEQ minimum requirements. For purposes of this subsection, a developer is one who subdivides or requests more than two meters on a piece of property. Commercial, industrial, and wholesale customers will be treated as developers.

Any applicant who places unique or non-standard service demands on the system may be required to provide contributions in aid of construction for the actual costs of any additional facilities required to maintain compliance with the TCEQ minimum design criteria for water production, treatment, pumping, storage and transmission.

Any service extension to a subdivision (recorded or unrecorded) may be subject to the provisions and restrictions of 16 TAC § 24.163(d). When a developer wishes to extend the system to prepare

### SECTION 3.0 - EXTENSION POLICY (Continued)

to service multiple new connections, the charge shall be the cost of such extension, plus a pro-rata charge for facilities which must be committed to such extension compliant with the TCEQ minimum design criteria. As provided by 16 TAC § 24.163(d)(4), for purposes of this section, commercial, industrial, and wholesale customers shall be treated as developers.

#### Section 3.04 - Appealing Connection Costs

The imposition of additional extension costs or charges as provided by Sections 3.0 - Extension Policy of this tariff shall be subject to appeal as provided in this tariff, PUC rules, or the rules of such other regulatory authority as may have jurisdiction over the utility's rates and services. Any applicant required to pay for any costs not specifically set forth in the rate schedule pages of this tariff shall be given a written explanation of such costs prior to payment and/or commencement of construction. If the applicant does not believe that these costs are reasonable or necessary, the applicant shall be informed of the right to appeal such costs to the PUC or such other regulatory authority having jurisdiction over the utility's rates in that portion of the utility's service area in which the applicant's property(ies) is located.

#### Section 3.05 - Applying for Service

The Utility will provide a written service application form to the applicant for each request for service received by the Utility's business offices. A separate application shall be required for each potential service location if more than one service connection is desired by any individual applicant. Service application forms will be available at the Utility's business office during normal weekday business hours. Service applications will be sent by prepaid first-class United States mail to the address provided by the applicant upon request. Completed applications should be returned by hand delivery in case there are questions which might delay fulfilling the service request. Completed service applications may be submitted by mail if hand delivery is not possible.

Where a new tap or service connection is required, the service applicant shall be required to submit a written service application and request that a tap be made. The tap request must be accompanied with a diagram, map, plat, or written metes and bounds description of precisely where the applicant desires each tap or service connection is to be made and, if necessary, where the meter is to be installed, along the applicant's property line. The actual point of connection and meter installation must be readily accessible to Utility personnel for inspection, servicing, and meter reading while being reasonably secure from damage by vehicles and mowers.

If the Utility has more than one main adjacent to the service applicant's property, the tap or service connection will be made to the Utility's nearest service main with adequate capacity to service the applicant's full potential service demand. Beyond the initial 200 feet, the customer shall bear only the equivalent cost of extending from the nearest main. If the tap or service connection cannot be made at the applicant's desired location, it will be made at another location mutually acceptable to the applicant and the Utility. If no agreement on location can be made, the applicant may refer the matter to the PUC for resolution.

SECTION 3.0 - EXTENSION POLICY (Continued)

Section 3.06 - Qualified Service Applicant

A "qualified service applicant" is an applicant who has: (1) met all of the Utility's requirements for service contained in this tariff, PUC rules and/or PUC order, (2) has made payment or made arrangement for payment of tap fees, (3) has provided all necessary easements and rights-of-way necessary to provide service to the requested location, (4) delivered an executed customer service inspection certificate to the Utility, if applicable, and (5) has executed a customer service application for each location to which service is being requested.

The Utility shall serve each qualified service applicant within its certificated service area as soon as practical after receiving a completed service application. All service requests will be fulfilled within the time limits prescribed by PUC rules once the applicant has met all conditions precedent to achieving "qualified service applicant" status. If a service request cannot be fulfilled within the required period, the applicant shall be notified in writing of the delay, its cause and the anticipated date that service will be available. The PUC service dates shall not become applicable until the service applicant has met all conditions precedent to becoming a qualified service applicant as defined by PUC rules.

Section 3.07 - Developer Requirements

As a condition of service to a new subdivision, the Utility shall require a developer (as defined by PUC rule) to provide permanent recorded public utility easements as a condition of service to any location within the developer's property.

APPENDIX A -- DROUGHT CONTINGENCY PLAN  
(Utility must attach copy of TCEQ approved Drought Contingency Plan)

APPENDIX B  
Chapter 290.47(b) Sample Service Agreement  
SERVICE AGREEMENT

- I. **PURPOSE.** The NAME OF WATER SYSTEM is responsible for protecting the drinking water supply from contamination or pollution which could result from improper private water distribution system construction or configuration. The purpose of this service agreement is to notify each customer of the restrictions which are in place to provide this protection. The utility enforces these restrictions to ensure the public health and welfare. Each customer must sign this agreement before the NAME OF WATER SYSTEM will begin service. In addition, when service to an existing connection has been suspended or terminated, the water system will not re-establish service unless it has a signed copy of this agreement.
- II. **RESTRICTIONS.** The following unacceptable practices are prohibited by State regulations.
- A. No direct connection between the public drinking water supply and a potential source of contamination is permitted. Potential sources of contamination shall be isolated from the public water system by an air-gap or an appropriate backflow prevention device.
  - B. No cross-connection between the public drinking water supply and a private water system is permitted. These potential threats to the public drinking water supply shall be eliminated at the service connection by the installation of an air-gap or a reduced pressure-zone backflow prevention device.
  - C. No connection which allows water to be returned to the public drinking water supply is permitted.
  - D. No pipe or pipe fitting which contains more than 8.0% lead may be used for the installation or repair of plumbing at any connection which provides water for human use.
  - E. No solder or flux which contains more than 0.2% lead can be used for the installation or repair of plumbing at any connection which provides water for human use.
- III. **SERVICE AGREEMENT.** The following are the terms of the service agreement between the NAME OF WATER SYSTEM (the Water System) and NAME OF CUSTOMER (the Customer).
- A. The Water System will maintain a copy of this agreement as long as the Customer and/or the premises is connected to the Water System.
  - B. The Customer shall allow his property to be inspected for possible cross-connections and other potential contamination hazards. These inspections shall be conducted by the Water System or its designated agent prior to initiating new water service; when there is reason to believe that cross-connections or other potential contamination hazards exist; or after any major changes to the private water distribution facilities. The inspections shall be conducted during the Water System's normal business hours.
  - C. The Water System shall notify the Customer in writing of any cross-connection or other potential contamination hazard which has been identified during the initial inspection or the periodic reinspection.



- D. The Customer shall immediately remove or adequately isolate any potential cross-connections or other potential contamination hazards on his premises.
  - E. The Customer shall, at his expense, properly install, test, and maintain any backflow prevention device required by the Water System. Copies of all testing and maintenance records shall be provided to the Water System.
- IV. ENFORCEMENT. If the Customer fails to comply with the terms of the Service Agreement, the Water System shall, at its option, either terminate service or properly install, test, and maintain an appropriate backflow prevention device at the service connection. Any expenses associated with the enforcement of this agreement shall be billed to the Customer.

CUSTOMER'S  
SIGNATURE: \_\_\_\_\_  
DATE: \_\_\_\_\_