



Control Number: 51870



Item Number: 1

Addendum StartPage: 0



Application to Obtain or Amend a Water or Sewer Certificate of Convenience and Necessity (CCN)

Pursuant to 16 Texas Administrative Code (TAC) Chapter 24, Substantive Rules Applicable to Water and Sewer Service Providers, Subchapter G: Certificates of Convenience and Necessity

CCN Application Instructions

- I. **COMPLETE:** In order for the Commission to find the application sufficient for filing, you should adhere to the following:
- Answer every question and submit all required attachments.
 - Use attachments or additional pages if needed to answer any question. If you use attachments or additional pages, reference their inclusion in the form.
 - Provide all mapping information as detailed in Part F: Mapping & Affidavits.
 - Provide any other necessary approvals from the Texas Commission on Environmental Quality (TCEQ), or evidence that a request for approval is being sought at the time of filing with the Commission.
- II. **FILE:** Seven (7) copies of the completed application with numbered attachments. One copy should be filed with no permanent binding, staples, tabs, or separators; and 7 copies of the portable electronic storage medium containing the digital mapping data.
- SEND TO:** Public Utility Commission of Texas, Attention: Filing Clerk, 1701 N. Congress Avenue, P.O. Box 13326, Austin, Texas 78711-3326 (NOTE: Electronic documents may be sent in advance of the paper copy; however, they will not be processed and added to the Commission's on-line Interchange until the paper copy is received and file-stamped in Central Records).
- III. The application will be assigned a docket number, and an administrative law judge (ALJ) will issue an order requiring Commission Staff to file a recommendation on whether the application is sufficient. The ALJ will issue an order after Staff's recommendation has been filed:
- DEFICIENT (Administratively Incomplete):** Applicant will be ordered to provide information to cure the deficiencies by a certain date (usually 30 days from ALJ's order). *Application is not accepted for filing.*
 - SUFFICIENT (Administratively Complete):** Applicant will be ordered by the ALJ to give appropriate notice of the application using the notice prepared by Commission Staff. *Application is accepted for filing.*
- IV. Once the Applicant issues notice, a copy of the actual notice sent (including any map) and an affidavit attesting to notice should be filed in the docket assigned to the application. Recipients of notice may choose to take one of the following actions:
- HEARING ON THE MERITS:** an affected party may request a hearing on the application. The request must be made within 30 days of notice. If this occurs, the application may be referred to the State Office of Administrative Hearings (SOAH) to complete this request.
 - LANDOWNER OPT-OUT:** A landowner owning a qualifying tract of land (25+ acres) may request to have their land removed from the requested area. The Applicant will be requested to amend its application and file new mapping information to remove the landowner's tract of land, in conformity with this request.
- V. **PROCEDURAL SCHEDULE:** Following the issuance of notice and the filing of proof of notice in step 4, the application will be granted a procedural schedule for final processing. During this time the Applicant must respond to hearing requests, landowner opt-out requests, and requests for information (RFI). The Applicant will be requested to provide written consent to the proposed maps, certificates, and tariff (if applicable) once all other requests have been resolved.
- VI. **FINAL RECOMMENDATION:** After receiving all required documents from the Applicant, Staff will file a recommendation on the CCN request. The ALJ will issue a final order after Staff's recommendation is filed.

FAQ:

Who can use this form?

Any retail public utility that provides or intends to provide retail water or wastewater utility service in Texas.

Who is required to use this form?

A retail public utility that is an investor owned utility (IOU) or a water supply corporation (WSC) must use this form to obtain or amend a CCN prior to providing retail water or sewer utility service in the requested area.

What is the purpose of the application?

A CCN Applicant is required to demonstrate financial, managerial, and technical (FMT) capability to provide continuous and adequate service to any requested area. The questions in the application are structured to support an Applicant's FMT capabilities, consistent with the regulatory requirements.

Application Summary

Applicant: Forest Glen Utility Company

CCN No. to be amended: 21070

or ☐ Obtain NEW CCN ☐ Water ☒ Sewer

County(ies) affected by this application: Medina

Dual CCN requested with: _____

CCN No.: _____ (name of retail public utility)
☐ Portion or ☐ All of requested area

Decertification of CCN for: _____

CCN No.: _____ (name of retail public utility)
☐ Portion or ☐ All of requested area

Table of Contents

CCN Application Instructions	1
Part A: Applicant Information.....	3
Part B: Requested Area Information	4
Part C: CCN Obtain or Amend Criteria Considerations	6
Part D: TCEQ Public Water System or Sewer (Wastewater) Information	7
Part E: Financial Information	9
Part F: Mapping & Affidavits.....	10
Part G: Notice Information.....	11
Appendix A: Historical Financial Information (Balance Sheet and Income Schedule).....	13
Appendix B: Projected Information.....	16

Please mark the items included in this filing

<input type="checkbox"/> Partnership Agreement	Part A: Question 4
<input type="checkbox"/> Articles of Incorporation and By-Laws (WSC)	Part A: Question 4
<input type="checkbox"/> Certificate of Account Status	Part A: Question 4
<input type="checkbox"/> Franchise, Permit, or Consent letter	Part B: Question 7
<input checked="" type="checkbox"/> Existing Infrastructure Map	Part B: Question 8
<input checked="" type="checkbox"/> Customer Requests For Service in requested area	Part B: Question 9
<input checked="" type="checkbox"/> Population Growth Report or Market Study	Part B: Question 10
<input checked="" type="checkbox"/> TCEQ Engineering Approvals	Part B: Question 11
<input type="checkbox"/> Requests & Responses For Service to ½ mile utility providers	Part B: Question 12.B
<input type="checkbox"/> Economic Feasibility (alternative provider) Statement	Part B: Question 12.C
<input type="checkbox"/> Alternative Provider Analysis	Part B: Question 12.D
<input type="checkbox"/> Enforcement Action Correspondence	Part C: Question 16
<input type="checkbox"/> TCEQ Compliance Correspondence	Part D: Question 20
<input type="checkbox"/> Purchased Water Supply or Treatment Agreement	Part D: Question 23
<input type="checkbox"/> Rate Study (new market entrant)	Part E: Question 28
<input checked="" type="checkbox"/> Tariff/Rate Schedule	Part E: Question 29
<input checked="" type="checkbox"/> Financial Audit	Part E: Question 30
<input checked="" type="checkbox"/> Application Attachment A & B	Part E: Question 30
<input type="checkbox"/> Capital Improvement Plan	Part E: Question 30
<input type="checkbox"/> Disclosure of Affiliated Interests	Part E: Question 31
<input checked="" type="checkbox"/> Detailed (large scale) Map	Part F: Question 32
<input checked="" type="checkbox"/> General Location (small scale) Map	Part F: Question 32
<input checked="" type="checkbox"/> Digital Mapping Data	Part F: Question 32
<input checked="" type="checkbox"/> Signed & Notarized Affidavit	Page 12

Part A: Applicant Information

1. A. Name: Forest Glen Utility Company
(individual, corporation, or other legal entity)
☐ Individual ☒ Corporation ☐ WSC ☐ Other: _____
- B. Mailing Address: P.O. Box 701201
San Antonio, TX 78270
Phone No.: (830) 500-2114 Email: _____
- C. Contact Person. Please provide information about the person to be contacted regarding this application. Indicate if this person is the owner, operator, engineer, attorney, accountant, or other title.
Name: Randall B Wilburn Title: Attorney
Mailing Address: 7000 N. MoPac Expwy, Suite 200, Austin, TX 78731
Phone No.: (512) 431-8442 Email: rbw@gwtxlaw.com
2. If the Applicant is someone other than a municipality, is the Applicant currently paid in full on the Regulatory Assessment Fees (RAF) remitted to the TCEQ?
☒ Yes ☐ No ☐ N/A
3. If the Applicant is an Investor Owned Utility (IOU), is the Applicant current on Annual Report filings with the Commission?
☒ Yes ☐ No If no, please state the last date an Annual Report was filed: _____
4. The legal status of the Applicant is:
☐ Individual or sole proprietorship
☐ Partnership or limited partnership (*attach* Partnership agreement)
☒ Corporation: Charter number (recorded with the Texas Secretary of State): 0030347100
☐ Non-profit, member-owned, member controlled Cooperative Corporation [Article 1434(a) Water Supply or Sewer Service Corporation, incorporated under TWC Chapter 67]
Charter number (as recorded with the Texas Secretary of State): _____
☐ Articles of Incorporation and By-Laws established (*attach*)
☐ Municipally-owned utility
☐ District (MUD, SUD, WCID, FWSD, PUD, etc.)
☐ County
☐ Affected County (a county to which Subchapter B, Chapter 232, Local Government Code, applies)
☐ Other (please explain): _____
5. If the Applicant operates under an assumed name (i.e., any d/b/a), provide the name below:
Name: N/A

Part B: Requested Area Information

6. Provide details on the existing or expected land use in the requested area, including details on requested actions such as dual certification or decertification of service area.

The original CCN was granted in 2012 for sewer service to the then-new Potranco Ranch Subdivision. An amendment was granted in February 2018. This CCN amendment represents further expansion to this single family residential subdivision in rural Medina County, Texas. No dual certification or decertification is requested or anticipated.

7. The requested area (check all applicable):

- ☐ Currently receives service from the Applicant ☒ Is being developed with no current customers
☐ Overlaps or is within municipal boundaries ☐ Overlaps or is within district boundaries

Municipality: _____ District: _____

Provide a copy of any franchise, permit, or consent granted by the city or district. If not available please explain:

N/A

8. Describe the circumstances (economic, environmental, etc.) driving the need for service in the requested area:

The expansion of the CCN area will facilitate sewer service to 388 new connections on 185 additional acres in Potranco Oaks, Potranco Garden and future residential development associated with the Potranco Ranch Subdivision.

9. Has the Applicant received any requests for service within the requested area?

☒ Yes* ☐ No *Attach copies of all applicable requests for service and show locations on a map

10. Is there existing or anticipated growth in the requested area?

☒ Yes* ☐ No *Attach copies of any reports and market studies supporting growth

11. A. Will construction of any facilities be necessary to provide service to the requested area?

☐ Yes* ☒ No *Attach copies of TCEQ approval letters

B. Date Plans & Specifications or Discharge Permit App. submitted to TCEQ: Existing TPDES Permit

C. Summarize an estimated timeline for construction for any required facilities to serve the requested area:

Internal infrastructure will be constructed as part of new subdivision development.

D. Describe the source and availability of funds for any required facilities to serve the requested area:

Forest Glen will make investments or guarantee financing of any required facilities (debt and equity).

Note: Failure to provide applicable TCEQ construction or permit approvals, or evidence showing that the construction or permit approval has been filed with the TCEQ may result in the delay or possible dismissal of the application.

12. A. If construction of a physically separate water or sewer system is necessary, provide a list of all retail public water and/or sewer utilities within one half mile from the outer boundary of the requested area below:

N/A

B. Did the Applicant request service from each of the above water or sewer utilities?

☐ Yes*

☒ No

*Attach copies of written requests and copies of the written response

C. Attach a statement or provide documentation explaining why it is not economically feasible to obtain retail service from the water or sewer retail public utilities listed above.

D. If a neighboring retail public utility agreed to provide service to the requested area, attach documentation addressing the following information:

- (A) A description of the type of service that the neighboring retail public utility is willing to provide and comparison with service the applicant is proposing;
- (B) An analysis of all necessary costs for constructing, operating, and maintaining the new facilities for at least the first five years of operations, including such items as taxes and insurance; and
- (C) An analysis of all necessary costs for acquiring and continuing to receive service from the neighboring retail public utility for at least the first five years of operations.

13. Explain the effect of granting the CCN request on the Applicant, any retail public utility of the same kind serving in the proximate area, and any landowners in the requested area. The statement should address, but is not limited to, regionalization, compliance, and economic effects.

Issuance of the CCN will ensure the new subdivision will receive environmentally-protective service from an organized sewer system, which is much more protective than septic systems. No other retail public utility provider is within 1 mile of the development. The City of Castroville is approximately 6 miles from the development and lacks capacity to serve. The San Antonio Water System has facilities in Bexar County 1.35 miles from the site; however, SAWS will not serve in Medina County and previously declined requests for service when Forest Glen requested initial authorization.

Part C: CCN Obtain or Amend Criteria Considerations

14. Describe the anticipated impact and changes in the quality of retail utility service for the requested area:

Issuance of the CCN will allow the retail public utility to provide high quality and environmentally-protective retail utility service to the requested area. As such, issuance of the CCN shall have a positive impact on the requested area.

15. Describe the experience and qualifications of the Applicant in providing continuous and adequate retail service:

FGU currently serves the Potranco Ranch subdivision and has a satisfactory compliance history with TCEQ and PUC.

16. Has the Applicant been under an enforcement action by the Commission, TCEQ, Texas Department of Health (TDH), the Office of the Attorney General (OAG), or the Environmental Protection Agency (EPA) in the past five (5) years for non-compliance with rules, orders, or state statutes?

☐ Yes* ☒ No

*Attach copies of any correspondence with the applicable regulatory agency concerning any enforcement actions, and attach a description of any actions or efforts the Applicant has taken to comply with these requirements.

17. Explain how the environmental integrity of the land will or will not be impacted or disrupted as a result of granting the CCN as requested:

Since the CCN amendment accommodates a growing residential development, environmental integrity will not be impacted or disrupted.

18. Has the Applicant made efforts to extend retail water or sewer utility service to any economically distressed area located within the requested area?

N/A

19. List all neighboring water or sewer retail public utilities, cities, districts (including ground water conservation districts), counties, or other political subdivisions (including river authorities) providing the same service located within two (2) miles from the outer boundary of the requested area:

San Antonio Water Systems (SAWS)

Part D: TCEQ Public Water System or Sewer (Wastewater) Information

20. A. Complete the following for all Public Water Systems (PWS) associated with the Applicant's CCN:

TCEQ PWS ID:	Name of PWS:	Date of TCEQ inspection*:	Subdivisions served:
N/A			

*Attach evidence of compliance with TCEQ for each PWS

- B. Complete the following for all TCEQ Water Quality (WQ) discharge permits associated with the Applicant's CCN:

TCEQ Discharge Permit No:	Date Permit expires:	Date of TCEQ inspection*:	Subdivisions served:
WQ- 15030-001	10/17/2023	4/9/2020	Potranco Ranch Subdivision
WQ-			
WQ-			
WQ-			

*Attach evidence of compliance with TCEQ for each Discharge Permit

- C. The requested CCN service area will be served via: PWS ID:
WQ - 15030-001

21. List the number of existing connections for the PWS & Discharge Permit indicated above (Question 20. C.):

Water				Sewer	
	Non-metered		2"	488	Residential
	5/8" or 3/4"		3"		Commercial
	1"		4"		Industrial
	1 1/2"		Other		Other
Total Water Connections:				Total Sewer Connections:	488

22. List the number of additional connections projected for the requested CCN area:

Water				Sewer	
	Non-metered		2"	388	Residential
	5/8" or 3/4"		3"		Commercial
	1"		4"		Industrial
	1 1/2"		Other		Other
Total Water Connections:				Total Sewer Connections:	

23. A. Will the system serving the requested area purchase water or sewer treatment capacity from another source?

☐ Yes* ☒ No *Attach a copy of purchase agreement or contract.

Capacity is purchased from:

Water: _____

Sewer: _____

- B. Are any of the Applicants PWS's required to purchase water to meet the TCEQ's minimum capacity requirements or TCEQ's drinking water standards?

☐ Yes ☒ No

- C. What is the amount of supply or treatment purchased, per the agreement or contract? What is the percent of overall demand supplied by purchased water or sewer treatment (if any)?

	Amount in Gallons	Percent of demand
Water:		0%
Sewer:		0%

24. Does the PWS or sewer treatment plant have adequate capacity to meet the current and projected demands in the requested area?

☒ Yes ☐ No

25. List the name, class, and TCEQ license number of the operators that will be responsible for the operations of the water or sewer utility service provided to the requested area:

Name (as it appears on license)	Class	License No.	Water/Sewer
Jason Smith	C	0033076	Wastewater

26. A. Are any improvements required for the existing PWS or sewer treatment plant to meet TCEQ or Commission standards?

☒ Yes ☐ No

- B. Provide details on each required major capital improvement necessary to correct deficiencies to meet the TCEQ or Commission standards (attach any engineering reports or TCEQ approval letters):

Description of the Capital Improvement:	Estimated Completion Date:	Estimated Cost:
Adding wastewater treatment unit "train" to accommodate an interim phase flow of 0.144 MGD	2/1/2021	\$ 777,727.00
enlarge chlorine contact chamber	2/1/2021	\$ 37,020.00
pretreatment screening at new headworks (included in 3rd train improvement cost)	6/1/2021	

27. Provide a map (or maps) showing all facilities for production, transmission, and distribution, and the location of existing or proposed customer connections, in the requested area. Facilities should be identified on subdivision plats, engineering planning maps, or other large scale maps. Color coding can be used, and is encouraged, to distinguish types of facilities.

Part E: Financial Information

28. If the Applicant seeking to obtain a CCN for the first time is an Investor Owned Utility (IOU) and under the original rate jurisdiction of the Commission, a proposed tariff must be attached to the application. The proposed rates must be supported by a rate study, which provides all calculations and assumptions made. Once a CCN is granted, the Applicant must submit a rate filing package with the Commission within 18 months from the date service begins. The purpose of this rate filing package is to revise a utility's tariff to adjust the rates to a historic test year and to true up the new tariff rates to the historic test year. It is the Applicant's responsibility in any future rate proceeding to provide written evidence and support for the original cost and installation date of all facilities used and useful for providing utility service. Any dollar amount collected under the rates charged during the test year in excess of the revenue requirement established by the Commission during the rate change proceeding shall be reflected as customer contributed capital going forward as an offset to rate base for ratemaking purposes.

29. If the Applicant is an existing IOU, please attach a copy of the current tariff and indicate:

- A. Effective date for most recent rates: 4/5/2019
- B. Was notice of this increase provided to the Commission or a predecessor regulatory authority?
☐ No ☒ Yes Application or Docket Number: 47897
- C. If notice was not provided to the Commission, please explain why (ex: rates are under the jurisdiction of a municipality)

If the Applicant is a Water Supply or Sewer Service Corporation (WSC/SSC) and seeking to obtain a CCN, attach a copy of the current tariff.

30. **Financial Information**

Applicants must provide accounting information typically included within a balance sheet, income statement, and statement of cash flows. If the Applicant is an existing retail public utility, this must include historical financial information and projected financial information. However, projected financial information is only required if the Applicant proposes new service connections and new investment in plant, or if requested by Commission Staff. If the Applicant is a new market entrant and does not have its own historical balance sheet, income statement, and statement of cash flows information, then the Applicant should establish a five-year projection.

Historical Financial Information may be shown by providing any combination of the following that includes necessary information found in a balance sheet, income statement, and statement of cash flows:

1. Completed Appendix A;
2. Documentation that includes all of the information required in Appendix A in a concise format; or
3. Audited financial statements issued within 18 months of the application filing date. This may be provided electronically by providing a uniform resource locator (URL) or a link to a website portal.

Projected Financial Information may be shown by providing any of the following:

1. Completed Appendix B;
2. Documentation that includes all of the information required in Appendix B in a concise format;
3. A detailed budget or capital improvement plan, which indicates sources and uses of funds required, including improvements to the system being transferred; or
4. A recent budget and capital improvements plan that includes information needed for analysis of the operations test for the system being transferred and any operations combined with the system. This may be provided electronically by providing a uniform resource locator (URL) or a link to a website portal.

- 31.** Attach a disclosure of any affiliated interest or affiliate. Include a description of the business relationship between all affiliated interests and the Applicant.

DO NOT INCLUDE ATTACHMENTS A OR B IF LEFT BLANK

Part F: Mapping & Affidavits

- 32.** Provide the following mapping information with each of the seven (7) copies of the application:

1. A general location (small scale) map identifying the requested area in reference to the nearest county boundary, city, or town. The Applicant should adhere to the following guidance:
 - i. If the application includes an amendment for both water and sewer certificated service areas, separate maps must be provided for each.
 - ii. A hand drawn map, graphic, or diagram of the requested area is not considered an acceptable mapping document.
 - iii. To maintain the integrity of the scale and quality of the map, copies must be exact duplicates of the original map. Therefore, copies of maps cannot be reduced or enlarged from the original map, or in black and white if the original map is in color.
2. A detailed (large scale) map identifying the requested area in reference to verifiable man-made or natural landmarks such as roads, rivers, and railroads. The Applicant should adhere to the following guidance:
 - i. The map should be clearly labeled and the outer boundary of the requested area should be marked in reference to the verifiable man-made or natural landmarks. These verifiable man-made and/or natural landmarks must be labeled and marked on the map as well.
 - ii. If the application includes an amendment for both water and sewer certificated service area, separate maps need to be provided for each.
 - iii. To maintain the integrity of the scale and quality of the map, copies must be exact duplicates of the original map. Therefore, copies of maps cannot be reduced or enlarged from the original map, or in black and white if the original map is in color.
3. One of the following identifying the requested area:
 - i. A metes and bounds survey sealed or embossed by either a licensed state land surveyor or a registered professional land surveyor. Please refer to the mapping guidance in part 2 (above);

- ii. A recorded plat. If the plat does not provide sufficient detail, Staff may request additional mapping information. Please refer to the mapping guidance in part 2 (above); or
- iii. Digital mapping data in a shapefile (SHP) format georeferenced in either NAD 83 Texas State Plane Coordinate System (US Feet) or in NAD 83 Texas Statewide Mapping System (Meters). The digital mapping data shall include a single, continuous polygon record. The following guidance should be adhered to:
 - a. The digital mapping data must correspond to the same requested area as shown on the general location and detailed maps. The requested area must be clearly labeled as either the water or sewer requested area.
 - b. A shapefile should include six files (.dbf, .shp, .shx, .sbx, .sbn, and the projection (.prj) file).
 - c. The digital mapping data shall be filed on a data disk (CD or USB drives), clearly labeled, and filed with Central Records. Seven (7) copies of the digital mapping data is also required.

Part G: Notice Information

The following information will be used to generate the proposed notice for the application.
DO NOT provide notice until the application is deemed sufficient for filing and the Applicant is ordered to provide notice.

33. Complete the following using verifiable man-made and/or natural landmarks such as roads, rivers, or railroads to describe the requested area (to be stated in the notice documents). Measurements should be approximated from the outermost boundary of the requested area:

The total acreage of the requested area is approximately: 185

Number of customer connections in the requested area: 0

The closest city or town: City of Castroville

Approximate mileage to closest city or town center: 6

Direction to closest city or town: south/southwest

The requested area is generally bounded on the North by: FM 1957 (Potranco Road)

on the East by: FM 471

on the South by: _____

on the West by: _____

34. A copy of the proposed map will be available at _____

Applicant's Oath

STATE OF Texas

COUNTY OF Bexar

I, Mia Natalino being duly sworn, file this application to
obtain or amend a water or sewer CCN, as General Manager
(owner, member of partnership, title as officer of corporation, or authorized representative)

I attest that, in such capacity, I am qualified and authorized to file and verify such application, am personally familiar with the documents filed with this application, and have complied with all the requirements contained in the application; and, that all such statements made and matters set forth therein with respect to Applicant are true and correct. Statements about other parties are made on information and belief. I further state that the application is made in good faith and that this application does not duplicate any filing presently before the Commission.

I further represent that the application form has not been changed, altered, or amended from its original form.

I further represent that the Applicant will provide continuous and adequate service to all customers and qualified applicants within its certificated service area should its request to obtain or amend its CCN be granted.

Mia Natalino Mia Natalino

AFFIANT

(Utility's Authorized Representative)

If the Affiant to this form is any person other than the sole owner, partner, officer of the Applicant, or its attorney, a properly verified Power of Attorney must be enclosed.

SUBSCRIBED AND SWORN BEFORE ME, a Notary Public in and for the State of Texas
this day the 11th of February, 20 21

SEAL



Rebecca Nollen

**NOTARY PUBLIC IN AND FOR THE
STATE OF TEXAS**

REBECCA NOLLEN

PRINT OR TYPE NAME OF NOTARY

My commission expires: 6-3-24

**FOREST GLEN UTILITY COMPANY - APPLICATION FOR CCN AMENDMENT
ATTACHMENT 9**

From:

Harry Hausman

15720 Bandera Rd. #103

Helotes TX. 78023

To:

Steven Greenberg

Forest Glen Utility

1918 Summerwood

San Antonio, TX 78232

Re: Request for Non-Standard Service for +/- 185 acres on Potranco Road known as Potranco Oaks

Dear Mr. Greenberg,

Attached please find our non-standard service application requesting wastewater treatment service be established to fulfill the needs of the new planned development described in the application.

Sincerely,

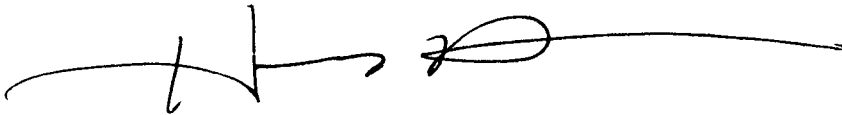
A handwritten signature in black ink, consisting of a stylized 'H' followed by a horizontal line and a small flourish.

Harry Hausman

Forest Glen Utility
1918 Summerwood Dr
San Antonio, Texas 78232
Tel: 210-968-0776

NON-STANDARD SERVICE APPLICATION

Select One:

_____Applying for development of new regulated utility retail service

XApplying for service extension

Name of Development: Potranco Oaks / Gardens

Maximum Number of Lots: 388 SFR Total Acreage: 185

Name of Applicant: Hausman Holdings

Name & Title of Person Completing Application: _____

Mailing Address: 15720 Bandera Rd #103, Helotes TX 78023

Phone: 210.695.6580

E-mail: marymhoyt@gmail.com

Name of Property Owner: HK Development

Mailing Address: 15720 Bandera Rd #103, Helotes TX 78023

Phone: _____

E-mail: _____

Responsible Engineer: Paul Landa Firm: MTR Engineers

Mailing Address: _____

Phone: _____

E-mail: _____

Property description: (State legal description or attach copy of deed)

185 acres near the intersection of Potranco Rd and Barden Parkway

Describe all intended land uses in the Development: (Attach additional sheets if necessary)

☒ Residential Subdivision ☐ Apartments ☐ Manufactured Home ☐ RV Park

☐ Commercial or other:

**FOREST GLEN UTILITY COMPANY - APPLICATION FOR CCN AMENDMENT
ATTACHMENT 10**

Forest Glen Utility Company Market Research Summary

Forest Glen Utility Company, LLC.
P.O. Box 701201, San Antonio, TX 78270
(210) 209 - 8029

Originated: 13 August 2019
Updated: 14 August 2019

BVRT Water Resources

Steven Greenberg
916-799-1560
steveg@bvrwater.com

Table of Contents

Medina County Census Data and Population Projections	3
Real Estate Market.....	3
San Antonio – New Braunfels Housing Data Profile	3
City of Castroville Overview	4

Forest Glen Utility Market Research Summary

Forest Glen Utility serves the Potranco Ranch subdivision located in Medina County, Texas.

Medina County Census Data and Population Projections

Population	
Population estimates, July 1, 2018, (V2018)	50,921
Population estimates base, April 1, 2010, (V2018)	46,006
Population, percent change - April 1, 2010 (estimates base) to July 1, 2018, (V2018)	10.7%
Population, Census, April 1, 2010	46,006

Table 1. Census.gov, QuickFacts

Real Estate Market

Housing	
Housing units, July 1, 2018, (V2018)	18,708
Owner-occupied housing unit rate, 2013-2017	82.1%
Median value of owner-occupied housing units, 2013-2017	\$134,400
Median selected monthly owner costs -with a mortgage, 2013-2017	\$1,299
Median selected monthly owner costs -without a mortgage, 2013-2017	\$398
Median gross rent, 2013-2017	\$732
Building permits, 2018	31
Families & Living Arrangements	
Households, 2013-2017	15,154
Persons per household, 2013-2017	3.03
Living in same house 1 year ago, percent of persons age 1 year+, 2013-2017	87.1%

Table 2. Census.gov, QuickFacts

San Antonio – New Braunfels Housing Data Profile

	2000	2010	Current	Average Annual Change (%)	
				2000 to 2010	2010 to Current
Total Resident Employment	787,868	943,771	1,141,000	1.8	2.5
Unemployment Rate	3.9%	7.2%	3.3%		
Total Nonfarm Payroll Jobs	753,900	855,000	1,052,000	1.3	2.7
Total Population	1,711,703	2,142,508	2,530,000	2.3	2.0
Total Households	601,265	763,022	900,300	2.4	2.0
Owner Households	387,770	488,523	557,900	2.3	1.6
Percent Owner	64.5%	64.0%	62.0%		
Renter Households	213,495	274,499	342,400	2.5	2.7
Percent Renter	35.5%	36.0%	38.0%		
Total Housing Units	648,593	837,999	963,600	2.6	1.7
Sales Vacancy Rate	1.5%	2.0%	1.5%		
Rental Vacancy Rate	7.0%	9.5%	7.0%		
Median Family Income	\$41,900	\$57,200	\$63,500	3.2	1.3

Notes: Median Family Incomes are for 1999, 2009, and 2017. Employment data represent annual averages for 2000, 2010, and the 12 months through August 2018.

Sources: Estimates by analyst; U.S. Census Bureau; U.S. Department of Housing and Urban Development

Table 3. U.S. HUD, Office of Policy Development and Research 2018 Comprehensive Market Analysis

City of Castroville Overview

Castroville Demographics

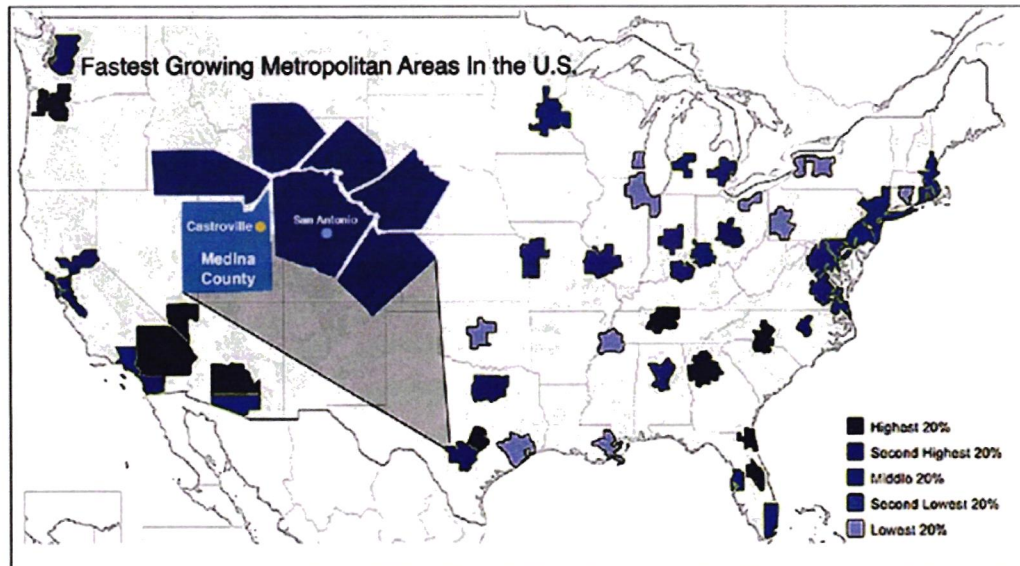

Figure 1a, 1b. Castroville Area Economic Development Council

Location -Medina County The 8th fastest growing small county in the U.S.

Population	3,059
Climate, Average Temperature	82 degrees
Cost of Living, March 2016	83.0 vs. 100.00 US average
Median Resident Age	40.7 years
Average Median Income	\$65,495 (2018 est.)
Property Taxes, Castroville	2.499
Comparisons	
Houston	3.503
Pittsburgh, PA	10.439
Chicago	7.390

Housing

Average Single Family House Sales Price in 2018 has been \$255,000

Labor Force

Employed	95%
Unemployed	5%

Transportation

Major Highways are U.S. 90, four lane-divided
State System Farm to Market highways 471 & 1343
Castroville Municipal Airport with 5,001' runway with Jet-A &
AV gas, with San Antonio International Airport only 30 miles away.

Education

Elementary Schools	3
Middle Schools	2
High Schools	1
Private Schools (3yrs to 5th grade)	1

Distance to Major Cities

San Antonio	22 miles
Austin	105 miles
Corpus Christi	167 miles
Dallas/Ft. Worth	300 miles
El Paso	550 miles
Houston	220 miles

**FOREST GLEN UTILITY COMPANY - APPLICATION FOR CCN
AMENDMENT ATTACHMENT 11**

**FOREST GLEN UTILITY EXPANSION
IN MEDINA COUNTY, TEXAS
PRELIMINARY ENGINEERING REPORT**

March 3, 2021

RE: Forest Glen Utility (FGU) Wastewater Treatment Plant
CCN Expansion in Medina County Texas

Prepared by: Mia Natalino, P.E. (PE License No. 91829)
FGU General Manager

1.0 PURPOSE

This preliminary engineer report serves as a summary of design assumptions used in determination of the hereinafter stated minimum wastewater system components, sizes, and capacities. This report is prepared for the purpose of obtaining approval from the Texas Public Utility Commission (the "PUCT") for a sewer Certificate of Convenience and Necessity ("CCN").

2.0 INTRODUCTION

The proposed CCN expansion area is comprised of a Master planned community called Potranco Oaks / Potranco Gardens includes 185 acres and 388 single family residential homes. The development is directly adjacent to Potranco Ranch Subdivision and is a residential development with open spaces, greenbelts, and parks.

This report is intended to provide general background information regarding the proposed residential development and the expansion of Forest Glen Utility services. Also, the report is intended to provide technical information regarding system capacities in relation to the minimum requirements for a wastewater system, as required by Chapter 317 of the TCEQ rules.

3.0 AREAS SERVED

Forest Glen Utility currently serves 488 customers within Potranco Ranch and Potranco Ranch West Subdivisions within Medina County, Texas, and the development is bound by Farm-to-Market Road 1957 (Potranco Road) to the north and east of FM 471.

The proposed expansion of wastewater systems will serve all of the current residents and expand facilities to serve and adjacent subdivision of Potranco Oaks / Potranco Gardens Subdivision which encompasses 185 acres and 388 additional customers. The wastewater system will be designed to serve approximately 900 total equivalent wastewater connections (based on an assumption of 240 gallons per day/connection) at full build out.

Attachment 1 Master Development Plan and phasing of the new subdivision and customer base, Potranco Oaks / Potranco Gardens.

4.0 DESIGN ASSUMPTIONS

Wastewater usage of 240 gallons per day ("gpd") per one living unit equivalent ("LUE") was used to estimate the total water usage for the development based on the proposed land usage within the TCEQ guidelines. Full build out of Forest Glen Utility is approximately 216,000 gallons per day. For the basis for developing an estimated wastewater usage schedule, the following design assumptions were used.

Single Family Residence	1 LUE/Residence
Multi-Family Residence	0.7 LUE/Unit
Office	1 LUE/3,000 square feet of Office
Retail or Commercial	1 LUE/1,660 square feet of Retail or Commercial
School	1 LUE/15 Students

Attachment 2 Technical Summary Letter approved by the TCEQ.

5.0 SITE LOCATION

The proposed locations of the expansion facilities are shown within the Facilities map that is being submitted as part of the application package. FGU will verify the final location of these facilities at a later date after subdivision plats are developed and a CCN is issued. In any case, all wastewater facilities will have perimeter fencing as required by the TCEQ, with appropriate buffer zone requirements and clearances for site maintenance.

6.0 SUMMARY

This preliminary engineering report is intended to summarize the engineering design for providing wastewater service for Potranco Ranch and Potranco Oaks Subdivisions that meets the minimum design requirements of the TCEQ. Upon obtaining a CCN from the PUC, FGU's engineering team will prepare a detailed engineering analysis to select one of the design options that will best serve the development. Upon completion of wastewater system designs, Forest Glen Utility will develop a complete set of plans and specifications and submit them to the TCEQ for review and approval.



Mia Natalino, P.E. 91829

Jon Niermann, *Chairman*
Emily Lindley, *Commissioner*
Bobby Janecka, *Commissioner*
Toby Baker, *Executive Director*

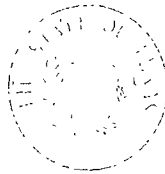

TEXAS COMMISSION ON ENVIRONMENTAL QUALITY

Protecting Texas by Reducing and Preventing Pollution

July 17, 2020

Paul Wood, P.E.
Lockwood Andrews & Newnam Inc.
2925 Briarpark Drive; Suite 400
Houston, TX 77042

Re: Forest Glen Utility Company
Forest Glen Utility Co.- Potranco Ranch WWTP Expansion
Permit No. WQ0015030-001
WWPR Log No. 0420/078
CN600701247, RN106339385
Medina County

Dear Mr. Wood:

On April 27, 2020, TCEQ received the project summary transmittal letter dated April 23, 2020 for an expansion project of the Forest Glen Utilities Potranco Ranch wastewater treatment plant in Medina County, Texas. The scope of the submitted expansion project is to do the following:

- Design and build a third 36,000 gpd treatment train at the existing plant site bringing the treatable average daily flow to the current permit interim II phase value of 0.108 MGD with a corresponding peak daily flow of 0.324 MGD (3Q)
- Update the influent design organic loading from 200 mg/l to 300 mg/l
- Upgrade the aeration basing volume of existing treatment trains 1 and 2 from 4 aeration basins to 6 aeration basins per train to handle the increased designed organic loading
- Relay, approximately a year after the third treatment train is installed, a fourth treatment train matching the third train will be installed to increase the treatable average daily flow to 0.144 MGD with a corresponding peak flow of 0.432 MGD; this change will require an amendment to the current Water Quality permit to add this as an interim flow and this permit work must be completed before construction can begin
- Relay that there is an updated cloth filtration system designed which will not to be installed as part of the work for this project; the updated design will allow for moving away from the combined bag and spin filter system currently being used

The facility is regulated by Water Quality permit WQ0015030001. The current permitted final phase flow values are an average daily flow of 0.108 MGD with a corresponding peak daily flow of 0.324 MGD. The treatment system must produce an effluent which meets effluent concentration limits of 20 mg/l of CBOD₅, 20 mg/l for TSS, and 126 cfu/100 ml for E.coli while maintaining a minimum dissolved oxygen concentration of 2.0 mg/l. The resulting treatment system after completion of this project's scope of work for this project is listed below.

The scope of the submitted project will include the following work items and produce the plant configuration:

- Treatment Trains 1 & 2 (existing treatment trains)
 - Increase the number of aeration basins from 4 basins per train to 6 basins per train; additional 1,512 ft³ producing approximately 20 lb. BOD₅ per 1000 ft³ for the 300 mg/l organic loading
- Addition of treatment train 3
 - 6 aeration basins – each concrete basin to be 12' x 6' x 10.5' SWD; 4,536 ft³ of aerated moving bed bioreactor (MBBR) basin with high efficiency plastic fluidized media in 30% on the basin volume with retention screens for the media with coarse bubble aeration
 - 2 - 12' x 6' x 10.5 SWD concrete basins to serve as flow equalization
 - 1 - 12' x 6' x 10.5 SWD concrete basin to serve as sludge holding chamber
 - 2 - 12' x 6' x 10.5 SWD concrete basins fitted with plates; 4 per basins, to create a hopper bottom like clarifiers with mechanical scrapper, the mechanical scrapper alleviate the issue of the 10,000 gpd maximum flow for a hopper bottom clarifier due to the normal hopper bottom clarifiers having to be manually scrapped
 - 2 - 12' x 6' x 9.5 SWD concrete basins (1,368 ft³) in series to be used as chlorine contact basins; the two basins will allow for a treatable flow of the current permitted final flow of 0.24 MGD (corresponding peak flow of 0.720 MGD
 - An influent side hill screen (one per train), 158 gpm capacity

Other work items and equipment included with the scope of this project include the following:

- Installation of a splitter box to allow four equal splits (3 to be used for this phase)
- Installation of 1 - 30 scfm blower and coarse bubble diffusers for the equalization basins
- Installation of 1 - submersible flow equalization pump 1/2 HP,
- Installation of 1 – sludge holding supernatant pump, 1/2 HP
- Installation of 2 – 202 scfm 7.5 HP blowers
- 6 Jet aerseal coarse bubble diffusers per MBBR basin
- 11 feet of V notch weir per clarifier basin, airlift surface skimmers, airlift sludge waste valves
- Automatic control units
- Installation of a new manhole with a flash mixer downstream of the MBBR and clarification units for introduction of the chlorine solution
- Use of calcium hypochlorite chlorination solution; if issues arise sodium hypochlorite solution can be used for chlorination
- Installation of a new effluent pump station to pump water to the authorized reuse storage tank or to the discharge outfall as the plant location does not allow for gravity flow
- Increasing the on-site lift station capacity to allow for a capacity of 225 gpm

TCEQ understands that the plant needs to and currently uses a filtration system to meet standards for Type I reclaimed water under 30 TAC Chapter 210. The current system uses a combination of bag filters and spin filters. A new expandable filter system has been designed which will use solely cloth media filters. Since the current system is still operational there is no current time frame for installation of the new designed cloth media filter system.

The summary transmittal letter also contained request for 5 variances to 30 TAC Chapter 217 requirements:

- The first requested variance is to 217.123(b) which requires a screenings holding container to have a tight-fitting cover or must use an alternative method of reducing vector attraction approved in writing by the Executive Director. The Engineer is proposing to not have a tight-fitting cover. The screenings will be washed and compacted as part of the headworks operation before they enter the screenings holding area. Handling screenings in this manner meets the intent of the alternative so the requested variance is conditionally granted. If the proposed system is unable to produce the desired vector and odor abatement, or if odor complaints are received and determined to be caused by screenings the granting of the requested variance may be rescinded, and a tight-fitting enclosure be required
- The second requested variance is for the use of a moving bed bioreactor (MBBR) system. Use of an MBBR is not directly addressed in the 30 TAC Chapter 217 requirements. Other treatment systems using moving bed attached media have been installed within Texas; including the existing Potranco Ranch system. TCEQ has reviewed and approved these installations. Given that it is not specifically addressed in 30 TAC Chapter 217 requirements TCEQ determines the use of these installations on a case-by-case basis. By this letter, TCEQ is conditionally granting the use of the MBBR system at the Potranco Ranch facility for the new treatment trains 3 & 4. The condition of the granting the use of the MBBR systems are that, as needed, excess air be supplied to sluff off and clean organic matter from the attachment media to ensure that no overabundance of organic matter condition exists where it would deleteriously affect the ability to act as an attachment media.
- The third variance is for 217.154(c)(1) which requires a clarifier to produce 1.8 hr. of detention time and surface loading of not more than 1200 gpd/sf. At peak flow conditions each treatment train will be required to treat 0.108 MGD (1/3 of the total plant permitted peak flow 0.324 MGD) through two clarifiers operating in series. The initial clarifier will produce a surface loading of 1500 gpd/ft² and retention time of approximately 1 hr. The trains initial clarifier will produce a reduction in solids. Since the two clarifiers will be operated in series the system should be able to produce the 30 TAC 217 required results of 1.8 hours of detention time and an adequate surface loading rate therefore the requested variance is conditionally granted.
- The fourth variance requested is to 217.190(g) which requires the addition of chlorine to a filter system to control slime growth. The filtration system is used to polish the effluent to the more stringent total suspended solids (TSS) and turbidity limits of the systems' 30 TAC 210 Reclaimed Water authorization. The reclaimed water system is downstream of the chlorine contact basins. If the water is chlorinated correctly and receives the required contact time, there is reason to believe that the influent water at the filtration system may have adequate chlorine residual to aide in abating slime growth in the filtration system. It is understood that heavily chlorinated water can deteriorate cloth filters but there is also a need for some chlorinated water to stop slime growth. The requested variance is conditionally granted on the condition of the slime growth not occur. If slime becomes an issue on the filters, once installed, the granted variance may be rescinded, and the issue revisited.
- The final variance requested was to 217.193(e)(4) which requires a turbidity monitor be installed for each filter. The design of the filters for this case includes filters which can be individually take offline for maintenance and cleaning, or just out of service. Given

that each individual filter media can be offline each individual filter must be piped separately to an effluent area. The Engineer is proposing to have a single collection area for all filters in a specific basin and monitor the turbidity for each basin separately. TCEQ has approved filter system like this system in the past therefore and therefore grants the requested variance.

The TCEQ review of the proposed project submittal seems to indicate that the treatment system as designed including the granted variances, if operated as indicated in the submitted documentation meets at least the minimum requirements of 30 TAC Chapter 217: Design Criteria for Wastewater Systems and should allow the plant to meet the permitted effluent limits. Given the result of the TCEQ review the 0.036 MGD ADF plant expansion project including the addition of the 3rd treatment train, and upgrades to treatment trains 1 and 2 are conditionally approved for completion as is the 4th treatment train. The conditions of this approval are as follows:

- **The two chlorine contact basin units be fitted with interior baffles to make a serpentine flow pattern to ensure the required 20 minutes of contact time be met 100% of the time**
- **The TSS at the discharge point and turbidity at the reclaimed water plant be monitored as required by the issued authorizations and if sampling indicates issues the new filtration system be implemented and that the system be able, per the 30 TAC 217 requirement, to filter the current peak daily flow at all times**
- **The 4th treatment train be constructed identical to the treatment train 3**
- **The 4th treatment train be implemented after a permit amendment is obtained for a flow of greater than 0.108 MGD and for a maximum flow not to exceed 0.144 MGD.**
- **Additional treatment capacity beyond the scope of this project and the ensuing 0.036 MGD 4th treatment train be implemented for flows exceeding 0.144 MGD**

You must keep certain materials on file for the life of the project and provide them to TCEQ upon request. These materials include an engineering report, test results, a summary transmittal letter, and the final version of the project plans and specifications. These materials shall be prepared and sealed by a Professional Engineer licensed in the State of Texas and must show substantial compliance with Chapter 217. All plans and specifications must conform to any waste discharge requirements authorized in a permit by the TCEQ. Certain specific items which shall be addressed in the engineering report are discussed in §217.10. Additionally, the engineering report must include all constants, graphs, equations, and calculations needed to show substantial compliance with Chapter 217.

If in the future, additional variances from the Chapter 217 requirements are desired for the project, each variance must be requested in writing by the design engineer. Then, the TCEQ will consider granting a written approval to the variance from the rules for the specific project and the specific circumstances.

Paul Wood, P.E.
Page 5
July 17, 2020

Within 60 days of the completion of construction, an appointed engineer shall notify both the Wastewater Permits Section of the TCEQ and the appropriate Region Office of the date of completion. The engineer shall also provide written certification that all construction, materials, and equipment were substantially in accordance with the approved project, the rules of the

TCEQ, and any change orders filed with the TCEQ. All notifications, certifications, and change orders must include the signed and dated seal of a Professional Engineer licensed in the State of Texas.

Please be reminded of 30 TAC §217.7(a) of the rules which states, "Approval given by the executive director or other authorized review authority does not relieve an owner of any liability or responsibility with respect to designing, constructing, or operating a collection system or treatment facility in accordance with applicable commission rules and the associated wastewater permit".

If you have any questions, or if we can be of any further assistance, please call me at (512) 239-1372.

Sincerely,

A handwritten signature in black ink that reads "Paul A. Brochi" followed by a horizontal line.

Paul A. Brochi, P.E.
Wastewater Permits Section (MC 148)
Water Quality Division
Texas Commission on Environmental Quality

PAB/tc



TPDES PERMIT NO. WQ0015030001
[For TCEQ office use only - EPA I.D.
No. TX0133442]

TEXAS COMMISSION ON ENVIRONMENTAL QUALITY
P.O. Box 13087
Austin, Texas 78711-3087

This major amendment supersedes and
replaces TPDES Permit No.
WQ0015030001 issued on March 9,
2015.

PERMIT TO DISCHARGE WASTES
under provisions of
Section 402 of the Clean Water Act
and Chapter 26 of the Texas Water Code

Forest Glen Utility Company

whose mailing address is

15720 Bandera Road, Suite 103
Helotes, Texas 78023

is authorized to treat and discharge wastes from the Potranco Ranch Subdivision Wastewater
Treatment Facility, SIC Code 4952

located approximately 3.54 miles west of State Highway 211, on the south side of Farm-to-Market 1957
(Potranco Road), in Medina County, Texas 78009

to an unnamed tributary; thence to Big Sous Creek; thence to Medina River Below Medina Diversion
Lake in Segment No. 1903 of the San Antonio River Basin

only according to effluent limitations, monitoring requirements, and other conditions set forth in this
permit, as well as the rules of the Texas Commission on Environmental Quality (TCEQ), the laws of the
State of Texas, and other orders of the TCEQ. The issuance of this permit does not grant to the
permittee the right to use private or public property for conveyance of wastewater along the discharge
route described in this permit. This includes, but is not limited to, property belonging to any individual,
partnership, corporation, or other entity. Neither does this permit authorize any invasion of personal
rights nor any violation of federal, state, or local laws or regulations. It is the responsibility of the
permittee to acquire property rights as may be necessary to use the discharge route.

This permit shall expire at midnight, **five years from the date of issuance.**

ISSUED DATE: October 17, 2018



For the Commission

INTERIM I EFFLUENT LIMITATIONS AND MONITORING REQUIREMENTSOutfall Number 001

1. During the period beginning upon the date of issuance and lasting through the completion of expansion to the 0.108 million gallons per day (MGD) facility, the permittee is authorized to discharge subject to the following effluent limitations:

The daily average flow of effluent shall not exceed 0.048 MGD, nor shall the average discharge during any two-hour period (2-hour peak) exceed 67 gallons per minute (gpm).

<u>Effluent Characteristic</u>	<u>Discharge Limitations</u>				<u>Min. Self-Monitoring Requirements</u>	
	Daily Avg mg/l (lbs/day)	7-day Avg mg/l	Daily Max mg/l	Single Grab mg/l	Report Daily Avg. & Max. Single Grab Measurement Frequency	Sample Type
Flow, MGD	Report	N/A	Report	N/A	Continuous	Totalizing Meter
Biochemical Oxygen Demand (5-day)	20 (8.0)	30	45	65	One/week	Grab
Total Suspended Solids	20 (8.0)	30	45	65	One/week	Grab
<i>E. coli</i> , colony-forming units or most probable number per 100 ml	126	N/A	N/A	399	One/quarter	Grab

2. The effluent shall contain a chlorine residual of at least 1.0 mg/l and shall not exceed a chlorine residual of 4.0 mg/l after a detention time of at least 20 minutes (based on peak flow), and shall be monitored five times per week by grab sample. An equivalent method of disinfection may be substituted only with prior approval of the Executive Director.
3. The pH shall not be less than 6.0 standard units nor greater than 9.0 standard units and shall be monitored once per month by grab sample.
4. There shall be no discharge of floating solids or visible foam in other than trace amounts and no discharge of visible oil.
5. Effluent monitoring samples shall be taken at the following location(s): Following the final treatment unit.
6. The effluent shall contain a minimum dissolved oxygen of 2.0 mg/l and shall be monitored once per week by grab sample.

INTERIM II EFFLUENT LIMITATIONS AND MONITORING REQUIREMENTSOutfall Number 001

- During the period beginning upon the date of the completion of expansion to the 0.108 million gallons per day (MGD) facility and lasting through the completion of expansion to the 0.240 MGD facility, the permittee is authorized to discharge subject to the following effluent limitations:

The daily average flow of effluent shall not exceed 0.108 MGD, nor shall the average discharge during any two-hour period (2-hour peak) exceed 225 gallons per minute (gpm).

<u>Effluent Characteristic</u>	<u>Discharge Limitations</u>				<u>Min. Self-Monitoring Requirements</u>	
	Daily Avg mg/l (lbs/day)	7-day Avg mg/l	Daily Max mg/l	Single Grab mg/l	Report Daily Avg. & Max. Single Grab Measurement Frequency	Sample Type
Flow, MGD	Report	N/A	Report	N/A	Continuous	Totalizing Meter
Biochemical Oxygen Demand (5-day)	20 (18)	30	45	65	One/week	Grab
Total Suspended Solids	20 (18)	30	45	65	One/week	Grab
<i>E. coli</i> , colony-forming units or most probable number per 100 ml	126	N/A	N/A	399	One/month	Grab

- The effluent shall contain a chlorine residual of at least 1.0 mg/l and shall not exceed a chlorine residual of 4.0 mg/l after a detention time of at least 20 minutes (based on peak flow), and shall be monitored five times per week by grab sample. An equivalent method of disinfection may be substituted only with prior approval of the Executive Director.
- The pH shall not be less than 6.0 standard units nor greater than 9.0 standard units and shall be monitored once per month by grab sample.
- There shall be no discharge of floating solids or visible foam in other than trace amounts and no discharge of visible oil.
- Effluent monitoring samples shall be taken at the following location(s): Following the final treatment unit.
- The effluent shall contain a minimum dissolved oxygen of 2.0 mg/l and shall be monitored once per week by grab sample.

FINAL EFFLUENT LIMITATIONS AND MONITORING REQUIREMENTSOutfall Number 001

1. During the period beginning upon the completion of expansion to the 0.240 million gallons per day (MGD) facility and lasting through the date of expiration, the permittee is authorized to discharge subject to the following effluent limitations:

The daily average flow of effluent shall not exceed 0.240 MGD, nor shall the average discharge during any two-hour period (2-hour peak) exceed 500 gallons per minute (gpm).

<u>Effluent Characteristic</u>	<u>Discharge Limitations</u>				<u>Min. Self-Monitoring Requirements</u>	
	Daily Avg mg/l (lbs/day)	7-day Avg mg/l	Daily Max mg/l	Single Grab mg/l	Report Daily Avg. & Max. Single Grab Measurement Frequency	Sample Type
Flow, MGD	Report	N/A	Report	N/A	Continuous	Totalizing Meter
Biochemical Oxygen Demand (5-day)	20 (40)	30	45	65	One/week	Grab
Total Suspended Solids	20 (40)	30	45	65	One/week	Grab
<i>E. coli</i> , colony-forming units or most probable number per 100 ml	126	N/A	N/A	399	One/month	Grab

2. The effluent shall contain a chlorine residual of at least 1.0 mg/l and shall not exceed a chlorine residual of 4.0 mg/l after a detention time of at least 20 minutes (based on peak flow), and shall be monitored five times per week by grab sample. An equivalent method of disinfection may be substituted only with prior approval of the Executive Director.
3. The pH shall not be less than 6.0 standard units nor greater than 9.0 standard units and shall be monitored once per month by grab sample.
4. There shall be no discharge of floating solids or visible foam in other than trace amounts and no discharge of visible oil.
5. Effluent monitoring samples shall be taken at the following location(s): Following the final treatment unit.
6. The effluent shall contain a minimum dissolved oxygen of 2.0 mg/l and shall be monitored once per week by grab sample.

DEFINITIONS AND STANDARD PERMIT CONDITIONS

As required by Title 30 Texas Administrative Code (TAC) Chapter 305, certain regulations appear as standard conditions in waste discharge permits. 30 TAC § 305.121 - 305.129 (relating to Permit Characteristics and Conditions) as promulgated under the Texas Water Code (TWC) §§ 5.103 and 5.105, and the Texas Health and Safety Code (THSC) §§ 361.017 and 361.024(a), establish the characteristics and standards for waste discharge permits, including sewage sludge, and those sections of 40 Code of Federal Regulations (CFR) Part 122 adopted by reference by the Commission. The following text includes these conditions and incorporates them into this permit. All definitions in TWC § 26.001 and 30 TAC Chapter 305 shall apply to this permit and are incorporated by reference. Some specific definitions of words or phrases used in this permit are as follows:

1. Flow Measurements

- a. Annual average flow - the arithmetic average of all daily flow determinations taken within the preceding 12 consecutive calendar months. The annual average flow determination shall consist of daily flow volume determinations made by a totalizing meter, charted on a chart recorder and limited to major domestic wastewater discharge facilities with one million gallons per day or greater permitted flow.
- b. Daily average flow - the arithmetic average of all determinations of the daily flow within a period of one calendar month. The daily average flow determination shall consist of determinations made on at least four separate days. If instantaneous measurements are used to determine the daily flow, the determination shall be the arithmetic average of all instantaneous measurements taken during that month. Daily average flow determination for intermittent discharges shall consist of a minimum of three flow determinations on days of discharge.
- c. Daily maximum flow - the highest total flow for any 24-hour period in a calendar month.
- d. Instantaneous flow - the measured flow during the minimum time required to interpret the flow measuring device.
- e. 2-hour peak flow (domestic wastewater treatment plants) - the maximum flow sustained for a two-hour period during the period of daily discharge. The average of multiple measurements of instantaneous maximum flow within a two-hour period may be used to calculate the 2-hour peak flow.
- f. Maximum 2-hour peak flow (domestic wastewater treatment plants) - the highest 2-hour peak flow for any 24-hour period in a calendar month.

2. Concentration Measurements

- a. Daily average concentration - the arithmetic average of all effluent samples, composite or grab as required by this permit, within a period of one calendar month, consisting of at least four separate representative measurements.
 - i. For domestic wastewater treatment plants - When four samples are not available in a calendar month, the arithmetic average (weighted by flow) of all values in the previous four consecutive month period consisting of at least four measurements shall be utilized as the daily average concentration.

- ii. For all other wastewater treatment plants - When four samples are not available in a calendar month, the arithmetic average (weighted by flow) of all values taken during the month shall be utilized as the daily average concentration.
- b. 7-day average concentration - the arithmetic average of all effluent samples, composite or grab as required by this permit, within a period of one calendar week, Sunday through Saturday.
- c. Daily maximum concentration - the maximum concentration measured on a single day, by the sample type specified in the permit, within a period of one calendar month.
- d. Daily discharge - the discharge of a pollutant measured during a calendar day or any 24-hour period that reasonably represents the calendar day for purposes of sampling. For pollutants with limitations expressed in terms of mass, the daily discharge is calculated as the total mass of the pollutant discharged over the sampling day. For pollutants with limitations expressed in other units of measurement, the daily discharge is calculated as the average measurement of the pollutant over the sampling day.

The daily discharge determination of concentration made using a composite sample shall be the concentration of the composite sample. When grab samples are used, the daily discharge determination of concentration shall be the arithmetic average (weighted by flow value) of all samples collected during that day.

- e. Bacteria concentration (*E. coli* or Enterococci) - Colony Forming Units (CFU) or Most Probable Number (MPN) of bacteria per 100 milliliters effluent. The daily average bacteria concentration is a geometric mean of the values for the effluent samples collected in a calendar month. The geometric mean shall be determined by calculating the n th root of the product of all measurements made in a calendar month, where n equals the number of measurements made; or, computed as the antilogarithm of the arithmetic mean of the logarithms of all measurements made in a calendar month. For any measurement of bacteria equaling zero, a substituted value of one shall be made for input into either computation method. If specified, the 7-day average for bacteria is the geometric mean of the values for all effluent samples collected during a calendar week.
 - f. Daily average loading (lbs/day) - the arithmetic average of all daily discharge loading calculations during a period of one calendar month. These calculations must be made for each day of the month that a parameter is analyzed. The daily discharge, in terms of mass (lbs/day), is calculated as (Flow, MGD x Concentration, mg/l x 8.34).
 - g. Daily maximum loading (lbs/day) - the highest daily discharge, in terms of mass (lbs/day), within a period of one calendar month.
3. Sample Type
- a. Composite sample - For domestic wastewater, a composite sample is a sample made up of a minimum of three effluent portions collected in a continuous 24-hour period or during the period of daily discharge if less than 24 hours, and combined in volumes proportional to flow, and collected at the intervals required by 30 TAC § 319.9 (a). For industrial wastewater, a composite sample is a sample made up of a minimum of three effluent portions collected in a continuous 24-hour period or during the period of daily discharge if less than 24 hours, and combined in volumes proportional to flow, and collected at the intervals required by 30 TAC § 319.9 (b).

- b. Grab sample - an individual sample collected in less than 15 minutes.
- 4. Treatment Facility (facility) - wastewater facilities used in the conveyance, storage, treatment, recycling, reclamation and/or disposal of domestic sewage, industrial wastes, agricultural wastes, recreational wastes, or other wastes including sludge handling or disposal facilities under the jurisdiction of the Commission.
- 5. The term "sewage sludge" is defined as solid, semi-solid, or liquid residue generated during the treatment of domestic sewage in 30 TAC Chapter 312. This includes the solids that have not been classified as hazardous waste separated from wastewater by unit processes.
- 6. Bypass - the intentional diversion of a waste stream from any portion of a treatment facility.

MONITORING AND REPORTING REQUIREMENTS

1. Self-Reporting

Monitoring results shall be provided at the intervals specified in the permit. Unless otherwise specified in this permit or otherwise ordered by the Commission, the permittee shall conduct effluent sampling and reporting in accordance with 30 TAC §§ 319.4 - 319.12. Unless otherwise specified, effluent monitoring data shall be submitted each month, to the Enforcement Division (MC 224), by the 20th day of the following month for each discharge which is described by this permit whether or not a discharge is made for that month. Monitoring results must be submitted online using the NetDMR reporting system available through the TCEQ website unless the permittee requests and obtains an electronic reporting waiver. Monitoring results must be signed and certified as required by Monitoring and Reporting Requirements No. 10.

As provided by state law, the permittee is subject to administrative, civil and criminal penalties, as applicable, for negligently or knowingly violating the Clean Water Act (CWA); TWC §§ 26, 27, and 28; and THSC § 361, including but not limited to knowingly making any false statement, representation, or certification on any report, record, or other document submitted or required to be maintained under this permit, including monitoring reports or reports of compliance or noncompliance, or falsifying, tampering with or knowingly rendering inaccurate any monitoring device or method required by this permit or violating any other requirement imposed by state or federal regulations.

2. Test Procedures

- a. Unless otherwise specified in this permit, test procedures for the analysis of pollutants shall comply with procedures specified in 30 TAC §§ 319.11 - 319.12. Measurements, tests, and calculations shall be accurately accomplished in a representative manner.
- b. All laboratory tests submitted to demonstrate compliance with this permit must meet the requirements of 30 TAC § 25, Environmental Testing Laboratory Accreditation and Certification.

3. Records of Results

- a. Monitoring samples and measurements shall be taken at times and in a manner so as to be representative of the monitored activity.

- b. Except for records of monitoring information required by this permit related to the permittee's sewage sludge use and disposal activities, which shall be retained for a period of at least five years (or longer as required by 40 CFR Part 503), monitoring and reporting records, including strip charts and records of calibration and maintenance, copies of all records required by this permit, records of all data used to complete the application for this permit, and the certification required by 40 CFR § 264.73(b)(9) shall be retained at the facility site, or shall be readily available for review by a TCEQ representative for a period of three years from the date of the record or sample, measurement, report, application or certification. This period shall be extended at the request of the Executive Director.
- c. Records of monitoring activities shall include the following:
 - i. date, time and place of sample or measurement;
 - ii. identity of individual who collected the sample or made the measurement.
 - iii. date and time of analysis;
 - iv. identity of the individual and laboratory who performed the analysis;
 - v. the technique or method of analysis; and
 - vi. the results of the analysis or measurement and quality assurance/quality control records.

The period during which records are required to be kept shall be automatically extended to the date of the final disposition of any administrative or judicial enforcement action that may be instituted against the permittee.

4. Additional Monitoring by Permittee

If the permittee monitors any pollutant at the location(s) designated herein more frequently than required by this permit using approved analytical methods as specified above, all results of such monitoring shall be included in the calculation and reporting of the values submitted on the approved self-report form. Increased frequency of sampling shall be indicated on the self-report form.

5. Calibration of Instruments

All automatic flow measuring or recording devices and all totalizing meters for measuring flows shall be accurately calibrated by a trained person at plant start-up and as often thereafter as necessary to ensure accuracy, but not less often than annually unless authorized by the Executive Director for a longer period. Such person shall verify in writing that the device is operating properly and giving accurate results. Copies of the verification shall be retained at the facility site and/or shall be readily available for review by a TCEQ representative for a period of three years.

6. Compliance Schedule Reports

Reports of compliance or noncompliance with, or any progress reports on, interim and final requirements contained in any compliance schedule of the permit shall be submitted no later

than 14 days following each schedule date to the Regional Office and the Enforcement Division (MC 224).

7. Noncompliance Notification

- a. In accordance with 30 TAC § 305.125(9) any noncompliance which may endanger human health or safety, or the environment shall be reported by the permittee to the TCEQ. Except as allowed by 30 TAC § 305.132, report of such information shall be provided orally or by facsimile transmission (FAX) to the Regional Office within 24 hours of becoming aware of the noncompliance. A written submission of such information shall also be provided by the permittee to the Regional Office and the Enforcement Division (MC 224) within five working days of becoming aware of the noncompliance. For Publicly Owned Treatment Works (POTWs), effective September 1, 2020, the permittee must submit the written report for unauthorized discharges and unanticipated bypasses that exceed any effluent limit in the permit using the online electronic reporting system available through the TCEQ website unless the permittee requests and obtains an electronic reporting waiver. The written submission shall contain a description of the noncompliance and its cause; the potential danger to human health or safety, or the environment; the period of noncompliance, including exact dates and times; if the noncompliance has not been corrected, the time it is expected to continue; and steps taken or planned to reduce, eliminate, and prevent recurrence of the noncompliance, and to mitigate its adverse effects.
 - b. The following violations shall be reported under Monitoring and Reporting Requirement 7.a.:
 - i. Unauthorized discharges as defined in Permit Condition 2(g).
 - ii. Any unanticipated bypass that exceeds any effluent limitation in the permit.
 - iii. Violation of a permitted maximum daily discharge limitation for pollutants listed specifically in the Other Requirements section of an Industrial TPDES permit.
 - c. In addition to the above, any effluent violation which deviates from the permitted effluent limitation by more than 40% shall be reported by the permittee in writing to the Regional Office and the Enforcement Division (MC 224) within 5 working days of becoming aware of the noncompliance.
 - d. Any noncompliance other than that specified in this section, or any required information not submitted or submitted incorrectly, shall be reported to the Enforcement Division (MC 224) as promptly as possible. For effluent limitation violations, noncompliances shall be reported on the approved self-report form.
8. In accordance with the procedures described in 30 TAC §§ 35.301 - 35.303 (relating to Water Quality Emergency and Temporary Orders) if the permittee knows in advance of the need for a bypass, it shall submit prior notice by applying for such authorization.
9. Changes in Discharges of Toxic Substances

All existing manufacturing, commercial, mining, and silvicultural permittees shall notify the Regional Office, orally or by facsimile transmission within 24 hours, and both the Regional Office and the Enforcement Division (MC 224) in writing within five (5) working days, after

becoming aware of or having reason to believe:

- a. That any activity has occurred or will occur which would result in the discharge, on a routine or frequent basis, of any toxic pollutant listed at 40 CFR Part 122, Appendix D, Tables II and III (excluding Total Phenols) which is not limited in the permit, if that discharge will exceed the highest of the following "notification levels":
 - i. One hundred micrograms per liter (100 µg/L);
 - ii. Two hundred micrograms per liter (200 µg/L) for acrolein and acrylonitrile; five hundred micrograms per liter (500 µg/L) for 2,4-dinitrophenol and for 2-methyl-4,6-dinitrophenol; and one milligram per liter (1 mg/L) for antimony;
 - iii. Five (5) times the maximum concentration value reported for that pollutant in the permit application; or
 - iv. The level established by the TCEQ.
- b. That any activity has occurred or will occur which would result in any discharge, on a nonroutine or infrequent basis, of a toxic pollutant which is not limited in the permit, if that discharge will exceed the highest of the following "notification levels":
 - i. Five hundred micrograms per liter (500 µg/L);
 - ii. One milligram per liter (1 mg/L) for antimony;
 - iii. Ten (10) times the maximum concentration value reported for that pollutant in the permit application; or
 - iv. The level established by the TCEQ.

10. Signatories to Reports

All reports and other information requested by the Executive Director shall be signed by the person and in the manner required by 30 TAC § 305.128 (relating to Signatories to Reports).

11. All POTWs must provide adequate notice to the Executive Director of the following:

- a. Any new introduction of pollutants into the POTW from an indirect discharger which would be subject to CWA § 301 or § 306 if it were directly discharging those pollutants;
- b. Any substantial change in the volume or character of pollutants being introduced into that POTW by a source introducing pollutants into the POTW at the time of issuance of the permit; and
- c. For the purpose of this paragraph, adequate notice shall include information on:
 - i. The quality and quantity of effluent introduced into the POTW; and
 - ii. Any anticipated impact of the change on the quantity or quality of effluent to be discharged from the POTW.

PERMIT CONDITIONS

1. General

- a. When the permittee becomes aware that it failed to submit any relevant facts in a permit application, or submitted incorrect information in an application or in any report to the Executive Director, it shall promptly submit such facts or information.
- b. This permit is granted on the basis of the information supplied and representations made by the permittee during action on an application, and relying upon the accuracy and completeness of that information and those representations. After notice and opportunity for a hearing, this permit may be modified, suspended, or revoked, in whole or in part, in accordance with 30 TAC Chapter 305, Subchapter D, during its term for good cause including, but not limited to, the following:
 - i. Violation of any terms or conditions of this permit;
 - ii. Obtaining this permit by misrepresentation or failure to disclose fully all relevant facts; or
 - iii. A change in any condition that requires either a temporary or permanent reduction or elimination of the authorized discharge.
- c. The permittee shall furnish to the Executive Director, upon request and within a reasonable time, any information to determine whether cause exists for amending, revoking, suspending or terminating the permit. The permittee shall also furnish to the Executive Director, upon request, copies of records required to be kept by the permit.

2. Compliance

- a. Acceptance of the permit by the person to whom it is issued constitutes acknowledgment and agreement that such person will comply with all the terms and conditions embodied in the permit, and the rules and other orders of the Commission.
- b. The permittee has a duty to comply with all conditions of the permit. Failure to comply with any permit condition constitutes a violation of the permit and the Texas Water Code or the Texas Health and Safety Code, and is grounds for enforcement action, for permit amendment, revocation, or suspension, or for denial of a permit renewal application or an application for a permit for another facility.
- c. It shall not be a defense for a permittee in an enforcement action that it would have been necessary to halt or reduce the permitted activity in order to maintain compliance with the conditions of the permit.
- d. The permittee shall take all reasonable steps to minimize or prevent any discharge or sludge use or disposal or other permit violation that has a reasonable likelihood of adversely affecting human health or the environment.
- e. Authorization from the Commission is required before beginning any change in the permitted facility or activity that may result in noncompliance with any permit requirements.

- f. A permit may be amended, suspended and reissued, or revoked for cause in accordance with 30 TAC §§ 305.62 and 305.66 and TWC§ 7.302. The filing of a request by the permittee for a permit amendment, suspension and reissuance, or termination, or a notification of planned changes or anticipated noncompliance, does not stay any permit condition.
- g. There shall be no unauthorized discharge of wastewater or any other waste. For the purpose of this permit, an unauthorized discharge is considered to be any discharge of wastewater into or adjacent to water in the state at any location not permitted as an outfall or otherwise defined in the Other Requirements section of this permit.
- h. In accordance with 30 TAC § 305.535(a), the permittee may allow any bypass to occur from a TPDES permitted facility which does not cause permitted effluent limitations to be exceeded or an unauthorized discharge to occur, but only if the bypass is also for essential maintenance to assure efficient operation.
- i. The permittee is subject to administrative, civil, and criminal penalties, as applicable, under TWC §§ 7.051 - 7.075 (relating to Administrative Penalties), 7.101 - 7.111 (relating to Civil Penalties), and 7.141 - 7.202 (relating to Criminal Offenses and Penalties) for violations including, but not limited to, negligently or knowingly violating the federal CWA §§ 301, 302, 306, 307, 308, 318, or 405, or any condition or limitation implementing any sections in a permit issued under the CWA § 402, or any requirement imposed in a pretreatment program approved under the CWA §§ 402 (a)(3) or 402 (b)(8).

3. Inspections and Entry

- a. Inspection and entry shall be allowed as prescribed in the TWC Chapters 26, 27, and 28, and THSC § 361.
- b. The members of the Commission and employees and agents of the Commission are entitled to enter any public or private property at any reasonable time for the purpose of inspecting and investigating conditions relating to the quality of water in the state or the compliance with any rule, regulation, permit or other order of the Commission. Members, employees, or agents of the Commission and Commission contractors are entitled to enter public or private property at any reasonable time to investigate or monitor or, if the responsible party is not responsive or there is an immediate danger to public health or the environment, to remove or remediate a condition related to the quality of water in the state. Members, employees, Commission contractors, or agents acting under this authority who enter private property shall observe the establishment's rules and regulations concerning safety, internal security, and fire protection, and if the property has management in residence, shall notify management or the person then in charge of his presence and shall exhibit proper credentials. If any member, employee, Commission contractor, or agent is refused the right to enter in or on public or private property under this authority, the Executive Director may invoke the remedies authorized in TWC § 7.002. The statement above, that Commission entry shall occur in accordance with an establishment's rules and regulations concerning safety, internal security, and fire protection, is not grounds for denial or restriction of entry to any part of the facility, but merely describes the Commission's duty to observe appropriate rules and regulations during an inspection.

4. Permit Amendment and/or Renewal

- a. The permittee shall give notice to the Executive Director as soon as possible of any planned physical alterations or additions to the permitted facility if such alterations or additions would require a permit amendment or result in a violation of permit requirements. Notice shall also be required under this paragraph when:
 - i. The alteration or addition to a permitted facility may meet one of the criteria for determining whether a facility is a new source in accordance with 30 TAC § 305.534 (relating to New Sources and New Dischargers); or
 - ii. The alteration or addition could significantly change the nature or increase the quantity of pollutants discharged. This notification applies to pollutants that are subject neither to effluent limitations in the permit, nor to notification requirements in Monitoring and Reporting Requirements No. 9;
 - iii. The alteration or addition results in a significant change in the permittee's sludge use or disposal practices, and such alteration, addition, or change may justify the application of permit conditions that are different from or absent in the existing permit, including notification of additional use or disposal sites not reported during the permit application process or not reported pursuant to an approved land application plan.
- b. Prior to any facility modifications, additions, or expansions that will increase the plant capacity beyond the permitted flow, the permittee must apply for and obtain proper authorization from the Commission before commencing construction.
- c. The permittee must apply for an amendment or renewal at least 180 days prior to expiration of the existing permit in order to continue a permitted activity after the expiration date of the permit. If an application is submitted prior to the expiration date of the permit, the existing permit shall remain in effect until the application is approved, denied, or returned. If the application is returned or denied, authorization to continue such activity shall terminate upon the effective date of the action. If an application is not submitted prior to the expiration date of the permit, the permit shall expire and authorization to continue such activity shall terminate.
- d. Prior to accepting or generating wastes which are not described in the permit application or which would result in a significant change in the quantity or quality of the existing discharge, the permittee must report the proposed changes to the Commission. The permittee must apply for a permit amendment reflecting any necessary changes in permit conditions, including effluent limitations for pollutants not identified and limited by this permit.
- e. In accordance with the TWC § 26.029(b), after a public hearing, notice of which shall be given to the permittee, the Commission may require the permittee, from time to time, for good cause, in accordance with applicable laws, to conform to new or additional conditions.
- f. If any toxic effluent standard or prohibition (including any schedule of compliance specified in such effluent standard or prohibition) is promulgated under CWA § 307(a) for a toxic pollutant which is present in the discharge and that standard or prohibition is more stringent than any limitation on the pollutant in this permit, this permit shall be

modified or revoked and reissued to conform to the toxic effluent standard or prohibition. The permittee shall comply with effluent standards or prohibitions established under CWA § 307(a) for toxic pollutants within the time provided in the regulations that established those standards or prohibitions, even if the permit has not yet been modified to incorporate the requirement.

5. Permit Transfer

- a. Prior to any transfer of this permit, Commission approval must be obtained. The Commission shall be notified in writing of any change in control or ownership of facilities authorized by this permit. Such notification should be sent to the Applications Review and Processing Team (MC 148) of the Water Quality Division.
- b. A permit may be transferred only according to the provisions of 30 TAC § 305.64 (relating to Transfer of Permits) and 30 TAC § 50.133 (relating to Executive Director Action on Application or WQMP update).

6. Relationship to Hazardous Waste Activities

This permit does not authorize any activity of hazardous waste storage, processing, or disposal that requires a permit or other authorization pursuant to the Texas Health and Safety Code.

7. Relationship to Water Rights

Disposal of treated effluent by any means other than discharge directly to water in the state must be specifically authorized in this permit and may require a permit pursuant to TWC Chapter 11.

8. Property Rights

A permit does not convey any property rights of any sort, or any exclusive privilege.

9. Permit Enforceability

The conditions of this permit are severable, and if any provision of this permit, or the application of any provision of this permit to any circumstances, is held invalid, the application of such provision to other circumstances, and the remainder of this permit, shall not be affected thereby.

10. Relationship to Permit Application

The application pursuant to which the permit has been issued is incorporated herein; provided, however, that in the event of a conflict between the provisions of this permit and the application, the provisions of the permit shall control.

11. Notice of Bankruptcy

- a. Each permittee shall notify the Executive Director, in writing, immediately following the filing of a voluntary or involuntary petition for bankruptcy under any chapter of Title 11 Bankruptcy) of the United States Code (11 USC) by or against:

- i. the permittee;
 - ii. an entity (as that term is defined in 11 USC, § 101(14)) controlling the permittee or listing the permit or permittee as property of the estate; or
 - iii. an affiliate (as that term is defined in 11 USC, § 101(2)) of the permittee.
- b. This notification must indicate:
- i. the name of the permittee and the permit number(s);
 - ii. the bankruptcy court in which the petition for bankruptcy was filed; and
 - iii. the date of filing of the petition.

OPERATIONAL REQUIREMENTS

1. The permittee shall at all times ensure that the facility and all of its systems of collection, treatment, and disposal are properly operated and maintained. This includes, but is not limited to, the regular, periodic examination of wastewater solids within the treatment plant by the operator in order to maintain an appropriate quantity and quality of solids inventory as described in the various operator training manuals and according to accepted industry standards for process control. Process control, maintenance, and operations records shall be retained at the facility site, or shall be readily available for review by a TCEQ representative, for a period of three years.
2. Upon request by the Executive Director, the permittee shall take appropriate samples and provide proper analysis in order to demonstrate compliance with Commission rules. Unless otherwise specified in this permit or otherwise ordered by the Commission, the permittee shall comply with all applicable provisions of 30 TAC Chapter 312 concerning sewage sludge use and disposal and 30 TAC §§ 319.21 - 319.29 concerning the discharge of certain hazardous metals.
3. Domestic wastewater treatment facilities shall comply with the following provisions:
 - a. The permittee shall notify the Municipal Permits Team, Wastewater Permitting Section (MC 148) of the Water Quality Division, in writing, of any facility expansion at least 90 days prior to conducting such activity.
 - b. The permittee shall submit a closure plan for review and approval to the Municipal Permits Team, Wastewater Permitting Section (MC 148) of the Water Quality Division, for any closure activity at least 90 days prior to conducting such activity. Closure is the act of permanently taking a waste management unit or treatment facility out of service and includes the permanent removal from service of any pit, tank, pond, lagoon, surface impoundment and/or other treatment unit regulated by this permit.
4. The permittee is responsible for installing prior to plant start-up, and subsequently maintaining, adequate safeguards to prevent the discharge of untreated or inadequately treated wastes during electrical power failures by means of alternate power sources, standby generators, and/or retention of inadequately treated wastewater.

5. Unless otherwise specified, the permittee shall provide a readily accessible sampling point and, where applicable, an effluent flow measuring device or other acceptable means by which effluent flow may be determined.
6. The permittee shall remit an annual water quality fee to the Commission as required by 30 TAC Chapter 21. Failure to pay the fee may result in revocation of this permit under TWC § 7.302(b)(6).
7. Documentation

For all written notifications to the Commission required of the permittee by this permit, the permittee shall keep and make available a copy of each such notification under the same conditions as self-monitoring data are required to be kept and made available. Except for information required for TPDES permit applications, effluent data, including effluent data in permits, draft permits and permit applications, and other information specified as not confidential in 30 TAC §§ 1.5(d), any information submitted pursuant to this permit may be claimed as confidential by the submitter. Any such claim must be asserted in the manner prescribed in the application form or by stamping the words confidential business information on each page containing such information. If no claim is made at the time of submission, information may be made available to the public without further notice. If the Commission or Executive Director agrees with the designation of confidentiality, the TCEQ will not provide the information for public inspection unless required by the Texas Attorney General or a court pursuant to an open records request. If the Executive Director does not agree with the designation of confidentiality, the person submitting the information will be notified.

8. Facilities that generate domestic wastewater shall comply with the following provisions; domestic wastewater treatment facilities at permitted industrial sites are excluded.
 - a. Whenever flow measurements for any domestic sewage treatment facility reach 75% of the permitted daily average or annual average flow for three consecutive months, the permittee must initiate engineering and financial planning for expansion and/or upgrading of the domestic wastewater treatment and/or collection facilities. Whenever the flow reaches 90% of the permitted daily average or annual average flow for three consecutive months, the permittee shall obtain necessary authorization from the Commission to commence construction of the necessary additional treatment and/or collection facilities. In the case of a domestic wastewater treatment facility which reaches 75% of the permitted daily average or annual average flow for three consecutive months, and the planned population to be served or the quantity of waste produced is not expected to exceed the design limitations of the treatment facility, the permittee shall submit an engineering report supporting this claim to the Executive Director of the Commission.

If in the judgment of the Executive Director the population to be served will not cause permit noncompliance, then the requirement of this section may be waived. To be effective, any waiver must be in writing and signed by the Director of the Enforcement Division (MC 169) of the Commission, and such waiver of these requirements will be reviewed upon expiration of the existing permit; however, any such waiver shall not be interpreted as condoning or excusing any violation of any permit parameter.

- b. The plans and specifications for domestic sewage collection and treatment works associated with any domestic permit must be approved by the Commission and failure to secure approval before commencing construction of such works or making a discharge is a violation of this permit and each day is an additional violation until approval has been secured.
 - c. Permits for domestic wastewater treatment plants are granted subject to the policy of the Commission to encourage the development of area-wide waste collection, treatment, and disposal systems. The Commission reserves the right to amend any domestic wastewater permit in accordance with applicable procedural requirements to require the system covered by this permit to be integrated into an area-wide system, should such be developed; to require the delivery of the wastes authorized to be collected in, treated by or discharged from said system, to such area-wide system; or to amend this permit in any other particular to effectuate the Commission's policy. Such amendments may be made when the changes required are advisable for water quality control purposes and are feasible on the basis of waste treatment technology, engineering, financial, and related considerations existing at the time the changes are required, exclusive of the loss of investment in or revenues from any then existing or proposed waste collection, treatment or disposal system.
9. Domestic wastewater treatment plants shall be operated and maintained by sewage plant operators holding a valid certificate of competency at the required level as defined in 30 TAC Chapter 30.
10. For Publicly Owned Treatment Works (POTWs), the 30-day average (or monthly average) percent removal for BOD and TSS shall not be less than 85%, unless otherwise authorized by this permit.
11. Facilities that generate industrial solid waste as defined in 30 TAC § 335.1 shall comply with these provisions:
- a. Any solid waste, as defined in 30 TAC § 335.1 (including but not limited to such wastes as garbage, refuse, sludge from a waste treatment, water supply treatment plant or air pollution control facility, discarded materials, discarded materials to be recycled, whether the waste is solid, liquid, or semisolid), generated by the permittee during the management and treatment of wastewater, must be managed in accordance with all applicable provisions of 30 TAC Chapter 335, relating to Industrial Solid Waste Management.
 - b. Industrial wastewater that is being collected, accumulated, stored, or processed before discharge through any final discharge outfall, specified by this permit, is considered to be industrial solid waste until the wastewater passes through the actual point source discharge and must be managed in accordance with all applicable provisions of 30 TAC Chapter 335.
 - c. The permittee shall provide written notification, pursuant to the requirements of 30 TAC § 335.8(b)(1), to the Environmental Cleanup Section (MC 127) of the Remediation Division informing the Commission of any closure activity involving an Industrial Solid Waste Management Unit, at least 90 days prior to conducting such an activity.

- d. Construction of any industrial solid waste management unit requires the prior written notification of the proposed activity to the Registration and Reporting Section (MC 129) of the Registration, Review, and Reporting Division. No person shall dispose of industrial solid waste, including sludge or other solids from wastewater treatment processes, prior to fulfilling the deed recordation requirements of 30 TAC § 335.5.
- e. The term "industrial solid waste management unit" means a landfill, surface impoundment, waste-pile, industrial furnace, incinerator, cement kiln, injection well, container, drum, salt dome waste containment cavern, or any other structure vessel, appurtenance, or other improvement on land used to manage industrial solid waste.
- f. The permittee shall keep management records for all sludge (or other waste) removed from any wastewater treatment process. These records shall fulfill all applicable requirements of 30 TAC § 335 and must include the following, as it pertains to wastewater treatment and discharge:
 - i. Volume of waste and date(s) generated from treatment process;
 - ii. Volume of waste disposed of on-site or shipped off-site;
 - iii. Date(s) of disposal;
 - iv. Identity of hauler or transporter;
 - v. Location of disposal site; and
 - vi. Method of final disposal.

The above records shall be maintained on a monthly basis. The records shall be retained at the facility site, or shall be readily available for review by authorized representatives of the TCEQ for at least five years.

- 12. For industrial facilities to which the requirements of 30 TAC § 335 do not apply, sludge and solid wastes, including tank cleaning and contaminated solids for disposal, shall be disposed of in accordance with THSC § 361.

TCEQ Revision 08/2008

SLUDGE PROVISIONS

The permittee is authorized to dispose of sludge only at a Texas Commission on Environmental Quality (TCEQ) authorized land application site or co-disposal landfill. **The disposal of sludge by land application on property owned, leased or under the direct control of the permittee is a violation of the permit unless the site is authorized with the TCEQ. This provision does not authorize Distribution and Marketing of Class A or Class AB Sewage Sludge. This provision does not authorize the permittee to land apply sludge on property owned, leased or under the direct control of the permittee.**

SECTION I. REQUIREMENTS APPLYING TO ALL SEWAGE SLUDGE LAND APPLICATION**A. General Requirements**

1. The permittee shall handle and dispose of sewage sludge in accordance with 30 TAC § 312 and all other applicable state and federal regulations in a manner that protects public health and the environment from any reasonably anticipated adverse effects due to any toxic pollutants that may be present in the sludge.
2. In all cases, if the person (permit holder) who prepares the sewage sludge supplies the sewage sludge to another person for land application use or to the owner or lease holder of the land, the permit holder shall provide necessary information to the parties who receive the sludge to assure compliance with these regulations.
3. The permittee shall give 180 days prior notice to the Executive Director in care of the Wastewater Permitting Section (MC 148) of the Water Quality Division of any change planned in the sewage sludge disposal practice.

B. Testing Requirements

1. Sewage sludge shall be tested once during the term of this permit in accordance with the method specified in both 40 CFR Part 261, Appendix II and 40 CFR Part 268, Appendix I [Toxicity Characteristic Leaching Procedure (TCLP)] or other method that receives the prior approval of the TCEQ for the contaminants listed in 40 CFR Part 261.24, Table 1. Sewage sludge failing this test shall be managed according to RCRA standards for generators of hazardous waste, and the waste's disposition must be in accordance with all applicable requirements for hazardous waste processing, storage, or disposal. Following failure of any TCLP test, the management or disposal of sewage sludge at a facility other than an authorized hazardous waste processing, storage, or disposal facility shall be prohibited until such time as the permittee can demonstrate the sewage sludge no longer exhibits the hazardous waste toxicity characteristics (as demonstrated by the results of the TCLP tests). A written report shall be provided to both the TCEQ Registration and Reporting Section (MC 129) of the Permitting and Remediation Support Division and the Regional Director (MC Region 13) within seven (7) days after failing the TCLP Test.

The report shall contain test results, certification that unauthorized waste management has stopped and a summary of alternative disposal plans that comply with RCRA standards for the management of hazardous waste. The report shall be addressed to: Director, Registration, Review, and Reporting Division (MC 129), Texas Commission on Environmental Quality, P.O. Box 13087, Austin, Texas 78711-3087. In addition, the permittee shall prepare an annual report on the results of all sludge toxicity testing. This annual report shall be submitted to the TCEQ Regional Office (MC Region 13) and the Compliance Monitoring Team (MC 224) of the Enforcement Division by September 30th of each year. Effective September 1, 2020, the permittee must submit this annual report using the online electronic reporting system available through the TCEQ website unless the permittee requests and obtains an electronic reporting waiver.

2. Sewage sludge shall not be applied to the land if the concentration of the pollutants exceeds the pollutant concentration criteria in Table 1. The frequency of testing for pollutants in Table 1 is found in Section I.C.

TABLE 1

<u>Pollutant</u>	<u>Ceiling Concentration</u> <u>(Milligrams per kilogram)*</u>
Arsenic	75
Cadmium	85
Chromium	3000
Copper	4300
Lead	840
Mercury	57
Molybdenum	75
Nickel	420
PCBs	49
Selenium	100
Zinc	7500

* Dry weight basis

3. Pathogen Control

All sewage sludge that is applied to agricultural land, forest, a public contact site, or a reclamation site must be treated by one of the following methods to ensure that the sludge meets either the Class A, Class AB or Class B pathogen requirements.

- a. For sewage sludge to be classified as Class A with respect to pathogens, the density of fecal coliform in the sewage sludge be less than 1,000 most probable number (MPN) per gram of total solids (dry weight basis), or the density of *Salmonella* sp. bacteria in the sewage sludge be less than three MPN per four grams of total solids (dry weight basis) at the time the sewage sludge is used or disposed. In addition, one of the alternatives listed below must be met.

Alternative 1 - The temperature of the sewage sludge that is used or disposed shall be maintained at or above a specific value for a period of time. See 30 TAC § 312.82(a)(2)(A) for specific information.

Alternative 5 (PFRP) - Sewage sludge that is used or disposed of must be treated in one of the Processes to Further Reduce Pathogens (PFRP) described in 40 CFR Part 503, Appendix B. PFRP include composting, heat drying, heat treatment, and thermophilic aerobic digestion.

Alternative 6 (PFRP Equivalent) - Sewage sludge that is used or disposed of must be treated in a process that has been approved by the U. S. Environmental Protection Agency as being equivalent to those in Alternative 5.

- b. For sewage sludge to be classified as Class AB with respect to pathogens, the density of fecal coliform in the sewage sludge be less than 1,000 MPN per gram of total solids (dry weight basis), or the density of *Salmonella* sp. bacteria in the sewage sludge be less than three MPN per four grams of total solids (dry weight basis) at the time the sewage sludge is used or disposed. In addition, one of the alternatives listed below must be met.

Alternative 2 - The pH of the sewage sludge that is used or disposed shall be raised to above 12 std. units and shall remain above 12 std. units for 72 hours.

The temperature of the sewage sludge shall be above 52° Celsius for 12 hours or longer during the period that the pH of the sewage sludge is above 12 std. units.

At the end of the 72-hour period during which the pH of the sewage sludge is above 12 std. units, the sewage sludge shall be air dried to achieve a percent solids in the sewage sludge greater than 50%.

Alternative 3 - The sewage sludge shall be analyzed for enteric viruses prior to pathogen treatment. The limit for enteric viruses is less than one Plaque-forming Unit per four grams of total solids (dry weight basis) either before or following pathogen treatment. See 30 TAC § 312.82(a)(2)(C)(i-iii) for specific information. The sewage sludge shall be analyzed for viable helminth ova prior to pathogen treatment. The limit for viable helminth ova is less than one per four grams of total solids (dry weight basis) either before or following pathogen treatment. See 30 TAC § 312.82(a)(2)(C)(iv-vi) for specific information.

Alternative 4 - The density of enteric viruses in the sewage sludge shall be less than one Plaque-forming Unit per four grams of total solids (dry weight basis) at the time the sewage sludge is used or disposed. The density of viable helminth ova in the sewage sludge shall be less than one per four grams of total solids (dry weight basis) at the time the sewage sludge is used or disposed.

- c. Sewage sludge that meets the requirements of Class AB sewage sludge may be classified a Class A sewage sludge if a variance request is submitted in writing that is supported by substantial documentation demonstrating equivalent methods for reducing odors and written approval is granted by the executive director. The executive director may deny the variance request or revoke that approved variance if it is determined that the variance may potentially endanger human health or the environment, or create nuisance odor conditions.
- d. Three alternatives are available to demonstrate compliance with Class B criteria for sewage sludge.

Alternative 1

- i. A minimum of seven random samples of the sewage sludge shall be collected within 48 hours of the time the sewage sludge is used or disposed of during each monitoring episode for the sewage sludge.
- ii. The geometric mean of the density of fecal coliform in the samples collected shall be less than either 2,000,000 MPN per gram of total solids (dry weight basis) or 2,000,000 Colony Forming Units per gram of total solids (dry weight basis).

Alternative 2 - Sewage sludge that is used or disposed of shall be treated in one of the Processes to Significantly Reduce Pathogens (PSRP) described in 40 CFR Part 503, Appendix B, so long as all of the following requirements are met by the generator of the sewage sludge.

- i. Prior to use or disposal, all the sewage sludge must have been generated from a single location, except as provided in paragraph v. below;
- ii. An independent Texas Licensed Professional Engineer must make a certification to the generator of a sewage sludge that the wastewater treatment facility generating the sewage sludge is designed to achieve one of the PSRP at the permitted design loading of the facility. The certification need only be repeated if the design loading of the facility is increased. The certification shall include a statement indicating the design meets all the applicable standards specified in Appendix B of 40 CFR Part 503;
- iii. Prior to any off-site transportation or on-site use or disposal of any sewage sludge generated at a wastewater treatment facility, the chief certified operator of the wastewater treatment facility or other responsible official who manages the processes to significantly reduce pathogens at the wastewater treatment facility for the permittee, shall certify that the sewage sludge underwent at least the minimum operational requirements necessary in order to meet one of the PSRP. The acceptable processes and the minimum operational and record keeping requirements shall be in accordance with established U.S. Environmental Protection Agency final guidance;
- iv. All certification records and operational records describing how the requirements of this paragraph were met shall be kept by the generator for a minimum of three years and be available for inspection by commission staff for review; and
- v. If the sewage sludge is generated from a mixture of sources, resulting from a person who prepares sewage sludge from more than one wastewater treatment facility, the resulting derived product shall meet one of the PSRP, and shall meet the certification, operation, and record keeping requirements of this paragraph.

Alternative 3 - Sewage sludge shall be treated in an equivalent process that has been approved by the U.S. Environmental Protection Agency, so long as all of the following requirements are met by the generator of the sewage sludge.

- i. Prior to use or disposal, all the sewage sludge must have been generated from a single location, except as provided in paragraph v. below;

- ii. Prior to any off-site transportation or on-site use or disposal of any sewage sludge generated at a wastewater treatment facility, the chief certified operator of the wastewater treatment facility or other responsible official who manages the processes to significantly reduce pathogens at the wastewater treatment facility for the permittee, shall certify that the sewage sludge underwent at least the minimum operational requirements necessary in order to meet one of the PSRP. The acceptable processes and the minimum operational and record keeping requirements shall be in accordance with established U.S. Environmental Protection Agency final guidance;
- iii. All certification records and operational records describing how the requirements of this paragraph were met shall be kept by the generator for a minimum of three years and be available for inspection by commission staff for review;
- iv. The Executive Director will accept from the U.S. Environmental Protection Agency a finding of equivalency to the defined PSRP; and
- v. If the sewage sludge is generated from a mixture of sources resulting from a person who prepares sewage sludge from more than one wastewater treatment facility, the resulting derived product shall meet one of the Processes to Significantly Reduce Pathogens, and shall meet the certification, operation, and record keeping requirements of this paragraph.

In addition, the following site restrictions must be met if Class B sludge is land applied:

- i. Food crops with harvested parts that touch the sewage sludge/soil mixture and are totally above the land surface shall not be harvested for 14 months after application of sewage sludge.
- ii. Food crops with harvested parts below the surface of the land shall not be harvested for 20 months after application of sewage sludge when the sewage sludge remains on the land surface for 4 months or longer prior to incorporation into the soil.
- iii. Food crops with harvested parts below the surface of the land shall not be harvested for 38 months after application of sewage sludge when the sewage sludge remains on the land surface for less than 4 months prior to incorporation into the soil.
- iv. Food crops, feed crops, and fiber crops shall not be harvested for 30 days after application of sewage sludge.
- v. Animals shall not be allowed to graze on the land for 30 days after application of sewage sludge.
- vi. Turf grown on land where sewage sludge is applied shall not be harvested for 1 year after application of the sewage sludge when the harvested turf is placed on either land with a high potential for public exposure or a lawn.
- vii. Public access to land with a high potential for public exposure shall be restricted for 1 year after application of sewage sludge.

viii. Public access to land with a low potential for public exposure shall be restricted for 30 days after application of sewage sludge.

ix. Land application of sludge shall be in accordance with the buffer zone requirements found in 30 TAC § 312.44.

4. Vector Attraction Reduction Requirements

All bulk sewage sludge that is applied to agricultural land, forest, a public contact site, or a reclamation site shall be treated by one of the following Alternatives 1 through 10 for vector attraction reduction.

- Alternative 1 - The mass of volatile solids in the sewage sludge shall be reduced by a minimum of 38%.
- Alternative 2 - If Alternative 1 cannot be met for an anaerobically digested sludge, demonstration can be made by digesting a portion of the previously digested sludge anaerobically in the laboratory in a bench-scale unit for 40 additional days at a temperature between 30° and 37° Celsius. Volatile solids must be reduced by less than 17% to demonstrate compliance.
- Alternative 3 - If Alternative 1 cannot be met for an aerobically digested sludge, demonstration can be made by digesting a portion of the previously digested sludge with percent solids of two percent or less aerobically in the laboratory in a bench-scale unit for 30 additional days at 20° Celsius. Volatile solids must be reduced by less than 15% to demonstrate compliance.
- Alternative 4 - The specific oxygen uptake rate (SOUR) for sewage sludge treated in an aerobic process shall be equal to or less than 1.5 milligrams of oxygen per hour per gram of total solids (dry weight basis) at a temperature of 20° Celsius.
- Alternative 5 - Sewage sludge shall be treated in an aerobic process for 14 days or longer. During that time, the temperature of the sewage sludge shall be higher than 40° Celsius and the average temperature of the sewage sludge shall be higher than 45° Celsius.
- Alternative 6 - The pH of sewage sludge shall be raised to 12 or higher by alkali addition and, without the addition of more alkali shall remain at 12 or higher for two hours and then remain at a pH of 11.5 or higher for an additional 22 hours at the time the sewage sludge is prepared for sale or given away in a bag or other container.
- Alternative 7 - The percent solids of sewage sludge that does not contain unstabilized solids generated in a primary wastewater treatment process shall be equal to or greater than 75% based on the moisture content and total solids prior to mixing with other materials. Unstabilized solids are defined as organic materials in sewage sludge that have not been treated in either an aerobic or anaerobic treatment process.

Alternative 8 - The percent solids of sewage sludge that contains unstabilized solids generated in a primary wastewater treatment process shall be equal to or greater than 90% based on the moisture content and total solids prior to mixing with other materials at the time the sludge is used. Unstabilized solids are defined as organic materials in sewage sludge that have not been treated in either an aerobic or anaerobic treatment process.

Alternative 9 -

- i. Sewage sludge shall be injected below the surface of the land.
- ii. No significant amount of the sewage sludge shall be present on the land surface within one hour after the sewage sludge is injected.
- iii. When sewage sludge that is injected below the surface of the land is Class A or Class AB with respect to pathogens, the sewage sludge shall be injected below the land surface within eight hours after being discharged from the pathogen treatment process.

Alternative 10 -

- i. Sewage sludge applied to the land surface or placed on a surface disposal site shall be incorporated into the soil within six hours after application to or placement on the land.
- ii. When sewage sludge that is incorporated into the soil is Class A or Class AB with respect to pathogens, the sewage sludge shall be applied to or placed on the land within eight hours after being discharged from the pathogen treatment process.

C. Monitoring Requirements

Toxicity Characteristic Leaching Procedure (TCLP) Test	- once during the term of this permit
PCBs	- once during the term of this permit

All metal constituents and fecal coliform or *Salmonella* sp. bacteria shall be monitored at the appropriate frequency shown below, pursuant to 30 TAC § 312.46(a)(1):

<u>Amount of sewage sludge (*) metric tons per 365-day period</u>	<u>Monitoring Frequency</u>
0 to less than 290	Once/Year
290 to less than 1,500	Once/Quarter
1,500 to less than 15,000	Once/Two Months
15,000 or greater	Once/Month

(*) *The amount of bulk sewage sludge applied to the land (dry wt. basis).*

Representative samples of sewage sludge shall be collected and analyzed in accordance with the methods referenced in 30 TAC § 312.7.

Identify each of the analytic methods used by the facility to analyze enteric viruses, fecal coliforms, helminth ova, *Salmonella* sp., and other regulated parameters.

Identify in the following categories (as applicable) the sewage sludge treatment process or processes at the facility: preliminary operations (e.g., sludge grinding and degritting), thickening (concentration), stabilization, anaerobic digestion, aerobic digestion, composting, conditioning, disinfection (e.g., beta ray irradiation, gamma ray irradiation, pasteurization), dewatering (e.g., centrifugation, sludge drying beds, sludge lagoons), heat drying, thermal reduction, and methane or biogas capture and recovery.

Identify the nature of material generated by the facility (such as a biosolid for beneficial use or land-farming, or sewage sludge for disposal at a monofill) and whether the material is ultimately conveyed off-site in bulk or in bags.

SECTION II. REQUIREMENTS SPECIFIC TO BULK SEWAGE SLUDGE FOR APPLICATION TO THE LAND MEETING CLASS A, CLASS AB or B PATHOGEN REDUCTION AND THE CUMULATIVE LOADING RATES IN TABLE 2, OR CLASS B PATHOGEN REDUCTION AND THE POLLUTANT CONCENTRATIONS IN TABLE 3

For those permittees meeting Class A, Class AB or B pathogen reduction requirements and that meet the cumulative loading rates in Table 2 below, or the Class B pathogen reduction requirements and contain concentrations of pollutants below listed in Table 3, the following conditions apply:

A. Pollutant Limits

Table 2

<u>Pollutant</u>	<u>Cumulative Pollutant Loading Rate (pounds per acre)*</u>
Arsenic	36
Cadmium	35
Chromium	2677
Copper	1339
Lead	268
Mercury	15
Molybdenum	Report Only
Nickel	375
Selenium	89
Zinc	2500

Table 3

<u>Pollutant</u>	<u>Monthly Average Concentration (milligrams per kilogram)*</u>
Arsenic	41
Cadmium	39
Chromium	1200
Copper	1500
Lead	300
Mercury	17
Molybdenum	Report Only
Nickel	420
Selenium	36
Zinc	2800

*Dry weight basis

B. Pathogen Control

All bulk sewage sludge that is applied to agricultural land, forest, a public contact site, a reclamation site, shall be treated by either Class A, Class AB or Class B pathogen reduction requirements as defined above in Section I.B.3.

C. Management Practices

1. Bulk sewage sludge shall not be applied to agricultural land, forest, a public contact site, or a reclamation site that is flooded, frozen, or snow-covered so that the bulk sewage sludge enters a wetland or other waters in the State.
2. Bulk sewage sludge not meeting Class A requirements shall be land applied in a manner which complies with Applicability in accordance with 30 TAC § 312.41 and the Management Requirements in accordance with 30 TAC § 312.44.
3. Bulk sewage sludge shall be applied at or below the agronomic rate of the cover crop.
4. An information sheet shall be provided to the person who receives bulk sewage sludge sold or given away. The information sheet shall contain the following information:
 - a. The name and address of the person who prepared the sewage sludge that is sold or given away in a bag or other container for application to the land.
 - b. A statement that application of the sewage sludge to the land is prohibited except in accordance with the instruction on the label or information sheet.
 - c. The annual whole sludge application rate for the sewage sludge application rate for the sewage sludge that does not cause any of the cumulative pollutant loading rates in Table 2 above to be exceeded, unless the pollutant concentrations in Table 3 found in Section II above are met.

D. Notification Requirements

1. If bulk sewage sludge is applied to land in a State other than Texas, written notice shall be provided prior to the initial land application to the permitting authority for the State in which the bulk sewage sludge is proposed to be applied. The notice shall include:
 - a. The location, by street address, and specific latitude and longitude, of each land application site.
 - b. The approximate time period bulk sewage sludge will be applied to the site.
 - c. The name, address, telephone number, and National Pollutant Discharge Elimination System permit number (if appropriate) for the person who will apply the bulk sewage sludge.
2. The permittee shall give 180 days prior notice to the Executive Director in care of the Wastewater Permitting Section (MC 148) of the Water Quality Division of any change planned in the sewage sludge disposal practice.

E. Record keeping Requirements

The sludge documents will be retained at the facility site and/or shall be readily available for review by a TCEQ representative. The person who prepares bulk sewage sludge or a sewage sludge material shall develop the following information and shall retain the information at

the facility site and/or shall be readily available for review by a TCEQ representative for a period of five years. If the permittee supplies the sludge to another person who land applies the sludge, the permittee shall notify the land applier of the requirements for record keeping found in 30 TAC § 312.47 for persons who land apply.

1. The concentration (mg/kg) in the sludge of each pollutant listed in Table 3 above and the applicable pollutant concentration criteria (mg/kg), or the applicable cumulative pollutant loading rate and the applicable cumulative pollutant loading rate limit (lbs/ac) listed in Table 2 above.
2. A description of how the pathogen reduction requirements are met (including site restrictions for Class AB and Class B sludge, if applicable).
3. A description of how the vector attraction reduction requirements are met.
4. A description of how the management practices listed above in Section II.C are being met.
5. The following certification statement:

"I certify, under penalty of law, that the applicable pathogen requirements in 30 TAC § 312.82(a) or (b) and the vector attraction reduction requirements in 30 TAC § 312.83(b) have been met for each site on which bulk sewage sludge is applied. This determination has been made under my direction and supervision in accordance with the system designed to ensure that qualified personnel properly gather and evaluate the information used to determine that the management practices have been met. I am aware that there are significant penalties for false certification including fine and imprisonment."
6. The recommended agronomic loading rate from the references listed in Section II.C.3. above, as well as the actual agronomic loading rate shall be retained. The person who applies bulk sewage sludge or a sewage sludge material shall develop the following information and shall retain the information at the facility site and/or shall be readily available for review by a TCEQ representative indefinitely. If the permittee supplies the sludge to another person who land applies the sludge, the permittee shall notify the land applier of the requirements for record keeping found in 30 TAC § 312.47 for persons who land apply:
 - a. A certification statement that all applicable requirements (specifically listed) have been met, and that the permittee understands that there are significant penalties for false certification including fine and imprisonment. See 30 TAC § 312.47(a)(4)(A)(ii) or 30 TAC § 312.47(a)(5)(A)(ii), as applicable, and to the permittee's specific sludge treatment activities.
 - b. The location, by street address, and specific latitude and longitude, of each site on which sludge is applied.
 - c. The number of acres in each site on which bulk sludge is applied.
 - d. The date and time sludge is applied to each site.

- e. The cumulative amount of each pollutant in pounds/acre listed in Table 2 applied to each site.
- f. The total amount of sludge applied to each site in dry tons.

The above records shall be maintained on-site on a monthly basis and shall be made available to the Texas Commission on Environmental Quality upon request.

F. Reporting Requirements

The permittee shall report annually to the TCEQ Regional Office (MC Region 13) and Compliance Monitoring Team (MC 224) of the Enforcement Division, by September 30th of each year the following information. Effective September 1, 2020, the permittee must submit this annual report using the online electronic reporting system available through the TCEQ website unless the permittee requests and obtains an electronic reporting waiver.

1. Identify in the following categories (as applicable) the sewage sludge treatment process or processes at the facility: preliminary operations (e.g., sludge grinding and degritting), thickening (concentration), stabilization, anaerobic digestion, aerobic digestion, composting, conditioning, disinfection (e.g., beta ray irradiation, gamma ray irradiation, pasteurization), dewatering (e.g., centrifugation, sludge drying beds, sludge lagoons), heat drying, thermal reduction, and methane or biogas capture and recovery.
2. Identify the nature of material generated by the facility (such as a biosolid for beneficial use or land-farming, or sewage sludge for disposal at a monofill) and whether the material is ultimately conveyed off-site in bulk or in bags.
3. Results of tests performed for pollutants found in either Table 2 or 3 as appropriate for the permittee's land application practices.
4. The frequency of monitoring listed in Section I.C. that applies to the permittee.
5. Toxicity Characteristic Leaching Procedure (TCLP) results.
6. PCB concentration in sludge in mg/kg.
7. Identity of hauler(s) and TCEQ transporter number.
8. Date(s) of transport.
9. Texas Commission on Environmental Quality registration number, if applicable.
10. Amount of sludge disposal dry weight (lbs/acre) at each disposal site.
11. The concentration (mg/kg) in the sludge of each pollutant listed in Table 1 (defined as a monthly average) as well as the applicable pollutant concentration criteria (mg/kg) listed in Table 3 above, or the applicable pollutant loading rate limit (lbs/acre) listed in Table 2 above if it exceeds 90% of the limit.
12. Level of pathogen reduction achieved (Class A, Class AB or Class B).
13. Alternative used as listed in Section I.B.3.(a. or b.). Alternatives describe how the pathogen reduction requirements are met. If Class B sludge, include information on how site restrictions were met.

14. Identify each of the analytic methods used by the facility to analyze enteric viruses, fecal coliforms, helminth ova, *Salmonella* sp., and other regulated parameters.
15. Vector attraction reduction alternative used as listed in Section I.B.4.
16. Amount of sludge transported in dry tons/year.
17. The certification statement listed in either 30 TAC § 312.47(a)(4)(A)(ii) or 30 TAC § 312.47(a)(5)(A)(ii) as applicable to the permittee's sludge treatment activities, shall be attached to the annual reporting form.
18. When the amount of any pollutant applied to the land exceeds 90% of the cumulative pollutant loading rate for that pollutant, as described in Table 2, the permittee shall report the following information as an attachment to the annual reporting form.
 - a. The location, by street address, and specific latitude and longitude.
 - b. The number of acres in each site on which bulk sewage sludge is applied.
 - c. The date and time bulk sewage sludge is applied to each site.
 - d. The cumulative amount of each pollutant (i.e., pounds/acre) listed in Table 2 in the bulk sewage sludge applied to each site.
 - e. The amount of sewage sludge (i.e., dry tons) applied to each site.

The above records shall be maintained on a monthly basis and shall be made available to the Texas Commission on Environmental Quality upon request.

**SECTION III. REQUIREMENTS APPLYING TO ALL SEWAGE SLUDGE
DISPOSED IN A MUNICIPAL SOLID WASTE LANDFILL**

- A. The permittee shall handle and dispose of sewage sludge in accordance with 30 TAC § 330 and all other applicable state and federal regulations to protect public health and the environment from any reasonably anticipated adverse effects due to any toxic pollutants that may be present. The permittee shall ensure that the sewage sludge meets the requirements in 30 TAC § 330 concerning the quality of the sludge disposed in a municipal solid waste landfill.
- B. If the permittee generates sewage sludge and supplies that sewage sludge to the owner or operator of a municipal solid waste landfill (MSWLF) for disposal, the permittee shall provide to the owner or operator of the MSWLF appropriate information needed to be in compliance with the provisions of this permit.
- C. The permittee shall give 180 days prior notice to the Executive Director in care of the Wastewater Permitting Section (MC 148) of the Water Quality Division of any change planned in the sewage sludge disposal practice.
- D. Sewage sludge shall be tested once during the term of this permit in accordance with the method specified in both 40 CFR Part 261, Appendix II and 40 CFR Part 268, Appendix I (Toxicity Characteristic Leaching Procedure) or other method, which receives the prior approval of the TCEQ for contaminants listed in Table 1 of 40 CFR § 261.24. Sewage sludge failing this test shall be managed according to RCRA standards for generators of hazardous waste, and the waste's disposition must be in accordance with all applicable requirements for hazardous waste processing, storage, or disposal.

Following failure of any TCLP test, the management or disposal of sewage sludge at a facility other than an authorized hazardous waste processing, storage, or disposal facility shall be prohibited until such time as the permittee can demonstrate the sewage sludge no longer exhibits the hazardous waste toxicity characteristics (as demonstrated by the results of the TCLP tests). A written report shall be provided to both the TCEQ Registration and Reporting Section (MC 129) of the Permitting and Remediation Support Division and the Regional Director (MC Region 13) of the appropriate TCEQ field office within 7 days after failing the TCLP Test.

The report shall contain test results, certification that unauthorized waste management has stopped and a summary of alternative disposal plans that comply with RCRA standards for the management of hazardous waste. The report shall be addressed to: Director, Registration, Review, and Reporting Division (MC 129), Texas Commission on Environmental Quality, P. O. Box 13087, Austin, Texas 78711-3087. In addition, the permittee shall prepare an annual report on the results of all sludge toxicity testing. This annual report shall be submitted to the TCEQ Regional Office (MC Region 13) and the Compliance Monitoring Team (MC 224) of the Enforcement Division by September 30 of each year.

- E. Sewage sludge shall be tested as needed, in accordance with the requirements of 30 TAC Chapter 330.
- F. Record keeping Requirements

The permittee shall develop the following information and shall retain the information for five years.

1. The description (including procedures followed and the results) of all liquid Paint Filter Tests performed.
2. The description (including procedures followed and results) of all TCLP tests performed.

The above records shall be maintained on-site on a monthly basis and shall be made available to the Texas Commission on Environmental Quality upon request.

G. Reporting Requirements

The permittee shall report annually to the TCEQ Regional Office (MC Region 13) and Compliance Monitoring Team (MC 224) of the Enforcement Division by September 30th of each year the following information. Effective September 1, 2020, the permittee must submit this annual report using the online electronic reporting system available through the TCEQ website unless the permittee requests and obtains an electronic reporting waiver.

1. Identify in the following categories (as applicable) the sewage sludge treatment process or processes at the facility: preliminary operations (e.g., sludge grinding and degritting), thickening (concentration), stabilization, anaerobic digestion, aerobic digestion, composting, conditioning, disinfection (e.g., beta ray irradiation, gamma ray irradiation, pasteurization), dewatering (e.g., centrifugation, sludge drying beds, sludge lagoons), heat drying, thermal reduction, and methane or biogas capture and recovery.
2. Toxicity Characteristic Leaching Procedure (TCLP) results.
3. Annual sludge production in dry tons/year.
4. Amount of sludge disposed in a municipal solid waste landfill in dry tons/year.
5. Amount of sludge transported interstate in dry tons/year.
6. A certification that the sewage sludge meets the requirements of 30 TAC § 330 concerning the quality of the sludge disposed in a municipal solid waste landfill.
7. Identity of hauler(s) and transporter registration number.
8. Owner of disposal site(s).
9. Location of disposal site(s).
10. Date(s) of disposal.

The above records shall be maintained on-site on a monthly basis and shall be made available to the Texas Commission on Environmental Quality upon request.

SECTION IV. REQUIREMENTS APPLYING TO SLUDGE TRANSPORTED TO ANOTHER FACILITY FOR FURTHER PROCESSING

These provisions apply to sludge that is transported to another wastewater treatment facility or facility that further processes sludge. These provisions are intended to allow transport of sludge to facilities that have been authorized to accept sludge. These provisions do not limit the ability of the receiving facility to determine whether to accept the sludge, nor do they limit the ability of the receiving facility to request additional testing or documentation.

A. General Requirements

1. The permittee shall handle and dispose of sewage sludge in accordance with 30 TAC Chapter 312 and all other applicable state and federal regulations in a manner that protects public health and the environment from any reasonably anticipated adverse effects due to any toxic pollutants that may be present in the sludge.
2. Sludge may only be transported using a registered transporter or using an approved pipeline.

B. Record Keeping Requirements

1. For sludge transported by an approved pipeline, the permittee must maintain records of the following:
 - a. the amount of sludge transported;
 - b. the date of transport;
 - c. the name and TCEQ permit number of the receiving facility or facilities;
 - d. the location of the receiving facility or facilities;
 - e. the name and TCEQ permit number of the facility that generated the waste; and
 - f. copy of the written agreement between the permittee and the receiving facility to accept sludge.
2. For sludge transported by a registered transporter, the permittee must maintain records of the completed trip tickets in accordance with 30 TAC § 312.145(a)(1)-(7) and amount of sludge transported.
3. The above records shall be maintained on-site on a monthly basis and shall be made available to the TCEQ upon request. These records shall be retained for at least five years.

C. Reporting Requirements

The permittee shall report the following information annually to the TCEQ Regional Office (MC Region 13) and Compliance Monitoring Team (MC 224) of the Enforcement Division, by September 30th of each year. Effective September 1, 2020, the permittee must submit this annual report using the online electronic reporting system available through the TCEQ website unless the permittee requests and obtains an electronic reporting waiver.

1. Identify in the following categories (as applicable) the sewage sludge treatment process or processes at the facility: preliminary operations (e.g., sludge grinding and degritting), thickening (concentration), stabilization, anaerobic digestion, aerobic digestion, composting, conditioning, disinfection (e.g., beta ray irradiation, gamma ray irradiation, pasteurization), dewatering (e.g., centrifugation, sludge drying beds, sludge lagoons), heat drying, thermal reduction, and methane or biogas capture and recovery.
2. the annual sludge production;
3. the amount of sludge transported;
4. the owner of each receiving facility;
5. the location of each receiving facility; and
6. the date(s) of disposal at each receiving facility.

TCEQ Revision 01/2016

OTHER REQUIREMENTS

1. The permittee shall employ or contract with one or more licensed wastewater treatment facility operators or wastewater system operations companies holding a valid license or registration according to the requirements of 30 TAC Chapter 30, Occupational Licenses and Registrations, and in particular 30 TAC Chapter 30, Subchapter J, Wastewater Operators and Operations Companies.

This Category D facility in Interim I phase must be operated by a chief operator or an operator holding a Category D license or higher. This Category C facility in Interim II phase and Final phase must be operated by a chief operator or an operator holding a Category C license or higher. The facility must be operated a minimum of five days per week by the licensed chief operator or an operator holding the required level of license or higher. The licensed chief operator or operator holding the required level of license or higher must be available by telephone or pager seven days per week. Where shift operation of the wastewater treatment facility is necessary, each shift that does not have the on-site supervision of the licensed chief operator must be supervised by an operator in charge who is licensed not less than one level below the category for the facility.

2. The facility is not located in the Coastal Management Program boundary.
3. The permittee shall comply with the requirements of 30 TAC § 309.13(a) through (d). In addition, by ownership of the required buffer zone area, the permittee shall comply with the requirements of 30 TAC § 309.13(e).
4. In accordance with 30 TAC § 319.9, a permittee that has at least twelve months of uninterrupted compliance with its bacteria limit may notify the commission in writing of its compliance and request a less frequent measurement schedule. To request a less frequent schedule, the permittee shall submit a written request to the TCEQ Wastewater Permitting Section (MC 148) for each phase that includes a different monitoring frequency. The request must contain all of the reported bacteria values (Daily Avg. and Daily Max/Single Grab) for the twelve consecutive months immediately prior to the request. If the Executive Director finds that a less frequent measurement schedule is protective of human health and the environment, the permittee may be given a less frequent measurement schedule. For this permit, 1/quarter may be reduced to 1/6 months in the Interim I phase, and 1/month may be reduced to 1/quarter in the Interim II and Final phases. **A violation of any bacteria limit by a facility that has been granted a less frequent measurement schedule will require the permittee to return to the standard frequency schedule and submit written notice to the TCEQ Wastewater Permitting Section (MC 148).** The permittee may not apply for another reduction in measurement frequency for at least 24 months from the date of the last violation. The Executive Director may establish a more frequent measurement schedule if necessary to protect human health or the environment.
5. Prior to construction of the Interim II and Final phases of the treatment facility, the permittee shall submit to the TCEQ Wastewater Permitting Section (MC 148) a summary transmittal letter in accordance with the requirements in 30 TAC § 217.6(d). If requested by the Wastewater Permitting Section, the permittee shall submit plans and specifications and a final engineering design report which comply with 30 TAC Chapter 217, Design Criteria for Domestic Wastewater Systems. The permittee shall clearly show how the treatment system will meet the permitted effluent limitations required on Page 2a and 2b of this permit. A copy of the summary transmittal letter shall be available at the plant site for inspection by authorized representatives of the TCEQ.
6. The permittee shall notify the TCEQ Regional Office (MC Region 13) and the Applications Review and Processing Team (MC 148) of the Water Quality Division, in writing at least forty-five (45) days prior to the completion of the Interim II and Final phase facilities on Notification of Completion Form 20007.

**FOREST GLEN UTILITY COMPANY - APPLICATION FOR
CCN AMENDMENT ATTACHMENT 27**

O:\CompanyData\Clients\0762 - BVRT Water Resources, LPI0762-016-21 - FGU CCN Exhibits (Task Order #17)\Work in Progress\CCN Exhibits.dwg

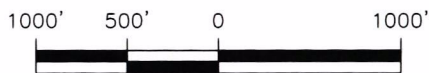
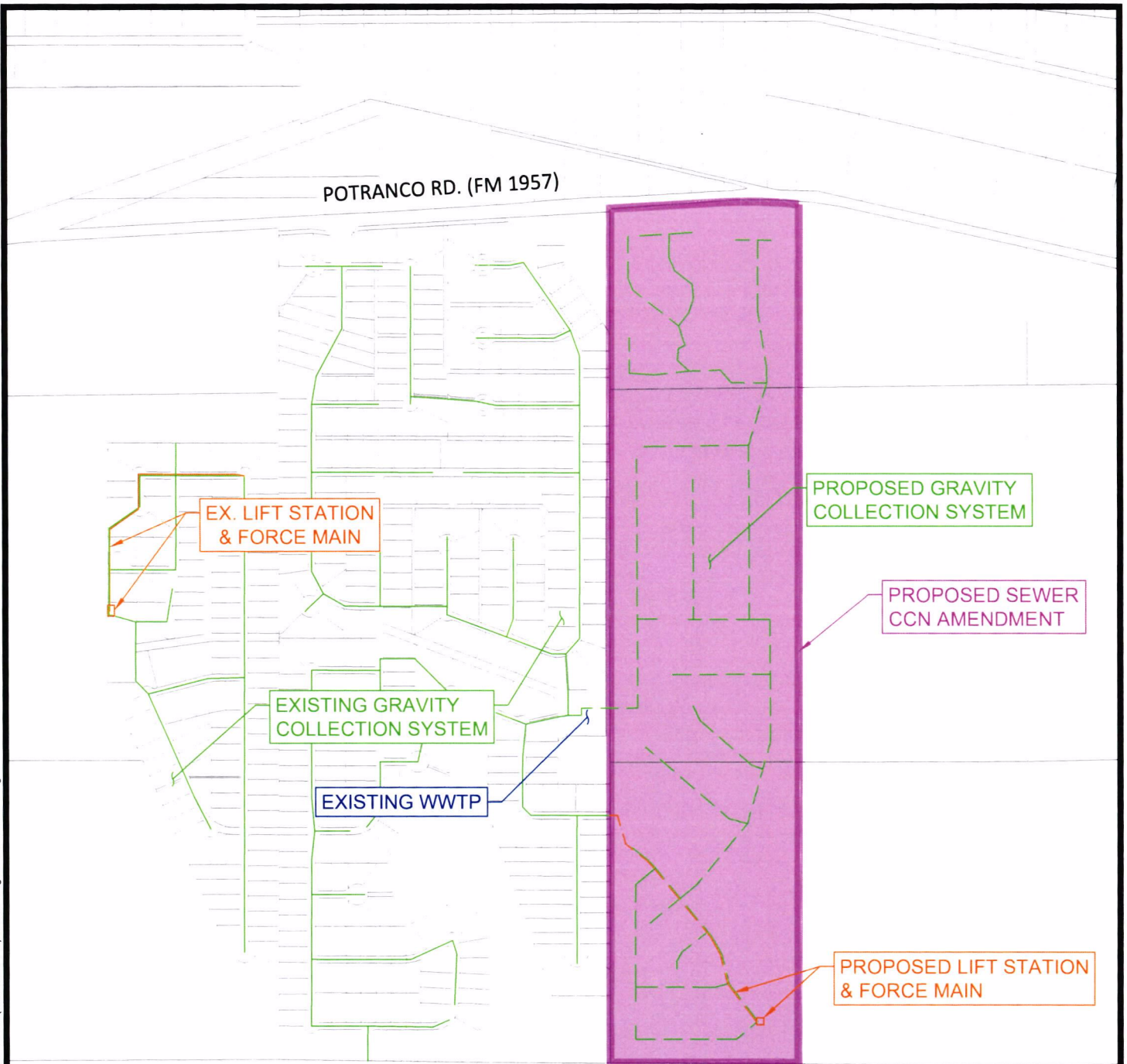

SCALE: 1" = 1000'



FACILITIES MAP JANUARY 2021

FOREST GLEN UTILITY COMPANY



Southwest Engineers

TBPE NO. F-1909
www.swengineers.com

HEADQUARTERS

307 Saint Lawrence Street, Gonzales TX 78629
P: 830.672.7546 F: 830.672.2034

CENTRAL TEXAS

205 Cimarron Park Loop, Ste. B, Buda TX 78610
P: 512.312.4336

FGU000067

**FOREST GLEN UTILITY COMPANY - APPLICATION
FOR CCN AMENDMENT ATTACHMENT 29**



SEWER UTILITY TARIFF
Docket Number 47897

Forest Glen Utility Company
(Utility Name)

15720 Bandera Road, # 103
(Business Address)

Helotes, Texas 78023
(City, State, Zip Code)

(210) 695-5490
(Area Code/Telephone)

This tariff is effective for utility operations under the following Certificate of Convenience and Necessity:

21070

This tariff is effective in the following county:

Medina

This tariff is effective in the following cities or unincorporated towns (if any):

N/A

This tariff is effective in the following subdivisions or systems:

Potranco Ranch Subdivision (WQ 15030-001)

TABLE OF CONTENTS

The above utility lists the following sections of its tariff (if additional pages are needed for a section, all pages should be numbered consecutively):

SECTION 1.0 -- RATE SCHEDULE	2
SECTION 2.0 -- SERVICE RULES AND POLICIES	4
SECTION 3.0 -- EXTENSION POLICY	9

APPENDIX A -- SAMPLE SERVICE AGREEMENT

SECTION 1.0 -- RATE SCHEDULE

Section 1.01 - Rates

The presiding officer has established the following interim rates to be in effect until the final decision on the requested rate change or until another interim rate is established.

Monthly Charge

Flat Rate of \$65.00 per connection.

FORM OF PAYMENT: The utility will accept the following forms of payment:

Cash X, Check X, Money Order X, Credit Card X, Other (specify)

THE UTILITY MAY REQUIRE EXACT CHANGE FOR PAYMENTS AND MAY REFUSE TO ACCEPT PAYMENTS MADE USING MORE THAN \$1.00 IN SMALL COINS. A WRITTEN RECEIPT WILL BE GIVEN FOR CASH PAYMENTS. AT THE CUSTOMER'S OPTION, ANY BILLING TRANSACTION OR COMMUNICATION MAY BE PERFORMED ON THE INTERNET. THIS INCLUDES THE UTILITY SENDING PAPERLESS BILLS BY EMAIL.

REGULATORY ASSESSMENT 1.0%

PUBLIC UTILITY COMMISSION (PUC) RULES REQUIRE THE UTILITY TO COLLECT A FEE OF ONE PERCENT OF THE RETAIL MONTHLY BILL AND TO REMIT FEE TO THE TEXAS COMMISSION ON ENVIRONMENTAL QUALITY (TCEQ)

TAP FEE \$300.00

TAP FEE IS BASED ON THE AVERAGE OF THE UTILITY'S ACTUAL COST FOR MATERIALS AND LABOR FOR STANDARD RESIDENTIAL CONNECTION OF 5/8" METER PLUS UNIQUE COSTS AS PERMITTED BY PUC RULE AT COST.

TAP FEE (Large Connection Tap)..... Actual Cost

TAP FEE IS BASED ON THE UTILITY'S ACTUAL COST FOR MATERIALS AND LABOR FOR METERS LARGER THAN STANDARD 5/8" METERS.

RECONNECTION FEE

THE RECONNECT FEE MUST BE PAID BEFORE SERVICE CAN BE RESTORED TO A CUSTOMER WHO HAS BEEN DISCONNECTED FOR THE FOLLOWING REASONS (OR OTHER REASONS LISTED UNDER SECTION 2.0 OF THIS TARIFF):

a) Non-payment of bill (Maximum \$25.00)..... \$25.00

b) Customer's request that service be disconnected \$50.00

or other reasons listed under Section 2.0 of this tariff

TRANSFER FEE \$50.00

THE TRANSFER FEE WILL BE CHARGED FOR CHANGING AN ACCOUNT NAME AT THE SAME SERVICE LOCATION WHEN THE SERVICE IS NOT DISCONNECTED.

SECTION 1.0 -- RATE SCHEDULE (Continued)

LATE CHARGE (Either \$5.00 or 10% of the bill).....10%
 COMMISSION RULES ALLOW A ONE-TIME PENALTY TO BE CHARGED ON DELINQUENT BILLS. A LATE CHARGE MAY NOT BE APPLIED TO ANY BALANCE TO WHICH THE PENALTY WAS APPLIED IN A PREVIOUS BILLING.

RETURNED CHECK CHARGE.....\$25.00
 RETURNED CHECK CHARGES MUST BE BASED ON THE UTILITY'S DOCUMENTABLE COST.

Section 1.02 – Miscellaneous Fees

CUSTOMER DEPOSIT RESIDENTIAL (Maximum \$50) \$50.00

COMMERCIAL AND NON-RESIDENTIAL DEPOSIT 1/6TH EST. ANNUAL BILL

GOVERNMENTAL TESTING, INSPECTION AND COSTS SURCHARGE CLAUSE:
 WHEN AUTHORIZED IN WRITING BY THE COMMISSION AND AFTER NOTICE TO CUSTOMERS, THE UTILITY MAY INCREASE RATES TO RECOVER INCREASED COSTS FOR INSPECTION FEES AND WATER TESTING. [16 TAC § 24.25(G)]

LINE EXTENSION AND CONSTRUCTION CHARGES:
 REFER TO SECTION 3.0--EXTENSION POLICY FOR TERMS, CONDITIONS, AND CHARGES WHEN NEW CONSTRUCTION IS NECESSARY TO PROVIDE SERVICE.

SECTION 2.0 - SERVICE RULES AND REGULATIONS

The Utility will have the most current Public Utility Commission of Texas (PUC or Commission) Rules, Chapter 24, available at its office for reference purposes. The Rules and this tariff shall be available for public inspection and reproduction at a reasonable cost. The latest Rules or Commission approved changes to the Rules supersede any rules or requirements in this tariff.

Section 2.01 - Application for Sewer Service

All applications for service will be made on the utility's standard application or contract form (attached in the Appendix to this tariff), will be signed by the applicant, any required fees (deposits, reconnect, tap, extension fees, etc. as applicable) will be paid and easements, if required, will be granted before service is provided by the utility. A separate application or contract will be made for each service location.

Section 2.02 – Refusal of Service

The Utility may decline to serve an applicant until the applicant has complied with the regulations of the regulatory agencies (state and municipal regulations) and for the reasons outlined in the commission rules. In the event that the Utility refuses to serve an applicant, the Utility will inform the applicant in writing of the basis of its refusal. The Utility is also required to inform the applicant that a complaint may be filed with the Commission.

Section 2.03 – Fees and Charges and Easements Required Before Service Can Be Connected

(A) Customer Deposits

If a residential applicant cannot establish credit to the satisfaction of the Utility, the applicant may be required to pay a deposit as provided for in Section 1.02 – Miscellaneous Fees of this tariff. The Utility will keep records of the deposit and credit interest in accordance with commission rules.

Residential applicants 65 years of age or older may not be required to pay deposits unless the applicant has an outstanding account balance with the Utility or another water or sewer utility that accrued within the last two years.

Nonresidential applicants who cannot establish credit to the satisfaction of the Utility may be required to make a deposit that does not exceed an amount equivalent to one-sixth of the estimated annual billings.

Refund of deposit - If service is not connected, or after disconnection of service, the Utility will promptly refund the customer's deposit plus accrued interest or the balance, if any, in excess of the unpaid bills for service furnished. The Utility may refund the deposit at any time prior to termination of utility service but must refund the deposit plus interest for any residential customer who has paid 18 consecutive billings without being delinquent. Deposits from non-residential customers may be held as long as that customer takes service.

SECTION 2.0 - SERVICE RULES AND REGULATIONS (Continued)**(B) Tap or Reconnect Fees**

A new customer requesting service at a location where service has not previously been provided must pay a tap fee as provided in Section 1. A customer requesting service where service has previously been provided must pay a reconnect fee as provided in Section 1. Any applicant or existing customer required to pay for any costs not specifically set forth in the rate schedule pages of this tariff shall be given a written explanation of such costs prior to request for payment and/or commencement of construction. If the applicant or existing customer does not believe that these costs are reasonable or necessary, the applicant or existing customer shall be informed of their right to appeal such costs to the commission or such other regulatory authority having jurisdiction over the utility's rates in that portion of the utility's service area in which the applicant's or existing customer's property (ies) is (are) located.

Fees in addition to the regular tap fee may be charged to cover unique costs not normally incurred as permitted by 16 TAC § 24.86(a)(1)(C) if they are listed on this approved tariff. For example, a road bore for customers outside a subdivision or residential area could be considered a unique cost.

(C) Easement Requirement

Where recorded public utility easements on the service applicant's property do not exist or public road right-of-way easements are not available to access the applicant's property, the utility may require the applicant to provide it with a permanent recorded public utility easement on and across the applicant's real property sufficient to provide service to that applicant. Such easement(s) shall not be used for the construction of production, storage, transmission or pressure facilities unless they are needed for adequate service to that applicant.

Section 2.04 - Utility Response to Applications for Service

After the applicant has met all the requirements, conditions and regulations for service, the utility will install tap and utility cut-off and/or take all necessary actions to initiate service. The utility will serve each qualified applicant for service within 5 working days unless line extensions or new facilities are required. If construction is required to fill the order and if it cannot be completed within 30 days, the utility will provide the applicant with a written explanation of the construction required and an expected date of service.

Except for good cause where service has previously been provided, service will be reconnected within one working day after the applicant has met the requirements for reconnection.

Section 2.05 - Customer Responsibility

The customer will be responsible for furnishing and laying the necessary customer service pipe from the tap location to the place of consumption. Customers will not be allowed to use the utility's cutoff.

SECTION 2.0 - SERVICE RULES AND REGULATIONS (Continued)

Section 2.06 Access to Customer's Premises

All customers or service applicants shall provide access to utility cutoffs at all times reasonably necessary to conduct ordinary utility business and after normal business hours as needed to protect and preserve the integrity of the public drinking water supply.

Section 2.07 - Back Flow Prevention Devices

No water connection shall be made to any establishment where an actual or potential contamination or system hazard exists without an approved air gap or mechanical backflow prevention assembly. The air gap or backflow prevention assembly shall be installed in accordance with the American Water Works Association (AWWA) standards C510, C511 and AWWA Manual M14 or the University Of Southern California Manual Of Cross-Connection Control, current edition. The backflow assembly installation by a licensed plumber shall occur at the customer's expense.

The back flow assembly shall be tested upon installation by a recognized prevention assembly tester and certified to be operating within specifications. Back flow prevention assemblies which are installed to provide protection against high health hazards must be tested and certified to be operating within specifications at least annually by a recognized back flow prevention device tester. The maintenance and testing of the back flow assembly shall occur at the customer's expense.

Section 2.10 - Billing

(A) Regular Billing

Bills from the utility will be mailed monthly unless otherwise authorized by the Commission. The due date of bills for utility service will be at least sixteen (16) days from the date of issuance. The postmark on the bill or, if there is no postmark on the bill, the recorded date of mailing by the utility will constitute proof of the date of issuance. Payment for utility service is delinquent if full payment, including late fees and the regulatory assessment, is not received at the utility or the utility's authorized payment agency by 5:00 p.m. on the due date. If the due date falls on a holiday or weekend, the due date for payment purposes will be the next workday after the due date.

(B) Late Fees

A late penalty of either \$5.00 or 10.0% will be charged on bills received after the due date. The penalty on delinquent bills will not be applied to any balance to which the penalty was applied in a previous billing. The utility must maintain a record of the date of mailing to charge the late penalty.

(C) Information on Bill

Each bill will provide all information required by the commission rules. For each of the systems it operates, the utility will maintain and note on the monthly bill a local or toll-free telephone number (or numbers) to which customers can direct questions about their utility service.

SECTION 2.0 - SERVICE RULES AND REGULATIONS (Continued)

(D) Prorated Bills

If service is interrupted or seriously impaired for 24 consecutive hours or more, the utility will prorate the monthly base bill in proportion to the time service was not available to reflect this loss of service.

Section 2.11 - Payments

All payments for utility service shall be delivered or mailed to the utility's business office. If the business office fails to receive payment prior to the time of noticed disconnection for non-payment of a delinquent account, service will be terminated as scheduled. Utility service crews shall not be allowed to collect payments on customer accounts in the field.

Payment of an account by any means that has been dishonored and returned by the payor or payee's bank shall be deemed to be delinquent. All returned payments must be redeemed with cash or valid money order. If a customer has two returned payments within a twelve month period, the customer shall be required to pay a deposit if one has not already been paid.

Section 2.12 - Service Disconnection

(A) With Notice

Utility service may be disconnected if the bill has not been paid in full by the date listed on the termination notice. The termination date must be at least 10 days after the notice is mailed or hand delivered.

The utility is encouraged to offer a deferred payment plan to a customer who cannot pay an outstanding bill in full and is willing to pay the balance in reasonable installments. However, a customer's utility service may be disconnected if a bill has not been paid or a deferred payment agreement entered into within 26 days from the date of issuance of a bill and if proper notice of termination has been given.

Notice of termination must be a separate mailing or hand delivery in accordance with the commission rules.

(B) Without Notice

Utility service may also be disconnected without notice for reasons as described in the commission rules.

Section 2.13 - Reconnection of Service

Utility personnel must be available during normal business hours to accept payments on the day service is disconnected and the following day unless service was disconnected at the customer's request or due to a hazardous condition.

SECTION 2.0 - SERVICE RULES AND REGULATIONS (Continued)

Service will be reconnected within 24 hours after the past due bill, reconnect fees and any other outstanding charges are paid or the conditions which caused service to be disconnected are corrected.

Section 2.14 - Service Interruptions

The utility will make all reasonable efforts to prevent interruptions of service. If interruptions occur, the utility will re-establish service within the shortest possible time. Except for momentary interruptions due to automatic equipment operations, the utility will keep a complete record of all interruptions, both emergency and scheduled and will notify the Commission in writing of any service interruptions affecting the entire system or any major division of the system lasting more than four hours. The notice will explain the cause of the interruptions.

Section 2.15 - Quality of Service

The Utility will plan, furnish, and maintain production, treatment, storage, transmission, and distribution facilities of sufficient size and capacity to provide a continuous and adequate supply of water for all reasonable consumer uses. Unless otherwise authorized by the Commission, the Utility will maintain facilities as described in the TCEQ Rules and Regulations for Public Water Systems.

Section 2.16 - Customer Complaints and Disputes

If a customer or applicant for service lodges a complaint, the Utility will promptly make a suitable investigation and advise the complainant of the results. Service will not be disconnected pending completion of the investigation. If the complainant is dissatisfied with the Utility's response, the Utility must advise the complainant that he has recourse through the PUC complaint process. Pending resolution of a complaint, the Commission may require continuation or restoration of service.

The Utility will maintain a record of all complaints which shows the name and address of the complainant, the date and nature of the complaint and the adjustment or disposition thereof, for a period of two years after the final settlement of the complaint.

In the event of a dispute between a customer and a utility regarding any bill for utility service, the utility will conduct an investigation and report the results to the customer. If the dispute is not resolved, the utility will inform the customer that a complaint may be filed with the Commission.

Section 2.17 - Customer Liability

Customer shall be liable for any damage or injury to utility-owned property shown to be caused by the customer.

SECTION 3.0 - EXTENSION POLICY

Section 3.01 - Standard Extension Requirements

Line Extension and Construction Charges: No Contribution In Aid of Construction may be required of any customer except as provided for in this approved extension policy.

The utility is not required to extend service to any applicant outside of its certified service area and will only do so under terms and conditions mutually agreeable to the utility and the applicant, in compliance with commission rules and policies, and upon extension of the utility's certified service area boundaries by the commission.

The applicant for service will be given an itemized statement of the costs, options such as rebates to the customer, sharing of construction costs between the utility and the customer, or sharing of costs between the customer and other applicants prior to beginning construction.

Section 3.02 - Costs Utilities and Service Applicants Shall Bear

Within its certified area, the utility will pay the cost of the first 200 feet of any water main or distribution line necessary to extend service to an individual residential customer within a platted subdivision.

However, if the residential customer requesting service purchased the property after the developer was notified in writing of the need to provide facilities to the utility, the utility may charge for the first 200 feet. The utility must also be able to document that the developer of the subdivision refused to provide facilities compatible with the utility's facilities in accordance with the utility's approved extension policy after receiving a written request from the utility.

Residential customers will be charged the equivalent of the costs of extending service to their property from the nearest collection line even if that line does not have adequate capacity to serve the customer. However, if the customer places unique, non-standard service demands upon the system, the customer may be charged the additional cost of extending service to and throughout their property, including the cost of all necessary transmission and storage facilities necessary to meet the service demands anticipated to be created by that property.

Unless an exception is granted by the PUC, the residential service applicant shall not be required to pay for costs of main extensions greater than 6" in diameter for gravity wastewater lines.

Exceptions may be granted by the PUC if

- adequate service cannot be provided to the applicant using the maximum line sizes listed due to distance or elevation, in which case, it shall be the utility's burden to justify that a larger diameter pipe is required for adequate service;
- or larger minimum line sizes are required under subdivision platting requirements or building codes of municipalities within whose corporate limits or extraterritorial jurisdiction the point of use is located; or the residential service applicant is located outside the CCN service area.

SECTION 3.0 - EXTENSION POLICY (continued)

If an exception is granted, the utility shall establish a proportional cost plan for the specific extension or a rebate plan which may be limited to seven years to return the portion of the applicant's costs for oversizing as new customers are added to ensure that future applicants for service on the line pay at least as much as the initial service applicant.

For purposes of determining the costs that service applicants shall pay, commercial customers with service demands greater than residential customer demands in the certified area, industrial, and wholesale customers shall be treated as developers.

If an applicant requires service other than the standard service provided by the utility, such applicant will be required to pay all expenses incurred by the utility in excess of the expenses that would be incurred in providing the standard service and connection beyond 200 feet and throughout his property including the cost of all necessary transmission facilities.

The utility will bear the full cost of any over-sizing of sewer mains necessary to serve other customers in the immediate area. The individual residential customer shall not be charged for any additional treatment facilities. Contributions in aid of construction of individual residential customers for production, storage, treatment or transmission facilities unless otherwise approved by the Commission under this specific extension policy.

Section 3.03 - Contributions in Aid of Construction

Developers may be required to provide contributions in aid of construction in amounts sufficient to furnish the development with all facilities necessary to provide for reasonable local demand requirements and to comply with the TCEQ minimum design criteria for facilities used in the production, collection, transmission, pumping, or treatment of sewage or the TCEQ minimum requirements. For purposes of this subsection, a developer is one who subdivides or requests more than two meters on a piece of property. Commercial, industrial, and wholesale customers will be treated as developers.

Any applicant who places unique or non-standard service demands on the system may be required to provide contributions in aid of construction for the actual costs of any additional facilities required to maintain compliance with the TCEQ minimum design criteria for water production, treatment, pumping, storage and transmission.

Any service extension to a subdivision (recorded or unrecorded) may be subject to the provisions and restrictions of 16 TAC § 24.86(d). When a developer wishes to extend the system to prepare to service multiple new connections, the charge shall be the cost of such extension, plus a pro-rata charge for facilities which must be committed to such extension compliant with the TCEQ minimum design criteria. As provided by 16 TAC § 24.85(e)(3), for purposes of this section, commercial, industrial, and wholesale customers shall be treated as developers.

SECTION 3.0 - EXTENSION POLICY (Continued)

A utility may only charge a developer standby fees for unrecovered costs of facilities committed to a developer's property under the following circumstances:

- Under a contract and only in accordance with the terms of the contract; or
- if service is not being provided to a lot or lots within two years after installation of facilities necessary to provide service to the lots has been completed and if the standby fees are included on the utilities approved tariff after a rate change application has been filed. The fees cannot be billed to the developer or collected until the standby fees have been approved by the commission or executive director.
- For purposes of this section, a manufactured housing rental community can only be charged standby fees under a contract or if the utility installs the facilities necessary to provide individually metered service to each of the rental lots or spaces in the community.

Section 3.04 - Appealing Connection Costs

The imposition of additional extension costs or charges as provided by Sections 3.0 - Extension Policy of this tariff shall be subject to appeal as provided in this tariff, commission rules, or the rules of such other regulatory authority as may have jurisdiction over the utility's rates and services. Any applicant required to pay for any costs not specifically set forth in the rate schedule pages of this tariff shall be given a written explanation of such costs prior to payment and/or commencement of construction. If the applicant does not believe that these costs are reasonable or necessary, the applicant shall be informed of the right to appeal such costs to the commission or such other regulatory authority having jurisdiction over the utility's rates in that portion of the utility's service area in which the applicant's property(ies) is (are) located.

Section 3.05 - Applying for Service

The utility will provide a written service application form to the applicant for each request for service received by the utility's business offices. A separate application shall be required for each potential service location if more than one service connection is desired by any individual applicant. Service application forms will be available at the utility's business office during normal weekday business hours. Service applications will be sent by prepaid first class United States mail to the address provided by the applicant upon request. Completed applications should be returned by hand delivery in case there are questions which might delay fulfilling the service request. Completed service applications may be submitted by mail if hand delivery is not possible.

Where a new tap or service connection is required, the service applicant shall be required to submit a written service application and request that a tap be made. A diagram, map, plat, or written metes and bounds description of precisely where the applicant desires each tap or service connection is to be made and, if necessary, where the meter is to be installed, along the applicant's property line may also be required with the tap request. The actual point of connection and meter installation must be readily accessible to utility personnel for inspection, servicing, and meter reading while being reasonably secure from damage by vehicles and mowers. If the utility has more than one main adjacent to the service applicant's property, the tap or service connection will be made to the utility's nearest service main with adequate capacity to service the applicant's full potential service demand.

SECTION 3.0 - EXTENSION POLICY (continued)

Beyond the initial 200 feet, the customer shall bear only the equivalent cost of extending from the nearest main. If the tap or service connection cannot be made at the applicant's desired location, it will be made at another location mutually acceptable to the applicant and the utility. If no agreement on location can be made, the applicant may refer the matter to the commission for resolution.

Section 3.06 - Qualified Service Applicant

A "qualified service applicant" is an applicant who has: (1) met all of the utility's requirements for service contained in this tariff, commission rules and/or order, (2) has made payment or made arrangement for payment of tap fees, (3) has provided all easements and rights-of-way required to provide service to the requested location, (4) delivered an executed customer service inspection certificate to the Utility, if applicable, and (5) has executed a customer service application for each location to which service is being requested.

The utility shall serve each qualified service applicant within its certified service area as soon as practical after receiving a completed service application. All service requests will be fulfilled within the time limits prescribed by commission rules once the applicant has met all conditions precedent to achieving "qualified service applicant" status. If a service request cannot be fulfilled within the required period, the applicant shall be notified in writing of the delay, its cause and the anticipated date that service will be available. The commission service dates shall not become applicable until the service applicant has met all conditions precedent to becoming a qualified service applicant as defined by commission rules.

Section 3.07 - Developer Requirements

As a condition of service to a new subdivision, the utility shall require a developer (as defined by PUC rule) to provide permanent recorded public utility easements as a condition of service to any location within the developer's property.

APPENDIX A -- SAMPLE SERVICE AGREEMENT
From TCEQ Rules, 30 TAC Chapter 290.47(b), Appendix B
SERVICE AGREEMENT

- I. **PURPOSE.** The Forest Glen Utility Company is responsible for protecting the drinking water supply from contamination or pollution which could result from improper private water distribution system construction or configuration. The purpose of this service agreement is to notify each customer of the restrictions which are in place to provide this protection. The utility enforces these restrictions to ensure the public health and welfare. Each customer must sign this agreement before the Forest Glen Utility Company will begin service. In addition, when service to an existing connection has been suspended or terminated, the sewer system will not re-establish service unless it has a signed copy of this agreement.
- II. **RESTRICTIONS.** The following unacceptable practices are prohibited by State regulations.
- A. No direct connection between the public drinking water supply and a potential source of contamination is permitted. Potential sources of contamination shall be isolated from the public water system by an air-gap or an appropriate backflow prevention device.
 - B. No cross-connection between the public drinking water supply and a private water system is permitted. These potential threats to the public drinking water supply shall be eliminated at the service connection by the installation of an air-gap or a reduced pressure-zone backflow prevention device.
 - C. No connection which allows water to be returned to the public drinking water supply is permitted.
 - D. No pipe or pipe fitting which contains more than 8.0% lead may be used for the installation or repair of plumbing at any connection which provides water for human use.
 - E. No solder or flux which contains more than 0.2% lead can be used for the installation or repair of plumbing at any connection which provides water for human use.
- III. **SERVICE AGREEMENT.** The following are the terms of the service agreement between the NAME OF SEWER SYSTEM (the Sewer System) and NAME OF CUSTOMER (the Customer).
- A. The Sewer System will maintain a copy of this agreement as long as the Customer and/or the premises are connected to the Sewer System.
 - B. The Customer shall allow his property to be inspected for possible cross-connections and other potential contamination hazards. These inspections shall be conducted by the Sewer System or its designated agent prior to initiating new water service; when there is reason to believe that cross-connections or other potential contamination hazards exist; or after any major changes to the private water distribution facilities. The inspections shall be conducted during the Sewer System's normal business hours.
 - C. The Sewer System shall notify the Customer in writing of any cross-connection or other potential contamination hazard which has been identified during the initial inspection or the periodic re-inspection.
 - D. The Customer shall immediately remove or adequately isolate any potential cross-connections or other potential contamination hazards on his premises.
 - E. The Customer shall, at his expense, properly install, test, and maintain any backflow prevention device required by the Sewer System. Copies of all testing and maintenance records shall be provided to the Sewer System.
- IV. **ENFORCEMENT.** If the Customer fails to comply with the terms of the Service Agreement, the Sewer System shall, at its option, either terminate service or properly install, test, and maintain an appropriate backflow prevention device at the service connection. Any expenses associated with the enforcement of this agreement shall be billed to the Customer.

Customer's Signature

Date

**FOREST GLEN UTILITY COMPANY - APPLICATION FOR
CCN AMENDMENT ATTACHMENT 30**

***APPENDICES A&B FINANCIAL INFORMATION FILED
CONFIDENTIALLY PER 16 TAC SEC. 22.71(d)***

**FOREST GLEN UTILITY COMPANY - APPLICATION FOR
CCN AMENDMENT ATTACHMENT 32(1)**

O:\CompanyData\Clients\0762 - BVRT Water Resources, LP\0762-016-21 - FGU CCN Exhibits\Work in Progress\CCN Exhibits.dwg

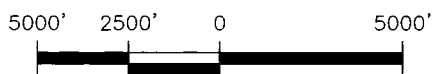
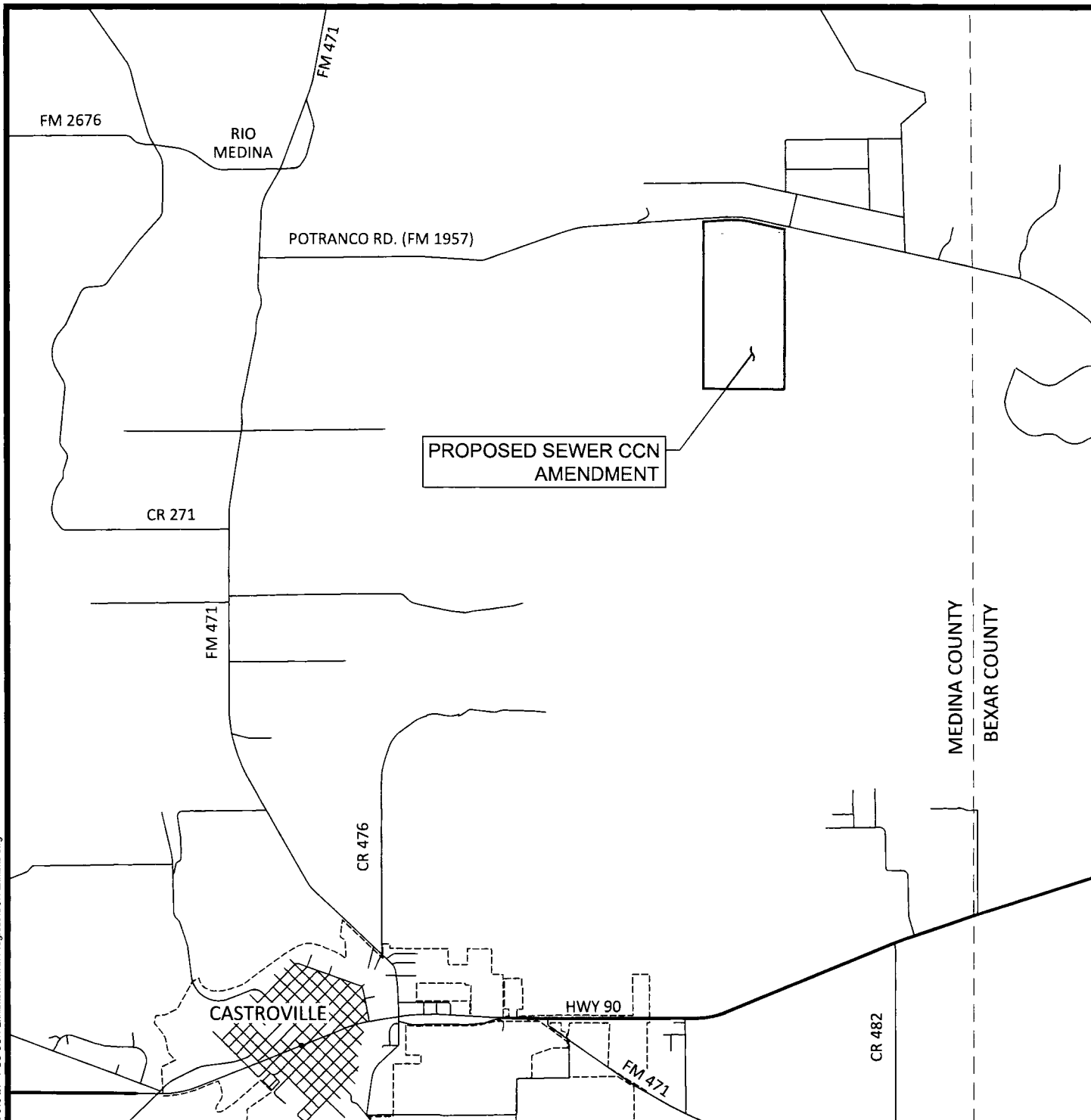

SCALE: 1" = 5000'



GENERAL LOCATION MAP
JANUARY 2021

FOREST GLEN UTILITY COMPANY



**Southwest
Engineers**

TBPE NO. F-1909
www.swengineers.com

HEADQUARTERS

307 Saint Lawrence Street, Gonzales TX 78629
P 830 672 7546 F 830 672 2034

CENTRAL TEXAS

205 Cimarron Park Loop, Ste B, Buda TX 78610
P 512 312 4336

FGU000004

**FOREST GLEN UTILITY COMPANY - APPLICATION
FOR CCN AMENDMENT ATTACHMENT 32(2)**

O:\CompanyData\Clients\0762 - BVRT Water Resources, LP\0762-016-21 - FGU CCN Exhibits\Work in Progress\CCN Exhibits.dwg

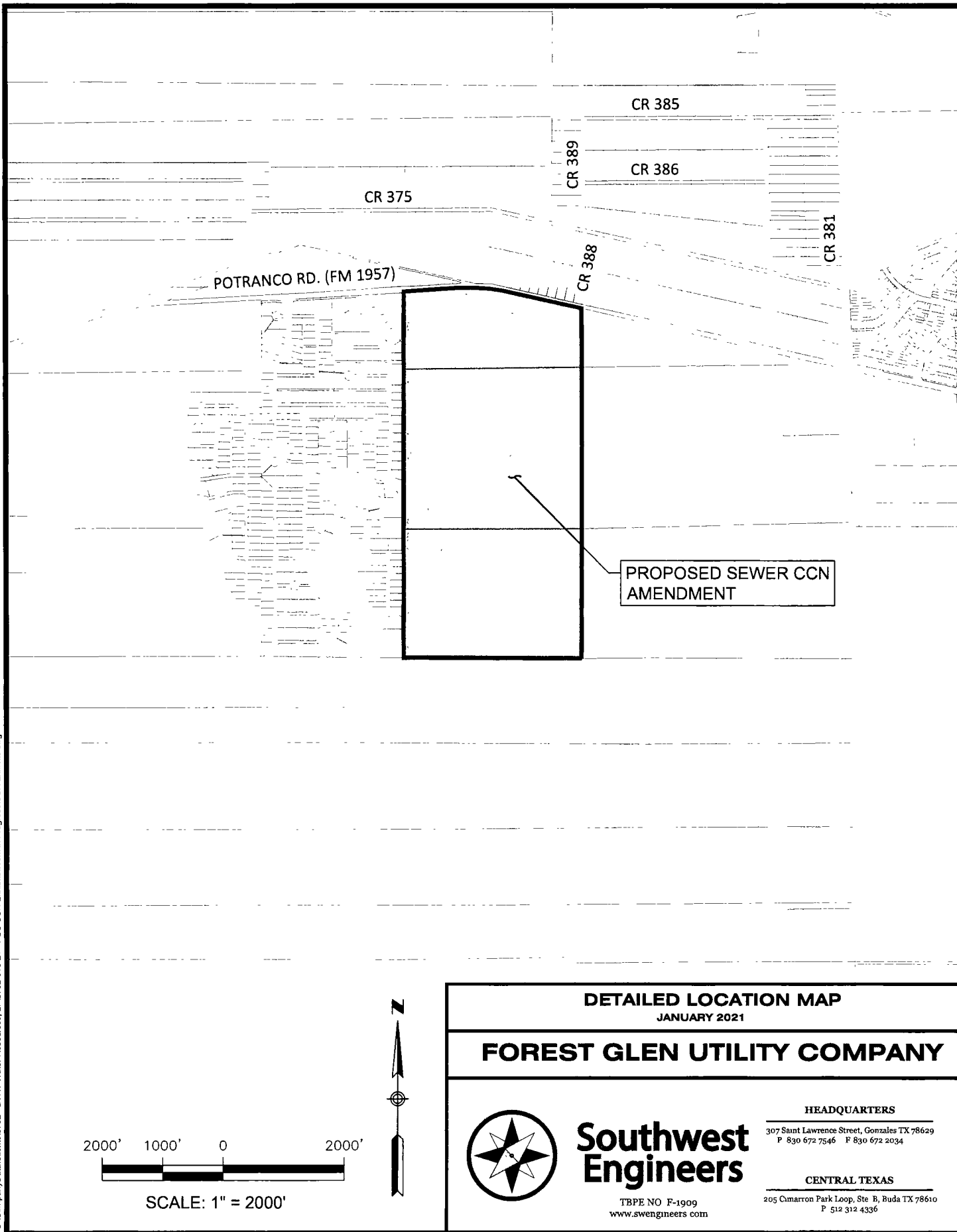

**FOREST GLEN UTILITY COMPANY - APPLICATION
FOR CCN AMENDMENT ATTACHMENT 32(3)**

SHP FILES FILED SEPARATELY