



Control Number: 51023



Item Number: 333

Addendum StartPage: 0

## Request to Intervene in PUC Docket No. 51023

The following information must be submitted by the person requesting to intervene in this proceeding. This completed form will be provided to all parties in this docket. **If you DO NOT want to be an intervenor, but still want to file comments, please complete the "Comments" page.**

Mail this completed form and 10 copies to:

Public Utility Commission of Texas  
Central Records  
Attn: Filing Clerk  
1701 N. Congress Ave.  
P.O. Box 13326  
Austin, TX 78711-3326



First Name: Raul Last Name: Figueroa  
Phone Number: (830) 755-6122 Fax Number: \_\_\_\_\_  
Address, City, State: 26670 Karsch Rd, Boerne, TX, 78006  
Email Address: rf-8787@hotmail.com

I am requesting to intervene in this proceeding. As an INTERVENOR, I understand the following:

- I am a party to the case;
- I am required to respond to all discovery requests from other parties in the case;
- If I file testimony, I may be cross-examined in the hearing;
- If I file any documents in the case, I will have to provide a copy of that document to every other party in the case; and
- I acknowledge that I am bound by the Procedural Rules of the Public Utility Commission of Texas (PUC) and the State Office of Administrative Hearings (SOAH).

Please check one of the following:

- ☒ I own property with a habitable structure located near one or more of the utility's proposed routes for a transmission line.
- ☐ One or more of the utility's proposed routes would cross my property.
- ☐ Other. Please describe and provide comments. You may attach a separate page, if necessary.

Signature of person requesting intervention:

A handwritten signature in black ink, appearing to read "Raul Figueroa", written over a horizontal line.

Date: 8/7/2020

Effective: April 8, 2020

26670 Karsch Rd.  
Boerne, TX, 78006  
Ph: 512-770-0326  
E-mail: rf\_0707@hotmail.com

August 7, 2020

Public Utility Commission of Texas  
Central Records  
Attn: Filing Clerk  
1701 N Congress Ave  
P.O. Box 13326  
Austin, TX, 78711-3326

Re: PUC Docket # 51023

To Whom It May Concern:

My wife and I recognize the need for and benefits of the Scenic Loop substation and transmission line project. However, proposed transmission line 46 is ill advised due to the negative impact it will have on the Crow Karsch / High Country Ranch community and our home. Out of the three proposed lines, 40, 46, and 49, for this area, the path of transmission line number 46 is the most concerning due to proximity, aesthetics, and possible health risks.

Transmission line 46 runs along a path with residential housing. Two of three TL poles will be placed along Karsch Rd a few feet away from water wells that deliver water to several homes in the community. One of two water wells is behind thick brush and trees, and it could have been missed by CPS or the consultants during the aerial survey to identify and evaluate transmission line segments. Furthermore, we are shocked to discover through the on-line map that line 46 snakes around our home (26670 Karsch Rd, Zip Code 78006) less than 200 feet away on three different sides outside our property line (circled on attached map). Our home is approximately 7 ft from the edge of Crow-Karsch ridge, and we are extremely concerned about the digging operations for the transmission line poles. The installation of the poles could impact the structure and foundation of our house.

Proposed transmission line 46 will desecrate the beautiful Crow Karsch landscape. Our home sits on a ridge that is known for its 20 – 30 mile panoramic views, *"Crow-Karsch Ranch Hill Country scenic views is something Boerne is known for. Did you know you could be so close to Boerne and still see all the way to the Tower of the Americas? Crow-Karsch Ranch is the little known place where you can do this. Go out there on a clear day and soak..."*, *Explore Magazine*. 3/28/14. Proposed transmission line 46 runs along the Crow Karsch Ranch ridge and will reduce the area's aesthetic quality. See attached pictures from our patio. Both photos are from 2017. If line 46 is selected, we will be looking at a pole with electrical lines approximately 200 feet away instead of jaw dropping scenery. Studies on high voltage transmission lines have shown proximity to and the visual encumbrance of transmission lines has a varying negative on property values. Our property will suffer a permanent diminution in property value due to losing the panoramic view and the vicinity of the transmission lines.

Health risks are a concern due to the proximity of the HV transmission lines around our home. My family will be constantly stressed about possible fire hazards, exposure to electric and magnetic fields, and physical safety. Though studies have not clearly shown whether exposure to EMF increase health risk, scientist continue to conduct research on the issue according to the US EPA. The EPA also states that if you are concern about exposure to EMFs, you can increase the distance between you and the source. This helps us lower our exposure. Avoiding exposure to EMFs will be difficult when surrounded on three sides less than 200 ft by transmission lines.

<https://www.epa.gov/radtown/electric-and-magnetic-fields-power-lines#what-you-can-do>

CPS Energy's decision to include transmission line 46 as a proposed route in eight of the primary route alternatives is unfathomable, especially when it surrounds a home 200 ft away outside the property line on three sides. According to the on-line map of the transmission line segments and substations, lines 40 and 49 encounter the least habitable structures along their routes. The latter runs through an open field which connects to the donated land. We are strong proponents of lines 40 or 49.

One of the factors that we considered when buying our home six years ago was whether we could spend the rest of lives living here. The answer was a definite yes, especially for my wife. This is our dream home. We hope the Texas Public Utility Commission and CPS Energy consider the negative factors such as property values, health, and safety of the

landowners along transmission line 46 when selecting a transmission line route and substation.

If further information is needed, please feel free to contact me at 830-755-6122 or 512-771-0326. My email address if needed is rf\_0707@hotmail.com.

Best Regards,

Raul Figueroa

COUNTY

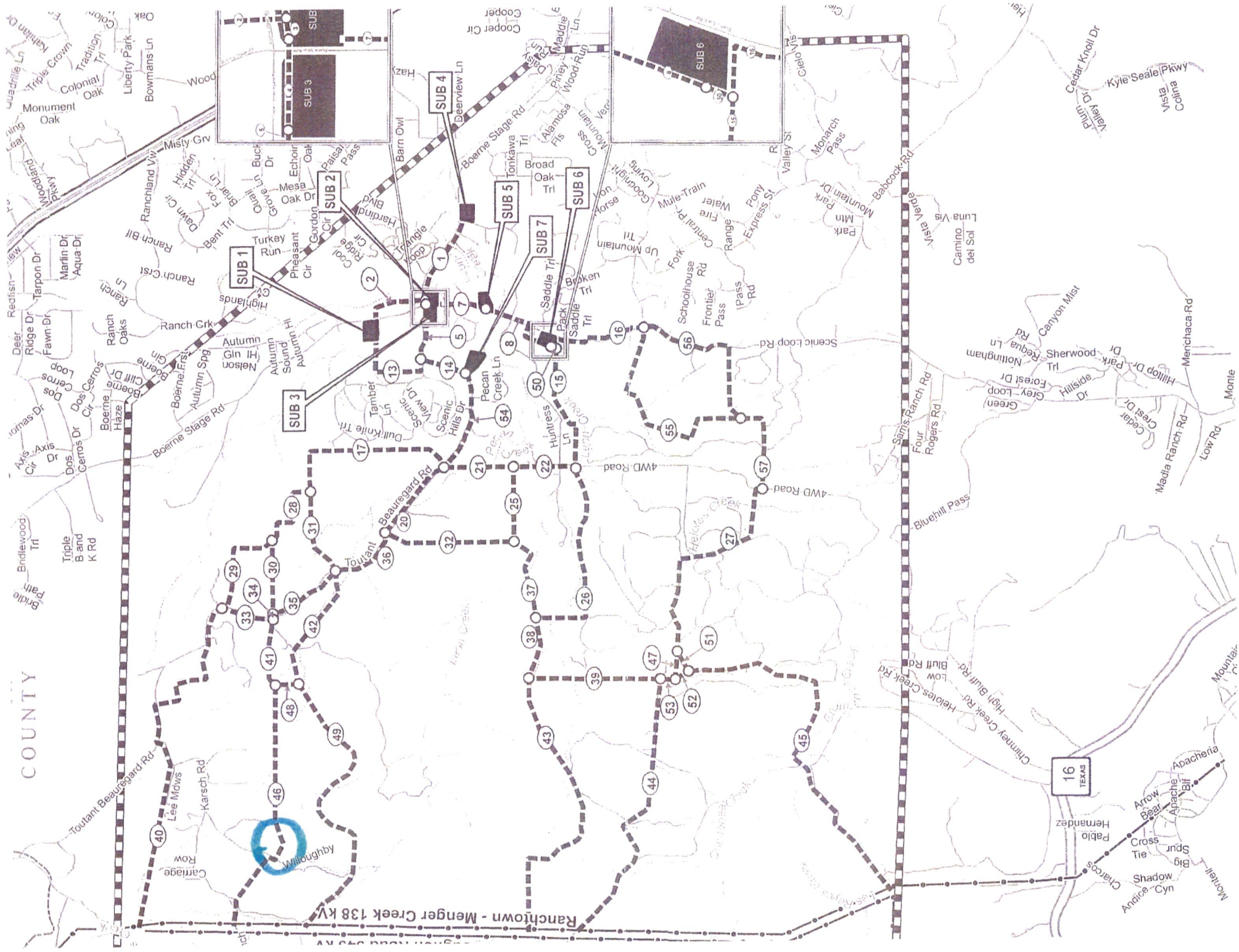

## Cascade Caverns – EXPLORE magazine

[hillcountryexplore.com/tag/cascade-caverns](http://hillcountryexplore.com/tag/cascade-caverns)

**Crow-Karsch Ranch** Hill Country scenic views is something Boerne is known for. Did you know you could be so close to Boerne and still see all the way to the Tower of the Americas? **Crow-Karsch Ranch** is the little known place where you can do this. ... **EXPLORE magazine** 930 E Blanco, Ste 200 Boerne, TX 78006 210-507-5250 [info@smvtexas.com](mailto:info@smvtexas.com).



