

Control Number: 50585



Item Number: 17

Addendum StartPage: 0



July 1, 2020

**VIA ELECTRONIC SUBMISSION WITH PUC INTERCHANGE**

Public Utility Commission  
PO Box 13326  
Austin, TX 78711-3326

**RE: Docket # 50585; Commission Staff's First Request for Information to the City of Lockhart Question Nos. Staff 1-1 Through Staff 1-2**

**Staff 1-1 Please provide a list of the infrastructure projects necessary, and the related cost required to transfer and provide continuous and adequate service to the requested area.**

The details of the overall infrastructure projects necessary to transfer water service from Polonia WSC to the City of Lockhart can be found in Exhibit A. The City of Lockhart water distribution staff plans on making one connection to Polonia's existing 6" water main on the northwest corner of SH130 and FM 2001. This connection will be to the City's existing 18" water main that runs parallel to Polonia's 6" water main and is approximately 15' away from the City's main (Shown in Exhibit B). The materials that will be purchased for this connection include an 18" x 12" tapping saddle, 12" gate valve, 12" x 6" reducer and various 6" water fitting to make the connection to Polonia's water line. Simultaneously another City of Lockhart water distribution crew will be removing a section of water main from the City of Lockhart/Polonia WSC border of the new service areas. This water main is only a 3" at this location. The City plans on reducing each end of these sections of Polonia's and the City's new dead-end water mains to 2" pipe and installing two 2" blow-offs for flushing and bacteriological testing purposes (Shown in Exhibit C). The total cost for making these connections and disconnections will cost approximately \$5,809.02 (Shown in Exhibit D). The water distribution crews will prepare all job sites before these connections and disconnections take place to minimize the disruption in service to these 25 customers. Polonia WSC has given the City permission to keep the existing water meters since they are the same brand and size that the City currently uses. Once the transfer is complete the City will inspect each meter for efficiency, replacing meters as needed.

**Staff 1-2 Please provide a list and description of the sources of funding and evidence of those sources for all facilities that will be constructed to transfer and serve the requested area.**

The cost for making this transfer is relatively minimal, costing only approximately \$5,809.02. The City of Lockhart will absorb these project cost in the water distribution budget for FY19-20. The current state of the budget is

shown in Exhibit E. The water distribution budget is currently operating under projected expenditures, there will not be an issue making these projects fit into our normal annual operating budget.

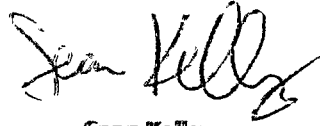

Sean Kelley

Public Works Director (Authorized Utility Representative)  
City of Lockhart

CC: Monte Alkers, City Attorney  
Steven Lewis, City Manager

Via Email  
Via Email





# CITY OF LOCKHART EXHIBIT A



PROPOSED LOCATION OF  
DISCONNECTION OF WATER  
SYSTEM BETWEEN POLONIA AND COL

PROPOSED LOCATION OF WATER  
SYSTEM CONNECTION OF ACQUIRED  
POLONIA WATER LINES

**Map Legend**

-  POLONIA WATERLINES
-  COL WATERLINES
-  PARCELS
-  LOCKHART CITY LIMITS

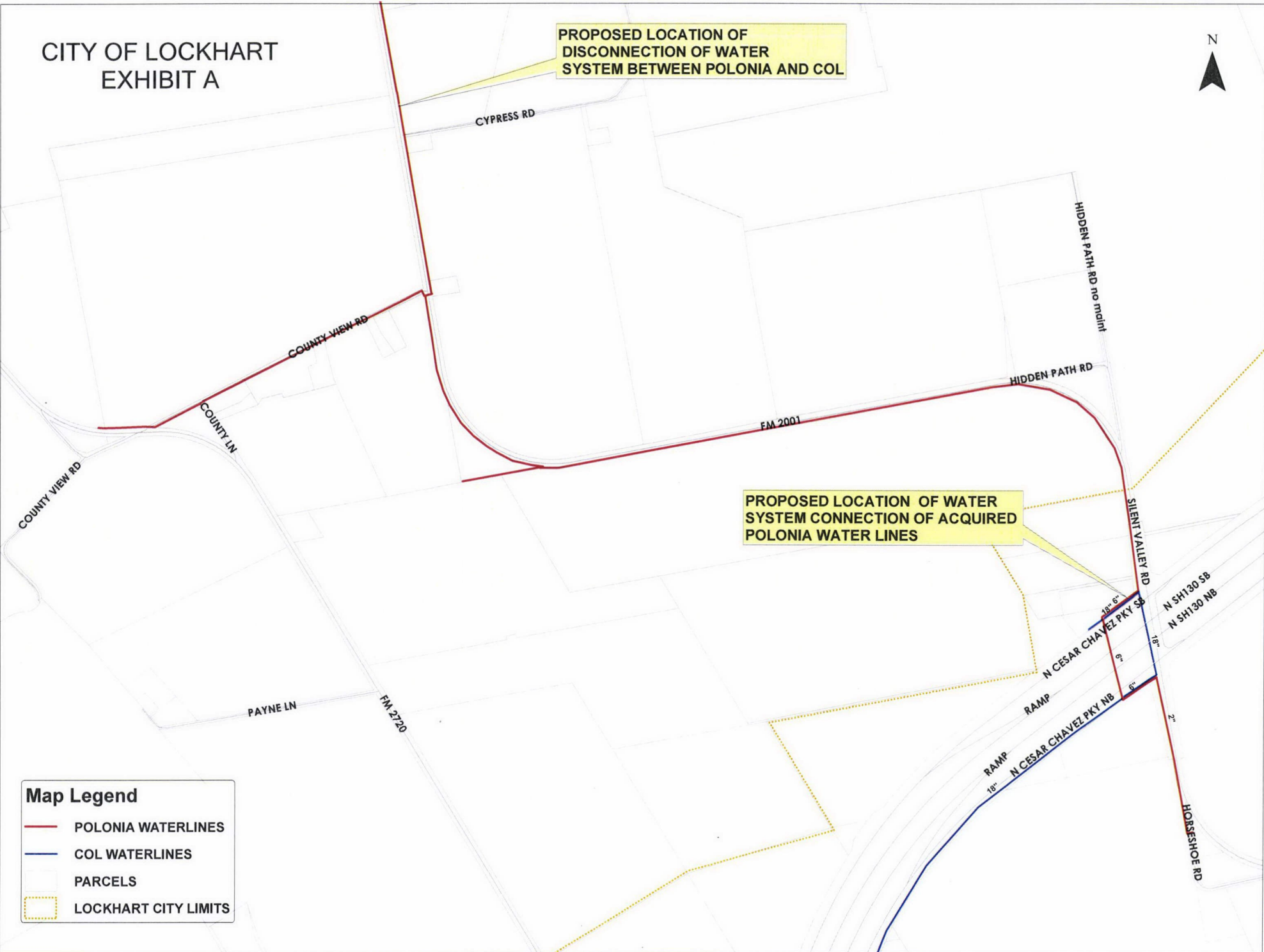

CITY OF LOCKHART  
EXHIBIT B



PROPOSED CONNECTION  
OF COL AND POLONIA

N CESAR CHAVEZ PKY SB

TURN AROUND

N SH130 SB

N SH130 NB

SILENT VALLEY RD

N CESAR CHAVEZ PKY NB

**Map Legend**

- CONNECTION\_POLONIA
- POLONIA WATERLINES
- COL WATERLINES
- PARCELS
- LOCKHART CITY LIMITS

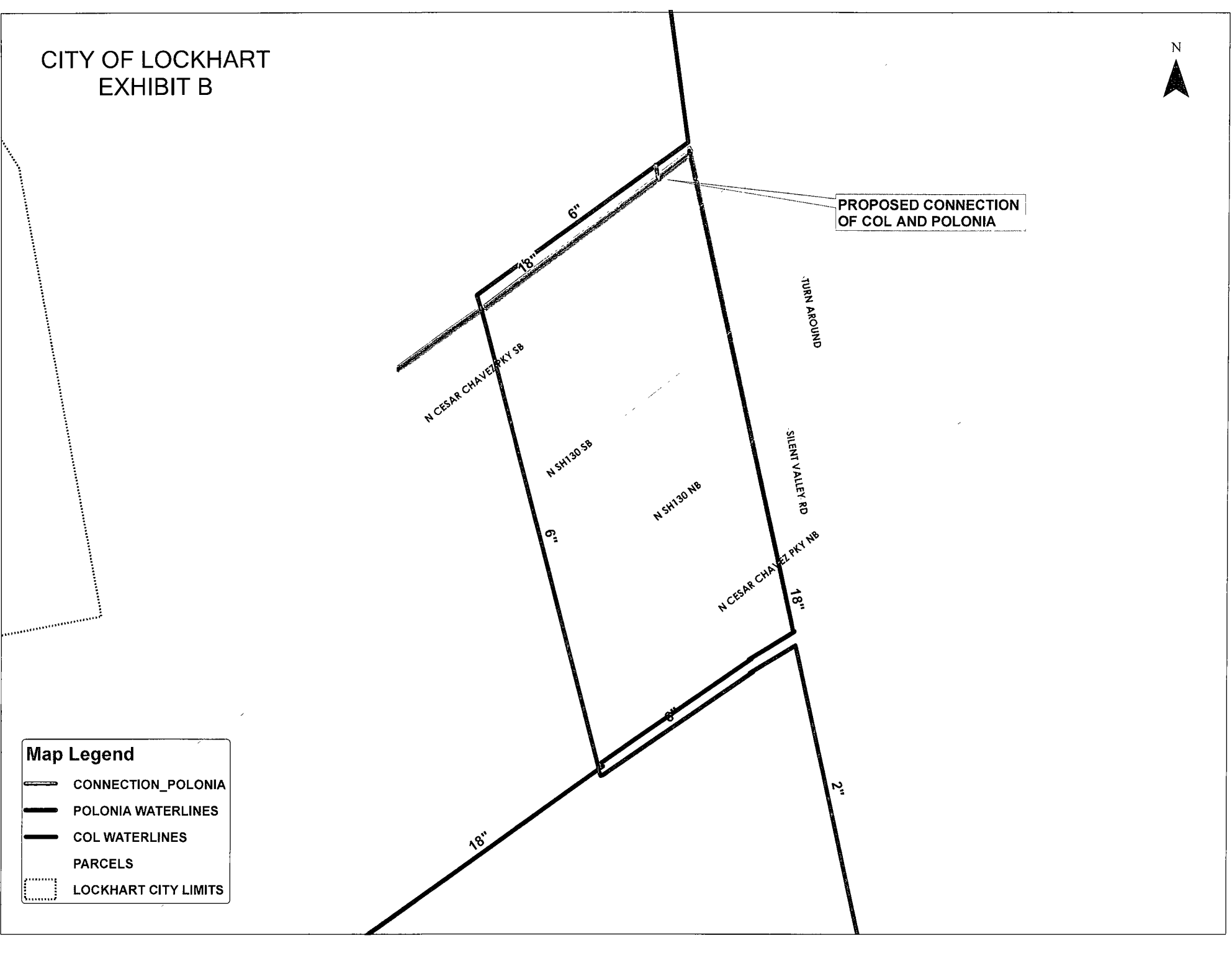

CITY OF LOCKHART  
EXHIBIT C







PROPOSED LOCATION OF  
DISCONNECTION OF WATER  
SYSTEM BETWEEN POLONIA AND COL

FM 2001

CYPRESS RD

**Map Legend**

-  TO REMAIN POLONIA WATERLINES
-  DISCONNECTION OF POLONIA
-  PROPOSED COL WATERLINES
-  PARCELS
-  LOCKHART CITY LIMITS

## Docket # 50585 Request for Information Exhibit D

Items	Quantity	Estimated Cost (\$)	
		Unit Price	EXT Price
18" x 12" Tapping Saddle	1	\$1,544.97	\$1,544.97
12" Tapping Valve	1	\$2,530.02	\$2,530.02
Valve Box w/ Lid	1	\$45.00	\$45.00
12" x 6" Mechanical Joint Reducer	1	\$78.49	\$78.49
3" x 2" Reducer	1	\$36.72	\$36.72
3" x 2" Reduced, Threaded	1	\$25.60	\$25.60
3" Mechanical Joint Cap	1	\$12.13	\$12.13
6" Mechanical Joint Restraint	10	\$37.85	\$378.50
12" Mechanical Joint Restraint	1	\$93.32	\$93.32
6" Mechanical Joint Sleeve	1	\$49.52	\$49.52
3" Mechanical Joint Restraint	3	\$26.89	\$80.67
2" Mechanical Joint Restraint	1	\$34.08	\$34.08
12" Wet Tap by Texas Taps	1	\$900.00	\$900.00
		<b>TOTAL</b>	<b>\$5,809.02</b>



Bid Proposal for Lockhart - 18x12 Tap

CITY OF LOCKHART  
 Bid Date: 06/26/2020  
 Core & Main 1383924

Core & Main  
 1301 West Wells Branch Pkwy  
 Pflugerville, TX 78660  
 Phone: 512-990-8470  
 Fax: 512-990-0069

Seq#	Qty	Description	Units	Price	Ext Price
20	1	662-195012-000 18X12 SS TAP SL	EA	1,544.97	1,544.97
30	1	12 T2361-19 MJ RW TAP VLV OL	EA	2,530.02	2,530.02
40	1	562-S VLV BOX W/LID M/WATER	EA	45.00	45.00
50	1	12X6 MJ RED C153 IMP	EA	78.49	78.49
60	1	3X2 MJ RED C153 IMP	EA	36.72	36.72
70	1	3X2 MJ TAPT CAP C153 IMP	EA	25.60	25.60
80	1	3 MJ CAP C153 IMP	EA	12.13	12.13
90	10	6 PVC 4006P STARGRIP RESTRAINT W/ACC C900-PVCPK4006	EA	37.85	378.50
100	1	12 PVC 4012P STARGRIP RESTRNT W/ACC C900-PVCPK4012	EA	93.32	93.32
110	1	6 MJ L/P SLV C153 IMP	EA	49.52	49.52
120	3	3 PVC 4003P STARGRIP RESTRAINT W/ACC	EA	26.89	80.67
130	1	2" MIDCO IPS RESTRAINT PACK	EA	34.08	34.08
				<b>Sub Total</b>	<b>4,909.02</b>
				<b>Tax</b>	<b>0.00</b>
				<b>Total</b>	<b>4,909.02</b>

Branch Terms:

UNLESS OTHERWISE SPECIFIED HEREIN, PRICES QUOTED ARE VALID IF ACCEPTED BY CUSTOMER AND PRODUCTS ARE RELEASED BY CUSTOMER FOR MANUFACTURE WITHIN THIRTY (30) CALENDAR DAYS FROM THE DATE OF THIS QUOTATION. CORE & MAIN LP RESERVES THE RIGHT TO INCREASE PRICES UPON THIRTY (30) CALENDAR DAYS' NOTICE TO ADDRESS FACTORS, INCLUDING BUT NOT LIMITED TO, GOVERNMENT REGULATIONS, TARIFFS, TRANSPORTATION, FUEL AND RAW MATERIAL COSTS. DELIVERY WILL COMMENCE BASED UPON MANUFACTURER LEAD TIMES. ANY MATERIAL DELIVERIES DELAYED BEYOND MANUFACTURER LEAD TIMES MAY BE SUBJECT TO PRICE INCREASES AND/OR APPLICABLE STORAGE FEES. THIS BID PROPOSAL IS CONTINGENT UPON BUYER'S ACCEPTANCE OF SELLER'S TERMS AND CONDITIONS OF SALE, AS MODIFIED FROM TIME TO TIME, WHICH CAN BE FOUND AT: <https://coreandmain.com/terms/>



Exhibit D

Sean Kelley

---

**From:** Jason Turnini  
**Sent:** Friday, June 19, 2020 4:31 PM  
**To:** Sean Kelley  
**Subject:** Quotation from Texas tap

Sean  
Here is the price for the tap

**From:** Ginnefer Valenzuela <ginnefer22@yahoo.com>  
**Sent:** Friday, June 19, 2020 4:24 PM  
**To:** Jason Turnini <jturnini@lockhart-tx.org>  
**Subject:** Re: New message - texastapservice.com

\$900

On Friday, June 19, 2020, 04:22:16 PM CDT, Texas Tap Service, Inc. <[donotreply@godaddy.com](mailto:donotreply@godaddy.com)> wrote:

Reply to Email to Respond

**Name:**  
Jason Turnini

**Email:**  
[jturnini@lockhart-tx.org](mailto:jturnini@lockhart-tx.org)

**Message:**  
For the City of Lockhart  
Need a QUOTATION ONLY!!!  
12" Tap on a 18" C900 pvc line  
Thank you

**Locale:**  
en-US

---

***This message was submitted from your website contact form:***  
<http://texastapservice.com>

3780442223

CITY OF LOCKHART  
EXPENDITURES REPORT (UNAUDITED)  
AS OF: JUNE 30TH, 2020

520-WATER UTILITY  
FINANCIAL SUMMARY

	CURRENT BUDGET	CURRENT PERIOD	YEAR TO DATE ACTUAL	TOTAL ENCUMBERED	BUDGET BALANCE	% YTD BUDGET
<u>EXPENDITURE SUMMARY</u>						
<u>PUBLIC SAFETY</u>						
TOTAL PUBLIC SAFETY	0	0.00	0.00	0.00	0.00	0.00
<u>PUBLIC UTILITY</u>						
WATER DISTRIBUTION	1,831,832	125,493.30	1,282,964.81	21,101.16	527,766.03	71.19
WATER TREATMENT	1,014,710	101,814.28	743,777.12	0.00	270,932.61	73.30
NON DEPARTMENTAL	1,225,822	37,336.00	592,787.89	0.00	633,034.11	48.36
TOTAL PUBLIC UTILITY	4,072,364	264,643.58	2,619,529.82	21,101.16	1,431,732.75	64.84
TOTAL EXPENDITURES	4,072,364	264,643.58	2,619,529.82	21,101.16	1,431,732.75	64.84
TOTAL PUBLIC SAFETY	0	0.00	0.00	0.00	0.00	0.00