



Control Number: 50543



Item Number: 1

Addendum StartPage: 0



Application to Obtain or Amend a Water or Sewer Certificate of Convenience and Necessity (CCN)

Pursuant to 16 Texas Administrative Code (TAC) Chapter 24, Substantive Rules Applicable to Water and Sewer Service Providers, Subchapter G: Certificates of Convenience and Necessity

CCN Application Instructions

- I. **COMPLETE:** In order for the Commission to find the application sufficient for filing, you should be adhere to the following:
 - i. Answer every question and submit all required attachments.
 - ii. Use attachments or additional pages if needed to answer any question. If you use attachments or additional pages, reference their inclusion in the form.
 - iii. Provide all mapping information as detailed in Part F: Mapping & Affidavits.
 - iv. Provide any other necessary approvals from the Texas Commission on Environmental Quality (TCEQ), or evidence that a request for approval is being sought at the time of filing with the Commission.
- II. **FILE:** Seven (7) copies of the completed application with numbered attachments. One copy should be filed with no permanent binding, staples, tabs, or separators; and 7 copies of the portable electronic storage medium containing the digital mapping data.
SEND TO: Public Utility Commission of Texas, Attention: Filing Clerk, 1701 N. Congress Avenue, P.O. Box 13326, Austin, Texas 78711-3326 (NOTE: Electronic documents may be sent in advance of the paper copy; however, they will not be processed and added to the Commission's on-line Interchange until the paper copy is received and file-stamped in Central Records).
- III. The application will be assigned a docket number, and an administrative law judge (ALJ) will issue an order requiring Commission Staff to file a recommendation on whether the application is sufficient. The ALJ will issue an order after Staff's recommendation has been filed:
 - i. **DEFICIENT (Administratively Incomplete):** Applicant will be ordered to provide information to cure the deficiencies by a certain date (usually 30 days from ALJ's order). **Application is not accepted for filing.**
 - ii. **SUFFICIENT (Administratively Complete):** Applicant will be ordered by the ALJ to give appropriate notice of the application using the notice prepared by Commission Staff. **Application is accepted for filing.**
- IV. Once the Applicant issues notice, a copy of the actual notice sent (including any map) and an affidavit attesting to notice should be filed in the docket assigned to the application. Recipients of notice may choose to take one of the following actions:
 - i. **HEARING ON THE MERITS:** an affected party may request a hearing on the application. The request must be made within 30 days of notice. If this occurs, the application may be referred to the State Office of Administrative Hearings (SOAH) to complete this request.
 - ii. **LANDOWNER OPT-OUT:** A landowner owning a qualifying tract of land (25+ acres) may request to have their land removed from the requested area. The Applicant will be requested to amend its application and file new mapping information to remove the landowner's tract of land, in conformity with this request.
- V. **PROCEDURAL SCHEDULE:** Following the issuance of notice and the filing of proof of notice in step 4, the application will be granted a procedural schedule for final processing. During this time the Applicant must respond to hearing requests, landowner opt-out requests, and requests for information (RFI). The Applicant will be requested to provide written consent to the proposed maps, certificates, and tariff (if applicable) once all other requests have been resolved.
- VI. **FINAL RECOMMENDATION:** After receiving all required documents from the Applicant, Staff will file a recommendation on the CCN request. The ALJ will issue a final order after Staff's recommendation is filed.

FAQ:

Who can use this form?

Any retail public utility that provides or intends to provide retail water or wastewater utility service in Texas.

Who is required to use this form?

A retail public utility that is an investor owned utility (IOU) or a water supply corporation (WSC) must use this form to obtain or amend a CCN prior to providing retail water or sewer utility service in the requested area.

What is the purpose of the application?

A CCN Applicant is required to demonstrate financial, managerial, and technical (FMT) capability to provide continuous and adequate service to any requested area. The questions in the application are structured to support an Applicant's FMT capabilities, consistent with the regulatory requirements.

Application Summary

Applicant: SP Utility Company, Inc.

CCN No. to be amended: 12978

or

☐

Obtain NEW CCN

☒

Water

☐

Sewer

County(ies) affected by this application: Montgomery

Dual CCN requested with: Drew T. Spencer dba Cypresswood Estates Water System

CCN No.: 12498

(name of retail public utility)

☐

Portion or

☒

All of requested area

Decertification of CCN for:

CCN No.: _____

(name of retail public utility)

☐

Portion or

☐

All of requested area

Table of Contents

CCN Application Instructions	1
Part A: Applicant Information	3
Part B: Requested Area Information	4
Part C: CCN Obtain or Amend Criteria Considerations	6
Part D: TCEQ Public Water System or Sewer (Wastewater) Information	7
Part E: Financial Information	9
Part F: Mapping & Affidavits	10
Part G: Notice Information	11
Appendix A: Historical Financial Information (Balance Sheet and Income Schedule)	13
Appendix B: Projected Information	16

Please mark the items included in this filing

<input type="checkbox"/>	Partnership Agreement	Part A: Question 4
<input type="checkbox"/>	Articles of Incorporation and By-Laws (WSC)	Part A: Question 4
<input checked="" type="checkbox"/>	Certificate of Account Status	Part A: Question 4
<input type="checkbox"/>	Franchise, Permit, or Consent letter	Part B: Question 7
<input type="checkbox"/>	Existing Infrastructure Map	Part B: Question 8
<input type="checkbox"/>	Customer Requests For Service in requested area	Part B: Question 9
<input type="checkbox"/>	Population Growth Report or Market Study	Part B: Question 10
<input type="checkbox"/>	TCEQ Engineering Approvals	Part B: Question 11
<input type="checkbox"/>	Requests & Responses For Service to ½ mile utility providers	Part B: Question 12.B
<input type="checkbox"/>	Economic Feasibility (alternative provider) Statement	Part B: Question 12.C
<input type="checkbox"/>	Alternative Provider Analysis	Part B: Question 12.D
<input type="checkbox"/>	Enforcement Action Correspondence	Part C: Question 16
<input type="checkbox"/>	TCEQ Compliance Correspondence	Part D: Question 20
<input type="checkbox"/>	Purchased Water Supply or Treatment Agreement	Part D: Question 23
<input type="checkbox"/>	Rate Study (new market entrant)	Part E: Question 28
<input checked="" type="checkbox"/>	Tariff/Rate Schedule	Part E: Question 29
<input checked="" type="checkbox"/>	Financial Audit	Part E: Question 30
<input type="checkbox"/>	Application Attachment A & B	Part E: Question 30
<input type="checkbox"/>	Capital Improvement Plan	Part E: Question 30
<input type="checkbox"/>	Disclosure of Affiliated Interests	Part E: Question 31
<input checked="" type="checkbox"/>	Detailed (large scale) Map	Part F: Question 32
<input checked="" type="checkbox"/>	General Location (small scale) Map	Part F: Question 32
<input checked="" type="checkbox"/>	Digital Mapping Data	Part F: Question 32
<input checked="" type="checkbox"/>	Signed & Notarized Affidavit	Page 12

Part A: Applicant Information

1. A. Name: SP Utility Company, Inc.

(individual, corporation, or other legal entity)

☐

Individual

☒

Corporation

☐

WSC

☐

Other: _____

B. Mailing Address: P.O. Box 690521, Houston, TX 77269

Phone No.: (832) 534-8545

Email: harrison.ftu@gmail.com

C. Contact Person. Please provide information about the person to be contacted regarding this application. Indicate if this person is the owner, operator, engineer, attorney, accountant, or other title.

Name: Helen S. Gilbert

Title: Attorney

Mailing Address: 7000 N. MoPac Expressway, Suite 200 Austin, TX 78731

Phone No.: (512) 494-5341

Email: hgilbert@gwtxlaw.com

2. If the Applicant is someone other than a municipality, is the Applicant currently paid in full on the Regulatory Assessment Fees (RAF) remitted to the TCEQ?

☒

Yes

☐

No

☐

N/A

3. If the Applicant is an Investor Owned Utility (IOU), is the Applicant current on Annual Report filings with the Commission?

☒

Yes

☐

No

If no, please state the last date an Annual Report was filed: _____

4. The legal status of the Applicant is:

☐

Individual or sole proprietorship

☐

Partnership or limited partnership (*attach* Partnership agreement)

☒

Corporation:

Charter number (recorded with the Texas Secretary of State): 0800200690

☐

Non-profit, member-owned, member controlled Cooperative Corporation [Article 1434(a) Water Supply or Sewer Service Corporation, incorporated under TWC Chapter 67]

Charter number (as recorded with the Texas Secretary of State): _____

☐

Articles of Incorporation and By-Laws established (*attach*)

☐

Municipally-owned utility

☐

District (MUD, SUD, WCID, FWSD, PUD, etc.)

☐

County

☐

Affected County (a county to which Subchapter B, Chapter 232, Local Government Code, applies)

☐

Other (please explain): _____

5. If the Applicant operates under an assumed name (i.e., any d/b/a), provide the name below:

Name: _____

Part B: Requested Area Information

6. Provide details on the existing or expected land use in the requested area, including details on requested actions such as dual certification or decertification of service area.

The existing system is under a the PUC appointed temporary manager due to the system being badly managed and operated by the current owner of the facilities. The applicant is asking that the entire requested service area be dually certificated with current CCN holder. The existing CCN holder, Drew T. Spencer, is deceased.

7. The requested area (check all applicable):

- ☐ Currently receives service from the Applicant ☐ Is being developed with no current customers
☐ Overlaps or is within municipal boundaries ☐ Overlaps or is within district boundaries

Municipality: _____ District: _____

Provide a copy of any franchise, permit, or consent granted by the city or district. If not available please explain:

N/A

8. Describe the circumstances (economic, environmental, etc.) driving the need for service in the requested area:

The existing system is under a PUC appointed temporary. The applicant will provide quality service and bring system up to PUC and TCEQ minimum standards.

9. Has the Applicant received any requests for service within the requested area?

☐ Yes* ☒ No *Attach copies of all applicable requests for service and show locations on a map

10. Is there existing or anticipated growth in the requested area?

☐ Yes* ☒ No *Attach copies of any reports and market studies supporting growth

11. A. Will construction of any facilities be necessary to provide service to the requested area?

☐ Yes* ☒ No *Attach copies of TCEQ approval letters

B. Date Plans & Specifications or Discharge Permit App. submitted to TCEQ: _____

C. Summarize an estimated timeline for construction for any required facilities to serve the requested area:

Customers meters will need to be installed at all service connections.

D. Describe the source and availability of funds for any required facilities to serve the requested area:

The applicant will use its currently available funds to install customer meters.

Note: Failure to provide applicable TCEQ construction or permit approvals, or evidence showing that the construction or permit approval has been filed with the TCEQ may result in the delay or possible dismissal of the application.

12. A. If construction of a physically separate water or sewer system is necessary, provide a list of all retail public water and/or sewer utilities within one half mile from the outer boundary of the requested area below:

N/A

B. Did the Applicant request service from each of the above water or sewer utilities?

☐ Yes*

☒ No

*Attach copies of written requests and copies of the written response

C. Attach a statement or provide documentation explaining why it is not economically feasible to obtain retail service from the water or sewer retail public utilities listed above.

D. If a neighboring retail public utility agreed to provide service to the requested area, attach documentation addressing the following information:

(A) A description of the type of service that the neighboring retail public utility is willing to provide and comparison with service the applicant is proposing;

(B) An analysis of all necessary costs for constructing, operating, and maintaining the new facilities for at least the first five years of operations, including such items as taxes and insurance; and

(C) An analysis of all necessary costs for acquiring and continuing to receive service from the neighboring retail public utility for at least the first five years of operations.

13. Explain the effect of granting the CCN request on the Applicant, any retail public utility of the same kind serving in the proximate area, and any landowners in the requested area. The statement should address, but is not limited to, regionalization, compliance, and economic effects.

This transaction will be in the interest and welfare of the public as the utility will be able to provide continuous and adequate water service to the customers of the transferred system.

Part C: CCN Obtain or Amend Criteria Considerations

- 14.** Describe the anticipated impact and changes in the quality of retail utility service for the requested area:

The quality of utility service will improve as the applicant has committed to make improvements to the water system including installing customer meters.

- 15.** Describe the experience and qualifications of the Applicant in providing continuous and adequate retail service:

The applicant operates and maintains other water systems in the region. The applicant will maintain this system in compliance with the rules and regulations of the PUC and TCEQ, as well as federal and local laws, rules and regulations.

- 16.** Has the Applicant been under an enforcement action by the Commission, TCEQ, Texas Department of Health (TDH), the Office of the Attorney General (OAG), or the Environmental Protection Agency (EPA) in the past five (5) years for non-compliance with rules, orders, or state statutes?

☐ Yes* ☒ No

*Attach copies of any correspondence with the applicable regulatory agency concerning any enforcement actions, and attach a description of any actions or efforts the Applicant has taken to comply with these requirements.

- 17.** Explain how the environmental integrity of the land will or will not be impacted or disrupted as a result of granting the CCN as requested:

The service area affected by this transaction will continue to receive water service. This eliminates the need for land owners to use individual wells. Thus, protecting the environment in the area from potential sources of contamination and encouraging rationalization of water service.

- 18.** Has the Applicant made efforts to extend retail water or sewer utility service to any economically distressed area located within the requested area?

N/A

19. List all neighboring water or sewer retail public utilities, cities, districts (including ground water conservation districts), counties, or other political subdivisions (including river authorities) providing the same service located within two (2) miles from the outer boundary of the requested area:

(See Attached List of neighboring utilities within 2 miles)

Part D: TCEQ Public Water System or Sewer (Wastewater) Information

20. A. Complete the following for all Public Water Systems (PWS) associated with the Applicant's CCN:

TCEQ PWS ID:	Name of PWS:	Date of TCEQ inspection*:	Subdivisions served:
1700301	Cypresswood Estates	7/22/2015	Cypresswood Estates Subdivision

*Attach evidence of compliance with TCEQ for each PWS

- B. Complete the following for all TCEQ Water Quality (WQ) discharge permits associated with the Applicant's CCN:

TCEQ Discharge Permit No:	Date Permit expires:	Date of TCEQ inspection*:	Subdivisions served:
WQ-			
WQ-			
WQ-			
WQ-			

*Attach evidence of compliance with TCEQ for each Discharge Permit

- C. The requested CCN service area will be served via: PWS ID: 1700301
WQ -

21. List the number of existing connections for the PWS & Discharge Permit indicated above (Question 20. C.):

Water				Sewer	
	Non-metered	160	2"		Residential
	5/8" or 3/4"		3"		Commercial
	1"		4"		Industrial
	1 1/2"		Other		Other
Total Water Connections:		160		Total Sewer Connections:	0

22. List the number of additional connections projected for the requested CCN area:

Water				Sewer	
	Non-metered		2"		Residential
	5/8" or 3/4"		3"		Commercial
	1"		4"		Industrial
	1 1/2"		Other		Other
Total Water Connections:		0		Total Sewer Connections:	0

23. A. Will the system serving the requested area purchase water or sewer treatment capacity from another source?

☐ Yes* ☒ No *Attach a copy of purchase agreement or contract.

Capacity is purchased from:

Water: _____

Sewer: _____

- B. Are any of the Applicants PWS's required to purchase water to meet the TCEQ's minimum capacity requirements or TCEQ's drinking water standards?

☐ Yes ☒ No

- C. What is the amount of supply or treatment purchased, per the agreement or contract? What is the percent of overall demand supplied by purchased water or sewer treatment (if any)?

	Amount in Gallons	Percent of demand
Water:		0%
Sewer:		0%

24. Does the PWS or sewer treatment plant have adequate capacity to meet the current and projected demands in the requested area?

☒ Yes ☐ No

25. List the name, class, and TCEQ license number of the operators that will be responsible for the operations of the water or sewer utility service provided to the requested area:

Name (as it appears on license)	Class	License No.	Water/Sewer
James Harrison Williams	B	WG0014737	Water

26. A. Are any improvements required for the existing PWS or sewer treatment plant to meet TCEQ or Commission standards?

☐ Yes ☒ No

- B. Provide details on each required major capital improvement necessary to correct deficiencies to meet the TCEQ or Commission standards (attach any engineering reports or TCEQ approval letters):

Description of the Capital Improvement:	Estimated Completion Date:	Estimated Cost:

27. Provide a map (or maps) showing all facilities for production, transmission, and distribution, and the location of existing or proposed customer connections, in the requested area. Facilities should be identified on subdivision plats, engineering planning maps, or other large scale maps. Color coding can be used, and is encouraged, to distinguish types of facilities.

Part E: Financial Information

28. If the Applicant seeking to obtain a CCN for the first time is an Investor Owned Utility (IOU) and under the original rate jurisdiction of the Commission, a proposed tariff must be attached to the application. The proposed rates must be supported by a rate study, which provides all calculations and assumptions made. Once a CCN is granted, the Applicant must submit a rate filing package with the Commission within 18 months from the date service begins. The purpose of this rate filing package is to revise a utility's tariff to adjust the rates to a historic test year and to true up the new tariff rates to the historic test year. It is the Applicant's responsibility in any future rate proceeding to provide written evidence and support for the original cost and installation date of all facilities used and useful for providing utility service. Any dollar amount collected under the rates charged during the test year in excess of the revenue requirement established by the Commission during the rate change proceeding shall be reflected as customer contributed capital going forward as an offset to rate base for ratemaking purposes.

29. If the Applicant is an existing IOU, please attach a copy of the current tariff and indicate:

A. Effective date for most recent rates: 9/1/2010

B. Was notice of this increase provided to the Commission or a predecessor regulatory authority?

☐ No

☒ Yes

Application or Docket Number: 36990-R

C. If notice was not provided to the Commission, please explain why (ex: rates are under the jurisdiction of a municipality)

N/A

If the Applicant is a Water Supply or Sewer Service Corporation (WSC/SSC) and seeking to obtain a CCN, attach a copy of the current tariff.

30. **Financial Information**

Applicants must provide accounting information typically included within a balance sheet, income statement, and statement of cash flows. If the Applicant is an existing retail public utility, this must include historical financial information and projected financial information. However, projected financial information is only required if the Applicant proposes new service connections and new investment in plant, or if requested by Commission Staff. If the Applicant is a new market entrant and does not have its own historical balance sheet, income statement, and statement of cash flows information, then the Applicant should establish a five-year projection.

Historical Financial Information may be shown by providing any combination of the following that includes necessary information found in a balance sheet, income statement, and statement of cash flows:

1. Completed Appendix A;
2. Documentation that includes all of the information required in Appendix A in a concise format; or
3. Audited financial statements issued within 18 months of the application filing date. This may be provided electronically by providing a uniform resource locator (URL) or a link to a website portal.

Projected Financial Information may be shown by providing any of the following:

1. Completed Appendix B;
2. Documentation that includes all of the information required in Appendix B in a concise format;
3. A detailed budget or capital improvement plan, which indicates sources and uses of funds required, including improvements to the system being transferred; or
4. A recent budget and capital improvements plan that includes information needed for analysis of the operations test for the system being transferred and any operations combined with the system. This may be provided electronically by providing a uniform resource locator (URL) or a link to a website portal.

31. Attach a disclosure of any affiliated interest or affiliate. Include a description of the business relationship between all affiliated interests and the Applicant.

DO NOT INCLUDE ATTACHMENTS A OR B IF LEFT BLANK

Part F: Mapping & Affidavits

32. Provide the following mapping information with each of the seven (7) copies of the application:
1. A general location (small scale) map identifying the requested area in reference to the nearest county boundary, city, or town. The Applicant should adhere to the following guidance:
 - i. If the application includes an amendment for both water and sewer certificated service areas, separate maps must be provided for each.
 - ii. A hand drawn map, graphic, or diagram of the requested area is not considered an acceptable mapping document.
 - iii. To maintain the integrity of the scale and quality of the map, copies must be exact duplicates of the original map. Therefore, copies of maps cannot be reduced or enlarged from the original map, or in black and white if the original map is in color.
 2. A detailed (large scale) map identifying the requested area in reference to verifiable man-made or natural landmarks such as roads, rivers, and railroads. The Applicant should adhere to the following guidance:
 - i. The map should be clearly labeled and the outer boundary of the requested area should be marked in reference to the verifiable man-made or natural landmarks. These verifiable man-made and/or natural landmarks must be labeled and marked on the map as well.
 - ii. If the application includes an amendment for both water and sewer certificated service area, separate maps need to be provided for each.
 - iii. To maintain the integrity of the scale and quality of the map, copies must be exact duplicates of the original map. Therefore, copies of maps cannot be reduced or enlarged from the original map, or in black and white if the original map is in color.
 3. One of the following identifying the requested area:
 - i. A metes and bounds survey sealed or embossed by either a licensed state land surveyor or a registered professional land surveyor. Please refer to the mapping guidance in part 2 (above);

- ii. A recorded plat. If the plat does not provide sufficient detail, Staff may request additional mapping information. Please refer to the mapping guidance in part 2 (above); or
- iii. Digital mapping data in a shapefile (SHP) format georeferenced in either NAD 83 Texas State Plane Coordinate System (US Feet) or in NAD 83 Texas Statewide Mapping System (Meters). The digital mapping data shall include a single, continuous polygon record. The following guidance should be adhered to:
 - a. The digital mapping data must correspond to the same requested area as shown on the general location and detailed maps. The requested area must be clearly labeled as either the water or sewer requested area.
 - b. A shapefile should include six files (.dbf, .shp, .shx, .sbx, .sbn, and the projection (.prj) file).
 - c. The digital mapping data shall be filed on a data disk (CD or USB drives), clearly labeled, and filed with Central Records. Seven (7) copies of the digital mapping data is also required.

Part G: Notice Information

The following information will be used to generate the proposed notice for the application.
DO NOT provide notice until the application is deemed sufficient for filing and the Applicant is ordered to provide notice.

33. Complete the following using verifiable man-made and/or natural landmarks such as roads, rivers, or railroads to describe the requested area (to be stated in the notice documents). Measurements should be approximated from the outermost boundary of the requested area:

The total acreage of the requested area is approximately: _____

Number of customer connections in the requested area: _____

The closest city or town: _____

Approximate mileage to closest city or town center: _____

Direction to closest city or town: _____

The requested area is generally bounded on the North by: _____

on the East by: _____

on the South by: _____

on the West by: _____

See Attached Description of
Requested Service Areas

34. A copy of the proposed map will be available at P.O. Box 690521, Houston, TX 77269

Applicant's Oath

STATE OF TEXAS

COUNTY OF HARRIS

I, JAMES HARRISON WILLIAMS being duly sworn, file this application to
obtain or amend a water or sewer CCN, as OWNER

(owner, member of partnership, title as officer of corporation, or authorized representative)

I attest that, in such capacity, I am qualified and authorized to file and verify such application, am personally familiar with the documents filed with this application, and have complied with all the requirements contained in the application; and, that all such statements made and matters set forth therein with respect to Applicant are true and correct. Statements about other parties are made on information and belief. I further state that the application is made in good faith and that this application does not duplicate any filing presently before the Commission.

I further represent that the application form has not been changed, altered, or amended from its original form.

I further represent that the Applicant will provide continuous and adequate service to all customers and qualified applicants within its certificated service area should its request to obtain or amend its CCN be granted.

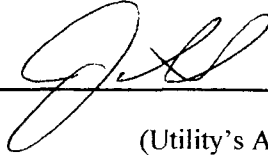

AFFIANT

(Utility's Authorized Representative)

If the Affiant to this form is any person other than the sole owner, partner, officer of the Applicant, or its attorney, a properly verified Power of Attorney must be enclosed.

SUBSCRIBED AND SWORN BEFORE ME, a Notary Public in and for the State of Texas

this day the 10 of February, 20 20

SEAL

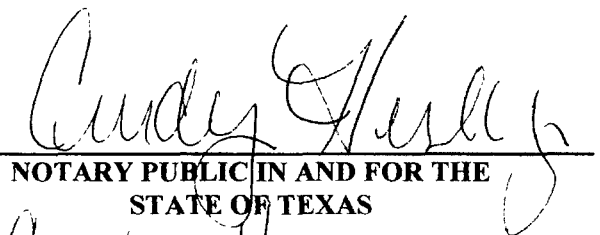
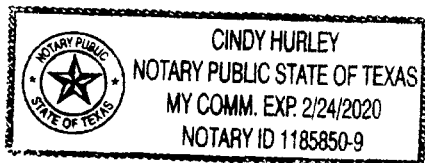

**NOTARY PUBLIC IN AND FOR THE
STATE OF TEXAS**

Cindy Hurley
PRINT OR TYPE NAME OF NOTARY

My commission expires:

2/24/2020

Certificate of Account Status



Franchise Tax Account Status

As of : 02/07/2020 12:42:25

This page is valid for most business transactions but is not sufficient for filings with the Secretary of State

SP UTILITY COMPANY, INC.

Texas Taxpayer Number 32011335893

Mailing Address 12111 SPRING CYPRESS RD STE C TOMBALL, TX 77377-8245

Right to Transact Business in Texas ACTIVE

State of Formation TX

Effective SOS Registration Date 05/06/2003

Texas SOS File Number 0800200690

Registered Agent Name JAMES H WILLIAMS

Registered Office Street Address 12111 SPRING CYPRESS, STE C TOMBALL, TX 77377

SP Utility Company, Inc. does not have any assumed names that this utility conducts business under.

SP Utility Company, Inc. is a corporation formed on May 6, 2003. Attached is a copy of the utility's account status.

SP Utility Company, Inc. does not have any parent company nor is any percentage of the utility owned by any other corporation.

Public Information Report

Public Information Report

SP UTILITY COMPANY, INC.

Report Year :2018

Information on this site is obtained from the most recent Public Information Report (PIR) processed by the Secretary of State (SOS). PIRs filed with annual franchise tax reports are forwarded to the SOS. After processing, the SOS sends the Comptroller an electronic copy of the information, which is displayed on this web site. The information will be updated as changes are received from the SOS.

You may order a copy of a Public Information Report from open.records@cpa.texas.gov or Comptroller of Public Accounts, Open Records Section, PO Box 13528, Austin, Texas 78711.

Title	Name and Address
DIRECTOR	JAMES H WILLIAMS P O BOX 690521 HOUSTON, TX 77269
RESIDENT	JAMES H WILLIAMS P O BOX 690521 HOUSTON, TX 77269
VICE PRESI	STEPHANIE L WILLIAMS P O BOX 690521 HOUSTON, TX 77269

Tariff / Rate Schedule

WATER UTILITY TARIFF FOR

SP Utility Company, Inc.
(Utility Name)

3 Greenway, Suite 2000
(Business Address)

Houston, Texas 77046-0307
(City, State, Zip Code)

713/651-0220
(Area Code/Telephone)

This tariff is effective for utility operations under the following Certificate of Convenience and Necessity:

12978

This tariff is effective in the following county:

Brazoria

This tariff is effective in the following cities or unincorporated towns (if any):

None

This tariff is effective in the following subdivisions and public water systems:

Savannah Plantation: PWS ID 0200599

TABLE OF CONTENTS

The above utility lists the following sections of its tariff (if additional pages are needed for a section, all pages should be numbered consecutively):

SECTION 1.0 -- RATE SCHEDULE	2
SECTION 2.0 -- SERVICE RULES AND POLICIES	4
SECTION 3.0 -- EXTENSION POLICY	11
SECTION 4.0 -- DROUGHT CONTINGENCY PLAN	16
APPENDIX A -- SAMPLE SERVICE AGREEMENT	
APPENDIX B -- APPLICATION FOR SERVICE	

SECTION 1.0 -- RATE SCHEDULE

Section 1.01 - Rates

<u>Meter Size</u>	<u>Monthly Minimum Charge</u>	<u>Gallorage Charge</u>
5/8" or 3/4"	<u>\$41.00</u> (Includes <u>1,000</u> gallons)	<u>\$6.00</u> per 1000 gallons, 1,001
1"	<u>\$64.50</u>	gallons to 10,000 gallons
1 1/2"	<u>\$89.50</u>	<u>\$8.00</u> per 1000 gallons,
2"	<u>\$145.00</u>	10,001 gallons to 13,000 gallons
3"	<u>\$265.00</u>	<u>\$10.00</u> per 1000 gallons, 13,001
		thereafter

FORM OF PAYMENT: The utility will accept the following forms of payment:

Cash X, Check X, Money Order X, Credit Card _____
 THE UTILITY MAY REQUIRE EXACT CHANGE FOR PAYMENTS AND MAY REFUSE TO ACCEPT
 PAYMENTS MADE USING MORE THAN \$1.00 IN SMALL COINS. A WRITTEN RECEIPT WILL BE
 GIVEN FOR CASH PAYMENTS.

REGULATORY ASSESSMENT 1.0%
 TCEQ RULES REQUIRE THE UTILITY TO COLLECT A FEE OF ONE PERCENT OF THE RETAIL
 MONTHLY BILL.

Section 1.02 - Miscellaneous Fees

TAP FEE \$800.00
 TAP FEE COVERS THE UTILITY'S COSTS FOR MATERIALS AND LABOR TO INSTALL A
 STANDARD RESIDENTIAL 5/8" or 3/4" METER. AN ADDITIONAL FEE TO COVER UNIQUE
 COSTS IS PERMITTED IF LISTED ON THIS TARIFF.

TAP FEE (Unique costs) Actual Cost
 FOR EXAMPLE, A ROAD BORE FOR CUSTOMERS OUTSIDE OF SUBDIVISIONS OR RESIDENTIAL
 AREAS.

TAP FEE (Large meter) Actual Cost
 TAP FEE IS THE UTILITY'S ACTUAL COST FOR MATERIALS AND LABOR FOR METER SIZE
 INSTALLED.

METER RELOCATION FEE Actual Relocation Cost, Not to Exceed Tap Fee
 THIS FEE MAY BE CHARGED IF A CUSTOMER REQUESTS THAT AN EXISTING METER BE
 RELOCATED.

RATES LISTED ARE EFFECTIVE ONLY
 IF THIS PAGE HAS TCEQ APPROVAL STAMP

SECTION 1.0 -- RATE SCHEDULE (Continued)

METER TEST FEE \$25.00

THIS FEE WHICH SHOULD REFLECT THE UTILITY'S COST MAY BE CHARGED IF A CUSTOMER REQUESTS A SECOND METER TEST WITHIN A TWO-YEAR PERIOD AND THE TEST INDICATES THAT THE METER IS RECORDING ACCURATELY. THE FEE MAY NOT EXCEED \$25.

RECONNECTION FEE

THE RECONNECT FEE MUST BE PAID BEFORE SERVICE CAN BE RESTORED TO A CUSTOMER WHO HAS BEEN DISCONNECTED FOR THE FOLLOWING REASONS (OR OTHER REASONS LISTED UNDER SECTION 2.0 OF THIS TARIFF):

- a) Nonpayment of bill (Maximum \$25.00) \$25.00
- b) Customer's request that service be disconnected..... \$25.00

TRANSFER FEE..... \$50.00

THE TRANSFER FEE WILL BE CHARGED FOR CHANGING AN ACCOUNT NAME AT THE SAME SERVICE LOCATION WHEN THE SERVICE IS NOT DISCONNECTED

LATE CHARGE (EITHER \$5.00 OR 10% OF THE BILL) 10%

TCEQ RULES ALLOW A ONE-TIME PENALTY TO BE CHARGED ON DELINQUENT BILLS. A LATE CHARGE MAY NOT BE APPLIED TO ANY BALANCE TO WHICH THE PENALTY WAS APPLIED IN A PREVIOUS BILLING.

RETURNED CHECK CHARGE \$30.00

RETURNED CHECK CHARGES MUST BE BASED ON THE UTILITY'S DOCUMENTABLE COST.

CUSTOMER DEPOSIT RESIDENTIAL (Maximum \$50) \$50.00

COMMERCIAL & NON-RESIDENTIAL DEPOSIT.....1/6TH OF ESTIMATED ANNUAL BILL

GOVERNMENTAL TESTING, INSPECTION AND COSTS SURCHARGE:

WHEN AUTHORIZED IN WRITING BY TCEQ AND AFTER NOTICE TO CUSTOMERS, THE UTILITY MAY INCREASE RATES TO RECOVER INCREASED COSTS FOR INSPECTION FEES AND WATER TESTING. [30 TAC 291.21(K)(2)]

LINE EXTENSION AND CONSTRUCTION CHARGES:

REFER TO SECTION 3.0--EXTENSION POLICY FOR TERMS, CONDITIONS, AND CHARGES WHEN NEW CONSTRUCTION IS NECESSARY TO PROVIDE SERVICE.

RATES LISTED ARE EFFECTIVE ONLY
IF THIS PAGE HAS TCEQ APPROVAL STAMP

Financial Information
(To Be Filed Confidentially)

List of Neighboring Utilities

Aqua Texas, Inc.
1106 Clayton LN Suite 400 W
Austin TX 78723-2476

Bauer Landing WCID
2929 Allen Pkwy. STE 3150
Houston, TX 7719-7100

Quadvest LP
PO Box 409
Tomball, TX 77377

H-M-W SUD
PO Box 837
Pinehurst, TX 77362

Clear Creek Forest MUD 1
Dormant - No Address

Clear Creek Forest MUD 2
Dormant - No Address

Coastal Water Authority
1801 Main Street #800
Houston, TX 77002

San Jacinto River Authority
PO Box 329
Conroe, TX 77305

Lone Star Groundwater
Conservation District
655 Conroe Park North Dr.
Conroe, TX 77303

Montgomery County Judge
501 North Thompson
Conroe, TX 77301

Gulf Coast Waste Disposal Authority
910 Bay Area Blvd.
Houston , TX 77058

Harris-Galveston Coastal Subsidence
District
1660 West Bay Area Blvd.
Friendswood, TX 77546-2640

Harris County FCD
9900 Northwest Fwy.
Houston, TX 77092-8619

North Harris County Regional
Water Authority
3648 Cypress Creek Parkway #110
Houston, TX 77068

Port of Houston Authority
111 East Loop North
Houston, TX 77029

Description of Requested Service Areas

30. Description of Requested Service Areas Affected by This Application:

Cypresswood Estates

The total acreage of the requested area is approx.: 160 acres

Number of customer connections in the requested area: 150

The closest city or town: Tomball

Approx. mileage to closest city or town center: 6 miles

Direction to closest city or town: West

The requested area is generally bounded on the North by: Abel Lane

on the East by: Spencer Blvd.

on the South by: Spring Creek

on the West by: Sanders Cemetery Road

FM 2854 Tract

The total acreage of the requested area is approx.: 93 acres

Number of customer connections in the requested area: Zero

The closest city or town: Conroe

Approx. mileage to closest city or town center: Less than 1.0 mile

Direction to closest city or town: East

The requested area is generally bounded on the North by: West Fork of San Jacinto River

on the East by: Steve Owens Road

on the South by: FM 2854

on the West by: Allen Drive

Maps

Requested Dual Certificated Water Service Area by SP Utility Company, Inc.

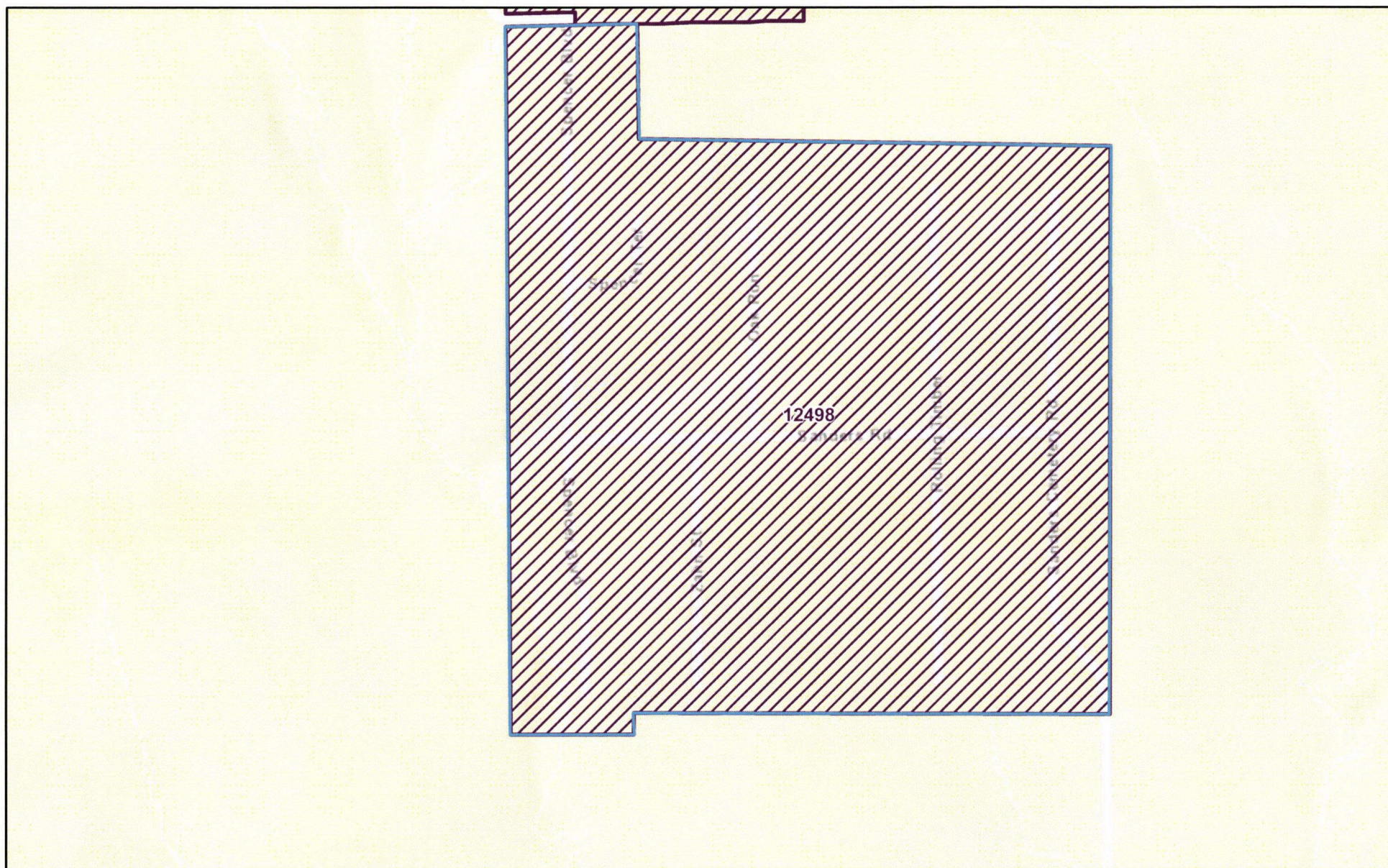

April 26, 2019

1:9,028

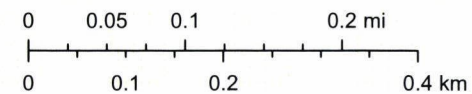

Sources: Esri, HERE, Garmin, USGS, Intermap, INCREMENT P, NRCan,

Requested Dual Certificated Water Service Area by SP Utility Company, Inc.

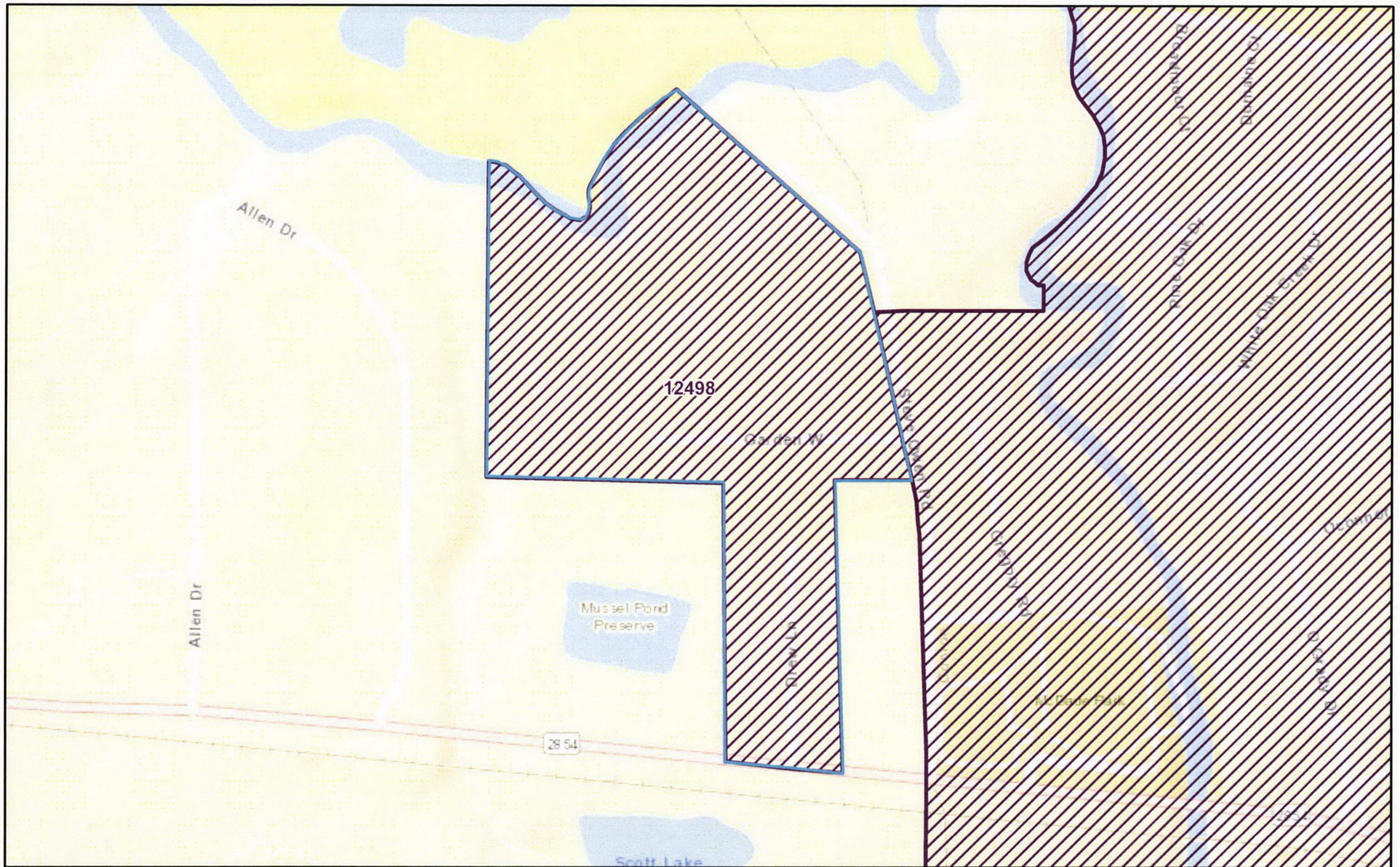

April 26, 2019

1:9,028

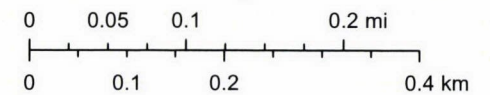

Sources: Esri, HERE, Garmin, USGS, Intermap, INCREMENT P, NRCan,

Requested Dual Certificated Water Service Area by SP Utility Company, Inc.

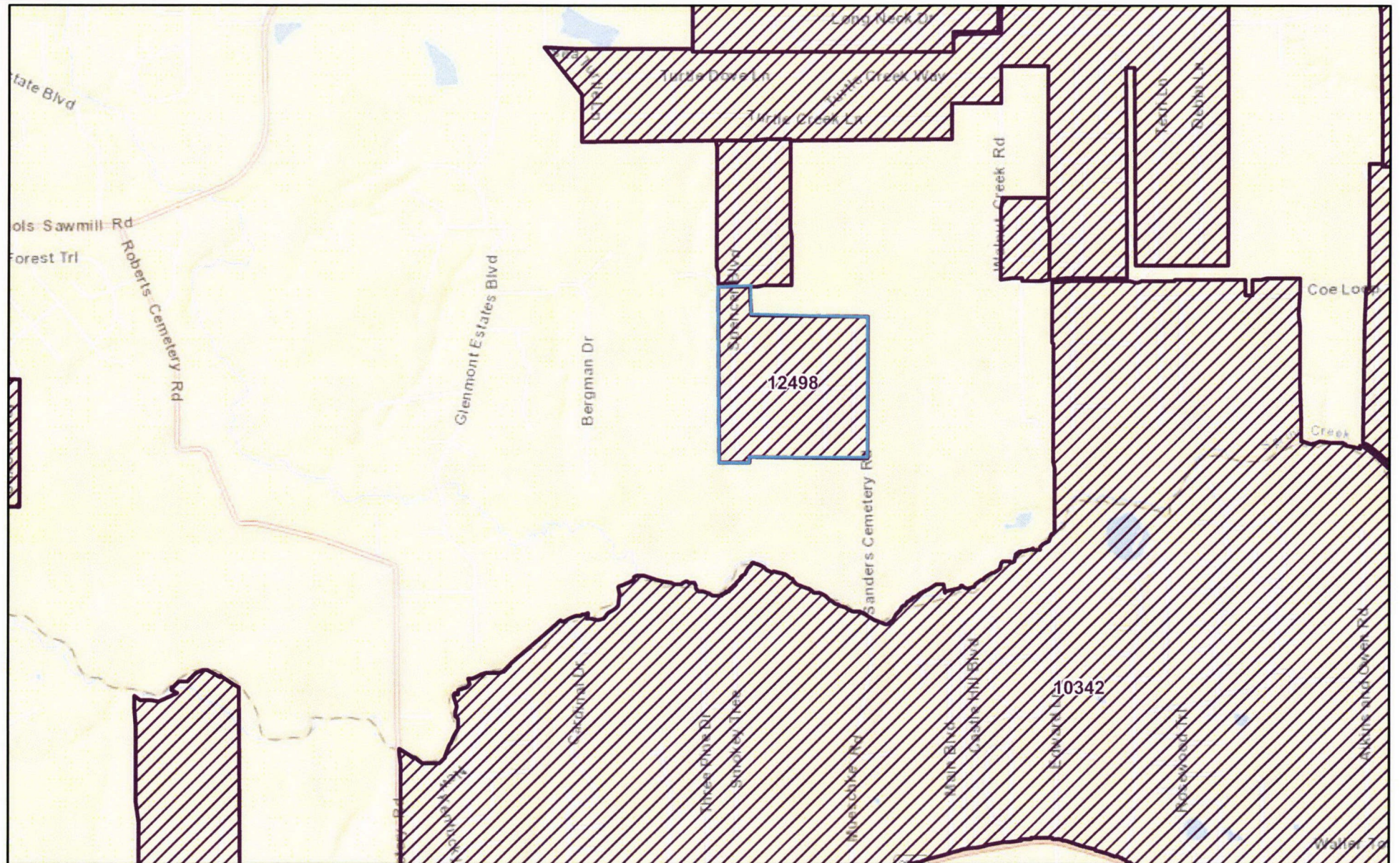

April 26, 2019

1:36,112

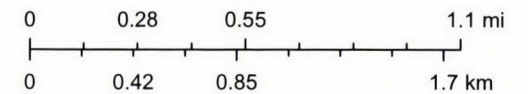

Sources: Esri, HERE, Garmin, USGS, Intermap, INCREMENT P, NRCan,

Requested Dual Certificated Water Service Area by SP Utility Company, Inc.

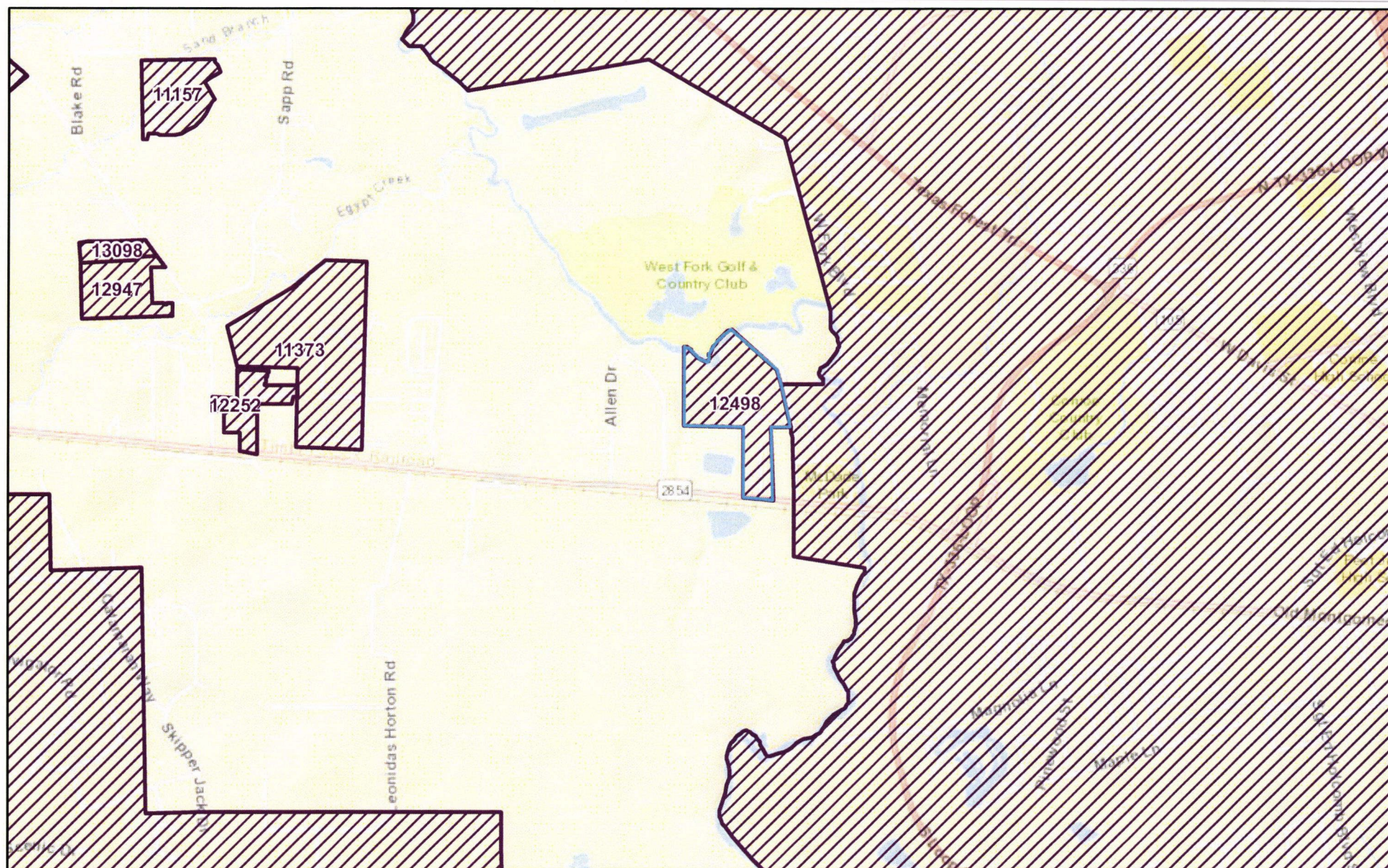

April 26, 2019

1:36,112

A number line illustrating the conversion of miles to kilometers. The top scale is in miles, ranging from 0 to 1.1. The bottom scale is in kilometers, ranging from 0 to 1.7. Key points are marked: 0.28 miles corresponds to 0.42 kilometers, and 0.55 miles corresponds to 0.85 kilometers.

Sources: Esri, HERE, Garmin, USGS, Intermap, INCREMENT P, NRCan,