



Control Number: 50421



Item Number: 285

Addendum StartPage: 0

**SOUTHWESTERN ELECTRIC POWER COMPANY
CONSTRUCTION PROGRESS REPORT
SEPTEMBER 2020**

**Public Utility Commission of Texas
Project No. 50421**

Utility's Project Number	Project Name	Location (City/County)	Description	Estimated (or Actual) Start Date	Finish Date (Construction Complete)	Date Energized (if Applicable)	Initial Estimated Project Cost (\$)	Final Estimated Project Cost (\$)	Final Actual Project Cost (\$)	% Variance	Percent Complete	Existing Voltage (kV)	Upgraded or New Voltage (kV)	Circuit Length (Miles)	Conductor Type & Size & Bundling	Structure Type(s)	Existing ROW Width (Feet)	Existing ROW Length (Miles)	New ROW Width (Feet)	New ROW Length (Miles)	Rule Section or PUC Control Number	Comments
42872935	Bann - Redlick 69-kV Rebuild	Bowie	Rebuild and Reconnector the Bann to Redlick 69-kV T-Line (existing double circuit with Bann to New Boston 138-kV transmission line) to 138-kV Standards but will continue to operate at 69 kV	9/3/2019	12/13/2019	12/14/2019	\$ 2 815 625 00				99	69		1 50	1272 KCM 54/19 ACSR PHEASANT	Steel Single Pole	Varies	1 50	100	1 50	16 TAC 25 101 (c)(5)(B)	Landowners Consent Obtained
42633475	Bann - North New Boston 138-kV Line Rebuild	Bowie	Rebuild and Reconnector 1 50 miles of the Bann to North New Boston 138-kV T-Line (existing double circuit with Bann to Redlick 69-kV transmission line)	9/3/2019	12/12/2019	12/12/2019	\$ 2 695 041 00				99	138		1 50	1272 KCM 54/19 ACSR PHEASANT	Steel Single Pole	Varies	1 50	100	1 50	16 TAC 25 101 (c)(5)(B)	Landowners Consent Obtained
42644732	Adora Tap - West Mt Pleasant	Mt Pleasant/Titus	Rebuild and Reconnector 0 86 miles of 69-kV T-Line to 138-kV Standards Continues to operate at 69 kV	3/19/2018	5/1/2109		\$ 1 360 000 00				0	69		0 86	1272 KCM 54/19 ACSR PHEASANT	Steel Single Pole	Varies	0 86			16 TAC 25 101 (c)(5)(B)	Utilizing existing easements Landowners noticed
42622941a	Pilgrims Pride - Winfield 345-kV (Pilgrims Pride - Adora Tap)	Titus	Rebuild and Reconnector 1 61 miles of 69-kV T-Line to 138-kV Standards Continues to operate at 69 kV	1/15/2018	3/16/2019		\$ 1 415 964 00				5	69		1 61	1272 KCM 54/19 ACSR PHEASANT	Steel Single Pole	Various	1 61			16 TAC 25 101 (c)(5)(B)	Utilizing existing easements Landowners noticed
42678576	Wilkes 345-kV Replace breakers and auto transformer	Marion	Replace 138-kV Breakers and Bus and one 138/345-kV auto transformer	4/1/2018	5/14/2021		\$ 13 776 933 00				65	345 / 138									16 TAC 25 83(a)(3)	Within Station Property
42707036	Vernon Station (SPF) Breaker Replacement	Vernon/Wibarger	Replace 69-kV Circuit Breakers 122	7/2/2018	5/1/2019	4/30/2019	\$ 797 621 00				99	69									16 TAC 25 83(a)(3)	Within existing property
42763999	Prkeley - Tenaska Rust County 345-kV Line Relocate	Harrison	Relocate a 1 50 mile section of the existing SWEPCO Prkeley - Tenaska Rust County 345-kV transmission line to facilitate advancement of mining at Sabine Mine. Relocation occurs between Prkeley Substation and Lebrock Substation	1/7/2019	6/14/2019		\$ 9 048 389 00				15	345		2 70	1272 KCM 54/19 ACSR PHEASANT	Steel Single Pole	150	1 50	150	2 70	16 TAC 25 101 (c)(5)(E)	Landowner Consent Obtained
42872933	Richmond Rd - NW Texarkana SWAEC Tap 69-kV Line Rebuild	Texarkana/Bowie	Rebuild and Reconnector 1 10 miles of the NW Texarkana SWAEC Tap to Richmond Road 69-kV T-Line to 138-kV standard but will continue to operate at 69 kV	12/1/2020	5/31/2021		\$ 2 046 020 00				0	69		1 10	1272 KCM 54/19 ACSR PHEASANT	Steel Single Pole	Varies	1 10			16 TAC 25 101 (c)(5)(B)	Utilizing existing easements Landowners noticed
42896414	Hill Lake	Panola	Hill Lake 138-kV Extension Terminate the Logansport - Rock Hill - Tanahia 138-kV transmission line with double-circuit structures into new Hill Lake Station	3/26/2019	8/31/2019	8/28/2019	\$ 1 680 114 00				98		138	0 50	1272 ACSR 54/19 (Pheasant)	Steel Single Pole			100	0 25	16 TAC 25 101 (c)(5)(A)	Landowner Consent Obtained
42879422	Brandy Branch 138-kV Box Bay	Harrison	Terminate the Knox Lee - Prkeley 138-kV transmission line into Brandy Branch 138-kV POD Box Bay. This will also include the temporary hard tap for the customer	7/15/2019	3/26/2020	5/21/2020	\$ 386 742 00				99	138		0 19	Bundled CURLEW 1033 5 ACSR/SD TYPE 5 4217	Steel Single Pole	Varies	0 19			16 TAC 25 101 (c)(5)(A)	Transmission line within Company owned property. No additional easement required
42986367	IPC 138-kV Expansion T-Station Asset	Cass	Install one bi-M bus support and bus work to get to the new switch in front of the circuit switcher	8/1/2019	3/30/2020	3/25/2020	\$ 335 446 00				99	138									16 TAC 25 83(a)(3)	Within Station Property
42872872	Mt Pleasant to Cookville Tap 69-kV Line Rebuild	Mt Pleasant/Titus	Rebuild and Reconnector Mt Pleasant to Cookville Tap 69-kV T-Line to 138-kV standards but will continue to operate at 69 kV	7/4/2019	4/19/2020	3/12/2020	\$ 8 771 835 00				99	69		8 16	1272 KCM 54/19 ACSR PHEASANT	Steel Single Pole	Varies	8 16			16 TAC 25 101 (c)(5)(B)	Utilizing existing easements Landowners noticed
42879407	Brandy Branch 138-kV Box Bay	Harrison	Construct a new 138-kV POD Box Bay with 2-3000A MO Scada-Controlled switches with SF6 Interrupters 1-3000A MO Scada-Controlled Tap Switch, and 1-3000A Maintenance Switch on the Knox Lee - Prkeley 138-kV transmission line	1/13/2020	5/21/2020	5/21/2020	\$ 1 776 292 00				99		138								16 TAC 25 83(a)(3)	Within Company-Owned property. No additional easement required
42905188	Mt Pleasant 69/138-kV substation	Mt Pleasant/Titus	Upgrade switch 4112 and associated breakers and bus jumpers to 2000amps. Upgraded strain bus in west 69 kV bay. Install OPGW fiber. Work includes mobil hook up and use	1/13/2020	3/10/2020	3/11/2020	\$ 402 442 00				99	69									16 TAC 25 83(a)(3)	Within Station Property
42872934	Richmond Rd - Redlick Tap 69-kV Line Rebuild	Texarkana/Bowie	Rebuild and Reconnector 2 8 miles of the Redlick Tap to Richmond Road 69-kV T-Line to 138-kV standards but will continue to operate at 69 kV	12/1/2019	5/29/2020	5/6/2020	\$ 7 257 264 00				99	69		2 87	1272 KCM 54/19 ACSR PHEASANT	Steel Single Pole	Varies	2 87			16 TAC 25 101 (c)(5)(B)	Utilizing existing easements Landowners noticed
42944083	North Mineola Substation Rebuild	Mineola/Wood	Replace circuit breakers and associated breaker jumpers. Replace disconnect switches. Replace PTs with (3) new CCVTs on Mineola line terminal and Outman line terminals	2/10/2020	11/2/2020		\$ 2 019 063 00				75	69									16 TAC 25 83(a)(3)	Within Station Property
42626681	Anderson Creek 138-kV Substation	Bowie	Remote end relay upgrade work. Replace existing CTs and PTs with new CT/PT combo metering. New 3 phase CCVT's will be installed. Install new 3-bay transclosure unit with DC power system	3/21/2020	5/22/2020	5/26/2020	\$ 1 062 184 00				99	138									16 TAC 25 83(a)(3)	Within Station Property

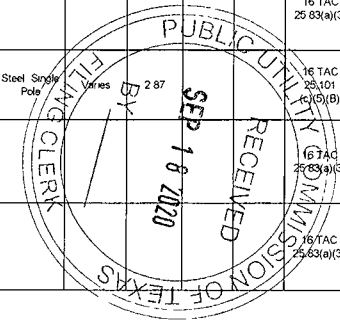

285

**SOUTHWESTERN ELECTRIC POWER COMPANY
CONSTRUCTION PROGRESS REPORT
SEPTEMBER 2020**

**Public Utility Commission of Texas
Project No. 50421**

Utility's Project Number	Project Name	Location (City/County)	Description	Estimated (or Actual) Start Date	Finish Date (Construction Complete)	Date Energized (If Applicable)	Initial Estimated Project Cost (\$)	Final Estimated Project Cost (\$)	Final Actual Project Cost (\$)	% Variance	Percent Complete	Existing Voltage (kV)	Upgraded or New Voltage (kV)	Circuit Length (Miles)	Conductor Type & Size & Bundling	Structure Type(s)	Existing ROW Width (Feet)	Existing ROW Length (Miles)	New ROW Width (Feet)	New ROW Length (Miles)	Rule Section or PUC Control Number	Comments
42905185	Cookville 69-kV Box Bay	Titus	Construct new 138-kV Box Bay POD (operating at 69-kV) at the Cookville 69-kV Tap with three (3) MOAB switches and remove two (2) existing switches. Add fiber transition into station along the line. No auto-sectionalizing required.	5/18/2020	9/29/2020			\$ 1 876 457 00			55		69								16 TAC 25 83(a)(3)	Landowner Consent Obtained
42905186	Buford Survey 69-kV Box Bay	Morris	Construct new 138-kV Box Bay POD (operating at 69-kV) at the Buford Survey 69-kV Tap with three (3) MOAB switches and remove three (3) existing switches. Add fiber transition into station along the line. Auto-sectionalizing required.	6/22/2020	10/28/2020			\$ 1 908 905 00			35		69								16 TAC 25 83(a)(3)	Landowner Consent Obtained
42905190	Dekalb to Mt Pleasant 69-kV transmission line. Cut-In to new Box Bays	Titus/Morris	Terminate the existing Dekalb to Mt Pleasant 69-kV transmission line into the new Cookville 69-kV Box Bay and Buford Survey 69-kV Box Bay. Will be built to 138-kV Standards but operated at 69-kV.	5/12/2020	10/28/2020			\$ 1 390 988 00			30	69		0 30	1272 KCM 54/19 ACSR "PHEASANT"	Steel Single Pole	Varies	0 30			16 TAC 25 101 (c)(5)(A)	Landowner Consent Obtained
T10104999	Cookville 69-kV Tap Cut-In to new Cookville Box Bay	Titus	Terminate the existing Cookville 69-kV Tap into the new Cookville 69-kV Box Bay. Will be built to 138-kV Standards but operated at 69-kV.	5/12/2020	9/29/2020			\$ 571 219 00			30	69		0 10	1272 KCM 54/19 ACSR "PHEASANT"	Steel Single Pole	Varies	0 10			16 TAC 25 101 (c)(5)(A)	Landowner Consent Obtained
T10105018	Buford Survey 69-kV Tap Cut-In to new Buford Survey Box Bay	Morris	Terminate the existing Buford Survey 69-kV Tap into the new Buford Survey 69-kV Box Bay. Will be built to 138-kV Standards but operated at 69-kV.	5/12/2020	10/28/2020			\$ 275 781 00			30	69		0 10	1272 KCM 54/19 ACSR "PHEASANT"	Steel Single Pole	Varies	0 10			16 TAC 25 101 (c)(5)(A)	Landowner Consent Obtained
42944074 (P18222007)	Mineola 69-kV Substation Upgrade & Expansion	Wood	Replacement of one 69-kV breaker and upgrade of another. Replacement of four switches (9) coils and 3 arresters. Rebuild of existing bus for increased rating needed and relocate existing arresters and other equipment for the rebuild. Install new DICM to replace switch house equipment. Expand substation property.	6/15/2020	4/21/2021			\$ 4 153 685 00			15	69									16 TAC 25 83(a)(3)	Property Purchased
42941298 (P18222001)	New Gutzman 69-kV Substation	Wood	Construct a new 69-kV, 40kA 2000A (4) four-breaker ring bus design substation on a new station pad on 10 acres of purchased property located about 0.6 miles to the northeast of existing Gutzman Substation.	6/15/2020	11/24/2021			\$ 5 674 838 00			10		69								16 TAC 25 83(a)(3)	Property Purchased
42631655 (A16906006)	39th Street - NW Texarkana SWAEC Tap 69-kV Line Rebuild	Texarkana/Bowie	Rebuild and Reconnector 4.92 miles of the 39th Street to NW Texarkana SWAEC Tap 69-kV T-Line to 138-kV standards but will continue to operate at 69-kV.	8/3/2020	2/28/2021			\$ 15 062 764 00			0	69		4.92	1272 KCM 54/19 ACSR "PHEASANT"	Steel Single Pole	Varies	4.92			16 TAC 25 101 (c)(5)(B)	Utilizing existing easements. Landowners noticed.
42944077 (P18222008)	Grand Saline 69-kV Substation Upgrade & Expansion	Grand Saline/Van Zandt	Replacement of two 69-kV breakers. Replacement of four breaker disconnect switches. Replacement of two breaker disconnect switches with new circuit switchers. Remove two bypass switches. All 69-kV clip and pin bus support insulators will be replaced. Install new DICM to replace switch house equipment. Expand substation property.	8/3/2020	5/26/2021			\$ 4 228 148 00			0	69									16 TAC 25 83(a)(3)	Property Purchased
42976121 (P16254001)	NW Texarkana 138-kV Station	Texarkana/Bowie	Add an additional 138-kV line terminal, circuit breaker, and necessary relaying for the Bann - NW Texarkana 138-kV transmission line so the Bann & North New Boston 138-kV lines can be separated and terminated at different station dead ends.	8/24/2020	11/19/2020			\$ 2 121,390 00			0	138									16 TAC 25 83(a)(3)	Within Station Property
42976124 (P18254002)	Bann - NW Texarkana 138-kV T-Line	Texarkana/Bowie	Re-terminate the Bann - NW Texarkana 138-kV transmission line to new station line terminal with (2) new spans.	9/1/2020	11/19/2020			\$ 995 987 00			0	138		0 07	1272 ACSR 54/19 Pheasant	Steel Dead-End	100	0 07			16 TAC 25 101 (c)(5)(A)	Utilizing existing easements. Landowners noticed.
43000210 (P16254005)	N New Boston - NW Texarkana 138-kV T-Line	Texarkana/Bowie	Re-terminate the North New Boston - NW Texarkana 138-kV transmission line into an existing station dead end.	9/1/2020	10/29/2020			\$ 404 697 00			0	138		0 04	1272 ACSR 54/19 Pheasant	Steel Dead-End	100	0 04			16 TAC 25 101 (c)(5)(A)	Utilizing existing easements. Landowners noticed.
42976122 (P16254006)	North New Boston 138-kV Substation	New Boston/Bowie	Upgrade relaying and replace CCVT's at remote end station.	9/15/2020	10/29/2020			\$ 575 263 00			0	138									16 TAC 25 83(a)(3)	Within Station Property

**SOUTHWESTERN ELECTRIC POWER COMPANY
CONSTRUCTION PROGRESS REPORT
SEPTEMBER 2020**

**Public Utility Commission of Texas
Project No. 50421**

Utility's Project Number	Project Name	Location (City/County)	Description	Estimated (or Actual) Start Date	Finish Date (Construction Complete)	Date Energized (If Applicable)	Initial Estimated Project Cost (\$)	Final Estimated Project Cost (\$)	Final Actual Project Cost (\$)	Variance %	Percent Complete	Existing Voltage (kV)	Upgraded or New Voltage (kV)	Circuit Length (Miles)	Conductor Type & Size & Bundling	Structure Type(s)	Existing ROW Width (Feet)	Existing ROW Length (Miles)	New ROW Width (Feet)	New ROW Length (Miles)	Rule Section or PUC Control Number	Comments
42976123 (P19254007)	Bann 138-kV Substation	Bowie	Upgrade relaying at remote end station	9/15/2020	11/19/2020			\$ 348,808.00			0	138									16 TAC 25.83(a)(3)	Within Station Property
42941390 (P18215001)	Lydia 345-kV Station	Bowie	Convert the Lydia 345kV station to a ring bus configuration eliminating the 3-terminal line by adding breakers. A new station will be built in the clear on newly purchased property. The existing station will be retired.	9/9/2020	5/11/2022			\$ 15,843,030.00			0	345									16 TAC 25.83(a)(3)	Property Purchased
T10068530 (DP20S05D0)	Alba 69-kV Substation Upgrade T-Station	Alba/Wood	Rebuild Alba substation with new station deadend bus work SSVT and relaying	10/4/2020	12/15/2020			\$ 658,792.77			0	69									16 TAC 25.83(a)(3)	Within Station Property
T10068526 (DP20S05C0)	Alba 69-kV Substation Upgrade T-Line	Alba/Wood	Install one transmission structure to feed the new station rebuild	10/4/2020	12/15/2020			\$ 425,355.00			0	69		0.02	T2 477 KCM ACSR	Steel Dead-End					16 TAC 25.83(a)(3)	Within Station Property
T10076668 (A19084001)	Bann - NW Texarkana 138-kV T-Line Interstate 30 TxDOT Relocation	Bowie	Relocate one structure along the Bann to NW Texarkana 138-kV transmission line to make room for access roads being built along Interstate Highway 30 (IH 30) as requested by the Texas Department of Transportation (TxDOT)	12/3/2020	12/7/2020			\$ 228,227.00				138			1590 ACSR 54/19 Falcon	Concrete Mono Pole	100				16 TAC 25.101 (c)(5)(F)	Landowners Noticed
T10076671 (A19084002)	Bann-New Boston 69-kV Line Interstate 30 TxDOT Relocation	Bowie	Relocate two structures along the Bann to New Boston 69-kV transmission line to make room for access roads being built along Interstate Highway 30 (IH 30) as requested by the Texas Department of Transportation (TxDOT)	12/8/2020	1/12/2021			\$ 561,505.00				69			1772 ACSR 54/19 Pheasant	Steel Mono Pole	100				16 TAC 25.101 (c)(5)(F)	Landowners Noticed

AFFIDAVIT

STATE OF TEXAS

COUNTY OF TRAVIS

I, Roy R. Bermea, being duly sworn, file this Affidavit as a Regulatory Consultant, AEP Texas Inc. representing Southwestern Electric Power Company (SWEPCO) regarding notice to perform the relocation of one transmission structure along the Bann to NW Texarkana 138-kV transmission line, as requested by TxDOT due to a road widening Project along Interstate 30, and as described in Project No. T10076668 in the PUCT Monthly Construction Progress Report (PUCT Project No. 50421) for September 2020. That in such capacity, I am qualified and authorized to file and verify to the best of my knowledge that SWEPCO has noticed all landowners on the current Bowie County tax rolls associated with these activities on all properties directly affected by these activities, has noticed any utilities whose certificated service area is crossed by this rebuild of facilities, has noticed any owners of parks and recreation areas within 1,000 feet, and any airports within 10,000 feet, of the centerline of this relocation of facilities, and has acquired all of the necessary easements to proceed with this project.



Roy R. Bermea
Regulatory Consultant
AEP Texas Inc.

SUBSCRIBED AND SWORN TO BEFORE ME, a Notary Public in and for the State of Texas, this 18th day of September, 2020.

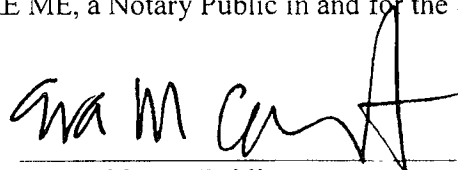

Notary Public

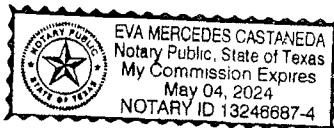

AFFIDAVIT

STATE OF TEXAS

COUNTY OF TRAVIS

I, Roy R. Bermea, being duly sworn, file this Affidavit as a Regulatory Consultant, AEP Texas Inc. representing Southwestern Electric Power Company (SWEPCO) regarding notice to perform the relocation of two transmission structures along the Bann to New Boston 69-kV transmission line, as requested by TxDOT due to a road widening Project along Interstate 30, and as described in Project No. T10076671 in the PUCT Monthly Construction Progress Report (PUCT Project No. 50421) for September 2020. That in such capacity, I am qualified and authorized to file and verify to the best of my knowledge that SWEPCO has noticed all landowners on the current Bowie County tax rolls associated with these activities on all properties directly affected by these activities, has noticed any utilities whose certificated service area is crossed by this rebuild of facilities, has noticed any owners of parks and recreation areas within 1,000 feet, and any airports within 10,000 feet, of the centerline of this relocation of facilities, and has acquired all of the necessary easements to proceed with this project.



Roy R. Bermea
Regulatory Consultant
AEP Texas Inc.

SUBSCRIBED AND SWORN TO BEFORE ME, a Notary Public in and for the State of Texas, this 18th day of September, 2020.

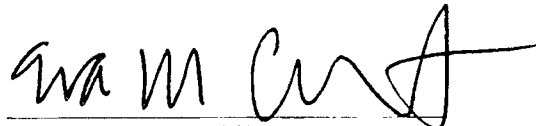

Notary Public

