



Control Number: 49740



Item Number: 18

Addendum StartPage: 0

DOCKET NO. 49740

**APPLICATION OF C&R WATER §
SUPPLY, INC. TO AMEND ITS §
CERTIFICATES OF CONVENIENCE §
AND NECESSITY IN MONTGOMERY §
COUNTY §**

PUBLIC UTILITY COMMISSION

OF TEXAS

RECEIVED

2020 MAR -3 PM 1:41

PUBLIC UTILITY COMMISSION
FILING CLERK

COMMISSION STAFF'S FINAL RECOMMENDATION

COMES NOW the Staff (Staff) of the Public Utility Commission of Texas (Commission), representing the public interest and files this Final Recommendation. In support thereof, Staff shows the following:

I. BACKGROUND

On July 15, 2019, the C&R Water Supply, Inc. (C&R) filed an application to amend its water Certificate of Convenience and Necessity (CCN) No. 13098, in Montgomery County, Texas. The requested area includes approximately 45 acres and has no current customers.

On February 26, 2020, the Administrative Law Judge (ALJ) issued Order No. 5 requiring Commission Staff to file its final recommendation or a request for a hearing by March 3, 2020. Therefore, this pleading is timely filed.

II. FINAL RECOMMENDATION

As detailed in the attached memorandum of Greg Charles of the Commission's Infrastructure Division, Staff recommends that the application be approved. On February 6, 2020, C&R consented to the attached map, certificate, and tariffs. Staff further recommends that C&R file certified copies of their CCN maps along with a written description of their CCN service area in the Montgomery County Clerk's Office as required by TWC §§ 13.257(r)-(s).

III. CONCLUSION

Staff respectfully requests an order approving the application.

**PUBLIC UTILITY COMMISSION OF
TEXAS LEGAL DIVISION**

Rachelle Nicolette Robles
Division Director

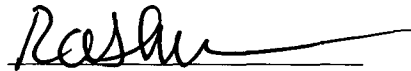

Rashmin J. Asher
State Bar No. 24092058
1701 N. Congress Avenue
P.O. Box 13326
Austin, Texas 78711-3326
(512) 936-7216
(512) 936-7268 (facsimile)
Rashmin.Asher@puc.texas.gov

DOCKET NO. 49740

CERTIFICATE OF SERVICE

I certify that a copy of this document will be served on all parties of record on March 3, 2020 in accordance with 16 TAC § 22.74.

Rashmin J. Asher

PUC Interoffice Memorandum

To: Rashmin Asher, Attorney
Legal Division

From: Greg Charles, Engineer
Infrastructure Division

Fred Bednarski III, Financial Analyst
Rate Regulation

Date: March 3, 2020

Subject: **Docket No. 49740**, *Application of C&R Water Supply, Inc. to Amend its Certificates of Convenience and Necessity (CCN) in Montgomery County*

On July 15, 2019, C&R Water Supply, Inc. (C&R Water) filed with the Public Utility Commission of Texas (Commission) an application to amend its water Certificate of Convenience and Necessity (CCN) No. 13098 and sewer CCN No. 20987 in Montgomery County, Texas pursuant to Texas Water Code Ann. (TWC) §§ 13.242 to 13.250 and the 16 Tex. Admin. Code (TAC) §§ 24.225 to 24.237. The requested service area consists of 45 acres and currently has no customers.

Notice

The comment period ended on December 4, 2019, and no protests or opt-out requests were received.

Criteria Considered

TWC § 13.246(c) requires the Commission to consider nine criteria when granting or amending a CCN. Therefore, the following criteria were considered:

TWC § 13.246(c)(1) and 16 TAC § 24.227(d)(1) requires the commission to consider the adequacy of service currently provided to the requested area.

Staff did not consider these criteria as water and sewer service is not currently being provided in the requested area.

TWC § 13.246(c)(2) and 16 TAC § 24.227(d)(2) requires the commission to consider the need for service in the requested area.

The requested service area is vacant land that is being developed into residential subdivisions.

TWC § 13.246(c)(3) and 16 TAC § 24.227(d)(3) requires the commission to consider the effect of granting certificate or an amendment on the recipient and on any other retail public utility servicing the proximate area.

There will be no effect on any retail public utility servicing the proximate area as there are no other water and sewer providers within the requested service area.

TWC §§ 13.241(b) and (c), 13.246(c)(4) and 16 TAC § 24.227(d)(4) requires the commission to consider the ability of the Applicant to provide adequate service.

The Applicant has a public water system (PWS) registered with the Texas Commission on Environmental Quality (TCEQ) under PWS ID No. 1700683 which is capable of providing drinking water that meets the requirements of Chapter 341, Health and Safety Code, and requirements of the TWC and will have access to an adequate supply of water. In addition, The Applicant has a wastewater permit registered with the TCEQ under WQ 0014285-001 serving Emerson Estates. There is one operator licensed for both water and sewer systems.

TWC §§ 13.241(d), 13.246(c)(5), and 16 TAC § 24.227(d)(5) requires the commission to consider the feasibility of obtaining service from an adjacent retail public utility.

The Applicant is the only entity within two miles of the requested service area that can provide both water and sewer utility services. The land is within the extra territorial jurisdiction of the City of Cut and Shoot (City,) and attached to the application is the minutes of the agreeing to the Applicant adding the requested area.

TWC § 13.246(c)(6) and 16 TAC § 24.227(d)(6) requires the commission to consider the financial ability of the Applicant to pay for facilities necessary to provide continuous and adequate service.

The financial criteria and tests are listed in 16 TAC § 24.11 including leverage tests and an operations test.

16 TAC § 24.11 establishes the criteria to demonstrate that an owner or operator of a retail public utility has the financial resources to operate and manage the utility and to provide continuous and adequate service to the current and requested utility service area. The financial tests include a leverage test and operations test. The Commission rules identify five leverage tests.¹ The Purchaser must demonstrate that it meets one of the five tests.²

The following shows that C&R Water meets one out of five leverage tests. This analysis is based on financial statements ending December 31, 2018. C&R Water meets the first test with a debt to equity ratio calculated as follows: long term debt of \$725,343³ divided by equity of \$1,506,692⁴ equals 0.48 which is less than one.

16 TAC § 24.11(e)(3) refers to the operations test which requires that the owner or operator must demonstrate sufficient cash is available to cover any projected operations and maintenance shortages in the first five years of operations. C&R Water submitted projected financial statements in its application, which shows there are no shortages to cover⁵. C&R Water will provide water and sewer service with its existing public water system PWS No. 1700683 and wastewater permit WQ-0014285-001⁶. The requested area is planned to be developed into a subdivision containing 279 lots that will be developed in three phases.

¹ See 16 TAC § 24.11(e)(2).

² *Id.*

³ Application at 38.

⁴ *Id.*

⁵ Supplement to Application at 4 (Oct. 4, 2019).

⁶ Application at 9.

C&R Water agrees to pay for all the labor and equipment cost to install the needed water and sewer infrastructure which is estimated to cost \$95,000 to \$100,000⁷. Per the agreement the developer will pay \$1,000 per each sewer connection upfront phase by phase. The upfront payment will be refunded to the developer as new connections are added⁸. The financial statements and the developer agreement indicate that funds are available for all plant investment required to provide continuous and adequate service to the area being requested. Therefore, C&R Water meets the operations test.

TWC § 13.246(d)(6) allows the Commission to require an applicant to provide a bond or other financial assurance in a form and amount specified by the Commission to ensure that continuous and adequate utility service is provided. Staff does not recommend that the Applicant be required to provide a bond or other financial assurance to ensure continuous and adequate service to the requested area.

TWC §§ 13.246(7) and (9) and 16 TAC §§ 24.227(d)(7) and (9) require the commission to consider the environmental integrity and the effect on the land to be included in the certificate.

The environmental integrity will be minimally affected as the requested area is developed. In addition, by granting the amendment the environmental integrity of the land will be protected by eliminating the need for landowners to use individual wells and septic tanks.

TWC § 13.246(8) and 16 TAC § 24.227(d)(8) requires the commission to consider the probable improvement in service or lowering of cost to consumers.

This is not applicable because there are no homes currently receiving service in the requested service area. Staff recommends that the proposed rates are reasonable with respect to the projected financial information provided with the application and the Applicant's responses to Staff's requests for information.

The Applicant consented to the attached maps, certificates, and tariffs on February 4, 2020.

Recommendation

Based on the above information, Staff recommends that:

- The Commission find that the Applicant meets all of the statutory requirements of TWC Chapter 13 and the Commission's Chapter 24 rules and regulations and is capable of providing continuous and adequate service;
- The Commission find that issuance of water CCN No. 13098 and sewer CCN No. 20987 is necessary for the service, accommodation, convenience, and safety of the public;
- The Applicant be ordered to file a rate application with the Commission under 16 TAC § 24.25(b)(1)(C) within 18 months from the date service begins;

⁷ Response to Staff's First Request for Information at 4 (Nov. 1, 2019).

⁸ Response to Order No. 2 at 14 (Sept. 16, 2019).

- The Commission require the Applicant to provide notice to the Commission once billing for service begins, as required by 16 TAC § 24.25(b)(1)(B)(vi);
- The Commission issue an order approving the application and provide the attached maps, certificates, and tariff to the Applicant; and
- The Applicant be required to file certified copies of their CCN maps along with a written description of the CCN service area in the county clerk's office under TWC §§ 13.257(r)-(s).

C &R Water Supply, Inc.
Portion of Sewer CCN No. 20987
PUC Docket No. 49740
Amended CCN No. 20987 in Montgomery County

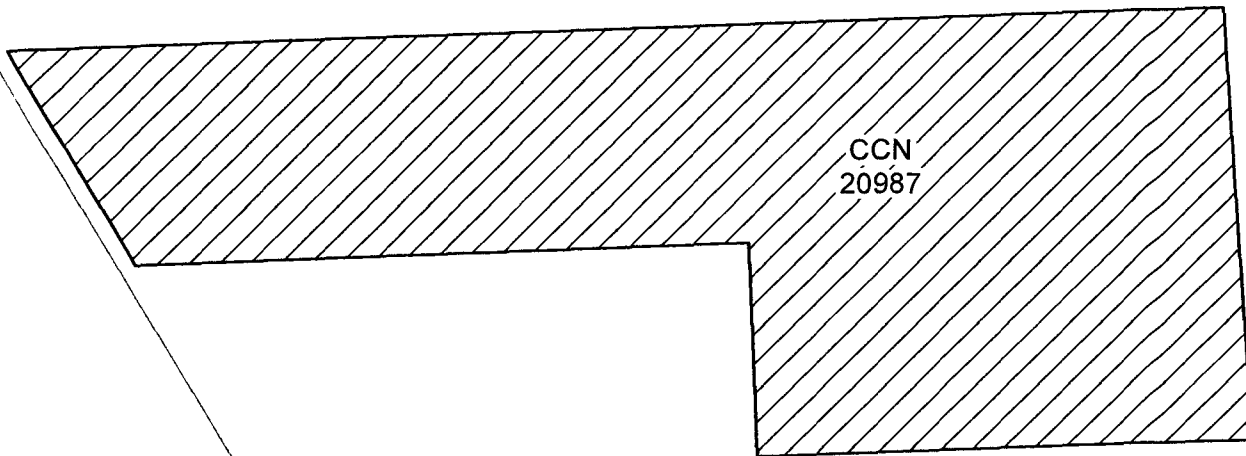

Public Utility Commission of Texas
1701 N. Congress Ave
Austin, TX 78701

Sewer CCN



20987 - C & R Water Supply Inc

0 225 450
Feet



Map by: Komal Patel
Date created: January 27, 2020
Project Path: n:\finalmapping\
49740C&RWSSewer

0000007

C & R Water Supply, Inc.
Portion of Water CCN No. 13098
PUC Docket No. 49740
Amended CCN No. 13098 in Montgomery County

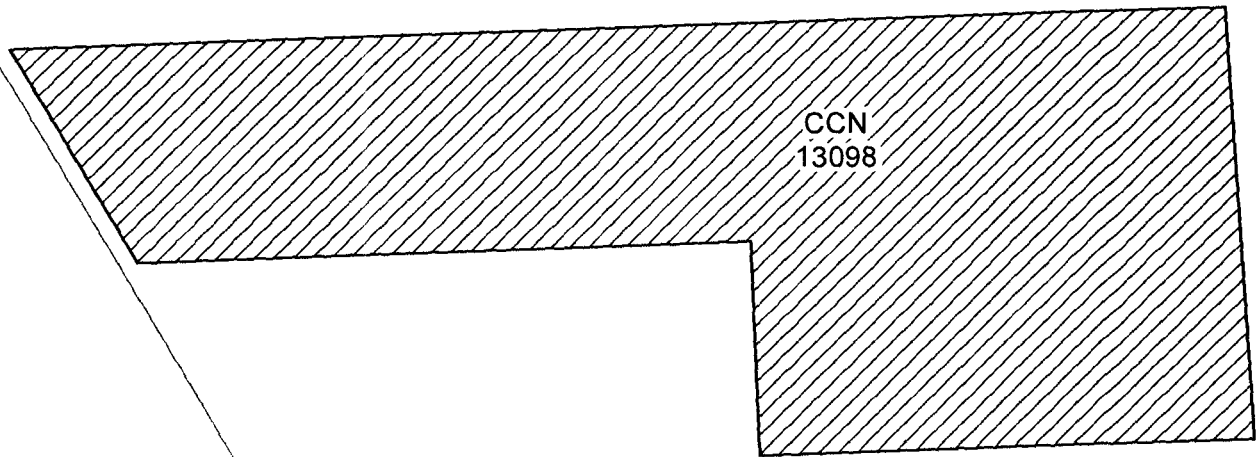

Public Utility Commission of Texas
1701 N. Congress Ave
Austin, TX 78701

Water CCN



13098 - C & R Water Supply Inc

0 225 450
Feet



Map by: Komal Patel
Date created: January 27, 2020
Project Path: n:\finalmapping\
49740C&RWSWater

0000008



Public Utility Commission of Texas

By These Presents Be It Known To All That
C & R Water Supply, Inc.

having obtained certification to provide water utility service for the convenience and necessity of the public, and it having been determined by this Commission that the public convenience and necessity would in fact be advanced by the provision of such service, C & R Water Supply, Inc. is entitled to this

Certificate of Convenience and Necessity No. 13098

to provide continuous and adequate water utility service to that service area or those service areas in Montgomery County as by final Order or Orders duly entered by this Commission, which Order or Orders resulting from Docket No. 49740 are on file at the Commission offices in Austin, Texas; and are a matter of official record available for public inspection; and be it known further that these presents do evidence the authority and the duty of C & R Water Supply, Inc. to provide such utility service in accordance with the laws of this State and Rules of this Commission, subject only to any power and responsibility of this Commission to revoke or amend this Certificate in whole or in part upon a subsequent showing that the public convenience and necessity would be better served thereby.

Issued at Austin, Texas, the _____ day of _____ 2020.

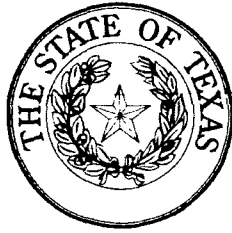

Public Utility Commission of Texas

By These Presents Be It Known To All That
C & R Water Supply, Inc.

having obtained certification to provide sewer utility service for the convenience and necessity of the public, and it having been determined by this Commission that the public convenience and necessity would in fact be advanced by the provision of such service, C & R Water Supply, Inc. is entitled to this

Certificate of Convenience and Necessity No. 20987

to provide continuous and adequate sewer utility service to that service area or those service areas in Montgomery County as by final Order or Orders duly entered by this Commission, which Order or Orders resulting from Docket No. 49740 are on file at the Commission offices in Austin, Texas; and are a matter of official record available for public inspection; and be it known further that these presents do evidence the authority and the duty of C & R Water Supply, Inc. to provide such utility service in accordance with the laws of this State and Rules of this Commission, subject only to any power and responsibility of this Commission to revoke or amend this Certificate in whole or in part upon a subsequent showing that the public convenience and necessity would be better served thereby.

Issued at Austin, Texas, the _____ day of _____ 2020.



SEWER UTILITY TARIFF
Docket Number: 49740

C & R Water Supply, Inc.
(Utility Name)

P. O. Box 187
(Business Address)

Willis, Texas 77378
(City, State, Zip Code)

(936) 856-4199
(Area Code/Telephone)

This tariff is effective for utility operations under the following Certificate of Convenience and Necessity:

20987

This tariff is effective in the following counties:

Montgomery

This tariff is effective in the following cities or unincorporated towns (if any):

Town of Cut and Shoot

This tariff is effective in the following subdivisions and public sewer systems:

See attached list

TABLE OF CONTENTS

The above utility lists the following sections of its tariff (if additional pages are needed for a section, all pages should be numbered consecutively):

SECTION 1.0 -- RATE SCHEDULE.....	2
SECTION 2.0 -- SERVICE RULES AND POLICIES	4
SECTION 3.0 -- EXTENSION POLICY	9

SECTION A -- SAMPLE SERVICE AGREEMENT

LIST OF SUBDIVISIONS OR SYSTEMS

SUBDIVISION	WASTEWATER NUMBER	COUNTY
Clearwater Cove Clearwater Point Falcon Sound Hard Times Boating Club Playa Vista Shiloh Marina	WQ13575001	Montgomery
Emerson Estates	WQ14285001	Montgomery

SECTION 1.0 - RATE SCHEDULE

Section 1.01--Rates

<u>Meter Size</u>	<u>Monthly Minimum Charge</u>	<u>Gallonage Charge</u>
All Connections	<u>\$39.35</u> (includes 0 gallons)	<u>\$2.75</u> for each 1,000 gallons

FORM OF PAYMENT: The utility will accept the following forms of payment:

Cash___, Check X, Money Order X, Credit Card ____, Other (specify) _____
THE UTILITY MAY REQUIRE EXACT CHANGE FOR PAYMENTS AND MAY REFUSE TO ACCEPT
PAYMENTS MADE USING MORE THAN \$1.00 IN SMALL COINS. A WRITTEN RECEIPT WILL BE GIVEN
FOR CASH PAYMENTS.

REGULATORY ASSESSMENT..... 1.0%
PUBLIC UTILITY COMMISSION (COMMISSION) RULES REQUIRE THE UTILITY TO COLLECT AND REMIT
TO THE TEXAS COMMISSION ON ENVIRONMENTAL QUALITY A FEE OF ONE PERCENT OF THE RETAIL
MONTHLY BILL.

Section 1.02 - Miscellaneous Fees

TAP FEE\$350.00
TAP FEE COVERS THE UTILITY'S COSTS FOR MATERIALS AND LABOR TO INSTALL A STANDARD
RESIDENTIAL CONNECTION. AN ADDITIONAL FEE TO COVER UNIQUE COSTS IS PERMITTED IF LISTED
ON THIS TARIFF.

SECTION 1.0 - RATE SCHEDULE (Continued)

RECONNECTION FEE

THE RECONNECT FEE MUST BE PAID BEFORE SERVICE CAN BE RESTORED TO A CUSTOMER WHO HAS BEEN DISCONNECTED FOR THE FOLLOWING REASONS (OR OTHER REASONS LISTED UNDER SECTION 2.0 OF THIS TARIFF):

- a) Non-payment of bill (Maximum \$25.00)\$25.00
- b) Customer's request that service be disconnected\$35.00

TRANSFER FEE\$35.00

THE TRANSFER FEE WILL BE CHARGED FOR CHANGING AN ACCOUNT NAME AT THE SAME SERVICE LOCATION WHEN THE SERVICE IS NOT DISCONNECTED.

LATE CHARGE (EITHER \$5.00 OR 10% OF THE BILL) 10%

COMMISSION RULES ALLOW A ONE-TIME PENALTY TO BE CHARGED ON DELINQUENT BILLS. A LATE CHARGE MAY NOT BE APPLIED TO ANY BALANCE TO WHICH THE PENALTY WAS APPLIED IN A PREVIOUS BILLING.

RETURNED CHECK CHARGE\$25.00

RETURNED CHECK CHARGES MUST BE BASED ON THE UTILITY'S DOCUMENTABLE COST.

CUSTOMER DEPOSIT RESIDENTIAL (Maximum \$50)\$50.00

COMMERCIAL & NON-RESIDENTIAL DEPOSIT 1/6TH OF ESTIMATED ANNUAL BILL

GOVERNMENTAL TESTING, INSPECTION AND COSTS SURCHARGE

WHEN AUTHORIZED IN WRITING BY THE COMMISSION AND AFTER NOTICE TO CUSTOMERS, THE UTILITY MAY INCREASE RATES TO RECOVER INCREASED COSTS FOR INSPECTION FEES AND WATER TESTING. [16 TAC § 24.21(b)(2)(F)]

LINE EXTENSION AND CONSTRUCTION CHARGES:

REFER TO SECTION 3.0--EXTENSION POLICY FOR TERMS, CONDITIONS, AND CHARGES WHEN NEW CONSTRUCTION IS NECESSARY TO PROVIDE SERVICE.

SECTION 2.0 -- SERVICE RULES AND POLICIES

The utility will have the most current Public Utility Commission of Texas (Commission or PUC) Rules relating to sewer utilities available at its office for reference purposes. The Rules and this tariff shall be available for public inspection and reproduction at a reasonable cost. The latest Rules or Commission approved changes to the Rules supersede any rules or requirements in this tariff.

Section 2.01 - Application for Sewer Service

All applications for service will be made on the utility's standard application or contract form (attached in the Appendix to this tariff), will be signed by the applicant, any required fees (deposits, reconnect, tap, extension fees, etc. as applicable) will be paid and easements, if required, will be granted before service is provided by the utility. A separate application or contract will be made for each service location.

Section 2.02 - Refusal of Service

The utility may decline to serve an applicant until the applicant has complied with the regulations of the regulatory agencies (state and municipal regulations) and for the reasons outlined in the commission rules. In the event that the utility refuses to serve an applicant, the utility will inform the applicant in writing of the basis of its refusal. The utility is also required to inform the applicant that a complaint may be filed with the Commission.

Section 2.03 - Fees and Charges & Easements Required Before Service Can Be Connected

(A) Customer Deposits

If a residential applicant cannot establish credit to the satisfaction of the utility, the applicant may be required to pay a deposit as provided for in Section 1.02 - Miscellaneous Fees of this tariff. The utility will keep records of the deposit and credit interest in accordance with the commission rules.

Residential applicants 65 years of age or older may not be required to pay deposits unless the applicant has an outstanding account balance with the utility or another water or sewer utility which accrued within the last two years.

Nonresidential applicants who cannot establish credit to the satisfaction of the utility may be required to make a deposit that does not exceed an amount equivalent to one-sixth of the estimated annual billings.

Refund of deposit. If service is not connected, or after disconnection of service, the utility will promptly refund the customer's deposit plus accrued interest or the balance, if any, in excess of the unpaid bills for service furnished. The utility may refund the residential customer's deposit at any time prior to termination of utility service but must refund the deposit plus interest for any residential customer who has paid 18 consecutive billings without being delinquent.

SECTION 2.0 -- SERVICE RULES AND POLICIES (Continued)

(B) Tap or Reconnect Fees

A new customer requesting service at a location where service has not previously been provided must pay a tap fee as provided in Section 1. A customer requesting service where service has previously been provided must pay a reconnect fee as provided in Section 1. Any applicant or existing customer required to pay for any costs not specifically set forth in the rate schedule pages of this tariff shall be given a written explanation of such costs prior to request for payment and/or commencement of construction. If the applicant or existing customer does not believe that these costs are reasonable or necessary, the applicant or existing customer shall be informed of their right to appeal such costs to the commission or such other regulatory authority having jurisdiction over the utility's rates in that portion of the utility's service area in which the applicant's or existing customer's property (ies) is located.

Fees in addition to the regular tap fee may be charged to cover unique costs not normally incurred as permitted by 16 TAC § 24.163(b)(1)(C) if they are listed on this approved tariff. For example, a road bore for customers outside a subdivision or residential area could be considered a unique cost.

(C) Easement Requirement

Where recorded public utility easements on the service applicant's property do not exist or public road right-of-way easements are not available to access the applicant's property, the utility may require the applicant to provide it with a permanent recorded public utility easement on and across the applicant's real property sufficient to provide service to that applicant. Such easement(s) shall not be used for the construction of production, storage, transmission or pressure facilities unless they are needed for adequate service to that applicant.

Section 2.04 - Utility Response to Applications for Service

After the applicant has met all the requirements, conditions and regulations for service, the utility will install tap and utility cut-off and/or take all necessary actions to initiate service. The utility will serve each qualified applicant for service within 5 working days unless line extensions or new facilities are required. If construction is required to fill the order and if it cannot be completed within 30 days, the utility will provide the applicant with a written explanation of the construction required and an expected date of service.

Except for good cause where service has previously been provided, service will be reconnected within one working day after the applicant has met the requirements for reconnection.

Section 2.05 - Customer Responsibility

The customer will be responsible for furnishing and laying the necessary customer service pipe from the tap location to the place of consumption. Customers will not be allowed to use the utility's cutoff.

SECTION 2.0 -- SERVICE RULES AND POLICIES (Continued)

Section 2.06 Access to Customer's Premises

All customers or service applicants shall provide access to utility cutoffs at all times reasonably necessary to conduct ordinary utility business and after normal business hours as needed to protect and preserve the integrity of the public drinking water supply.

Section 2.07 - Back Flow Prevention Devices

No water connection shall be made to any establishment where an actual or potential contamination or system hazard exists without an approved air gap or mechanical backflow prevention assembly. The air gap or backflow prevention assembly shall be installed in accordance with the American Water Works Association (AWWA) standards C510, C511 and AWWA Manual M14 or the University of Southern California Manual Of Cross-Connection Control, current edition. The backflow assembly installation by a licensed plumber shall occur at the customer's expense.

The backflow assembly shall be tested upon installation by a recognized prevention assembly tester and certified to be operating within specifications. Back flow prevention assemblies which are installed to provide protection against high health hazards must be tested and certified to be operating within specifications at least annually by a recognized back flow prevention device tester. The maintenance and testing of the backflow assembly shall occur at the customer's expense.

Section 2.10 - Billing

(A) Regular Billing

Bills from the utility will be mailed monthly unless otherwise authorized by the Commission. The due date of bills for utility service will be at least sixteen (16) days from the date of issuance. The postmark on the bill or, if there is no postmark on the bill, the recorded date of mailing by the utility will constitute proof of the date of issuance. Payment for utility service is delinquent if full payment, including late fees and the regulatory assessment, is not received at the utility or the utility's authorized payment agency by 5:00 p.m. on the due date. If the due date falls on a holiday or weekend, the due date for payment purposes will be the next workday after the due date.

(B) Late Fees

A late penalty of either \$5.00 or 10.0% will be charged on bills received after the due date. The penalty on delinquent bills will not be applied to any balance to which the penalty was applied in a previous billing. The utility must maintain a record of the date of mailing to charge the late penalty.

(C) Information on Bill

Each bill will provide all information required by the commission rules. For each of the systems it operates, the utility will maintain and note on the monthly bill a local or toll-free telephone number (or numbers) to which customers can direct questions about their utility service.

SECTION 2.0 -- SERVICE RULES AND POLICIES (Continued)

(D) Prorated Bills

If service is interrupted or seriously impaired for 24 consecutive hours or more, the utility will prorate the monthly base bill in proportion to the time service was not available to reflect this loss of service.

Section 2.11- Payments

All payments for utility service shall be delivered or mailed to the utility's business office. If the business office fails to receive payment prior to the time of noticed disconnection for non-payment of a delinquent account, service will be terminated as scheduled. Utility service crews shall not be allowed to collect payments on customer accounts in the field.

Payment of an account by any means that has been dishonored and returned by the payor or payee's bank shall be deemed to be delinquent. All returned payments must be redeemed with cash or valid money order. If a customer has two returned payments within a twelve-month period, the customer shall be required to pay a deposit if one has not already been paid.

Section 2.12 - Service Disconnection

(A) With Notice

Utility service may be disconnected if the bill has not been paid in full by the date listed on the termination notice. The termination date must be at least 10 days after the notice is mailed or hand delivered.

The utility is encouraged to offer a deferred payment plan to a customer who cannot pay an outstanding bill in full and is willing to pay the balance in reasonable installments. However, a customer's utility service may be disconnected if a bill has not been paid or a deferred payment agreement entered into within 26 days from the date of issuance of a bill and if proper notice of termination has been given.

Notice of termination must be a separate mailing or hand delivery in accordance with the commission rules.

(B) Without Notice

Utility service may also be disconnected without notice for reasons as described in the commission rules.

Section 2.13 - Reconnection of Service

Utility personnel must be available during normal business hours to accept payments on the day service is disconnected and the following day unless service was disconnected at the customer's request or due to a hazardous condition.

SECTION 2.0 -- SERVICE RULES AND POLICIES (Continued)

Service will be reconnected within 24 hours after the past due bill, reconnect fees and any other outstanding charges are paid or the conditions which caused service to be disconnected are corrected.

Section 2.14 - Service Interruptions

The utility will make all reasonable efforts to prevent interruptions of service. If interruptions occur, the utility will re-establish service within the shortest possible time. Except for momentary interruptions due to automatic equipment operations, the utility will keep a complete record of all interruptions, both emergency and scheduled and will notify the Commission in writing of any service interruptions affecting the entire system or any major division of the system lasting more than four hours. The notice will explain the cause of the interruptions.

Section 2.15 - Quality of Service

The utility will plan, furnish, and maintain and operate production, treatment, storage, transmission, and collection facilities of sufficient size and capacity to provide continuous and adequate service for all reasonable consumer uses and to treat sewage and discharge effluent of the quality required by its discharge permit issued by the TCEQ. Unless otherwise authorized by the PUC, the utility will maintain facilities as described in the TCEQ's rules.

Section 2.16 - Customer Complaints and Disputes

If a customer or applicant for service lodges a complaint, the utility will promptly make a suitable investigation and advise the complainant of the results. Service will not be disconnected pending completion of the investigation. If the complainant is dissatisfied with the utility's response, the utility must advise the complainant that he has recourse through the commission's complaint process. Pending resolution of a complaint, the commission may require continuation or restoration of service.

The utility will maintain a record of all complaints which shows the name and address of the complainant, the date and nature of the complaint and the adjustment or disposition thereof, for a period of two years after the final settlement of the complaint.

In the event of a dispute between a customer and a utility regarding any bill for utility service, the utility will conduct an investigation and report the results to the customer. If the dispute is not resolved, the utility will inform the customer that a complaint may be filed with the Commission.

Section 2.17 - Customer Liability

Customer shall be liable for any damage or injury to utility-owned property shown to be caused by the customer.

SECTION 3.0 -- EXTENSION POLICY

Section 3.01 - Standard Extension Requirements

Line Extension and Construction Charges: No Contributions in Aid of Construction may be required of any customer except as provided for in the approved extension policy.

The utility is not required to extend service to any applicant outside of its certified service area and will only do so under terms and conditions mutually agreeable to the utility and the applicant, in compliance with commission rules and policies, and upon extension of the utility's certified service area boundaries by the commission.

The applicant for service will be given an itemized statement of the costs, options such as rebates to the customer, sharing of construction costs between the utility and the customer, or sharing of costs between the customer and other applicants prior to beginning construction.

Section 3.02 - Costs Utilities and Service Applicants Shall Bear

Within its certified area, the utility will pay the cost of the first 200 feet of any water main or distribution line necessary to extend service to an individual residential customer within a platted subdivision.

However, if the residential customer requesting service purchased the property after the developer was notified in writing of the need to provide facilities to the utility, the utility may charge for the first 200 feet. The utility must also be able to document that the developer of the subdivision refused to provide facilities compatible with the utility's facilities in accordance with the utility's approved extension policy after receiving a written request from the utility.

Residential customers will be charged the equivalent of the costs of extending service to their property from the nearest collection line even if that line does not have adequate capacity to serve the customer. However, if the customer places unique, non-standard service demands upon the system, the customer may be charged the additional cost of extending service to and throughout their property, including the cost of all necessary transmission and storage facilities necessary to meet the service demands anticipated to be created by that property.

Unless an exception is granted by the PUC, the residential service applicant shall not be required to pay for costs of main extensions greater than 6" in diameter for gravity wastewater lines.

Exceptions may be granted by the PUC if

- adequate service cannot be provided to the applicant using the maximum line sizes listed due to distance or elevation, in which case, it shall be the utility's burden to justify that a larger diameter pipe is required for adequate service;
- or larger minimum line sizes are required under subdivision platting requirements or building codes of municipalities within whose corporate limits or extraterritorial jurisdiction the point of use is located; or the residential service applicant is located outside the CCN service area.

SECTION 3.0 -- EXTENSION POLICY (Continued)

If an exception is granted, the utility shall establish a proportional cost plan for the specific extension or a rebate plan which may be limited to seven years to return the portion of the applicant's costs for oversizing as new customers are added to ensure that future applicants for service on the line pay at least as much as the initial service applicant.

For purposes of determining the costs that service applicants shall pay, commercial customers with service demands greater than residential customer demands in the certified area, industrial, and wholesale customers shall be treated as developers.

If an applicant requires service other than the standard service provided by the utility, such applicant will be required to pay all expenses incurred by the utility in excess of the expenses that would be incurred in providing the standard service and connection beyond 200 feet and throughout his property including the cost of all necessary transmission facilities.

The utility will bear the full cost of any over-sizing of sewer mains necessary to serve other customers in the immediate area. The individual residential customer shall not be charged for any additional treatment facilities. Contributions in aid of construction of individual residential customers for production, storage, treatment or transmission facilities unless otherwise approved by the Commission under this specific extension policy.

Section 3.03 - Contributions in Aid of Construction

Developers may be required to provide contributions in aid of construction in amounts sufficient to furnish the development with all facilities necessary to provide for reasonable local demand requirements and to comply with Texas Commission on Environmental Quality (TCEQ) minimum design criteria for facilities used in the production, collection, transmission, pumping, or treatment of sewage or TCEQ minimum requirements. For purposes of this subsection, a developer is one who subdivides or requests more than two meters on a piece of property. Commercial, industrial, and wholesale customers will be treated as developers.

Any applicant who places unique or non-standard service demands on the system may be required to provide contributions in aid of construction for the actual costs of any additional facilities required to maintain compliance with the TCEQ minimum design criteria for water production, treatment, pumping, storage and transmission.

Any service extension to a subdivision (recorded or unrecorded) may be subject to the provisions and restrictions of 16 TAC § 24.163(d). When a developer wishes to extend the system to prepare to service multiple new connections, the charge shall be the cost of such extension, plus a pro-rata charge for facilities which must be committed to such extension compliant with the TCEQ minimum design criteria. As provided by 16 TAC § 24.163(d)(4), for purposes of this section, commercial, industrial, and wholesale customers shall be treated as developers.

SECTION 3.0 -- EXTENSION POLICY (Continued)

A utility may only charge a developer standby fees for unrecovered costs of facilities committed to a developer's property under the following circumstances:

- Under a contract and only in accordance with the terms of the contract; or
- if service is not being provided to a lot or lots within two years after installation of facilities necessary to provide service to the lots has been completed and if the standby fees are included on the utilities approved tariff after a rate change application has been filed. The fees cannot be billed to the developer or collected until the standby fees have been approved by the commission or executive director.
- For purposes of this section, a manufactured housing rental community can only be charged standby fees under a contract or if the utility installs the facilities necessary to provide individually metered service to each of the rental lots or spaces in the community.

Section 3.04 - Appealing Connection Costs

The imposition of additional extension costs or charges as provided by Sections 3.0 - Extension Policy of this tariff shall be subject to appeal as provided in this tariff, commission rules, or the rules of such other regulatory authority as may have jurisdiction over the utility's rates and services. Any applicant required to pay for any costs not specifically set forth in the rate schedule pages of this tariff shall be given a written explanation of such costs prior to payment and/or commencement of construction. If the applicant does not believe that these costs are reasonable or necessary, the applicant shall be informed of the right to appeal such costs to the commission or such other regulatory authority having jurisdiction over the utility's rates in that portion of the utility's service area in which the applicant's property(ies) is located.

Section 3.05 - Applying for Service

The utility will provide a written service application form to the applicant for each request for service received by the utility's business offices. A separate application shall be required for each potential service location if more than one service connection is desired by any individual applicant. Service application forms will be available at the utility's business office during normal weekday business hours. Service applications will be sent by prepaid first class United States mail to the address provided by the applicant upon request. Completed applications should be returned by hand delivery in case there are questions which might delay fulfilling the service request. Completed service applications may be submitted by mail if hand delivery is not possible.

Where a new tap or service connection is required, the service applicant shall be required to submit a written service application and request that a tap be made. A diagram, map, plat, or written metes and bounds description of precisely where the applicant desires each tap or service connection is to be made and, if necessary, where the meter is to be installed, along the applicant's property line may also be required with the tap request. The actual point of connection and meter installation must be readily accessible to utility personnel for inspection, servicing, and meter reading while being reasonably secure from damage by vehicles and mowers.

SECTION 3.0 -- EXTENSION POLICY (Continued)

If the utility has more than one main adjacent to the service applicant's property, the tap or service connection will be made to the utility's nearest service main with adequate capacity to service the applicant's full potential service demand. Beyond the initial 200 feet, the customer shall bear only the equivalent cost of extending from the nearest main. If the tap or service connection cannot be made at the applicant's desired location, it will be made at another location mutually acceptable to the applicant and the utility. If no agreement on location can be made, the applicant may refer the matter to the commission for resolution.

Section 3.06 - Qualified Service Applicant

A "qualified service applicant" is an applicant who has: (1) met all of the utility's requirements for service contained in this tariff, commission rules and/or order, (2) has made payment or made arrangement for payment of tap fees, (3) has provided all easements and rights-of-way required to provide service to the requested location, (4) delivered an executed customer service inspection certificate to the Utility, if applicable, and (5) has executed a customer service application for each location to which service is being requested.

The utility shall serve each qualified service applicant within its certified service area as soon as practical after receiving a completed service application. All service requests will be fulfilled within the time limits prescribed by commission rules once the applicant has met all conditions precedent to achieving "qualified service applicant" status. If a service request cannot be fulfilled within the required period, the applicant shall be notified in writing of the delay, its cause and the anticipated date that service will be available. The commission service dates shall not become applicable until the service applicant has met all conditions precedent to becoming a qualified service applicant as defined by commission rules.

Section 3.07 - Developer Requirements

As a condition of service to a new subdivision, the utility shall require a developer (as defined by PUC rule) to provide permanent recorded public utility easements as a condition of service to any location within the developer's property.

APPENDIX A
Chapter 290.47(b) Sample Service Agreement
SERVICE AGREEMENT

- I. **PURPOSE.** The NAME OF SEWER SYSTEM is responsible for protecting the drinking water supply from contamination or pollution which could result from improper private water distribution system construction or configuration. The purpose of this service agreement is to notify each customer of the restrictions which are in place to provide this protection. The utility enforces these restrictions to ensure the public health and welfare. Each customer must sign this agreement before the NAME OF SEWER SYSTEM will begin service. In addition, when service to an existing connection has been suspended or terminated, the water system will not re-establish service unless it has a signed copy of this agreement.
- II. **RESTRICTIONS.** The following unacceptable practices are prohibited by State regulations.
- A. No direct connection between the public drinking water supply and a potential source of contamination is permitted. Potential sources of contamination shall be isolated from the public water system by an air-gap or an appropriate backflow prevention device.
 - B. No cross-connection between the public drinking water supply and a private water system is permitted. These potential threats to the public drinking water supply shall be eliminated at the service connection by the installation of an air-gap or a reduced pressure-zone backflow prevention device.
 - C. No connection which allows water to be returned to the public drinking water supply is permitted.
 - D. No pipe or pipe fitting which contains more than 8.0% lead may be used for the installation or repair of plumbing at any connection which provides water for human use.
 - E. No solder or flux which contains more than 0.2% lead can be used for the installation or repair of plumbing at any connection which provides water for human use.
- III. **SERVICE AGREEMENT.** The following are the terms of the service agreement between the NAME OF WATER SYSTEM (the Water System) and NAME OF CUSTOMER (the Customer).
- A. The Water System will maintain a copy of this agreement as long as the Customer and/or the premises is connected to the Water System.
 - B. The Customer shall allow his property to be inspected for possible cross-connections and other potential contamination hazards. These inspections shall be conducted by the Water System or its designated agent prior to initiating new water service; when there is reason to believe that cross-connections or other potential contamination hazards exist; or after any major changes to the private water distribution facilities. The inspections shall be conducted during the Water System's normal business hours.
 - C. The Water System shall notify the Customer in writing of any cross-connection or other potential contamination hazard which has been identified during the initial inspection or the periodic re-inspection.
 - D. The Customer shall immediately remove or adequately isolate any potential cross-connections or other potential contamination hazards on his premises.
 - E. The Customer shall, at his expense, properly install, test, and maintain any backflow prevention device required by the Water System. Copies of all testing and maintenance records shall be provided to the Water System.

IV. ENFORCEMENT

If the Customer fails to comply with the terms of the Service Agreement, the Water System shall, at its option, either terminate service or properly install, test, and maintain an appropriate backflow prevention device at the service connection. Any expenses associated with the enforcement of this agreement shall be billed to the Customer.

CUSTOMER'S

SIGNATURE: _____

DATE: _____



WATER UTILITY TARIFF

Docket Number: 49740

C & R Water Supply Inc.
(Utility Name)

P. O. Box 187
(Business Address)

Willis, Texas 77378
(City, State, Zip Code)

(936) 856-4199
(Area Code/Telephone)

This tariff is effective for utility operations under the following Certificate of Convenience and Necessity:

13098

This tariff is effective in the following county:

Grimes, Leon, Liberty, Madison, Montgomery, and San Jacinto

This tariff is effective in the following cities or unincorporated towns (if any):

Town of Cut and Shoot

The rates set or approved by the city for the systems entirely within its corporate boundary are not presented in this tariff. Those rates are not under the original jurisdiction of the PUC and will have to be obtained from the city or utility.

This tariff is effective in the following subdivisions or systems:

See attached list.

TABLE OF CONTENTS

The above utility lists the following sections of its tariff (if additional pages are needed for a section, all pages should be numbered consecutively):

SECTION 1.0 -- RATE SCHEDULE.....	2
SECTION 2.0 -- SERVICE RULES AND POLICIES	7
SECTION 3.0 -- EXTENSION POLICY	13
SECTION 4.0 -- DROUGHT CONTINGENCY PLAN	17

APPENDIX A -- SAMPLE SERVICE AGREEMENT

APPENDIX B -- APPLICATION FOR SERVICE

LIST OF SUBDIVISIONS OR SYSTEMS

SUBDIVISION	PWS ID NUMBER	COUNTY
Bee Creek Estates	1700685	Montgomery
Bridgepoint Subdivision	1700316	Montgomery
Clear Water Cove Inc. Clearwater Point Falcon Sound Hard Times Boating Club Playa Vista Shiloh Marina	1700480	Montgomery
Creekside Acres Water System	1700680	Montgomery
Emerson Estates Crockett Trace Kellyon Oaks The Villages	1700683	Montgomery
Five Oaks Estates	1460159	Liberty
HWY 59 Estates	1460160	Liberty
Mt. Pleasant Village Water System	1700423	Montgomery
River Oaks Sunshine Acres	1450017	Leon, Madison
Rogers Road Water System Oak Hills Subdivision The Oaks of Willis	1700590	Montgomery
Shannon Estates Water System	0930052	Grimes, Madison
Timberline Estates	1700728	Montgomery
Timber Oaks Crossing	1700697	Montgomery
Trails End	2040066	San Jacinto

**Bee Creek Estates, Creekside Acres Water System,
Oak Hills Subdivision, Rogers Road Water System,
The Oaks of Willis, Timber Oaks Crossing, Timberline Estates**

SECTION 1.0 -- RATE SCHEDULE

Section 1.01 – Rates

<u>Meter Size</u>	<u>Monthly Minimum Charge</u>	<u>Gallonage Charge</u>
5/8" or 3/4"	<u>\$46.29</u> (Includes 0 gallons)	<u>\$2.00</u> per 1000 gallons
1"	<u>\$115.72</u>	Plus
1½"	<u>\$231.45</u>	<u>*\$0.07</u> per 1000 gallons for LSGCD
2"	<u>\$370.32</u>	<u>**\$2.73</u> per 1000 gallons for SJRA
3"	<u>\$694.35</u>	<u>***\$2.47</u> per 1000 gallons for SJRA
4"	<u>\$925.80</u>	
6"	<u>\$1,018.38</u>	

Pass Through Fees, In addition to the gallonage charge:

*Lone Star Groundwater Conservation District (LSGCD) Fee: \$0.07 per 1,000 gallons of water used for systems and ratepayers under this LSGCD, adjusted for water loss.

San Jacinto River Authority (SJRA) Groundwater Reduction Plan (GRP) fee: \$2.73 per 1,000 gallons of water used, which is \$2.32 adjusted for 15% water loss, will be charged to all ratepayers for **Rogers Road Water System (PWS 1700590) and **Timberline Estates** (PWS 1700728). **(Docket 44965)**

***San Jacinto River Authority (SJRA) Groundwater Reduction Plan (GRP) fee: \$2.47 per 1,000 gallons of water used, which is \$2.32 adjusted for 15% water loss, will be charged to all ratepayers for **Creekside Acres Water System** (PWS 1700680). **(Docket 45582)**

FORM OF PAYMENT: The utility will accept the following forms of payment:

Cash X , Check X , Money Order X , Credit Card _____, Other (specify) _____

THE UTILITY MAY REQUIRE EXACT CHANGE FOR PAYMENTS AND MAY REFUSE TO ACCEPT PAYMENTS MADE USING MORE THAN \$1.00 IN SMALL COINS. A WRITTEN RECEIPT WILL BE GIVEN FOR CASH PAYMENTS.

REGULATORY ASSESSMENT..... 1.0%

PUC RULES REQUIRE THE UTILITY TO COLLECT A FEE OF ONE PERCENT OF THE RETAIL MONTHLY BILL AND TO REMIT FEE TO THE TCEQ.

Section 1.02 - Miscellaneous Fees

TAP FEE.....\$500.00

TAP FEE COVERS THE UTILITY'S COSTS FOR MATERIALS AND LABOR TO INSTALL A STANDARD RESIDENTIAL 5/8" or 3/4" METER. AN ADDITIONAL FEE TO COVER UNIQUE COSTS IS PERMITTED IF LISTED ON THIS TARIFF.

METER TEST FEE\$25.00

THIS FEE WHICH SHOULD REFLECT THE UTILITY'S COST MAY BE CHARGED IF A CUSTOMER REQUESTS A SECOND METER TEST WITHIN A TWO-YEAR PERIOD AND THE TEST INDICATES THAT THE METER IS RECORDING ACCURATELY. THE FEE MAY NOT EXCEED \$25.

**Bee Creek Estates, Creekside Acres Water System,
Oak Hills Subdivision, Rogers Road Water System,
The Oaks of Willis, Timber Oaks Crossing, Timberline Estates**

SECTION 1.0 -- RATE SCHEDULE (Continued)

RECONNECTION FEE

THE RECONNECT FEE MUST BE PAID BEFORE SERVICE CAN BE RESTORED TO A CUSTOMER WHO HAS BEEN DISCONNECTED FOR THE FOLLOWING REASONS (OR OTHER REASONS LISTED UNDER SECTION 2.0 OF THIS TARIFF):

- a) Nonpayment of bill (Maximum \$25.00).....\$25.00
- b) Customer's request that service be disconnected.....\$50.00

TRANSFER FEE.....\$35.00

THE TRANSFER FEE WILL BE CHARGED FOR CHANGING AN ACCOUNT NAME AT THE SAME SERVICE LOCATION WHEN THE SERVICE IS NOT DISCONNECTED

LATE CHARGE (EITHER \$5.00 OR 10% OF THE BILL)\$5.00

PUC RULES ALLOW A ONE-TIME PENALTY TO BE CHARGED ON DELINQUENT BILLS. A LATE CHARGE MAY NOT BE APPLIED TO ANY BALANCE TO WHICH THE PENALTY WAS APPLIED IN A PREVIOUS BILLING. SERVICE LOCATION WHEN THE SERVICE IS NOT DISCONNECTED

RETURNED CHECK CHARGE (Maximum).....\$30.00

RETURNED CHECK CHARGES MUST BE BASED ON THE UTILITY'S DOCUMENTABLE COST.

CUSTOMER DEPOSIT RESIDENTIAL (Maximum \$50).....\$50.00

LINE EXTENSION AND CONSTRUCTION CHARGES:

REFER TO SECTION 3.0--EXTENSION POLICY FOR TERMS, CONDITIONS, AND CHARGES WHEN NEW CONSTRUCTION IS NECESSARY TO PROVIDE SERVICE.

PASS THROUGH ADJUSTMENT CLAUSE:

The utility's cost attributable to annual fee, pumpage fee and/or consumption-based fee from the Lone Star Ground Water Conservation District Authority and/or other such governmental authority shall be passed through to all customers affected by such fees using the following calculations:

Adjusted Gallonage Rate (AG) = $G + [B / (1 - L)]$, Where:

AG = adjusted gallonage charge, rounded to nearest one cent;

G = approved gallonage charge, per 1,000 gallons;

B = change in fee (per 1,000 gallons);

L = water or sewer line loss for preceding 12 months, not to exceed 0.15 (15%)

To implement or modify the Pass-Through Adjustment Clause, the utility must comply with all notice requirements of 16 TAC § 24.25(b)(2)(F).

Bridgepoint Subdivision, Clear Water Cove Inc.,**Clearwater Point, Falcon Sound, Hard Times Boating Club, Playa Vista, Shiloh Marina****SECTION 1.0 -- RATE SCHEDULE****Section 1.01 – Rates**

<u>Meter Size</u>	<u>Monthly Minimum Charge</u>	<u>Gallonge Charge</u>
5/8" or 3/4"	<u>\$33.89</u> (Includes 0 gallons)	<u>\$2.00</u> per 1000 gallons
1"	<u>\$84.73</u>	Plus
1½"	<u>\$169.45</u>	<u>*\$0.07</u> per 1000 gallons for LSGCD
2"	<u>\$271.12</u>	<u>**\$2.73</u> per 1000 gallons for SJRA
3"	<u>\$508.35</u>	
4"	<u>\$847.25</u>	
6"	<u>\$1,694.50</u>	

Pass Through Fees, In addition to the gallonage charge:

*Lone Star Groundwater Conservation District (LSGCD) Fee: \$0.07 per 1,000 gallons of water used for systems and ratepayers under the LSGCD, as adjusted for water loss.

San Jacinto River Authority (SJRA) Groundwater Reduction Plan (GRP) fee: \$2.73 per 1,000 gallons of water used, which is \$2.32 adjusted for 15% water loss, will be charged to all ratepayers for **Bridgepoint Subdivision (PWS 1700316) and **Clear Water Cove Inc.** (PWS 1700480). (**Docket No. 44965**)

FORM OF PAYMENT: The utility will accept the following forms of payment:

Cash X, Check X, Money Order X, Credit Card _____, Other (specify) _____

THE UTILITY MAY REQUIRE EXACT CHANGE FOR PAYMENTS AND MAY REFUSE TO ACCEPT PAYMENTS MADE USING MORE THAN \$1.00 IN SMALL COINS. A WRITTEN RECEIPT WILL BE GIVEN FOR CASH PAYMENTS.

REGULATORY ASSESSMENT 1.0%

PUC RULES REQUIRE THE UTILITY TO COLLECT A FEE OF ONE PERCENT OF THE RETAIL MONTHLY BILL AND TO REMIT THE FEE TO THE TCEQ.

Section 1.02 - Miscellaneous Fees

TAP FEE \$500.00

TAP FEE COVERS THE UTILITY'S COSTS FOR MATERIALS AND LABOR TO INSTALL A STANDARD RESIDENTIAL 5/8" or 3/4" METER. AN ADDITIONAL FEE TO COVER UNIQUE COSTS IS PERMITTED IF LISTED ON THIS TARIFF.

METER TEST FEE \$25.00

THIS FEE WHICH SHOULD REFLECT THE UTILITY'S COST MAY BE CHARGED IF A CUSTOMER REQUESTS A SECOND METER TEST WITHIN A TWO-YEAR PERIOD AND THE TEST INDICATES THAT THE METER IS RECORDING ACCURATELY. THE FEE MAY NOT EXCEED \$25.

Bridgepoint Subdivision, Clear Water Cove Inc.,**Clearwater Point, Falcon Sound, Hard Times Boating Club, Playa Vista, Shiloh Marina****SECTION 1.0 -- RATE SCHEDULE (Continued)****RECONNECTION FEE**

THE RECONNECT FEE MUST BE PAID BEFORE SERVICE CAN BE RESTORED TO A CUSTOMER WHO HAS BEEN DISCONNECTED FOR THE FOLLOWING REASONS (OR OTHER REASONS LISTED UNDER SECTION 2.0 OF THIS TARIFF):

- a) Nonpayment of bill (Maximum \$25.00).....\$25.00
- b) Customer's request that service be disconnected.....\$50.00

TRANSFER FEE.....\$35.00

THE TRANSFER FEE WILL BE CHARGED FOR CHANGING AN ACCOUNT NAME AT THE SAME SERVICE LOCATION WHEN THE SERVICE IS NOT DISCONNECTED

LATE CHARGE (EITHER \$5.00 OR 10% OF THE BILL)\$5.00

PUC RULES ALLOW A ONE-TIME PENALTY TO BE CHARGED ON DELINQUENT BILLS. A LATE CHARGE MAY NOT BE APPLIED TO ANY BALANCE TO WHICH THE PENALTY WAS APPLIED IN A PREVIOUS BILLING. SERVICE LOCATION WHEN THE SERVICE IS NOT DISCONNECTED

RETURNED CHECK CHARGE (Maximum).....\$30.00

RETURNED CHECK CHARGES MUST BE BASED ON THE UTILITY'S DOCUMENTABLE COST.

CUSTOMER DEPOSIT RESIDENTIAL (Maximum \$50).....\$50.00**LINE EXTENSION AND CONSTRUCTION CHARGES:**

REFER TO SECTION 3.0--EXTENSION POLICY FOR TERMS, CONDITIONS, AND CHARGES WHEN NEW CONSTRUCTION IS NECESSARY TO PROVIDE SERVICE.

PASS THROUGH ADJUSTMENT CLAUSE:

The utility's cost attributable to annual fee, pumpage fee and/or consumption-based fee from the Lone Star Ground Water Conservation District Authority and/or other such governmental authority shall be passed through to all customers affected by such fees using the following calculations:

Adjusted Gallonage Rate (AG) = $G + [B / (1 - L)]$, Where:

AG = adjusted gallonage charge, rounded to nearest one cent;

G = approved gallonage charge, per 1,000 gallons;

B = change in fee (per 1,000 gallons);

L = water or sewer line loss for preceding 12 months, not to exceed 0.15 (15%)

To implement or modify the Pass-Through Adjustment Clause, the utility must comply with all notice requirements of 16 TAC § 24.25(b)(2)(F).

SECTION 1.0 -- RATE SCHEDULE

Section 1.01 – Rates

<u>Meter Size</u>	<u>Monthly Minimum Charge</u>	<u>Gallonge Charge</u>
5/8" or 3/4"	<u>\$39.09</u> (Includes 0 gallons)	<u>\$2.00</u> per 1000 gallons for all usage
1"	<u>\$97.73</u>	Plus
1½"	<u>\$195.45</u>	<u>*\$0.07</u> per 1000 gallons for LSGCD
2"	<u>\$312.72</u>	<u>**\$2.73</u> per 1000 gallons for SJRA
3"	<u>\$586.35</u>	
4"	<u>\$781.80</u>	

Pass Through Fees, In addition to the gallonage charge:

*Lone Star Groundwater Conservation District (LSGCD) Fee: \$0.07 per 1,000 gallons of water used for systems under this LSGCD, adjusted for water loss.

San Jacinto River Authority (SJRA) Groundwater Reduction Plan (GRP) fee: \$2.73 per 1,000 gallons of water used, which is \$2.32 adjusted for 15% water loss, will be charged to all ratepayers for **Emerson Estates (PWS 1700683). **(Docket No. 44965)**

FORM OF PAYMENT: The utility will accept the following forms of payment:

Cash X, Check X, Money Order X, Credit Card _____, Other (specify) _____

THE UTILITY MAY REQUIRE EXACT CHANGE FOR PAYMENTS AND MAY REFUSE TO ACCEPT PAYMENTS MADE USING MORE THAN \$1.00 IN SMALL COINS. A WRITTEN RECEIPT WILL BE GIVEN FOR CASH PAYMENTS.

REGULATORY ASSESSMENT.....1.0%

PUC RULES REQUIRE THE UTILITY TO COLLECT A FEE OF ONE PERCENT OF THE RETAIL MONTHLY BILL AND TO REMIT THE FEE TO THE TCEQ.

Section 1.02 - Miscellaneous Fees

TAP FEE.....\$500.00

TAP FEE COVERS THE UTILITY'S COSTS FOR MATERIALS AND LABOR TO INSTALL A STANDARD RESIDENTIAL 5/8" or 3/4" METER. AN ADDITIONAL FEE TO COVER UNIQUE COSTS IS PERMITTED IF LISTED ON THIS TARIFF.

METER TEST FEE\$25.00

THIS FEE WHICH SHOULD REFLECT THE UTILITY'S COST MAY BE CHARGED IF A CUSTOMER REQUESTS A SECOND METER TEST WITHIN A TWO-YEAR PERIOD AND THE TEST INDICATES THAT THE METER IS RECORDING ACCURATELY. THE FEE MAY NOT EXCEED \$25.

SECTION 1.0 -- RATE SCHEDULE (Continued)

RECONNECTION FEE

THE RECONNECT FEE MUST BE PAID BEFORE SERVICE CAN BE RESTORED TO A CUSTOMER WHO HAS BEEN DISCONNECTED FOR THE FOLLOWING REASONS (OR OTHER REASONS LISTED UNDER SECTION 2.0 OF THIS TARIFF):

- a) Nonpayment of bill (Maximum \$25.00).....\$25.00
- b) Customer's request that service be disconnected.....\$50.00

TRANSFER FEE.....\$35.00

THE TRANSFER FEE WILL BE CHARGED FOR CHANGING AN ACCOUNT NAME AT THE SAME SERVICE LOCATION WHEN THE SERVICE IS NOT DISCONNECTED

LATE CHARGE (EITHER \$5.00 OR 10% OF THE BILL)\$5.00

PUC RULES ALLOW A ONE-TIME PENALTY TO BE CHARGED ON DELINQUENT BILLS. A LATE CHARGE MAY NOT BE APPLIED TO ANY BALANCE TO WHICH THE PENALTY WAS APPLIED IN A PREVIOUS BILLING. SERVICE LOCATION WHEN THE SERVICE IS NOT DISCONNECTED

RETURNED CHECK CHARGE (Maximum).....\$30.00

RETURNED CHECK CHARGES MUST BE BASED ON THE UTILITY'S DOCUMENTABLE COST.

CUSTOMER DEPOSIT RESIDENTIAL (Maximum \$50).....\$50.00

LINE EXTENSION AND CONSTRUCTION CHARGES:

REFER TO SECTION 3.0--EXTENSION POLICY FOR TERMS, CONDITIONS, AND CHARGES WHEN NEW CONSTRUCTION IS NECESSARY TO PROVIDE SERVICE.

PASS THROUGH ADJUSTMENT CLAUSE:

The utility's cost attributable to annual fee, pumpage fee and/or consumption-based fee from the Lone Star Ground Water Conservation District Authority and/or other such governmental authority shall be passed through to all customers affected by such fees using the following calculations:

Adjusted Gallonage Rate (AG) = $G + [B / (1 - L)]$, Where:

AG = adjusted gallonage charge, rounded to nearest one cent;

G = approved gallonage charge, per 1,000 gallons;

B = change in fee (per 1,000 gallons);

L = water or sewer line loss for preceding 12 months, not to exceed 0.15 (15%)

To implement or modify the Pass-Through Adjustment Clause, the utility must comply with all notice requirements of 16 TAC § 24.25(b)(2)(F).

Five Oaks Estates, HWY 59 Estates, River Oaks Sunshine Acres,
Shannon Estates Water System, Trails End

SECTION 1.0 -- RATE SCHEDULE

Section 1.01 – Rates

<u>Meter Size</u>	<u>Monthly Minimum Charge</u>	<u>Gallonage Charge</u>
5/8" or 3/4"	<u>\$46.29</u> (Includes 0 gallons)	<u>\$2.00</u> per 1000 gallons for all meter sizes
1"	<u>\$115.72</u>	Plus
1½"	<u>\$231.45</u>	<u>*\$0.58</u> per 1000 gallons for SJRA
2"	<u>\$370.32</u>	
3"	<u>\$694.35</u>	
4"	<u>\$925.80</u>	
6"	<u>\$1,018.38</u>	

Pass Through Fees:

*In addition to the gallonage charge, the San Jacinto River Authority (SJRA) Groundwater Reduction Plan fee of \$0.58 per 1,000 gallons used will be charged to all ratepayers affected by the SJRA Groundwater Reduction Plan.

FORM OF PAYMENT: The utility will accept the following forms of payment:

Cash X, Check X, Money Order X, Credit Card , Other (specify) Cashier's Check X

THE UTILITY MAY REQUIRE EXACT CHANGE FOR PAYMENTS AND MAY REFUSE TO ACCEPT PAYMENTS MADE USING MORE THAN \$1.00 IN SMALL COINS. A WRITTEN RECEIPT WILL BE GIVEN FOR CASH PAYMENTS.

REGULATORY ASSESSMENT..... 1.0%

PUC RULES REQUIRE THE UTILITY TO COLLECT A FEE OF ONE PERCENT OF THE RETAIL MONTHLY BILL AND TO REMIT FEE TO THE TCEQ.

Section 1.02 - Miscellaneous Fees

TAP FEE..... \$500.00

TAP FEE COVERS THE UTILITY'S COSTS FOR MATERIALS AND LABOR TO INSTALL A STANDARD RESIDENTIAL 5/8" or 3/4" METER. AN ADDITIONAL FEE TO COVER UNIQUE COSTS IS PERMITTED IF LISTED ON THIS TARIFF.

TAP FEE (Large meter)..... Actual Cost

TAP FEE IS THE UTILITY'S ACTUAL COST FOR MATERIALS AND LABOR FOR METER SIZE INSTALLED.

METER RELOCATION FEE (Actual Cost to Relocate Meter Not to Exceed Tap Fee)

THIS FEE MAY BE CHARGED IF A CUSTOMER REQUESTS THAT AN EXISTING METER BE RELOCATED.

METER TEST FEE \$25.00

THIS FEE WHICH SHOULD REFLECT THE UTILITY'S COST MAY BE CHARGED IF A CUSTOMER REQUESTS A SECOND METER TEST WITHIN A TWO-YEAR PERIOD AND THE TEST INDICATES THAT THE METER IS RECORDING ACCURATELY. THE FEE MAY NOT EXCEED \$25.

Five Oaks Estates, HWY 59 Estates, River Oaks Sunshine Acres,
Shannon Estates Water System, Trails End

SECTION 1.0 -- RATE SCHEDULE (Continued)

RECONNECTION FEE

THE RECONNECT FEE MUST BE PAID BEFORE SERVICE CAN BE RESTORED TO A CUSTOMER WHO HAS BEEN DISCONNECTED FOR THE FOLLOWING REASONS (OR OTHER REASONS LISTED UNDER SECTION 2.0 OF THIS TARIFF):

- a) Nonpayment of bill (Maximum \$25.00).....\$25.00
- b) Customer's request that service be disconnected.....\$50.00

RETURNED CHECK CHARGE (Maximum).....\$30.00

RETURNED CHECK CHARGES MUST BE BASED ON THE UTILITY'S DOCUMENTABLE COST.

TRANSFER FEE.....\$35.00

THE TRANSFER FEE WILL BE CHARGED FOR CHANGING AN ACCOUNT NAME AT THE SAME SERVICE LOCATION WHEN THE SERVICE IS NOT DISCONNECTED

LATE CHARGE (EITHER \$5.00 OR 10 % OF THE BILL).....\$5.00

PUC RULES ALLOW A ONE-TIME PENALTY TO BE CHARGED ON DELINQUENT BILLS. A LATE CHARGE MAY NOT BE APPLIED TO ANY BALANCE TO WHICH THE PENALTY WAS APPLIED IN A PREVIOUS BILLING. SERVICE LOCATION WHEN THE SERVICE IS NOT DISCONNECTED

CUSTOMER DEPOSIT RESIDENTIAL (Maximum \$50).....\$50.00

COMMERCIAL & NON-RESIDENTIAL DEPOSIT 1/6TH OF ESTIMATED ANNUAL BILL

GOVERNMENTAL TESTING, INSPECTION AND COSTS SURCHARGE

WHEN AUTHORIZED IN WRITING BY TCEQ AND AFTER NOTICE TO CUSTOMERS, THE UTILITY MAY INCREASE RATES TO RECOVER INCREASED COSTS FOR INSPECTION FEES AND WATER TESTING 16 TAC 24.25(b)(2)(G).

LINE EXTENSION AND CONSTRUCTION CHARGES:

REFER TO SECTION 3.0--EXTENSION POLICY FOR TERMS, CONDITIONS, AND CHARGES WHEN NEW CONSTRUCTION IS NECESSARY TO PROVIDE SERVICE.

PASS THROUGH ADJUSTMENT CLAUSE:

The utility's cost attributable to annual fee, pumpage fee and/or consumption-based fee from the Lone Star Ground Water Conservation District Authority and/or other such governmental authority shall be passed through to all customers affected by such fees using the following calculations:

Adjusted Gallonage Rate (AG) = $G + [B / (1 - L)]$, Where:

AG = adjusted gallonage charge, rounded to nearest one cent;

G = approved gallonage charge, per 1,000 gallons;

B = change in fee (per 1,000 gallons);

L = water or sewer line loss for preceding 12 months, not to exceed 0.15 (15%)

To implement or modify the Pass-Through Adjustment Clause, the utility must comply with all notice requirements of 16 TAC § 24.25(b)(2)(F).

SECTION 1.0 -- RATE SCHEDULE

Section 1.01 – Rates

<u>Meter Size</u>	<u>Monthly Minimum Charge</u>	<u>Gallage Charge</u>
5/8" or 3/4"	<u>\$37.00</u> (Includes 0 gallons)	<u>\$3.50</u> per 1000 gallons, over the minimum

FORM OF PAYMENT: The utility will accept the following forms of payment:

Cash X, Check X, Money Order X, Credit Card _____, Other (specify) _____

THE UTILITY MAY REQUIRE EXACT CHANGE FOR PAYMENTS AND MAY REFUSE TO ACCEPT PAYMENTS MADE USING MORE THAN \$1.00 IN SMALL COINS. A WRITTEN RECEIPT WILL BE GIVEN FOR CASH PAYMENTS.

REGULATORY ASSESSMENT..... 1.0%

PUC RULES REQUIRE THE UTILITY TO COLLECT A FEE OF ONE PERCENT OF THE RETAIL MONTHLY BILL AND TO REMIT FEE TO THE TCEQ.

Section 1.02 - Miscellaneous Fees

TAP FEE.....\$500.00

TAP FEE COVERS THE UTILITY'S COSTS FOR MATERIALS AND LABOR TO INSTALL A STANDARD RESIDENTIAL 5/8" or 3/4" METER. AN ADDITIONAL FEE TO COVER UNIQUE COSTS IS PERMITTED IF LISTED ON THIS TARIFF.

TAP FEE (Large meter).....Actual Cost

TAP FEE IS THE UTILITY'S ACTUAL COST FOR MATERIALS AND LABOR FOR METER SIZE INSTALLED.

METER RELOCATION FEE (Actual Cost to Relocate Meter Not to Exceed Tap Fee)

THIS FEE MAY BE CHARGED IF A CUSTOMER REQUESTS THAT AN EXISTING METER BE RELOCATED.

METER TEST FEE\$25.00

THIS FEE WHICH SHOULD REFLECT THE UTILITY'S COST MAY BE CHARGED IF A CUSTOMER REQUESTS A SECOND METER TEST WITHIN A TWO-YEAR PERIOD AND THE TEST INDICATES THAT THE METER IS RECORDING ACCURATELY. THE FEE MAY NOT EXCEED \$25.

RECONNECTION FEE

THE RECONNECT FEE MUST BE PAID BEFORE SERVICE CAN BE RESTORED TO A CUSTOMER WHO HAS BEEN DISCONNECTED FOR THE FOLLOWING REASONS (OR OTHER REASONS LISTED UNDER SECTION 2.0 OF THIS TARIFF):

a) Nonpayment of bill (Maximum \$25.00).....\$25.00

b) Customer's request that service be disconnected \$45.00

RETURNED CHECK CHARGE (Maximum).....\$25.00

RETURNED CHECK CHARGES MUST BE BASED ON THE UTILITY'S DOCUMENTABLE COST.

SECTION 1.0 -- RATE SCHEDULE (Continued)

TRANSFER FEE.....\$45.00

THE TRANSFER FEE WILL BE CHARGED FOR CHANGING AN ACCOUNT NAME AT THE SAME SERVICE LOCATION WHEN THE SERVICE IS NOT DISCONNECTED

LATE CHARGE (EITHER \$5.00 OR 10 % OF THE BILL).....10%

PUC RULES ALLOW A ONE-TIME PENALTY TO BE CHARGED ON DELINQUENT BILLS. A LATE CHARGE MAY NOT BE APPLIED TO ANY BALANCE TO WHICH THE PENALTY WAS APPLIED IN A PREVIOUS BILLING. SERVICE LOCATION WHEN THE SERVICE IS NOT DISCONNECTED

CUSTOMER DEPOSIT RESIDENTIAL (Maximum \$50).....\$50.00

COMMERCIAL & NON-RESIDENTIAL DEPOSIT 1/6TH OF ESTIMATED ANNUAL BILL

GOVERNMENTAL TESTING, INSPECTION AND COSTS SURCHARGE

WHEN AUTHORIZED IN WRITING BY TCEQ AND AFTER NOTICE TO CUSTOMERS, THE UTILITY MAY INCREASE RATES TO RECOVER INCREASED COSTS FOR INSPECTION FEES AND WATER TESTING 16 TAC 24.25(b)(2)(G).

LINE EXTENSION AND CONSTRUCTION CHARGES:

REFER TO SECTION 3.0--EXTENSION POLICY FOR TERMS, CONDITIONS, AND CHARGES WHEN NEW CONSTRUCTION IS NECESSARY TO PROVIDE SERVICE.

SECTION 2.0 -- SERVICE RULES AND POLICIES

The utility will have the most current Public Utility Commission of Texas (PUC or Commission) Rules, 16 TAC Chapter 24, available at its office for reference purposes. The Rules and this tariff shall be available for public inspection and reproduction at a reasonable cost. The latest Rules or Commission approved changes to the Rules supersede any rules or requirements in this tariff.

Section 2.01 - Application for Water Service

All applications for service will be made on the utility's standard application or contract form (attached in the Appendix to this tariff), will be signed by the applicant, any required fees (deposits, reconnect, tap, extension fees, etc. as applicable) will be paid and easements, if required, will be granted before service is provided by the utility. A separate application or contract will be made for each service location.

Section 2.02 - Refusal of Service

The utility may decline to serve an applicant until the applicant has complied with the regulations of the regulatory agencies (state and municipal regulations) and for the reasons outlined in the PUC Rules. In the event that the utility refuses to serve an applicant, the utility will inform the applicant in writing of the basis of its refusal. The utility is also required to inform the applicant that a complaint may be filed with the Commission.

Section 2.03 - Fees and Charges & Easements Required Before Service Can Be Connected

(A) Customer Deposits

If a residential applicant cannot establish credit to the satisfaction of the utility, the applicant may be required to pay a deposit as provided for in Section 1.02 - Miscellaneous Fees of this tariff. The utility will keep records of the deposit and credit interest in accordance with PUC Rules.

Residential applicants 65 years of age or older may not be required to pay deposits unless the applicant has an outstanding account balance with the utility or another water or sewer utility which accrued within the last two years.

Nonresidential applicants who cannot establish credit to the satisfaction of the utility may be required to make a deposit that does not exceed an amount equivalent to one-sixth of the estimated annual billings.

Refund of deposit. If service is not connected, or after disconnection of service, the utility will promptly refund the customer's deposit plus accrued interest or the balance, if any, in excess of the unpaid bills for service furnished. The utility may refund the deposit at any time prior to termination of utility service but must refund the deposit plus interest for any residential customer who has paid 18 consecutive billings without being delinquent.

(B) Tap or Reconnect Fees

A new customer requesting service at a location where service has not previously been provided must pay a tap fee as provided in Section 1. A customer requesting service where service has previously been provided must pay a reconnect fee as provided in Section 1.

SECTION 2.0 – SERVICE RULES AND POLICIES (Continued)

Any applicant or existing customer required to pay for any costs not specifically set forth in the rate schedule pages of this tariff shall be given a written explanation of such costs prior to request for payment and/or commencement of construction. If the applicant or existing customer does not believe that these costs are reasonable or necessary, the applicant or existing customer shall be informed of their right to appeal such costs to the PUC or such other regulatory authority having jurisdiction over the utility's rates in that portion of the utility's service area in which the applicant's or existing customer's property(ies) is (are) located.

Fees in addition to the regular tap fee may be charged if listed specifically in Section 1 to cover unique costs not normally incurred as permitted by 16 TAC § 24.163(a)(1)(C). For example, a road bore for customers outside a subdivision or residential area could be considered a unique cost.

(C) Easement Requirement

Where recorded public utility easements on the service applicant's property do not exist or public road right-of-way easements are not available to access the applicant's property, the Utility may require the applicant to provide it with a permanent recorded public utility easement on and across the applicant's real property sufficient to provide service to that applicant. Such easement(s) shall not be used for the construction of production, storage, transmission or pressure facilities unless they are needed for adequate service to that applicant.

Section 2.04 - Utility Response to Applications for Service

After the applicant has met all the requirements, conditions and regulations for service, the utility will install tap, meter and utility cut-off valve and/or take all necessary actions to initiate service. The utility will serve each qualified applicant for service within 5 working days unless line extensions or new facilities are required. If construction is required to fill the order and if it cannot be completed within 30 days, the utility will provide the applicant with a written explanation of the construction required and an expected date of service.

Except for good cause where service has previously been provided, service will be reconnected within one working day after the applicant has met the requirements for reconnection.

Section 2.05 - Customer Responsibility

The customer will be responsible for furnishing and laying the necessary customer service pipe from the meter location to the place of consumption. Customers will not be allowed to use the utility's cutoff valve on the utility's side of the meter. Existing customers may install cutoff valves on their side of the meter and are encouraged to do so. All new customers may be required to install and maintain a cutoff valve on their side of the meter

No direct connection between a public water supply system and any potential source of contamination or between a public water supply system and a private water source (ex. private well) will be allowed. A customer shall not connect, or allow any other person or party to connect, onto any water lines on his premises.

SECTION 2.0 – SERVICE RULES AND POLICIES (Continued)

Section 2.06 - Customer Service Inspections

Applicants for new service connections or facilities which have undergone extensive plumbing modifications are required to furnish the utility a completed customer service inspection certificate. The inspection certificate shall certify that the establishment is in compliance with the Texas Commission on Environmental Quality (TCEQ) Rules and Regulations for Public Water Systems, 30 TAC § 290.46(j). The Utility is not required to perform these inspections for the applicant/customer but will assist the applicant/customer in locating and obtaining the services of a certified inspector.

Section 2.07 - Back Flow Prevention Devices

No water connection shall be allowed to any residence or establishment where an actual or potential contamination hazard exists unless the public water facilities are protected from contamination by either an approved air gap, backflow prevention assembly, or other approved device. The type of device or backflow prevention assembly required shall be determined by the specific potential hazard identified in 30 TAC § 290.47(f) Appendix F, Assessment of Hazards and Selection of Assemblies of the TCEQ Rules and Regulations for Public Water Systems.

The use of a backflow prevention assembly at the service connection shall be considered as additional backflow protection and shall not negate the use of backflow protection on internal hazards as outlined and enforced by local plumbing codes. When a customer service inspection certificate indicates that an adequate internal cross-connection control program is in effect, backflow protection at the water service entrance or meter is not required.

At any residence or establishment where it has been determined by a customer service inspection, that there is no actual or potential contamination hazard, as referenced in 30 TAC § 290.47(f) Appendix F, Assessment of Hazards and Selection of Assemblies of the TCEQ Rules and Regulations for Public Water Systems, then a backflow prevention assembly or device is not required. Outside hose bibs do require, at a minimum, the installation and maintenance of a working atmospheric vacuum breaker.

All backflow prevention assemblies or devices shall be tested upon installation by a TCEQ certified backflow prevention assembly tester and certified to be operating within specifications. Backflow prevention assemblies which are installed to provide protection against health hazards must also be tested and certified to be operating within specifications at least annually by a certified backflow prevention assembly tester.

If the utility determines that a backflow prevention assembly or device is required, the utility will provide the customer or applicant with a list of TCEQ certified backflow prevention assembly testers. The customer will be responsible for the cost of installation and testing, if any, of backflow prevention assembly or device. The customer should contact several qualified installers to compare prices before installation. The customer must pay for any required maintenance and annual testing and must furnish a copy of the test results demonstrating that the assembly is functioning properly to the utility within 30 days after the anniversary date of the installation unless a different date is agreed upon.

SECTION 2.0 – SERVICE RULES AND POLICIES (Continued)

Section 2.08 - Access to Customer's Premises

The utility will have the right of access to the customer's premises at all reasonable times for the purpose of installing, testing, inspecting or repairing water mains or other equipment used in connection with its provision of water service, or for the purpose of removing its property and disconnecting lines, and for all other purposes necessary to the operation of the utility system including inspecting the customer's plumbing for code, plumbing or tariff violations. The customer shall allow the utility and its personnel access to the customer's property to conduct any water quality tests or inspections required by law. Unless necessary to respond to equipment failure, leak or other condition creating an immediate threat to public health and safety or the continued provision of adequate utility service to others, such entry upon the customer's property shall be during normal business hours and the utility personnel will attempt to notify the customer that they will be working on the customer's property. The customer may require any utility representative, employee, contractor, or agent seeking to make such entry identify themselves, their affiliation with the utility, and the purpose of their entry.

All customers or service applicants shall provide access to meters and utility cutoff valves at all times reasonably necessary to conduct ordinary utility business and after normal business hours as needed to protect and preserve the integrity of the public drinking water supply.

Section 2.09 - Meter Requirements, Readings, and Testing

One meter is required for each residential, commercial, or industrial connection. All water sold by the utility will be billed based on meter measurements. The utility will provide, install, own and maintain meters to measure amounts of water consumed by its customers.

Meters will be read at monthly intervals and as nearly as possible on the corresponding day of each monthly meter reading period unless otherwise authorized by the Commission.

Meter tests. The utility will, upon the request of a customer, and, if the customer so desires, in his or her presence or in that of his or her authorized representative, make without charge a test of the accuracy of the customer's meter. If the customer asks to observe the test, the test will be made during the utility's normal working hours at a time convenient to the customer. Whenever possible, the test will be made on the customer's premises, but may, at the utility's discretion, be made at the utility's testing facility. If within a period of two years the customer requests a new test, the utility will make the test, but if the meter is found to be within the accuracy standards established by the American Water Works Association, the utility will charge the customer a fee which reflects the cost to test the meter up to a maximum \$25 for a residential customer. Following the completion of any requested test, the utility will promptly advise the customer of the date of removal of the meter, the date of the test, the result of the test, and who made the test.

Section 2.10 - Billing

(A) Regular Billing

Bills from the utility will be mailed monthly unless otherwise authorized by the Commission. The due date of bills for utility service will be at least sixteen (16) days from the date of issuance.

SECTION 2.0 – SERVICE RULES AND POLICIES (Continued)

The postmark on the bill or, if there is no postmark on the bill, the recorded date of mailing by the utility will constitute proof of the date of issuance. Payment for utility service is delinquent if full payment, including late fees and the regulatory assessment, is not received at the utility or the utility's authorized payment agency by 5:00 p.m. on the due date. If the due date falls on a holiday or weekend, the due date for payment purposes will be the next workday after the due date.

(B) Late Fees

A late penalty of either \$5.00 or 10.0% will be charged on bills received after the due date. The penalty on delinquent bills will not be applied to any balance to which the penalty was applied in a previous billing. The utility must maintain a record of the date of mailing to charge the late penalty.

(C) Information on Bill

Each bill will provide all information required by the PUC Rules. For each of the systems it operates, the utility will maintain and note on the monthly bill a local or toll-free telephone number (or numbers) to which customers can direct questions about their utility service.

(D) Prorated Bills - If service is interrupted or seriously impaired for 24 consecutive hours or more, the utility will prorate the monthly base bill in proportion to the time service was not available to reflect this loss of service.

Section 2.11- Payments

All payments for utility service shall be delivered or mailed to the utility's business office. If the business office fails to receive payment prior to the time of noticed disconnection for non-payment of a delinquent account, service will be terminated as scheduled. Utility service crews shall not be allowed to collect payments on customer accounts in the field.

Payment of an account by any means that has been dishonored and returned by the payor or payee's bank, shall be deemed to be delinquent. All returned payments must be redeemed with cash or valid money order. If a customer has two returned payments within a twelve month period, the customer shall be required to pay a deposit if one has not already been paid.

Section 2.12 - Service Disconnection

(A) With Notice

Utility service may be disconnected if the bill has not been paid in full by the date listed on the termination notice. The termination date must be at least 10 days after the notice is mailed or hand delivered.

The utility is encouraged to offer a deferred payment plan to a customer who cannot pay an outstanding bill in full and is willing to pay the balance in reasonable installments. However, a customer's utility service may be disconnected if a bill has not been paid or a deferred payment agreement entered into within 26 days from the date of issuance of a bill and if proper notice of termination has been given.

Notice of termination must be a separate mailing or hand delivery in accordance with the PUC Rules.

SECTION 2.0 – SERVICE RULES AND POLICIES (Continued)

(B) Without Notice

Utility service may also be disconnected without notice for reasons as described in the PUC Rules.

Section 2.13 - Reconnection of Service

Utility personnel must be available during normal business hours to accept payments on the day service is disconnected and the following day unless service was disconnected at the customer's request or due to a hazardous condition.

Service will be reconnected within 36 hours after the past due bill, reconnect fees and any other outstanding charges are paid or the conditions which caused service to be disconnected are corrected.

Section 2.14 - Service Interruptions

The utility will make all reasonable efforts to prevent interruptions of service. If interruptions occur, the utility will re-establish service within the shortest possible time. Except for momentary interruptions due to automatic equipment operations, the utility will keep a complete record of all interruptions, both emergency and scheduled and will notify the Commission in writing of any service interruptions affecting the entire system or any major division of the system lasting more than four hours. The notice will explain the cause of the interruptions.

Section 2.15 - Quality of Service

The utility will plan, furnish, and maintain production, treatment, storage, transmission, and distribution facilities of sufficient size and capacity to provide a continuous and adequate supply of water for all reasonable consumer uses. Unless otherwise authorized by the Commission, the utility will maintain facilities as described in the TCEQ Rules and Regulations for Public Water Systems.

Section 2.16 - Customer Complaints and Disputes

If a customer or applicant for service lodges a complaint, the utility will promptly make a suitable investigation and advise the complainant of the results. Service will not be disconnected pending completion of the investigation. If the complainant is dissatisfied with the utility's response, the utility must advise the complainant that he has recourse through the PUC complaint process. Pending resolution of a complaint, the commission may require continuation or restoration of service.

The utility will maintain a record of all complaints which shows the name and address of the complainant, the date and nature of the complaint and the adjustment or disposition thereof, for a period of two years after the final settlement of the complaint.

In the event of a dispute between a customer and a utility regarding any bill for utility service, the utility will conduct an investigation and report the results to the customer. If the dispute is not resolved, the utility will inform the customer that a complaint may be filed with the Commission.

Section 2.17 - Customer Liability

Customer shall be liable for any damage or injury to utility-owned property shown to be caused by the customer.

SECTION 3.0 -- EXTENSION POLICY

Section 3.01 - Standard Extension Requirements

Line Extension and Construction Charges: No Contribution in Aid of Construction may be required of any customer except as provided for in this approved extension policy.

The Utility is not required to extend service to any applicant outside of its certified service area and will only do so under terms and conditions mutually agreeable to the Utility and the applicant, in compliance with PUC rules and policies, and upon extension of the Utility's certified service area boundaries by the PUC.

The applicant for service will be given an itemized statement of the costs, options such as rebates to the customer, sharing of construction costs between the utility and the customer, or sharing of costs between the customer and other applicants prior to beginning construction.

Section 3.02 - Costs Utilities and Service Applicants Shall Bear

Within its certified area, the utility will pay the cost of the first 200 feet of any water main or distribution line necessary to extend service to an individual residential customer within a platted subdivision.

However, if the residential customer requesting service purchased the property after the developer was notified in writing of the need to provide facilities to the utility, the utility may charge for the first 200 feet. The utility must also be able to document that the developer of the subdivision refused to provide facilities compatible with the utility's facilities in accordance with the utility's approved extension policy after receiving a written request from the utility.

Residential customers will be charged the equivalent of the costs of extending service to their property from the nearest transmission or distribution line even if that line does not have adequate capacity to serve the customer. However, if the customer places unique, non-standard service demands upon the system, the customer may be charged the additional cost of extending service to and throughout their property, including the cost of all necessary transmission and storage facilities necessary to meet the service demands anticipated to be created by that property.

Unless an exception is granted by the PUC, the residential service applicant shall not be required to pay for costs of main extensions greater than 2" in diameter for water distribution and pressure wastewater collection lines and 6" in diameter for gravity wastewater lines.

Exceptions may be granted by the PUC if:

- adequate service cannot be provided to the applicant using the maximum line sizes listed due to distance or elevation, in which case, it shall be the utility's burden to justify that a larger diameter pipe is required for adequate service;
- or larger minimum line sizes are required under subdivision platting requirements or building codes of municipalities within whose corporate limits or extraterritorial jurisdiction the point of use is located; or the residential service applicant is located outside the CCN service area.

SECTION 3.0 -- EXTENSION POLICY (Continued)

If an exception is granted, the Utility shall establish a proportional cost plan for the specific extension or a rebate plan which may be limited to seven years to return the portion of the applicant's costs for oversizing as new customers are added to ensure that future applicants for service on the line pay at least as much as the initial service applicant.

For purposes of determining the costs that service applicants shall pay, commercial customers with service demands greater than residential customer demands in the certified area, industrial, and wholesale customers shall be treated as developers. A service applicant requesting a one-inch meter for a lawn sprinkler system to service a residential lot is not considered nonstandard service.

If an applicant requires service other than the standard service provided by the utility, such applicant will be required to pay all expenses incurred by the utility in excess of the expenses that would be incurred in providing the standard service and connection beyond 200 feet and throughout his property including the cost of all necessary transmission facilities.

The utility will bear the full cost of any over-sizing of water mains necessary to serve other customers in the immediate area. The individual residential customer shall not be charged for any additional production, storage, or treatment facilities. Contributions in aid of construction may not be required of individual residential customers for production, storage, treatment or transmission facilities unless otherwise approved by the Commission under this specific extension policy.

Section 3.03 - Contributions in Aid of Construction

Developers may be required to provide contributions in aid of construction in amounts sufficient to furnish the development with all facilities necessary to provide for reasonable local demand requirements and to comply with TCEQ minimum design criteria for facilities used in the production, transmission, pumping, or treatment of water or TCEQ minimum requirements. For purposes of this subsection, a developer is one who subdivides or requests more than two meters on a piece of property. Commercial, industrial, and wholesale customers will be treated as developers.

Any applicant who places unique or non-standard service demands on the system may be required to provide contributions in aid of construction for the actual costs of any additional facilities required to maintain compliance with the TCEQ minimum design criteria for water production, treatment, pumping, storage and transmission.

Any service extension to a subdivision (recorded or unrecorded) may be subject to the provisions and restrictions of 16 TAC § 24.163(d). When a developer wishes to extend the system to prepare to service multiple new connections, the charge shall be the cost of such extension, plus a pro-rata charge for facilities which must be committed to such extension compliant with the TCEQ minimum design criteria. As provided by 16 TAC § 24.163(d)(4), for purposes of this section, commercial, industrial, and wholesale customers shall be treated as developers.

SECTION 3.0 -- EXTENSION POLICY (Continued)

A utility may only charge a developer standby fees for unrecovered costs of facilities committed to a developer's property under the following circumstances:

- Under a contract and only in accordance with the terms of the contract; or
- if service is not being provided to a lot or lots within two years after installation of facilities necessary to provide service to the lots has been completed and if the standby fees are included on the utility's approved tariff after a rate change application has been filed. The fees cannot be billed to the developer or collected until the standby fees have been approved by the commission or executive director.
- for purposes of this section, a manufactured housing rental community can only be charged standby fees under a contract or if the utility installs the facilities necessary to provide individually metered service to each of the rental lots or spaces in the community.

Section 3.04 - Appealing Connection Costs

The imposition of additional extension costs or charges as provided by Sections 3.0 - Extension Policy of this tariff shall be subject to appeal as provided in this tariff, PUC rules, or the rules of such other regulatory authority as may have jurisdiction over the utility's rates and services. Any applicant required to pay for any costs not specifically set forth in the rate schedule pages of this tariff shall be given a written explanation of such costs prior to payment and/or commencement of construction. If the applicant does not believe that these costs are reasonable or necessary, the applicant shall be informed of the right to appeal such costs to the PUC or such other regulatory authority having jurisdiction over the utility's rates in that portion of the utility's service area in which the applicant's property(ies) is (are) located.

Section 3.05 - Applying for Service

The Utility will provide a written service application form to the applicant for each request for service received by the Utility's business offices. A separate application shall be required for each potential service location if more than one service connection is desired by any individual applicant. Service application forms will be available at the Utility's business office during normal weekday business hours.

Service applications will be sent by prepaid first class United States mail to the address provided by the applicant upon request. Completed applications should be returned by hand delivery in case there are questions which might delay fulfilling the service request. Completed service applications may be submitted by mail if hand delivery is not possible.

Where a new tap or service connection is required, the service applicant shall be required to submit a written service application and request that a tap be made. A diagram, map, plat, or written metes and bounds description of precisely where the applicant desires each tap or service connection is to be made and, if necessary, where the meter is to be installed, along the applicant's property line may also be required with the tap request.

SECTION 3.0 -- EXTENSION POLICY (Continued)

The actual point of connection and meter installation must be readily accessible to Utility personnel for inspection, servicing, and meter reading while being reasonably secure from damage by vehicles and mowers. If the Utility has more than one main adjacent to the service applicant's property, the tap or service connection will be made to the Utility's nearest service main with adequate capacity to service the applicant's full potential service demand. Beyond the initial 200 feet, the customer shall bear only the equivalent cost of extending from the nearest main. If the tap or service connection cannot be made at the applicant's desired location, it will be made at another location mutually acceptable to the applicant and the Utility. If no agreement on location can be made, the applicant may refer the matter to the PUC for resolution.

Section 3.06 - Qualified Service Applicant

A "qualified service applicant" is an applicant who has: (1) met all of the Utility's requirements for service contained in this tariff, PUC rules and/or PUC order, (2) has made payment or made arrangement for payment of tap fees, (3) has provided all easements and rights-of-way required to provide service to the requested location, (4) delivered an executed customer service inspection certificate to the Utility, if applicable, and (5) has executed a customer service application for each location to which service is being requested.

The Utility shall serve each qualified service applicant within its certified service area as soon as practical after receiving a completed service application. All service requests will be fulfilled within the time limits prescribed by PUC rules once the applicant has met all conditions precedent to achieving "qualified service applicant" status. If a service request cannot be fulfilled within the required period, the applicant shall be notified in writing of the delay, its cause and the anticipated date that service will be available. The PUC service dates shall not become applicable until the service applicant has met all conditions precedent to becoming a qualified service applicant as defined by PUC rules.

Section 3.07 - Developer Requirements

As a condition of service to a new subdivision, the Utility shall require a developer (as defined by PUC rule) to provide permanent recorded public utility easements as a condition of service to any location within the developer's property.

SECTION 4.0 -- DROUGHT CONTINGENCY PLAN
(Utility must attach copy of TCEQ approved Drought Contingency Plan)

APPENDIX A -- SAMPLE SERVICE AGREEMENT
From 30 TAC § 290.47(b), Appendix B
SERVICE AGREEMENT

- I. **PURPOSE.** The NAME OF WATER SYSTEM is responsible for protecting the drinking water supply from contamination or pollution which could result from improper private water distribution system construction or configuration. The purpose of this service agreement is to notify each customer of the restrictions which are in place to provide this protection. The utility enforces these restrictions to ensure the public health and welfare. Each customer must sign this agreement before the NAME OF WATER SYSTEM will begin service. In addition, when service to an existing connection has been suspended or terminated, the water system will not re-establish service unless it has a signed copy of this agreement.
- II. **RESTRICTIONS.** The following unacceptable practices are prohibited by State regulations.
- A. No direct connection between the public drinking water supply and a potential source of contamination is permitted. Potential sources of contamination shall be isolated from the public water system by an air-gap or an appropriate backflow prevention device.
 - B. No cross-connection between the public drinking water supply and a private water system is permitted. These potential threats to the public drinking water supply shall be eliminated at the service connection by the installation of an air-gap or a reduced pressure-zone backflow prevention device.
 - C. No connection which allows water to be returned to the public drinking water supply is permitted.
 - D. No pipe or pipe fitting which contains more than 8.0% lead may be used for the installation or repair of plumbing at any connection which provides water for human use.
 - E. No solder or flux which contains more than 0.2% lead can be used for the installation or repair of plumbing at any connection which provides water for human use.
- III. **SERVICE AGREEMENT.** The following are the terms of the service agreement between the NAME OF WATER SYSTEM (the Water System) and NAME OF CUSTOMER (the Customer).
- A. The Water System will maintain a copy of this agreement as long as the Customer and/or the premises are connected to the Water System.
 - B. The Customer shall allow his property to be inspected for possible cross-connections and other potential contamination hazards. These inspections shall be conducted by the Water System or its designated agent prior to initiating new water service; when there is reason to believe that cross-connections or other potential contamination hazards exist; or after any major changes to the private water distribution facilities. The inspections shall be conducted during the Water System's normal business hours.
 - C. The Water System shall notify the Customer in writing of any cross-connection or other potential contamination hazard which has been identified during the initial inspection or the periodic reinspection.
 - D. The Customer shall immediately remove or adequately isolate any potential cross-connections or other potential contamination hazards on his premises.
 - E. The Customer shall, at his expense, properly install, test, and maintain any backflow prevention device required by the Water System. Copies of all testing and maintenance records shall be provided to the Water System.
- IV. **ENFORCEMENT.** If the Customer fails to comply with the terms of the Service Agreement, the Water System shall, at its option, either terminate service or properly install, test, and maintain an appropriate backflow prevention device at the service connection. Any expenses associated with the enforcement of this agreement shall be billed to the Customer.

CUSTOMER'S SIGNATURE: _____

DATE: _____

APPENDIX B -- APPLICATION FOR SERVICE
(Utility Must Attach Blank Copy)