

Control Number: 49715

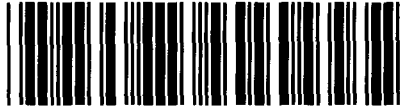

Item Number: 58

Addendum StartPage: 0

STATEMENT OF POSITION  
Docket # 49215 2019 DEC 20 11:25 AM

Hello, this is for whomever it  
may concern, I, James Lord - address  
174 County Road 3564 New Caney Tx. 77357

Do give this statement of position  
concerning the circled Route on provided  
map. this Power Line Route cuts my  
Property in half and I am firmly  
against this Route.

Thank you, James Lord

(Route "S" on Map)

58

All routes and route segments included in this notice are available for selection and approval by the Public Utility Commission of Texas

Route Number	Segments
1	A1-A2-D-E-L1-L2
2	A1-A2-D-F-J-K1-K2-N
3	A1-A2-D-F-J-K1-K2-M-Q-R
4	A1-A2-C-H-O-R
5	A1-A2-C-H-P-R
6	B1-B2-L1-L2
7	B1-B2-G-J-K1-K2-N
8	B1-B2-G-J-K1-K2-M-Q-R
9	A1-S-B2-L1-T-K2-N
10	A1-S-B2-L1-L2

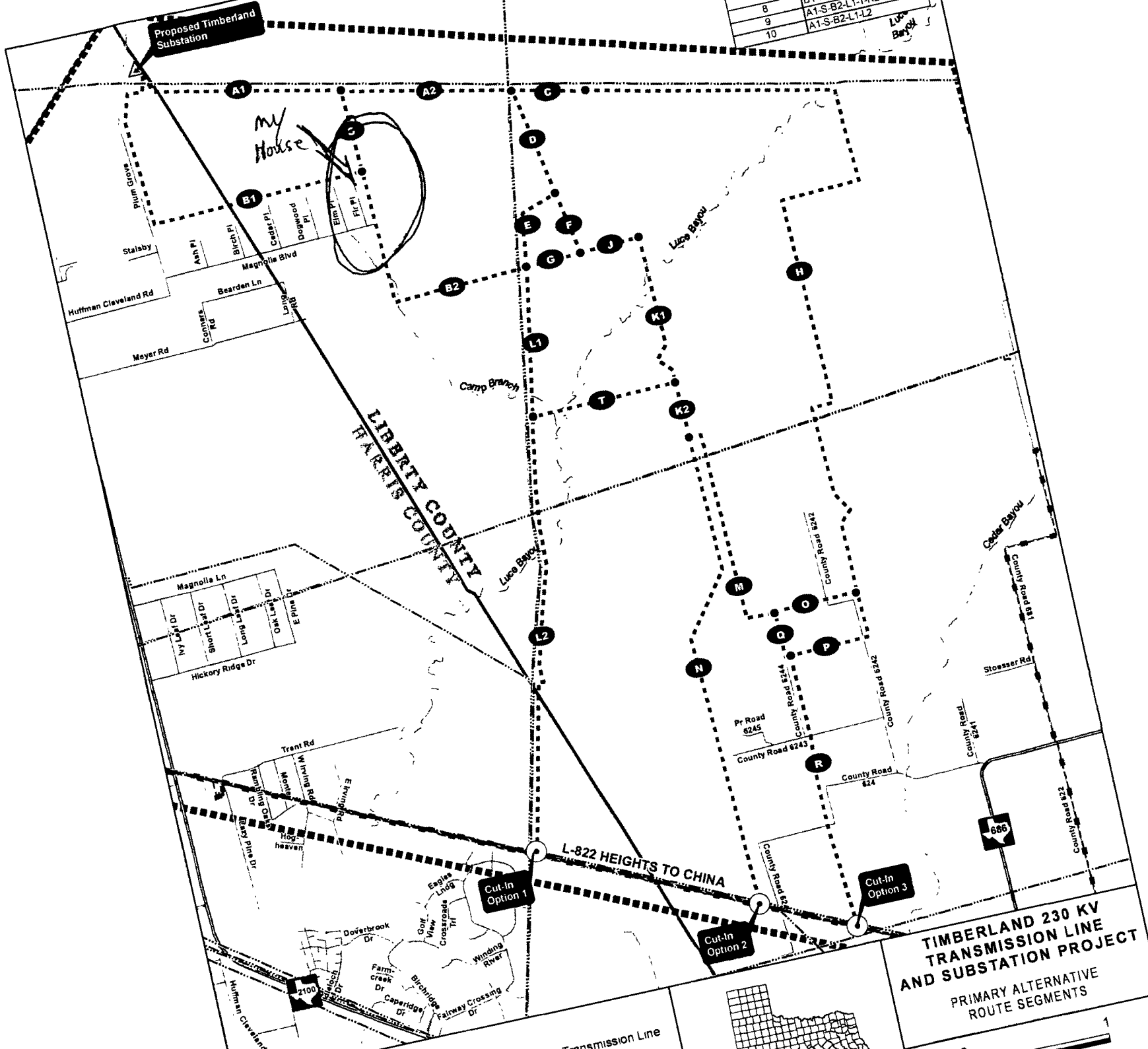

- Legend**
- Proposed Substation Site
  - Primary Alternative Route Segment Node
  - Primary Alternative Route Segment
  - Alternative Cut-In Location
  - Study Area Boundary
  - Existing Transmission Line
  - Oil / Gas Transmission Pipeline
  - Stream/Bayou
  - FM Road
  - County / Local Road
  - County Boundary

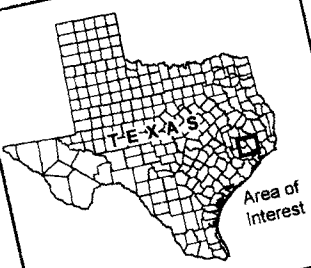

**TIMBERLAND 230 KV TRANSMISSION LINE AND SUBSTATION PROJECT**  
 PRIMARY ALTERNATIVE ROUTE SEGMENTS

0 1 Miles

POWER ENGINEERS  
 Date 5/14/2019