



Control Number: 49311



Item Number: 38

Addendum StartPage: 0

DOCKET NO. 49311

APPLICATION OF PARK WATER
COMPANY TO OBTAIN
CERTIFICATES OF CONVENIENCE
AND NECESSITY IN MIDLAND
COUNTY

§
§
§
§
§

RECEIVED
2020 MAR 13 PM 1:16
PUBLIC UTILITY COMMISSION
OF TEXAS
FILED CLERK

NOTICE OF APPROVAL

This Notice of Approval addresses the application of the Park Water Company to obtain new water and sewer certificates of convenience and necessity (CCN) in Midland County. Commission Staff recommends approval of the application, as amended and supplemented. The Commission approves the application, as amended and supplemented, and grants water CCN number 13278 and sewer CCN number 21115.

I. Findings of Fact

The Commission makes the following findings of fact.

Applicant

1. Park Water is a Texas for-profit corporation registered with the Texas secretary of state under file number 802526497.
2. Park Water is a retail public utility.
3. Park Water proposes to construct and operate facilities to provide water and sewer service in Midland County.
4. Park Water will own and operate Texas Commission on Environmental Quality (TCEQ)-registered public water system (PWS) identification number 1650167.
5. Park Water will own and operate a sewer system under Texas Pollutant Discharge Elimination System (TPDES) permit No. WQ0015661001.
6. Park Water is wholly owned by Permian Basin Water Resources, LLC, a Delaware limited liability company registered with the Texas secretary of state under file number 803442273.

Application

7. On March 8, 2019, Park Water filed the application at issue in this docket, seeking a new water CCN and sewer CCN in Midland County.
8. The proposed service area contains approximately 262 acres and no current customers.
9. The proposed service area consists of the land that will be developed as the Vander Ranch Subdivision in Midland County.
10. The proposed service area is located approximately 8 miles east of downtown Midland, Texas, and is generally bounded on the north by a location approximately 0.7 miles south of County Road 2014; on the east by a location approximately one mile east of County Road 1110; on the south by a location approximately 0.6 miles north of County Road 120; and on the west by South County Road 1110.
11. In Order No. 3 filed on June 6, 2019, the administrative law judge (ALJ) found the application administratively complete.

Notice of Application

12. On July 8, 2019, Park Water filed the affidavit of Jonathan Cochran, an attorney for Park Water, attesting that notice was mailed to current customers, landowners, neighboring utilities, and affected parties on June 17, 2019.
13. On July 8, 2019, Park Water filed the affidavit of Rachel Moore, Sales Assistant, attesting that notice was published in the *Midland Reporter-Telegram*, a newspaper of general circulation in Midland County, on June 15 and 22, 2019.
14. In Order No. 5 filed on July 22, 2019, the ALJ found the notice of the application sufficient.

Evidentiary Record

15. On January 21, 2020, Commission Staff and Park Water filed join a motion to admit evidence.
16. In Order No. 10 filed on March 10, 2020, the ALJ admitted the following evidence into the record of the proceeding: (a) Park Water's application filed on March 8, 2019; (b) Park Water's supplements to the application filed on March 12 and 26, April 12, May 7, and August 20, 2019; (c) Park Water's proof of notice filed on July 8, 2019; (d) Park Water's

response to Commission Staff's first request for information filed on July 24, 2019; (e) Park Water's response to Commission Staff's second request for information filed on September 17, 2019; (f) Park Water's response to Commission Staff's third request for information filed on October 18, 2019; (g) Park Water's response to Commission Staff's fourth request for information filed on December 5, 2019; (h) Park Water's consent form filed on December 16, 2019; and (i) Commission Staff's final recommendation and attachments filed on January 7, 2020.

Adequacy of Existing Service—Texas Water Code (TWC) § 13.246(c)(1); 16 Texas Administrative Code (TAC) § 24.227(d)(1)

17. Water and sewer services are not currently being provided in the requested area.
18. Additional construction is necessary for Park Water to serve the requested area.

Need for Service—TWC § 13.246(c)(2); 16 TAC § 24.227(d)(2)

19. The requested area is vacant land that is being developed into residential subdivisions.
20. The water system and sewer system that will be constructed by Park Water are necessary for the development of the subdivisions.

Effect of Granting the Certificates—TWC § 13.246(c)(3); 16 TAC § 24.227(d)(3)

21. Greenwood Water Corporation provides water utility service within two miles of the requested service area.
22. Park Water and Greenwood Water are commonly owned by Permian Basin.
23. There will be no effect on any other retail public utility servicing the proximate area as there are no other water or sewer providers within two miles of the boundary of the requested area.
24. The Commission received no protests or adverse comments from any other retail public utility.

Ability to Serve: Managerial and Technical—TWC §§ 13.241(a) through (c), 13.246(c)(4); 16 TAC §§ 24.227(a) and (d)(4)

25. Park Water's proposed PWS is registered with the TCEQ under PWS ID No. 1650167.
26. Park Water has licensed operators to operate the water and sewer systems.

27. Park Water has provided a capital improvements plan for constructing the facilities that are necessary for Park Water to serve the requested area.
28. Park Water is capable of providing drinking water that meets the requirements of the Texas Health and Safety Code, Chapter 341, the TWC, Chapter 13, and has access to an adequate supply of water.
29. Park Water's proposed sewer system will be permitted by the TCEQ under TPDES permit number WQ0015661001 and is capable of meeting TCEQ's design criteria for sewer treatment plants.

Service from Other Utilities—TWC § 13.246(c)(5); 16 TAC § 24.227(d)(5)

30. There are no other retail public water or sewer utilities with one-half mile of the requested area.
31. It is not feasible for an adjacent utility to provide service to the requested area.

Regionalization or Consolidation—TWC § 13.241(d); 16 TAC § 24.227(b)

32. Greenwood Water, a commonly owned affiliate, is within two miles of the boundary of the requested area.
33. New facilities are the optimum plan for providing service because of the age and capacity of Greenwood Water's facilities.
34. It is not feasible for Greenwood Water to provide water service to the requested area.
35. Park Water has satisfied the Commission's requirements on regionalization and consolidation.

Ability to Serve: Financial Ability and Stability—TWC §§ 13.241(a), 13.246(c)(6); 16 TAC §§ 24.227(a) and (d)(6), 24.11(e)

36. Park Water has a debt-to-equity ratio of zero, which is less than one, which meets the leverage test.
37. Park Water has sufficient cash available to cover any projected operations and maintenance shortages in the first five years of operations, which meets the operations test.

38. Park Water has demonstrated that it has the financial ability and stability to finance the facilities necessary to operate and manage the utility and to provide continuous and adequate service to the proposed service area.

Financial Assurance—TWC § 13.246(d); 16 TAC § 24.227(e)

39. There is no need to require Park Water to provide a bond or other financial assurance to ensure continuous and adequate utility service is provided.

Environmental Integrity—TWC § 13.246(c)(7); 16 TAC § 24.227(d)(7)

40. Granting Park Water's water CCN will have a minimal effect on the environmental integrity on the land as the requested area is already being developed.
41. Granting Park Water's sewer CCN will protect the environmental integrity of the land by eliminating the need for additional onsite sewage facilities in the service area.

Effect on Land—TWC § 13.246(c)(9); 16 TAC § 24.227(d)(9)

42. Additional construction is necessary to provide service in the requested area, which will have a minimal effect on the land.

Improvement in Service—TWC § 13.246(c)(8); 16 TAC § 24.227(d)(8)

43. Granting Park Water a water and sewer CCN will allow Park Water to provide service to potential future customers in the requested area, which is not currently receiving service.

Lowering of Cost—TWC § 13.246(c)(8); 16 TAC § 24.227(d)(8)

44. There will be no lowering of cost because there are no current customers in the requested area.

Rate Study—16 TAC § 24.25(b)(1)(B)(i)

45. Park Water provided a rate study supporting its proposed rates.

Calculations Supporting Proposed Rates—16 TAC § 24.25(b)(1)(B)(ii)

46. Park Water provided all calculations supporting its proposed rates.

Assumptions for Projections Included in Rate Study—16 TAC § 24.25(b)(1)(B)(iii)

47. Park Water provided all assumptions for projections included in its rate study.

Estimated Completion Date for Physical Plant—16 TAC § 24.25(b)(1)(B)(iv)

48. Park Water provided an estimated completion date for the systems.

Estimated Service Start Dates for All Phases of Construction—16 TAC § 24.25(b)(1)(B)(v)

49. Service and billing will commence upon the approval of this application by the Commission and completion of the systems.

Maps, Tariffs, and Certificates

50. On December 12, 2019, Commission Staff emailed its proposed maps, tariffs, and certificates to Park Water.
51. On December 16, 2019, Park Water filed its consent to the proposed maps, tariffs, and certificates.
52. On January 7, 2020, Commission Staff filed its final recommendation of approval of Park Water's application.
53. On January 21, 2020, Commission Staff filed the proposed maps, certificates, and tariffs as attachments to its joint proposed notice of approval and motion to admit evidence.

Informal Disposition

54. More than 15 days have passed since the completion of notice provided in this docket.
55. No person filed a protest or motion to intervene.
56. Commission Staff and Park Water are the only parties to this proceeding.
57. No party requested a hearing and no hearing is needed.
58. Commission Staff recommended approval of the application.
59. This decision is not adverse to any party.

II. Conclusions of Law

The Commission makes the following conclusions of law.

1. The Commission has jurisdiction over the application under TWC §§ 13.041, 13.241, 13.244, and 13.246.
2. Park Water is a retail public utility as defined in TWC § 13.002(19) and 16 TAC § 24.3(59).
3. Notice of the application complies with TWC § 13.246 and 16 TAC § 24.235.

4. The Commission processed the application in accordance with the requirements of the Administrative Procedure Act,¹ the TWC, and Commission rules.
5. The application meets the requirements set forth in TWC §§ 13.241 and 13.246 and 16 TAC §§ 24.25 and 24.227.
6. Park Water has demonstrated adequate financial, managerial, and technical capability to provide continuous and adequate service to the requested area as required by TWC § 13.241(a), (b), and (c), and 16 TAC § 24.227.
7. After considering the factors in TWC § 13.246(c) and 16 TAC § 24.227(d), the issuance of new water CCN number 13278 and sewer CCN number 2115 is necessary for the service, accommodation, convenience, or safety of the public as required by TWC § 13.246(b) and 16 TAC § 24.227(c).
8. Under TWC § 13.257(r) and (s), Park Water must record a certified copy of the approved certificates and maps, along with a boundary description of the service area, in the real property records of Midland County and to submit evidence of the recording to the Commission.
9. The requirements for informal disposition under 16 TAC § 22.35 have been met in this proceeding.

III. Ordering Paragraphs

In accordance with these findings of fact and conclusions of law, the Commission issues the following orders.

1. The Commission approves the application and grants Park Water water CCN number 13278 and sewer CCN number 2115 consistent with this Notice of Approval and shown on the maps attached to this Notice of Approval.
2. The Commission grants the certificates attached to this Notice of Approval.
3. The Commission approves the tariff filed with Commission Staff's joint proposed notice of approval and motion to admit evidence and attached to this Notice of Approval.

¹ Tex. Gov't Code ch. 2001.

4. Park Water must serve every customer and applicant for service within the areas certificated under water CCN number 13278 and sewer CCN number 21115 and such service must be continuous and adequate.
5. Park Water must comply with the recording requirements in TWC § 13.257(r) and (s) for the area in Midland County affected by the application.
6. Park Water must file in this docket proof of the recording required in ordering paragraph five not later than 45 days after the date of this Notice of Approval.
7. Park Water must provide notice to the Commission once billing for service begins under 16 TAC § 24.25(b)(1)(B)(vi).
8. Park Water must file a rate application in order to true-up the rates approved in this docket with the Commission within 18 months from the date service begins under 16 TAC § 24.25(b)(1)(C).
9. The Commission denies all other motions and any other requests for general or specific relief, if not expressly granted.

Signed at Austin, Texas the 10 day of March 2020.



ISAAC TA
ADMINISTRATIVE LAW JUDGE

W2013

q:\cadm\doCKET management\water\ccn\49xxx\49311-noa.docx

Park Water Company
Water CCN No. 13278
PUC Docket No. 49311
Obtained New CCN in Midland County

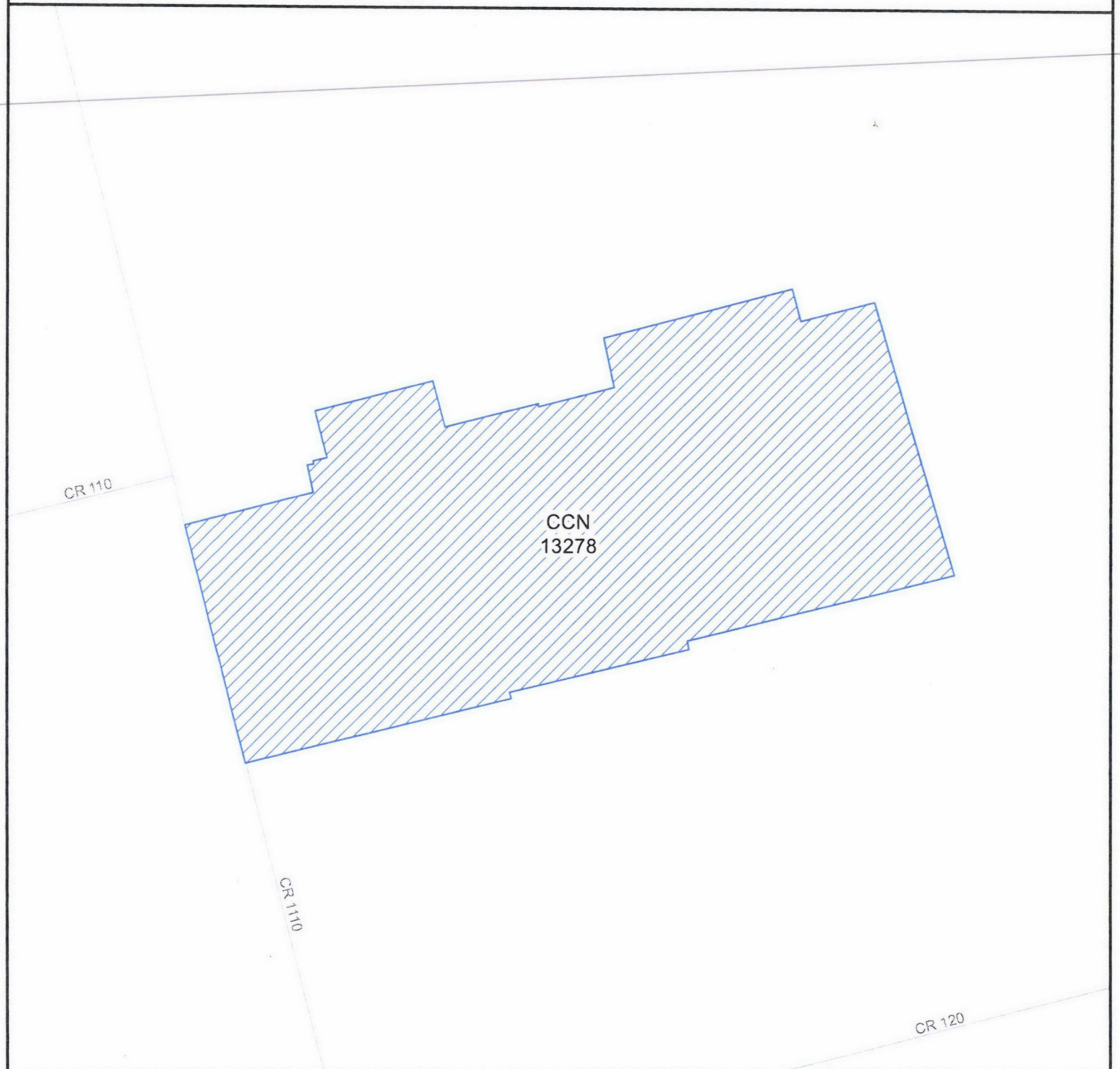

Public Utility Commission of Texas
1701 N. Congress Ave
Austin, TX 78701

Water CCN

 13278 - Park Water Company

0 500 1,000
Feet



Map by: Komal Patel
Date created: August 16, 2019
Project Path: n:\finalmapping\
49311ParkWaterCoWater.mxd

00000009

Park Water Company
Sewer CCN No. 21115
PUC Docket No. 49311
Obtained New CCN in Midland County

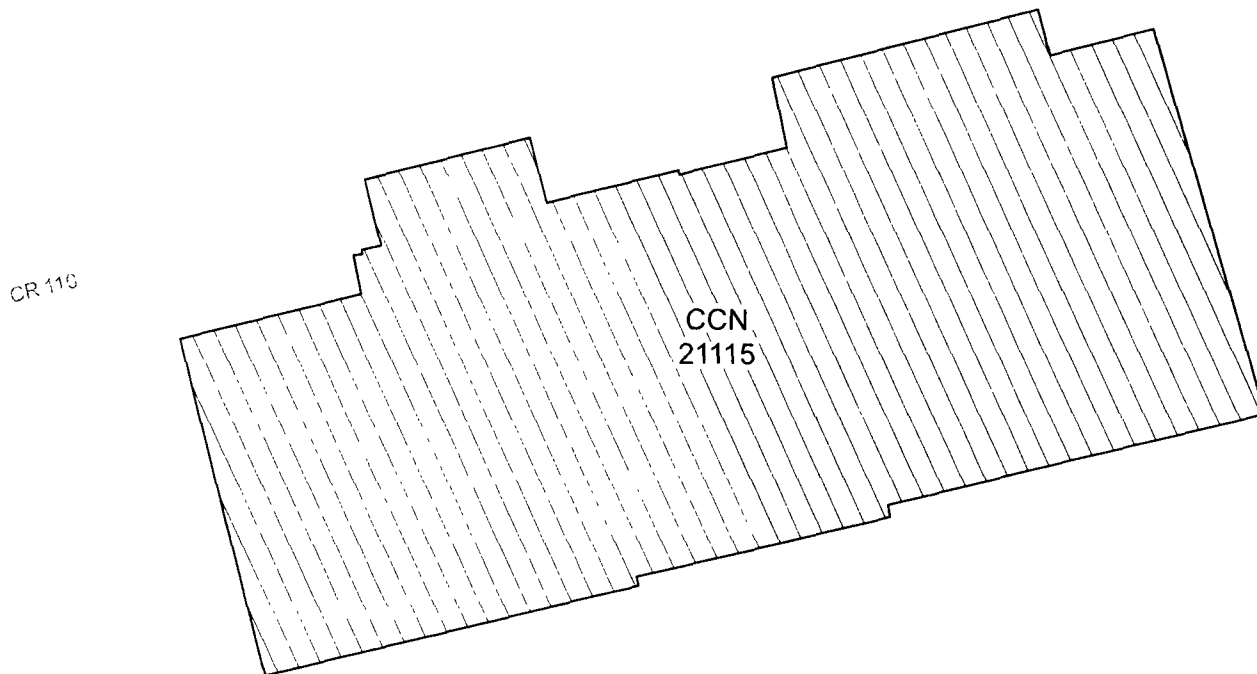

Public Utility Commission of Texas
1701 N. Congress Ave
Austin, TX 78701

Sewer CCN



21115 - Park Water Company

0 500 1,000
Feet



Map by Komal Patel
Date created August 16, 2019
Project Path: n:\finalmapping\
49311ParkWaterCoSewer.mxd

000000011

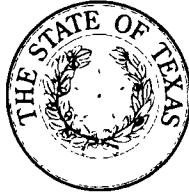

Public Utility Commission of Texas

By These Presents Be It Known To All That Park Water Company

having obtained certification to provide water utility service for the convenience and necessity of the public, and it having been determined by this Commission that the public convenience and necessity would in fact be advanced by the provision of such service, Park Water Company is entitled to this

Certificate of Convenience and Necessity No. 13278

to provide continuous and adequate water utility service to that service area or those service areas in Midland County as by final Order or Orders duly entered by this Commission, which Order or Orders resulting from Docket No. 49311 are on file at the Commission offices in Austin, Texas; and are matters of official record available for public inspection; and be it known further that these presents do evidence the authority and the duty of Park Water Company, to provide such utility service in accordance with the laws of this State and Rules of this Commission, subject only to any power and responsibility of this Commission to revoke or amend this Certificate in whole or in part upon a subsequent showing that the public convenience and necessity would be better served thereby.

Issued at Austin, Texas, this 10th day of March 2020.



Public Utility Commission of Texas

By These Presents Be It Known To All That

Park Water Company

having obtained certification to provide sewer utility service for the convenience and necessity of the public, and it having been determined by this Commission that the public convenience and necessity would in fact be advanced by the provision of such service, Park Water Company is entitled to this

Certificate of Convenience and Necessity No. 21115

to provide continuous and adequate sewer utility service to that service area or those service areas in Midland County as by final Order or Orders duly entered by this Commission, which Order or Orders resulting from Docket No. 49311 are on file at the Commission offices in Austin, Texas; and are matters of official record available for public inspection; and be it known further that these presents do evidence the authority and the duty of Park Water Company, to provide such utility service in accordance with the laws of this State and Rules of this Commission, subject only to any power and responsibility of this Commission to revoke or amend this Certificate in whole or in part upon a subsequent showing that the public convenience and necessity would be better served thereby.

Issued at Austin, Texas, this 10th day of March 2020.



WATER UTILITY TARIFF
Docket Number: 49311

Park Water Company
(Utility Name)

7107 FM 307
(Business Address)

Midland, Texas 79706
(City, State, Zip Code)

(432) 687-2070
(Area Code/Telephone)

This tariff is effective for utility operations under the following Certificate of Convenience and Necessity:

13278

This tariff is effective in the following counties:

Midland

This tariff is effective in the following cities or unincorporated towns (if any):

Greenwood (unincorporated area)

This tariff is effective in the following subdivisions and public water systems:

Vander Ranch, PWS No. 2200052

TABLE OF CONTENTS

The above utility lists the following sections of its tariff (if additional pages are needed for a section, all pages should be numbered consecutively):

SECTION 1.0 -- RATE SCHEDULE	2
SECTION 2.0 -- SERVICE RULES AND POLICIES	4
SECTION 3.0 -- EXTENSION POLICY	12

APPENDIX A – DROUGHT CONTINGENCY PLAN

APPENDIX B – SAMPLE SERVICE AGREEMENT

APPENDIX C – APPLICATION FOR SERVICE

SECTION 1.0 - RATE SCHEDULE

Section 1.01 - Rates

<u>Meter Size</u>	<u>Monthly Minimum Charge</u>	<u>Gallage Charge</u>
5/8" or 3/4"	\$ <u>112.82</u> (Includes 0 gallons)	\$7.94 per 1,000 gallons
1"	\$ <u>282.05</u>	
1½"	\$ <u>564.10</u>	
2"	\$ <u>902.56</u>	
3"	\$ <u>1692.30</u>	
4"	\$ <u>2820.50</u>	

FORM OF PAYMENT: The utility will accept the following forms of payment:

Cash X, Check X, Money Order X, Credit Card X, Other (specify)
THE UTILITY MAY REQUIRE EXACT CHANGE FOR PAYMENTS AND MAY REFUSE TO ACCEPT PAYMENTS
MADE USING MORE THAN \$1.00 IN SMALL COINS. A WRITTEN RECEIPT WILL BE GIVEN FOR CASH
PAYMENTS.

REGULATORY ASSESSMENT 1.0%
PUC RULES REQUIRE THE UTILITY TO COLLECT A FEE OF ONE PERCENT OF THE RETAIL MONTHLY BILL
AND TO REMIT FEE TO THE TCEQ.

Section 1.02 - Miscellaneous Fees

TAP FEE \$750.00
TAP FEE COVERS THE UTILITY'S COSTS FOR MATERIALS AND LABOR TO INSTALL A STANDARD
RESIDENTIAL 5/8" or 3/4" METER. AN ADDITIONAL FEE TO COVER UNIQUE COSTS IS PERMITTED IF LISTED
ON THIS TARIFF.

TAP FEE (Unique costs)..... Actual Cost
FOR EXAMPLE, A ROAD BORE FOR CUSTOMERS OUTSIDE OF SUBDIVISIONS OR RESIDENTIAL AREAS.

TAP FEE (Large meter)..... Actual Cost
TAP FEE IS THE UTILITY'S ACTUAL COST FOR MATERIALS AND LABOR FOR METER SIZE INSTALLED.

METER RELOCATION FEE Actual Relocation Cost, Not to Exceed Tap Fee
THIS FEE MAY BE CHARGED IF A CUSTOMER REQUESTS THAT AN EXISTING METER BE RELOCATED.

METER TEST FEE \$25.00
THIS FEE WHICH SHOULD REFLECT THE UTILITY'S COST MAY BE CHARGED IF A CUSTOMER REQUESTS
A SECOND METER TEST WITHIN A TWO-YEAR PERIOD AND THE TEST INDICATES THAT THE METER IS
RECORDING ACCURATELY. THE FEE MAY NOT EXCEED \$25.

SECTION 1.0 - RATE SCHEDULE (Continued)

RECONNECTION FEE

THE RECONNECT FEE MUST BE PAID BEFORE SERVICE CAN BE RESTORED TO A CUSTOMER WHO HAS BEEN DISCONNECTED FOR THE FOLLOWING REASONS (OR OTHER REASONS LISTED UNDER SECTION 2.0 OF THIS TARIFF):

- a) Non-payment of bill (Maximum \$25.00).....\$25.00
- b) Customer's request that service be disconnected\$50.00

TRANSFER FEE\$35.00

THE TRANSFER FEE WILL BE CHARGED FOR CHANGING AN ACCOUNT NAME AT THE SAME SERVICE LOCATION WHEN THE SERVICE IS NOT DISCONNECTED.

LATE CHARGE (EITHER \$5.00 OR 10% OF THE BILL)..... 10%

PUC RULES ALLOW A ONE-TIME PENALTY TO BE CHARGED ON DELINQUENT BILLS. A LATE CHARGE MAY NOT BE APPLIED TO ANY BALANCE TO WHICH THE PENALTY WAS APPLIED IN A PREVIOUS BILLING.

RETURNED CHECK CHARGE\$30.00

RETURNED CHECK CHARGES MUST BE BASED ON THE UTILITY'S DOCUMENTABLE COST.

CUSTOMER DEPOSIT RESIDENTIAL (Maximum \$50)\$50.00

COMMERCIAL & NON-RESIDENTIAL DEPOSIT 1/6TH OF ESTIMATED ANNUAL BILL

GOVERNMENTAL TESTING, INSPECTION AND COSTS SURCHARGE:

WHEN AUTHORIZED IN WRITING BY PUC AND AFTER NOTICE TO CUSTOMERS, THE UTILITY MAY INCREASE RATES TO RECOVER INCREASED COSTS FOR INSPECTION FEES AND WATER TESTING. [16 TAC 24.21(b)(2)(F)]

LINE EXTENSION AND CONSTRUCTION CHARGES:

REFER TO SECTION 3.0--EXTENSION POLICY FOR TERMS, CONDITIONS, AND CHARGES WHEN NEW CONSTRUCTION IS NECESSARY TO PROVIDE SERVICE.

SECTION 2.0 -- SERVICE RULES AND POLICIES

The utility will have the most current Public Utility Commission of Texas (PUC or Commission) Rules, Chapter 24, available at its office for reference purposes. The Rules and this tariff shall be available for public inspection and reproduction at a reasonable cost. The latest Rules or Commission approved changes to the Rules supersede any rules or requirements in this tariff.

Section 2.01 - Application for Water Service

All applications for service will be made on the utility's standard application or contract form (attached in the Appendix to this tariff), will be signed by the applicant, any required fees (deposits, reconnect, tap, extension fees, etc. as applicable) will be paid and easements, if required, will be granted before service is provided by the utility. A separate application or contract will be made for each service location.

Section 2.02 - Refusal of Service

The utility may decline to serve an applicant until the applicant has complied with the regulations of the regulatory agencies (state and municipal regulations) and for the reasons outlined in the PUC Rules. In the event that the utility refuses to serve an applicant, the utility will inform the applicant in writing of the basis of its refusal. The utility is also required to inform the applicant that a complaint may be filed with the Commission.

Section 2.03 - Fees and Charges & Easements Required Before Service Can Be Connected

(A) Customer Deposits

If a residential applicant cannot establish credit to the satisfaction of the utility, the applicant may be required to pay a deposit as provided for in Section 1.02 - Miscellaneous Fees of this tariff. The utility will keep records of the deposit and credit interest in accordance with PUC Rules.

Residential applicants 65 years of age or older may not be required to pay deposits unless the applicant has an outstanding account balance with the utility or another water or sewer utility which accrued within the last two years.

Nonresidential applicants who cannot establish credit to the satisfaction of the utility may be required to make a deposit that does not exceed an amount equivalent to one-sixth of the estimated annual billings.

Refund of deposit. If service is not connected, or after disconnection of service, the utility will promptly refund the customer's deposit plus accrued interest or the balance, if any, in excess of the unpaid bills for service furnished. The utility may refund the deposit at any time prior to termination of utility service but must refund the deposit plus interest for any residential customer who has paid 18 consecutive billings without being delinquent.

SECTION 2.0 -- SERVICE RULES AND POLICIES (Continued)

(B) Tap or Reconnect Fees

A new customer requesting service at a location where service has not previously been provided must pay a tap fee as provided in Section 1. A customer requesting service where service has previously been provided must pay a reconnect fee as provided in Section 1. Any applicant or existing customer required to pay for any costs not specifically set forth in the rate schedule pages of this tariff shall be given a written explanation of such costs prior to request for payment and/or commencement of construction.

SECTION 2.0 – SERVICE RULES AND POLICIES (Continued)

If the applicant or existing customer does not believe that these costs are reasonable or necessary, the applicant or existing customer shall be informed of their right to appeal such costs to the PUC or such other regulatory authority having jurisdiction over the utility's rates in that portion of the utility's service area in which the applicant's or existing customer's property(ies) is located.

Fees in addition to the regular tap fee may be charged if listed specifically in Section 1 to cover unique costs not normally incurred as permitted by 16 TAC § 24.86(a)(1)(C). For example, a road bore for customers outside a subdivision or residential area could be considered a unique cost.

(C) Easement Requirement

Where recorded public utility easements on the service applicant's property do not exist or public road right-of-way easements are not available to access the applicant's property, the Utility may require the applicant to provide it with a permanent recorded public utility easement on and across the applicant's real property sufficient to provide service to that applicant. Such easement(s) shall not be used for the construction of production, storage, transmission or pressure facilities unless they are needed for adequate service to that applicant.

Section 2.04 - Utility Response to Applications for Service

After the applicant has met all the requirements, conditions and regulations for service, the utility will install tap, meter and utility cut-off valve and/or take all necessary actions to initiate service. The utility will serve each qualified applicant for service within 5 working days unless line extensions or new facilities are required. If construction is required to fill the order and if it cannot be completed within 30 days, the utility will provide the applicant with a written explanation of the construction required and an expected date of service.

Except for good cause where service has previously been provided, service will be reconnected within one working day after the applicant has met the requirements for reconnection.

Section 2.05 - Customer Responsibility

The customer will be responsible for furnishing and laying the necessary customer service pipe from the meter location to the place of consumption. Customers will not be allowed to use the utility's cutoff valve on the utility's side of the meter. Existing customers may install cutoff valves on their side of the meter and are encouraged to do so. All new customers may be required to install and maintain a cutoff valve on their side of the meter.

No direct connection between a public water supply system and any potential source of contamination or between a public water supply system and a private water source (ex. private well) will be allowed. A customer shall not connect, or allow any other person or party to connect, onto any water lines on his premises.

SECTION 2.0 – SERVICE RULES AND POLICIES (Continued)

Section 2.06 - Customer Service Inspections

Applicants for new service connections or facilities which have undergone extensive plumbing modifications are required to furnish the utility a completed customer service inspection certificate. The inspection certificate shall certify that the establishment is in compliance with the Texas Commission on Environmental Quality (TCEQ) Rules and Regulations for Public Water Systems, 30 TAC § 290.46(j). The Utility is not required to perform these inspections for the applicant/customer, but will assist the applicant/customer in locating and obtaining the services of a certified inspector.

Section 2.07 - Back Flow Prevention Devices

No water connection shall be allowed to any residence or establishment where an actual or potential contamination hazard exists unless the public water facilities are protected from contamination by either an approved air gap, backflow prevention assembly, or other approved device. The type of device or backflow prevention assembly required shall be determined by the specific potential hazard identified in 30 TAC § 290.47(i) Appendix I, Assessment of Hazards and Selection of Assemblies of the TCEQ Rules and Regulations for Public Water Systems.

The use of a backflow prevention assembly at the service connection shall be considered as additional backflow protection and shall not negate the use of backflow protection on internal hazards as outlined and enforced by local plumbing codes. When a customer service inspection certificate indicates that an adequate internal cross-connection control program is in effect, backflow protection at the water service entrance or meter is not required.

At any residence or establishment where it has been determined by a customer service inspection, that there is no actual or potential contamination hazard, as referenced in 30 TAC § 290.47(i) Appendix I, Assessment of Hazards and Selection of Assemblies of the TCEQ Rules and Regulations for Public Water Systems, then a backflow prevention assembly or device is not required. Outside hose bibs do require, at a minimum, the installation and maintenance of a working atmospheric vacuum breaker.

All backflow prevention assemblies or devices shall be tested upon installation by a TCEQ certified backflow prevention assembly tester and certified to be operating within specifications. Backflow prevention assemblies which are installed to provide protection against health hazards must also be tested and certified to be operating within specifications at least annually by a certified backflow prevention assembly tester.

If the utility determines that a backflow prevention assembly or device is required, the utility will provide the customer or applicant with a list of TCEQ certified backflow prevention assembly testers. The customer will be responsible for the cost of installation and testing, if any, of backflow prevention assembly or device. The customer should contact several qualified installers to compare prices before installation. The customer must pay for any required maintenance and annual testing and must furnish a copy of the test results demonstrating that the assembly is functioning properly to the utility within 30 days after the anniversary date of the installation unless a different date is agreed upon.

SECTION 2.0 -- SERVICE RULES AND POLICIES (Continued)

Section 2.08 - Access to Customer's Premises

The utility will have the right of access to the customer's premises at all reasonable times for the purpose of installing, testing, inspecting or repairing water mains or other equipment used in connection with its provision of water service, or for the purpose of removing its property and disconnecting lines, and for all other purposes necessary to the operation of the utility system including inspecting the customer's plumbing for code, plumbing or tariff violations.

The customer shall allow the utility and its personnel access to the customer's property to conduct any water quality tests or inspections required by law. Unless necessary to respond to equipment failure, leak or other condition creating an immediate threat to public health and safety or the continued provision of adequate utility service to others, such entry upon the customer's property shall be during normal business hours and the utility personnel will attempt to notify the customer that they will be working on the customer's property. The customer may require any utility representative, employee, contractor, or agent seeking to make such entry identify themselves, their affiliation with the utility, and the purpose of their entry.

All customers or service applicants shall provide access to meters and utility cutoff valves at all times reasonably necessary to conduct ordinary utility business and after normal business hours as needed to protect and preserve the integrity of the public drinking water supply.

Section 2.09 - Meter Requirements, Readings, and Testing

One meter is required for each residential, commercial, or industrial connection. All water sold by the utility will be billed based on meter measurements. The utility will provide, install, own and maintain meters to measure amounts of water consumed by its customers.

Meters will be read at monthly intervals and as nearly as possible on the corresponding day of each monthly meter reading period unless otherwise authorized by the Commission.

Meter tests. The utility will, upon the request of a customer, and, if the customer so desires, in his or her presence or in that of his or her authorized representative, make without charge a test of the accuracy of the customer's meter. If the customer asks to observe the test, the test will be made during the utility's normal working hours at a time convenient to the customer. Whenever possible, the test will be made on the customer's premises, but may, at the utility's discretion, be made at the utility's testing facility. If within a period of two years the customer requests a new test, the utility will make the test, but if the meter is found to be within the accuracy standards established by the American Water Works Association, the utility will charge the customer a fee which reflects the cost to test the meter up to a maximum \$25 for a residential customer. Following the completion of any requested test, the utility will promptly advise the customer of the date of removal of the meter, the date of the test, the result of the test, and who made the test.

Docket Number: 49311

SECTION 2.0 -- SERVICE RULES AND POLICIES (Continued)

Section 2.10 - Billing

(A) Regular Billing

Bills from the utility will be mailed monthly unless otherwise authorized by the Commission. The due date of bills for utility service will be at least sixteen (16) days from the date of issuance.

The postmark on the bill or, if there is no postmark on the bill, the recorded date of mailing by the utility will constitute proof of the date of issuance. Payment for utility service is delinquent if full payment, including late fees and the regulatory assessment, is not received at the utility or the utility's authorized payment agency by 5:00 p.m. on the due date. If the due date falls on a holiday or weekend, the due date for payment purposes will be the next workday after the due date.

(B) Late Fees

A late penalty of either \$5.00 or 10.0% will be charged on bills received after the due date. The penalty on delinquent bills will not be applied to any balance to which the penalty was applied in a previous billing. The utility must maintain a record of the date of mailing to charge the late penalty.

(C) Information on Bill

Each bill will provide all information required by the PUC Rules. For each of the systems it operates, the utility will maintain and note on the monthly bill a local or toll-free telephone number (or numbers) to which customers can direct questions about their utility service.

(D) Prorated Bills

If service is interrupted or seriously impaired for 24 consecutive hours or more, the utility will prorate the monthly base bill in proportion to the time service was not available to reflect this loss of service.

Section 2.11- Payments

All payments for utility service shall be delivered or mailed to the utility's business office. If the business office fails to receive payment prior to the time of noticed disconnection for non-payment of a delinquent account, service will be terminated as scheduled. Utility service crews shall not be allowed to collect payments on customer accounts in the field.

Payment of an account by any means that has been dishonored and returned by the payor or payee's bank, shall be deemed to be delinquent. All returned payments must be redeemed with cash or valid money order. If a customer has two returned payments within a twelve month period, the customer shall be required to pay a deposit if one has not already been paid.

Section 2.12 - Service Disconnection

(A) With Notice

Utility service may be disconnected if the bill has not been paid in full by the date listed on the termination notice. The termination date must be at least 10 days after the notice is mailed or hand delivered.

SECTION 2.0 -- SERVICE RULES AND POLICIES (Continued)

The utility is encouraged to offer a deferred payment plan to a customer who cannot pay an outstanding bill in full and is willing to pay the balance in reasonable installments. However, a customer's utility service may be disconnected if a bill has not been paid or a deferred payment agreement entered into within 26 days from the date of issuance of a bill and if proper notice of termination has been given.

Notice of termination must be a separate mailing or hand delivery in accordance with the PUC Rules.

B) Without Notice

Utility service may also be disconnected without notice for reasons as described in the PUC Rules.

Section 2.13 - Reconnection of Service

Utility personnel must be available during normal business hours to accept payments on the day service is disconnected and the following day unless service was disconnected at the customer's request or due to a hazardous condition.

Service will be reconnected within 36 hours after the past due bill, reconnect fees and any other outstanding charges are paid or the conditions which caused service to be disconnected are corrected.

Section 2.14 - Service Interruptions

The utility will make all reasonable efforts to prevent interruptions of service. If interruptions occur, the utility will re-establish service within the shortest possible time. Except for momentary interruptions due to automatic equipment operations, the utility will keep a complete record of all interruptions, both emergency and scheduled and will notify the Commission in writing of any service interruptions affecting the entire system or any major division of the system lasting more than four hours. The notice will explain the cause of the interruptions.

Section 2.15 - Quality of Service

The utility will plan, furnish, and maintain production, treatment, storage, transmission, and distribution facilities of sufficient size and capacity to provide a continuous and adequate supply of water for all reasonable consumer uses. Unless otherwise authorized by PUC and TCEQ, the utility will maintain facilities as described in the TCEQ Rules and Regulations for Public Water Systems.

Section 2.16 - Customer Complaints and Disputes

If a customer or applicant for service lodges a complaint, the utility will promptly make a suitable investigation and advise the complainant of the results. Service will not be disconnected pending completion of the investigation. If the complainant is dissatisfied with the utility's response, the utility must advise the complainant that he has recourse through the PUC complaint process. Pending resolution of a complaint, the commission may require continuation or restoration of service.

SECTION 2.0 -- SERVICE RULES AND POLICIES (Continued)

The utility will maintain a record of all complaints which shows the name and address of the complainant, the date and nature of the complaint and the adjustment or disposition thereof, for a period of two years after the final settlement of the complaint.

In the event of a dispute between a customer and a utility regarding any bill for utility service, the utility will conduct an investigation and report the results to the customer. If the dispute is not resolved, the utility will inform the customer that a complaint may be filed with the Commission.

Section 2.17 - Customer Liability

Customer shall be liable for any damage or injury to utility-owned property shown to be caused by the customer.

SECTION 3.0 -- EXTENSION POLICY

Section 3.01 - Standard Extension Requirements

Line Extension and Construction Charges. No Contribution in Aid of Construction may be required of any customer except as provided for in this approved tariff.

The Utility is not required to extend service to any applicant outside of its certified service area and will only do so under terms and conditions mutually agreeable to the Utility and the applicant, in compliance with PUC rules and policies, and upon extension of the Utility's certified service area boundaries by the PUC.

The applicant for service will be given an itemized statement of the costs, options such as rebates to the customer, sharing of construction costs between the utility and the customer, or sharing of costs between the customer and other applicants prior to beginning construction.

Section 3.02 - Costs Utilities and Service Applicants Shall Bear

Within its certified area, the utility will pay the cost of the first 200 feet of any water main or distribution line necessary to extend service to an individual residential customer within a platted subdivision.

However, if the residential customer requesting service purchased the property after the developer was notified in writing of the need to provide facilities to the utility, the utility may charge for the first 200 feet. The utility must also be able to document that the developer of the subdivision refused to provide facilities compatible with the utility's facilities in accordance with the utility's approved extension policy after receiving a written request from the utility.

Residential customers will be charged the equivalent of the costs of extending service to their property from the nearest transmission or distribution line even if that line does not have adequate capacity to serve the customer. However, if the customer places unique, non-standard service demands upon the system, the customer may be charged the additional cost of extending service to and throughout their property, including the cost of all necessary transmission and storage facilities necessary to meet the service demands anticipated to be created by that property.

Unless an exception is granted by the PUC, the residential service applicant shall not be required to pay for costs of main extensions greater than 2" in diameter for water distribution and pressure wastewater collection lines and 6" in diameter for gravity wastewater lines.

Exceptions may be granted by the PUC if:

- adequate service cannot be provided to the applicant using the maximum line sizes listed due to distance or elevation, in which case, it shall be the utility's burden to justify that a larger diameter pipe is required for adequate service;
- or larger minimum line sizes are required under subdivision platting requirements or building codes of municipalities within whose corporate limits or extraterritorial jurisdiction the point of use is located; or the residential service applicant is located outside the CCN service area.

Docket Number: 49311

SECTION 3.0 -- EXTENSION POLICY (Continued)

If an exception is granted, by the PUC, the utility shall establish a proportional cost plan for the specific extension or a rebate plan which may be limited to seven years to return the portion of the applicant's costs for oversizing as new customers are added to ensure that future applicants for service on the line pay at least as much as the initial service applicant.

For purposes of determining the costs that service applicants shall pay, commercial customers with service demands greater than residential customer demands in the certified area, industrial, and wholesale customers shall be treated as developers. A service applicant requesting a one inch meter for a lawn sprinkler system to service a residential lot is not considered nonstandard service.

If an applicant requires service other than the standard service provided by the utility, such applicant will be required to pay all expenses incurred by the utility in excess of the expenses that would be incurred in providing the standard service and connection beyond 200 feet and throughout his property including the cost of all necessary transmission facilities.

The utility will bear the full cost of any over-sizing of water mains necessary to serve other customers in the immediate area. The individual residential customer shall not be charged for any additional production, storage, or treatment facilities. Contributions in aid of construction may not be required of individual residential customers for production, storage, treatment or transmission facilities unless otherwise approved by the Commission under this specific extension policy.

Section 3.03 - Contributions in Aid of Construction

Developers may be required to provide contributions in aid of construction in amounts sufficient to furnish the development with all facilities necessary to provide for reasonable local demand requirements and to comply with TCEQ minimum design criteria for facilities used in the production, transmission, pumping, or treatment of water or TCEQ minimum requirements. For purposes of this subsection, a developer is one who subdivides or requests more than two meters on a piece of property. Commercial, industrial, and wholesale customers will be treated as developers.

Any applicant who places unique or non-standard service demands on the system may be required to provide contributions in aid of construction for the actual costs of any additional facilities required to maintain compliance with the TCEQ minimum design criteria for water production, treatment, pumping, storage and transmission.

Any service extension to a subdivision (recorded or unrecorded) may be subject to the provisions and restrictions of 16 TAC § 24.86(d). When a developer wishes to extend the system to prepare to service multiple new connections, the charge shall be the cost of such extension, plus a pro-rata charge for facilities which must be committed to such extension compliant with the TCEQ minimum design criteria. As provided by 16 TAC § 24.85(e)(3), for purposes of this section, commercial, industrial, and wholesale customers shall be treated as developers.

SECTION 3.0 -- EXTENSION POLICY (Continued)

A utility may only charge a developer standby fees for unrecovered costs of facilities committed to a developer's property under the following circumstances:

- Under a contract and only in accordance with the terms of the contract; or
- if service is not being provided to a lot or lots within two years after installation of facilities necessary to provide service to the lots has been completed and if the standby fees are included on the utilities approved tariff after a rate change application has been filed. The fees cannot be billed to the developer or collected until the standby fees have been approved by the commission or executive director.
- for purposes of this section, a manufactured housing rental community can only be charged standby fees under a contract or if the utility installs the facilities necessary to provide individually metered service to each of the rental lots or spaces in the community.

Section 3.04 - Appealing Connection Costs

The imposition of additional extension costs or charges as provided by Sections 3.0 - Extension Policy of this tariff shall be subject to appeal as provided in this tariff, PUC rules, or the rules of such other regulatory authority as may have jurisdiction over the utility's rates and services.

Any applicant required to pay for any costs not specifically set forth in the rate schedule pages of this tariff shall be given a written explanation of such costs prior to payment and/or commencement of construction. If the applicant does not believe that these costs are reasonable or necessary, the applicant shall be informed of the right to appeal such costs to the PUC or such other regulatory authority having jurisdiction over the utility's rates in that portion of the utility's service area in which the applicant's property(ies) is located.

Section 3.05 - Applying for Service

The Utility will provide a written service application form to the applicant for each request for service received by the Utility's business offices. A separate application shall be required for each potential service location if more than one service connection is desired by any individual applicant. Service application forms will be available at the Utility's business office during normal weekday business hours. Service applications will be sent by prepaid first class United States mail to the address provided by the applicant upon request. Completed applications should be returned by hand delivery in case there are questions which might delay fulfilling the service request. Completed service applications may be submitted by mail if hand delivery is not possible.

Where a new tap or service connection is required, the service applicant shall be required to submit a written service application and request that a tap be made. A diagram, map, plat, or written metes and bounds description of precisely where the applicant desires each tap or service connection is to be made and, if necessary, where the meter is to be installed, along the applicant's property line may also be required with the tap request.

Docket Number: 49311

SECTION 3.0 -- EXTENSION POLICY (Continued)

The actual point of connection and meter installation must be readily accessible to Utility personnel for inspection, servicing, and meter reading while being reasonably secure from damage by vehicles and mowers. If the Utility has more than one main adjacent to the service applicant's property, the tap or service connection will be made to the Utility's nearest service main with adequate capacity to service the applicant's full potential service demand. Beyond the initial 200 feet, the customer shall bear only the equivalent cost of extending from the nearest main. If the tap or service connection cannot be made at the applicant's desired location, it will be made at another location mutually acceptable to the applicant and the Utility. If no agreement on location can be made, the applicant may refer the matter to the PUC for resolution.

Section 3.06 - Qualified Service Applicant

A "qualified service applicant" is an applicant who has: (1) met all of the Utility's requirements for service contained in this tariff, PUC rules and/or PUC order, (2) has made payment or made arrangement for payment of tap fees, (3) has provided all easements and rights-of-way required to provide service to the requested location, (4) delivered an executed customer service inspection certificate to the Utility, if applicable, and (5) has executed a customer service application for each location to which service is being requested.

The utility shall serve each qualified service applicant within its certified service area as soon as practical after receiving a completed service application. All service requests will be fulfilled within the time limits prescribed by PUC rules once the applicant has met all conditions precedent to achieving "qualified service applicant" status. If a service request cannot be fulfilled within the required period, the applicant shall be notified in writing of the delay, its cause and the anticipated date that service will be available. The PUC service dates shall not become applicable until the service applicant has met all conditions precedent to becoming a qualified service applicant as defined by PUC rules.

Section 3.07 - Developer Requirements

As a condition of service to a new subdivision, the Utility shall require a developer (as defined by PUC rule) to provide permanent recorded public utility easements as a condition of service to any location within the developer's property.

APPENDIX A – DROUGHT CONTINGENCY PLAN

“This page incorporates by reference the utility’s Drought Contingency Plan, as approved and periodically amended by the Texas Commission on Environmental Quality.”

APPENDIX B -- SAMPLE SERVICE AGREEMENT
From 30 TAC Chapter 290.47(b), Appendix B
SERVICE AGREEMENT

- I. **PURPOSE.** The NAME OF WATER SYSTEM is responsible for protecting the drinking water supply from contamination or pollution which could result from improper private water distribution system construction or configuration. The purpose of this service agreement is to notify each customer of the restrictions which are in place to provide this protection. The utility enforces these restrictions to ensure the public health and welfare. Each customer must sign this agreement before the NAME OF WATER SYSTEM will begin service. In addition, when service to an existing connection has been suspended or terminated, the water system will not re-establish service unless it has a signed copy of this agreement.
- II. **RESTRICTIONS.** The following unacceptable practices are prohibited by State regulations.
- A. No direct connection between the public drinking water supply and a potential source of contamination is permitted. Potential sources of contamination shall be isolated from the public water system by an air-gap or an appropriate backflow prevention device.
 - B. No cross-connection between the public drinking water supply and a private water system is permitted. These potential threats to the public drinking water supply shall be eliminated at the service connection by the installation of an air-gap or a reduced pressure-zone backflow prevention device.
 - C. No connection which allows water to be returned to the public drinking water supply is permitted.
 - D. No pipe or pipe fitting which contains more than 0.25% lead may be used for the installation or repair of plumbing at any connection which provides water for human use.
 - E. No solder or flux which contains more than 0.2% lead can be used for the installation or repair of plumbing at any connection which provides water for human use.
- III. **SERVICE AGREEMENT.** The following are the terms of the service agreement between the NAME OF WATER SYSTEM (the Water System) and NAME OF CUSTOMER (the Customer).
- A. The Water System will maintain a copy of this agreement as long as the Customer and/or the premises is connected to the Water System.
 - B. The Customer shall allow his property to be inspected for possible cross-connections and other potential contamination hazards. These inspections shall be conducted by the Water System or its designated agent prior to initiating new water service; when there is reason to believe that cross-connections or other potential contamination hazards exist; or after any major changes to the private water distribution facilities. The inspections shall be conducted during the Water System's normal business hours.
 - C. The Water System shall notify the Customer in writing of any cross-connection or other potential contamination hazard which has been identified during the initial inspection or the periodic reinspection.
 - D. The Customer shall immediately remove or adequately isolate any potential cross-connections or other potential contamination hazards on his premises.
 - E. The Customer shall, at his expense, properly install, test, and maintain any backflow prevention device required by the Water System. Copies of all testing and maintenance records shall be provided to the Water System.
- IV. **ENFORCEMENT.** If the Customer fails to comply with the terms of the Service Agreement, the Water System shall, at its option, either terminate service or properly install, test, and maintain an appropriate backflow prevention device at the service connection. Any expenses associated with the enforcement of this agreement shall be billed to the Customer.

CUSTOMER'S SIGNATURE: _____

DATE: _____

APPENDIX C -- APPLICATION FOR SERVICE
(Utility Must Attach Blank Copy)



SEWER UTILITY TARIFF

Docket Number: 49311

Park Water Company
(Utility Name)

7107 FM 307
(Business Address)

Midland, Texas 79706
(City, State, Zip Code)

(432) 687-2070
(Area Code/Telephone)

This tariff is effective for utility operations under the following Certificate of Convenience and Necessity:

21115

This tariff is effective in the following counties:

Midland

This tariff is effective in the following cities or unincorporated towns (if any):

Greenwood (unincorporated area)

This tariff is effective in the following subdivisions and public water systems:

Vander Ranch, WQ0015661-001

TABLE OF CONTENTS

The above utility lists the following sections of its tariff (if additional pages are needed for a section, all pages should be numbered consecutively):

SECTION 1.0 -- RATE SCHEDULE.....	2
SECTION 2.0 -- SERVICE RULES AND POLICIES.....	4
SECTION 3.0 -- EXTENSION POLICY	11

APPENDIX A – DROUGHT CONTINGENCY PLAN

APPENDIX B – SAMPLE SERVICE AGREEMENT

APPENDIX C – APPLICATION FOR SERVICE

SECTION 1.0 - RATE SCHEDULE

Section 1.01 - Rates

Meter Size	Monthly Minimum Charge	Gallonge Charge
5/8" or 3/4"	\$134.66 (Includes zero gallons)	\$13.26 per 1000 gallons
1"	\$336.65	\$13.26 per 1000 gallons
1½"	\$673.30	\$13.26 per 1000 gallons
2"	\$1,077.28	\$13.26 per 1000 gallons
3"	\$2,019.90	\$13.26 per 1000 gallons
4"	\$2,693.20	\$13.26 per 1000 gallons

Volume charges are determined based on average water consumption for the winter period which includes the following months: December, January, and February. The monthly billing for new residential connections shall be based on 5,000 gallons per month until a winter average water consumption is established. Billing for non-residential connections shall be based on actual water monthly water consumption.

FORM OF PAYMENT: The utility will accept the following forms of payment:

Cash X, Check X, Money Order X, Credit Card X, Other (specify)____
THE UTILITY MAY REQUIRE EXACT CHANGE FOR PAYMENTS AND MAY REFUSE TO ACCEPT PAYMENTS MADE USING MORE THAN \$1.00 IN SMALL COINS. A WRITTEN RECEIPT WILL BE GIVEN FOR CASH PAYMENTS.

REGULATORY ASSESSMENT 1.0%
PUC RULES REQUIRE THE UTILITY TO COLLECT A FEE OF ONE PERCENT OF THE RETAIL MONTHLY BILL AND TO REMIT FEE TO THE TCEQ.

Section 1.02 - Miscellaneous Fees

TAP FEE \$750.00
TAP FEE COVERS THE UTILITY'S COSTS FOR MATERIALS AND LABOR TO INSTALL A STANDARD RESIDENTIAL 5/8" or 3/4" METER. AN ADDITIONAL FEE TO COVER UNIQUE COSTS IS PERMITTED IF LISTED ON THIS TARIFF.

TAP FEE (Unique costs)..... Actual Cost
FOR EXAMPLE, A ROAD BORE FOR CUSTOMERS OUTSIDE OF SUBDIVISIONS OR RESIDENTIAL AREAS.

TAP FEE (Large meter)..... Actual Cost
TAP FEE IS THE UTILITY'S ACTUAL COST FOR MATERIALS AND LABOR FOR METER SIZE INSTALLED.

METER RELOCATION FEE Actual Relocation Cost, Not to Exceed Tap Fee
THIS FEE MAY BE CHARGED IF A CUSTOMER REQUESTS THAT AN EXISTING METER BE RELOCATED.

METER TEST FEE \$25.00
THIS FEE WHICH SHOULD REFLECT THE UTILITY'S COST MAY BE CHARGED IF A CUSTOMER REQUESTS A SECOND METER TEST WITHIN A TWO-YEAR PERIOD AND THE TEST INDICATES THAT THE METER IS RECORDING ACCURATELY. THE FEE MAY NOT EXCEED \$25.

RECONNECTION FEE

THE RECONNECT FEE MUST BE PAID BEFORE SERVICE CAN BE RESTORED TO A CUSTOMER WHO HAS BEEN DISCONNECTED FOR THE FOLLOWING REASONS (OR OTHER REASONS LISTED UNDER SECTION 2.0 OF THIS TARIFF):

a) Non-payment of bill (Maximum \$25.00).....	<u>\$25.00</u>
b) Customer's request that service be disconnected	<u>\$50.00</u>

Docket Number: 49311

SECTION 1.0 - RATE SCHEDULE (Continued)

TRANSFER FEE \$35.00
THE TRANSFER FEE WILL BE CHARGED FOR CHANGING AN ACCOUNT NAME AT THE SAME SERVICE LOCATION WHEN THE SERVICE IS NOT DISCONNECTED.

LATE CHARGE (EITHER \$5.00 OR 10% OF THE BILL)..... 10%
PUC RULES ALLOW A ONE-TIME PENALTY TO BE CHARGED ON DELINQUENT BILLS. A LATE CHARGE MAY NOT BE APPLIED TO ANY BALANCE TO WHICH THE PENALTY WAS APPLIED IN A PREVIOUS BILLING.

RETURNED CHECK CHARGE \$30.00
RETURNED CHECK CHARGES MUST BE BASED ON THE UTILITY'S DOCUMENTABLE COST.

CUSTOMER DEPOSIT RESIDENTIAL (Maximum \$50) \$50.00

COMMERCIAL & NON-RESIDENTIAL DEPOSIT 1/6TH OF ESTIMATED ANNUAL BILL

GOVERNMENTAL TESTING, INSPECTION AND COSTS SURCHARGE:
WHEN AUTHORIZED IN WRITING BY PUC AND AFTER NOTICE TO CUSTOMERS, THE UTILITY MAY INCREASE RATES TO RECOVER INCREASED COSTS FOR INSPECTION FEES AND WATER TESTING. [16 TAC 24.21(b)(2)(F)]

LINE EXTENSION AND CONSTRUCTION CHARGES:
REFER TO SECTION 3.0--EXTENSION POLICY FOR TERMS, CONDITIONS, AND CHARGES WHEN NEW CONSTRUCTION IS NECESSARY TO PROVIDE SERVICE.

SECTION 2.0 -- SERVICE RULES AND POLICIES

The utility will have the most current Public Utility Commission of Texas (PUC or Commission) Rules, Chapter 24, available at its office for reference purposes. The Rules and this tariff shall be available for public inspection and reproduction at a reasonable cost. The latest Rules or Commission approved changes to the Rules supersede any rules or requirements in this tariff.

Section 2.01 - Application for Sewer Service

All applications for service will be made on the utility's standard application or contract form (attached in the Appendix to this tariff), will be signed by the applicant, any required fees (deposits, reconnect, tap, extension fees, etc. as applicable) will be paid and easements, if required, will be granted before service is provided by the utility. A separate application or contract will be made for each service location.

Section 2.02 - Refusal of Service

The utility may decline to serve an applicant until the applicant has complied with the regulations of the regulatory agencies (state and municipal regulations) and for the reasons outlined in the PUC Rules. In the event that the utility refuses to serve an applicant, the utility will inform the applicant in writing of the basis of its refusal. The utility is also required to inform the applicant that a complaint may be filed with the Commission.

Section 2.03 - Fees and Charges & Easements Required Before Service Can Be Connected

(A) Customer Deposits

If a residential applicant cannot establish credit to the satisfaction of the utility, the applicant may be required to pay a deposit as provided for in Section 1.02 - Miscellaneous Fees of this tariff. The utility will keep records of the deposit and credit interest in accordance with PUC Rules.

Residential applicants 65 years of age or older may not be required to pay deposits unless the applicant has an outstanding account balance with the utility or another water or sewer utility which accrued within the last two years.

Nonresidential applicants who cannot establish credit to the satisfaction of the utility may be required to make a deposit that does not exceed an amount equivalent to one-sixth of the estimated annual billings.

Refund of deposit. If service is not connected, or after disconnection of service, the utility will promptly refund the customer's deposit plus accrued interest or the balance, if any, in excess of the unpaid bills for service furnished. The utility may refund the deposit at any time prior to termination of utility service but must refund the deposit plus interest for any residential customer who has paid 18 consecutive billings without being delinquent.

SECTION 2.0 – SERVICE RULES AND POLICIES (Continued)

(B) Tap or Reconnect Fees

A new customer requesting service at a location where service has not previously been provided must pay a tap fee as provided in Section 1. A customer requesting service where service has previously been provided must pay a reconnect fee as provided in Section 1. Any applicant or existing customer required to pay for any costs not specifically set forth in the rate schedule pages of this tariff shall be given a written explanation of such costs prior to request for payment and/or commencement of construction.

If the applicant or existing customer does not believe that these costs are reasonable or necessary, the applicant or existing customer shall be informed of their right to appeal such costs to the PUC or such other regulatory authority having jurisdiction over the utility's rates in that portion of the utility's service area in which the applicant's or existing customer's property(ies) is located.

Fees in addition to the regular tap fee may be charged if listed specifically in Section 1 to cover unique costs not normally incurred as permitted by 16 TAC § 24.86(a)(1)(C). For example, a road bore for customers outside a subdivision or residential area could be considered a unique cost.

(C) Easement Requirement

Where recorded public utility easements on the service applicant's property do not exist or public road right-of-way easements are not available to access the applicant's property, the Utility may require the applicant to provide it with a permanent recorded public utility easement on and across the applicant's real property sufficient to provide service to that applicant. Such easement(s) shall not be used for the construction of production, storage, transmission or pressure facilities unless they are needed for adequate service to that applicant.

Section 2.04 - Utility Response to Applications for Service

After the applicant has met all the requirements, conditions and regulations for service, the utility will install tap, meter and utility cut-off valve and/or take all necessary actions to initiate service. The utility will serve each qualified applicant for service within 5 working days unless line extensions or new facilities are required. If construction is required to fill the order and if it cannot be completed within 30 days, the utility will provide the applicant with a written explanation of the construction required and an expected date of service.

Except for good cause where service has previously been provided, service will be reconnected within one working day after the applicant has met the requirements for reconnection.

Section 2.05 - Customer Responsibility

The customer will be responsible for furnishing and laying the necessary customer service pipe from the meter location to the place of consumption. Customers will not be allowed to use the utility's cutoff valve on the utility's side of the meter. Existing customers may install cutoff valves on their side of the meter and are encouraged to do so. All new customers may be required to install and maintain a cutoff valve on their side of the meter.

SECTION 2.0 – SERVICE RULES AND POLICIES (Continued)

No direct connection between a public water supply system and any potential source of contamination or between a public water supply system and a private water source (ex. private well) will be allowed. A customer shall not connect, or allow any other person or party to connect, onto any water lines on his premises.

Section 2.06 - Customer Service Inspections

Applicants for new service connections or facilities which have undergone extensive plumbing modifications are required to furnish the utility a completed customer service inspection certificate. The inspection certificate shall certify that the establishment is in compliance with the Texas Commission on Environmental Quality (TCEQ) Rules and Regulations for Public Water Systems, 30 TAC § 290.46(j). The Utility is not required to perform these inspections for the applicant/customer, but will assist the applicant/customer in locating and obtaining the services of a certified inspector.

Section 2.07 - Back Flow Prevention Devices

No water connection shall be allowed to any residence or establishment where an actual or potential contamination hazard exists unless the public water facilities are protected from contamination by either an approved air gap, backflow prevention assembly, or other approved device. The type of device or backflow prevention assembly required shall be determined by the specific potential hazard identified in 30 TAC § 290.47(i) Appendix I, Assessment of Hazards and Selection of Assemblies of the TCEQ Rules and Regulations for Public Water Systems.

The use of a backflow prevention assembly at the service connection shall be considered as additional backflow protection and shall not negate the use of backflow protection on internal hazards as outlined and enforced by local plumbing codes. When a customer service inspection certificate indicates that an adequate internal cross-connection control program is in effect, backflow protection at the water service entrance or meter is not required.

At any residence or establishment where it has been determined by a customer service inspection, that there is no actual or potential contamination hazard, as referenced in 30 TAC § 290.47(i) Appendix I, Assessment of Hazards and Selection of Assemblies of the TCEQ Rules and Regulations for Public Water Systems, then a backflow prevention assembly or device is not required. Outside hose bibs do require, at a minimum, the installation and maintenance of a working atmospheric vacuum breaker.

All backflow prevention assemblies or devices shall be tested upon installation by a TCEQ certified backflow prevention assembly tester and certified to be operating within specifications. Backflow prevention assemblies which are installed to provide protection against health hazards must also be tested and certified to be operating within specifications at least annually by a certified backflow prevention assembly tester.

If the utility determines that a backflow prevention assembly or device is required, the utility will provide the customer or applicant with a list of TCEQ certified backflow prevention assembly testers. The customer will be responsible for the cost of installation and testing, if any, of backflow prevention

SECTION 2.0 -- SERVICE RULES AND POLICIES (Continued)

assembly or device. The customer should contact several qualified installers to compare prices before installation. The customer must pay for any required maintenance and annual testing and must furnish a copy of the test results demonstrating that the assembly is functioning properly to the utility within 30 days after the anniversary date of the installation unless a different date is agreed upon.

Section 2.08 - Access to Customer's Premises

The utility will have the right of access to the customer's premises at all reasonable times for the purpose of installing, testing, inspecting or repairing water mains or other equipment used in connection with its provision of water service, or for the purpose of removing its property and disconnecting lines, and for all other purposes necessary to the operation of the utility system including inspecting the customer's plumbing for code, plumbing or tariff violations.

The customer shall allow the utility and its personnel access to the customer's property to conduct any water quality tests or inspections required by law. Unless necessary to respond to equipment failure, leak or other condition creating an immediate threat to public health and safety or the continued provision of adequate utility service to others, such entry upon the customer's property shall be during normal business hours and the utility personnel will attempt to notify the customer that they will be working on the customer's property. The customer may require any utility representative, employee, contractor, or agent seeking to make such entry identify themselves, their affiliation with the utility, and the purpose of their entry.

All customers or service applicants shall provide access to meters and utility cutoff valves at all times reasonably necessary to conduct ordinary utility business and after normal business hours as needed to protect and preserve the integrity of the public drinking water supply.

Section 2.09 - Meter Requirements, Readings, and Testing

One meter is required for each residential, commercial, or industrial connection. All water sold by the utility will be billed based on meter measurements. The utility will provide, install, own and maintain meters to measure amounts of water consumed by its customers.

Meters will be read at monthly intervals and as nearly as possible on the corresponding day of each monthly meter reading period unless otherwise authorized by the Commission.

Meter tests. The utility will, upon the request of a customer, and, if the customer so desires, in his or her presence or in that of his or her authorized representative, make without charge a test of the accuracy of the customer's meter. If the customer asks to observe the test, the test will be made during the utility's normal working hours at a time convenient to the customer. Whenever possible, the test will be made on the customer's premises, but may, at the utility's discretion, be made at the utility's testing facility. If within a period of two years the customer requests a new test, the utility will make the test, but if the meter is found to be within the accuracy standards established by the American Water Works Association, the utility will charge the customer a fee which reflects the cost to test the meter up to a maximum \$25 for a residential customer. Following the completion of any requested

SECTION 2.0 -- SERVICE RULES AND POLICIES (Continued)

test, the utility will promptly advise the customer of the date of removal of the meter, the date of the test, the result of the test, and who made the test.

Section 2.10 - Billing

(A) Regular Billing

Bills from the utility will be mailed monthly unless otherwise authorized by the Commission. The due date of bills for utility service will be at least sixteen (16) days from the date of issuance.

The postmark on the bill or, if there is no postmark on the bill, the recorded date of mailing by the utility will constitute proof of the date of issuance. Payment for utility service is delinquent if full payment, including late fees and the regulatory assessment, is not received at the utility or the utility's authorized payment agency by 5:00 p.m. on the due date. If the due date falls on a holiday or weekend, the due date for payment purposes will be the next workday after the due date.

(B) Late Fees

A late penalty of either \$5.00 or 10.0% will be charged on bills received after the due date. The penalty on delinquent bills will not be applied to any balance to which the penalty was applied in a previous billing. The utility must maintain a record of the date of mailing to charge the late penalty.

(C) Information on Bill

Each bill will provide all information required by the PUC Rules. For each of the systems it operates, the utility will maintain and note on the monthly bill a local or toll-free telephone number (or numbers) to which customers can direct questions about their utility service.

(D) Prorated Bills

If service is interrupted or seriously impaired for 24 consecutive hours or more, the utility will prorate the monthly base bill in proportion to the time service was not available to reflect this loss of service.

Section 2.11 - Payments

All payments for utility service shall be delivered or mailed to the utility's business office. If the business office fails to receive payment prior to the time of noticed disconnection for non-payment of a delinquent account, service will be terminated as scheduled. Utility service crews shall not be allowed to collect payments on customer accounts in the field.

Payment of an account by any means that has been dishonored and returned by the payor or payee's bank, shall be deemed to be delinquent. All returned payments must be redeemed with cash or valid money order. If a customer has two returned payments within a twelve-month period, the customer shall be required to pay a deposit if one has not already been paid.

SECTION 2.0 -- SERVICE RULES AND POLICIES (Continued)

Section 2.12 - Service Disconnection

(A) With Notice

Utility service may be disconnected if the bill has not been paid in full by the date listed on the termination notice. The termination date must be at least 10 days after the notice is mailed or hand delivered.

The utility is encouraged to offer a deferred payment plan to a customer who cannot pay an outstanding bill in full and is willing to pay the balance in reasonable installments. However, a customer's utility service may be disconnected if a bill has not been paid or a deferred payment agreement entered into within 26 days from the date of issuance of a bill and if proper notice of termination has been given.

Notice of termination must be a separate mailing or hand delivery in accordance with the PUC Rules.

B) Without Notice

Utility service may also be disconnected without notice for reasons as described in the PUC Rules.

Section 2.13 - Reconnection of Service

Utility personnel must be available during normal business hours to accept payments on the day service is disconnected and the following day unless service was disconnected at the customer's request or due to a hazardous condition.

Service will be reconnected within 36 hours after the past due bill, reconnect fees and any other outstanding charges are paid or the conditions which caused service to be disconnected are corrected.

Section 2.14 - Service Interruptions

The utility will make all reasonable efforts to prevent interruptions of service. If interruptions occur, the utility will re-establish service within the shortest possible time. Except for momentary interruptions due to automatic equipment operations, the utility will keep a complete record of all interruptions, both emergency and scheduled and will notify the Commission in writing of any service interruptions affecting the entire system or any major division of the system lasting more than four hours. The notice will explain the cause of the interruptions.

Section 2.15 - Quality of Service

The utility will plan, furnish, and maintain production, treatment, storage, transmission, and distribution facilities of sufficient size and capacity to provide a continuous and adequate supply of water for all reasonable consumer uses. Unless otherwise authorized by PUC and TCEQ, the utility will maintain facilities as described in the TCEQ Rules and Regulations for Public Water Systems.

SECTION 2.0 -- SERVICE RULES AND POLICIES (Continued)

Section 2.16 - Customer Complaints and Disputes

If a customer or applicant for service lodges a complaint, the utility will promptly make a suitable investigation and advise the complainant of the results. Service will not be disconnected pending completion of the investigation. If the complainant is dissatisfied with the utility's response, the utility must advise the complainant that he has recourse through the PUC complaint process. Pending resolution of a complaint, the commission may require continuation or restoration of service.

The utility will maintain a record of all complaints which shows the name and address of the complainant, the date and nature of the complaint and the adjustment or disposition thereof, for a period of two years after the final settlement of the complaint.

In the event of a dispute between a customer and a utility regarding any bill for utility service, the utility will conduct an investigation and report the results to the customer. If the dispute is not resolved, the utility will inform the customer that a complaint may be filed with the Commission.

Section 2.17 - Customer Liability

Customer shall be liable for any damage or injury to utility-owned property shown to be caused by the customer.

SECTION 3.0 -- EXTENSION POLICY

Section 3.01 - Standard Extension Requirements

Line Extension and Construction Charges. No Contribution in Aid of Construction may be required of any customer except as provided for in this approved tariff.

The Utility is not required to extend service to any applicant outside of its certified service area and will only do so under terms and conditions mutually agreeable to the Utility and the applicant, in compliance with PUC rules and policies, and upon extension of the Utility's certified service area boundaries by the PUC.

The applicant for service will be given an itemized statement of the costs, options such as rebates to the customer, sharing of construction costs between the utility and the customer, or sharing of costs between the customer and other applicants prior to beginning construction.

Section 3.02 - Costs Utilities and Service Applicants Shall Bear

Within its certified area, the utility will pay the cost of the first 200 feet of any water main or distribution line necessary to extend service to an individual residential customer within a platted subdivision.

However, if the residential customer requesting service purchased the property after the developer was notified in writing of the need to provide facilities to the utility, the utility may charge for the first 200 feet. The utility must also be able to document that the developer of the subdivision refused to provide facilities compatible with the utility's facilities in accordance with the utility's approved extension policy after receiving a written request from the utility.

Residential customers will be charged the equivalent of the costs of extending service to their property from the nearest transmission or distribution line even if that line does not have adequate capacity to serve the customer. However, if the customer places unique, non-standard service demands upon the system, the customer may be charged the additional cost of extending service to and throughout their property, including the cost of all necessary transmission and storage facilities necessary to meet the service demands anticipated to be created by that property.

Unless an exception is granted by the PUC, the residential service applicant shall not be required to pay for costs of main extensions greater than 2" in diameter for water distribution and pressure wastewater collection lines and 6" in diameter for gravity wastewater lines.

Exceptions may be granted by the PUC if:

- adequate service cannot be provided to the applicant using the maximum line sizes listed due to distance or elevation, in which case, it shall be the utility's burden to justify that a larger diameter pipe is required for adequate service;
- or larger minimum line sizes are required under subdivision platting requirements or building codes of municipalities within whose corporate limits or extraterritorial jurisdiction the point of use is located; or the residential service applicant is located outside the CCN service area.

SECTION 3.0 -- EXTENSION POLICY (Continued)

If an exception is granted, by the PUC, the utility shall establish a proportional cost plan for the specific extension or a rebate plan which may be limited to seven years to return the portion of the applicant's costs for oversizing as new customers are added to ensure that future applicants for service on the line pay at least as much as the initial service applicant.

For purposes of determining the costs that service applicants shall pay, commercial customers with service demands greater than residential customer demands in the certified area, industrial, and wholesale customers shall be treated as developers. A service applicant requesting a one inch meter for a lawn sprinkler system to service a residential lot is not considered nonstandard service.

If an applicant requires service other than the standard service provided by the utility, such applicant will be required to pay all expenses incurred by the utility in excess of the expenses that would be incurred in providing the standard service and connection beyond 200 feet and throughout his property including the cost of all necessary transmission facilities.

The utility will bear the full cost of any over-sizing of water mains necessary to serve other customers in the immediate area. The individual residential customer shall not be charged for any additional production, storage, or treatment facilities. Contributions in aid of construction may not be required of individual residential customers for production, storage, treatment or transmission facilities unless otherwise approved by the Commission under this specific extension policy.

Section 3.03 - Contributions in Aid of Construction

Developers may be required to provide contributions in aid of construction in amounts sufficient to furnish the development with all facilities necessary to provide for reasonable local demand requirements and to comply with TCEQ minimum design criteria for facilities used in the production, transmission, pumping, or treatment of water or TCEQ minimum requirements. For purposes of this subsection, a developer is one who subdivides or requests more than two meters on a piece of property. Commercial, industrial, and wholesale customers will be treated as developers.

Any applicant who places unique or non-standard service demands on the system may be required to provide contributions in aid of construction for the actual costs of any additional facilities required to maintain compliance with the TCEQ minimum design criteria for water production, treatment, pumping, storage and transmission.

Any service extension to a subdivision (recorded or unrecorded) may be subject to the provisions and restrictions of 16 TAC § 24.86(d). When a developer wishes to extend the system to prepare to service multiple new connections, the charge shall be the cost of such extension, plus a pro-rata charge for facilities which must be committed to such extension compliant with the TCEQ minimum design criteria. As provided by 16 TAC § 24.85(e)(3), for purposes of this section, commercial, industrial, and wholesale customers shall be treated as developers.

SECTION 3.0 -- EXTENSION POLICY (Continued)

A utility may only charge a developer standby fees for unrecovered costs of facilities committed to a developer's property under the following circumstances:

- Under a contract and only in accordance with the terms of the contract; or
- if service is not being provided to a lot or lots within two years after installation of facilities necessary to provide service to the lots has been completed and if the standby fees are included on the utilities approved tariff after a rate change application has been filed. The fees cannot be billed to the developer or collected until the standby fees have been approved by the commission or executive director.
- for purposes of this section, a manufactured housing rental community can only be charged standby fees under a contract or if the utility installs the facilities necessary to provide individually metered service to each of the rental lots or spaces in the community.

Section 3.04 - Appealing Connection Costs

The imposition of additional extension costs or charges as provided by Sections 3.0 - Extension Policy of this tariff shall be subject to appeal as provided in this tariff, PUC rules, or the rules of such other regulatory authority as may have jurisdiction over the utility's rates and services.

Any applicant required to pay for any costs not specifically set forth in the rate schedule pages of this tariff shall be given a written explanation of such costs prior to payment and/or commencement of construction. If the applicant does not believe that these costs are reasonable or necessary, the applicant shall be informed of the right to appeal such costs to the PUC or such other regulatory authority having jurisdiction over the utility's rates in that portion of the utility's service area in which the applicant's property(ies) is located.

Section 3.05 - Applying for Service

The Utility will provide a written service application form to the applicant for each request for service received by the Utility's business offices. A separate application shall be required for each potential service location if more than one service connection is desired by any individual applicant. Service application forms will be available at the Utility's business office during normal weekday business hours. Service applications will be sent by prepaid first class United States mail to the address provided by the applicant upon request. Completed applications should be returned by hand delivery in case there are questions which might delay fulfilling the service request. Completed service applications may be submitted by mail if hand delivery is not possible.

Where a new tap or service connection is required, the service applicant shall be required to submit a written service application and request that a tap be made. A diagram, map, plat, or written metes and bounds description of precisely where the applicant desires each tap or service connection is to be made and, if necessary, where the meter is to be installed, along the applicant's property line may also be required with the tap request.

SECTION 3.0 -- EXTENSION POLICY (Continued)

The actual point of connection and meter installation must be readily accessible to Utility personnel for inspection, servicing, and meter reading while being reasonably secure from damage by vehicles and mowers. If the Utility has more than one main adjacent to the service applicant's property, the tap or service connection will be made to the Utility's nearest service main with adequate capacity to service the applicant's full potential service demand. Beyond the initial 200 feet, the customer shall bear only the equivalent cost of extending from the nearest main. If the tap or service connection cannot be made at the applicant's desired location, it will be made at another location mutually acceptable to the applicant and the Utility. If no agreement on location can be made, the applicant may refer the matter to the PUC for resolution.

Section 3.06 - Qualified Service Applicant

A "qualified service applicant" is an applicant who has: (1) met all of the Utility's requirements for service contained in this tariff, PUC rules and/or PUC order, (2) has made payment or made arrangement for payment of tap fees, (3) has provided all easements and rights-of-way required to

provide service to the requested location, (4) delivered an executed customer service inspection certificate to the Utility, if applicable, and (5) has executed a customer service application for each location to which service is being requested.

The utility shall serve each qualified service applicant within its certified service area as soon as practical after receiving a completed service application. All service requests will be fulfilled within the time limits prescribed by PUC rules once the applicant has met all conditions precedent to achieving "qualified service applicant" status. If a service request cannot be fulfilled within the required period, the applicant shall be notified in writing of the delay, its cause and the anticipated date that service will be available. The PUC service dates shall not become applicable until the service applicant has met all conditions precedent to becoming a qualified service applicant as defined by PUC rules.

Section 3.07 - Developer Requirements

As a condition of service to a new subdivision, the Utility shall require a developer (as defined by PUC rule) to provide permanent recorded public utility easements as a condition of service to any location within the developer's property.

APPENDIX A – DROUGHT CONTINGENCY PLAN

“This page incorporates by reference the utility’s Drought Contingency Plan, as approved and periodically amended by the Texas Commission on Environmental Quality.”

APPENDIX B -- SAMPLE SERVICE AGREEMENT

From 30 TAC Chapter 290.47(b), Appendix B SERVICE AGREEMENT

- I. **PURPOSE.** The NAME OF WATER SYSTEM is responsible for protecting the drinking water supply from contamination or pollution which could result from improper private water distribution system construction or configuration. The purpose of this service agreement is to notify each customer of the restrictions which are in place to provide this protection. The utility enforces these restrictions to ensure the public health and welfare. Each customer must sign this agreement before the NAME OF WATER SYSTEM will begin service. In addition, when service to an existing connection has been suspended or terminated, the water system will not re-establish service unless it has a signed copy of this agreement.
- II. **RESTRICTIONS.** The following unacceptable practices are prohibited by State regulations.
- A. No direct connection between the public drinking water supply and a potential source of contamination is permitted. Potential sources of contamination shall be isolated from the public water system by an air-gap or an appropriate backflow prevention device.
 - B. No cross-connection between the public drinking water supply and a private water system is permitted. These potential threats to the public drinking water supply shall be eliminated at the service connection by the installation of an air-gap or a reduced pressure-zone backflow prevention device.
 - C. No connection which allows water to be returned to the public drinking water supply is permitted.
 - D. No pipe or pipe fitting which contains more than 0.25% lead may be used for the installation or repair of plumbing at any connection which provides water for human use.
 - E. No solder or flux which contains more than 0.2% lead can be used for the installation or repair of plumbing at any connection which provides water for human use.
- III. **SERVICE AGREEMENT.** The following are the terms of the service agreement between the NAME OF WATER SYSTEM (the Water System) and NAME OF CUSTOMER (the Customer).
- A. The Water System will maintain a copy of this agreement as long as the Customer and/or the premises is connected to the Water System.
 - B. The Customer shall allow his property to be inspected for possible cross-connections and other potential contamination hazards. These inspections shall be conducted by the Water System or its designated agent prior to initiating new water service; when there is reason to believe that cross-connections or other potential contamination hazards exist; or after any major changes to the private water distribution facilities. The inspections shall be conducted during the Water System's normal business hours.
 - C. The Water System shall notify the Customer in writing of any cross-connection or other potential contamination hazard which has been identified during the initial inspection or the periodic reinspection.
 - D. The Customer shall immediately remove or adequately isolate any potential cross-connections or other potential contamination hazards on his premises.
 - E. The Customer shall, at his expense, properly install, test, and maintain any backflow prevention device required by the Water System. Copies of all testing and maintenance records shall be provided to the Water System.
- IV. **ENFORCEMENT.** If the Customer fails to comply with the terms of the Service Agreement, the Water System shall, at its option, either terminate service or properly install, test, and maintain an appropriate backflow prevention device at the service connection. Any expenses associated with the enforcement of this agreement shall be billed to the Customer.

CUSTOMER'S SIGNATURE: _____

DATE: _____

APPENDIX C -- APPLICATION FOR SERVICE
(Utility Must Attach Blank Copy)