

Control Number: 46745



Item Number: 44

Addendum StartPage: 0

DOCKET NO. 46745

RECEIVED

APPLICATION OF ORBIT SYSTEMS, §
INC. AND UNDINE TEXAS, LLC FOR §
THE SALE, TRANSFER, OR MERGER §
OF FACILITIES AND CERTIFICATE §
OF RIGHTS IN BRAZORIA, FORT §
BEND, AND MATAGORDA COUNTIES §

PUBLIC UTILITY COMMISSION

2017 OCT 13 AM 8:58
PUBLIC UTILITY COMMISSION
OF TEXAS

JOINT MOTION FOR ADMISSION OF EVIDENCE AND ADOPTION OF PROPOSED NOTICE OF APPROVAL

Commission Staff of the Public Utility Commission (“Staff”) and Undine Texas, LLC (“Undine”), file this Joint Proposed Notice of Approval and Request to Admit Evidence on the application (“Application”) of Orbit Systems, Inc. (“Orbit”) and Undine for the sale, transfer, or merger of water and sewer facilities and certificate rights in Brazoria, Fort Bend, and Matagorda counties. Pursuant to Order No. 6, the Joint Proposed Notice and Approval (Attachment 1) includes findings of fact, conclusions of law, and ordering paragraphs, and is timely filed by the deadline.

I.

BACKGROUND

Undine (“Purchaser”) and Orbit (“Seller”), collectively the “Applicants”, filed the Application with the Commission on January 9, 2017.

On May 19, 2017, Staff recommended, following a review of the Application, that the Applicants be allowed to proceed with the transaction, and Order No. 5, issued on June 29, 2017, authorized the transaction as contemplated in the Application to proceed and be consummated. Pursuant to Order No. 5, the final closing documents and a sworn statement regarding customer deposits were filed August 17, 2017. Staff recommended on August 30, 2017 that the closing documents and sworn statements be deemed sufficient. Order No. 6 found that the closing documents and sworn statements were sufficient, and required the submission of consent forms, which were filed on September 28, 2017.

II.

PROPOSED NOTICE OF APPROVAL

The Proposed Notice of Approval (Attachment 1) would grant the Application for approval of the sale of water and wastewater facilities and portions of the certificated water and sewer service area held under Seller's CCN No. 11982 (water) and CCN No. 20682 (sewer) in Brazoria, Fort Bend, and Matagorda Counties and the transfer of the same from Seller to Purchaser and the incorporation of such water and sewer service area into Purchaser's new CCNs. This docket was processed in accordance with applicable statutes and Commission rules. Notice of the Application was provided to affected parties. On March 13, 2017 U.S. Land Corp DBA Paradise Cove Water and Wastewater filed a letter for a public hearing. That request was withdrawn, as reflected in a May 15, 2017 filing. On April 5, 2017, Adan G. Cardena filed a letter regarding a request to "opt out" of services. On June 29, 2017, Order No. 5 approved the sale/transfer to proceed and addressed the Cardenas letter, confirming that Cardenas did not have a right to intervene in the proceeding. Therefore, Applicants and Staff are the only parties to this proceeding. There are no contested issues of law or fact in the proceeding. Staff recommends approval of this proceeding pursuant to 16 TAC § 22.35 relating to Informal Disposition.

III.

REQUEST TO ADMIT EVIDENCE

Staff and Undine request to admit the following filed in this docket in the evidentiary record in this proceeding:

- a. The Applicants' January 9, 2017 Application (Commission's automated interchange system ("AIS") Item 1);
- b. Undine's Response to Order No. 1 (AIS Item 9, filed 1/12/17);
- c. Undine's First Amendment to Application (AIS Item 16 filed 2/17/17);
- d. Undine's Response to Commission Staff's First RFI (AIS Item 17, filed 2/17/17);
- e. Undine's Response to Order No. 2, including notice, customer list, maps and affidavits (ALS Items 18 and 19, filed 3/10/17);
- f. U.S. Land Corp DBA Paradise Cove Water and Wastewater letter requesting a public hearing (AIS Item 20, filed 3/13/17);

- g. Adan G. Cardenas letter regarding a request to “opt out” of services (AIS Item 23, filed 4/5/17);
- h. Undine’s Response to Commission Staff’s Confidential Second RFI (AIS Items 26 and 27, filed 4/21/17);
- i. Undine’s Submittal of Withdrawal Request and Withdrawal (AIS items 31 and 32, filed 5/15/17)
- j. Commission Staff’s Recommendation of Approval (AIS Item 33, filed 5/19/17);
- k. Undine’s Notice of Proof that transaction has been consummated and customer deposits have been properly addressed and Clarification regarding the Notice of Proof (AIS Items 38 and 39, filed 8/17/17, and AIS Item 40, filed 8/22/17);
- l. Commission Staff’s recommendation on proof of sale (AIS Item 41, filed 8/30/17);
- m. Consent Forms filed by Undine and Orbit (AIS Item 43, filed September 28, 2017);
- n. Certificates, maps, and tariffs (attached).

IV.

JOINT MOTION FOR ADOPTION OF PROPOSED NOTICE OF APPROVAL

The attached Proposed Notice of Approval would grant the Application for approval of the sale of water and wastewater facilities and portions of the certificated water and sewer service area held under Seller’s CCN No. 11982 (water) and CCN No. 20682 (sewer) in Brazoria, Fort Bend, and Matagorda Counties and the transfer of the same from Seller to Purchaser and the incorporation of such water and sewer service area into Purchaser’s new CCNs.

V.

CONCLUSION

The Parties have indicated to Staff that Staff is authorized to file this pleading on their behalf. Therefore, the Parties respectfully request that the Commission grant the joint motions to admit the evidence specified above and adopt the attached proposed Notice of Approval.

Respectfully submitted,

**PUBLIC UTILITY COMMISSION OF TEXAS
LEGAL DIVISION**

Margaret Uhlig Pemberton
Division Director

Katherine Lengieza Gross
Managing Attorney

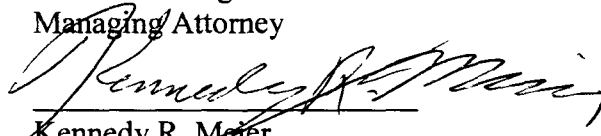

Kennedy R. Meier
State Bar No. 24092819
1701 N. Congress Avenue
P.O. Box 13326
Austin, Texas 78711-3326
(512) 936-7265
(512) 936-7268 (facsimile)
Kennedy.Meier@puc.texas.gov

CERTIFICATE OF SERVICE

I certify that a copy of this document will be served on all parties of record on this the 13th of October, 2017 in accordance with 16 TAC § 22.74.

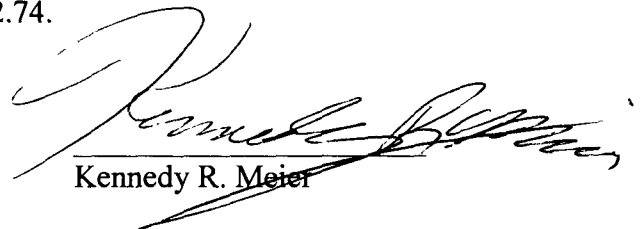

Kennedy R. Meier

ATTACHMENT A

DOCKET NO. 46745

APPLICATION OF ORBIT SYSTEMS, INC. AND UNDINE TEXAS, LLC FOR THE SALE, TRANSFER, OR MERGER OF FACILITIES AND CERTIFICATE OF RIGHTS IN BRAZORIA, FORT BEND, AND MATAGORDA COUNTIES	§ § § § § §	PUBLIC UTILITY COMMISSION OF TEXAS
--	--	--

JOINT PROPOSED NOTICE OF APPROVAL

This notice addresses the application (“Application”) of Undine Texas, LLC (“Undine”) and Orbit Systems, Inc. (“Orbit”) for the sale of water and wastewater facilities and portions of the certificated water and sewer service area held under Orbit’s CCN No. 11982 (water) and CCN No. 20682 (sewer) in Brazoria, Fort Bend, and Matagorda Counties and the transfer of the same from Orbit to Undine and the incorporation of such water and sewer service area into Buyer’s new CCNs. The Application is approved.

The Commission adopts the following findings of fact and conclusions of law:

I.

FINDINGS OF FACT

Procedural History, Description, and Background

1. Orbit Systems, Inc. (“Orbit”) is the seller/transferor of certain facilities and corresponding certificated areas in Brazoria, Fort Bend, and Matagorda Counties under CCN No. 11982 (water) and CCN No. 20682 (sewer).
2. Undine Texas, LLC (“Undine”) is the purchaser/transferee of the facilities and corresponding certificated areas in Brazoria, Fort Bend, and Matagorda Counties under CCN No. 11982 (water) and CCN No. 20682 (sewer).

3. On January 9, 2017, Undine filed an Application with the Commission for approval of the sale of certain Orbit facilities and transfer of related certificate rights under water CCN No. 11982 and wastewater CCN No. 20682 to Undine.

4. On January 11, 2017, Order No. 1 was issued requiring comments on the administrative completeness of the Application. On January 12, 2017, Undine filed a response to Order No. 1, clarifying the intended effect of the transaction. On February 17, 2017, Undine filed its first amendment to Application, and on February 9, 2017 Staff filed comments on administrative completeness.

5. On February 10, 2017, Order No. 2 was issued deeming the application administratively complete and establishing a procedural schedule.

6. On February 14, 2017, Commission Staff sent its First RFI to Applicant.

7. On February 17, 2017, Undine filed its response to Commission Staff's First RFI.

8. On March 10, 2017, Undine filed Notice and Affidavit of Notice to Neighboring Utilities and Affected Parties regarding the provision of notice of the Application.

9. On March 13, 2017, U.S. Land Corp DBA Paradise Cove Water and Wastewater filed a letter regarding a request for hearing.

10. On March 20, 2017, Commission Staff filed its recommendation on sufficiency of notice.

11. On March 22, 2017, Order No. 3 was issued, deeming notice sufficient and complete and adopting procedural schedule.

12. On April 5, 2017, Adan G. Cardenas filed a letter regarding a request to "opt out" of the Services.

13. On April 12, 2017, Commission Staff filed a redacted Second RFI to Applicants.

14. On April 21, 2017, Undine responded to Commission Staff's Second RFI.
15. On May 8, 2017, Order No. 4 was issued, extending the procedural schedule.
16. On May 15, 2017, Undine filed a Withdrawal Request that contained a letter withdrawing the U.S. Land request for hearing.
17. On May 19, 2017, Commission Staff filed its recommendation on approval.
18. On June 29, 2017, Order No. 5 was filed approving the sale/transfer to proceed and addressing the Cardenas letter.
19. On August 17, 2017, Undine filed Notice of Proof that Transaction has been Consummated and Customer Deposits have been Properly Addressed.
20. On August 22, 2017, Undine filed a clarification regarding notice of proof.
21. On August 30, 2017, Commission Staff filed its recommendation on proof of sale
22. On August 31, 2017, Order No. 6 was filed, finding closing documents sufficient and establishing a further procedural schedule.
23. On September 28, 2017, Undine filed consent forms in response to Order No. 6.
24. On October 13, 2017, the parties jointly filed a proposed notice of approval and a request to admit evidence.
25. On _____, Order No. ____ was issued, admitting evidence.

Notice

26. Notice of the Application was published in:
 - a. *Bay City Tribune* in Matagorda County on February 26, 2017 and March 5, 2017;
 - b. *Fort Bend Herald* in Fort Bend County on February 23, 2017 and March 2, 2017; and

- c. *The Facts* in Brazoria County on February 23, 2017 and February 27, 2017.

27. Mailed notice was provided to neighboring systems, landowners, cities and affected parties on March 3, 2017.

Informal Disposition

28. The requirements for informal disposition under 16 Tex. Admin. Code § 22.35 have been met in this proceeding. At least 15 days have passed since the completion of notice requirements, and it is not necessary to hold a hearing on the merits regarding the application.

II.

CONCLUSIONS OF LAW

1. The Commission has jurisdiction over the proceeding under Tex. Water Code §§ 13.041, 13.241, 13.244, 13.246, 13.251, 13.254, and 13.301.
2. Undine is a retail public utility, as defined by Tex. Water Code § 13.002(19) and 16 Tex. Admin. Code § 24.3(59).
3. Public notice of the Application was provided as required by Tex. Water Code § 13.301(a)(2) and Tex. Admin. Code §§ 24.109(a)-(c).
4. The Application was processed in accordance with the requirements of the Tex. Water Code § 13.301 and 16 Tex. Admin. Code § 24.109.
5. Undine and Orbit completed the sale within 180 days of the Commission's approval of the sale, consistent with 16 Tex. Admin. Code § 24.109(o).
6. After consideration of the factors in Tex. Water Code § 13.246(c), Undine has demonstrated adequate financial, managerial, and technical capability for providing adequate and continuous service to the requested area.

7. Undine and Orbit have demonstrated that the sale and transfer of the certificated service area and the associated CCNs requested in the Application are necessary for the service, accommodation, convenience, and safety of the public.

8. Pursuant to Tex. Water Code § 13.257(r) and 16 Tex. Admin. Code § 24.106(e), Undine is required to record a certified copy of the approved CCNs and maps, along with a boundary description of the service area, in the real property records of each county in which the service area or portion of a service area is located, and submit to the Commission evidence of the recording.

9. The requirements for informal disposition pursuant to 16 Tex. Admin. Code § 22.35 have been met in this proceeding.

III.

ORDERING PARAGRAPHS

The Commission issues the following ordering paragraphs in accordance with these findings of fact and conclusions of law:

1. The Application is approved.
2. The sale and transfer of Orbit's water and sewer facilities in the certificated area in Brazoria, Fort Bend and Matagorda Counties under CCN No. 11982 (water) and CCN No. 20682 (sewer) are approved.
3. Undine's new CCN No. 13260 (water) and new CCN No. 21106 (sewer) reflect that Undine will be providing water and sewer service to portions of Orbit's formerly certificated area in Brazoria, Fort Bend and Matagorda Counties.

4. Undine shall service every customer and applicant for service within the areas previously served by Orbit under CCN No. 11982 (water) and CCN No. 20682 (sewer) and transferred from those areas, and such service shall be continuous and adequate.

6. Undine shall comply with the recording requirements of Tex. Water Code § 13.257(r) for the areas of Brazoria, Fort Bend, and Matagorda Counties affected by the Application and submit to the Commission evidence of the recording not later than 31 days after receipt of this Notice.

7. All other motions, requests for entry of specific findings of fact or conclusions of law, and any other requests for general or specific relief, if not expressly granted in this Notice of Approval, are hereby denied.

SIGNED AT AUSTIN, TEXAS, the ____ day of _____, 2017.

Administrative Law Judge

ATTACHMENT B

Attachment

Notice of Approval



Public Utility Commission of Texas

By These Presents Be It Known To All That

Orbit Systems, Inc.

having obtained certification to provide water utility service for the convenience and necessity of the public, and it having been determined by this Commission that the public convenience and necessity would in fact be advanced by the provision of such service, Orbit Systems, Inc., is entitled to this

Certificate of Convenience and Necessity No. 11982

to provide continuous and adequate water utility service to that service area or those service areas in Brazoria County as by final Order or Orders duly entered by this Commission, which Order or Orders resulting from Docket No. 46745 are on file at the Commission offices in Austin, Texas; and are matters of official record available for public inspection; and be it known further that these presents do evidence the authority and the duty of the Orbit Systems, Inc., to provide such utility service in accordance with the laws of this State and Rules of this Commission, subject only to any power and responsibility of this Commission to revoke or amend this Certificate in whole or in part upon a subsequent showing that the public convenience and necessity would be better served thereby.

Issued at Austin, Texas, this _____ day of _____ 2017.



Public Utility Commission of Texas

By These Presents Be It Known To All That

Orbit Systems, Inc.

having obtained certification to provide sewer utility service for the convenience and necessity of the public, and it having been determined by this Commission that the public convenience and necessity would in fact be advanced by the provision of such service, Orbit Systems, Inc., is entitled to this

Certificate of Convenience and Necessity No. 20682

to provide continuous and adequate sewer utility service to that service area or those service areas in Brazoria County as by final Order or Orders duly entered by this Commission, which Order or Orders resulting from Docket No. 46745 are on file at the Commission offices in Austin, Texas; and are matters of official record available for public inspection; and be it known further that these presents do evidence the authority and the duty of the Orbit Systems, Inc., to provide such utility service in accordance with the laws of this State and Rules of this Commission, subject only to any power and responsibility of this Commission to revoke or amend this Certificate in whole or in part upon a subsequent showing that the public convenience and necessity would be better served thereby.

Issued at Austin, Texas, this _____ day of _____ 2017.

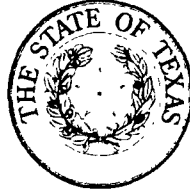

Public Utility Commission of Texas

By These Presents Be It Known To All That

Undine Texas, LLC

having obtained certification to provide water utility service for the convenience and necessity of the public, and it having been determined by this Commission that the public convenience and necessity would in fact be advanced by the provision of such service, Undine Texas, LLC is entitled to this

Certificate of Convenience and Necessity No. 13260

to provide continuous and adequate water utility service to that service area or those service areas in Brazoria, Fort Bend, and Matagorda Counties as by final Order or Orders duly entered by this Commission, which Order or Orders resulting from Docket No. 46745 are on file at the Commission offices in Austin, Texas; and are matters of official record available for public inspection; and be it known further that these presents do evidence the authority and the duty of the Undine Texas, LLC, to provide such utility service in accordance with the laws of this State and Rules of this Commission, subject only to any power and responsibility of this Commission to revoke or amend this Certificate in whole or in part upon a subsequent showing that the public convenience and necessity would be better served thereby.

Issued at Austin, Texas, this _____ day of _____ 2017.



Public Utility Commission of Texas

**By These Presents Be It Known To All That
Undine Texas, LLC**

having obtained certification to provide sewer utility service for the convenience and necessity of the public, and it having been determined by this Commission that the public convenience and necessity would in fact be advanced by the provision of such service, Undine Texas, LLC is entitled to this

Certificate of Convenience and Necessity No. 21106

to provide continuous and adequate sewer utility service to that service area or those service areas in Brazoria, Fort Bend, and Matagorda Counties as by final Order or Orders duly entered by this Commission, which Order or Orders resulting from Docket No. 46745 are on file at the Commission offices in Austin, Texas; and are matters of official record available for public inspection; and be it known further that these presents do evidence the authority and the duty of the Undine Texas, LLC, to provide such utility service in accordance with the laws of this State and Rules of this Commission, subject only to any power and responsibility of this Commission to revoke or amend this Certificate in whole or in part upon a subsequent showing that the public convenience and necessity would be better served thereby.



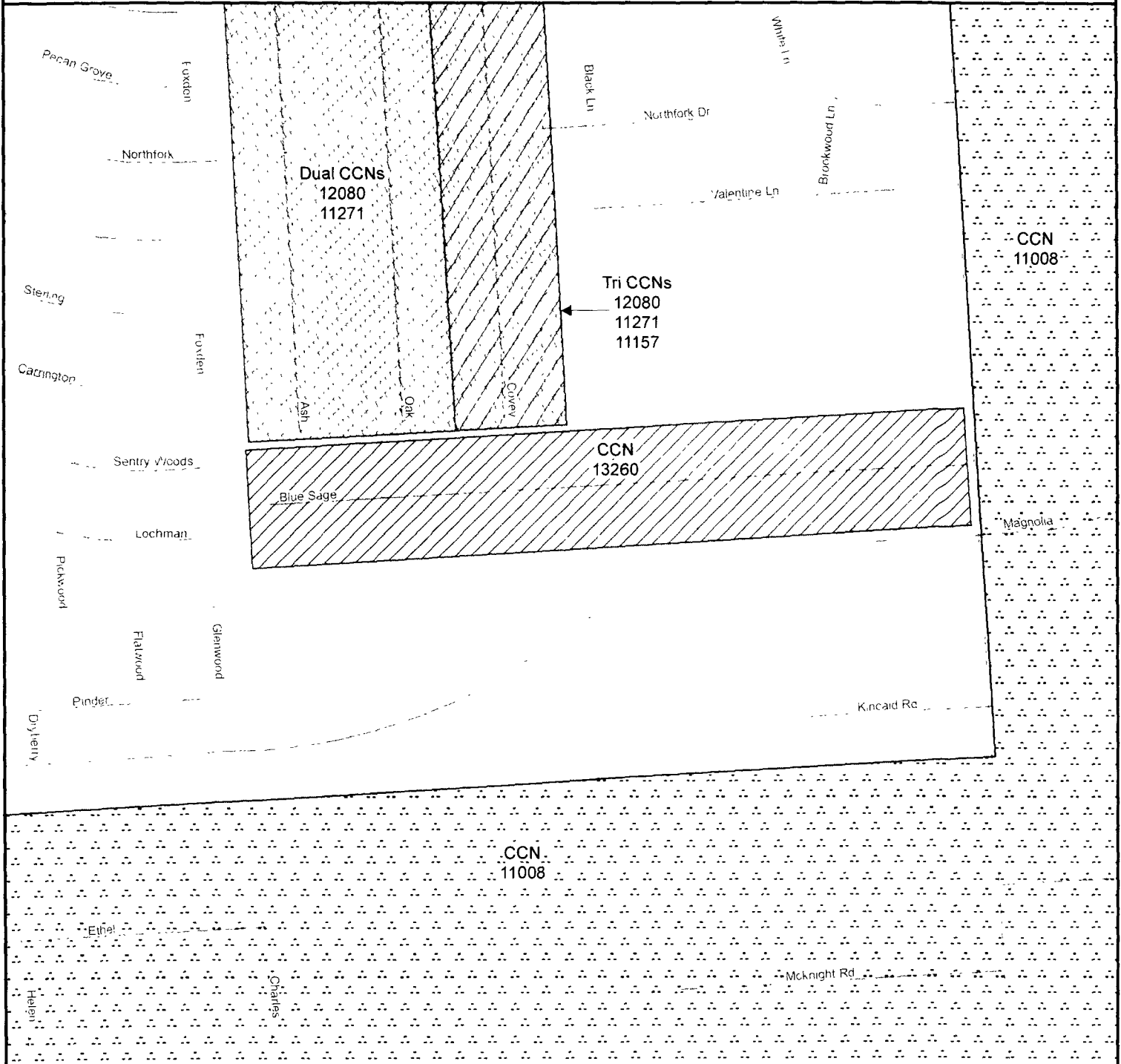

Issued at Austin, Texas, this _____ day of _____ 2017.

Undine Texas, LLC
 Portion of Water CCN No.13260
 PUC Docket No. 46745

Amended, Decertified and Transferred a Portion of Orbit Systems, Inc., CCN No. 11982 in Brazoria County



Water CCN

-  13260 - Undine Texas LLC
-  12080 - Manvel Terrace Utilites
-  11271 - LHL Industries
-  11157 - Aqua Texas Inc
-  11008 - City of Pearland

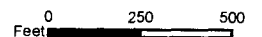

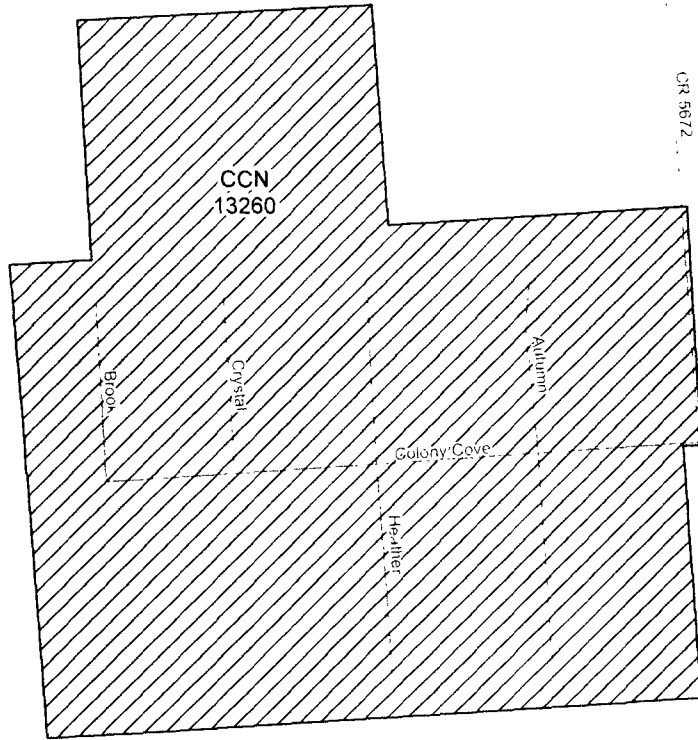
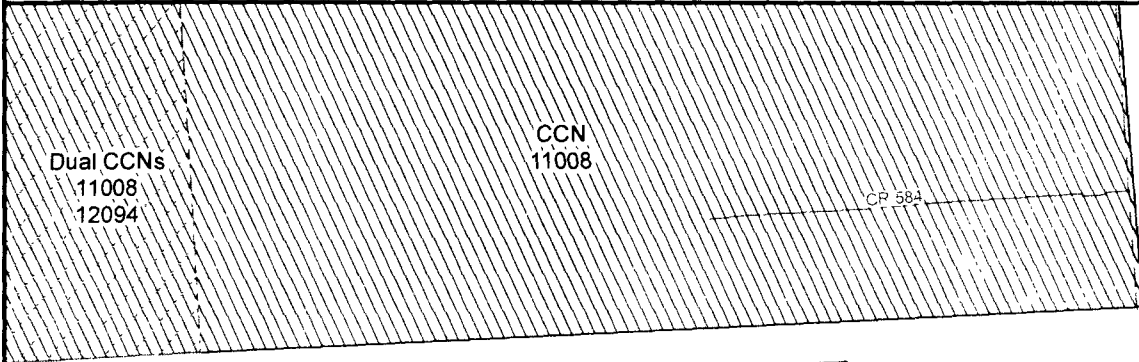

Undine Texas, LLC
 Portion of Water CCN No. 13260
 PUC Docket No. 46745
 Amended and Transferred a Portion of Orbit Systems, Inc., CCN No. 11982 in Brazoria County



Public Utility Commission of Texas
 1701 N Congress Ave
 Austin, TX 78701

Water CCN

-  13260 - Undine Texas LLC
-  11008 - City of Pearland
-  12094 - Gulf Coast Utility Co Inc

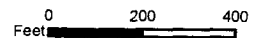

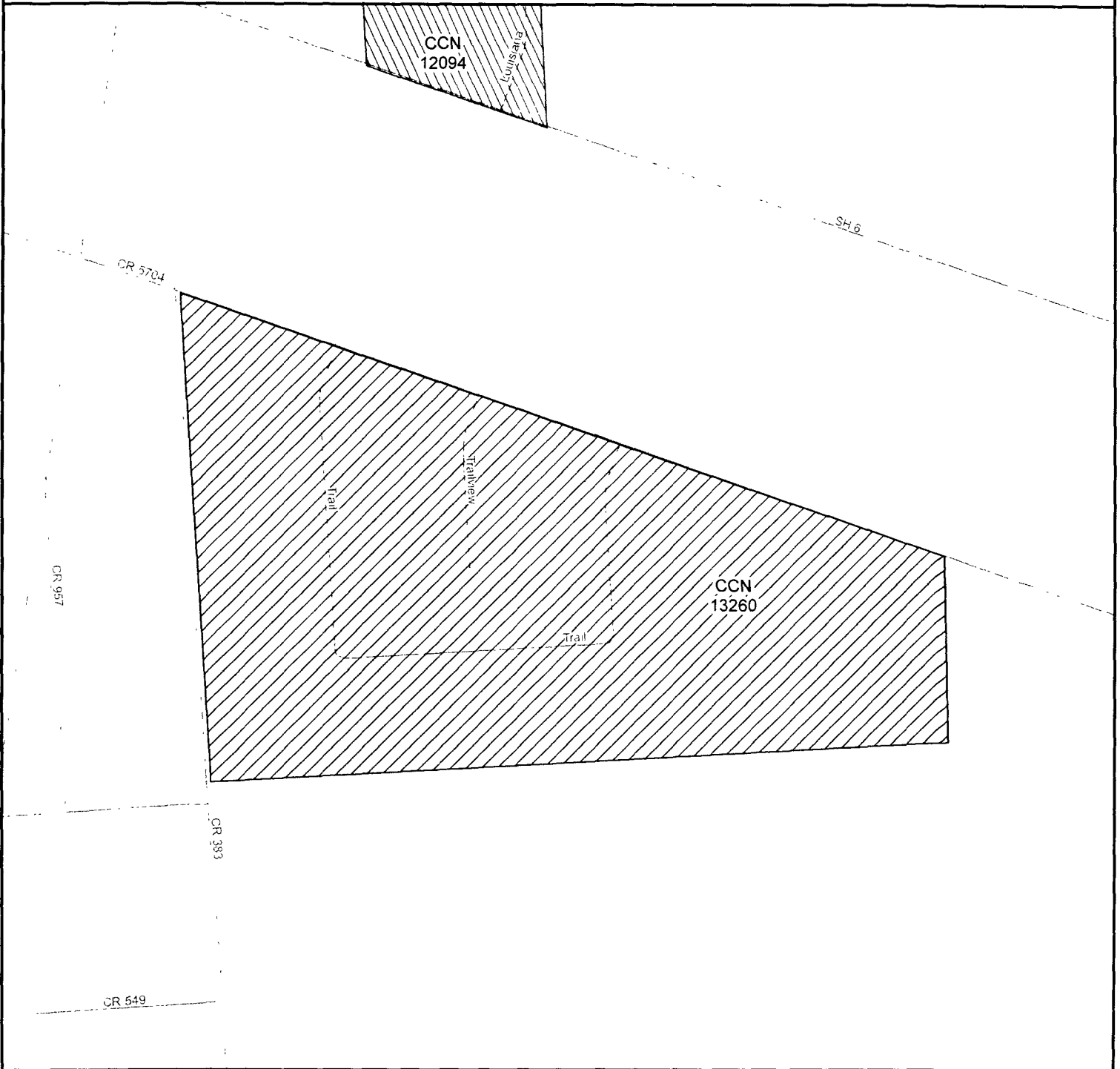

Map by Komal Patel
 Date created September 11, 2017
 Project Path n\finalmapping\46745UndineTXBrazoria2.mxd

Undine Texas, LLC
Portion of Water CCN No. 13260
PUC Docket No. 46745
Transferred a Portion of Orbit Systems, Inc., CCN No. 11982 in Brazoria County



Public Utility Commission of Texas
1701 N Congress Ave
Austin, TX 78701

Water CCN

-  13260 - Undine Texas LLC
-  12094 - Gulf Coast Utility Co Inc

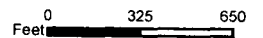

Map by Komal Patel
Date created September 11, 2017
Project Path n:\finalmapping\46745UndineTXBrazoria3.mxd

Undine Texas, LLC
 Portion of Water CCN No. 13260
 PUC Docket No. 46745
 Transferred a Portion of Orbit Systems, Inc., CCN No. 11982 in Brazoria County

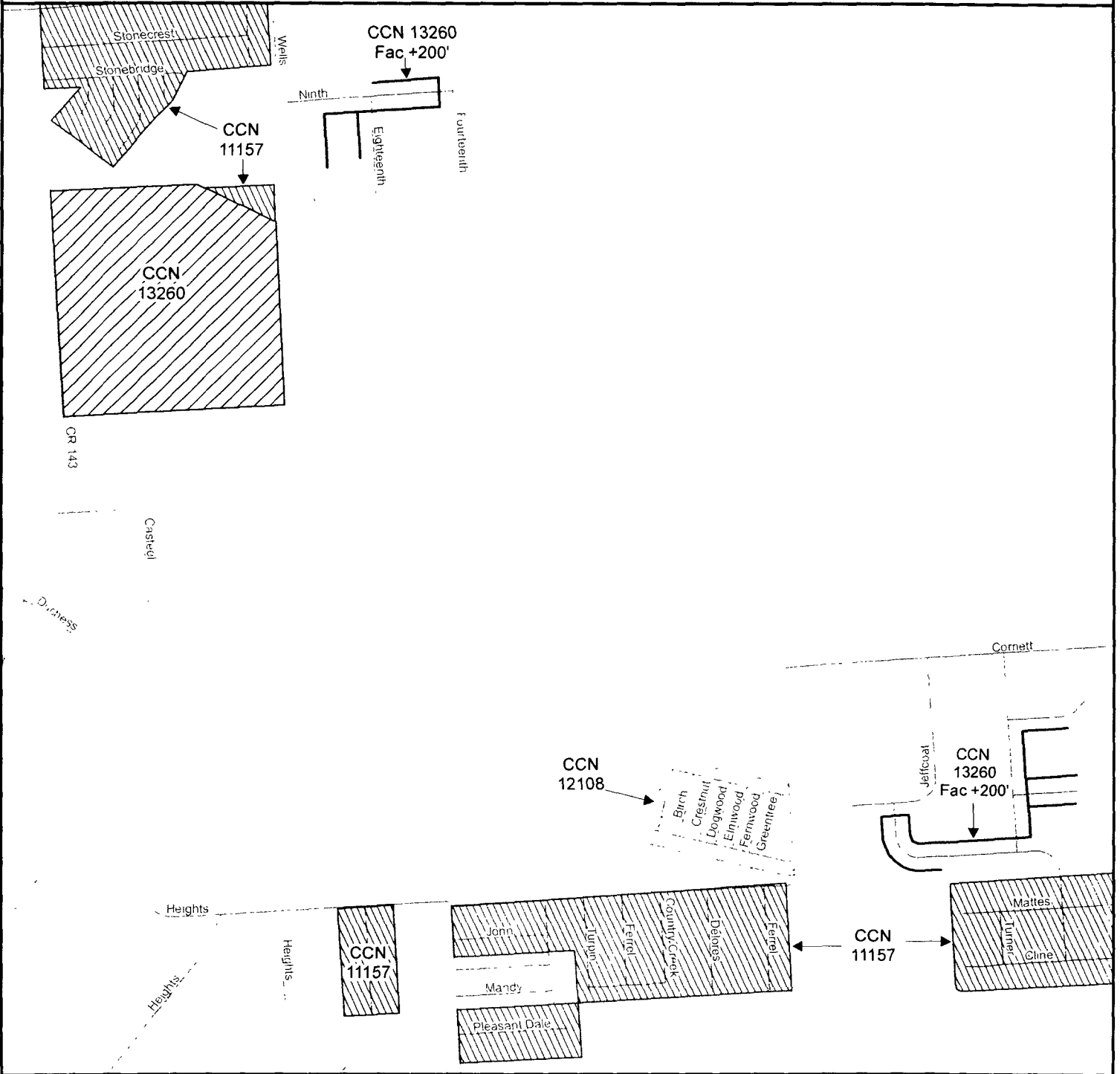

Public Utility Commission of Texas
 1701 N Congress Ave
 Austin, TX 78701

Water CCN

- 13260 - Undine Texas LLC
- 11157 - Aqua Texas Inc
- 12108 - KC Utilities Inc

Water Facility CCN

- 13260 - Undine Texas LLC
- Facilities +200'

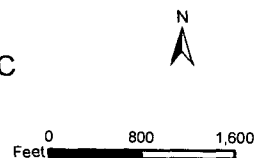

Map by Komal Patel
 Date created September 12, 2017
 Project Path n\finalmapping\46745UndineTXBrazoria4.mxd

Undine Texas LLC
Portion of Water CCN No. 13260
PUC Docket No. 46745
Amended and Transferred a Portion of Orbit Systems, Inc. CCN No. 11982 in Brazoria County



Public Utility Commission of Texas
 1701 N Congress Ave
 Austin, TX 78701

Water CCN

- 13260 - Undine Texas LLC
- 12653 - City of Manvel

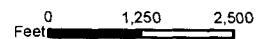

Map by Komal Patel
 Date created September 12, 2017
 Project Path n\finalmapping\46745UndineTXBrazoria5.mxd

Undine Texas, LLC
Portion of Water CCN No. 13260
PUC Docket No. 46745
Transferred a Portion of Orbit Systems, Inc., CCN No. 11982 in Brazoria County

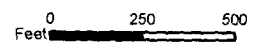
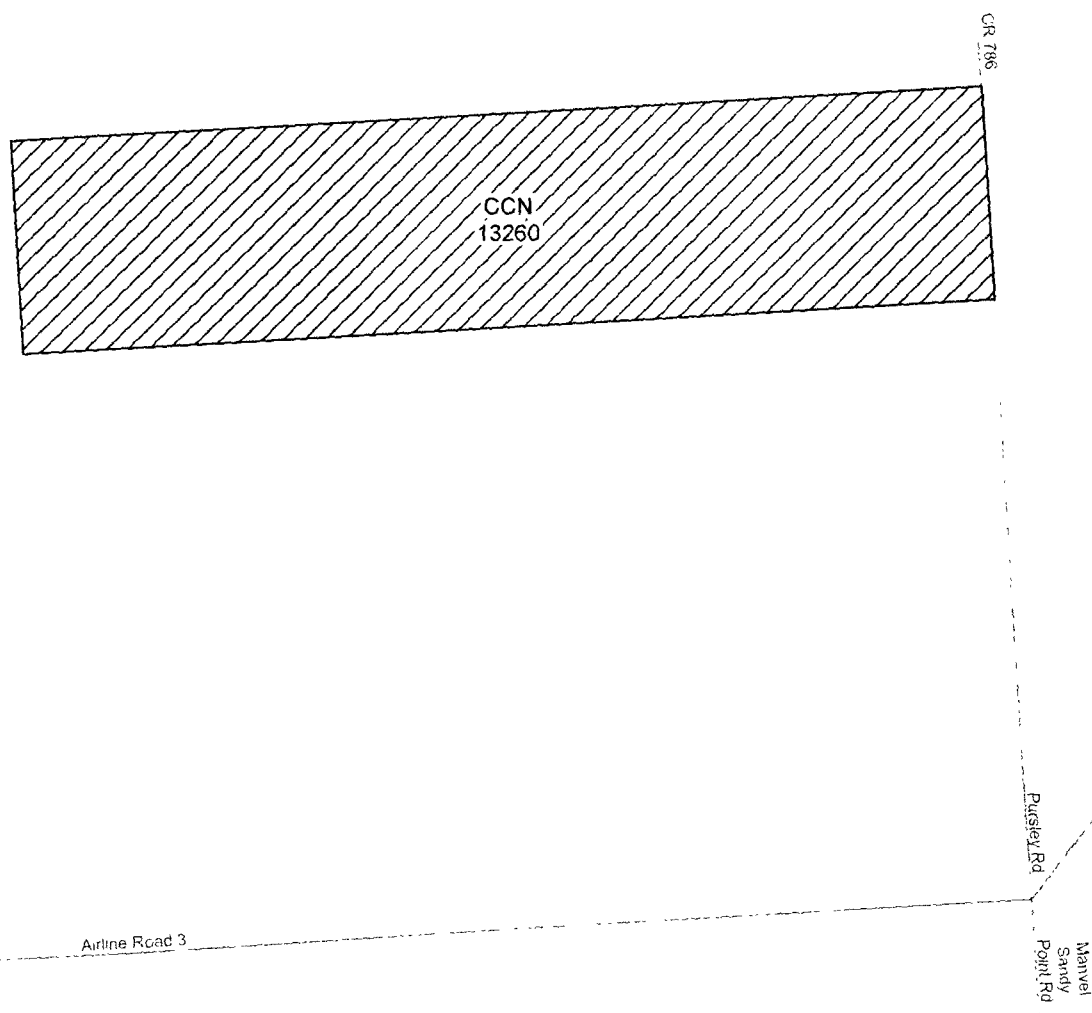

Water CCN

 13260 - Undine Texas LLC



Public Utility Commission of Texas
1701 N Congress Ave
Austin, TX 78701



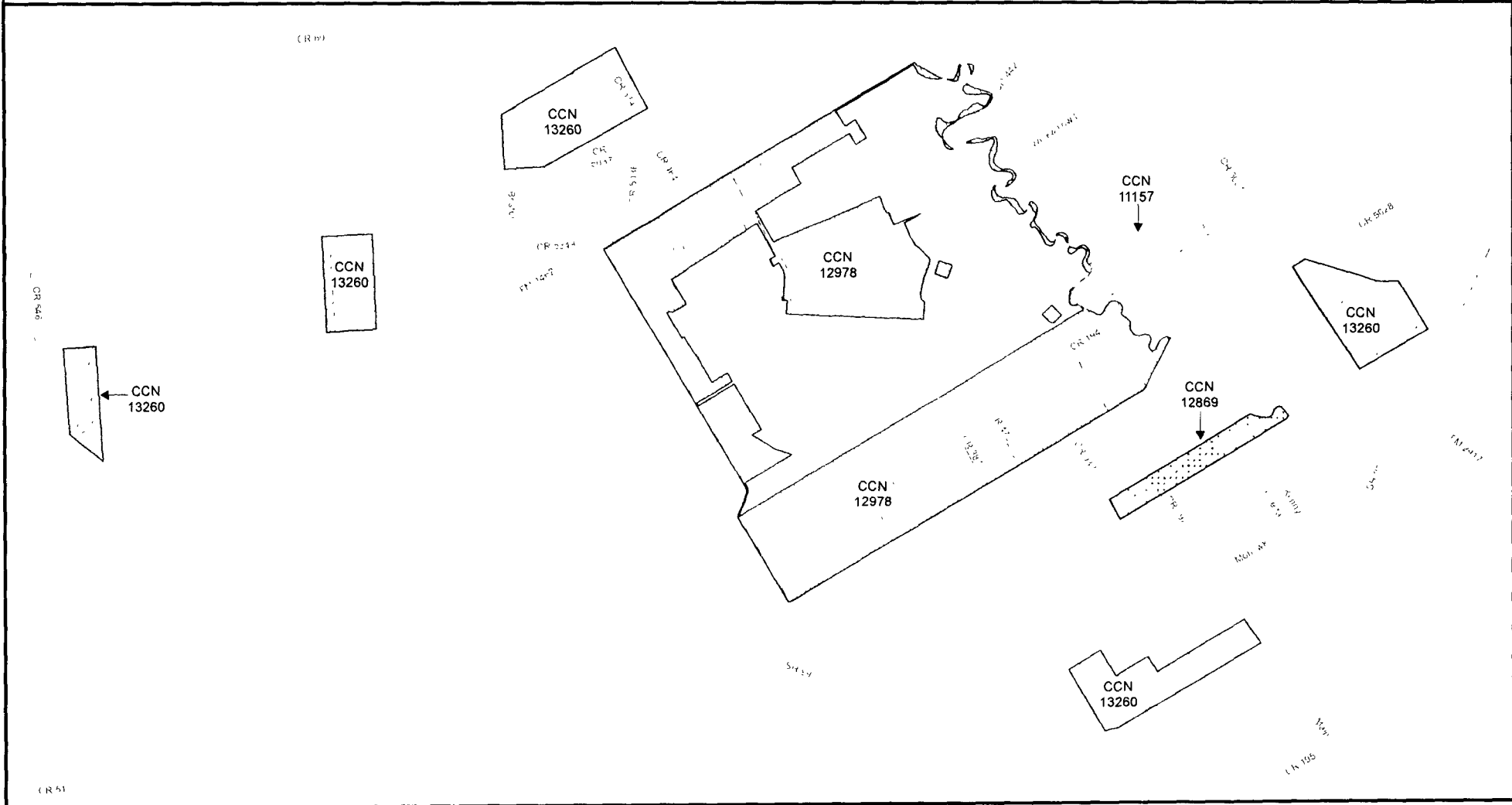

Map by Komal Patel
Date created September 12, 2017
Project Path n:\finalmapping\46745UndineTXBrazoria6.mxd

Undine Texas, LLC
 Portion of Water CCN No. 13260
 PUC Docket No. 46745
 Transferred a Portion of Orbit Systems, Inc., CCN No. 11982 in Brazoria County



Public Utility Commission of Texas
 1701 N. Congress Ave
 Austin, TX 78701

Water CCN

-  13260 - Undine Texas LLC
-  12978 - S P Utility Company Inc
-  11157 - Aqua Texas Inc
-  12869 - Bayou Shadows

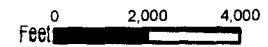

Map by Komal Patel
 Date created, September 12, 2017
 Project Path n\finalmapping\46745UndineTXBrazoria7.mxd

Undine Texas, LLC
Portion of Water CCN No. 13260
PUC Docket No. 46745
Amended and Transferred a Portion of Orbit Systems, Inc., CCN No. 11982 in Brazoria County

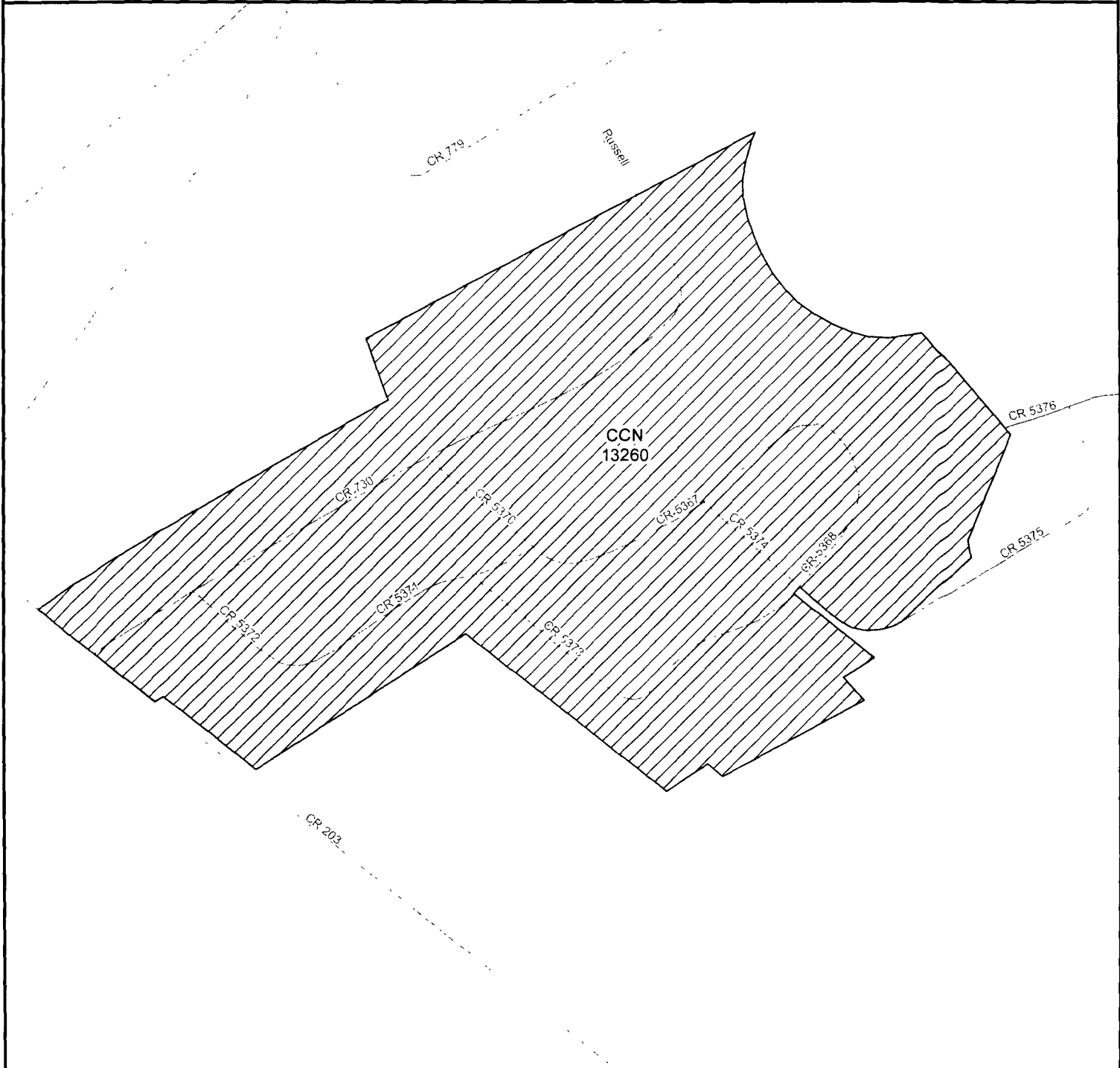

Public Utility Commission of Texas
1701 N Congress Ave
Austin, TX 78701

Water CCN

 13260 - Undine Texas LLC

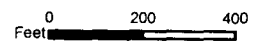

Map by Komal Patel
Date created September 12, 2017
Project Path n:\finalmapping\46745UndineTXBrazoria8.mxd

Undine Texas, LLC
Portion of Water CCN No. 13260
PUC Docket No. 46745
Amended and Transferred a Portion of Orbit Systems, Inc., CCN No. 11982 in Brazoria County

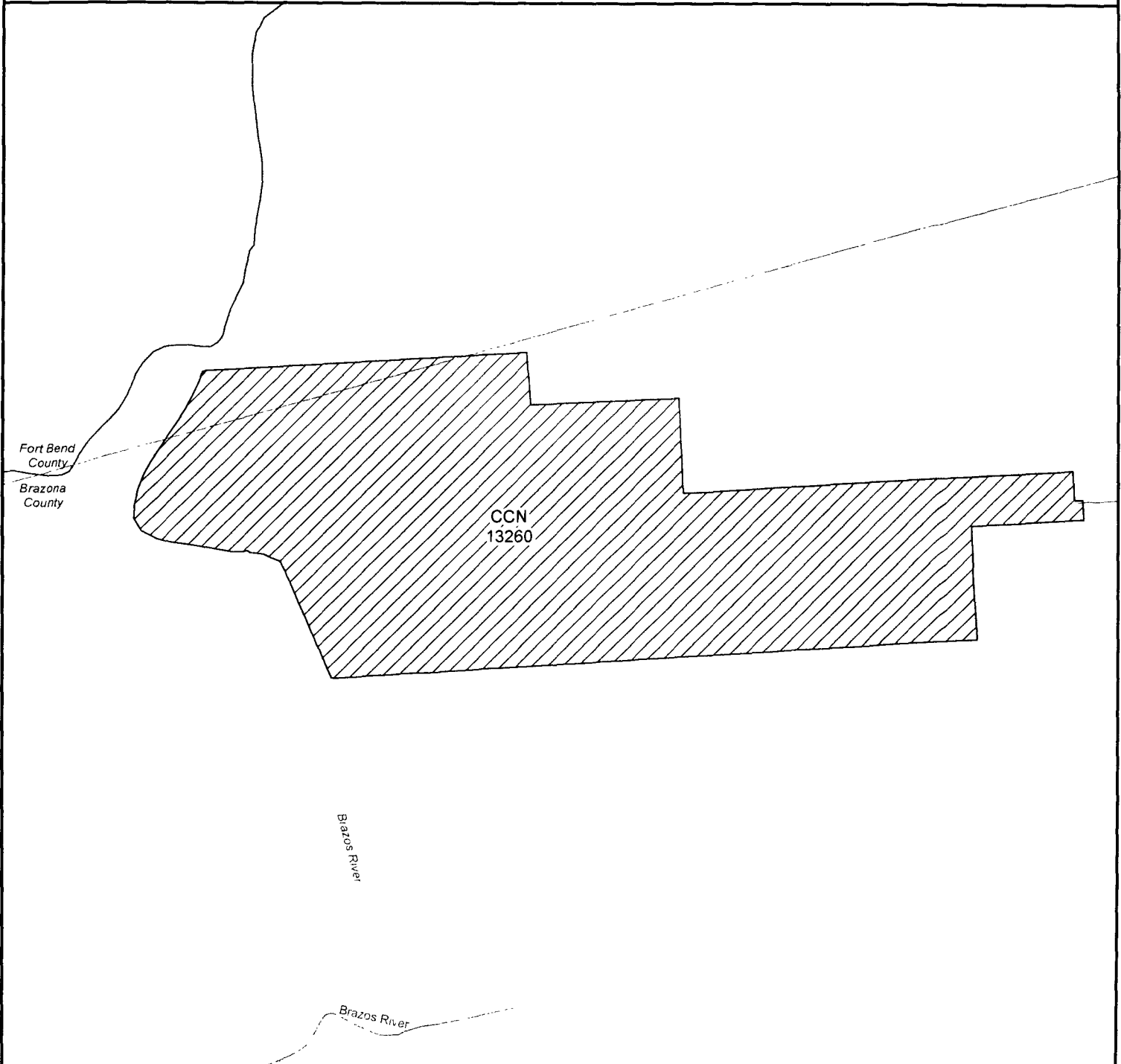

Public Utility Commission of Texas
1701 N. Congress Ave
Austin, TX 78701

Water CCN
 13260 - Undine Texas LLC

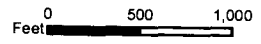

Map by Komal Patel
Date created September 12, 2017
Project Path n\finalmapping\46745UndineTXBrazoria9.mxd

Undine Texas, LLC
Portion of Water CCN No. 13260
PUC Docket No. 46745
Amedned and Transferred a Portion of Orbit Systems, Inc., CCN No. 11982 in Brazoria County



Public Utility Commission of Texas
 1701 N Congress Ave
 Austin, TX 78701

Water CCN

13260 - Undine Texas LLC

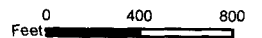

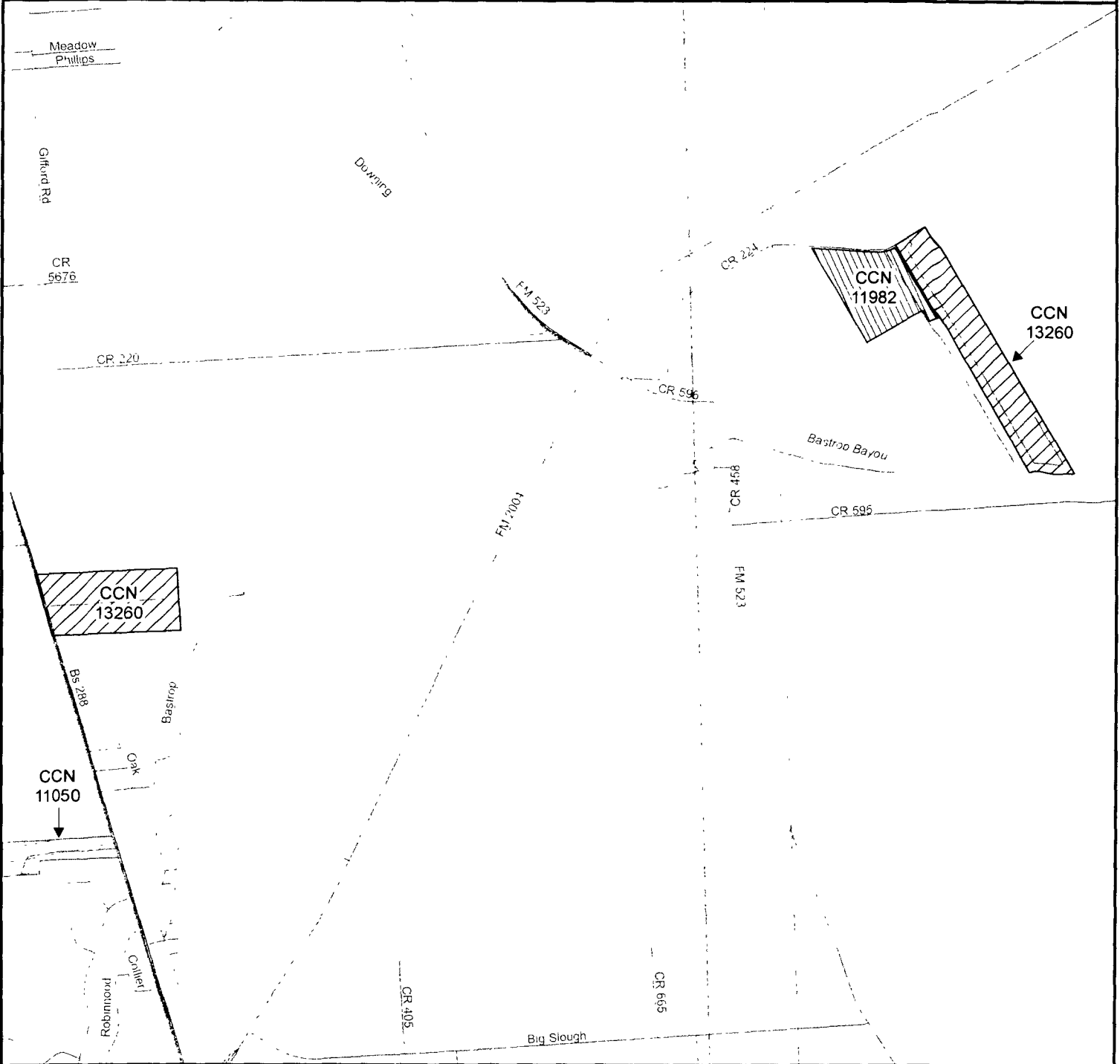

Map by: Komal Patel
 Date created September 12, 2017
 Project Path: n:\finalmapping\46745UndineTXBrazoria11.mxd

Undine Texas, LLC
 Portion of Water CCN No. 13260
 PUC Docket No. 46745
 Transferred a Portion of Orbit Systems, Inc., CCN No. 11982 in Brazoria County



Public Utility Commission of Texas
 1701 N Congress Ave
 Austin, TX 78701

Water CCN

-  13260 - Undine Texas LLC
-  11982 - Orbit Systems Inc
-  11050 - Trent Water Works

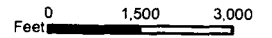



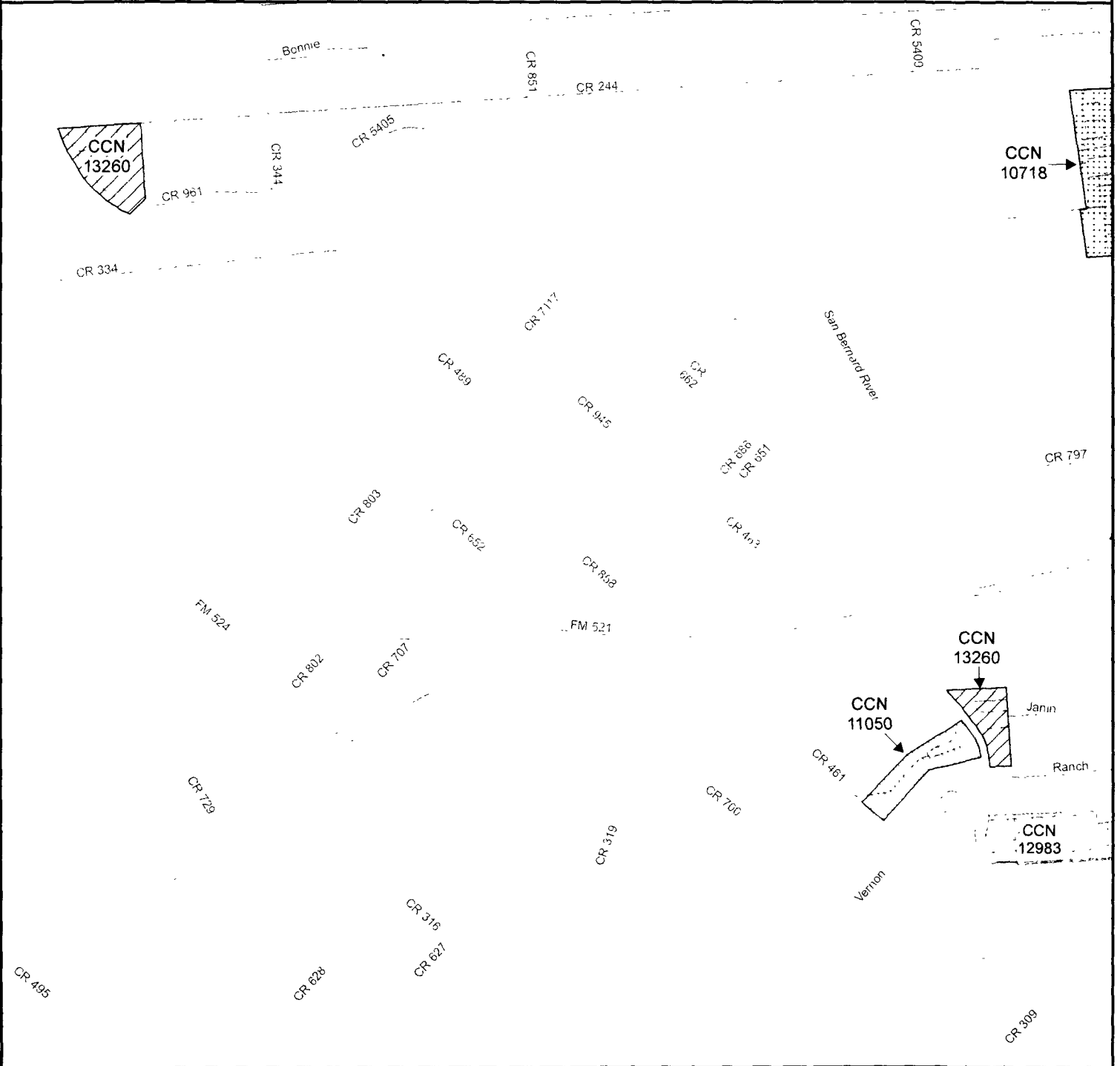

Map by Komal Patel
 Date created September 13, 2017
 Project Path n:\vinalmapping\46745UndineTXBrazoria12.mxd

Undine Texas, LLC
 Portion of Water CCN No. 13260
 PUC Docket No. 46745
 Transferred a Portion of Orbit Systems, Inc., CCN No. 11982 in Brazoria County



Public Utility Commission of Texas
 1701 N. Congress Ave
 Austin, TX 78701

- Water CCN**
-  13260 - Undine Texas LLC
 -  11050 - Trent Water Works
 -  12983 - Monarch Utilities I LP
 -  10718 - City of Brazoria

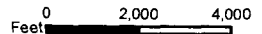



Map by Komal Patel
 Date created September 13, 2017
 Project Path n:\finalmapping\46745UndineTXBrazoria13.mxd

Undine Texas, LLC
Portion of Water CCN No. 13260
PUC Docket No. 46745
Transferred a Portion of Orbit Systems, Inc., CCN No. 11982 in Fort Bend County



Public Utility Commission of Texas
1701 N. Congress Ave
Austin, TX 78701

Water CCN

-  13260 - Undine Texas LLC
-  12922 - Royal Valley Utilities Inc

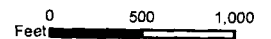

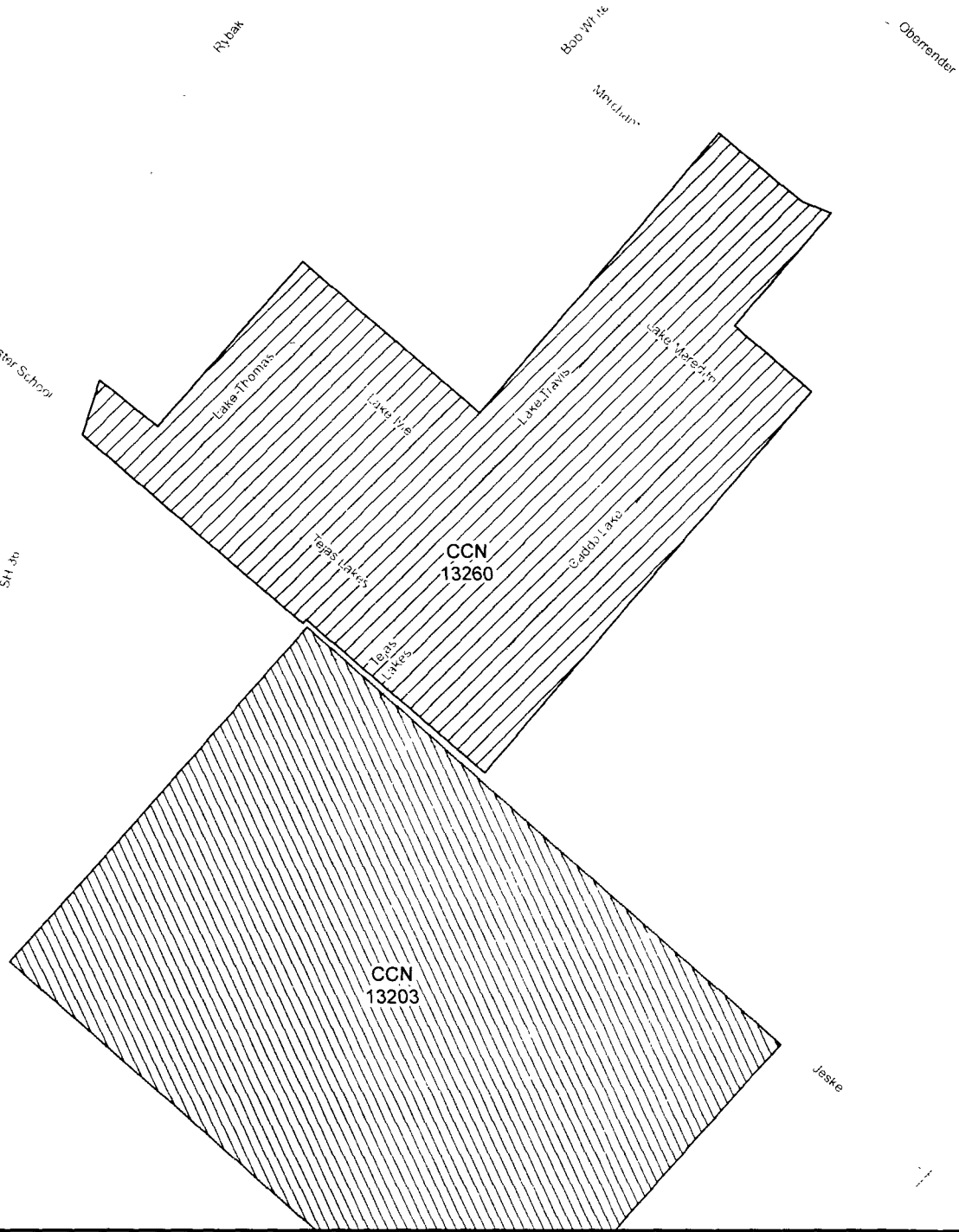

Map by: Komal Patel
Date created: September 11, 2017
Project Path: n:\vinalmapping\46745UndineTXFB1.mxd

Undine Texas, LLC
 Portion of Water CCN No. 13260
 PUC Docket No. 46745
 Transferred a Portion of Orbit Systems, Inc., CCN No. 11982 in Fort Bend County



Public Utility Commission of Texas
 1701 N. Congress Ave
 Austin, TX 78701

Water CCN

-  13260 - Undine Texas LLC
-  13203 - Aqua Texas Inc

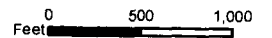

Map by Komal Patel
 Date created September 11, 2017
 Project Path n\finalmapping\46745UndineTXFB2.mxd

Undine Texas, LLC
Portion of Water CCN No. 13260
PUC Docket No. 46745
Transferred a Portion of Orbit Systems, Inc., CCN No. 11982 in Matagorda County

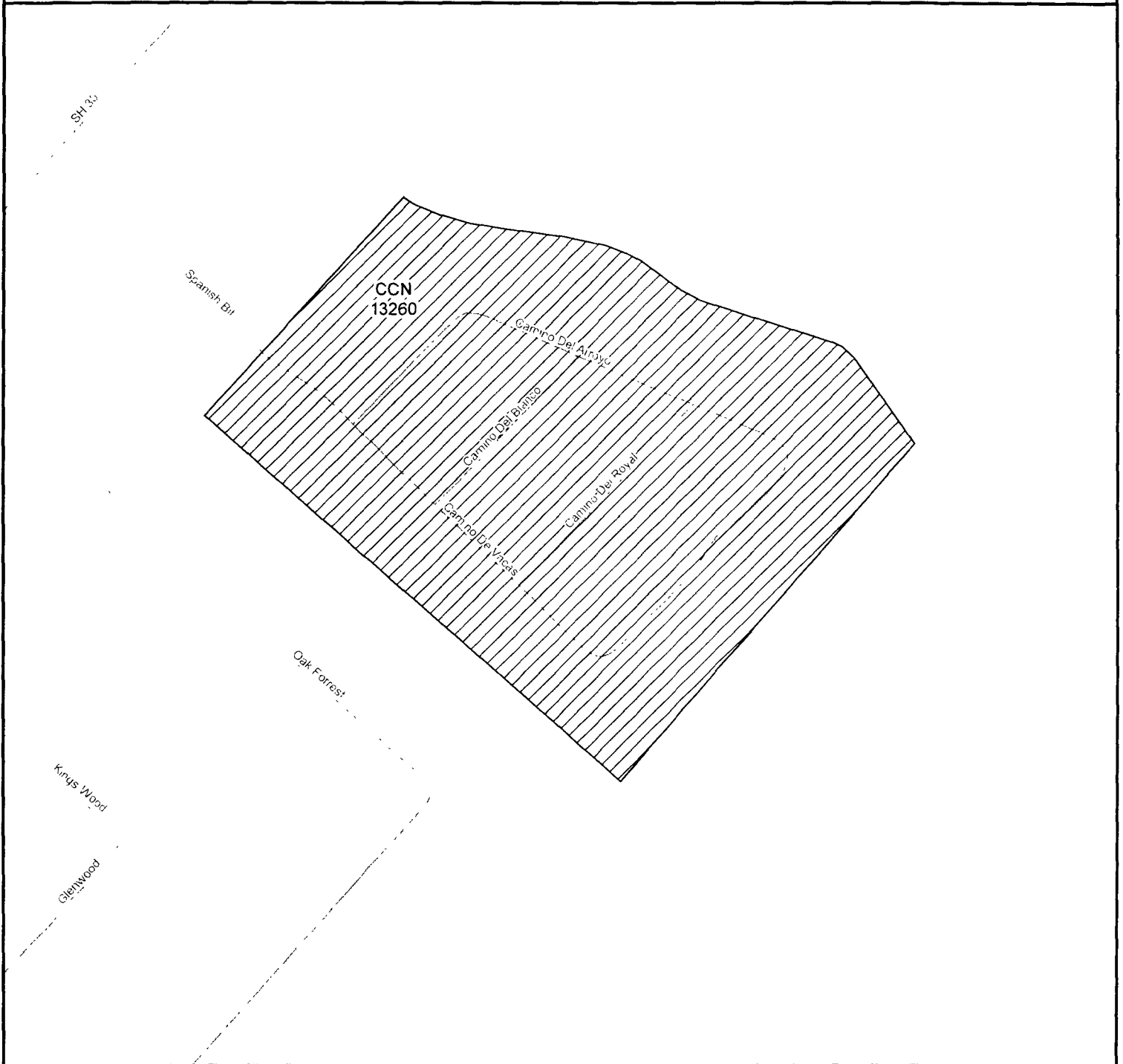

Public Utility Commission of Texas
1701 N Congress Ave
Austin, TX 78701

Water CCN



13260 - Undine Texas LLC

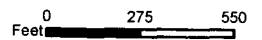

Map by Komal Patel
Date created September 11, 2017
Project Path n \finalmapping\46745UndineTX\Maragorda.mxd



WATER UTILITY TARIFF
Docket Number: 46745

Orbit Systems, Inc.
(Utility Name)

1302 Airline North
(Business Address)

Rosharon, Texas 77583
(City, State, Zip Code)

(281) 369-2041
(Area Code/Telephone)

This tariff is effective for utility operations under the following Certificate of Convenience and Necessity:

11982

This tariff is effective in the following counties:

Brazoria

This tariff is effective in the following cities or unincorporated towns (if any):

None

TABLE OF CONTENTS

The above utility lists the following sections of its tariff (if additional pages are needed for a section, all pages should be numbered consecutively):

SECTION 1.0 -- RATE SCHEDULE	2
SECTION 2.0 -- SERVICE RULES AND POLICIES	4
SECTION 3.0 -- EXTENSION POLICY.....	11

APPENDIX A -- DROUGHT CONTINGENCY PLAN
APPENDIX B -- SAMPLE SERVICE AGREEMENT

This tariff is effective in the following subdivisions or systems:

PWS #	Subdivision/Facility Name	County
0200275	Coronado Country	Brazoria
0200360	Grasslands (Airline Road Est)	Brazoria
0200566	Oak Meadows	Brazoria
0200597	Paloma Acres Subdivision	Brazoria
0200592	Quail Valley Ranches Sec. IV	Brazoria
0200624	Stoneridge Lakes Subdivision	Brazoria

SECTION 1.0 -- RATE SCHEDULE

Section 1.01 - Rates

<u>Meter Size</u>	<u>Monthly Base Rate</u>	<u>Gallonage Charge</u>
5/8" or 3/4"	<u>\$35.00</u> (Includes 0 gallons)	<u>\$3.00</u> per 1000 gallons
1"	<u>\$70.00</u>	
1½"	<u>\$175.00</u>	
2"	<u>\$280.00</u>	
3"	<u>\$525.00</u>	
4" & larger	<u>\$1,100.00</u>	
Unmetered	<u>\$54.78</u>	

Brazoria County Groundwater Conservation

District Production Fee \$0.03 per 1,000 gallons of water usage

FORM OF PAYMENT: The utility will accept the following forms of payment:

Check X, Money Order X, Other (specify) Online Payment or Automatic Bank Draft

THE UTILITY MAY REQUIRE EXACT CHANGE FOR PAYMENTS AND MAY REFUSE TO ACCEPT PAYMENTS MADE USING MORE THAN \$1.00 IN SMALL COINS. A WRITTEN RECEIPT WILL BE GIVEN FOR CASH PAYMENTS.

REGULATORY ASSESSMENT.....1.0%

PUC RULES REQUIRE THE UTILITY TO COLLECT A FEE OF ONE PERCENT OF THE RETAIL MONTHLY BILL AND TO REMIT TO THE TCEQ.

Section 1.02 - Miscellaneous Fees

TAP FEE.....\$600.00

TAP FEE COVERS THE UTILITY'S COSTS FOR MATERIALS AND LABOR TO INSTALL A STANDARD RESIDENTIAL 5/8" or 3/4" METER. AN ADDITIONAL FEE TO COVER UNIQUE COSTS IS PERMITTED IF LISTED ON THIS TARIFF.

TAP FEE (Unique costs).....Actual Cost

FOR EXAMPLE, A ROAD BORE FOR CUSTOMERS OUTSIDE OF SUBDIVISIONS OR RESIDENTIAL AREAS.

TAP FEE (Large meter).....Actual Cost

TAP FEE IS THE UTILITY'S ACTUAL COST FOR MATERIALS AND LABOR FOR METER SIZE INSTALLED.

METER RELOCATION FEE.....Actual Relocation Cost, Not to Exceed Tap Fee

THIS FEE MAY BE CHARGED IF A CUSTOMER REQUESTS THAT AN EXISTING METER BE RELOCATED.

Docket Number: 46745

SECTION 1.0 -- RATE SCHEDULE (Continued)

METER TEST FEE.....\$25.00
THIS FEE WHICH SHOULD REFLECT THE UTILITY'S COST MAY BE CHARGED IF A CUSTOMER REQUESTS A SECOND METER TEST WITHIN A TWO-YEAR PERIOD AND THE TEST INDICATES THAT THE METER IS RECORDING ACCURATELY. THE FEE MAY NOT EXCEED \$25.

RECONNECTION FEE
THE RECONNECT FEE MUST BE PAID BEFORE SERVICE CAN BE RESTORED TO A CUSTOMER WHO HAS BEEN DISCONNECTED FOR THE FOLLOWING REASONS (OR OTHER REASONS LISTED UNDER SECTION 2.0 OF THIS TARIFF):
a) Non payment of bill (Maximum \$25.00).....\$25.00
b) Customer's request that service be disconnected.....\$50.00

TRANSFER FEE.....\$25.00
THE TRANSFER FEE WILL BE CHARGED FOR CHANGING AN ACCOUNT NAME AT THE SAME SERVICE LOCATION WHEN THE SERVICE IS NOT DISCONNECTED.

LATE CHARGE (EITHER \$5.00 OR 10% OF THE BILL)\$5.00
PUC RULES ALLOW A ONE-TIME PENALTY TO BE CHARGED ON DELINQUENT BILLS. A LATE CHARGE MAY NOT BE APPLIED TO ANY BALANCE TO WHICH THE PENALTY WAS APPLIED IN A PREVIOUS BILLING.

RETURNED CHECK CHARGE.....\$25.00
RETURNED CHECK CHARGES MUST BE BASED ON THE UTILITY'S DOCUMENTABLE COST.

CUSTOMER DEPOSIT RESIDENTIAL (Maximum \$50).....\$50.00

COMMERCIAL & NON-RESIDENTIAL DEPOSIT..... 1/6TH OF ESTIMATED ANNUAL BILL

GOVERNMENTAL TESTING, INSPECTION AND COSTS SURCHARGE:
WHEN AUTHORIZED IN WRITING BY PUC AND AFTER NOTICE TO CUSTOMERS, THE UTILITY MAY INCREASE RATES TO RECOVER INCREASED COSTS FOR INSPECTION FEES AND WATER TESTING. [16 TAC 24.21(b)(2)(F)]

LINE EXTENSION AND CONSTRUCTION CHARGES:
REFER TO SECTION 3.0--EXTENSION POLICY FOR TERMS, CONDITIONS, AND CHARGES WHEN NEW CONSTRUCTION IS NECESSARY TO PROVIDE SERVICE.

PURCHASED WATER AND/OR DISTRICT FEE PASS THROUGH CLAUSE:
Changes in fees imposed by any non-affiliated third party water supplier or underground water district having jurisdiction over the Utility shall be passed through as an adjustment to the water gallonage charge according to the following formula:

AG=G + B/(1-L), where
AG= adjusted gallonage charge, rounded to the nearest one cent:
G= approved gallonage charge (per 1,000 gallons);
B=change in purchased water/district gallonage charge (per 1,000 gallons);
L=system average line loss for preceding 12 months not to exceed 0.15

SECTION 2.0 - SERVICE RULES AND POLICIES

The utility will have the most current Public Utility Commission of Texas (PUC or Commission) Rules, Chapter 24, available at its office for reference purposes. The Rules and this tariff shall be available for public inspection and reproduction at a reasonable cost. The latest Rules or Commission approved changes to the Rules supersede any rules or requirements in this tariff.

Section 2.01 - Application for Water Service

All applications for service will be made on the utility's standard application or contract form (attached in the Appendix to this tariff), will be signed by the applicant, any required fees (deposits, reconnect, tap, extension fees, etc. as applicable) will be paid and easements, if required, will be granted before service is provided by the utility. A separate application or contract will be made for each service location.

Section 2.02 - Refusal of Service

The utility may decline to serve an applicant until the applicant has complied with the regulations of the regulatory agencies (state and municipal regulations) and for the reasons outlined in the PUC Rules. In the event that the utility refuses to serve an applicant, the utility will inform the applicant in writing of the basis of its refusal. The utility is also required to inform the applicant that a complaint may be filed with the Commission.

Section 2.03 - Fees and Charges & Easements Required Before Service Can Be Connected

(A) Customer Deposits

If a residential applicant cannot establish credit to the satisfaction of the utility, the applicant may be required to pay a deposit as provided for in Section 1.02 - Miscellaneous Fees of this tariff. The utility will keep records of the deposit and credit interest in accordance with PUC Rules.

Residential applicants 65 years of age or older may not be required to pay deposits unless the applicant has an outstanding account balance with the utility or another water or sewer utility which accrued within the last two years.

Nonresidential applicants who cannot establish credit to the satisfaction of the utility may be required to make a deposit that does not exceed an amount equivalent to one-sixth of the estimated annual billings.

Refund of deposit - If service is not connected, or after disconnection of service, the utility will promptly refund the customer's deposit plus accrued interest or the balance, if any, in excess of the unpaid bills for service furnished. The utility may refund the deposit at any time prior to termination of utility service but must refund the deposit plus interest for any customer who has paid 18 consecutive billings without being delinquent.

(B) Tap or Reconnect Fees

A new customer requesting service at a location where service has not previously been provided must pay a tap fee as provided in Section 1. A customer requesting service where service has previously been provided must pay a reconnect fee as provided in Section 1.

Docket Number: 46745

SECTION 2.0 - SERVICE RULES AND POLICIES (CONT.)

Any applicant or existing customer required to pay for any costs not specifically set forth in the rate schedule pages of this tariff shall be given a written explanation of such costs prior to request for payment and/or commencement of construction. If the applicant or existing customer does not believe that these costs are reasonable or necessary, the applicant or existing customer shall be informed of their right to appeal such costs to the PUC or such other regulatory authority having jurisdiction over the utility's rates in that portion of the utility's service area in which the applicant's or existing customer's property(ies) is located.

Fees in addition to the regular tap fee may be charged to cover unique costs not normally incurred as permitted by §24.86(a)(1)(C) if they are listed on this approved tariff. For example, a road bore for customers outside a subdivision or residential area could be considered a unique cost.

(C) Easement Requirement

Where recorded public utility easements on the service applicant's property do not exist or public road right-of-way easements are not available to access the applicant's property, the Utility may require the applicant to provide it with a permanent recorded public utility easement on and across the applicant's real property sufficient to provide service to that applicant. Such easement(s) shall not be used for the construction of production, storage, transmission or pressure facilities unless they are needed for adequate service to that applicant.

Section 2.04 - Utility Response to Applications for Service

After the applicant has met all the requirements, conditions and regulations for service, the utility will install tap, meter and utility cut-off valve and/or take all necessary actions to initiate service. The utility will serve each qualified applicant for service within 5 working days unless line extensions or new facilities are required. If construction is required to fill the order and if it cannot be completed within 30 days, the utility will provide the applicant with a written explanation of the construction required and an expected date of service.

Except for good cause where service has previously been provided, service will be reconnected within one working day after the applicant has met the requirements for reconnection.

Section 2.05 - Customer Responsibility

The customer will be responsible for furnishing and laying the necessary customer service pipe from the meter location to the place of consumption. Customers will not be allowed to use the utility's cutoff valve on the utility's side of the meter. Existing customers may install cutoff valves on their side of the meter and are encouraged to do so. All new customers must install and maintain a cutoff valve on their side of the meter.

No direct connection between a public water supply system and any potential source of contamination or between a public water supply system and a private water source (ex. private well) will be allowed. A customer shall not connect, or allow any other person or party to connect, onto any water lines on his premises.

Docket Number: 46745

SECTION 2.0 - SERVICE RULES AND POLICIES (CONT.)

Section 2.06 - Customer Service Inspections

Applicants for new service connections or facilities which have undergone extensive plumbing modifications are required to furnish the utility a completed customer service inspection certificate. The inspection certificate shall certify that the establishment is in compliance with the Texas Commission on Environmental Quality(TCEQ) Rules and Regulations for Public Water Systems, §290.46(j). The Utility is not required to perform these inspections for the applicant/customer, but will assist the applicant/customer in locating and obtaining the services of a certified inspector.

Section 2.07 - Back Flow Prevention Devices

All non-residential customers requiring a greater than 1" meter or any customer with irrigation or fire fighting systems, must install back flow prevention devices which have been approved by the utility or its consulting engineers on each of their customer service lines.

The back flow assembly shall be tested upon installation by a recognized prevention assembly tester and certified to be operating within specifications. Back flow prevention assemblies which are installed to provide protection against high health hazards must be tested and certified to be operating within specifications at least annually by a recognized back flow prevention device tester. The maintenance and testing of the back flow assembly shall occur at the customer's expense.

No water connection shall be made to any establishment where an actual or potential contamination or system hazard exists without an approved air gap or mechanical backflow prevention assembly. The air gap or backflow prevention assembly shall be installed in accordance with the American Water Works Association (AWWA) standards C510, C511 and AWWA Manual M14 or the University of Southern California Manual of Cross-Connection Control, current edition. The backflow assembly installation by a licensed plumber shall occur at the customer's expense.

Section 2.08 - Access to Customer's Premises

The utility will have the right of access to the customer's premises at all reasonable times for the purpose of installing, testing, inspecting or repairing water mains or other equipment used in connection with its provision of water service, or for the purpose of removing its property and disconnecting lines, and for all other purposes necessary to the operation of the utility system including inspecting the customer's plumbing for code, plumbing or tariff violations. The customer shall allow the utility and its personnel access to the customer's property to conduct any water quality tests or inspections required by law. Unless necessary to respond to equipment failure, leak or other condition creating an immediate threat to public health and safety or the continued provision of adequate utility service to others, such entry upon the customer's property shall be during normal business hours and the utility personnel will attempt to notify the customer that they will be working on the customer's property. The customer may require any utility representative, employee, contractor, or agent seeking to make such entry identify themselves, their affiliation with the utility, and the purpose of their entry.

SECTION 2.0 - SERVICE RULES AND POLICIES (CONT.)

All customers or service applicants shall provide access to meters and utility cutoff valves at all times reasonably necessary to conduct ordinary utility business and after normal business hours as needed to protect and preserve the integrity of the public drinking water supply.

Section 2.09 - Meter Requirements, Readings, and Testing

One meter is required for each residential, commercial, or industrial connection. All water sold by the utility will be billed based on meter measurements. The utility will provide, install, own and maintain meters to measure amounts of water consumed by its customers.

Meters will be read at monthly intervals and as nearly as possible on the corresponding day of each monthly meter reading period unless otherwise authorized by the Commission.

Meter tests. The utility will, upon the request of a customer, and, if the customer so desires, in his or her presence or in that of his or her authorized representative, make without charge a test of the accuracy of the customer's meter. If the customer asks to observe the test, the test will be made during the utility's normal working hours at a time convenient to the customer. Whenever possible, the test will be made on the customer's premises, but may, at the utility's discretion, be made at the utility's testing facility. If within a period of two years the customer requests a new test, the utility will make the test, but if the meter is found to be within the accuracy standards established by the American Water Works Association, the utility will charge the customer a fee which reflects the cost to test the meter up to a maximum \$25 for a residential customer. Following the completion of any requested test, the utility will promptly advise the customer of the date of removal of the meter, the date of the test, the result of the test, and who made the test.

Section 2.10 - Billing

(A) Regular Billing

Bills from the utility will be mailed monthly unless otherwise authorized by the Commission. The due date of bills for utility service will be at least sixteen (16) days from the date of issuance. The postmark on the bill or, if there is no postmark on the bill, the recorded date of mailing by the utility will constitute proof of the date of issuance. Payment for utility service is delinquent if full payment, including late fees and the regulatory assessment, is not received at the utility or the utility's authorized payment agency by 5:00 p.m. on the due date. If the due date falls on a holiday or weekend, the due date for payment purposes will be the next workday after the due date.

(B) Late Fees

A late penalty of either \$5.00 or 10.0% will be charged on bills received after the due date. The penalty on delinquent bills will not be applied to any balance to which the penalty was applied in a previous billing. The utility must maintain a record of the date of mailing to charge the late penalty.

(C) Information on Bill

Each bill will provide all information required by the PUC Rules. For each of the systems it operates, the utility will maintain and note on the monthly bill a local or toll-free telephone number (or numbers) to which customers can direct questions about their utility service.

SECTION 2.0 - SERVICE RULES AND POLICIES (CONT.)

(D) Prorated Bills

If service is interrupted or seriously impaired for 24 consecutive hours or more, the utility will prorate the monthly base bill in proportion to the time service was not available to reflect this loss of service.

Section 2.11- Payments

All payments for utility service shall be delivered or mailed to the utility's business office. If the business office fails to receive payment prior to the time of noticed disconnection for non-payment of a delinquent account, service will be terminated as scheduled. Utility service crews shall not be allowed to collect payments on customer accounts in the field.

Payment of an account by any means that has been dishonored and returned by the payor or payee's bank, shall be deemed to be delinquent. All returned payments must be redeemed with cash or valid money order. If a customer has two returned payments within a twelve month period, the customer shall be required to pay a deposit if one has not already been paid.

Section 2.12 - Service Disconnection

(A) With Notice

Utility service may be disconnected if the bill has not been paid in full by the date listed on the termination notice. The termination date must be at least 10 days after the notice is mailed or hand delivered.

The utility is encouraged to offer a deferred payment plan to a customer who cannot pay an outstanding bill in full and is willing to pay the balance in reasonable installments. However, a customer's utility service may be disconnected if a bill has not been paid or a deferred payment agreement entered into within 26 days from the date of issuance of a bill and if proper notice of termination has been given. Notice of termination must be a separate mailing or hand delivery in accordance with the PUC Rules.

(B) Without Notice

Utility service may also be disconnected without notice for reasons as described in the PUC Rules.

Section 2.13 - Reconnection of Service

Utility personnel must be available during normal business hours to accept payments on the day service is disconnected and the following day unless service was disconnected at the customer's request or due to a hazardous condition.

Service will be reconnected within 24 hours after the past due bill, reconnect fees and any other outstanding charges are paid or the conditions which caused service to be disconnected are corrected.

SECTION 2.0 - SERVICE RULES AND POLICIES (CONT.)

Section 2.14 - Service Interruptions

The utility will make all reasonable efforts to prevent interruptions of service. If interruptions occur, the utility will re-establish service within the shortest possible time. Except for momentary interruptions due to automatic equipment operations, the utility will keep a complete record of all interruptions, both emergency and scheduled and will notify the Commission in writing of any service interruptions affecting the entire system or any major division of the system lasting more than four hours. The notice will explain the cause of the interruptions.

Section 2.15 - Quality of Service

The utility will plan, furnish, and maintain production, treatment, storage, transmission, and distribution facilities of sufficient size and capacity to provide a continuous and adequate supply of water for all reasonable consumer uses. Unless otherwise authorized by the Commission, the utility will maintain facilities as described in the TCEQ Rules and Regulations for Public Water Systems.

Section 2.16 - Customer Complaints and Disputes

If a customer or applicant for service lodges a complaint, the utility will promptly make a suitable investigation and advise the complainant of the results. Service will not be disconnected pending completion of the investigation. If the complainant is dissatisfied with the utility's response, the utility must advise the complainant that he has recourse through the PUC complaint process. Pending resolution of a complaint, the commission may require continuation or restoration of service.

The utility will maintain a record of all complaints which shows the name and address of the complainant, the date and nature of the complaint and the adjustment or disposition thereof, for a period of two years after the final settlement of the complaint.

In the event of a dispute between a customer and a utility regarding any bill for utility service, the utility will conduct an investigation and report the results to the customer. If the dispute is not resolved, the utility will inform the customer that a complaint may be filed with the Commission.

Section 2.17 - Customer Liability

Customer shall be liable for any damage or injury to utility-owned property shown to be caused by the customer.

SECTION 3.0 - EXTENSION POLICY

Section 3.01 - Standard Extension Requirements

Line Extension and Construction Charges: No Contributions in Aid of Construction may be required of any customer except as provided for in the approved extension policy.

The customer will be given an itemized statement of the costs, options such as rebates to the customer, sharing of construction costs between the utility and the customer, or sharing of costs between the customer and other applicants prior to beginning construction.

Unless an exception is granted by the PUC, the residential service applicant shall not be required to pay for costs of main extensions greater than 2" in diameter for water distribution and pressure wastewater collection lines and 6" in diameter for gravity wastewater lines.

Exceptions may be granted by the PUC if:

- adequate service cannot be provided to the applicant using the maximum line sizes listed due to distance or elevation, in which case, it shall be the utility's burden to justify that a larger diameter pipe is required for adequate service;
- or larger minimum line sizes are required under subdivision platting requirements or building codes of municipalities within whose corporate limits or extraterritorial jurisdiction the point of use is located; or the residential service applicant is located outside the CCN service area.

If an exception is granted, the Utility shall establish a proportional cost plan for the specific extension or a rebate plan which may be limited to seven years to return the portion of the applicant's costs for oversizing as new customers are added to ensure that future applicants for service on the line pay at least as much as the initial service applicant.

The utility shall bear the cost of any over-sizing of water distribution lines or waste water collection lines necessary to serve other potential service applicants for customers in the immediate area.

For purposes of determining the costs that service applicants shall pay, commercial customers with service demands greater than residential customer demands in the certificated area, industrial, and wholesale customers shall be treated as developers. A service applicant requesting a one inch meter for a lawn sprinkler system to service a residential lot is not considered nonstandard service.

If an applicant requires service other than the standard service provided by the utility, such applicant will be required to pay all expenses incurred by the utility in excess of the expenses that would be incurred in providing the standard service and connection beyond 200 feet and throughout his property including the cost of all necessary transmission facilities.

Residential customers will be charged the equivalent of the costs of extending service to their property from the nearest transmission or distribution line even if that line does not have adequate capacity to serve the customer. However, if the customer places unique, non-standard service demands upon the system, the customer may be charged the additional cost of extending service to and throughout their property, including the cost of all necessary transmission and storage facilities necessary to meet the service demands anticipated to be created by that property.

SECTION 3.0 - EXTENSION POLICY (CONT.)

Section 3.02 - Costs Utilities Shall Bear

The utility will bear the full cost of any oversizing of water mains necessary to serve other customers in the immediate area. The individual residential customer shall not be charged for any additional production, storage, or treatment facilities. Contributions in aid of construction may not be required of individual residential customers for production, storage, treatment or transmission facilities unless otherwise approved by the Commission under this specific extension policy.

Within its certificate area, the utility will pay the cost of the first 200 feet of any water main or distribution line necessary to extend service to an individual residential customer within a platted subdivision. However, if the residential customer requesting service purchased the property after the developer was notified of the need to provide facilities to the utility, the utility may charge for the first 200 feet. The utility must also be able to document that the developer of the subdivision refused to provide facilities compatible with the utility's facilities in accordance with the utility's approved extension policy after receiving a written request from the utility.

The Utility is not required to extend service to any applicant outside of its certificated service area and will only do so under terms and conditions mutually agreeable to the Utility and the applicant, in compliance with PUC rules and policies, and upon extension of the Utility's certificated service area boundaries by the PUC.

Section 3.03 - Contributions in Aid of Construction

Developers may be required to provide contributions in aid of construction in amounts sufficient to furnish the development with all facilities necessary to provide for reasonable local demand requirements and to comply with TCEQ minimum design criteria for facilities used in the production, transmission, pumping, or treatment of water or TCEQ minimum requirements. For purposes of this subsection, a developer is one who subdivides or requests more than two meters on a piece of property. Commercial, industrial, and wholesale customers will be treated as developers.

Any applicant who places unique or non-standard service demands on the system may be required to provide contributions in aid of construction for the actual costs of any additional facilities required to maintain compliance with the TCEQ minimum design criteria for water production, treatment, pumping, storage and transmission.

Any service extension to a subdivision (recorded or unrecorded) may be subject to the provisions and restrictions of § 24.86(d). When a developer wishes to extend the system to prepare to service multiple new connections, the charge shall be the cost of such extension, plus a pro-rata charge for facilities which must be committed to such extension compliant with the TCEQ minimum design criteria. As provided by § 24.85(e)(3), for purposes of this section, commercial, industrial, and wholesale customers shall be treated as developers.

SECTION 3.0 - EXTENSION POLICY (CONT.)

Section 3.04 - Appealing Connection Costs

The imposition of additional extension costs or charges as provided by Sections 3.0 - Extension Policy of this tariff shall be subject to appeal as provided in this tariff, PUC rules, or the rules of such other regulatory authority as may have jurisdiction over the utility's rates and services. Any applicant required to pay for any costs not specifically set forth in the rate schedule pages of this tariff shall be given a written explanation of such costs prior to payment and/or commencement of construction. If the applicant does not believe that these costs are reasonable or necessary, the applicant shall be informed of the right to appeal such costs to the PUC or such other regulatory authority having jurisdiction over the utility's rates in that portion of the utility's service area in which the applicant's property(ies) is located.

Section 3.05 - Applying for Service

The Utility will provide a written service application form to the applicant for each request for service received by the Utility's business offices. A separate application shall be required for each potential service location if more than one service connection is desired by any individual applicant. Service application forms will be available at the Utility's business office during normal weekday business hours. Service applications will be sent by prepaid first class United States mail to the address provided by the applicant upon request. Completed applications should be returned by hand delivery in case there are questions which might delay fulfilling the service request. Completed service applications may be submitted by mail if hand delivery is not possible.

Where a new tap or service connection is required, the service applicant shall be required to submit a written service application and request that a tap be made.

The tap request must be accompanied with a diagram, map, plat, or written metes and bounds description of precisely where the applicant desires each tap or service connection is to be made and, if necessary, where the meter is to be installed, along the applicant's property line. The actual point of connection and meter installation must be readily accessible to Utility personnel for inspection, servicing, and meter reading while being reasonably secure from damage by vehicles and mowers. If the Utility has more than one main adjacent to the service applicant's property, the tap or service connection will be made to the Utility's nearest service main with adequate capacity to service the applicant's full potential service demand. Beyond the initial 200 feet, the customer shall bear only the equivalent cost of extending from the nearest main. If the tap or service connection cannot be made at the applicant's desired location, it will be made at another location mutually acceptable to the applicant and the Utility. If no agreement on location can be made, the applicant may refer the matter to the PUC for resolution.

Section 3.06 - Qualified Service Applicant

A "qualified service applicant" is an applicant who has: (1) met all of the Utility's requirements for service contained in this tariff, PUC rules and/or PUC order, (2) has made payment or made arrangement for payment of tap fees, (3) has provided all necessary easements and rights-of-way necessary to provide service to the requested location, (4) delivered an executed customer service inspection certificate to the Utility, if applicable, and (5) has executed a customer service application for each location to which service is being requested.

Docket Number: 46745

SECTION 3.0 - EXTENSION POLICY (CONT.)

The Utility shall serve each qualified service applicant within its certificated service area as soon as practical after receiving a completed service application. All service requests will be fulfilled within the time limits prescribed by PUC rules once the applicant has met all conditions precedent to achieving "qualified service applicant" status. If a service request cannot be fulfilled within the required period, the applicant shall be notified in writing of the delay, its cause and the anticipated date that service will be available. The PUC service dates shall not become applicable until the service applicant has met all conditions precedent to becoming a qualified service applicant as defined by PUC rules.

Section 3.07 - Developer Requirements

As a condition of service to a new subdivision, the Utility shall require a developer (as defined by PUC rule) to provide permanent recorded public utility easements as a condition of service to any location within the developer's property.

In cases of extreme drought, periods of abnormally high usage, or extended reduction in ability to supply water due to equipment failure, temporary restrictions may be instituted to limit water usage. The purpose of the Drought Contingency Plan is to encourage customer conservation in order to maintain supply, storage or pressure or to comply with requirements of a court, government agency or other authority.

APPENDIX A – DROUGHT CONTINGENCY PLAN
(Utility must attach a copy of TCEQ approved Drought Contingency Plan)

APPENDIX B
Chapter 290.47(b) Sample Service Agreement

SERVICE AGREEMENT

- I. **PURPOSE.** The NAME OF WATER SYSTEM is responsible for protecting the drinking water supply from contamination or pollution which could result from improper private water distribution system construction or configuration. The purpose of this service agreement is to notify each customer of the restrictions which are in place to provide this protection. The utility enforces these restrictions to ensure the public health and welfare. Each customer must sign this agreement before the NAME OF WATER SYSTEM will begin service. In addition, when service to an existing connection has been suspended or terminated, the water system will not re-establish service unless it has a signed copy of this agreement.

- II. **RESTRICTIONS.** The following unacceptable practices are prohibited by State regulations.
 - A. No direct connection between the public drinking water supply and a potential source of contamination is permitted. Potential sources of contamination shall be isolated from the public water system by an air-gap or an appropriate backflow prevention device.
 - B. No cross-connection between the public drinking water supply and a private water system is permitted. These potential threats to the public drinking water supply shall be eliminated at the service connection by the installation of an air-gap or a reduced pressure-zone backflow prevention device.
 - C. No connection which allows water to be returned to the public drinking water supply is permitted.
 - D. No pipe or pipe fitting which contains more than 8.0% lead may be used for the installation or repair of plumbing at any connection which provides water for human use.
 - E. No solder or flux which contains more than 0.2% lead can be used for the installation or repair of plumbing at any connection which provides water for human use.

- III. **SERVICE AGREEMENT.** The following are the terms of the service agreement between the NAME OF WATER SYSTEM (the Water System) and NAME OF CUSTOMER (the Customer).
 - A. The Water System will maintain a copy of this agreement as long as the Customer and/or the premises is connected to the Water System.
 - B. The Customer shall allow his property to be inspected for possible cross-connections and other potential contamination hazards. These inspections shall be conducted by the Water System or its designated agent prior to initiating new water service; when there is reason to believe that cross-connections or other potential contamination hazards exist; or after any major changes to the private water distribution facilities. The inspections shall be conducted during the Water System's normal business hours.
 - C. The Water System shall notify the Customer in writing of any cross-connection or other potential contamination hazard which has been identified during the initial inspection or the periodic reinspection.
 - D. The Customer shall immediately remove or adequately isolate any potential cross-connections or other potential contamination hazards on his premises.

- E. The Customer shall, at his expense, properly install, test, and maintain any backflow prevention device required by the Water System. Copies of all testing and maintenance records shall be provided to the Water System.

IV. ENFORCEMENT

If the Customer fails to comply with the terms of the Service Agreement, the Water System shall, at its option, either terminate service or properly install, test, and maintain an appropriate backflow prevention device at the service connection. Any expenses associated with the enforcement of this agreement shall be billed to the Customer.

CUSTOMER'S SIGNATURE: _____

DATE: _____



WATER UTILITY TARIFF
Docket Number: 46745

Undine Texas, LLC.
(Utility Name)

10913 Metronome Dr.
(Business Address)

Houston, Texas 77043
(City, State, Zip Code)

(713) 574-5953
(Area Code/Telephone)

This tariff is effective for utility operations under the following Certificate of Convenience and Necessity:

13260

This tariff is effective in the following counties:

Brazoria, Fort Bend, and Matagorda

This utility provides service in the following cities or unincorporated towns (if any):

City of Manvel (Brandi Estates)

“The rates set or approved by the city for the systems within its corporate boundary are not presented in this tariff. Those rates are not under the original jurisdiction of the Public Utility Commission of Texas and will have to be obtained from the city or utility.”

This tariff is effective in the following subdivisions and public water systems:

See attached list

TABLE OF CONTENTS

The above utility lists the following sections of its tariff (if additional pages are needed for a section, all pages should be numbered consecutively):

SECTION 1.0 -- RATE SCHEDULE.....	2
SECTION 2.0 -- SERVICE RULES AND POLICIES	3
SECTION 3.0 -- EXTENSION POLICY	12

APPENDIX A -- DROUGHT CONTINGENCY PLAN
APPENDIX B -- SAMPLE SERVICE AGREEMENT

This tariff is effective in the following subdivisions or systems:

PWS #	Subdivision/Facility Name	County
0790425	723 Utility	Fort Bend
0200244	Angle Acres Water System	Brazoria
0200358	Bayou Colony Subdivision	Brazoria
0200245	Beechwood Subdivision	Brazoria
0200338	Bernard Oaks Subdivision	Brazoria
0200323	Blue Sage Gardens Subdivision	Brazoria
0200325	Brandi Estates *	Brazoria
0200639	Brazos Oaks Subdivision	Brazoria
0200410	Briar Meadows	Brazoria
0200324	Colony Cove	Brazoria
0200604	Colony Trails	Brazoria
0200274	Country Acres Estates	Brazoria
0200273	Country Meadows	Brazoria
0790510	Crystal Lake Estates	Fort Bend
0200185	Demi-John Place Water System	Brazoria
0200234	Demi-John Island Water System	Brazoria
0200339	Larkspur Subdivision	Brazoria
0200506	Lee Ridge	Brazoria
0200432	Mark V Estates	Brazoria
0200094	Mooreland	Brazoria
0200592	Quail Valley Ranches Sec. IV	Brazoria
0200058	Riverside Estates	Brazoria
0200346	Rosharon Road Estates	Brazoria
0200108	Ryan Long II	Brazoria
0200460	San Bernard River Estates	Brazoria
0200335	Sandy Meadows Estates	Brazoria
0200053	Snug Harbor	Brazoria
1610102	Spanish Bit Plantation	Matagorda
0790504	Tejas Lakes Subdivision	Fort Bend
0200638	Village Lakes	Brazoria
0200083	Wilco Water/Holiday Beach	Brazoria
0200370	Wolf Glen	Brazoria

*Brandi Estates subject to City of Manvel Approval

Docket Number: 46745

SECTION 1.0 -- RATE SCHEDULE

Section 1.01 - Rates

<u>Meter Size</u>	<u>Monthly Base Rate</u>	<u>Gallonage Charge</u>
5/8" or 3/4"	<u>\$35.00</u> (Includes 0 gallons)	<u>\$3.00</u> per 1000 gallons
1"	<u>\$70.00</u>	
1½"	<u>\$175.00</u>	
2"	<u>\$280.00</u>	
3"	<u>\$525.00</u>	
4" & larger	<u>\$1,100.00</u>	
Unmetered	<u>\$54.78</u>	

Brazoria County Groundwater Conservation

District Production Fee\$0.03 per 1,000 gallons of water usage

FORM OF PAYMENT: The utility will accept the following forms of payment:

Check X, Money Order X, Other (specify) Online Payment or Automatic Bank Draft

THE UTILITY MAY REQUIRE EXACT CHANGE FOR PAYMENTS AND MAY REFUSE TO ACCEPT PAYMENTS MADE USING MORE THAN \$1.00 IN SMALL COINS. A WRITTEN RECEIPT WILL BE GIVEN FOR CASH PAYMENTS.

REGULATORY ASSESSMENT 1.0%

PUC RULES REQUIRE THE UTILITY TO COLLECT A FEE OF ONE PERCENT OF THE RETAIL MONTHLY BILL AND TO REMIT TO THE TCEQ.

Section 1.02 - Miscellaneous Fees

TAP FEE \$600.00

TAP FEE COVERS THE UTILITY'S COSTS FOR MATERIALS AND LABOR TO INSTALL A STANDARD RESIDENTIAL 5/8" or 3/4" METER. AN ADDITIONAL FEE TO COVER UNIQUE COSTS IS PERMITTED IF LISTED ON THIS TARIFF.

TAP FEE (Unique costs) Actual Cost

FOR EXAMPLE, A ROAD BORE FOR CUSTOMERS OUTSIDE OF SUBDIVISIONS OR RESIDENTIAL AREAS.

TAP FEE (Large meter) Actual Cost

TAP FEE IS THE UTILITY'S ACTUAL COST FOR MATERIALS AND LABOR FOR METER SIZE INSTALLED.

METER RELOCATION FEE Actual Relocation Cost, Not to Exceed Tap Fee

THIS FEE MAY BE CHARGED IF A CUSTOMER REQUESTS THAT AN EXISTING METER BE RELOCATED.

SECTION 1.0 -- RATE SCHEDULE (Continued)

METER TEST FEE.....\$25.00
THIS FEE WHICH SHOULD REFLECT THE UTILITY'S COST MAY BE CHARGED IF A CUSTOMER REQUESTS A SECOND METER TEST WITHIN A TWO-YEAR PERIOD AND THE TEST INDICATES THAT THE METER IS RECORDING ACCURATELY. THE FEE MAY NOT EXCEED \$25.

RECONNECTION FEE
THE RECONNECT FEE MUST BE PAID BEFORE SERVICE CAN BE RESTORED TO A CUSTOMER WHO HAS BEEN DISCONNECTED FOR THE FOLLOWING REASONS (OR OTHER REASONS LISTED UNDER SECTION 2.0 OF THIS TARIFF):
a) Non payment of bill (Maximum \$25.00).....\$25.00
b) Customer's request that service be disconnected.....\$50.00

TRANSFER FEE.....\$25.00
THE TRANSFER FEE WILL BE CHARGED FOR CHANGING AN ACCOUNT NAME AT THE SAME SERVICE LOCATION WHEN THE SERVICE IS NOT DISCONNECTED.

LATE CHARGE (EITHER \$5.00 OR 10% OF THE BILL)\$5.00
PUC RULES ALLOW A ONE-TIME PENALTY TO BE CHARGED ON DELINQUENT BILLS. A LATE CHARGE MAY NOT BE APPLIED TO ANY BALANCE TO WHICH THE PENALTY WAS APPLIED IN A PREVIOUS BILLING.

RETURNED CHECK CHARGE\$25.00
RETURNED CHECK CHARGES MUST BE BASED ON THE UTILITY'S DOCUMENTABLE COST.

CUSTOMER DEPOSIT RESIDENTIAL (Maximum \$50).....\$50.00

COMMERCIAL & NON-RESIDENTIAL DEPOSIT..... 1/6TH OF ESTIMATED ANNUAL BILL

GOVERNMENTAL TESTING, INSPECTION AND COSTS SURCHARGE:
WHEN AUTHORIZED IN WRITING BY PUC AND AFTER NOTICE TO CUSTOMERS, THE UTILITY MAY INCREASE RATES TO RECOVER INCREASED COSTS FOR INSPECTION FEES AND WATER TESTING. [16 TAC 24.21(b)(2)(F)]

LINE EXTENSION AND CONSTRUCTION CHARGES:
REFER TO SECTION 3.0--EXTENSION POLICY FOR TERMS, CONDITIONS, AND CHARGES WHEN NEW CONSTRUCTION IS NECESSARY TO PROVIDE SERVICE.

PURCHASED WATER AND/OR DISTRICT FEE PASS THROUGH CLAUSE:
Changes in fees imposed by any non-affiliated third party water supplier or underground water district having jurisdiction over the Utility shall be passed through as an adjustment to the water gallonage charge according to the following formula:

AG=G + B/(1-L), where
AG= adjusted gallonage charge, rounded to the nearest one cent;
G= approved gallonage charge (per 1,000 gallons);
B=change in purchased water/district gallonage charge (per 1,000 gallons);
L=system average line loss for preceding 12 months not to exceed 0.15

SECTION 2.0 - SERVICE RULES AND POLICIES

The utility will have the most current Public Utility Commission of Texas (PUC or Commission) Rules, Chapter 24, available at its office for reference purposes. The Rules and this tariff shall be available for public inspection and reproduction at a reasonable cost. The latest Rules or Commission approved changes to the Rules supersede any rules or requirements in this tariff.

Section 2.01 - Application for Water Service

All applications for service will be made on the utility's standard application or contract form (attached in the Appendix to this tariff), will be signed by the applicant, any required fees (deposits, reconnect, tap, extension fees, etc. as applicable) will be paid and easements, if required, will be granted before service is provided by the utility. A separate application or contract will be made for each service location.

Section 2.02 - Refusal of Service

The utility may decline to serve an applicant until the applicant has complied with the regulations of the regulatory agencies (state and municipal regulations) and for the reasons outlined in the PUC Rules. In the event that the utility refuses to serve an applicant, the utility will inform the applicant in writing of the basis of its refusal. The utility is also required to inform the applicant that a complaint may be filed with the Commission.

Section 2.03 - Fees and Charges & Easements Required Before Service Can Be Connected

(A) Customer Deposits

If a residential applicant cannot establish credit to the satisfaction of the utility, the applicant may be required to pay a deposit as provided for in Section 1.02 - Miscellaneous Fees of this tariff. The utility will keep records of the deposit and credit interest in accordance with PUC Rules.

Residential applicants 65 years of age or older may not be required to pay deposits unless the applicant has an outstanding account balance with the utility or another water or sewer utility which accrued within the last two years.

Nonresidential applicants who cannot establish credit to the satisfaction of the utility may be required to make a deposit that does not exceed an amount equivalent to one-sixth of the estimated annual billings.

Refund of deposit - If service is not connected, or after disconnection of service, the utility will promptly refund the customer's deposit plus accrued interest or the balance, if any, in excess of the unpaid bills for service furnished. The utility may refund the deposit at any time prior to termination of utility service but must refund the deposit plus interest for any customer who has paid 18 consecutive billings without being delinquent.

(B) Tap or Reconnect Fees

A new customer requesting service at a location where service has not previously been provided must pay a tap fee as provided in Section 1. A customer requesting service where service has previously been provided must pay a reconnect fee as provided in Section 1.

SECTION 2.0 - SERVICE RULES AND POLICIES (CONT.)

Any applicant or existing customer required to pay for any costs not specifically set forth in the rate schedule pages of this tariff shall be given a written explanation of such costs prior to request for payment and/or commencement of construction. If the applicant or existing customer does not believe that these costs are reasonable or necessary, the applicant or existing customer shall be informed of their right to appeal such costs to the PUC or such other regulatory authority having jurisdiction over the utility's rates in that portion of the utility's service area in which the applicant's or existing customer's property(ies) is located.

Fees in addition to the regular tap fee may be charged to cover unique costs not normally incurred as permitted by §24.86(a)(1)(C) if they are listed on this approved tariff. For example, a road bore for customers outside a subdivision or residential area could be considered a unique cost.

(C) Easement Requirement

Where recorded public utility easements on the service applicant's property do not exist or public road right-of-way easements are not available to access the applicant's property, the Utility may require the applicant to provide it with a permanent recorded public utility easement on and across the applicant's real property sufficient to provide service to that applicant. Such easement(s) shall not be used for the construction of production, storage, transmission or pressure facilities unless they are needed for adequate service to that applicant.

Section 2.04 - Utility Response to Applications for Service

After the applicant has met all the requirements, conditions and regulations for service, the utility will install tap, meter and utility cut-off valve and/or take all necessary actions to initiate service. The utility will serve each qualified applicant for service within 5 working days unless line extensions or new facilities are required. If construction is required to fill the order and if it cannot be completed within 30 days, the utility will provide the applicant with a written explanation of the construction required and an expected date of service.

Except for good cause where service has previously been provided, service will be reconnected within one working day after the applicant has met the requirements for reconnection.

Section 2.05 - Customer Responsibility

The customer will be responsible for furnishing and laying the necessary customer service pipe from the meter location to the place of consumption. Customers will not be allowed to use the utility's cutoff valve on the utility's side of the meter. Existing customers may install cutoff valves on their side of the meter and are encouraged to do so. All new customers must install and maintain a cutoff valve on their side of the meter.

No direct connection between a public water supply system and any potential source of contamination or between a public water supply system and a private water source (ex. private well) will be allowed. A customer shall not connect, or allow any other person or party to connect, onto any water lines on his premises.

SECTION 2.0 - SERVICE RULES AND POLICIES (CONT.)

Section 2.06 - Customer Service Inspections

Applicants for new service connections or facilities which have undergone extensive plumbing modifications are required to furnish the utility a completed customer service inspection certificate. The inspection certificate shall certify that the establishment is in compliance with the Texas Commission on Environmental Quality (TCEQ) Rules and Regulations for Public Water Systems, §290.46(j). The Utility is not required to perform these inspections for the applicant/customer, but will assist the applicant/customer in locating and obtaining the services of a certified inspector.

Section 2.07 - Back Flow Prevention Devices

All non-residential customers requiring a greater than 1" meter or any customer with irrigation or fire fighting systems, must install back flow prevention devices which have been approved by the utility or its consulting engineers on each of their customer service lines.

The back flow assembly shall be tested upon installation by a recognized prevention assembly tester and certified to be operating within specifications. Back flow prevention assemblies which are installed to provide protection against high health hazards must be tested and certified to be operating within specifications at least annually by a recognized back flow prevention device tester. The maintenance and testing of the back flow assembly shall occur at the customer's expense.

No water connection shall be made to any establishment where an actual or potential contamination or system hazard exists without an approved air gap or mechanical backflow prevention assembly. The air gap or backflow prevention assembly shall be installed in accordance with the American Water Works Association (AWWA) standards C510, C511 and AWWA Manual M14 or the University of Southern California Manual of Cross-Connection Control, current edition. The backflow assembly installation by a licensed plumber shall occur at the customer's expense.

Section 2.08 - Access to Customer's Premises

The utility will have the right of access to the customer's premises at all reasonable times for the purpose of installing, testing, inspecting or repairing water mains or other equipment used in connection with its provision of water service, or for the purpose of removing its property and disconnecting lines, and for all other purposes necessary to the operation of the utility system including inspecting the customer's plumbing for code, plumbing or tariff violations. The customer shall allow the utility and its personnel access to the customer's property to conduct any water quality tests or inspections required by law. Unless necessary to respond to equipment failure, leak or other condition creating an immediate threat to public health and safety or the continued provision of adequate utility service to others, such entry upon the customer's property shall be during normal business hours and the utility personnel will attempt to notify the customer that they will be working on the customer's property. The customer may require any utility representative, employee, contractor, or agent seeking to make such entry identify themselves, their affiliation with the utility, and the purpose of their entry.

SECTION 2.0 - SERVICE RULES AND POLICIES (CONT.)

All customers or service applicants shall provide access to meters and utility cutoff valves at all times reasonably necessary to conduct ordinary utility business and after normal business hours as needed to protect and preserve the integrity of the public drinking water supply.

Section 2.09 - Meter Requirements, Readings, and Testing

One meter is required for each residential, commercial, or industrial connection. All water sold by the utility will be billed based on meter measurements. The utility will provide, install, own and maintain meters to measure amounts of water consumed by its customers.

Meters will be read at monthly intervals and as nearly as possible on the corresponding day of each monthly meter reading period unless otherwise authorized by the Commission.

Meter tests. The utility will, upon the request of a customer, and, if the customer so desires, in his or her presence or in that of his or her authorized representative, make without charge a test of the accuracy of the customer's meter. If the customer asks to observe the test, the test will be made during the utility's normal working hours at a time convenient to the customer. Whenever possible, the test will be made on the customer's premises, but may, at the utility's discretion, be made at the utility's testing facility. If within a period of two years the customer requests a new test, the utility will make the test, but if the meter is found to be within the accuracy standards established by the American Water Works Association, the utility will charge the customer a fee which reflects the cost to test the meter up to a maximum \$25 for a residential customer. Following the completion of any requested test, the utility will promptly advise the customer of the date of removal of the meter, the date of the test, the result of the test, and who made the test.

Section 2.10 - Billing

(A) Regular Billing

Bills from the utility will be mailed monthly unless otherwise authorized by the Commission. The due date of bills for utility service will be at least sixteen (16) days from the date of issuance. The postmark on the bill or, if there is no postmark on the bill, the recorded date of mailing by the utility will constitute proof of the date of issuance. Payment for utility service is delinquent if full payment, including late fees and the regulatory assessment, is not received at the utility or the utility's authorized payment agency by 5:00 p.m. on the due date. If the due date falls on a holiday or weekend, the due date for payment purposes will be the next workday after the due date.

(B) Late Fees

A late penalty of either \$5.00 or 10.0% will be charged on bills received after the due date. The penalty on delinquent bills will not be applied to any balance to which the penalty was applied in a previous billing. The utility must maintain a record of the date of mailing to charge the late penalty.

(C) Information on Bill

Each bill will provide all information required by the PUC Rules. For each of the systems it operates, the utility will maintain and note on the monthly bill a local or toll-free telephone number (or numbers) to which customers can direct questions about their utility service.

SECTION 2.0 - SERVICE RULES AND POLICIES (CONT.)

(D) Prorated Bills

If service is interrupted or seriously impaired for 24 consecutive hours or more, the utility will prorate the monthly base bill in proportion to the time service was not available to reflect this loss of service.

Section 2.11- Payments

All payments for utility service shall be delivered or mailed to the utility's business office. If the business office fails to receive payment prior to the time of noticed disconnection for non-payment of a delinquent account, service will be terminated as scheduled. Utility service crews shall not be allowed to collect payments on customer accounts in the field.

Payment of an account by any means that has been dishonored and returned by the payor or payee's bank, shall be deemed to be delinquent. All returned payments must be redeemed with cash or valid money order. If a customer has two returned payments within a twelve month period, the customer shall be required to pay a deposit if one has not already been paid.

Section 2.12 - Service Disconnection

(A) With Notice

Utility service may be disconnected if the bill has not been paid in full by the date listed on the termination notice. The termination date must be at least 10 days after the notice is mailed or hand delivered.

The utility is encouraged to offer a deferred payment plan to a customer who cannot pay an outstanding bill in full and is willing to pay the balance in reasonable installments. However, a customer's utility service may be disconnected if a bill has not been paid or a deferred payment agreement entered into within 26 days from the date of issuance of a bill and if proper notice of termination has been given. Notice of termination must be a separate mailing or hand delivery in accordance with the PUC Rules.

(B) Without Notice

Utility service may also be disconnected without notice for reasons as described in the PUC Rules.

Section 2.13 - Reconnection of Service

Utility personnel must be available during normal business hours to accept payments on the day service is disconnected and the following day unless service was disconnected at the customer's request or due to a hazardous condition.

Service will be reconnected within 24 hours after the past due bill, reconnect fees and any other outstanding charges are paid or the conditions which caused service to be disconnected are corrected.

SECTION 2.0 - SERVICE RULES AND POLICIES (CONT.)

Section 2.14 - Service Interruptions

The utility will make all reasonable efforts to prevent interruptions of service. If interruptions occur, the utility will re-establish service within the shortest possible time. Except for momentary interruptions due to automatic equipment operations, the utility will keep a complete record of all interruptions, both emergency and scheduled and will notify the Commission in writing of any service interruptions affecting the entire system or any major division of the system lasting more than four hours. The notice will explain the cause of the interruptions.

Section 2.15 - Quality of Service

The utility will plan, furnish, and maintain production, treatment, storage, transmission, and distribution facilities of sufficient size and capacity to provide a continuous and adequate supply of water for all reasonable consumer uses. Unless otherwise authorized by the Commission, the utility will maintain facilities as described in the TCEQ Rules and Regulations for Public Water Systems.

Section 2.16 - Customer Complaints and Disputes

If a customer or applicant for service lodges a complaint, the utility will promptly make a suitable investigation and advise the complainant of the results. Service will not be disconnected pending completion of the investigation. If the complainant is dissatisfied with the utility's response, the utility must advise the complainant that he has recourse through the PUC complaint process. Pending resolution of a complaint, the commission may require continuation or restoration of service.

The utility will maintain a record of all complaints which shows the name and address of the complainant, the date and nature of the complaint and the adjustment or disposition thereof, for a period of two years after the final settlement of the complaint.

In the event of a dispute between a customer and a utility regarding any bill for utility service, the utility will conduct an investigation and report the results to the customer. If the dispute is not resolved, the utility will inform the customer that a complaint may be filed with the Commission.

Section 2.17 - Customer Liability

Customer shall be liable for any damage or injury to utility-owned property shown to be caused by the customer.

SECTION 3.0 - EXTENSION POLICY

Section 3.01 - Standard Extension Requirements

Line Extension and Construction Charges: No Contributions in Aid of Construction may be required of any customer except as provided for in the approved extension policy.

The customer will be given an itemized statement of the costs, options such as rebates to the customer, sharing of construction costs between the utility and the customer, or sharing of costs between the customer and other applicants prior to beginning construction.

Unless an exception is granted by the PUC, the residential service applicant shall not be required to pay for costs of main extensions greater than 2" in diameter for water distribution and pressure wastewater collection lines and 6" in diameter for gravity wastewater lines.

Exceptions may be granted by the PUC if:

- adequate service cannot be provided to the applicant using the maximum line sizes listed due to distance or elevation, in which case, it shall be the utility's burden to justify that a larger diameter pipe is required for adequate service;
- or larger minimum line sizes are required under subdivision platting requirements or building codes of municipalities within whose corporate limits or extraterritorial jurisdiction the point of use is located; or the residential service applicant is located outside the CCN service area.

If an exception is granted, the Utility shall establish a proportional cost plan for the specific extension or a rebate plan which may be limited to seven years to return the portion of the applicant's costs for oversizing as new customers are added to ensure that future applicants for service on the line pay at least as much as the initial service applicant.

The utility shall bear the cost of any over-sizing of water distribution lines or waste water collection lines necessary to serve other potential service applicants for customers in the immediate area.

For purposes of determining the costs that service applicants shall pay, commercial customers with service demands greater than residential customer demands in the certificated area, industrial, and wholesale customers shall be treated as developers. A service applicant requesting a one inch meter for a lawn sprinkler system to service a residential lot is not considered nonstandard service.

If an applicant requires service other than the standard service provided by the utility, such applicant will be required to pay all expenses incurred by the utility in excess of the expenses that would be incurred in providing the standard service and connection beyond 200 feet and throughout his property including the cost of all necessary transmission facilities.

Residential customers will be charged the equivalent of the costs of extending service to their property from the nearest transmission or distribution line even if that line does not have adequate capacity to serve the customer. However, if the customer places unique, non-standard service demands upon the system, the customer may be charged the additional cost of extending service to and throughout their property, including the cost of all necessary transmission and storage facilities necessary to meet the service demands anticipated to be created by that property.

Docket Number: 46745

SECTION 3.0 - EXTENSION POLICY (CONT.)

Section 3.02 - Costs Utilities Shall Bear

The utility will bear the full cost of any oversizing of water mains necessary to serve other customers in the immediate area. The individual residential customer shall not be charged for any additional production, storage, or treatment facilities. Contributions in aid of construction may not be required of individual residential customers for production, storage, treatment or transmission facilities unless otherwise approved by the Commission under this specific extension policy.

Within its certificate area, the utility will pay the cost of the first 200 feet of any water main or distribution line necessary to extend service to an individual residential customer within a platted subdivision. However, if the residential customer requesting service purchased the property after the developer was notified of the need to provide facilities to the utility, the utility may charge for the first 200 feet. The utility must also be able to document that the developer of the subdivision refused to provide facilities compatible with the utility's facilities in accordance with the utility's approved extension policy after receiving a written request from the utility.

The Utility is not required to extend service to any applicant outside of its certificated service area and will only do so under terms and conditions mutually agreeable to the Utility and the applicant, in compliance with PUC rules and policies, and upon extension of the Utility's certificated service area boundaries by the PUC.

Section 3.03 - Contributions in Aid of Construction

Developers may be required to provide contributions in aid of construction in amounts sufficient to furnish the development with all facilities necessary to provide for reasonable local demand requirements and to comply with TCEQ minimum design criteria for facilities used in the production, transmission, pumping, or treatment of water or TCEQ minimum requirements. For purposes of this subsection, a developer is one who subdivides or requests more than two meters on a piece of property. Commercial, industrial, and wholesale customers will be treated as developers.

Any applicant who places unique or non-standard service demands on the system may be required to provide contributions in aid of construction for the actual costs of any additional facilities required to maintain compliance with the TCEQ minimum design criteria for water production, treatment, pumping, storage and transmission.

Any service extension to a subdivision (recorded or unrecorded) may be subject to the provisions and restrictions of § 24.86(d). When a developer wishes to extend the system to prepare to service multiple new connections, the charge shall be the cost of such extension, plus a pro-rata charge for facilities which must be committed to such extension compliant with the TCEQ minimum design criteria. As provided by § 24.85(e)(3), for purposes of this section, commercial, industrial, and wholesale customers shall be treated as developers.

SECTION 3.0 - EXTENSION POLICY (CONT.)

Section 3.04 - Appealing Connection Costs

The imposition of additional extension costs or charges as provided by Sections 3.0 - Extension Policy of this tariff shall be subject to appeal as provided in this tariff, PUC rules, or the rules of such other regulatory authority as may have jurisdiction over the utility's rates and services. Any applicant required to pay for any costs not specifically set forth in the rate schedule pages of this tariff shall be given a written explanation of such costs prior to payment and/or commencement of construction. If the applicant does not believe that these costs are reasonable or necessary, the applicant shall be informed of the right to appeal such costs to the PUC or such other regulatory authority having jurisdiction over the utility's rates in that portion of the utility's service area in which the applicant's property(ies) is located.

Section 3.05 - Applying for Service

The Utility will provide a written service application form to the applicant for each request for service received by the Utility's business offices. A separate application shall be required for each potential service location if more than one service connection is desired by any individual applicant. Service application forms will be available at the Utility's business office during normal weekday business hours. Service applications will be sent by prepaid first class United States mail to the address provided by the applicant upon request. Completed applications should be returned by hand delivery in case there are questions which might delay fulfilling the service request. Completed service applications may be submitted by mail if hand delivery is not possible.

Where a new tap or service connection is required, the service applicant shall be required to submit a written service application and request that a tap be made.

The tap request must be accompanied with a diagram, map, plat, or written metes and bounds description of precisely where the applicant desires each tap or service connection is to be made and, if necessary, where the meter is to be installed, along the applicant's property line. The actual point of connection and meter installation must be readily accessible to Utility personnel for inspection, servicing, and meter reading while being reasonably secure from damage by vehicles and mowers. If the Utility has more than one main adjacent to the service applicant's property, the tap or service connection will be made to the Utility's nearest service main with adequate capacity to service the applicant's full potential service demand. Beyond the initial 200 feet, the customer shall bear only the equivalent cost of extending from the nearest main. If the tap or service connection cannot be made at the applicant's desired location, it will be made at another location mutually acceptable to the applicant and the Utility. If no agreement on location can be made, the applicant may refer the matter to the PUC for resolution.

Section 3.06 - Qualified Service Applicant

A "qualified service applicant" is an applicant who has: (1) met all of the Utility's requirements for service contained in this tariff, PUC rules and/or PUC order, (2) has made payment or made arrangement for payment of tap fees, (3) has provided all necessary easements and rights-of-way necessary to provide service to the requested location, (4) delivered an executed customer service inspection certificate to the Utility, if applicable, and (5) has executed a customer service application for each location to which service is being requested.

Docket Number: 46745

SECTION 3.0 - EXTENSION POLICY (CONT.)

The Utility shall serve each qualified service applicant within its certificated service area as soon as practical after receiving a completed service application. All service requests will be fulfilled within the time limits prescribed by PUC rules once the applicant has met all conditions precedent to achieving "qualified service applicant" status. If a service request cannot be fulfilled within the required period, the applicant shall be notified in writing of the delay, its cause and the anticipated date that service will be available. The PUC service dates shall not become applicable until the service applicant has met all conditions precedent to becoming a qualified service applicant as defined by PUC rules.

Section 3.07 - Developer Requirements

As a condition of service to a new subdivision, the Utility shall require a developer (as defined by PUC rule) to provide permanent recorded public utility easements as a condition of service to any location within the developer's property.

In cases of extreme drought, periods of abnormally high usage, or extended reduction in ability to supply water due to equipment failure, temporary restrictions may be instituted to limit water usage. The purpose of the Drought Contingency Plan is to encourage customer conservation in order to maintain supply, storage or pressure or to comply with requirements of a court, government agency or other authority.

APPENDIX A – DROUGHT CONTINGENCY PLAN
(Utility must attach a copy of TCEQ approved Drought Contingency Plan)

APPENDIX B
Chapter 290.47(b) Sample Service Agreement

SERVICE AGREEMENT

- I. **PURPOSE.** The NAME OF WATER SYSTEM is responsible for protecting the drinking water supply from contamination or pollution which could result from improper private water distribution system construction or configuration. The purpose of this service agreement is to notify each customer of the restrictions which are in place to provide this protection. The utility enforces these restrictions to ensure the public health and welfare. Each customer must sign this agreement before the NAME OF WATER SYSTEM will begin service. In addition, when service to an existing connection has been suspended or terminated, the water system will not re-establish service unless it has a signed copy of this agreement.

- II. **RESTRICTIONS.** The following unacceptable practices are prohibited by State regulations.
 - A. No direct connection between the public drinking water supply and a potential source of contamination is permitted. Potential sources of contamination shall be isolated from the public water system by an air-gap or an appropriate backflow prevention device.

 - B. No cross-connection between the public drinking water supply and a private water system is permitted. These potential threats to the public drinking water supply shall be eliminated at the service connection by the installation of an air-gap or a reduced pressure-zone backflow prevention device.

 - C. No connection which allows water to be returned to the public drinking water supply is permitted.

 - D. No pipe or pipe fitting which contains more than 8.0% lead may be used for the installation or repair of plumbing at any connection which provides water for human use.

 - E. No solder or flux which contains more than 0.2% lead can be used for the installation or repair of plumbing at any connection which provides water for human use.

- III. **SERVICE AGREEMENT.** The following are the terms of the service agreement between the NAME OF WATER SYSTEM (the Water System) and NAME OF CUSTOMER (the Customer).
 - A. The Water System will maintain a copy of this agreement as long as the Customer and/or the premises is connected to the Water System.

 - B. The Customer shall allow his property to be inspected for possible cross-connections and other potential contamination hazards. These inspections shall be conducted by the Water System or its designated agent prior to initiating new water service; when there is reason to believe that cross-connections or other potential contamination hazards exist; or after any major changes to the private water distribution facilities. The inspections shall be conducted during the Water

System's normal business hours.

- C. The Water System shall notify the Customer in writing of any cross-connection or other potential contamination hazard which has been identified during the initial inspection or the periodic reinspection.
- D. The Customer shall immediately remove or adequately isolate any potential cross-connections or other potential contamination hazards on his premises.
- E. The Customer shall, at his expense, properly install, test, and maintain any backflow prevention device required by the Water System. Copies of all testing and maintenance records shall be provided to the Water System.

IV. ENFORCEMENT

If the Customer fails to comply with the terms of the Service Agreement, the Water System shall, at its option, either terminate service or properly install, test, and maintain an appropriate backflow prevention device at the service connection. Any expenses associated with the enforcement of this agreement shall be billed to the Customer.

CUSTOMER'S

SIGNATURE: _____

DATE: _____



SEWER UTILITY TARIFF
Docket Number: 46745

Orbit Systems, Inc
(Utility Name)

1302 Airline North
(Business Address)

Rosharon, Texas 77583
(City, State, Zip Code)

(713) 266-8288
(Area Code/Telephone)

This tariff is effective for utility operations under the following Certificate of Convenience and Necessity:

20682

This tariff is effective in the following counties:

Brazoria

This tariff is effective in the following cities or unincorporated towns (if any):

None

This tariff is effective for the following subdivisions and water quality permit numbers:

Grasslands WWTP - TPDES # 0012672-001

TABLE OF CONTENTS

The above utility lists the following sections of its tariff (if additional pages are needed for a section, all pages should be numbered consecutively):

SECTION 1.0 -- RATE SCHEDULE.....	2
SECTION 2.0 -- SERVICE RULES AND POLICIES	4
SECTION 3.0 -- EXTENSION POLICY	9

APPENDIX A -- SAMPLE SERVICE AGREEMENT

APPENDIX B -- APPLICATION FOR SERVICE

SECTION 1.0 -- RATE SCHEDULE

Section 1.01 - Rates

<u>Meter Size</u>	<u>Monthly Base Rate</u>	<u>Gallonage Charge</u>
All Meters	<u>\$30.00</u> (Includes 0 gallons)	<u>\$3.00</u> per 1000 gallons

Flat Rate \$47.01 for new service prior to establishment of winter months' average.

Volume charges are determined based on average consumption for winter period which includes The following months: December, January, and February

FORM OF PAYMENT: The utility will accept the following forms of payment:

Check X, Money Order X, Other (specify) Online Payment or Automatic Bank Draft
THE UTILITY MAY REQUIRE EXACT CHANGE FOR PAYMENTS AND MAY REFUSE TO ACCEPT PAYMENTS MADE USING MORE THAN \$1.00 IN SMALL COINS. A WRITTEN RECEIPT WILL BE GIVEN FOR CASH PAYMENTS.

REGULATORY ASSESSMENT..... 1.0%
PUC RULES REQUIRE THE UTILITY TO COLLECT A FEE OF ONE PERCENT OF THE RETAIL MONTHLY BILL AND TO REMIT TO THE TCEQ.

Section 1.02 - Miscellaneous Fees

TAP FEE.....\$600.00
TAP FEE COVERS THE UTILITY'S COSTS FOR MATERIALS AND LABOR TO INSTALL A STANDARD RESIDENTIAL 5/8" or 3/4" METER. AN ADDITIONAL FEE TO COVER UNIQUE COSTS IS PERMITTED IF LISTED ON THIS TARIFF.

TAP FEE (Unique costs)Actual Cost
FOR EXAMPLE, A ROAD BORE FOR CUSTOMERS OUTSIDE OF SUBDIVISIONS OR RESIDENTIAL AREAS.

TAP FEE (Large Connection Tap).....Actual Cost
TAP FEE IS THE UTILITY'S ACTUAL COST FOR MATERIALS AND LABOR FOR METER SIZE INSTALLED.

SECTION 1.0 -- RATE SCHEDULE (Continued)

RECONNECTION FEE

THE RECONNECT FEE MUST BE PAID BEFORE SERVICE CAN BE RESTORED TO A CUSTOMER WHO HAS BEEN DISCONNECTED FOR THE FOLLOWING REASONS (OR OTHER REASONS LISTED UNDER SECTION 2.0 OF THIS TARIFF):

- a) Non payment of bill (Maximum \$25.00).....\$25.00
- b) Customer's request that service be disconnected\$50.00

TRANSFER FEE\$25.00

THE TRANSFER FEE WILL BE CHARGED FOR CHANGING AN ACCOUNT NAME AT THE SAME SERVICE LOCATION WHEN THE SERVICE IS NOT DISCONNECTED.

LATE CHARGE (EITHER \$5.00 OR 10% OF THE BILL)\$5.00

PUC RULES ALLOW A ONE-TIME PENALTY TO BE CHARGED ON DELINQUENT BILLS. A LATE CHARGE MAY NOT BE APPLIED TO ANY BALANCE TO WHICH THE PENALTY WAS APPLIED IN A PREVIOUS BILLING.

RETURNED CHECK CHARGE\$25.00

RETURNED CHECK CHARGES MUST BE BASED ON THE UTILITY'S DOCUMENTABLE COST.

CUSTOMER DEPOSIT RESIDENTIAL (Maximum \$50).....\$50.00

COMMERCIAL & NON-RESIDENTIAL DEPOSIT..... 1/6TH OF ESTIMATED ANNUAL BILL

GOVERNMENTAL TESTING, INSPECTION AND COSTS SURCHARGE:

WHEN AUTHORIZED IN WRITING BY PUC AND AFTER NOTICE TO CUSTOMERS, THE UTILITY MAY INCREASE RATES TO RECOVER INCREASED COSTS FOR INSPECTION FEES AND WATER TESTING. [16 TAC 24.21(b)(2)(F)]

LINE EXTENSION AND CONSTRUCTION CHARGES:

REFER TO SECTION 3.0--EXTENSION POLICY FOR TERMS, CONDITIONS, AND CHARGES WHEN NEW CONSTRUCTION IS NECESSARY TO PROVIDE SERVICE.

SECTION 2.0 -- SERVICE RULES AND POLICIES

The utility will have the most current Public Utility Commission of Texas (PUC or Commission) Rules relating to sewer utilities available at its office for reference purposes. The Rules and this tariff shall be available for public inspection and reproduction at a reasonable cost. The latest Rules or Commission approved changes to the Rules supersede any rules or requirements in this tariff.

Section 2.01 - Application for Sewer Service

All applications for service will be made on the utility's standard application or contract form (attached in the Appendix to this tariff), will be signed by the applicant, any required fees (deposits, reconnect, tap, extension fees, etc. as applicable) will be paid and easements, if required, will be granted before service is provided by the utility. A separate application or contract will be made for each service location.

Section 2.02 - Refusal of Service

The utility may decline to serve an applicant until the applicant has complied with the regulations of the regulatory agencies (state and municipal regulations) and for the reasons outlined in the commission rules. In the event that the utility refuses to serve an applicant, the utility will inform the applicant in writing of the basis of its refusal. The utility is also required to inform the applicant that a complaint may be filed with the Commission.

Section 2.03 - Fees and Charges & Easements Required Before Service Can Be Connected

(A) Customer Deposits

If a residential applicant cannot establish credit to the satisfaction of the utility, the applicant may be required to pay a deposit as provided for in Section 1.02 - Miscellaneous Fees of this tariff. The utility will keep records of the deposit and credit interest in accordance with the commission rules.

Residential applicants 65 years of age or older may not be required to pay deposits unless the applicant has an outstanding account balance with the utility or another water or sewer utility which accrued within the last two years.

Nonresidential applicants who cannot establish credit to the satisfaction of the utility may be required to make a deposit that does not exceed an amount equivalent to one-sixth of the estimated annual billings.

Refund of deposit - If service is not connected, or after disconnection of service, the utility will promptly refund the customer's deposit plus accrued interest or the balance, if any, in excess of the unpaid bills for service furnished. The utility may refund the residential customer's deposit at any time prior to termination of utility service but must refund the deposit plus interest for any residential customer who has paid 18 consecutive billings without being delinquent.

SECTION 2.0 -- SERVICE RULES AND POLICIES (Continued)

(B) Tap or Reconnect Fees

A new customer requesting service at a location where service has not previously been provided must pay a tap fee as provided in Section 1. A customer requesting service where service has previously been provided must pay a reconnect fee as provided in Section 1. Any applicant or existing customer required to pay for any costs not specifically set forth in the rate schedule pages of this tariff shall be given a written explanation of such costs prior to request for payment and/or commencement of construction. If the applicant or existing customer does not believe that these costs are reasonable or necessary, the applicant or existing customer shall be informed of their right to appeal such costs to the commission or such other regulatory authority having jurisdiction over the utility's rates in that portion of the utility's service area in which the applicant's or existing customer's property (ies) is located.

Fees in addition to the regular tap fee may be charged to cover unique costs not normally incurred as permitted by P.U.C. SUBST. R. 24.86(a)(1)(C) if they are listed on this approved tariff. For example, a road bore for customers outside a subdivision or residential area could be considered a unique cost.

(C) Easement Requirement

Where recorded public utility easements on the service applicant's property do not exist or public road right-of-way easements are not available to access the applicant's property, the utility may require the applicant to provide it with a permanent recorded public utility easement on and across the applicant's real property sufficient to provide service to that applicant. Such easement(s) shall not be used for the construction of production, storage, transmission or pressure facilities unless they are needed for adequate service to that applicant.

Section 2.04 - Utility Response to Applications for Service

After the applicant has met all the requirements, conditions and regulations for service, the utility will install tap and utility cut-off and/or take all necessary actions to initiate service. The utility will serve each qualified applicant for service within 5 working days unless line extensions or new facilities are required. If construction is required to fill the order and if it cannot be completed within 30 days, the utility will provide the applicant with a written explanation of the construction required and an expected date of service.

Except for good cause where service has previously been provided, service will be reconnected within one working day after the applicant has met the requirements for reconnection.

Section 2.05 - Customer Responsibility

The customer will be responsible for furnishing and laying the necessary customer service pipe from the tap location to the place of consumption. Customers will not be allowed to use the utility's cutoff.

SECTION 2.0 -- SERVICE RULES AND POLICIES (Continued)

Section 2.06 Access to Customer's Premises

All customers or service applicants shall provide access to utility cutoffs at all times reasonably necessary to conduct ordinary utility business and after normal business hours as needed to protect and preserve the integrity of the public drinking water supply.

Section 2.07 - Back Flow Prevention Devices

No water connection shall be made to any establishment where an actual or potential contamination or system hazard exists without an approved air gap or mechanical backflow prevention assembly. The air gap or backflow prevention assembly shall be installed in accordance with the American Water Works Association (AWWA) standards C510, C511 and AWWA Manual M14 or the University Of Southern California Manual Of Cross-Connection Control, current edition. The backflow assembly installation by a licensed plumber shall occur at the customer's expense.

The back flow assembly shall be tested upon installation by a recognized prevention assembly tester and certified to be operating within specifications. Back flow prevention assemblies which are installed to provide protection against high health hazards must be tested and certified to be operating within specifications at least annually by a recognized back flow prevention device tester. The maintenance and testing of the back flow assembly shall occur at the customer's expense.

Section 2.10 - Billing

(A) Regular Billing

Bills from the utility will be mailed monthly unless otherwise authorized by the Commission. The due date of bills for utility service will be at least sixteen (16) days from the date of issuance. The postmark on the bill or, if there is no postmark on the bill, the recorded date of mailing by the utility will constitute proof of the date of issuance. Payment for utility service is delinquent if full payment, including late fees and the regulatory assessment, is not received at the utility or the utility's authorized payment agency by 5:00 p.m. on the due date. If the due date falls on a holiday or weekend, the due date for payment purposes will be the next workday after the due date.

(B) Late Fees

A late penalty of either \$5.00 or 10.0% will be charged on bills received after the due date. The penalty on delinquent bills will not be applied to any balance to which the penalty was applied in a previous billing. The utility must maintain a record of the date of mailing to charge the late penalty.

(C) Information on Bill

Each bill will provide all information required by the commission rules. For each of the systems it operates, the utility will maintain and note on the monthly bill a local or toll-free telephone number (or numbers) to which customers can direct questions about their utility service.

SECTION 2.0 -- SERVICE RULES AND POLICIES (Continued)

(D) Prorated Bills

If service is interrupted or seriously impaired for 24 consecutive hours or more, the utility will prorate the monthly base bill in proportion to the time service was not available to reflect this loss of service.

Section 2.11- Payments

All payments for utility service shall be delivered or mailed to the utility's business office. If the business office fails to receive payment prior to the time of noticed disconnection for non-payment of a delinquent account, service will be terminated as scheduled. Utility service crews shall not be allowed to collect payments on customer accounts in the field.

Payment of an account by any means that has been dishonored and returned by the payer or payee's bank shall be deemed to be delinquent. All returned payments must be redeemed with cash or valid money order. If a customer has two returned payments within a twelve month period, the customer shall be required to pay a deposit if one has not already been paid.

Section 2.12 - Service Disconnection

(A) With Notice

Utility service may be disconnected if the bill has not been paid in full by the date listed on the termination notice. The termination date must be at least 10 days after the notice is mailed or hand delivered.

The utility is encouraged to offer a deferred payment plan to a customer who cannot pay an outstanding bill in full and is willing to pay the balance in reasonable installments. However, a customer's utility service may be disconnected if a bill has not been paid or a deferred payment agreement entered into within 26 days from the date of issuance of a bill and if proper notice of termination has been given.

Notice of termination must be a separate mailing or hand delivery in accordance with the commission rules.

(B) Without Notice

Utility service may also be disconnected without notice for reasons as described in the commission rules.

Section 2.13 - Reconnection of Service

Utility personnel must be available during normal business hours to accept payments on the day service is disconnected and the following day unless service was disconnected at the customer's request or due to a hazardous condition.

Service will be reconnected within 24 hours after the past due bill, reconnect fees and any other outstanding charges are paid or the conditions which caused service to be disconnected are corrected.

SECTION 2.0 -- SERVICE RULES AND POLICIES (Continued)

Section 2.14 - Service Interruptions

The utility will make all reasonable efforts to prevent interruptions of service. If interruptions occur, the utility will re-establish service within the shortest possible time. Except for momentary interruptions due to automatic equipment operations, the utility will keep a complete record of all interruptions, both emergency and scheduled and will notify the Commission in writing of any service interruptions affecting the entire system or any major division of the system lasting more than four hours. The notice will explain the cause of the interruptions.

Section 2.15 - Quality of Service

The utility will plan, furnish, and maintain and operate production, treatment, storage, transmission, and collection facilities of sufficient size and capacity to provide continuous and adequate service for all reasonable consumer uses and to treat sewage and discharge effluent of the quality required by its discharge permit issued by the Texas Commission of Environmental Quality (TCEQ). Unless otherwise authorized by the TCEQ, the utility will maintain facilities as described in the TCEQ's rules.

Section 2.16 - Customer Complaints and Disputes

If a customer or applicant for service lodges a complaint, the utility will promptly make a suitable investigation and advise the complainant of the results. Service will not be disconnected pending completion of the investigation. If the complainant is dissatisfied with the utility's response, the utility must advise the complainant that he has recourse through the commission's complaint process. Pending resolution of a complaint, the commission may require continuation or restoration of service.

The utility will maintain a record of all complaints which shows the name and address of the complainant, the date and nature of the complaint and the adjustment or disposition thereof, for a period of two years after the final settlement of the complaint.

In the event of a dispute between a customer and a utility regarding any bill for utility service, the utility will conduct an investigation and report the results to the customer. If the dispute is not resolved, the utility will inform the customer that a complaint may be filed with the Commission.

Section 2.17 - Customer Liability

Customer shall be liable for any damage or injury to utility-owned property shown to be caused by the customer.

SECTION 3.0 -- EXTENSION POLICY

Section 3.01 - Standard Extension Requirements

Line Extension and Construction Charges: No Contribution in Aid of Construction may be required of any customers except as provided for in this approved extension policy.

The utility is not required to extend service to any applicant outside of its certified service area and will only do so under terms and conditions mutually agreeable to the utility and the applicant, in compliance with commission rules and policies, and upon extension of the utility's certified service area boundaries by the commission.

The applicant for service will be given an itemized statement of the costs, options such as rebates to the customer, sharing of construction costs between the utility and the customer, or sharing of costs between the customer and other applicants prior to beginning construction.

Section 3.02 - Costs Utilities and Service Applicants Shall Bear

Within its certified area, the utility will pay the cost of the first 200 feet of any water main or distribution line necessary to extend service to an individual residential customer within a platted subdivision.

However, if the residential customer requesting service purchased the property after the developer was notified in writing of the need to provide facilities to the utility, the utility may charge for the first 200 feet. The utility must also be able to document that the developer of the subdivision refused to provide facilities compatible with the utility's facilities in accordance with the utility's approved extension policy after receiving a written request from the utility.

Residential customers will be charged the equivalent of the costs of extending service to their property from the nearest collection line even if that line does not have adequate capacity to serve the customer. However, if the customer places unique, non-standard service demands upon the system, the customer may be charged the additional cost of extending service to and throughout their property, including the cost of all necessary transmission and storage facilities necessary to meet the service demands anticipated to be created by that property.

Unless an exception is granted by the PUC, the residential service applicant shall not be required to pay for costs of main extensions greater than 6" in diameter for gravity wastewater lines.

Exceptions may be granted by the PUC if

- adequate service cannot be provided to the applicant using the maximum line sizes listed due to distance or elevation, in which case, it shall be the utility's burden to justify that a larger diameter pipe is required for adequate service;
- or larger minimum line sizes are required under subdivision platting requirements or building codes of municipalities within whose corporate limits or extraterritorial jurisdiction the point of use is located; or the residential service applicant is located outside the CCN service area.

SECTION 3.0 -- EXTENSION POLICY (Continued)

If an exception is granted, the utility shall establish a proportional cost plan for the specific extension or a rebate plan which may be limited to seven years to return the portion of the applicant's costs for oversizing as new customers are added to ensure that future applicants for service on the line pay at least as much as the initial service applicant.

For purposes of determining the costs that service applicants shall pay, commercial customers with service demands greater than residential customer demands in the certified area, industrial, and wholesale customers shall be treated as developers.

If an applicant requires service other than the standard service provided by the utility, such applicant will be required to pay all expenses incurred by the utility in excess of the expenses that would be incurred in providing the standard service and connection beyond 200 feet and throughout his property including the cost of all necessary transmission facilities.

The utility will bear the full cost of any over-sizing of sewer mains necessary to serve other customers in the immediate area. The individual residential customer shall not be charged for any additional treatment facilities. Contributions in aid of construction of individual residential customers for production, storage, treatment or transmission facilities unless otherwise approved by the Commission under this specific extension policy.

Section 3.03 - Contributions in Aid of Construction

Developers may be required to provide contributions in aid of construction in amounts sufficient to furnish the development with all facilities necessary to provide for reasonable local demand requirements and to comply with TCEQ minimum design criteria for facilities used in the production, collection, transmission, pumping, or treatment of sewage or TCEQ minimum requirements. For purposes of this subsection, a developer is one who subdivides or requests more than two meters on a piece of property. Commercial, industrial, and wholesale customers will be treated as developers.

Any applicant who places unique or non-standard service demands on the system may be required to provide contributions in aid of construction for the actual costs of any additional facilities required to maintain compliance with the TCEQ minimum design criteria for water production, treatment, pumping, storage and transmission.

Any service extension to a subdivision (recorded or unrecorded) may be subject to the provisions and restrictions of 16 TAC 2486(d). When a developer wishes to extend the system to prepare to service multiple new connections, the charge shall be the cost of such extension, plus a pro-rata charge for facilities which must be committed to such extension compliant with the TCEQ minimum design criteria. As provided by 16 TAC 24.85(e)(3), for purposes of this section, commercial, industrial, and wholesale customers shall be treated as developers.

SECTION 3.0 -- EXTENSION POLICY (Continued)

A utility may only charge a developer standby fees for unrecovered costs of facilities committed to a developer's property under the following circumstances:

- Under a contract and only in accordance with the terms of the contract; or
- if service is not being provided to a lot or lots within two years after installation of facilities necessary to provide service to the lots has been completed and if the standby fees are included on the utilities approved tariff after a rate change application has been filed. The fees cannot be billed to the developer or collected until the standby fees have been approved by the commission or executive director.
- For purposes of this section, a manufactured housing rental community can only be charged standby fees under a contract or if the utility installs the facilities necessary to provide individually metered service to each of the rental lots or spaces in the community.

Section 3.04 - Appealing Connection Costs

The imposition of additional extension costs or charges as provided by Sections 3.0 - Extension Policy of this tariff shall be subject to appeal as provided in this tariff, commission rules, or the rules of such other regulatory authority as may have jurisdiction over the utility's rates and services. Any applicant required to pay for any costs not specifically set forth in the rate schedule pages of this tariff shall be given a written explanation of such costs prior to payment and/or commencement of construction. If the applicant does not believe that these costs are reasonable or necessary, the applicant shall be informed of the right to appeal such costs to the commission or such other regulatory authority having jurisdiction over the utility's rates in that portion of the utility's service area in which the applicant's property(ies) is located.

Section 3.05 - Applying for Service

The utility will provide a written service application form to the applicant for each request for service received by the utility's business offices. A separate application shall be required for each potential service location if more than one service connection is desired by any individual applicant. Service application forms will be available at the utility's business office during normal weekday business hours. Service applications will be sent by prepaid first class United States mail to the address provided by the applicant upon request. Completed applications should be returned by hand delivery in case there are questions which might delay fulfilling the service request. Completed service applications may be submitted by mail if hand delivery is not possible.

Docket No. 46745

SECTION 3.0 -- EXTENSION POLICY (Continued)

Where a new tap or service connection is required, the service applicant shall be required to submit a written service application and request that a tap be made. A diagram, map, plat, or written metes and bounds description of precisely where the applicant desires each tap or service connection is to be made and, if necessary, where the meter is to be installed, along the applicant's property line may also be required with the tap request. The actual point of connection and meter installation must be readily accessible to utility personnel for inspection, servicing, and meter reading while being reasonably secure from damage by vehicles and mowers. If the utility has more than one main adjacent to the service applicant's property, the tap or service connection will be made to the utility's nearest service main with adequate capacity to service the applicant's full potential service demand. Beyond the initial 200 feet, the customer shall bear only the equivalent cost of extending from the nearest main. If the tap or service connection cannot be made at the applicant's desired location, it will be made at another location mutually acceptable to the applicant and the utility. If no agreement on location can be made, the applicant may refer the matter to the commission for resolution.

Section 3.06 - Qualified Service Applicant

A "qualified service applicant" is an applicant who has: (1) met all of the utility's requirements for service contained in this tariff, commission rules and/or order, (2) has made payment or made arrangement for payment of tap fees, (3) has provided all easements and rights-of-way required to provide service to the requested location, (4) delivered an executed customer service inspection certificate to the Utility, if applicable, and (5) has executed a customer service application for each location to which service is being requested.

The utility shall serve each qualified service applicant within its certified service area as soon as practical after receiving a completed service application. All service requests will be fulfilled within the time limits prescribed by commission rules once the applicant has met all conditions precedent to achieving "qualified service applicant" status. If a service request cannot be fulfilled within the required period, the applicant shall be notified in writing of the delay, its cause and the anticipated date that service will be available. The commission service dates shall not become applicable until the service applicant has met all conditions precedent to becoming a qualified service applicant as defined by commission rules.

Section 3.07 - Developer Requirements

As a condition of service to a new subdivision, the utility shall require a developer (as defined by PUC rule) to provide permanent recorded public utility easements as a condition of service to any location within the developer's property.

APPENDIX A -- SAMPLE SERVICE AGREEMENT
From TCEQ Rules, 30 TAC Chapter 290.47(b), Appendix B
SERVICE AGREEMENT

- I. PURPOSE. The NAME OF SEWER SYSTEM is responsible for protecting the drinking water supply from contamination or pollution which could result from improper private water distribution system construction or configuration. The purpose of this service agreement is to notify each customer of the restrictions which are in place to provide this protection. The utility enforces these restrictions to ensure the public health and welfare. Each customer must sign this agreement before the NAME OF SEWER SYSTEM will begin service. In addition, when service to an existing connection has been suspended or terminated, the sewer system will not re-establish service unless it has a signed copy of this agreement.
- II. RESTRICTIONS. The following unacceptable practices are prohibited by State regulations.
- A. No direct connection between the public drinking water supply and a potential source of contamination is permitted. Potential sources of contamination shall be isolated from the public water system by an air-gap or an appropriate backflow prevention device.
 - B. No cross-connection between the public drinking water supply and a private water system is permitted. These potential threats to the public drinking water supply shall be eliminated at the service connection by the installation of an air-gap or a reduced pressure-zone backflow prevention device.
 - C. No connection which allows water to be returned to the public drinking water supply is permitted.
 - D. No pipe or pipe fitting which contains more than 8.0% lead may be used for the installation or repair of plumbing at any connection which provides water for human use.
 - E. No solder or flux which contains more than 0.2% lead can be used for the installation or repair of plumbing at any connection which provides water for human use.
- III. SERVICE AGREEMENT. The following are the terms of the service agreement between the NAME OF SEWER SYSTEM (the Sewer System) and NAME OF CUSTOMER (the Customer).
- A. The Sewer System will maintain a copy of this agreement as long as the Customer and/or the premises are connected to the Sewer System.
 - B. The Customer shall allow his property to be inspected for possible cross-connections and other potential contamination hazards. These inspections shall be conducted by the Sewer System or its designated agent prior to initiating new water service; when there is reason to believe that cross-connections or other potential contamination hazards exist; or after any major changes to the private water distribution facilities. The inspections shall be conducted during the Sewer System's normal business hours.
 - C. The Sewer System shall notify the Customer in writing of any cross-connection or other potential contamination hazard which has been identified during the initial inspection or the periodic reinspection.
 - D. The Customer shall immediately remove or adequately isolate any potential cross-connections or other potential contamination hazards on his premises.
 - E. The Customer shall, at his expense, properly install, test, and maintain any backflow prevention device required by the Sewer System. Copies of all testing and maintenance records shall be provided to the Sewer System.
- IV. ENFORCEMENT. If the Customer fails to comply with the terms of the Service Agreement, the Sewer System shall, at its option, either terminate service or properly install, test, and maintain an appropriate backflow prevention device at the service connection. Any expenses associated with the enforcement of this agreement shall be billed to the Customer.

CUSTOMER'S SIGNATURE: _____
DATE: _____



SEWER UTILITY TARIFF
Docket Number: 46745

Undine Texas, LLC.
(Utility Name)

10913 Metronome Dr.
(Business Address)

Houston, Texas 77043
(City, State, Zip Code)

(713) 574-5953
(Area Code/Telephone)

This tariff is effective for utility operations under the following Certificate of Convenience and Necessity:

21106

This tariff is effective in the following counties:

Brazoria, Fort Bend and Matagorda

This tariff is effective in the following cities or unincorporated towns (if any):

None

This tariff is effective in the following subdivisions or systems:

Angle Acres WWTP - TPDES # 0012420-001

Beechwood WWTP- TPDES # 0012113-001

TABLE OF CONTENTS

The above utility lists the following sections of its tariff (if additional pages are needed for a section, all pages should be numbered consecutively):

SECTION 1.0 -- RATE SCHEDULE.....	2
SECTION 2.0 -- SERVICE RULES AND POLICIES	4
SECTION 3.0 -- EXTENSION POLICY	9

APPENDIX A -- SAMPLE SERVICE AGREEMENT

SECTION 1.0 -- RATE SCHEDULE

Section 1.01 - Rates

<u>Meter Size</u>	<u>Monthly Base Rate</u>	<u>Gallonage Charge</u>
All Meters	<u>\$30.00</u> (Includes 0 gallons)	<u>\$3.00</u> per 1000 gallons

Flat Rate \$47.01 for new service prior to establishment of winter months' average.

Volume charges are determined based on average consumption for winter period which includes The following months: December, January, and February

FORM OF PAYMENT: The utility will accept the following forms of payment:

Check X, Money Order X, Other (specify) Online Payment or Automatic Bank Draft
THE UTILITY MAY REQUIRE EXACT CHANGE FOR PAYMENTS AND MAY REFUSE TO ACCEPT PAYMENTS MADE USING MORE THAN \$1.00 IN SMALL COINS. A WRITTEN RECEIPT WILL BE GIVEN FOR CASH PAYMENTS.

REGULATORY ASSESSMENT..... 1.0%
PUC RULES REQUIRE THE UTILITY TO COLLECT A FEE OF ONE PERCENT OF THE RETAIL MONTHLY BILL AND TO REMIT TO THE TCEQ.

Section 1.02 - Miscellaneous Fees

TAP FEE.....\$600.00
TAP FEE COVERS THE UTILITY'S COSTS FOR MATERIALS AND LABOR TO INSTALL A STANDARD RESIDENTIAL 5/8" or 3/4" METER. AN ADDITIONAL FEE TO COVER UNIQUE COSTS IS PERMITTED IF LISTED ON THIS TARIFF.

TAP FEE (Unique costs)Actual Cost
FOR EXAMPLE, A ROAD BORE FOR CUSTOMERS OUTSIDE OF SUBDIVISIONS OR RESIDENTIAL AREAS.

TAP FEE (Large Connection Tap).....Actual Cost
TAP FEE IS THE UTILITY'S ACTUAL COST FOR MATERIALS AND LABOR FOR METER SIZE INSTALLED.

SECTION 1.0 -- RATE SCHEDULE (Continued)

RECONNECTION FEE

THE RECONNECT FEE MUST BE PAID BEFORE SERVICE CAN BE RESTORED TO A CUSTOMER WHO HAS BEEN DISCONNECTED FOR THE FOLLOWING REASONS (OR OTHER REASONS LISTED UNDER SECTION 2.0 OF THIS TARIFF):

- a) Non payment of bill (Maximum \$25.00).....\$25.00
- b) Customer's request that service be disconnected\$50.00

TRANSFER FEE.....\$25.00

THE TRANSFER FEE WILL BE CHARGED FOR CHANGING AN ACCOUNT NAME AT THE SAME SERVICE LOCATION WHEN THE SERVICE IS NOT DISCONNECTED.

LATE CHARGE (EITHER \$5.00 OR 10% OF THE BILL)\$5.00

PUC RULES ALLOW A ONE-TIME PENALTY TO BE CHARGED ON DELINQUENT BILLS. A LATE CHARGE MAY NOT BE APPLIED TO ANY BALANCE TO WHICH THE PENALTY WAS APPLIED IN A PREVIOUS BILLING.

RETURNED CHECK CHARGE\$25.00

RETURNED CHECK CHARGES MUST BE BASED ON THE UTILITY'S DOCUMENTABLE COST.

CUSTOMER DEPOSIT RESIDENTIAL (Maximum \$50).....\$50.00

COMMERCIAL & NON-RESIDENTIAL DEPOSIT 1/6TH OF ESTIMATED ANNUAL BILL

GOVERNMENTAL TESTING, INSPECTION AND COSTS SURCHARGE:

WHEN AUTHORIZED IN WRITING BY PUC AND AFTER NOTICE TO CUSTOMERS, THE UTILITY MAY INCREASE RATES TO RECOVER INCREASED COSTS FOR INSPECTION FEES AND WATER TESTING. [16 TAC 24.21(b)(2)(F)]

LINE EXTENSION AND CONSTRUCTION CHARGES:

REFER TO SECTION 3.0--EXTENSION POLICY FOR TERMS, CONDITIONS, AND CHARGES WHEN NEW CONSTRUCTION IS NECESSARY TO PROVIDE SERVICE.

SECTION 2.0 -- SERVICE RULES AND POLICIES

The utility will have the most current Public Utility Commission of Texas (PUC or Commission) Rules relating to sewer utilities available at its office for reference purposes. The Rules and this tariff shall be available for public inspection and reproduction at a reasonable cost. The latest Rules or Commission approved changes to the Rules supersede any rules or requirements in this tariff.

Section 2.01 - Application for Sewer Service

All applications for service will be made on the utility's standard application or contract form (attached in the Appendix to this tariff), will be signed by the applicant, any required fees (deposits, reconnect, tap, extension fees, etc. as applicable) will be paid and easements, if required, will be granted before service is provided by the utility. A separate application or contract will be made for each service location.

Section 2.02 - Refusal of Service

The utility may decline to serve an applicant until the applicant has complied with the regulations of the regulatory agencies (state and municipal regulations) and for the reasons outlined in the commission rules. In the event that the utility refuses to serve an applicant, the utility will inform the applicant in writing of the basis of its refusal. The utility is also required to inform the applicant that a complaint may be filed with the Commission.

Section 2.03 - Fees and Charges & Easements Required Before Service Can Be Connected

(A) Customer Deposits

If a residential applicant cannot establish credit to the satisfaction of the utility, the applicant may be required to pay a deposit as provided for in Section 1.02 - Miscellaneous Fees of this tariff. The utility will keep records of the deposit and credit interest in accordance with the commission rules.

Residential applicants 65 years of age or older may not be required to pay deposits unless the applicant has an outstanding account balance with the utility or another water or sewer utility which accrued within the last two years.

Nonresidential applicants who cannot establish credit to the satisfaction of the utility may be required to make a deposit that does not exceed an amount equivalent to one-sixth of the estimated annual billings.

Refund of deposit - If service is not connected, or after disconnection of service, the utility will promptly refund the customer's deposit plus accrued interest or the balance, if any, in excess of the unpaid bills for service furnished. The utility may refund the residential customer's deposit at any time prior to termination of utility service but must refund the deposit plus interest for any residential customer who has paid 18 consecutive billings without being delinquent.

SECTION 2.0 -- SERVICE RULES AND POLICIES (Continued)

(B) Tap or Reconnect Fees

A new customer requesting service at a location where service has not previously been provided must pay a tap fee as provided in Section 1. A customer requesting service where service has previously been provided must pay a reconnect fee as provided in Section 1. Any applicant or existing customer required to pay for any costs not specifically set forth in the rate schedule pages of this tariff shall be given a written explanation of such costs prior to request for payment and/or commencement of construction. If the applicant or existing customer does not believe that these costs are reasonable or necessary, the applicant or existing customer shall be informed of their right to appeal such costs to the commission or such other regulatory authority having jurisdiction over the utility's rates in that portion of the utility's service area in which the applicant's or existing customer's property (ies) is located.

Fees in addition to the regular tap fee may be charged to cover unique costs not normally incurred as permitted by P.U.C. SUBST. R. 24.86(a)(1)(C) if they are listed on this approved tariff. For example, a road bore for customers outside a subdivision or residential area could be considered a unique cost.

(C) Easement Requirement

Where recorded public utility easements on the service applicant's property do not exist or public road right-of-way easements are not available to access the applicant's property, the utility may require the applicant to provide it with a permanent recorded public utility easement on and across the applicant's real property sufficient to provide service to that applicant. Such easement(s) shall not be used for the construction of production, storage, transmission or pressure facilities unless they are needed for adequate service to that applicant.

Section 2.04 - Utility Response to Applications for Service

After the applicant has met all the requirements, conditions and regulations for service, the utility will install tap and utility cut-off and/or take all necessary actions to initiate service. The utility will serve each qualified applicant for service within 5 working days unless line extensions or new facilities are required. If construction is required to fill the order and if it cannot be completed within 30 days, the utility will provide the applicant with a written explanation of the construction required and an expected date of service.

Except for good cause where service has previously been provided, service will be reconnected within one working day after the applicant has met the requirements for reconnection.

Section 2.05 - Customer Responsibility

The customer will be responsible for furnishing and laying the necessary customer service pipe from the tap location to the place of consumption. Customers will not be allowed to use the utility's cutoff.

SECTION 2.0 -- SERVICE RULES AND POLICIES (Continued)

Section 2.06 Access to Customer's Premises

All customers or service applicants shall provide access to utility cutoffs at all times reasonably necessary to conduct ordinary utility business and after normal business hours as needed to protect and preserve the integrity of the public drinking water supply.

Section 2.07 - Back Flow Prevention Devices

No water connection shall be made to any establishment where an actual or potential contamination or system hazard exists without an approved air gap or mechanical backflow prevention assembly. The air gap or backflow prevention assembly shall be installed in accordance with the American Water Works Association (AWWA) standards C510, C511 and AWWA Manual M14 or the University Of Southern California Manual Of Cross-Connection Control, current edition. The backflow assembly installation by a licensed plumber shall occur at the customer's expense.

The back flow assembly shall be tested upon installation by a recognized prevention assembly tester and certified to be operating within specifications. Back flow prevention assemblies which are installed to provide protection against high health hazards must be tested and certified to be operating within specifications at least annually by a recognized back flow prevention device tester. The maintenance and testing of the back flow assembly shall occur at the customer's expense.

Section 2.10 - Billing

(A) Regular Billing

Bills from the utility will be mailed monthly unless otherwise authorized by the Commission. The due date of bills for utility service will be at least sixteen (16) days from the date of issuance. The postmark on the bill or, if there is no postmark on the bill, the recorded date of mailing by the utility will constitute proof of the date of issuance. Payment for utility service is delinquent if full payment, including late fees and the regulatory assessment, is not received at the utility or the utility's authorized payment agency by 5:00 p.m. on the due date. If the due date falls on a holiday or weekend, the due date for payment purposes will be the next workday after the due date.

(B) Late Fees

A late penalty of either \$5.00 or 10.0% will be charged on bills received after the due date. The penalty on delinquent bills will not be applied to any balance to which the penalty was applied in a previous billing. The utility must maintain a record of the date of mailing to charge the late penalty.

(C) Information on Bill

Each bill will provide all information required by the commission rules. For each of the systems it operates, the utility will maintain and note on the monthly bill a local or toll-free telephone number (or numbers) to which customers can direct questions about their utility service.

SECTION 2.0 -- SERVICE RULES AND POLICIES (Continued)

(D) Prorated Bills

If service is interrupted or seriously impaired for 24 consecutive hours or more, the utility will prorate the monthly base bill in proportion to the time service was not available to reflect this loss of service.

Section 2.11- Payments

All payments for utility service shall be delivered or mailed to the utility's business office. If the business office fails to receive payment prior to the time of noticed disconnection for non-payment of a delinquent account, service will be terminated as scheduled. Utility service crews shall not be allowed to collect payments on customer accounts in the field.

Payment of an account by any means that has been dishonored and returned by the payer or payee's bank shall be deemed to be delinquent. All returned payments must be redeemed with cash or valid money order. If a customer has two returned payments within a twelve month period, the customer shall be required to pay a deposit if one has not already been paid.

Section 2.12 - Service Disconnection

(A) With Notice

Utility service may be disconnected if the bill has not been paid in full by the date listed on the termination notice. The termination date must be at least 10 days after the notice is mailed or hand delivered.

The utility is encouraged to offer a deferred payment plan to a customer who cannot pay an outstanding bill in full and is willing to pay the balance in reasonable installments. However, a customer's utility service may be disconnected if a bill has not been paid or a deferred payment agreement entered into within 26 days from the date of issuance of a bill and if proper notice of termination has been given.

Notice of termination must be a separate mailing or hand delivery in accordance with the commission rules.

(B) Without Notice

Utility service may also be disconnected without notice for reasons as described in the commission rules.

Section 2.13 - Reconnection of Service

Utility personnel must be available during normal business hours to accept payments on the day service is disconnected and the following day unless service was disconnected at the customer's request or due to a hazardous condition.

Service will be reconnected within 24 hours after the past due bill, reconnect fees and any other outstanding charges are paid or the conditions which caused service to be disconnected are corrected.

SECTION 2.0 -- SERVICE RULES AND POLICIES (Continued)

Section 2.14 - Service Interruptions

The utility will make all reasonable efforts to prevent interruptions of service. If interruptions occur, the utility will re-establish service within the shortest possible time. Except for momentary interruptions due to automatic equipment operations, the utility will keep a complete record of all interruptions, both emergency and scheduled and will notify the Commission in writing of any service interruptions affecting the entire system or any major division of the system lasting more than four hours. The notice will explain the cause of the interruptions.

Section 2.15 - Quality of Service

The utility will plan, furnish, and maintain and operate production, treatment, storage, transmission, and collection facilities of sufficient size and capacity to provide continuous and adequate service for all reasonable consumer uses and to treat sewage and discharge effluent of the quality required by its discharge permit issued by the Texas Commission of Environmental Quality (TCEQ). Unless otherwise authorized by the TCEQ, the utility will maintain facilities as described in the TCEQ's rules.

Section 2.16 - Customer Complaints and Disputes

If a customer or applicant for service lodges a complaint, the utility will promptly make a suitable investigation and advise the complainant of the results. Service will not be disconnected pending completion of the investigation. If the complainant is dissatisfied with the utility's response, the utility must advise the complainant that he has recourse through the commission's complaint process. Pending resolution of a complaint, the commission may require continuation or restoration of service.

The utility will maintain a record of all complaints which shows the name and address of the complainant, the date and nature of the complaint and the adjustment or disposition thereof, for a period of two years after the final settlement of the complaint.

In the event of a dispute between a customer and a utility regarding any bill for utility service, the utility will conduct an investigation and report the results to the customer. If the dispute is not resolved, the utility will inform the customer that a complaint may be filed with the Commission.

Section 2.17 - Customer Liability

Customer shall be liable for any damage or injury to utility-owned property shown to be caused by the customer.

SECTION 3.0 -- EXTENSION POLICY

Section 3.01 - Standard Extension Requirements

Line Extension and Construction Charges: No Contribution in Aid of Construction may be required of any customers except as provided for in this approved extension policy.

The utility is not required to extend service to any applicant outside of its certified service area and will only do so under terms and conditions mutually agreeable to the utility and the applicant, in compliance with commission rules and policies, and upon extension of the utility's certified service area boundaries by the commission.

The applicant for service will be given an itemized statement of the costs, options such as rebates to the customer, sharing of construction costs between the utility and the customer, or sharing of costs between the customer and other applicants prior to beginning construction.

Section 3.02 - Costs Utilities and Service Applicants Shall Bear

Within its certified area, the utility will pay the cost of the first 200 feet of any water main or distribution line necessary to extend service to an individual residential customer within a platted subdivision.

However, if the residential customer requesting service purchased the property after the developer was notified in writing of the need to provide facilities to the utility, the utility may charge for the first 200 feet. The utility must also be able to document that the developer of the subdivision refused to provide facilities compatible with the utility's facilities in accordance with the utility's approved extension policy after receiving a written request from the utility.

Residential customers will be charged the equivalent of the costs of extending service to their property from the nearest collection line even if that line does not have adequate capacity to serve the customer. However, if the customer places unique, non-standard service demands upon the system, the customer may be charged the additional cost of extending service to and throughout their property, including the cost of all necessary transmission and storage facilities necessary to meet the service demands anticipated to be created by that property.

Unless an exception is granted by the PUC, the residential service applicant shall not be required to pay for costs of main extensions greater than 6" in diameter for gravity wastewater lines.

Exceptions may be granted by the PUC if

- adequate service cannot be provided to the applicant using the maximum line sizes listed due to distance or elevation, in which case, it shall be the utility's burden to justify that a larger diameter pipe is required for adequate service;
- or larger minimum line sizes are required under subdivision platting requirements or building codes of municipalities within whose corporate limits or extraterritorial jurisdiction the point of use is located; or the residential service applicant is located outside the CCN service area.

SECTION 3.0 -- EXTENSION POLICY (Continued)

If an exception is granted, the utility shall establish a proportional cost plan for the specific extension or a rebate plan which may be limited to seven years to return the portion of the applicant's costs for oversizing as new customers are added to ensure that future applicants for service on the line pay at least as much as the initial service applicant.

For purposes of determining the costs that service applicants shall pay, commercial customers with service demands greater than residential customer demands in the certified area, industrial, and wholesale customers shall be treated as developers.

If an applicant requires service other than the standard service provided by the utility, such applicant will be required to pay all expenses incurred by the utility in excess of the expenses that would be incurred in providing the standard service and connection beyond 200 feet and throughout his property including the cost of all necessary transmission facilities.

The utility will bear the full cost of any over-sizing of sewer mains necessary to serve other customers in the immediate area. The individual residential customer shall not be charged for any additional treatment facilities. Contributions in aid of construction of individual residential customers for production, storage, treatment or transmission facilities unless otherwise approved by the Commission under this specific extension policy.

Section 3.03 - Contributions in Aid of Construction

Developers may be required to provide contributions in aid of construction in amounts sufficient to furnish the development with all facilities necessary to provide for reasonable local demand requirements and to comply with TCEQ minimum design criteria for facilities used in the production, collection, transmission, pumping, or treatment of sewage or TCEQ minimum requirements. For purposes of this subsection, a developer is one who subdivides or requests more than two meters on a piece of property. Commercial, industrial, and wholesale customers will be treated as developers.

Any applicant who places unique or non-standard service demands on the system may be required to provide contributions in aid of construction for the actual costs of any additional facilities required to maintain compliance with the TCEQ minimum design criteria for water production, treatment, pumping, storage and transmission.

Any service extension to a subdivision (recorded or unrecorded) may be subject to the provisions and restrictions of 16 TAC 2486(d). When a developer wishes to extend the system to prepare to service multiple new connections, the charge shall be the cost of such extension, plus a pro-rata charge for facilities which must be committed to such extension compliant with the TCEQ minimum design criteria. As provided by 16 TAC 24.85(e)(3), for purposes of this section, commercial, industrial, and wholesale customers shall be treated as developers.

SECTION 3.0 -- EXTENSION POLICY (Continued)

A utility may only charge a developer standby fees for unrecovered costs of facilities committed to a developer's property under the following circumstances:

- Under a contract and only in accordance with the terms of the contract; or
- if service is not being provided to a lot or lots within two years after installation of facilities necessary to provide service to the lots has been completed and if the standby fees are included on the utilities approved tariff after a rate change application has been filed. The fees cannot be billed to the developer or collected until the standby fees have been approved by the commission or executive director.
- For purposes of this section, a manufactured housing rental community can only be charged standby fees under a contract or if the utility installs the facilities necessary to provide individually metered service to each of the rental lots or spaces in the community.

Section 3.04 - Appealing Connection Costs

The imposition of additional extension costs or charges as provided by Sections 3.0 - Extension Policy of this tariff shall be subject to appeal as provided in this tariff, commission rules, or the rules of such other regulatory authority as may have jurisdiction over the utility's rates and services. Any applicant required to pay for any costs not specifically set forth in the rate schedule pages of this tariff shall be given a written explanation of such costs prior to payment and/or commencement of construction. If the applicant does not believe that these costs are reasonable or necessary, the applicant shall be informed of the right to appeal such costs to the commission or such other regulatory authority having jurisdiction over the utility's rates in that portion of the utility's service area in which the applicant's property(ies) is located.

Section 3.05 - Applying for Service

The utility will provide a written service application form to the applicant for each request for service received by the utility's business offices. A separate application shall be required for each potential service location if more than one service connection is desired by any individual applicant. Service application forms will be available at the utility's business office during normal weekday business hours. Service applications will be sent by prepaid first class United States mail to the address provided by the applicant upon request. Completed applications should be returned by hand delivery in case there are questions which might delay fulfilling the service request. Completed service applications may be submitted by mail if hand delivery is not possible.

Docket No. 46745

SECTION 3.0 -- EXTENSION POLICY (Continued)

Where a new tap or service connection is required, the service applicant shall be required to submit a written service application and request that a tap be made. A diagram, map, plat, or written metes and bounds description of precisely where the applicant desires each tap or service connection is to be made and, if necessary, where the meter is to be installed, along the applicant's property line may also be required with the tap request. The actual point of connection and meter installation must be readily accessible to utility personnel for inspection, servicing, and meter reading while being reasonably secure from damage by vehicles and mowers. If the utility has more than one main adjacent to the service applicant's property, the tap or service connection will be made to the utility's nearest service main with adequate capacity to service the applicant's full potential service demand. Beyond the initial 200 feet, the customer shall bear only the equivalent cost of extending from the nearest main. If the tap or service connection cannot be made at the applicant's desired location, it will be made at another location mutually acceptable to the applicant and the utility. If no agreement on location can be made, the applicant may refer the matter to the commission for resolution.

Section 3.06 - Qualified Service Applicant

A "qualified service applicant" is an applicant who has: (1) met all of the utility's requirements for service contained in this tariff, commission rules and/or order, (2) has made payment or made arrangement for payment of tap fees, (3) has provided all easements and rights-of-way required to provide service to the requested location, (4) delivered an executed customer service inspection certificate to the Utility, if applicable, and (5) has executed a customer service application for each location to which service is being requested.

The utility shall serve each qualified service applicant within its certified service area as soon as practical after receiving a completed service application. All service requests will be fulfilled within the time limits prescribed by commission rules once the applicant has met all conditions precedent to achieving "qualified service applicant" status. If a service request cannot be fulfilled within the required period, the applicant shall be notified in writing of the delay, its cause and the anticipated date that service will be available. The commission service dates shall not become applicable until the service applicant has met all conditions precedent to becoming a qualified service applicant as defined by commission rules.

Section 3.07 - Developer Requirements

As a condition of service to a new subdivision, the utility shall require a developer (as defined by PUC rule) to provide permanent recorded public utility easements as a condition of service to any location within the developer's property.

APPENDIX A -- SAMPLE SERVICE AGREEMENT
From TCEQ Rules, 30 TAC Chapter 290.47(b), Appendix B
SERVICE AGREEMENT

- I. PURPOSE. The NAME OF SEWER SYSTEM is responsible for protecting the drinking water supply from contamination or pollution which could result from improper private water distribution system construction or configuration. The purpose of this service agreement is to notify each customer of the restrictions which are in place to provide this protection. The utility enforces these restrictions to ensure the public health and welfare. Each customer must sign this agreement before the NAME OF SEWER SYSTEM will begin service. In addition, when service to an existing connection has been suspended or terminated, the sewer system will not re-establish service unless it has a signed copy of this agreement.
- II. RESTRICTIONS. The following unacceptable practices are prohibited by State regulations.
- A. No direct connection between the public drinking water supply and a potential source of contamination is permitted. Potential sources of contamination shall be isolated from the public water system by an air-gap or an appropriate backflow prevention device.
 - B. No cross-connection between the public drinking water supply and a private water system is permitted. These potential threats to the public drinking water supply shall be eliminated at the service connection by the installation of an air-gap or a reduced pressure-zone backflow prevention device.
 - C. No connection which allows water to be returned to the public drinking water supply is permitted.
 - D. No pipe or pipe fitting which contains more than 8.0% lead may be used for the installation or repair of plumbing at any connection which provides water for human use.
 - E. No solder or flux which contains more than 0.2% lead can be used for the installation or repair of plumbing at any connection which provides water for human use.
- III. SERVICE AGREEMENT. The following are the terms of the service agreement between the NAME OF SEWER SYSTEM (the Sewer System) and NAME OF CUSTOMER (the Customer).
- A. The Sewer System will maintain a copy of this agreement as long as the Customer and/or the premises are connected to the Sewer System.
 - B. The Customer shall allow his property to be inspected for possible cross-connections and other potential contamination hazards. These inspections shall be conducted by the Sewer System or its designated agent prior to initiating new water service; when there is reason to believe that cross-connections or other potential contamination hazards exist; or after any major changes to the private water distribution facilities. The inspections shall be conducted during the Sewer System's normal business hours.
 - C. The Sewer System shall notify the Customer in writing of any cross-connection or other potential contamination hazard which has been identified during the initial inspection or the periodic reinspection.
 - D. The Customer shall immediately remove or adequately isolate any potential cross-connections or other potential contamination hazards on his premises.
 - E. The Customer shall, at his expense, properly install, test, and maintain any backflow prevention device required by the Sewer System. Copies of all testing and maintenance records shall be provided to the Sewer System.
- IV. ENFORCEMENT. If the Customer fails to comply with the terms of the Service Agreement, the Sewer System shall, at its option, either terminate service or properly install, test, and maintain an appropriate backflow prevention device at the service connection. Any expenses associated with the enforcement of this agreement shall be billed to the Customer.

CUSTOMER'S SIGNATURE: _____
DATE: _____