

Control Number: 46009

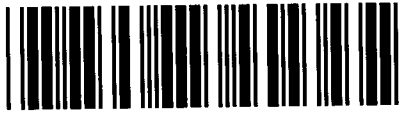

Item Number: 1

Addendum StartPage: 0



WATERENGINEERS, INC.

46009

~~WATER & WASTEWATER TREATMENT CONSULTANTS~~

17230 HUFFMEISTER ROAD, SUITE A~CYPRESS, TEXAS 77429-1643

TEL: 281-373-0500 FAX: 281-373-1118

RECEIVED

2016

051

May 27, 2016

Public Utility Commission of Texas
Central Records
1701 N. Congress, Suite 8-100
Austin, TX 78701

Re: Application from Crystal Springs Water Company, Inc.
to Amend Water CCN No. 11373 and Sewer CCN No. 20782 for the Ponderosa Pines
Subdivision in Montgomery County, TX

Dear Public Utility Commission of Texas:

Please find enclosed seven (7) copies of an Application for an Amendment to Water CCN No. 11373 and Sewer CCN No. 20782 for Crystal Springs Water Co., Inc. Also enclosed are two (2) CD's containing digital map data and one (1) CD containing an electronic copy of the application in .pdf format.

We appreciate your earliest review and issuance of a letter indicating administrative completeness. Please feel free to email me at syoung@waterengineers.com or call at 281-373-0500 if you have any questions regarding the information contained in this submittal.

Thank you for your assistance in this review process.

Sincerely,
WATERENGINEERS, INC.

Shelley Young, P.E.
Project Engineer

Encl. – 7 copies of CCN Amendment application
2 CD's containing digital map data
1 CD containing an electronic copy of the CCN Amendment Application

46009

**APPLICATION FOR AN AMENDMENT TO
WATER CERTIFICATE OF CONVENIENCE AND NECESSITY
NO. 11373
AND
SEWER CERTIFICATE OF CONVENIENCE AND NECESSITY
NO. 20782**

FOR

**CRYSTAL SPRINGS WATER CO., INC.
P.O. BOX 603
PORTER, TX 77365**

PREPARED BY:

WATERENGINEERS, INC.
WATER & WASTEWATER TREATMENT CONSULTANTS
17230 HUFFMEISTER ROAD CYPRESS, TEXAS 77429
TEL: 281-373-0500 FAX: 281-373-1113

MAY 2016

APPLICATION FOR AN AMENDMENT TO
WATER CCN NO. 11373 AND
SEWER CCN NO. 20782

CRYSTAL SPRINGS WATER CO., INC.

TABLE OF CONTENTS

<u>DESCRIPTION</u>	<u>NUMBER OF PAGES</u>
Application for an Amendment to Water CCN No. 11373 and Sewer CCN No. 20782 (Pages 1 – 16 of 25)	16
Attachment “A”- Certificate of Account Status	1
Attachment “B”- Need For Service	1
Attachment “C”- General Location Map	1
Attachment “D”- Proposed Service Area Map	1
Attachment “E”- Written Description of Service Area	1
Attachment “F”- Neighboring Public Utilities within 2 Miles And Service Request Letters & Map	11
Attachment “G”- Proof of Water Plans & Specs Submittal Proof of TPDES Application	3
Attachment “H”- Other System Most Recent Inspection Reports	101
Attachment “I”- Effect of Granting a Certificate	1
Attachment “J”- Ability to Provide Adequate Service	1
Attachment “K”- Financial Information	17
Attachment “L” – Water Tariff	17
Attachment “M” – Sewer Tariff	12



PURSUANT TO PUC CHAPTER 24, SUBSTANTIVE RULES APPLICABLE TO WATER AND SEWER SERVICE PROVIDERS, SUBCHAPTER G: CERTIFICATES OF CONVENIENCE AND NECESSITY

Application to Obtain or Amend a Water or Sewer Certificate of Convenience and Necessity (CCN)

Docket Number: **46009**

(this number will be assigned by the Public Utility Commission after your application is filed)

7 copies of the application, including the original, shall be filed with

Public Utility Commission of Texas
Attention: Filing Clerk
1701 N. Congress Avenue
P.O. Box 13326
Austin, Texas 78711-3326

If submitting digital map data, two copies of the portable electronic storage medium (such as CD or DVD) are required.

Table of Contents

Purpose of Application	2
1. Applicant Information.....	2
2. Location Information.....	3
3. Map Requirements.....	5
4. New System Information or Utilities Requesting a CCN for the First Time	5
5. Existing System Information	6
6. Financial Information	9
7. Notice Requirements.....	10
OATH.....	12
Notice for Publication.....	13
Notice to Neighboring Systems, Landowners and Cities.....	15
Notice to Customers of IOUs in Proposed Area	17

Historical Balance Sheets	19
Historical Income Statement.....	20
Historical Expenses Statement	21
Projected Balance Sheets	22
Projected Income Statement	23
Projected Expenses Statement.....	24
Projected Sources And Uses Of Cash Statements	25

Application to Obtain or Amend a Water or Sewer Certificate of Convenience and Necessity (CCN)

Purpose of Application		
<input type="checkbox"/> Obtain	<input type="checkbox"/> New Water CCN	<input type="checkbox"/> New Sewer CCN
<input checked="" type="checkbox"/> Amend	<input checked="" type="checkbox"/> Water CCN# (s)	11373
<input checked="" type="checkbox"/> Amend	<input checked="" type="checkbox"/> Sewer CCN#(s)	20782

1. Applicant Information

Applicant	
Utility name: Crystal Springs Water Co., Inc.	
Certificate number: Water CCN 11373 Sewer CCN 20782	
Street address (City/ST/ZIP/Code): 23449 Hwy. 59 North, Porter, TX 77365	
Mailing address(City/ST/ZIP/Code): P.O. Box 603, Porter, TX 77365-0603	
Utility Phone Number and Fax: (281) 354-5736	
Contact information	
Please provide information about the person(s) to be contacted regarding this application. Indicate if this person is the owner, operator, engineer, attorney, accountant manager, or other title related to the applicant.	
Name: Shelley Young, P.E.	Title: Engineer
Mailing address: 17230 Huffmeister Road, Suite A, Cypress, TX 77429	
Email: syoung@waterengineers.com	Phone and Fax: (281) 373-0500
List all counties in which service is proposed: Montgomery	

A. Check the appropriate box and provide information regarding the legal status of the applicant:

- Investor Owned Utility Individual Partnership
- Home or Property Owners Association For-profit Corporation
- Non-profit, member-owned, member-controlled cooperative corporation
(Water Code Chapter 67, Water Supply or Sewer Service Corporation)
- Municipality District Other - Please explain:

B. If the applicant is a For-Profit business or corporation, please include the following information:

- i. A copy of the corporation's "Certification of Account Status" from the Texas State Comptroller of Public Accounts. See Attachment A
- ii. The corporation's charter number as recorded with the Office of the Texas Secretary of State: 17420905428
- iii. A listing of all stockholders and their respective percentages of ownership.
- iv. A copy of the company's organizational chart, if available.
- v. A list of all directors and disclose the title of each individual.
- vi. A list of all affiliated organizations (if any) and explain the affiliate's business relationship with the applicant.

C. If the applicant is a Texas Water Code (TWC) Chapter 67 water supply or sewer service corporation please provide:

- i. A copy of the Articles of Incorporation and By-Laws. N/A
- ii. The corporation's charter number as recorded with the Office of the Texas Secretary of State.
- iii. Identification of all board members including name, address, title, and telephone number.
- iv. A copy of the corporation's *Certificate of Account Status* from the Texas Comptroller of Public Accounts.

2. Location Information

- A. Are there people already living in the proposed area? Yes No
- If YES, are any currently receiving utility service? Yes No
- If YES, from WHOM? _____

B. Demonstrate the Need for Service by providing the following:

Have you received any requests for service in the requested service area?

Yes No

If YES, provide the following:

- i. Describe the service area and circumstances driving the need for service in the requested area. Indicate the name(s) and address(es) of landowner(s), prospective landowner(s), tenant(s), or resident(s) that have requested service; and/or See Attachment B
- ii. Describe the economic need(s) for service in the requested area (i.e. plat approvals, recent annexation(s) or annexation request(s), building permits, septic tank permits, hospitals, etc.); and/or
- iii. Discuss in detail the environmental need(s) for service in the requested area (i.e. failing septic tanks in the requested area, fueling wells, etc.); and/or
- iv. Provide copies of any written application(s) or request(s) for service in the requested area; and/or
- v. Provide copies of any reports and/or market studies demonstrating existing or anticipated growth in the requested area.
- vi. If none of these items exist or are available, please justify the need for service in the proposed area in writing.

Note: Failure to demonstrate a need for additional service in the proposed service area may result in the delay and /or possible denial of the application.

C. Is any portion of the proposed service area inside an incorporated city or district?

Yes No

If YES, within the corporate limits of: _____

Provide a copy of any franchise, permit, or consent granted by the city or district. If not available please explain:

D. Is any portion of the proposed service area inside another utility's CCN area?

Yes No

If YES, has the current CCN holder agreed to decertify the proposed area?

If NO, are you seeking dual or single certification of the area? Explain why decertification of the area is in the public interest:

3. Map Requirements

Attach the following hard copy maps with each copy of the application:

- A. A location map delineating the proposed service area with enough detail to accurately locate the proposed area within the county. See Attachment C
- B. A map showing only the proposed area by: See Attachment D
 - i. metes and bounds survey certified by a licensed state or register professional land surveyor; or
 - ii. projectable digital data with metadata (proposed areas should be in a single record and clearly labeled). Also, a data disk labeled with the applicant's name must be provided; or
 - iii. following verifiable natural and man-made landmarks; or
 - iv. a copy of recorded plat map with metes and bounds.
- C. A written description of the proposed service area. See Attachment E
- D. Provide separate and additional maps of the proposed area(s) to show the following:
 - i. all facilities, illustrating separately facilities for production, transmission, and distribution of the applicant's service(s); and Facilities have not yet been built
 - ii. any facilities, customers or area currently being served outside the applicant's certificated area(s).

Note: Failure to provide adequate mapping information may result in the delay or possible denial of your application.

Digital data submitted in a format other than ArcView shape file or Arc/Info E00 file may result in the delay or inability to review applicant's mapping information.

For information on obtaining a CCN base map or questions about sending digital map data, please visit the Water Utilities section of the PUC website for assistance.

4. New System Information or Utilities Requesting a CCN for the First Time

A. Please provide the following information:

- i. a list of public drinking water supply system(s) or sewer system(s) within a 2 mile radius of the proposed system; See Attachment F
- ii. copies of written requests seeking to obtain service from each of the public drinking water systems or sewer systems listed in a. 1 above or documentation that it is not economically feasible to obtain service from each entity; See Attachment F
- iii. copies of written responses from each system or evidence that they did not reply; and
- iv. for sewer utilities, documentation showing that you have obtained or applied for a wastewater discharge permit. See Attachment G

B. Were your requests for service denied? Yes No

- i. If yes, please provide documentation of the denial of service and go to c.
 - ii. If no, please provide a detailed analysis which justifies your reasons for not accepting service. A separate analysis must be prepared and submitted for each utility that granted your request for service.
- C. Please summarize how the proposed utility system will be constructed and describe each projected construction phase, if any:

Phase I Water: In the first phase the following will be constructed: A 6" well with a 15 Hp motor capable of producing 200 gpm, a 83,000 gallon ground storage tank, a 5,000 gallon hydropneumatic tank, 3 - 25 Hp booster pumps capable of pumping 350 gpm each at 55 psi, facilities to store and feed sodium hypochlorite for disinfection, a 6' high fence with 3 strands of barbed wire and a 150 kW generator.

Phase II Water: When customer demand or plant physical characteristics require, a second 6" well will be drilled, a second hydropneumatic tank will be added and an additional booster pump will be added. +

Phase I Wastewater: A 75,000 gallon per day wastewater plant with on-site lift station, chemical disinfection facilities, plant fencing and a generator will all be built in the first phase.

D. Date of plat approval, if required: _____
 Approved by: _____

E. Date Plans & Specifications submitted to the TCEQ for approval:
 water-10/30/2014 wastewater plans not yet submitted (TPDES submitted 9/10/2014) Attach copy of approval letter, if available. If the letter is not available by the time your CCN application is submitted, please supplement your application with a copy of the letter once you receive it from the TCEQ.

F. Date construction is scheduled to commence: 1/15/2017

G. Date service is scheduled to commence: 9/1/2017

5. Existing System Information

A. Please provide the following information for each water and/or sewer system, attach additional sheets if necessary.

i. Water system(s): TCEQ Public Water System identification number(s):

1 7 0 0 5 8 0 ;	1 7 0 0 1 4 7 ;	1 7 0 0 7 5 6
1 7 0 0 2 9 0 ;	1 7 0 0 4 3 4 ;	1 7 0 0 4 3 5
1 7 0 0 6 2 2 ;	1 7 0 0 3 2 2 ;	2 3 6 0 0 4 4
1 7 0 0 7 1 9 ;	1 7 0 0 1 8 4 ;	1 7 0 0 1 9 8

ii. Sewer system(s): TCEQ Discharge Permit number(s)

- i. If yes, please provide documentation of the denial of service and go to c.
 - ii. If no, please provide a detailed analysis which justifies your reasons for not accepting service. A separate analysis must be prepared and submitted for each utility that granted your request for service.
- C. Please summarize how the proposed utility system will be constructed and describe each projected construction phase, if any:

Phase I Water: In the first phase the following will be constructed: A 6" well with a 15 Hp motor capable of producing 200 gpm, a 83,000 gallon ground storage tank, a 5,000 gallon hydropneumatic tank, 3 - 25 Hp booster pumps capable of pumping 350 gpm each at 55 psi, facilities to store and feed sodium hypochlorite for disinfection, a 6' high fence with 3 strands of barbed wire and a 150 kW generator.

Phase II Water: When customer demand or plant physical characteristics require, a second 6" well will be drilled, a second hydropneumatic tank will be added and an additional booster pump will be added.

Phase I Wastewater: A 75,000 gallon per day wastewater plant with on-site lift station, chemical disinfection facilities, plant fencing and a generator will all be built in the first phase.

D. Date of plat approval, if required: _____
 Approved by: _____

E. Date Plans & Specifications submitted to the TCEQ for approval:
water-10/30/2014 wastewater plans not yet submitted (TPDES submitted 9/10/2014) Attach copy of approval letter, if available. If the letter is not available by the time your CCN application is submitted, please supplement your application with a copy of the letter once you receive it from the TCEQ.

F. Date construction is scheduled to commence: 1/15/2017

G. Date service is scheduled to commence: 9/1/2017

5. Existing System Information

A. Please provide the following information for each water and/or sewer system, attach additional sheets if necessary.

i. Water system(s): TCEQ Public Water System identification number(s):

1	7	0	0	4	3	2	1	7	0	0	0	5	8	1	7	0	0	6	2	6
1	7	0	0	6	1	2	1	7	0	0	4	3	3	1	7	0	0	2	8	9
1	7	0	0	6	2	9	1	7	0	0	0	6	6	1	7	0	0	6	1	3
1	7	0	0	4	6	6	1	7	0	0	0	7	5							

ii. Sewer system(s): TCEQ Discharge Permit number(s)

W Q 1 4 0 8 1 - 0 0 1 ;

W Q 1 2 6 2 1 - 0 0 1

W Q -

W Q -

W Q -

W Q -

- iii. Date of last TCEQ water and/or sewer system inspection(s): _____ See Attachment H
- iv. Attach a copy of the most recent TCEQ water and/or sewer inspection report letter(s). See Attachment H
- v. For each system deficiency listed in the TCEQ inspection report letter; attach a brief explanation listing the actions taken or being taken by the utility to correct the listed deficiencies, including the proposed completion dates.

B. Provide the following information about the utility's certified water and/or sewer operators

Name	Classes	License Number
Larry Purcell	C-Water, C-WW	WG0006200, WW0013058
Gary Gray	C-Water, D-WW	WG0011038, WW0031216
Abel Garcia	C-Water	WG0013679
Frank Schuler	D-Water, D-WW	WO0032749, WW0050871
Bobbie McDonald	D-Water	WO0010545

- Attach additional sheet(s) if necessary -

C. Using the current number of customers, is any facility component in systems named in #5A above operating at 85% or greater of minimum standard capacity?

- Yes
- No

Attach a copy of the 85% rule compliance document filed with the TCEQ if the system is operating at 85% or greater of the TCEQ's minimum standard capacity requirements.

D. In the table below, the number of existing and/or proposed metered and non-metered connections (by size). The proposed number should reflect the information presented in the business plan or financial documentation and reflect the number of service requests identified in Question 2.b in the application.

TCEQ Water System			TCEQ Sewer System		
Connection	Existing	Proposed	Connection	Existing	Proposed
5/8" or 3/4" meter	0	350	Residential	0	350
1" meter or larger		1	Commercial		1
Non-Metered			Industrial		

TCEQ Water System			TCEQ Sewer System		
Other:			Other:		
Total Water	0	351	Total Sewer	0	351

E. If this application is for a water CCN only, please explain how sewer service is or will be provided:

N/A

F. If this application is for a sewer CCN only, please explain how water service is or will be provided:

N/A

G. Effect of Granting a Certificate Amendment. See Attachment I

Explain in detail the effect of granting of a certificate or an amendment, including, but not limited to regionalization, compliance and economic effects on the following:

- i. the applicant,
- ii. any retail public utility of the same kind already serving the proximate area; and
- iii. any landowner(s) in the requested area.

H. Do you currently purchase or plan to purchase water or sewer treatment capacity from another source?

i. No, (skip the rest of this question and go to #6)

ii. Yes, Water

Purchased on a Regular Seasonal Emergency basis?

Water Source	% of Total Treatment
	0.00%

Water Source	% of Total Treatment
	0.00%
	0.00%

- iii. Yes, Sewer treatment capacity
Purchased on a Regular Seasonal Emergency basis?

Sewer Source	% of Total Treatment
	0.00%
	0.00%
	0.00%

iv. Provide a signed and dated copy of the most current water or sewer treatment capacity purchase agreement or contract.

I. Ability to Provide Adequate Service. See Attachment J

Describe the ability of the applicant to provide adequate service, including meeting the standards of the commission, taking both of the following items into consideration:

- i. the current and projected density; and
- ii. the land use of the requested area.

J. Effect on the Land. Explain the effect on the land to be included in the certificated area.

The land is currently wooded and unoccupied and is in the land planning stage of being developed into a residential neighborhood.

6. Financial Information

- A. For new water and/or sewer systems and for applicants with existing CCNs who are constructing a new stand-alone water and/or sewer system: See Attachment K
 - i. the applicant must provide an analysis of all necessary costs for constructing, operating, and maintaining the system, and the source of that capital (such as a financial statement for the developing entity) for which the CCN is requested for at least the first five years. In addition, if service has been offered by an existing retail water service provider as stated in #4.A., but the applicant has determined that the cost of service as finally offered renders the project not economically feasible, the applicant must provide a comparison analysis of all necessary costs for acquiring and continuing to receive service from the existing system for the same period.
 - ii. Attach projected profit and loss statements, cash flow worksheets, and balance sheets (projected five year financial plan worksheet is attached) for each of the first five years of operation. Income from rates

13

should correlate to the projected growth in connections, shown on the projected profit and loss statement.

- iii. Attach a proposed rate schedule or tariff. Describe the procedure for determining the rates and fees and indicate the date of last change, if applicable. Attach copies of any cost of service studies or rate analysis worksheets. See Attachment L

B. For existing water and/or sewer systems:

- i. Attach a profit and loss statement and current balance sheet for existing businesses (end of last fiscal year is acceptable). Describe sources and terms for borrowed capital such as loans, bonds, or notes (profit and loss and balance sheet worksheets are attached, if needed).
- ii. Attach a proposed rate schedule or tariff.

❖ **Note: An existing water and/or sewer system may be required to provide the information in 6.A.i. above during the technical review phase if necessary for staff to completely evaluate the application**

C. Identify any funds you are required to accumulate and restrict by lenders or capital providers.

D. In lieu of the information in #6.A. thru #6.C., you may provide information concerning loan approvals within the last three (3) years from lending institutions or agencies including the most recent financial audit of the applicant.

❖ **Note: Failure to provide adequate financial information may result in the delay or possible denial of your application.**

7. Notice Requirements

- A. All proposed notice forms must be completed and submitted with the application. Do not mail or publish the notices until you receive written approval from the commission to do so.
- B. The commission cannot grant a CCN until proper notice of the application has been given. Commission rules do not allow a waiver of notice requirements for CCN applicants.
- C. It is the applicant's responsibility to ensure that proper notice is given to all entities that are required to receive notice.
- D. Recommended notice forms for publication, neighboring cities and systems, landowners with 25 acres or more, and customers are included with this application for use in preparing proposed notices. (Notice forms are available in Spanish upon request.)
- E. After reviewing and, if necessary, modifying the proposed notice, the commission will send the notice to the applicant after the application is accepted for filing along with instructions for publication and/or mailing. Please review the notice carefully before providing the notice.
- F. Notice For Publication:
The applicant shall publish the notice in a newspaper with general circulation in the county(ies) where a CCN is being requested. The notice must be published once each week for two consecutive weeks beginning with the week after the notice is received from the commission. Proof of publication in the form of a publisher's affidavit shall be submitted to the commission within 30 days of the last publication date. The affidavit shall state with specificity each county in which the newspaper is of general circulation.
- G. Notice To Neighboring Utilities:
 - i. List all neighboring retail public utilities and cities providing the same utility service within the following vicinities of the applicant's proposed certificate area.
 - ii. For applications for the issuance of a NEW CCN, the applicant must mail the notice with a copy of the proposed CCN map to all cities and neighboring retail public utilities providing the same utility service within five (5) miles of the requested service area.

iii. For applications for the AMENDMENT of a CCN, the applicant must mail the notice with a copy of the proposed CCN map to all cities and neighboring retail public utilities providing the same utility service within two (2) miles of the requested service area. See Attachment F

H. Notice to Customers:

Investor Owned Utilities (IOUs) that are currently providing service without a CCN must provide individual mailed notice to all current customers. The notice must contain the current rates, the date those rates were instituted and any other information required in the application.

I. The commission may require the applicant to deliver notice to other affected persons or agencies.

Do not publish or send copies of the proposed notices to anyone at the time you submit the application to the commission. Wait until you receive written authorization to do so. Authorization occurs after the commission has reviewed the notices for completeness, and your application has been accepted for filing. Once the application is accepted for filing, you will receive written authorization to provide notice. Please check the notices for accuracy before providing them to the public. It is the applicant's burden to ensure that correct and accurate notice is provided.

OATH

STATE OF TEXAS
COUNTY OF MONTGOMERY

I, JULIE DUBROS, being duly sworn, file this application as SECRETARY/TREASURER (indicate relationship to Applicant, that is, owner, member of partnership, title as officer of corporation, or other authorized representative of Applicant); that, in such capacity, I am qualified and authorized to file and verify such application, am personally familiar with the maps and financial information filed with this application, and have complied with all the requirements contained in this application; and, that all such statements made and matters set forth therein are true and correct. I further state that the application is made in good faith and that this application does not duplicate any filing presently before the Public Utility Commission of Texas.

I further represent that the application form has not been changed, altered or amended from its original form.

I further represent that the Applicant will provide continuous and adequate service to all customers and qualified applicants for service within its certificated service area.

Julie Dubros
AFFIANT
(Utility's Authorized Representative)

If the Affiant to this form is any person other than the sole owner, partner, officer of the Applicant, or its attorney, a properly verified Power of Attorney must be enclosed.

SUBSCRIBED AND SWORN TO BEFORE ME, a Notary Public in and for the State of Texas, This day 20th of May 20 16

SEAL

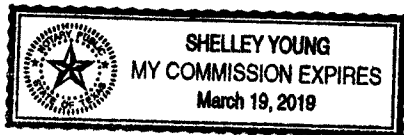

Shelley Young
NOTARY PUBLIC IN AND FOR THE
STATE OF TEXAS

Shelley Young
PRINT OR TYPE NAME OF NOTARY

MY COMMISSION EXPIRES March 19, 2019

Notice for Publication

NOTICE OF APPLICATION FOR A CERTIFICATE OF CONVENIENCE AND NECESSITY (CCN) TO PROVIDE WATER AND SEWER UTILITY SERVICE IN MONTGOMERY COUNTY, TEXAS

Crystal Springs Water Company, Inc. has filed an application to amend Water Certificate of Convenience and Necessity (CCN) No. 11373 and Sewer CCN No. 20782 with the Public Utility Commission of Texas to provide water and sewer utility service in Montgomery County.

The proposed utility service area is located approximately 3.5 miles east of downtown Cut and Shoot, Texas, and is **generally** bounded on the north by State Highway 105; on the east by S. Walker Road; on the south by Old Highway 105; and on the west by a line 4,450 feet west of and parallel to S. Walker Road.

The total area being requested for the proposed water and sewer service areas includes approximately 121 acres for each service area and 0 current customers.

A copy of the proposed service area map is available at: WaterEngineers, Inc., 17230 Huffmeister Road, Suite A, Cypress, Texas 77429 (281) 373-0500.

A request for a public hearing must be in writing. You must state (1) your name, mailing address, and daytime telephone number; (2) the applicant's name, application number or another recognizable reference to this application; (3) the statement, "I/we request a public hearing"; (4) a brief description of how you or the persons you represent, would be adversely affected by the granting of the application for a CCN; and (5) your proposed adjustment to the application or CCN which would satisfy your concerns and cause you to withdraw your request for a hearing.

Persons who wish to intervene or comment should file with the PUC at the following address:

Filing Clerk
Public Utility Commission of Texas
1701 North Congress Avenue
P.O. Box 13326
Austin, TX 78711-3326

within thirty (30) days from the date of this publication or notice. A public hearing will be held only if a legally sufficient hearing request is received or if the Commission on its own motion requests a hearing. Only those individuals who submit a written hearing request or a written request to be notified if a hearing is set will receive notice if a hearing is scheduled.

If a public hearing is requested, the Executive Director will not issue the CCN and will forward the application to the State Office of Administrative Hearings (SOAH) for a hearing. If no settlement is reached and an evidentiary hearing is held, the SOAH will submit a recommendation to the Commission for final decision. If an evidentiary hearing is held, it will be a legal proceeding similar to a civil trial in state district court.

If you are a landowner with a tract of land at least 25 acres or more, that is partially or wholly located within the proposed area, you may request to be excluded from the proposed area (or "opt out") by providing written notice to the Commission within (30) days from the date that notice was provided by the applicant. All request to opt out of the requested service area must include a scaled, general location map and a metes and bounds description of the tract of land.

Persons who meet the requirements to opt out, and wish to request this option should file the required documents with the:

Filing Clerk
Public Utility Commission of Texas
1701 North Congress Avenue
P.O. Box 13326
Austin, TX 78711-3326

A copy of the request to opt out of the proposed area must also be sent to the applicant. Staff may request additional information regarding your request.

Si desea informacion en Espanol, puede llamar al 1-888-782-8477.

Notice to Neighboring Systems, Landowners and Cities

NOTICE OF APPLICATION FOR A CERTIFICATE OF CONVENIENCE AND NECESSITY
(CCN) TO PROVIDE WATER AND SEWER UTILITY SERVICE IN MONTGOMERY
COUNTY, TEXAS

To: _____ Date Notice Mailed: _____, 2016
(Neighboring System, Landowner or City)

(Address)

(City State Zip)

Crystal Springs Water Company, Inc. has filed an application to amend Water Certificate of Convenience and Necessity (CCN) No. 11373 and Sewer CCN No. 20782 with the Public Utility Commission of Texas to provide water and sewer utility service in Montgomery County.

The proposed utility service area is located approximately 3.5 miles east of downtown Cut and Shoot, Texas, and is **generally** bounded on the north by State Highway 105; on the east by S. Walker Road; on the south by Old Highway 105; and on the west by a line 4,450 feet west of and parallel to S. Walker Road.

See enclosed map of the proposed service area.

The total area being requested for the proposed water and sewer service areas includes approximately 121 acres for each service area and 0 current customers.

A request for a public hearing must be in writing. You must state (1) your name, mailing address, and daytime telephone number; (2) the applicant's name, application number or another recognizable reference to this application; (3) the statement, "I/we request a public hearing"; (4) a brief description of how you or the persons you represent, would be adversely affected by the granting of the application for a CCN; and (5) your proposed adjustment to the application or CCN which would satisfy your concerns and cause you to withdraw your request for a hearing.

Persons who wish to intervene or comment should write the:

Filing Clerk
Public Utility Commission of Texas
1701 North Congress Avenue
P.O. Box 13326
Austin, Texas 78711-3326

within thirty (30) days from the date of this publication or notice. A public hearing will be held only if a legally sufficient hearing request is received or if the Commission on its own motion requests a hearing. Only those individuals who submit a written hearing request or a written request to be notified if a hearing is set will receive notice if a hearing is scheduled.

If a public hearing is requested, the Executive Director will not issue the CCN and will forward the application to the State Office of Administrative Hearings (SOAH) for a hearing. If no settlement is reached and an evidentiary hearing is held, the SOAH will submit a recommendation to the Commission for final decision. If an evidentiary hearing is held, it will be a legal proceeding similar to a civil trial in state district court.

If you are a landowner with a tract of land at least 25 acres or more, that is partially or wholly located within the proposed area, you may request to exclude the tract from the proposed area (or "opt out") by providing written notice to the Commission within (30) days from the date that notice was provided by the applicant. All request to opt out of the requested service area must include a scaled, general location map and a metes and bounds description of the tract of land.

Persons who meet the requirements to opt out, and wish to request this option should file the required documents with the:

Filing Clerk
Public Utility Commission of Texas
1701 North Congress Avenue
P.O. Box 13326
Austin, Texas 78711-3326

A copy of the request to opt out of the proposed area must also be sent to the applicant. Staff may request additional information regarding your request.

Si desea informacion en Espanol, puede llamar al 1-888-782-8477.

ATTACHMENT "A"
CERTIFICATE OF ACCOUNT STATUS
CRYSTAL SPRINGS WATER CO., INC.



Franchise Tax Account Status

As of: 05/18/2016 03:07:40 PM

This Page is Not Sufficient for Filings with the Secretary of State

CRYSTAL SPRINGS WATER CO., INC.

Texas Taxpayer Number 17420905428

Mailing Address PO BOX 603
PORTER, TX 77365-0603

Right to Transact ACTIVE
Business in Texas

State of Formation TX

Effective SOS 02/09/1979
Registration Date

Texas SOS File Number 0046316600

Registered Agent Name TOM A MARTIN

Registered Office Street P O BOX 603
Address PORTER, TX 77365

22

ATTACHMENT "B"

NEED FOR SERVICE

CRYSTAL SPRINGS WATER CO., INC.

ATTACHMENT B

NEED FOR SERVICE

Martin Land Development, LLC (DEVELOPER) plans to develop approximately 121 acres of land in Montgomery County, Texas into residential lots, and has partnered with Crystal Springs Water Co., Inc. to provide water and sewer service. The tract is not in any other CCN, district or city.

Martin Land Development, LLC and Crystal Springs Water Co., Inc. are under common ownership.

ATTACHMENT "C"
GENERAL LOCATION MAP

CRYSTAL SPRINGS WATER CO., INC.

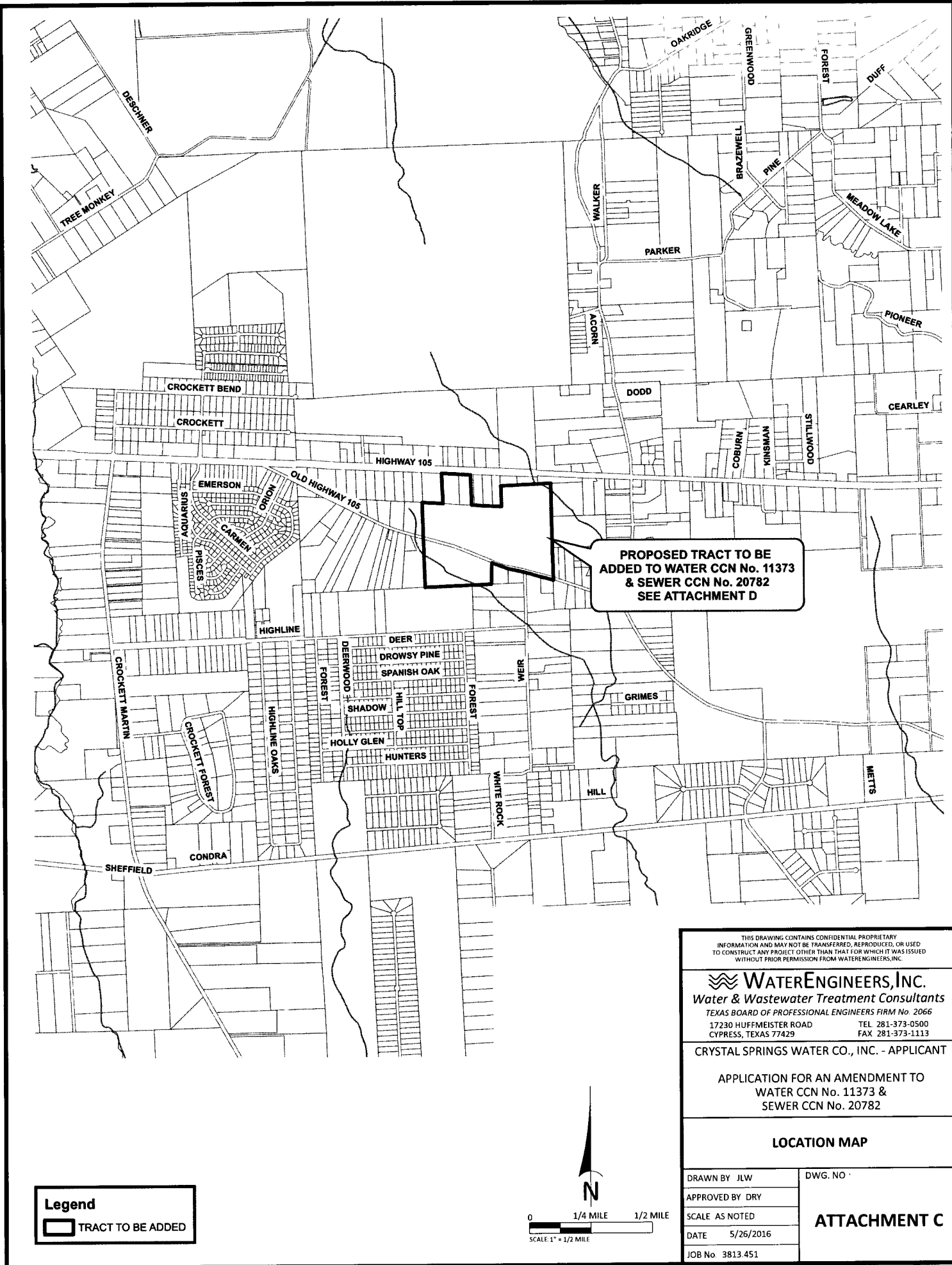

**PROPOSED TRACT TO BE
ADDED TO WATER CCN No. 11373
& SEWER CCN No. 20782
SEE ATTACHMENT D**

Legend
 **TRACT TO BE ADDED**

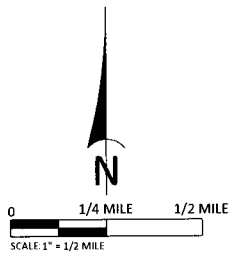

THIS DRAWING CONTAINS CONFIDENTIAL PROPRIETARY INFORMATION AND MAY NOT BE TRANSFERRED, REPRODUCED, OR USED TO CONSTRUCT ANY PROJECT OTHER THAN THAT FOR WHICH IT WAS ISSUED WITHOUT PRIOR PERMISSION FROM WATERENGINEERS, INC.

WaterEngineers, Inc.
Water & Wastewater Treatment Consultants
 TEXAS BOARD OF PROFESSIONAL ENGINEERS FIRM No. 2066
 17230 HUFFMEISTER ROAD TEL 281-373-0500
 CYPRESS, TEXAS 77429 FAX 281-373-1113

CRYSTAL SPRINGS WATER CO., INC. - APPLICANT

**APPLICATION FOR AN AMENDMENT TO
WATER CCN No. 11373 &
SEWER CCN No. 20782**

LOCATION MAP

DRAWN BY JLW	DWG. NO.
APPROVED BY DRY	ATTACHMENT C
SCALE AS NOTED	
DATE 5/26/2016	
JOB No. 3813.451	

26

I:\served\water\current\job\3813.46\ssandrs\pines\map & con\con amendment\dwg\files\attachment_c.dwg

ATTACHMENT "D"

PROPOSED SERVICE AREA MAP

CRYSTAL SPRINGS WATER CO., INC.

25.335, 4.057, 82.760, 2.993 & 6.13 ACRES
 OF LAND AND LOTS 30, 31 & 32
 OF THE SURVEY KNOWN AS
 VOLUME 3, PAGE 169 M.C.M.R.
 IN THE
 RICHARD PEEBLES SURVEY, A - 414
 MONTGOMERY COUNTY, TEXAS
 Date November, 2014
 Scale 1" = 200'

- Notes
1. Bearings are based upon Texas State Plane Coordinate System NAD 83, Texas Central Zone, Grid 03, 46339.
 2. 1, 2, 1R Set w/Cop. (Jeff Moon RPLS)
 3. This survey is based in part of d. Metes and Bounds description of even date.

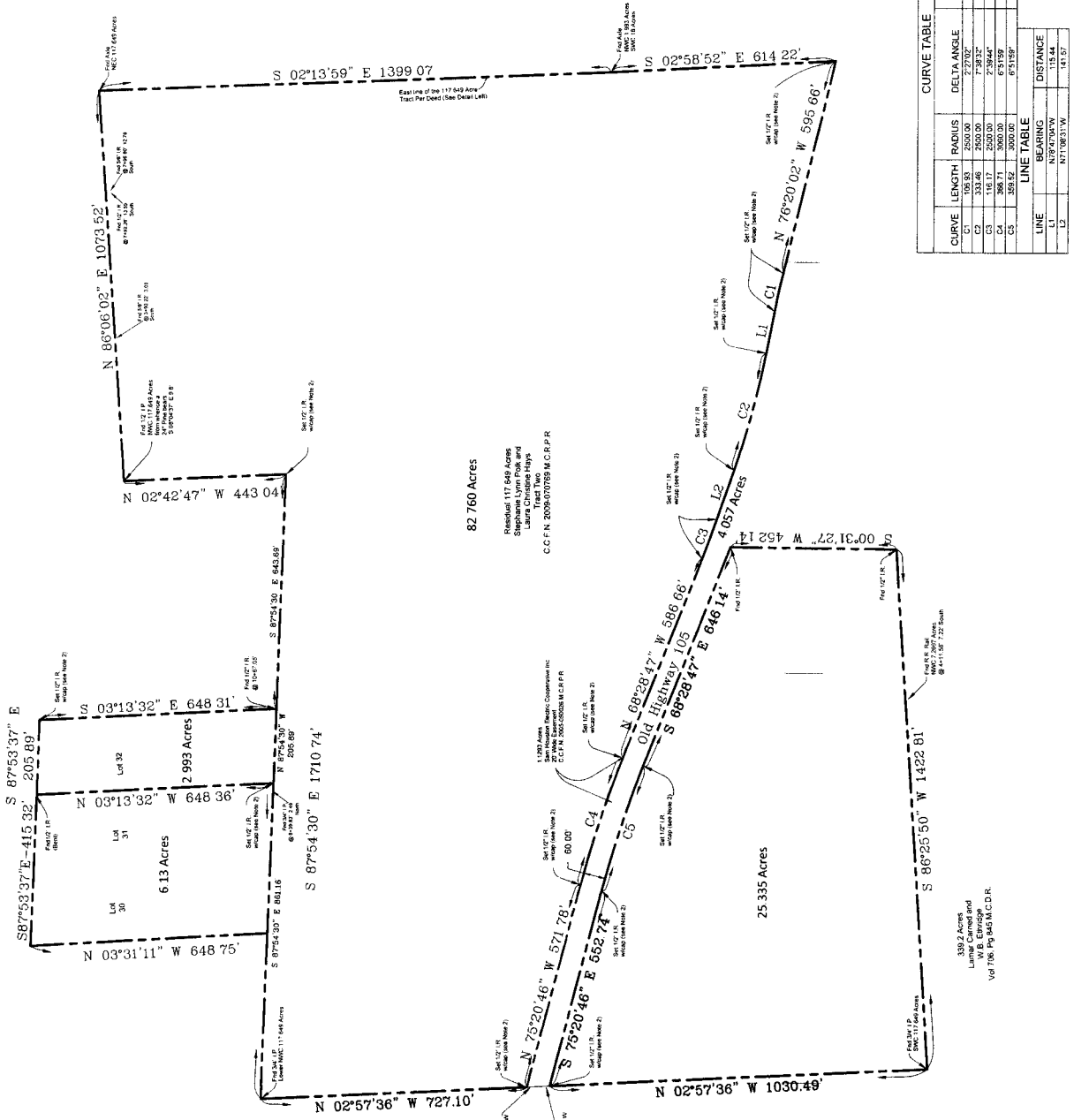

CURVE TABLE		CHORD BEARING & DISTANCE	
CURVE	LENGTH	RADIUS	DELTA ANGLE
C1	100.31	2500.00	7°28'32"
C2	333.46	2500.00	7°28'32"
C3	116.17	2500.00	2°39'44"
C4	396.71	3000.00	6°31'59"
C5	253.52	2000.00	6°31'59"

LINE TABLE		DISTANCE	
LINE	LENGTH	BEARING	DISTANCE
L1	100.31	N71°54'45"E	144.57
L2	333.46	N71°54'45"E	144.57

WATERENGINEERS, INC
 Water & Wastewater Treatment Consultants
 TEXAS BOARD OF PROFESSIONAL ENGINEERS REG. NO. 2086
 1100 W. UNIVERSITY BLVD., SUITE 100
 CYPRESS, TEXAS 77429
 FAX: 281.375.3113

APPLICATION FOR AN AMENDMENT TO
 WATER CON. NO. 11373 &
 SEWER CON. NO. 20782

SERVICE AREA

DRAWN BY: RLW
 DWG. NO.
 APPROVED BY: DRY
 SCALE AS SHOWN
 DATE: 5/22/2015
 JOB NO. 8814-451

ATTACHMENT "E"

WRITTEN DESCRIPTION OF SERVICE AREA

CRYSTAL SPRINGS WATER CO., INC.

ATTACHMENT E

WRITTEN DESCRIPTION OF SERVICE AREA

The proposed utility service area is located approximately 3.5 miles east of Cut and Shoot, Texas in Montgomery County and is generally bounded on the north by State Highway 105, on the east by S. Walker Road, on the south by Old Highway 105, and on the west by a line 4,450 feet west of and parallel to S. Walker Road.

ATTACHMENT "F"

**NEIGHBORING PUBLIC UTILITIES
WITHIN 2 MILES AND SERVICE
REQUEST LETTERS**

AND

**NEIGHBORING PUBLIC UTILITIES
WITHIN 5 MILES**

CRYSTAL SPRINGS WATER CO., INC.

ATTACHMENT F
TWO MILE RADIUS
DISTRICTS, CCN HOLDERS AND OTHER ENTITIES

Aqua Texas, Inc. 1106 Clayton Lane, Suite 400W Austin, TX 78723	CCN No. 13203
Town of Cut and Shoot P.O. Box 7364 Cut and Shoot, TX 77306	CCN No. 11615
Highline Oaks Water Utility c/o ES Water Utility Consolidators, Inc. 9132 White Oak Dr. Conroe, TX 77384	CCN No. 13006
C & R Water Supply, Inc. P.O. Box 187 Willis, TX 77378-0187	CCN No. 13098 CCN No. 20987
David Lee Sheffield Texas Landing Utilities P.O. Box 2110 Onalaska, TX 77360	CCN No. 11997
Orchard Crossing P.O. Box 279 New Waverly, TX 77358	CCN No. 12671
East Montgomery County Improvement District 21575 U.S. Highway 59 North New Caney, TX 77357-1019	District ID 2801500
San Jacinto River Authority 1577 Dam Site road Conroe, TX 77304	District ID 7490000
Lone Star Groundwater Conservation District 665 Conroe Park North Drive Conroe, TX 77303	District ID 5445500
Montgomery County 501 North Thompson, Suite 401 Conroe, TX 77301	

WATERENGINEERS, INC.

WATER & WASTEWATER TREATMENT CONSULTANTS

17230 HUFFMEISTER ROAD, SUITE A~CYPRESS, TEXAS 77429-1643

TEL: 281-373-0500 FAX: 281-373-1113

May 22, 2015

Aqua Texas, Inc. CCN 13203
1106 Clayton Lane, Suite 400W
Austin, TX 78723

Dear Sir/Ms.:

We are in the process of obtaining approval from the TCEQ for a proposed community public water system and a proposed community wastewater system and submitting an application to amend Water Certificate of Convenience and Necessity (CCN) No. 11373 and CCN No. 20782 with the Public Utility Commission of Texas (PUC) for Crystal Springs Water Company, Inc. The proposed new water and wastewater systems will serve the proposed new residential development off of Highway 105 between Old Highway 105 and S. Walker Road in Montgomery County, Texas, as shown on the attached map.

PUC rules require that we contact all existing CCN holders and Utility Districts within a two mile radius to determine if an existing utility is willing to provide retail water and/or wastewater service to the proposed development in a manner that is competitive with what can be provided by the new system.

In accordance with PUC requirements, we are hereby requesting retail water and/or wastewater service from your utility. If your utility is willing to provide water and/or wastewater service to the proposed 250 lot subdivision, please return a copy of this letter indicating your proposal, provide an estimate of capital costs as well as a copy of your Rate Order, a service request form, and specific requirements affecting scheduling and costs.

You may fax your response to 281-373-1113 or email it to syoung@waterengineers.com. Please feel free to call me at 281-373-0500 if you have any questions. Thank you for your assistance.

Sincerely,
WATERENGINEERS, INC.

Shelley Young, P.E.

cc: Crystal Springs Water Company, Inc.

REPLY

Date of Reply: 6/19/15

Name of Utility: AQUA TEXAS, INC.

Will you provide Retail Water Service? (Yes / No)

(If Yes, please provide a copy of your Rate Order)

Terms: _____

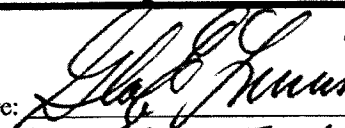
Signature: 

Printed Name: GLEN E. LEWIS

Title: AIR. OF CORPORATE DEV.

Address: 1106 CLAYTON LN, 400W

AUSTIN, TEXAS 78723

Telephone: 512/990-4400 EXT 56104

Email: _____

WATERENGINEERS, INC.

WATER & WASTEWATER TREATMENT CONSULTANTS

17230 HUFFMEISTER ROAD, SUITE A~CYPRESS, TEXAS 77429-1643

TEL: 281-373-0500 FAX: 281-373-1113

May 22, 2015

Mr. David Lee Sheffield CCN 11997
Texas Landing Utilities
P.O. Box 2110
Onalaska, TX 77360

Dear Sir.:

We are in the process of obtaining approval from the TCEQ for a proposed community public water system and a proposed community wastewater system and submitting an application to amend Water Certificate of Convenience and Necessity (CCN) No. 11373 and CCN No. 20782 with the Public Utility Commission of Texas (PUC) for Crystal Springs Water Company, Inc. The proposed new water and wastewater systems will serve the proposed new residential development off of Highway 105 between Old Highway 105 and S. Walker Road in Montgomery County, Texas, as shown on the attached map.

PUC rules require that we contact all existing CCN holders and Utility Districts within a two mile radius to determine if an existing utility is willing to provide retail water and/or wastewater service to the proposed development in a manner that is competitive with what can be provided by the new system.

In accordance with PUC requirements, we are hereby requesting retail water and/or wastewater service from your utility. If your utility is willing to provide water and/or wastewater service to the proposed 250 lot subdivision, please return a copy of this letter indicating your proposal, provide an estimate of capital costs as well as a copy of your Rate Order, a service request form, and specific requirements affecting scheduling and costs.

You may fax your response to 281-373-1113 or email it to syoung@waterengineers.com. Please feel free to call me at 281-373-0500 if you have any questions. Thank you for your assistance.

Sincerely,
WATERENGINEERS, INC.

Shelley Young, P.E.

cc: Crystal Springs Water Company, Inc.

REPLY

Date of Reply: 05-27-15

Name of Utility: Texas Landing Deerwood

Will you provide Retail Water Service? (Yes No)

(If Yes, please provide a copy of your Rate Order)

Terms: _____

Signature: 

Printed Name: KAREN MANN

Title: Authorized agent

Address: PO 2110

Onalaska TX 77360

Telephone: 9366466261

Email: KMANN@Eastex.net

34

WATERENGINEERS, INC.

WATER & WASTEWATER TREATMENT CONSULTANTS
17230 HUFFMEISTER ROAD, SUITE A-CYPRESS, TEXAS 77429-1643
TEL: 281-373-0500 FAX: 281-373-1113

May 22, 2015

Orchard Crossing CCN No. 12671
P.O. Box 279
New Waverly, TX 77358

Dear Sir/Ms.:

We are in the process of obtaining approval from the TCEQ for a proposed community public water system and a proposed community wastewater system and submitting an application to amend Water Certificate of Convenience and Necessity (CCN) No. 11373 and CCN No. 20782 with the Public Utility Commission of Texas (PUC) for Crystal Springs Water Company, Inc. The proposed new water and wastewater systems will serve the proposed new residential development off of Highway 105 between Old Highway 105 and S. Walker Road in Montgomery County, Texas, as shown on the attached map.

PUC rules require that we contact all existing CCN holders and Utility Districts within a two mile radius to determine if an existing utility is willing to provide retail water and/or wastewater service to the proposed development in a manner that is competitive with what can be provided by the new system.

In accordance with PUC requirements, we are hereby requesting retail water and/or wastewater service from your utility. If your utility is willing to provide water and/or wastewater service to the proposed 250 lot subdivision, please return a copy of this letter indicating your proposal, provide an estimate of capital costs as well as a copy of your Rate Order, a service request form, and specific requirements affecting scheduling and costs.

You may fax your response to 281-373-1113 or email it to syoung@waterengineers.com. Please feel free to call me at 281-373-0500 if you have any questions. Thank you for your assistance.

Sincerely,
WATERENGINEERS, INC.

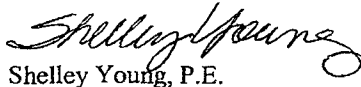
Shelley Young, P.E.

cc: Crystal Springs Water Company, Inc.

REPLY

Date of Reply: 6/2/15
Name of Utility: Orchard Crossing Utility
Will you provide Retail Water Service? (Yes No
(If Yes, please provide a copy of your Rate Order)
Terms: _____
Signature: 
Printed Name: Shannon Marsh
Title: operator
Address: P.O. Box 279
New Waverly, TX 77358
Telephone: 281-590-4359
Email: _____



WATERENGINEERS, INC.

WATER & WASTEWATER TREATMENT CONSULTANTS

17230 HUFFMEISTER ROAD, SUITE A~CYPRESS, TEXAS 77429-1643

TEL: 281-373-0500 FAX: 281-373-1113

May 22, 2015

Town of Cut and Shoot CCN No. 11615
P.O. Box 7364
Cut and Shoot, TX 77306

Dear Sir/Ms.:

We are in the process of obtaining approval from the TCEQ for a proposed community public water system and a proposed community wastewater system and submitting an application to amend Water Certificate of Convenience and Necessity (CCN) No. 11373 and CCN No. 20782 with the Public Utility Commission of Texas (PUC) for Crystal Springs Water Company, Inc. The proposed new water and wastewater systems will serve the proposed new residential development off of Highway 105 between Old Highway 105 and S. Walker Road in Montgomery County, Texas, as shown on the attached map.

PUC rules require that we contact all existing CCN holders and Utility Districts within a two mile radius to determine if an existing utility is willing to provide retail water and/or wastewater service to the proposed development in a manner that is competitive with what can be provided by the new system.

In accordance with PUC requirements, we are hereby requesting retail water and/or wastewater service from your utility. If your utility is willing to provide water and/or wastewater service to the proposed 250 lot subdivision, please return a copy of this letter indicating your proposal, provide an estimate of capital costs as well as a copy of your Rate Order, a service request form, and specific requirements affecting scheduling and costs.

You may fax your response to 281-373-1113 or email it to syoung@waterengineers.com. Please feel free to call me at 281-373-0500 if you have any questions. Thank you for your assistance.

Sincerely,
WATERENGINEERS, INC.

Shelley Young, P.E.

cc: Crystal Springs Water Company, Inc.

REPLY

Date of Reply: _____

Name of Utility: _____

Will you provide Retail Water Serv _____

(If Yes, please provide a copy of you _____

Terms: _____

Telephone: _____

Email: _____

NO REPLY RECEIVED

WATERENGINEERS, INC.

WATER & WASTEWATER TREATMENT CONSULTANTS

17230 HUFFMEISTER ROAD, SUITE A~CYPRESS, TEXAS 77429-1643

TEL: 281-373-0500 FAX: 281-373-1113

May 22, 2015

Highline Oaks Water Utility CCN No. 13006
c/o ES Water Utility Consolidators, Inc.
9132 White Oak Drive
Conroe, TX 77384

Dear Sir/Ms.:

We are in the process of obtaining approval from the TCEQ for a proposed community public water system and a proposed community wastewater system and submitting an application to amend Water Certificate of Convenience and Necessity (CCN) No. 11373 and CCN No. 20782 with the Public Utility Commission of Texas (PUC) for Crystal Springs Water Company, Inc. The proposed new water and wastewater systems will serve the proposed new residential development off of Highway 105 between Old Highway 105 and S. Walker Road in Montgomery County, Texas, as shown on the attached map.

PUC rules require that we contact all existing CCN holders and Utility Districts within a two mile radius to determine if an existing utility is willing to provide retail water and/or wastewater service to the proposed development in a manner that is competitive with what can be provided by the new system.

In accordance with PUC requirements, we are hereby requesting retail water and/or wastewater service from your utility. If your utility is willing to provide water and/or wastewater service to the proposed 250 lot subdivision, please return a copy of this letter indicating your proposal, provide an estimate of capital costs as well as a copy of your Rate Order, a service request form, and specific requirements affecting scheduling and costs.

You may fax your response to 281-373-1113 or email it to syoung@waterengineers.com. Please feel free to call me at 281-373-0500 if you have any questions. Thank you for your assistance.

Sincerely,
WATERENGINEERS, INC.

Shelley Young, P.E.

cc: Crystal Springs Water Company, Inc.

REPLY

Date of Reply: _____

Name of Utility: _____

Will you provide Retail Water Servi _____

(If Yes, please provide a copy of your _____ address: _____

Terms: _____

Telephone: _____

Email: _____

NO REPLY RECEIVED

WATERENGINEERS, INC.

WATER & WASTEWATER TREATMENT CONSULTANTS

17230 HUFFMEISTER ROAD, SUITE A-CYPRESS, TEXAS 77429-1643

TEL: 281-373-0500 FAX: 281-373-1113

May 22, 2015

C & R Water Supply, Inc. CCN No. 13098 and No. 20987
P.O. Box 187
Willis, TX 77378-0187

Dear Sir/Ms.:

We are in the process of obtaining approval from the TCEQ for a proposed community public water system and a proposed community wastewater system and submitting an application to amend Water Certificate of Convenience and Necessity (CCN) No. 11373 and CCN No. 20782 with the Public Utility Commission of Texas (PUC) for Crystal Springs Water Company, Inc. The proposed new water and wastewater systems will serve the proposed new residential development off of Highway 105 between Old Highway 105 and S. Walker Road in Montgomery County, Texas, as shown on the attached map.

PUC rules require that we contact all existing CCN holders and Utility Districts within a two mile radius to determine if an existing utility is willing to provide retail water and/or wastewater service to the proposed development in a manner that is competitive with what can be provided by the new system.

In accordance with PUC requirements, we are hereby requesting retail water and/or wastewater service from your utility. If your utility is willing to provide water and/or wastewater service to the proposed 250 lot subdivision, please return a copy of this letter indicating your proposal, provide an estimate of capital costs as well as a copy of your Rate Order, a service request form, and specific requirements affecting scheduling and costs.

You may fax your response to 281-373-1113 or email it to syoung@waterengineers.com. Please feel free to call me at 281-373-0500 if you have any questions. Thank you for your assistance.

Sincerely,
WATERENGINEERS, INC.

Shelley Young, P.E.

cc: Crystal Springs Water Company, Inc.

REPLY

Date of Reply: _____

Name of Utility: _____

Will you provide Retail Water Service _____

(If Yes, please provide a copy of your _____

Terms: _____

Telephone: _____

Email: _____

NO REPLY RECEIVED

380

WATERENGINEERS, INC.

WATER & WASTEWATER TREATMENT CONSULTANTS

17230 HUFFMEISTER ROAD, SUITE A-CYPRESS, TEXAS 77429-1643

TEL: 281-373-0500 FAX: 281-373-1113

May 18, 2016

Montgomery County
501 North Thompson, Suite 401
Conroe, TX 77301

Dear Sir/Ms.:

We are in the process of obtaining approval from the TCEQ for a proposed community public water system and a proposed community wastewater system and submitting an application to amend Water Certificate of Convenience and Necessity (CCN) No. 11373 and CCN No. 20782 with the Public Utility Commission of Texas (PUC) for Crystal Springs Water Company, Inc. The proposed new water and wastewater systems will serve the proposed new residential development off of Highway 105 between Old Highway 105 and S. Walker Road in Montgomery County, Texas, as shown on the attached map.

PUC rules require that we contact all existing CCN holders and Utility Districts within a two mile radius to determine if an existing utility is willing to provide retail water and/or wastewater service to the proposed development in a manner that is competitive with what can be provided by the new system.

In accordance with PUC requirements, we are hereby requesting retail water and/or wastewater service from your utility. If your utility is willing to provide water and/or wastewater service to the proposed 350 lot subdivision, please return a copy of this letter indicating your proposal, provide an estimate of capital costs as well as a copy of your Rate Order, a service request form, and specific requirements affecting scheduling and costs.

You may fax your response to 281-373-1113 or email it to syoung@waterengineers.com. Please feel free to call me at 281-373-0500 if you have any questions. Thank you for your assistance.

Sincerely,
WATERENGINEERS, INC.

Shelley Young, P.E.

cc: Crystal Springs Water Company, Inc.

REPLY

Date of Reply: _____ Sign: _____

Name of Utility: _____

Will you provide Retail Water Se _____

(If Yes, please provide a copy of y _____

Terms: _____

Telephone: _____

Email: _____

NO REPLY RECEIVED

WATERENGINEERS, INC.

WATER & WASTEWATER TREATMENT CONSULTANTS

17230 HUFFMEISTER ROAD, SUITE A~CYPRESS, TEXAS 77429-1643

TEL: 281-373-0500 FAX: 281-373-1113

May 18, 2016

Lone Star Groundwater Conservation District (District ID 5445500)
665 Conroe Park North Drive
Conroe, TX 77303

Dear Sir/Ms.:

We are in the process of obtaining approval from the TCEQ for a proposed community public water system and a proposed community wastewater system and submitting an application to amend Water Certificate of Convenience and Necessity (CCN) No. 11373 and CCN No. 20782 with the Public Utility Commission of Texas (PUC) for Crystal Springs Water Company, Inc. The proposed new water and wastewater systems will serve the proposed new residential development off of Highway 105 between Old Highway 105 and S. Walker Road in Montgomery County, Texas, as shown on the attached map.

PUC rules require that we contact all existing CCN holders and Utility Districts within a two mile radius to determine if an existing utility is willing to provide retail water and/or wastewater service to the proposed development in a manner that is competitive with what can be provided by the new system.

In accordance with PUC requirements, we are hereby requesting retail water and/or wastewater service from your utility. If your utility is willing to provide water and/or wastewater service to the proposed 350 lot subdivision, please return a copy of this letter indicating your proposal, provide an estimate of capital costs as well as a copy of your Rate Order, a service request form, and specific requirements affecting scheduling and costs.

You may fax your response to 281-373-1113 or email it to syoung@waterengineers.com. Please feel free to call me at 281-373-0500 if you have any questions. Thank you for your assistance.

Sincerely,
WATERENGINEERS, INC.

Shelley Young, P.E.

cc: Crystal Springs Water Company, Inc.

REPLY

Date of Reply: _____

Name of Utility: _____

Will you provide Retail Water Serv _____

(If Yes, please provide a copy of you _____

Terms: _____

Telephone: _____

Email: _____

NO REPLY RECEIVED

 **WATERENGINEERS, INC.**

WATER & WASTEWATER TREATMENT CONSULTANTS

17230 HUFFMEISTER ROAD, SUITE A~CYPRESS, TEXAS 77429-1643

TEL: 281-373-0500 FAX: 281-373-1113

May 18, 2016

San Jacinto River Authority (District ID 7490000)
1577 Dam Site Road
Conroe, TX 77304

Dear Sir/Ms.:

We are in the process of obtaining approval from the TCEQ for a proposed community public water system and a proposed community wastewater system and submitting an application to amend Water Certificate of Convenience and Necessity (CCN) No. 11373 and CCN No. 20782 with the Public Utility Commission of Texas (PUC) for Crystal Springs Water Company, Inc. The proposed new water and wastewater systems will serve the proposed new residential development off of Highway 105 between Old Highway 105 and S. Walker Road in Montgomery County, Texas, as shown on the attached map.

PUC rules require that we contact all existing CCN holders and Utility Districts within a two mile radius to determine if an existing utility is willing to provide retail water and/or wastewater service to the proposed development in a manner that is competitive with what can be provided by the new system.

In accordance with PUC requirements, we are hereby requesting retail water and/or wastewater service from your utility. If your utility is willing to provide water and/or wastewater service to the proposed 350 lot subdivision, please return a copy of this letter indicating your proposal, provide an estimate of capital costs as well as a copy of your Rate Order, a service request form, and specific requirements affecting scheduling and costs.

You may fax your response to 281-373-1113 or email it to syoung@waterengineers.com. Please feel free to call me at 281-373-0500 if you have any questions. Thank you for your assistance.

Sincerely,
WATERENGINEERS, INC.

Shelley Young, P.E.

cc: Crystal Springs Water Company, Inc.

REPLY

Date of Reply: _____ Signature: _____

Name of Utility: _____

Will you provide Retail Water Service _____
(If Yes, please provide a copy of your _____

Terms: _____

Telephone: _____

Email: _____

NO REPLY RECEIVED

 **WATERENGINEERS, INC.**

WATER & WASTEWATER TREATMENT CONSULTANTS

17230 HUFFMEISTER ROAD, SUITE A~CYPRESS, TEXAS 77429-1643

TEL: 281-373-0500 FAX: 281-373-1113

May 18, 2016

East Montgomery County Improvement District (District ID 2801500)
21575 U.S. Highway 59 North
New Caney, TX 77357-1019

Dear Sir/Ms.:

We are in the process of obtaining approval from the TCEQ for a proposed community public water system and a proposed community wastewater system and submitting an application to amend Water Certificate of Convenience and Necessity (CCN) No. 11373 and CCN No. 20782 with the Public Utility Commission of Texas (PUC) for Crystal Springs Water Company, Inc. The proposed new water and wastewater systems will serve the proposed new residential development off of Highway 105 between Old Highway 105 and S. Walker Road in Montgomery County, Texas, as shown on the attached map.

PUC rules require that we contact all existing CCN holders and Utility Districts within a two mile radius to determine if an existing utility is willing to provide retail water and/or wastewater service to the proposed development in a manner that is competitive with what can be provided by the new system.

In accordance with PUC requirements, we are hereby requesting retail water and/or wastewater service from your utility. If your utility is willing to provide water and/or wastewater service to the proposed 350 lot subdivision, please return a copy of this letter indicating your proposal, provide an estimate of capital costs as well as a copy of your Rate Order, a service request form, and specific requirements affecting scheduling and costs.

You may fax your response to 281-373-1113 or email it to syoung@waterengineers.com. Please feel free to call me at 281-373-0500 if you have any questions. Thank you for your assistance.

Sincerely,
WATERENGINEERS, INC.

Shelley Young, P.E.

cc: Crystal Springs Water Company, Inc.

REPLY

Date of Reply: _____ c: _____

Name of Utility: _____

Will you provide Retail Water Serv _____

(If Yes, please provide a copy of you _____

Terms: _____



Telephone: _____

Email: _____

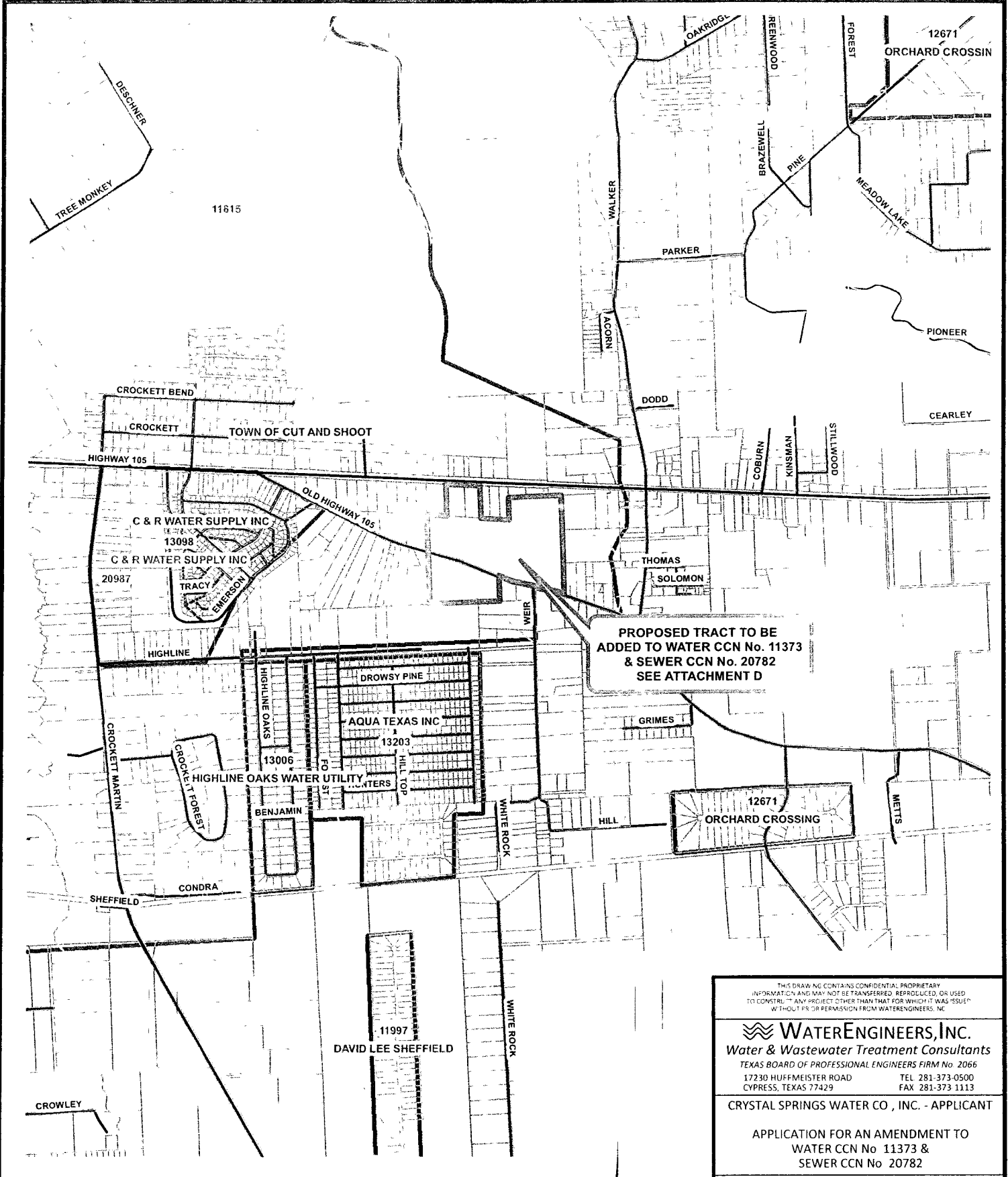
NO REPLY RECEIVED



PROPOSED TRACT TO BE
ADDED TO WATER CCN No. 11373
& SEWER CCN No. 20782
SEE ATTACHMENT D

- Legend**
-  Tract to be added
 -  Water CCN Utility
 -  Sewer CCN Utility

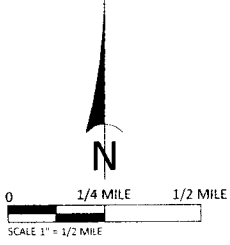

THIS DRAWING CONTAINS CONFIDENTIAL, PROPRIETARY INFORMATION AND MAY NOT BE TRANSFERRED, REPRODUCED, OR USED TO CONSTRUCT ANY PROJECT OTHER THAN THAT FOR WHICH IT WAS ISSUED WITHOUT THE WRITTEN PERMISSION FROM WATERENGINEERS, INC.

WaterENGINEERS, INC.
Water & Wastewater Treatment Consultants
 TEXAS BOARD OF PROFESSIONAL ENGINEERS FIRM No. 2066
 17230 HUFFMEISTER ROAD TEL 281-373-0500
 CYPRESS, TEXAS 77429 FAX 281-373-1113

CRYSTAL SPRINGS WATER CO, INC. - APPLICANT

APPLICATION FOR AN AMENDMENT TO
 WATER CCN No 11373 &
 SEWER CCN No 20782

LOCATION MAP	
DRAWN BY JLW	DWG NO
APPROVED BY DRV	ATTACHMENT C
SCALE AS NOTED	
DATE 5/22/2015	
JOB No 3813 451	

43

ATTACHMENT "G"

**PROOF OF WATER PLANS AND SPECIFICATIONS
SUBMITTAL
AND
PROOF OF TPDES APPLICATION**

CRYSTAL SPRINGS WATER CO., INC.

WATERENGINEERS, INC.

WATER & WASTEWATER TREATMENT CONSULTANTS

17230 HUFFMEISTER ROAD, SUITE A ~ CYPRESS, TEXAS 77429-1643

TEL: 281-373-0500 FAX: 281-373-1113

May 20, 2016

Ms. Vera Poe, P.E.
Texas Commission on Environmental Quality
Water Utilities Division
Plans Review & Rate Design Team MC 159
12100 Park 35 Circle, Building F
Austin, Texas 78753

Re: Martin Land Development, LLC - Ponderosa Pines Water System
Request for new Public Water System approval
Montgomery County, Texas

Dear Ms. Poe:

Please find herewith the engineering plans, specifications, and design report for the proposed Ponderosa Pines Water System.

1. Plan Review Submittal Form & Core Data Form
2. Engineering Design Report
3. Utility Correspondence with Service Area Map
4. Well Search
5. Cooling Velocity Calculations
6. Well Hydraulic Calculations
7. Deed and Draft Sanitary Control Easement
8. Business Plan, Financial Ability Form & Recent Financials
9. Technical Specifications
10. Engineering Design Drawings

Should you have questions or comments, please contact me by telephone at 281-373-0500 or by email at d.ray@waterengineers.com.

Sincerely,
WATER ENGINEERS, INC.

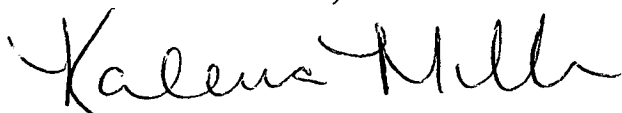

Kalena Miller, P.E.



D. Ray Young, P.E.
Principal Engineer

WATERENGINEERS, INC.
TBPE FIRM REGISTRATION No. 2066

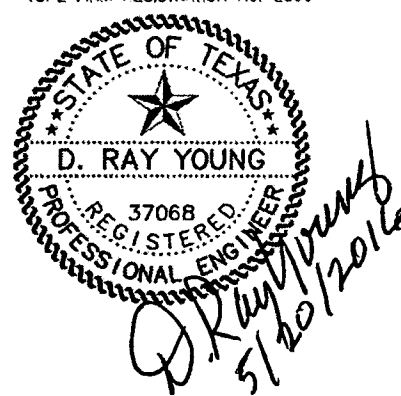

Enclosures: As Note Above

cc: Tom Martin via email to rebecca3@yahoo.com
Larry Purcell via email to lpwater2000@yahoo.com
TCEQ Region 12 via email to R12WQ@tceq.texas.gov



TPDES PERMIT NO. WQ0015349001
[For TCEQ office use only - EPA I.D.
No. TX0136263]

TEXAS COMMISSION ON ENVIRONMENTAL QUALITY
P.O. Box 13087
Austin, Texas 78711-3087

PERMIT TO DISCHARGE WASTES
under provisions of
Section 402 of the Clean Water Act
and Chapter 26 of the Texas Water Code

Crystal Springs Water Co., Inc.

whose mailing address is

P.O. Box 603
Porter, Texas 77365

is authorized to treat and discharge wastes from the Ponderosa Pines Subdivision Wastewater Treatment Facility, SIC Code 4952

located approximately 3.6 miles east of the Town of Cut and Shoot, 3,100 feet northwest of the intersection of Walker Road and Old Highway 105, and 2,000 feet west-southwest of the intersection of Walker Road and Highway 105, in Montgomery County, Texas 77306

to West Fork Spring Branch; thence to Spring Branch; thence to Caney Creek in Segment No. 1010 of the San Jacinto River Basin

only according to effluent limitations, monitoring requirements and other conditions set forth in this permit, as well as the rules of the Texas Commission on Environmental Quality (TCEQ), the laws of the State of Texas, and other orders of the TCEQ. The issuance of this permit does not grant to the permittee the right to use private or public property for conveyance of wastewater along the discharge route described in this permit. This includes, but is not limited to, property belonging to any individual, partnership, corporation, or other entity. Neither does this permit authorize any invasion of personal rights nor any violation of federal, state, or local laws or regulations. It is the responsibility of the permittee to acquire property rights as may be necessary to use the discharge route.

This permit shall expire at midnight, **June 1, 2018**.

ISSUED DATE: November 16, 2015

For the Commission

EFFLUENT LIMITATIONS AND MONITORING REQUIREMENTS

1. During the period beginning upon the date of issuance and lasting through the date of expiration the permittee is authorized to discharge subject to the following effluent limitations:

The daily average flow of effluent shall not exceed 0.075 million gallons per day (MGD), nor shall the average discharge during any two-hour period (2-hour peak) exceed 208 gallons per minute (gpm).

<u>Effluent Characteristic</u>	<u>Discharge Limitations</u>			<u>Min. Self-Monitoring Requirements</u>	
	Daily Avg mg/l (lbs/day)	7-day Avg mg/l	Daily Max mg/l	Report Daily Avg. & Max. Measurement Frequency	Single Grab Sample Type
Flow, MGD	Report 10 (6.2)	N/A	Report	Continuous	Totalizing Meter
Carbonaceous Biochemical Oxygen Demand (5-day)	15 (9.4)	25	40	One/week	Grab
Total Suspended Solids	3 (1.9)	6	10	One/week	Grab
Ammonia Nitrogen	63	N/A	N/A	One/quarter	Grab
<i>E. coli</i> , CFU or MPN/100 ml					

2. The effluent shall contain a chlorine residual of at least 1.0 mg/l and shall not exceed a chlorine residual of 4.0 mg/l after a detention time of at least 20 minutes (based on peak flow), and shall be monitored five times per week by grab sample. An equivalent method of disinfection may be substituted only with prior approval of the Executive Director.
3. The pH shall not be less than 6.0 standard units nor greater than 9.0 standard units and shall be monitored once per month by grab sample.
4. There shall be no discharge of floating solids or visible foam in other than trace amounts and no discharge of visible oil.
5. Effluent monitoring samples shall be taken at the following location(s): Following the final treatment unit.
6. The effluent shall contain a minimum dissolved oxygen of 6.0 mg/l and shall be monitored once per week by grab sample.

ATTACHMENT "H"

**OTHER SYSTEM MOST RECENT
INSPECTION REPORTS**

CRYSTAL SPRINGS WATER CO., INC.

Bryan W. Shaw, Ph.D., P.E., *Chairman*
Toby Baker, *Commissioner*
Richard A. Hyde, P.E., *Executive Director*



*Letter
FBI*

TEXAS COMMISSION ON ENVIRONMENTAL QUALITY

Protecting Texas by Reducing and Preventing Pollution

July 8, 2015

Mr. Tom A. Martin, President
Crystal Springs Water Company, Inc.
P.O. Box 603
Porter, Texas 77365-0603

Re: Notice of Compliance with Notice of Violation (NOV) dated January 14, 2015:
1485 Limited Crystal Springs Water Co., 2.5 miles west of Highway 59 on FM 1485,
New Caney, Montgomery County, Texas
Regulated Entity No.: 102682515
TCEQ ID No.: 1700580

Investigation No.: 1260992

Dear Mr. Martin:

On June 22, 2015, the Texas Commission on Environmental Quality (TCEQ) Houston Region Office received adequate compliance documentation to resolve the alleged violation documented during the investigation of the above-referenced regulated entity conducted on July 24, 2014. Based on the information submitted, no further action is required concerning this investigation.

The Texas Commission on Environmental Quality appreciates your assistance in this matter and your compliance efforts to ensure protection of the State's environment. If you or members of your staff have any questions, please feel free to contact Ms. Leticia DeLeon, in the Houston Region Office at (713) 767-3655.

Sincerely,

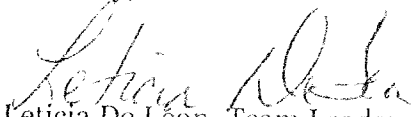
Leticia De León, Team Leader
Public Water Supply
Houston Region Office

LD/KB/mar

Enclosure: Summary of Investigation Findings

cc: Montgomery County Environmental Health Services