

## CMEC Communication Record

---

**Prepared by:** Christine Polito

**Date of Communication:** August 4, 2015

**Project Name & Client:** Brazos Electric, Oak Point

**Communication Method:** phone

**Contact Name:** John Spiars, Spiars Engineering

**Contact Information:**

The following is our understanding of the subject matter discussed during the referenced communication.

---

### **Summary of Communication:**

Mr. Spiars' client owns property (approximately 50 acres) at the southwest corner of US 380 and FM 720. He asked questions about the project including: project timeline, process, ROW width, how landowners can obtain more information, if any meetings are planned for the project, why the line is placed on the west side of FM 720 and not on the east in that location, and are there alternatives other than at the intersection of 720 and 380? He said that his clients indicated to him that they just found out about this project, and he asked why they are just being notified this late in the process.

I answered his questions, and referred him to Brazos Electric's website for additional information and maps. I let Mr. Spiars know there was a public meeting in May and that no additional meetings are planned at this time, but that he can view information from the meeting on the website. I also let him know that his clients are included on our landowner notification list as "720 & 380 LTD", and that they were sent notice of the public meeting in May, as well as sent a "sorry you could not attend the meeting" letter after the public meeting because the sign in sheets did not indicate their attendance.



## QUESTIONNAIRE

### OAK POINT TRANSMISSION LINE AND SUBSTATION PROJECT

Welcome and thank you for taking the time to attend this meeting. After you have visited the various display stations around the room and talked with the project planners, please fill out this questionnaire. Your responses will help us understand the community's concerns and aid the project team in the route selection process. Again, thank you for your time and interest!

1. In your opinion, has the need for the project been adequately explained?

Yes \_\_\_\_\_ No \_\_\_\_\_

If "no", how could we have improved this effort? What did you not understand?

2. Several factors are considered when routing a transmission line, including potential impacts to:

- Residences, businesses, schools, churches, hospitals, nursing homes;
- Cemeteries, parks, and/or recreational areas;
- Commercial radio transmitters, microwave relay stations and similar electronic installations;
- Airports, runways;
- Agricultural areas irrigated by traveling irrigation systems;
- Historical and archeological sites;
- Environmentally sensitive areas, endangered species; and
- Proximity to existing corridors.

- (A) Do you believe that all relevant factors are being considered?

Yes \_\_\_\_\_ No X \_\_\_\_\_

If "no", please describe which additional factors you would like to see addressed.

Substation + towers with power lines down Yacht Club Rd is totally unacceptable as it devalues our property in Oak Point which is known for its quality of life as a small town Country Place.

- (B) Are you aware of any features not depicted correctly or not shown on the maps? If so, please explain.

See item # 6

3. Which of the following applies to your situation?

- X Potential route is near my home  
\_\_\_\_\_ Potential route is near my business  
\_\_\_\_\_ Potential route crosses my land  
\_\_\_\_\_ Other (please describe)



4. Please provide the letter designating the route segment which affects or comes near your property.

KK

Do you live on this property?

Yes X No       

5. Please indicate your preferred end-to-end route utilizing the links identified on the maps.

R, W, BB with substation somewhere along  
BB perhaps near Lloyds Rd.

6. Please list any additional concerns or information here.

The map does not show what happens when the  
line gets to the substation. Does it end or will it  
be extended from there?

7. Please provide the following information (please print):

Name: Don + Peggy Stancil

Street Address: 710 Eagles Landing

City, State, Zip Code: Oak Point, Tx 75068

Phone: 540-353-6925

Email: stancils21@gmail.com

**THANK YOU FOR YOUR COMMENTS**

**PLEASE DROP THIS IN THE COMMENT BOX OR RETURN TO THE ADDRESS SHOWN BELOW WITHIN 7-10 DAYS.**

Please send it to:

Attn: Christine Polito  
Cox|McLain Environmental Consulting, Inc.  
600 E. John Carpenter Fwy, Suite 380  
Irving, Texas 75062  
christine@coxmcclain.com



## QUESTIONNAIRE

### OAK POINT TRANSMISSION LINE AND SUBSTATION PROJECT

Welcome and thank you for taking the time to attend this meeting. After you have visited the various display stations around the room and talked with the project planners, please fill out this questionnaire. Your responses will help us understand the community's concerns and aid the project team in the route selection process. Again, thank you for your time and interest!

1. In your opinion, has the need for the project been adequately explained?

Yes \_\_\_\_\_ No ☒

If "no", how could we have improved this effort? What did you not understand?

*See Attachment "A," #1.*

2. Several factors are considered when routing a transmission line, including potential impacts to:

- Residences, businesses, schools, churches, hospitals, nursing homes;
- Cemeteries, parks, and/or recreational areas;
- Commercial radio transmitters, microwave relay stations and similar electronic installations;
- Airports, runways;
- Agricultural areas irrigated by traveling irrigation systems;
- Historical and archeological sites;
- Environmentally sensitive areas, endangered species; and
- Proximity to existing corridors.

- (A) Do you believe that all relevant factors are being considered?

Yes \_\_\_\_\_ No ☒

If "no", please describe which additional factors you would like to see addressed.

*See Attachment "A," #2(A).*

- (B) Are you aware of any features not depicted correctly or not shown on the maps? If so, please explain.

*See Attachment "A," #2(B).*

*See also Attachment "B."*

3. Which of the following applies to your situation?

- ☒ Potential route is near my home  
☐ Potential route is near my business  
☒ Potential route crosses my land  
☐ Other (please describe)



4. Please provide the letter designating the route segment which affects or comes near your property.

LL

Do you live on this property?

Yes ☒ No ☐

5. Please indicate your preferred end-to-end route utilizing the links identified on the maps.

The shortest least expensive route:

Tap 1, A, G, I, K, L, P, S, U, X, Z, AA, CC, DD, Sub 1.

6. Please list any additional concerns or information here.

The property owners of Oak Point had a public meeting after which my property became an added route, but without any opportunity for a similar public meeting. That is an unfair treatment of, potentially damaged landowners.

7. Please provide the following information (please print):

Name: William Steding, PhD

Street Address: 1600 Historic Lane

City, State, Zip Code: Crossroads, TX 76227-2583

Phone: 214-244-5669

Email: william@steding.net

THANK YOU FOR YOUR COMMENTS

PLEASE DROP THIS IN THE COMMENT BOX OR RETURN TO THE ADDRESS SHOWN BELOW WITHIN 7-10 DAYS.

Please send it to:

Attn: Christine Polito  
Cox|McLain Environmental Consulting, Inc.  
600 E. John Carpenter Fwy, Suite 380  
Irving, Texas 75062  
christine@coxmcclain.com

## Attachment A

1. As a landowner whose property was added after the public meeting, which in and of itself is unfair, I have only had the opportunity to review the packet of documents sent that are inadequate in a number of areas. While the argument is made that growth in demand necessitates additional electrical capacity in the area, there is no justification of the size of facilities proposed. Why does this growth necessitate the transmission lines proposed? Moreover, there are no options presented, just the most intrusive, obstructive, and aesthetically displeasing option, which may be preferred by Brazos and CoServ to meet their own financial needs, but amounts to an extraction of wealth from the landowner by Brazos/CoServ, as well as an imposition of safety and health risks on the landowner. The burden is on you to treat landowners fairly by giving everyone the same access to information in a public forum and to justify every element of your proposal including how you will be compensating those damaged by the expansion of your business.
2. (A). Why are buried lines not being considered? Again, presenting only one option—138kV lines on 120' poles—only exacerbates distrust toward the big public utility appearing to attempt to run over landowners.
2. (B). Star Heliport (FAA Identifier 95TE) is mislocated on your map. It is .75 miles west on my property south of "LL." In addition, there is no "COLLECTOR ROAD" along "LL" as identified on your map. It simply does not exist. That is all private land, no road.



Attachment B

Federal Aviation Administration

December 17, 2002

800 Independence Avenue, S.W.  
Washington, D.C. 20591

William J. Steding  
1600 Historic Lane  
Aubrey, TX 76227

---

The National Flight Data Center has assigned/reassigned the location identifier for the following airport:  
Star Heliport

---

The new location identifier for the landing facility is 95TE

This action has taken place in response to:

- ☐ Landing facility changed from Public to Private Use
- ☐ Landing facility changed from Private to Public Use
- ☒ Establishment of a New Landing Facility
- ☐ Other (Assignment of identifier consistent with a private use landing facility)

The new or changed identifier will be effective 23 January 2003.

If you have any questions please call 1-866-295-8236 Ext. 79286.

## Christine Polito

---

**From:** Christine Polito  
**Sent:** Tuesday, June 23, 2015 2:21 PM  
**To:** 'william steding'  
**Subject:** RE: Oak Point Transmission Line and Substaton Project

Mr. Steding,

Thank you for sending this additional information. This is very helpful, and I think we should be able to locate it with this description as well as the coordinates you provided. I will be sure to let you know if there are any questions from our mapping team about the heliport location.

Thank you,

Christine

**From:** william steding [mailto:williamsteding@gmail.com]  
**Sent:** Tuesday, June 23, 2015 11:35 AM  
**To:** Christine Polito  
**Subject:** Re: Oak Point Transmission Line and Substaton Project

For further reference, if it is easier, the heliport is immediately to the northwest of the hangar, which is the large white square structure north of 1600 Historic Lane on your map. If you want me to mark it on a map, please send me one that you are using as a pdf and I can mark, scan, and return. Whatever is easiest.  
William Steding, PhD  
[william@steding.net](mailto:william@steding.net)

On Jun 23, 2015, at 11:21 AM, Christine Polito <[christine@coxmcclain.com](mailto:christine@coxmcclain.com)> wrote:

Mr. Steding,

Thank you for providing this information. We will update our constraints maps accordingly.

Have a good day,  
Christine

**From:** william steding [mailto:williamsteding@gmail.com]  
**Sent:** Tuesday, June 23, 2015 11:05 AM  
**To:** Christine Polito  
**Subject:** Re: Oak Point Transmission Line and Substaton Project

Christine:  
Yes, FAA databases are often, surprisingly, inaccurate. The Lat/Lon coordinates for the center of the landing zone at Star Heliport are: 33.13.4N and 96.59.46W, which is about .75 miles west of where you have it identified on your map. For some reason, the FAA dropped the "46" from



the west longitude, although they also note the coordinates as "estimates" in their database. Star Heliport was certified in 2002. I am the listed manager and owner, which is also in the database for Star Heliport (95TE) at 1600 Historic Lane, Cross Roads, TX. Please correct the error on your map.  
Thank you.

William Steding, PhD  
[william@steding.net](mailto:william@steding.net)

On Jun 23, 2015, at 10:36 AM, Christine Polito <[christine@coxmcclain.com](mailto:christine@coxmcclain.com)> wrote:

Mr. Steding,

The location we have shown for the Star Heliport was obtained from FAA databases. If you can provide us with more accurate location information, we would certainly appreciate it.

The removal of existing transmission lines is not planned as part of the proposed project.

Thank you,

Christine Polito  
Senior Ecologist  
Cox|McLain Environmental Consulting Inc.  
600 E John Carpenter Freeway, Suite 380  
Irving, Texas 75062  
[www.coxmcclain.com](http://www.coxmcclain.com)  
469.647.4866 (office)

The information contained in this email is confidential and may be legally privileged. It is intended solely for the addressee. If you are not the intended recipient, any disclosure, copying, distribution, or any action or act of forbearance taken in reliance on it, is prohibited and may be unlawful. Any views expressed in this email are those of the individual sender, except where the sender specifically states them to be the views of Cox|McLain Environmental Consulting, Inc.

**From:** william steding [<mailto:williamsteding@gmail.com>]  
**Sent:** Monday, June 22, 2015 12:58 PM  
**To:** [rchambers@brazoselectric.com](mailto:rchambers@brazoselectric.com)  
**Cc:** Christine Polito  
**Subject:** Oak Point Transmission Line and Substation Project

Mr. Chambers:

I have reviewed your letter and exhibits of 18 June 2015 and have one comment and one question. For your reference, my property is between Pottershop Road on the west, Naylor Road on the east, and Historic Lane on the south in Cross

Roads. The east-west portion of your proposed line designated as "LL" travels along my north border.

1. The location of Star Heliport is on my property, approximately .75 miles west/southwest of where it is located on your map. If you would like, I can send you more specific information, but it is quite a ways off on your map. (I'm not sure that matters to you.)
2. Will the existing transmission lines that travel from southwest to Northeast across the northern portion of my property be removed in any new installation of lines across my north property boundary?

William Steding, PhD  
[william@steding.net](mailto:william@steding.net)

## **Christine Polito**

---

**From:** william steding <williamsteding@gmail.com>  
**Sent:** Monday, June 29, 2015 9:49 AM  
**To:** Christine Polito  
**Subject:** Re: Oak Point Transmission Line and Substaton Project

**Follow Up Flag:** Follow up  
**Flag Status:** Completed

Thank you, Christine.  
William Steding, PhD  
[william@steding.net](mailto:william@steding.net)

On Jun 29, 2015, at 7:38 AM, Christine Polito <[christine@coxmcclain.com](mailto:christine@coxmcclain.com)> wrote:

Mr. Steding,

Thank you for the information. That road name came from the Denton County Appraisal District data (road name layer for the county). We have actually already verified that no such name exists in the field, and the name has been removed from our maps. Future maps will not show Collector Road.

Sincerely,

Christine

**From:** william steding [<mailto:williamsteding@gmail.com>]  
**Sent:** Friday, June 26, 2015 3:15 PM  
**To:** Christine Polito  
**Subject:** Re: Oak Point Transmission Line and Substaton Project

Christine:

One other correction. On the "LL" line you show "COLLECTOR RD" as an east-west road along which "LL" would run. This road does not exist today, nor has the Town of Crossroads even approached the landowners (of which I am one) about securing this land and right of way for a new road. I am not sure where you picked that up (perhaps in some future planning document from the Town?) but it is inaccurate and misleading to identify it as a road on your map.

William Steding, PhD  
[william@steding.net](mailto:william@steding.net)

On Jun 23, 2015, at 2:21 PM, Christine Polito <[christine@coxmcclain.com](mailto:christine@coxmcclain.com)> wrote:

Mr. Stedi



## QUESTIONNAIRE

### OAK POINT TRANSMISSION LINE AND SUBSTATION PROJECT

Welcome and thank you for taking the time to attend this meeting. After you have visited the various display stations around the room and talked with the project planners, please fill out this questionnaire. Your responses will help us understand the community's concerns and aid the project team in the route selection process. Again, thank you for your time and interest!

1. In your opinion, has the need for the project been adequately explained?

Yes ☒ No ☐

If "no", how could we have improved this effort? What did you not understand?

2. Several factors are considered when routing a transmission line, including potential impacts to:

- Residences, businesses, schools, churches, hospitals, nursing homes;
- Cemeteries, parks, and/or recreational areas;
- Commercial radio transmitters, microwave relay stations and similar electronic installations;
- Airports, runways;
- Agricultural areas irrigated by traveling irrigation systems;
- Historical and archeological sites;
- Environmentally sensitive areas, endangered species; and
- Proximity to existing corridors.

- (A) Do you believe that all relevant factors are being considered?

Yes ☐ No ☒

If "no", please describe which additional factors you would like to see addressed.

Please consider ~~property lines~~ using property lines without homes

- (B) Are you aware of any features not depicted correctly or not shown on the maps? If so, please explain.

N/A

3. Which of the following applies to your situation?

- ☐ Potential route is near my home  
☐ Potential route is near my business  
☐ Potential route crosses my land  
☒ Other (please describe)

Potential route will ~~be~~ border our property on two sides



4. Please provide the letter designating the route segment which affects or comes near your property.

D + H

Do you live on this property?

Yes ☒ No ☐

5. Please indicate your preferred end-to-end route utilizing the links identified on the maps.

~~None listed~~ ~~None listed~~ NONE LISTED!  
GO BACK TO THE DRAWING BOARD.

6. Please list any additional concerns or information here.

DECREASE IN PROPERTY VALUE

7. Please provide the following information (please print):

Name: EDDIE + LORI STEPHENS

Street Address: 9496 LIBERTY ROAD

City, State, Zip Code: AUBREY, TX 76227

Phone: 940 440-9002

Email: HAWSPB@SBCGLOBAL.NET

THANK YOU FOR YOUR COMMENTS

PLEASE DROP THIS IN THE COMMENT BOX OR RETURN TO THE ADDRESS SHOWN BELOW WITHIN 7-10 DAYS.

Please send it to:

Attn: Christine Polito  
Cox|McLain Environmental Consulting, Inc.  
600 E. John Carpenter Fwy, Suite 380  
Irving, Texas 75062  
christine@coxmcclain.com

## CMEC Communication Record

---

**Prepared by:** Christine Polito

**Date of Communication:** May 27, 2015

**Project Name & Client:** Brazos Electric, Oak Point

**Communication Method:** phone

**Contact Name:** Ted Stoinoff

**Contact Information:**

The following is our understanding of the subject matter discussed during the referenced communication.

---

### **Summary of Communication:**

Mr. Stoinoff is a lawyer, and his client owns a significant piece of property along FM 720 – the polo fields. Route segments JJ and KK both affect the property. He will attend the public meeting.

## CMEC Communication Record

---

**Prepared by:** Christine Polito

**Date of Communication:** May 29, 2015

**Project Name & Client:** Brazos Electric, Oak Point

**Communication Method:** phone

**Contact Name:** Ted Stoinoff

**Contact Information:**

The following is our understanding of the subject matter discussed during the referenced communication.

---

### **Summary of Communication:**

Mr. Stoinoff thanked me for my assistance at the public meeting and stated that the ROW agent he spoke with (Don McKelvain) was very helpful. He will fill out a questionnaire on behalf of his client. His client would have to move his polo fields in order to accommodate the proposed lines and the cost of that would exceed \$1 million. His client went through the same thing with TxDOT when they were widening FM 720, and ultimately TxDOT decided to revise the design so that the fields would not have to be moved. Moving the fields would put his client's land out of use for over two months while new fields are prepared. His client already has a plan in place to replace the tree line that TxDOT is taking out. The cost of the tree replacement is between \$150,000-200,000, and he is planning to start the planting in one month.



## **Christine Polito**

---

**From:** Stoinoff, Ted <tstoinoff@uplawtx.com>  
**Sent:** Friday, May 29, 2015 11:20 AM  
**To:** Christine Polito  
**Subject:** Oak Point Project [IWOV-LEGAL.FID519053]

Christine –

Once again – thank you for taking the time to talk to me about this project – my contact information is below.

For your file, my client is Kevin Mocarow and his property is 2700 FM 720, Oak Point, Texas – I believe that it was on map “29” when I was reviewing the right of way issues. We will put together our response to the questionnaire and include the cost associated with moving the 2 fields should same be necessary.

Ted

*P. Theodore Stoinoff, II*  
*Attorney*  
*Underwood Perkins, P.C.*  
5420 LBJ Freeway, Suite 1900  
Dallas, Texas 75240  
(972) 661-5114  
(972) 788-3352 eFax  
[www.uplawtx.com](http://www.uplawtx.com)

### **FIRM PRACTICE AREAS INCLUDE**

APPELLATE ~ BANKRUPTCY ~ BUSINESS LITIGATION ~ CIVIL LITIGATION ~ CORPORATE TRANSACTIONS ~ ELDER LAW  
EMPLOYEE BENEFITS ~ EMPLOYMENT ~ ESTATE PLANNING & PROBATE ~ FAMILY LAW ~ INTELLECTUAL PROPERTY  
MEDIA & ENTERTAINMENT ~ OIL & GAS ~ REAL ESTATE ~ TAX PLANNING & LITIGATION

This communication may be protected by the attorney/client privilege and may contain confidential information intended only for the person to whom it is addressed. If it has been sent to you in error, please reply to the sender that you have received the message in error then delete this message without copying or reading it.

## Christine Polito

---

**From:** Christine Polito  
**Sent:** Tuesday, June 02, 2015 10:11 AM  
**To:** 'Stoinoff, Ted'  
**Subject:** RE: Brazos Electric - Oak Point Questionnaire - Kevin Mokarow [IWOV-LEGAL.FID519053]

Ted,

Thank you for providing these comments. I will pass them along to Brazos.

Sincerely,

Christine Polito  
Senior Ecologist  
Cox|McLain Environmental Consulting Inc.  
600 E John Carpenter Freeway, Suite 380  
Irving, Texas 75062  
[www.coxmclain.com](http://www.coxmclain.com)  
469.647.4866 (office)

The information contained in this email is confidential and may be legally privileged. It is intended solely for the addressee. If you are not the intended recipient, any disclosure, copying, distribution, or any action or act of forbearance taken in reliance on it, is prohibited and may be unlawful. Any views expressed in this email are those of the individual sender, except where the sender specifically states them to be the views of Cox|McLain Environmental Consulting, Inc.

**From:** Stoinoff, Ted [mailto:tstoinoff@uplawtx.com]  
**Sent:** Tuesday, June 02, 2015 8:36 AM  
**To:** Christine Polito  
**Subject:** Brazos Electric - Oak Point Questionnaire - Kevin Mokarow [IWOV-LEGAL.FID519053]

Ms. Polito –

Attached please find the Oak Point Questionnaire on behalf of my client Kevin Mòkarow – 2700 FM 720, Oak Point, Texas.

Please let me know if you have any questions.

Thank you  
Ted

*P. Theodore Stoinoff, II*  
*Director-Attorney*  
*Underwood Perkins, P.C.*

5420 LBJ Freeway, Suite 1900  
Dallas, Texas 75240  
(972) 661-5114  
(972) 788-3352 eFax  
[www.uplawtx.com](http://www.uplawtx.com)

**FIRM PRACTICE AREAS INCLUDE**

**APPELLATE ~ BANKRUPTCY ~ BUSINESS LITIGATION ~ CIVIL LITIGATION ~ CORPORATE TRANSACTIONS ~ ELDER LAW  
EMPLOYEE BENEFITS ~ EMPLOYMENT ~ ESTATE PLANNING & PROBATE ~ FAMILY LAW ~ INTELLECTUAL PROPERTY  
MEDIA & ENTERTAINMENT ~ OIL & GAS ~ REAL ESTATE ~ TAX PLANNING & LITIGATION**

This communication may be protected by the attorney/client privilege and may contain confidential information intended only for the person to whom it is addressed. If it has been sent to you in error, please reply to the sender that you have received the message in error then delete this message without copying or reading it.

UNDERWOOD PERKINS, P.C.

Attorneys and Counselors at Law  
Two Lincoln Centre  
5420 LBJ Freeway, Suite 1900  
Dallas, Texas 75240  
www.uplawtx.com

From the Office of:  
P. Theodore Stoinoff, II

Telephone (972) 661-5114  
Facsimile (972) 661-5691  
tstoinoff@uplawtx.com

June 2, 2015

Christine Polito  
Cox|McLain Environmental Consulting, Inc.  
600 East John Carpenter Freeway, Suite 380  
Irving, Texas 75062

via email: Christine@coxmcclain.com  
and Regular Mail

Re: Our File No. M1545-0007; 2700 FM 720, Oak Point, Texas

Dear Ms. Polito:

Enclosed please find the Questionnaire and Addendum submitted on behalf of my client, Kevin Mekarow, for the property located at 2700 FM 720, Oak Point, Texas. Should you have any questions after you have had an opportunity to review same, please do not hesitate to contact me.

Additionally, if it would be helpful, my client would appreciate an opportunity to meet with both you and Brazos Electric Cooperative to discuss his concerns regarding Substation 4/Route JJ and the adverse impact it would have on his property.

Once again, thank you for taking your time to discuss this matter with me.

Sincerely,

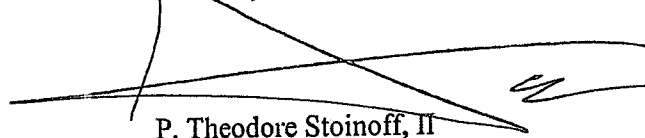

P. Theodore Stoinoff, II

PTSII/dm  
Enclosure



## QUESTIONNAIRE

### OAK POINT TRANSMISSION LINE AND SUBSTATION PROJECT

Welcome and thank you for taking the time to attend this meeting. After you have visited the various display stations around the room and talked with the project planners, please fill out this questionnaire. Your responses will help us understand the community's concerns and aid the project team in the route selection process. Again, thank you for your time and interest!

1. In your opinion, has the need for the project been adequately explained?

Yes ☒ No ☐

If "no", how could we have improved this effort? What did you not understand?

2. Several factors are considered when routing a transmission line, including potential impacts to:

- Residences, businesses, schools, churches, hospitals, nursing homes;
- Cemeteries, parks, and/or recreational areas;
- Commercial radio transmitters, microwave relay stations and similar electronic installations;
- Airports, runways;
- Agricultural areas irrigated by traveling irrigation systems;
- Historical and archeological sites;
- Environmentally sensitive areas, endangered species; and
- Proximity to existing corridors.

- (A) Do you believe that all relevant factors are being considered?

Yes ☐ No ☒

If "no", please describe which additional factors you would like to see addressed.

Please see attached.

- (B) Are you aware of any features not depicted correctly or not shown on the maps? If so, please explain.

Please see attached.

3. Which of the following applies to your situation?

- ☒ Potential route is near my home  
☐ Potential route is near my business  
☐ Potential route crosses my land  
☒ Other (please describe)

Please see attached



4. Please provide the letter designating the route segment which affects or comes near your property.

JJ

Do you live on this property?

Yes ☒ No ☐

5. Please indicate your preferred end-to-end route utilizing the links identified on the maps.

Please see attached

6. Please list any additional concerns or information here.

Please see attached

7. Please provide the following information (please print):

Name: Kevin Mekarow

Street Address: 2700 FM 720

City, State, Zip Code: Oak Point, Texas

Phone: \_\_\_\_\_

Email: Kevin@aperasolutions.com; Tstoinoff@uplawtx.com

**THANK YOU FOR YOUR COMMENTS**

**PLEASE DROP THIS IN THE COMMENT BOX OR RETURN TO THE ADDRESS SHOWN BELOW WITHIN 7-10 DAYS.**

Please send it to: Attn: Christine Polito  
Cox|McLain Environmental Consulting, Inc.  
600 E. John Carpenter Fwy, Suite 380  
Irving, Texas 75062  
christine@coxmcclain.com

## Oak Point Questionnaire

### Attachment

2.(A) The property is also utilized for the following:

1. Hosting of multiple charity polo matches and youth lacrosse events throughout the year.
2. Hosting of other charity events throughout the year.

2.(B) The properties polo fields (see below).

3. Residence on the property. The property also consists of horse stables, in which 40 horses are maintained. Along with the permanent structures, the property includes two professionally maintained polo fields (100 yards x 300 yards) which are used to host (i) multiple charity polo matches throughout the year, (ii) numerous youth lacrosse events throughout the year and (iii) other charity events throughout the year.

5. **OPPOSE THE CONSTRUCTION OF SUBSTATION 4.** Proposed Substations 1, 2 and 3 are north of the property, and as such, do not interfere with the continued use and enjoyment of the property. If Substation 4 is an option, object to Route JJ, and would suggest the use of Route KK. Should Substation 4 be an option - **please see concerns regarding Substation 4 and Route JJ below (§6).**

6. The possible construction of Substation 4, as well as Route JJ, raises the following concerns:

1. Interference with Current Use of Property.

a. It was learned during the 05/28/2015 meeting that the JJ transmission lines would be on the property and would require a right-of-way and/or taking. As outlined above, this portion of the property currently includes two professionally maintained polo fields. Construction of the proposed single-pole structures on the property would create a significant danger to both the participants and the horses. The proposed single-pole construction would be within approximately 10 to 15 feet of the polo fields which require adequate area outside the boundaries for both the horses and riders to exit the field of play. The 35-foot right-of-way from the centerline would also extend on to the polo fields. As a result, for safety reasons, the two fields would have to be moved and suitable replacements would have to be rented for two years, all at an approximate cost of \$1.2 - \$1.5 million.

(1) Cost to Move Two Polo Fields.

(a) \$300,000.00 per field for dirt work.

(b) \$75,000.00 per field for two inches of sand.

(c) \$50,000.00 per field for labor.

(d) \$60,000.00 per field for installation of Tiff 319 grass.

(e) \$50,000.00 per field to move western berms.

(f) \$10,000.00 per field to rebuild the seating on western berms.

(g) \$2,500.00 per field to reseed western berms.

(2) Loss of Use for Two Years: Required to rent two fields for 7 months of each year - \$2,500.00 per month per field.

b. Additionally, a portion of the property has already been taken by TXDOT in order to enlarge FM 720 (specifically, 87,098 square feet at the west side of FM 720). As a result, plans have already been developed to construct a berm on the east property line in order to provide a natural buffer from the expanded FM 720 (at a cost of \$100,000.00). Moreover, a line of youpon holly trees will be planted along the eastern berm (at a cost of \$150,000.00). All of this would have to be replaced, at a cost of approximately \$250,000.00, if Route JJ is used.

2. Property Value:

a. Would directly lower the value of the property due to valid health concerns and aesthetic issues. The property in the future may be developed into single family residences and the proximity of the proposed transmission lines would lessen the property value.

b. Would indirectly lower the property value, in that the residential community directly east of Route JJ would also lower in value, thereby reducing the desirability and value of the property at issue. Additionally, the proximity of the proposed lines to any



existing schools and/or proposed schools (specifically, the northwest corner of McCormick and FM 720) would lower the overall desirability of the neighborhood in that any school age child would be required to attend those schools in question.

3. Potential construction and repair issue - As outlined above, the property currently includes two professionally maintained polo fields which host multiple charity polo matches, youth lacrosse events and other charity events throughout the year. Any construction and/or repair to the proposed transmission lines would adversely affect various events scheduled throughout the year.

4. Safety - Would be required to drive under the transmission lines to enter and exit the property.

5. Other than Route JJ, the other proposed transmission lines avoid the various residential communities north of the property in question. Based upon Brazos Electric's concerted effort to avoid those residential communities north of the property at issue, it is only reasonable and just that the property at issue (which may be developed into single family residences in the future) and the residential community located directly east of Route JJ also be avoided.

6. Cost - Substation 4 could potentially increase the cost of electricity for all those north of Substation 4 due to the cost associated with the added length of transmission (versus Substations 1, 2 and 3).

UNDERWOOD PERKINS, P.C.

Attorneys and Counselors at Law  
Two Lincoln Centre  
5420 LBJ Freeway, Suite 1900  
Dallas, Texas 75240  
www.uplawtx.com

From the Office of:  
P. Theodore Stoinoff, II

Telephone (972) 661-5114  
Facsimile (972) 661-5691  
tstoinoff@uplawtx.com

June 2, 2015

Richard Chambers  
Brazos Electric Power Cooperative, Inc.  
P.O. Box 2585  
Waco, Texas 76702-2585

Re: Our File No. M1545-0007; 2700 FM 720, Oak Point, Texas

Dear Mr. Chambers:

Enclosed please find the Questionnaire and Addendum submitted on behalf of my client, Kevin Mokarow, for the property located at 2700 FM 720, Oak Point, Texas. Should you have any questions after you have had an opportunity to review same, please do not hesitate to contact me.

Additionally, if it would be helpful, my client would appreciate an opportunity to meet with both you and Christine Polito of Cox|McLain Environmental Consulting, Inc. to discuss his concerns regarding Substation 4/Route JJ and the adverse impact it would have on his property.

Sincerely,

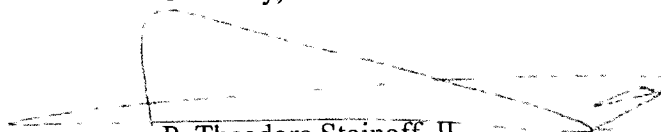

P. Theodore Stoinoff, II

PTSII/dm  
Enclosure



## QUESTIONNAIRE

### OAK POINT TRANSMISSION LINE AND SUBSTATION PROJECT

Welcome and thank you for taking the time to attend this meeting. After you have visited the various display stations around the room and talked with the project planners, please fill out this questionnaire. Your responses will help us understand the community's concerns and aid the project team in the route selection process. Again, thank you for your time and interest!

1. In your opinion, has the need for the project been adequately explained?

Yes ☒ No ☐

If "no", how could we have improved this effort? What did you not understand?

2. Several factors are considered when routing a transmission line, including potential impacts to:

- Residences, businesses, schools, churches, hospitals, nursing homes;
- Cemeteries, parks, and/or recreational areas;
- Commercial radio transmitters, microwave relay stations and similar electronic installations;
- Airports, runways;
- Agricultural areas irrigated by traveling irrigation systems;
- Historical and archeological sites;
- Environmentally sensitive areas, endangered species; and
- Proximity to existing corridors.

- (A) Do you believe that all relevant factors are being considered?

Yes ☐ No ☒

If "no", please describe which additional factors you would like to see addressed.

Please see attached.

- (B) Are you aware of any features not depicted correctly or not shown on the maps? If so, please explain.

Please see attached.

3. Which of the following applies to your situation?

- ☒ Potential route is near my home  
☐ Potential route is near my business  
☐ Potential route crosses my land  
☒ Other (please describe)

Please see attached



4. Please provide the letter designating the route segment which affects or comes near your property.  
JJ

Do you live on this property?

Yes ☒ No ☐

5. Please indicate your preferred end-to-end route utilizing the links identified on the maps.  
Please see attached

6. Please list any additional concerns or information here.  
Please see attached

7. Please provide the following information (please print):

Name: Kevin Mocarow

Street Address: 2700 FM 720

City, State, Zip Code: Oak Point, Texas

Phone: \_\_\_\_\_

Email: Kevin@aperasolutions.com; Tstoinoff@uplawtx.com

**THANK YOU FOR YOUR COMMENTS**

**PLEASE DROP THIS IN THE COMMENT BOX OR RETURN TO THE ADDRESS SHOWN BELOW WITHIN 7-10 DAYS.**

Please send it to: Attn: Christine Polito  
Cox|McLain Environmental Consulting, Inc.  
600 E. John Carpenter Fwy, Suite 380  
Irving, Texas 75062  
christine@coxmcclain.com

## Oak Point Questionnaire

### Attachment

2.(A) The property is also utilized for the following:

1. Hosting of multiple charity polo matches and youth lacrosse events throughout the year.

2. Hosting of other charity events throughout the year.

2.(B) The properties polo fields (see below).

3. Residence on the property. The property also consists of horse stables, in which 40 horses are maintained. Along with the permanent structures, the property includes two professionally maintained polo fields (100 yards x 300 yards) which are used to host (i) multiple charity polo matches throughout the year, (ii) numerous youth lacrosse events throughout the year and (iii) other charity events throughout the year.

5. **OPPOSE THE CONSTRUCTION OF SUBSTATION 4.** Proposed Substations 1, 2 and 3 are north of the property, and as such, do not interfere with the continued use and enjoyment of the property. If Substation 4 is an option, object to Route JJ, and would suggest the use of Route KK. Should Substation 4 be an option - **please see concerns regarding Substation 4 and Route JJ below ¶6).**

6. The possible construction of Substation 4, as well as Route JJ, raises the following concerns:

1. Interference with Current Use of Property.

a. It was learned during the 05/28/2015 meeting that the JJ transmission lines would be on the property and would require a right-of-way and/or taking. As outlined above, this portion of the property currently includes two professionally maintained polo fields. Construction of the proposed single-pole structures on the property would create a significant danger to both the participants and the horses. The proposed single-pole construction would be within approximately 10 to 15 feet of the polo fields which require adequate area outside the boundaries for both the horses and riders to exit the field of play. The 35-foot right-of-way from the centerline would also extend on to the polo fields. As a result, for safety reasons, the two fields would have to be moved and suitable replacements would have to be rented for two years, all at an approximate cost of \$1.2 - \$1.5 million.

(1) Cost to Move Two Polo Fields.

(a) \$300,000.00 per field for dirt work.

(b) \$75,000.00 per field for two inches of sand.

(c) \$50,000.00 per field for labor.

(d) \$60,000.00 per field for installation of Tiff 319 grass.

(e) \$50,000.00 per field to move western berms.

(f) \$10,000.00 per field to rebuild the seating on western berms.

(g) \$2,500.00 per field to reseed western berms.

(2) Loss of Use for Two Years: Required to rent two fields for 7 months of each year - \$2,500.00 per month per field.

b. Additionally, a portion of the property has already been taken by TXDOT in order to enlarge FM 720 (specifically, 87,098 square feet at the west side of FM 720). As a result, plans have already been developed to construct a berm on the east property line in order to provide a natural buffer from the expanded FM 720 (at a cost of \$100,000.00). Moreover, a line of youpon holly trees will be planted along the eastern berm (at a cost of \$150,000.00). All of this would have to be replaced, at a cost of approximately \$250,000.00, if Route JJ is used.

2. Property Value:

a. Would directly lower the value of the property due to valid health concerns and aesthetic issues. The property in the future may be developed into single family residences and the proximity of the proposed transmission lines would lessen the property value.

b. Would indirectly lower the property value, in that the residential community directly east of Route JJ would also lower in value, thereby reducing the desirability and value of the property at issue. Additionally, the proximity of the proposed lines to any

existing schools and/or proposed schools (specifically, the northwest corner of McCormick and FM 720) would lower the overall desirability of the neighborhood in that any school age child would be required to attend those schools in question.

3. Potential construction and repair issue - As outlined above, the property currently includes two professionally maintained polo fields which host multiple charity polo matches, youth lacrosse events and other charity events throughout the year. Any construction and/or repair to the proposed transmission lines would adversely affect various events scheduled throughout the year.

4. Safety - Would be required to drive under the transmission lines to enter and exit the property.

5. Other than Route JJ, the other proposed transmission lines avoid the various residential communities north of the property in question. Based upon Brazos Electric's concerted effort to avoid those residential communities north of the property at issue, it is only reasonable and just that the property at issue (which may be developed into single family residences in the future) and the residential community located directly east of Route JJ also be avoided.

6. Cost - Substation 4 could potentially increase the cost of electricity for all those north of Substation 4 due to the cost associated with the added length of transmission (versus Substations 1, 2 and 3).

UNDERWOOD PERKINS, P.C.

Attorneys and Counselors at Law  
Two Lincoln Centre  
5420 LBJ Freeway, Suite 1900  
Dallas, Texas 75240  
www.uplawtx.com

From the Office of:  
P. Theodore Stoinoff, II

Telephone (972) 661-5114  
Facsimile (972) 661-5691  
tstoinoff@uplawtx.com

June 2, 2015

Christine Polito  
Cox|McLain Environmental Consulting, Inc.  
600 East John Carpenter Freeway, Suite 380  
Irving, Texas 75062

via email: Christine@coxmcclain.com  
and Regular Mail

Re: Our File No. M1545-0007; 2700 FM 720, Oak Point, Texas

Dear Ms. Polito:

Enclosed please find the Questionnaire and Addendum submitted on behalf of my client, Kevin Mokarow, for the property located at 2700 FM 720, Oak Point, Texas. Should you have any questions after you have had an opportunity to review same, please do not hesitate to contact me.

Additionally, if it would be helpful, my client would appreciate an opportunity to meet with both you and Brazos Electric Cooperative to discuss his concerns regarding Substation 4/Route JJ and the adverse impact it would have on his property.

Once again, thank you for taking your time to discuss this matter with me.

Sincerely,

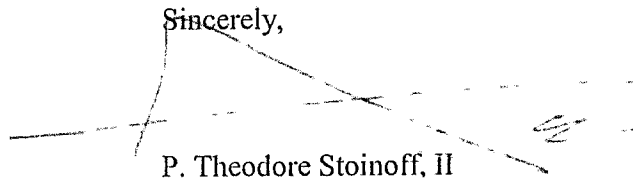

P. Theodore Stoinoff, II

PTSII/dm  
Enclosure





## QUESTIONNAIRE

### OAK POINT TRANSMISSION LINE AND SUBSTATION PROJECT

Welcome and thank you for taking the time to attend this meeting. After you have visited the various display stations around the room and talked with the project planners, please fill out this questionnaire. Your responses will help us understand the community's concerns and aid the project team in the route selection process. Again, thank you for your time and interest!

1. In your opinion, has the need for the project been adequately explained?

Yes X No \_\_\_\_\_

If "no", how could we have improved this effort? What did you not understand?

2. Several factors are considered when routing a transmission line, including potential impacts to:

- Residences, businesses, schools, churches, hospitals, nursing homes;
- Cemeteries, parks, and/or recreational areas;
- Commercial radio transmitters, microwave relay stations and similar electronic installations;
- Airports, runways;
- Agricultural areas irrigated by traveling irrigation systems;
- Historical and archeological sites;
- Environmentally sensitive areas, endangered species; and
- Proximity to existing corridors.

- (A) Do you believe that all relevant factors are being considered?

Yes \_\_\_\_\_ No X

If "no", please describe which additional factors you would like to see addressed.

Please see attached.

- (B) Are you aware of any features not depicted correctly or not shown on the maps? If so, please explain.

Please see attached.

3. Which of the following applies to your situation?

- X Potential route is near my home  
\_\_\_\_\_ Potential route is near my business  
\_\_\_\_\_ Potential route crosses my land  
X Other (please describe)

Please see attached



4. Please provide the letter designating the route segment which affects or comes near your property.  
JJ

Do you live on this property?

Yes ☒ No ☐

5. Please indicate your preferred end-to-end route utilizing the links identified on the maps.  
Please see attached

6. Please list any additional concerns or information here.  
Please see attached

7. Please provide the following information (please print):

Name: Kevin Mekarow

Street Address: 2700 FM 720

City, State, Zip Code: Oak Point, Texas

Phone: \_\_\_\_\_

Email: Kevin@aperasolutions.com; Tstoinoff@uplawtx.com

**THANK YOU FOR YOUR COMMENTS**

**PLEASE DROP THIS IN THE COMMENT BOX OR RETURN TO THE ADDRESS SHOWN BELOW WITHIN 7-10 DAYS.**

Please send it to: Attn: Christine Polito  
Cox|McLain Environmental Consulting, Inc.  
600 E. John Carpenter Fwy, Suite 380  
Irving, Texas 75062  
christine@coxmcclain.com

## Oak Point Questionnaire

### Attachment

2.(A) The property is also utilized for the following:

1. Hosting of multiple charity polo matches and youth lacrosse events throughout the year.
2. Hosting of other charity events throughout the year.

2.(B) The properties polo fields (see below).

3. Residence on the property. The property also consists of horse stables, in which 40 horses are maintained. Along with the permanent structures, the property includes two professionally maintained polo fields (100 yards x 300 yards) which are used to host (i) multiple charity polo matches throughout the year, (ii) numerous youth lacrosse events throughout the year and (iii) other charity events throughout the year.

5. **OPPOSE THE CONSTRUCTION OF SUBSTATION 4.** Proposed Substations 1, 2 and 3 are north of the property, and as such, do not interfere with the continued use and enjoyment of the property. If Substation 4 is an option, object to Route JJ, and would suggest the use of Route KK. Should Substation 4 be an option - **please see concerns regarding Substation 4 and Route JJ below (¶6).**

6. The possible construction of Substation 4, as well as Route JJ, raises the following concerns:

1. Interference with Current Use of Property.

a. It was learned during the 05/28/2015 meeting that the JJ transmission lines would be on the property and would require a right-of-way and/or taking. As outlined above, this portion of the property currently includes two professionally maintained polo fields. Construction of the proposed single-pole structures on the property would create a significant danger to both the participants and the horses. The proposed single-pole construction would be within approximately 10 to 15 feet of the polo fields which require adequate area outside the boundaries for both the horses and riders to exit the field of play. The 35-foot right-of-way from the centerline would also extend on to the polo fields. As a result, for safety reasons, the two fields would have to be moved and suitable replacements would have to be rented for two years, all at an approximate cost of \$1.2 - \$1.5 million.

(1) Cost to Move Two Polo Fields.

(a) \$300,000.00 per field for dirt work.

(b) \$75,000.00 per field for two inches of sand.

(c) \$50,000.00 per field for labor.

(d) \$60,000.00 per field for installation of Tiff 319 grass.

(e) \$50,000.00 per field to move western berms.

(f) \$10,000.00 per field to rebuild the seating on western berms.

(g) \$2,500.00 per field to reseed western berms.

(2) Loss of Use for Two Years: Required to rent two fields for 7 months of each year - \$2,500.00 per month per field.

b. Additionally, a portion of the property has already been taken by TXDOT in order to enlarge FM 720 (specifically, 87,098 square feet at the west side of FM 720). As a result, plans have already been developed to construct a berm on the east property line in order to provide a natural buffer from the expanded FM 720 (at a cost of \$100,000.00). Moreover, a line of youpon holly trees will be planted along the eastern berm (at a cost of \$150,000.00). All of this would have to be replaced, at a cost of approximately \$250,000.00, if Route JJ is used.

2. Property Value:

a. Would directly lower the value of the property due to valid health concerns and aesthetic issues. The property in the future may be developed into single family residences and the proximity of the proposed transmission lines would lessen the property value.

b. Would indirectly lower the property value, in that the residential community directly east of Route JJ would also lower in value, thereby reducing the desirability and value of the property at issue. Additionally, the proximity of the proposed lines to any

existing schools and/or proposed schools (specifically, the northwest corner of McCormick and FM 720) would lower the overall desirability of the neighborhood in that any school age child would be required to attend those schools in question.

3. Potential construction and repair issue - As outlined above, the property currently includes two professionally maintained polo fields which host multiple charity polo matches, youth lacrosse events and other charity events throughout the year. Any construction and/or repair to the proposed transmission lines would adversely affect various events scheduled throughout the year.

4. Safety - Would be required to drive under the transmission lines to enter and exit the property.

5. Other than Route JJ, the other proposed transmission lines avoid the various residential communities north of the property in question. Based upon Brazos Electric's concerted effort to avoid those residential communities north of the property at issue, it is only reasonable and just that the property at issue (which may be developed into single family residences in the future) and the residential community located directly east of Route JJ also be avoided.

6. Cost - Substation 4 could potentially increase the cost of electricity for all those north of Substation 4 due to the cost associated with the added length of transmission (versus Substations 1, 2 and 3).



## QUESTIONNAIRE

### OAK POINT TRANSMISSION LINE AND SUBSTATION PROJECT

Welcome and thank you for taking the time to attend this meeting. After you have visited the various display stations around the room and talked with the project planners, please fill out this questionnaire. Your responses will help us understand the community's concerns and aid the project team in the route selection process. Again, thank you for your time and interest!

1. In your opinion, has the need for the project been adequately explained?

Yes ☒ No ☐

If "no", how could we have improved this effort? What did you not understand?

*However, the need for the particular implementation*

2. Several factors are considered when routing a transmission line, including potential impacts to: *has not*

- Residences, businesses, schools, churches, hospitals, nursing homes;
- Cemeteries, parks, and/or recreational areas;
- Commercial radio transmitters, microwave relay stations and similar electronic installations;
- Airports, runways;
- Agricultural areas irrigated by traveling irrigation systems;
- Historical and archeological sites;
- Environmentally sensitive areas, endangered species; and
- Proximity to existing corridors.

- (A) Do you believe that all relevant factors are being considered?

Yes ☐ No ☒

If "no", please describe which additional factors you would like to see addressed.

*People live in Oak Point to enjoy a rural environment. This project damages this environment. This impact should be considered as a high priority.*

- (B) Are you aware of any features not depicted correctly or not shown on the maps? If so, please explain.

3. Which of the following applies to your situation?

- ☐ Potential route is near my home  
☐ Potential route is near my business  
☐ Potential route crosses my land  
☒ Other (please describe)

*Potential route destroys my enjoyment of my town.*



4. Please provide the letter designating the route segment which affects or comes near your property.

KK

Do you live on this property?

Yes ☒ No ☐

5. Please indicate your preferred end-to-end route utilizing the links identified on the maps.

None of them. I'd like to see a route to the northeast, with the substation not on 720.

6. Please list any additional concerns or information here.

It feels as if this process is just a formality - decisions have already largely been made.

If you want to consider yourselves as a partner with the community, and not just an exploiter of it, please consider the non-tangible aspects of your decisions.

Leave us a town we can enjoy.

7. Please provide the following information (please print):

Name: Dave Thuse

Street Address: 1007 Fox Hollow Ln

City, State, Zip Code: Oak Point 75068 TX

Phone: 214 233 6543

Email: dave@thomases.com

THANK YOU FOR YOUR COMMENTS

PLEASE DROP THIS IN THE COMMENT BOX OR RETURN TO THE ADDRESS SHOWN BELOW WITHIN 7-10 DAYS.

Please send it to:

Attn: Christine Polito  
Cox|McLain Environmental Consulting, Inc.  
600 E. John Carpenter Fwy, Suite 380  
Irving, Texas 75062  
christine@coxmcclain.com



## QUESTIONNAIRE

### OAK POINT TRANSMISSION LINE AND SUBSTATION PROJECT

Welcome and thank you for taking the time to attend this meeting. After you have visited the various display stations around the room and talked with the project planners, please fill out this questionnaire. Your responses will help us understand the community's concerns and aid the project team in the route selection process. Again, thank you for your time and interest!

1. In your opinion, has the need for the project been adequately explained?

Yes \_\_\_\_\_ No X

If "no", how could we have improved this effort? What did you not understand?

Never heard anything about it, no meetings, no nothing!

2. Several factors are considered when routing a transmission line, including potential impacts to:

- Residences, businesses, schools, churches, hospitals, nursing homes;
- Cemeteries, parks, and/or recreational areas;
- Commercial radio transmitters, microwave relay stations and similar electronic installations;
- Airports, runways;
- Agricultural areas irrigated by traveling irrigation systems;
- Historical and archeological sites;
- Environmentally sensitive areas, endangered species; and
- Proximity to existing corridors.

- (A) Do you believe that all relevant factors are being considered?

Yes \_\_\_\_\_ No X

If "no", please describe which additional factors you would like to see addressed.

The planned lines go across better properties that have been there for years. There is no growth in these areas. The lines from the taps are for growth in Oak Point. Therefore, the new lines should go through growth areas. Specifically,

- (B) Are you aware of any features not depicted correctly or not shown on the maps? If so, please explain.

from Tap 4 to PE R on the Green line!

3. Which of the following applies to your situation?

- X Potential route is near my home  
\_\_\_\_ Potential route is near my business  
\_\_\_\_ Potential route crosses my land  
\_\_\_\_ Other (please describe)





4. Please provide the letter designating the route segment which affects or comes near your property.

K, H, M

Do you live on this property?

Yes ☒ No ☐

5. Please indicate your preferred end-to-end route utilizing the links identified on the maps.

None! I don't like the link that should be considered.

6. Please list any additional concerns or information here.

Growth is for out front & the suburbs moving north. Power lines should go through these suburbs, not areas that have been zoned for actual growth!

7. Please provide the following information (please print):

Name: Harry B. Tipton

Street Address: 2433 Dr. Sander Road

City, State, Zip Code: Aubrey, TX 76227

Phone: 469 387 5667

Email: hbtipton@yahoo.com





**THANK YOU FOR YOUR COMMENTS**

**PLEASE DROP THIS IN THE COMMENT BOX OR RETURN TO THE ADDRESS SHOWN BELOW WITHIN 7-10 DAYS.**

Please send it to:

Attn: Christine Polito  
Cox|McLain Environmental Consulting, Inc.  
600 E. John Carpenter Fwy, Suite 380  
Irving, Texas 75062  
christine@coxmcclain.com



-  Route Segments
-  Existing Transmission Lines
-  Proposed Tap Sites
-  Proposed Substations

# **BRAZOS ELECTRIC COOPERATIVE** **OAK POINT TRANSMISSION LINE AND SUBSTATION PROJECT** TRANSMISSION LINE ALTERNATIVE SEGMENTS

ALL SUBSTITUTES, TAPS, AND ROUTE SEGMENTS SHOWN ARE PRELIMINARY AND SUBJECT TO CHANGE

## Christine Polito

---

**From:** Christine Polito  
**Sent:** Thursday, June 04, 2015 10:05 AM  
**To:** 'Nancy T'  
**Subject:** RE: Brazos Oak Point transmission Line Project

Ms. Tremblay,

Thank you for providing your comments.

Sincerely,

Christine Polito  
Senior Ecologist  
Cox|McLain Environmental Consulting Inc.  
600 E John Carpenter Freeway, Suite 380  
Irving, Texas 75062  
[www.coxmclain.com](http://www.coxmclain.com)  
469.647.4866 (office)

The information contained in this email is confidential and may be legally privileged. It is intended solely for the addressee. If you are not the intended recipient, any disclosure, copying, distribution, or any action or act of forbearance taken in reliance on it, is prohibited and may be unlawful. Any views expressed in this email are those of the individual sender, except where the sender specifically states them to be the views of Cox|McLain Environmental Consulting, Inc.

**From:** Nancy T [mailto:nlktgkskt@live.com]  
**Sent:** Thursday, June 04, 2015 9:57 AM  
**To:** Christine Polito  
**Subject:** Brazos Oak Point transmission Line Project

Christine, .

I live near one of the proposed transmission lines in Oak Point. I am not sure how to file my preferred route but have printed, marked, scanned and attached it to this email. Please let me know if there is another process as the ones I have found on the web don't apply are confusing and do not get the result I am looking for. Thank you in advance.

Nancy Tremblay  
502 Corinthian Drive  
Oak Point, Tx 75068  
469.964.0901

N. FREMONT - 5000' within Oak Brook -

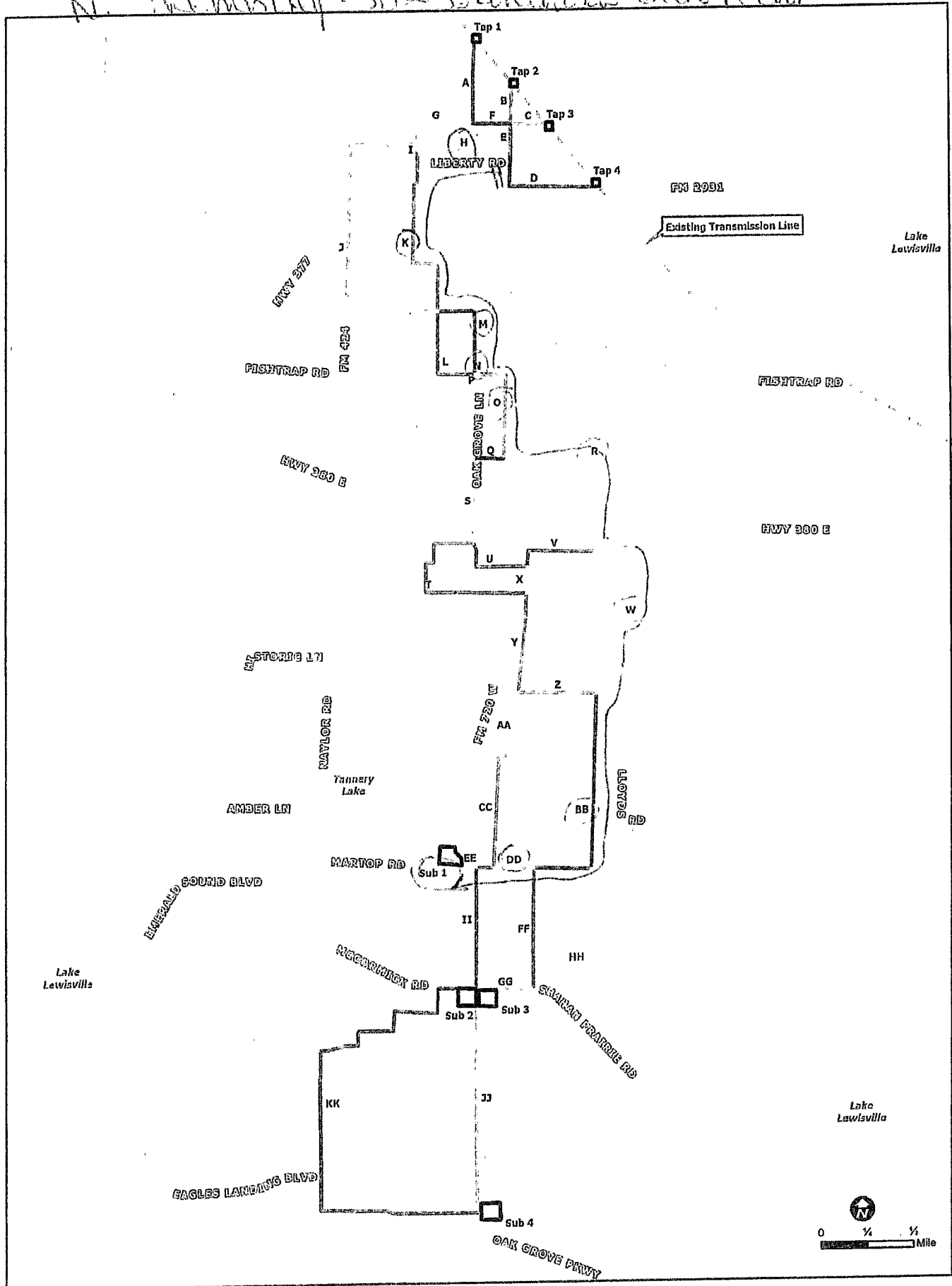



## QUESTIONNAIRE

### OAK POINT TRANSMISSION LINE AND SUBSTATION PROJECT

Welcome and thank you for taking the time to attend this meeting. After you have visited the various display stations around the room and talked with the project planners, please fill out this questionnaire. Your responses will help us understand the community's concerns and aid the project team in the route selection process. Again, thank you for your time and interest!

1. In your opinion, has the need for the project been adequately explained?

Yes ☒ No ☒

If "no", how could we have improved this effort? What did you not understand?

No actual numbers were cited. You just say "growth" is the reason.

2. Several factors are considered when routing a transmission line, including potential impacts to:

- Residences, businesses, schools, churches, hospitals, nursing homes;
- Cemeteries, parks, and/or recreational areas;
- Commercial radio transmitters, microwave relay stations and similar electronic installations;
- Airports, runways;
- Agricultural areas irrigated by traveling irrigation systems;
- Historical and archeological sites;
- Environmentally sensitive areas, endangered species; and
- Proximity to existing corridors.

- (A) Do you believe that all relevant factors are being considered?

Yes ☐ No ☒

If "no", please describe which additional factors you would like to see addressed.

It sounds to us like you have already made your decision, and it doesn't matter what our concerns are. You are going to do what you want to do anyway.

- (B) Are you aware of any features not depicted correctly or not shown on the maps? If so, please explain.

3. Which of the following applies to your situation?

- ☒ Potential route is near my home  
☐ Potential route is near my business  
☐ Potential route crosses my land  
☐ Other (please describe)



4. Please provide the letter designating the route segment which affects or comes near your property.

JJ

Do you live on this property?

Yes ☒ No ☐

5. Please indicate your preferred end-to-end route utilizing the links identified on the maps.

Sub1, EE, DD, BB, W, R, O, N, M, K, H, E, C, Tap3

6. Please list any additional concerns or information here.

7. Please provide the following information (please print):

Name: Jerel + Sharon Twiford

Street Address: 2575 Oak Grove Parkway

City, State, Zip Code: Little Elm, Tx 75068

Phone: 214-407-6362

Email: sr-twiford@hotmail.com

**THANK YOU FOR YOUR COMMENTS**

**PLEASE DROP THIS IN THE COMMENT BOX OR RETURN TO THE ADDRESS SHOWN BELOW WITHIN 7-10 DAYS.**

Please send it to: Attn: Christine Polito  
Cox|McLain Environmental Consulting, Inc.  
600 E. John Carpenter Fwy, Suite 380  
Irving, Texas 75062  
christine@coxmcclain.com



## QUESTIONNAIRE

### OAK POINT TRANSMISSION LINE AND SUBSTATION PROJECT

Welcome and thank you for taking the time to attend this meeting. After you have visited the various display stations around the room and talked with the project planners, please fill out this questionnaire. Your responses will help us understand the community's concerns and aid the project team in the route selection process. Again, thank you for your time and interest!

1. In your opinion, has the need for the project been adequately explained?

Yes \_\_\_\_\_ No \_\_\_\_\_ *NO ANSWER*

If "no", how could we have improved this effort? What did you not understand?

2. Several factors are considered when routing a transmission line, including potential impacts to:

- Residences, businesses, schools, churches, hospitals, nursing homes;
- Cemeteries, parks, and/or recreational areas;
- Commercial radio transmitters, microwave relay stations and similar electronic installations;
- Airports, runways;
- Agricultural areas irrigated by traveling irrigation systems;
- Historical and archeological sites;
- Environmentally sensitive areas, endangered species; and
- Proximity to existing corridors.

- (A) Do you believe that all relevant factors are being considered?

Yes \_\_\_\_\_ No ☒

If "no", please describe which additional factors you would like to see addressed.

*Followed plot lines, not property lines  
Inadequate (unprepared for proposed routes)*

- (B) Are you aware of any features not depicted correctly or not shown on the maps? If so, please explain.

*Yes KK - multiple diagonals  
through my property*

3. Which of the following applies to your situation?

- ☐ Potential route is near my home  
☐ Potential route is near my business  
☒ Potential route crosses my land  
☐ Other (please describe)



4. Please provide the letter designating the route segment which affects or comes near your property.

Do you live on this property?

Yes ☒ No ☐

5. Please indicate your preferred end-to-end route utilizing the links identified on the maps.

6. Please list any additional concerns or information here.

KK bisects Unnershall Farm

7. Please provide the following information (please print):

Name: DAVE Unnershall

Street Address: 401 McCormick Rd

City, State, Zip Code: PAK Point TX 75068

Phone: 214 975 2175

Email: unnershall.d@spcglobal.net

THANK YOU FOR YOUR COMMENTS

PLEASE DROP THIS IN THE COMMENT BOX OR RETURN TO THE ADDRESS SHOWN BELOW WITHIN 7-10 DAYS.

Please send it to:

Attn: Christine Polito  
Cox|McLain Environmental Consulting, Inc.  
600 E. John Carpenter Fwy, Suite 380  
Irving, Texas 75062  
christine@coxmcclain.com



## Christine Polito

---

**From:** Christine Polito  
**Sent:** Monday, June 01, 2015 3:53 PM  
**To:** 'Michael Uren'  
**Subject:** RE: Brozos Electric Questionnaire

Thank you for providing your comments.

Sincerely,

Christine Polito  
Senior Ecologist  
Cox|McLain Environmental Consulting Inc.  
600 E John Carpenter Freeway, Suite 380  
Irving, Texas 75062  
[www.coxmclain.com](http://www.coxmclain.com)  
469.647.4866 (office)

The information contained in this email is confidential and may be legally privileged. It is intended solely for the addressee. If you are not the intended recipient, any disclosure, copying, distribution, or any action or act of forbearance taken in reliance on it, is prohibited and may be unlawful. Any views expressed in this email are those of the individual sender, except where the sender specifically states them to be the views of Cox|McLain Environmental Consulting, Inc.

**From:** Michael Uren [mailto:[muren@ihntech.net](mailto:muren@ihntech.net)]  
**Sent:** Monday, June 01, 2015 1:45 PM  
**To:** Christine Polito  
**Subject:** Brozos Electric Questionnaire



Michael Uren  
O: 972-539-7970  
C: 214-315-4958  
F: 972-591-4579  
1120 Oak View Ct.  
Oak Point, TX 75068  
[muren@ihntech.net](mailto:muren@ihntech.net)



## QUESTIONNAIRE

### OAK POINT TRANSMISSION LINE AND SUBSTATION PROJECT

Welcome and thank you for taking the time to attend this meeting. After you have visited the various display stations around the room and talked with the project planners, please fill out this questionnaire. Your responses will help us understand the community's concerns and aid the project team in the route selection process. Again, thank you for your time and interest!

1. In your opinion, has the need for the project been adequately explained?

Yes \_\_\_\_\_ No X

If "no", how could we have improved this effort? What did you not understand?

*YOUR PUBLIC NOTIFICATION & ASKING FOR INPUT  
WAS VERY WEAK.*

2. Several factors are considered when routing a transmission line, including potential impacts to:

- Residences, businesses, schools, churches, hospitals, nursing homes;
- Cemeteries, parks, and/or recreational areas;
- Commercial radio transmitters, microwave relay stations and similar electronic installations;
- Airports, runways;
- Agricultural areas irrigated by traveling irrigation systems;
- Historical and archeological sites;
- Environmentally sensitive areas, endangered species; and
- Proximity to existing corridors.

- (A) Do you believe that all relevant factors are being considered?

Yes \_\_\_\_\_ No X

If "no", please describe which additional factors you would like to see addressed.

*WE DO NOT WANT SUBSTATIONS AT THE GATEWAYS  
TO OUR OAK POINT COMMUNITY. THIS WILL REDUCE  
ALL OUR PROPERTY VALUES AND IS AN EYE SORE*

- (B) Are you aware of any features not depicted correctly or not shown on the maps? If so, please explain.

*THE INTRUSION & 100FT MAJOR TOWERS  
& LINES ARE NOT SHOWN WELL.*

3. Which of the following applies to your situation?

- X Potential route is near my home  
\_\_\_\_\_ Potential route is near my business  
\_\_\_\_\_ Potential route crosses my land  
\_\_\_\_\_ Other (please describe)