

Control Number: 44523



Item Number: 8

Addendum StartPage: 0

CMA Engineering, Inc.

Firm No. F-3053

Robert P. Callegari, P.E.
Felix J. Manka, P.E.

April 24, 2015

2015 APR 29 AM 9:34

PUBLIC UTILITY COMMISSION
FILING CLERK

Filing Clerk
Public Utility Commission of Texas
1701 North Congress Avenue
P.O. Box 13326
Austin, Texas 78711

Re: City of Dripping Springs
TCEQ Application to Amend Water Certificate of Convenience and Necessity No. 13030
Public Utility Commission Docket No. 44523
Response to Order No. 2
CMA Job Number 1644-001

Dear Review Team:

This letter is in response to the Public Utility Commission's (PUC's) Order No. 2 dated April 13, 2015 and PUC Interoffice Memorandum dated April 8, 2015 for the above referenced application.

General Comment: The Applicant's survey plat maps referenced as Attachment 3 show a different proposed water service area on sheet 1, than shown on sheet 2. The proposed water service area is also shown differently on the additional maps submitted in attachments 2, 5, and Exhibit 2 with this application. The maps submitted reference the development, "Blue Blazes or Blue Blazes WSC," rather than the City of Dripping Springs, who is the Applicant and utility amending their water CCN 13030. All maps must clearly show the intent of the application, which is for the City of Dripping Springs to amend their water CCN 13030. The maps must clearly label the proposed water service area, not the development or subdivision name. Therefore, staff is unable to clearly determine the proposed water service area being requested with this application.

Response to General Comment: In regards to Attachment 3, Sheet 1 of the Replat of the subject tract, the Vicinity map is not intended to be the map illustrating the proposed area to be added to the City of Dripping Springs' Water CCN, but rather to provide regulatory entities indicating the general vicinity of the Replatted area. Sheet 2 should be used to illustrate the area to be added to the City of Dripping Springs' Water CCN.

Comment 1: Submit a general location (small scale) map only showing the proposed service area with enough detail to accurately locate the proposed service area in the vicinity of the nearest town, city, or county.

Response 1: Enclosed, please find eight (8) copies of the revised Attachment 2.

235 Ledge Stone Dr.
Phone: (512) 432-1000

Austin, Texas 78737
Fax (512) 432-1015

Comment 2: Submit a large scale map clearly delineating the proposed water service area with enough detail to accurately locate the service area on the vicinity of surrounding roads, streets, and highways. This map should be used for notice purposes.

- a. Submit a scaled map only showing the proposed water service area. Do not show surrounding CCN service areas on maps.*
- b. Must add a title and a legend to the clearly stating the intent of the application, and identify the utility name and CCN number being amended.*
- c. Must clearly label, mark or highlight the proposed water service area being amended.*

Response 2: Enclosed, please find eight (8) copies of the revised Attachment 5.

If you have any questions concerning this application please contact me at 512-432-1000.

Sincerely,



Robert P. Callegari, P.E.
Principal

Enclosures: Revised Attachment 2 and Attachment 5

Xc: Ginger Faught, City of Deputy City Administrator
David Tuckfield, Special Projects Counsel for the City
Public Viewing Binder
Jacy Warwick, Bowman Consulting (2 copies)

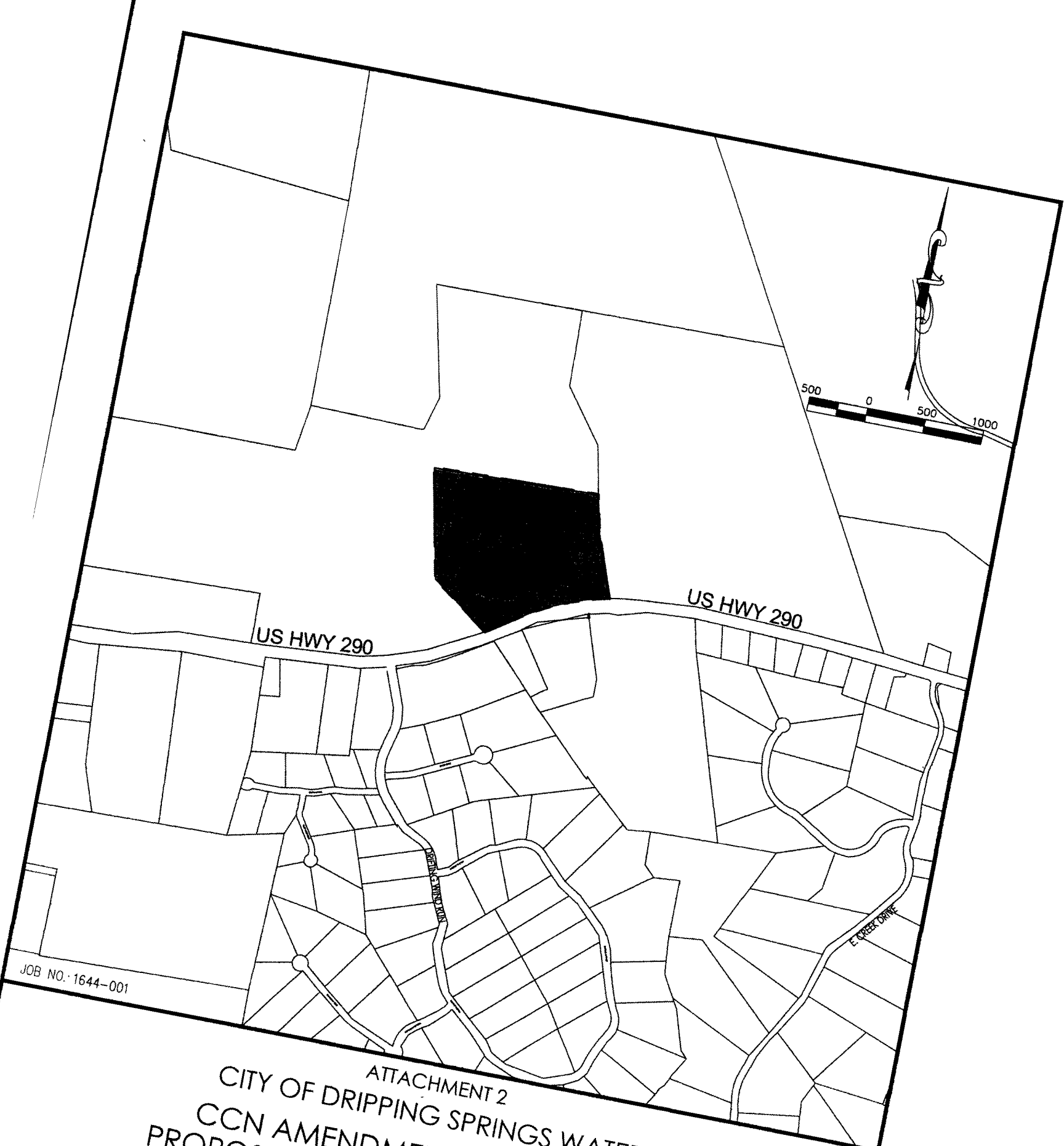

JOB NO. 1644-001

ATTACHMENT 2
CITY OF DRIPPING SPRINGS WATER
CCN AMENDMENT APPLICATION
PROPOSED WATER CCN SERVICE AREA

CMA ENGINEERING, INC.
235 LEDGE STONE DRIVE
AUSTIN, TEXAS 78737 (512) 432-1000

OVERSIZED MAP(S)

TO VIEW OVERSIZED MAP(S)
PLEASE GO TO
CENTRAL RECORDS

FOR ANY QUESTIONS
PLEASE CALL *CR* MAIN LINE
(512) 936-7180