

AIR ★ WATER ★ WASTE CONSULTANTS

CHASEWOOD WSC
12750 MERIT DR STE 1175
DALLAS, TX 75251-1235

Re: Sewer and Water Utility Service Request

Inline Utilities, LLC is applying to the Texas Commission on Environmental Quality (TCEQ) to amend their "Certificate of Convenience and Necessity" (CCN). In accordance with regulation 30 TAC §291.101, the utility is required to demonstrate that regionalization or consolidation with another retail public utility is not economically feasible. In order to demonstrate that regionalization or consolidation is not economically feasible, the TCEQ requires the applicant to send written requests regarding sewer and/or water service to each public sewer system within a two-mile radius of the applicants' system. The following information will be utilized to determine if regionalization or consolidation is/is not economically feasible.

Do you currently provide sewer and/or utility services (Please Check One)?

Yes _____

No _____

Based on economics and other matters would you be willing to provide sewer and/or water utility services capable of handling 100,000 gallons of discharge per day for the proposed CCN area? The proposed area is approximately 5 miles south of downtown Tomball and is generally bounded on the north by Timber Tech Road; on the east by Huffsmith Kohrville Road; on the south by Spring Cypress Road; and on the west by State Highway 249.

Yes _____

No _____

If you are willing to provide sewer and/or water utility services, provide a brief description of the services you are willing to provide and the cost, if any, to update your current system to deliver this service to the proposed CCN area.

This letter has been sent to you on behalf of Inline Utilities, LLC by Source Environmental Sciences, Inc. Please respond to the above address within seven (7) days. Please call me at the number above if you have any questions. Thanks in advance for your prompt assistance with this matter.

Sincerely,

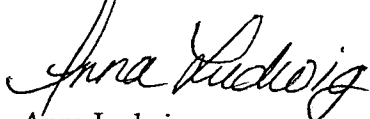

Anna Ludwig
Environmental Consultant



4100 WESTHEIMER, SUITE 106
HOUSTON, TEXAS 77027
E-mail: source@pdq.net
Phone (713) 621-4474
Fax (713) 621-4588

AIR ★ WATER ★ WASTE CONSULTANTS

UA HOLDINGS 1994-5 LP
8765 SPRING CYPRESS RD STE L# 173
SPRING, TX 77379-3195

Re: Sewer and Water Utility Service Request

Inline Utilities, LLC is applying to the Texas Commission on Environmental Quality (TCEQ) to amend their "Certificate of Convenience and Necessity" (CCN). In accordance with regulation 30 TAC §291.101, the utility is required to demonstrate that regionalization or consolidation with another retail public utility is not economically feasible. In order to demonstrate that regionalization or consolidation is not economically feasible, the TCEQ requires the applicant to send written requests regarding sewer and/or water service to each public sewer system within a two-mile radius of the applicants' system. The following information will be utilized to determine if regionalization or consolidation is/is not economically feasible.

Do you currently provide sewer and/or utility services (Please Check One)?

Yes _____

No _____

Based on economics and other matters would you be willing to provide sewer and/or water utility services capable of handling 100,000 gallons of discharge per day for the proposed CCN area? The proposed area is approximately 5 miles south of downtown Tomball and is generally bounded on the north by Timber Tech Road; on the east by Huffsmith Kohrville Road; on the south by Spring Cypress Road; and on the west by State Highway 249.

Yes _____

No _____

If you are willing to provide sewer and/or water utility services, provide a brief description of the services you are willing to provide and the cost, if any, to update your current system to deliver this service to the proposed CCN area.

This letter has been sent to you on behalf of Inline Utilities, LLC by Source Environmental Sciences, Inc. Please respond to the above address within seven (7) days. Please call me at the number above if you have any questions. Thanks in advance for your prompt assistance with this matter.

Sincerely,

Anna Ludwig
Environmental Consultant

AIR ★ WATER ★ WASTE CONSULTANTS

WOODMARK WATER LC
11703 BEXHILL
HOUSTON, TX 77065

Re: Sewer and Water Utility Service Request

Inline Utilities, LLC is applying to the Texas Commission on Environmental Quality (TCEQ) to amend their "Certificate of Convenience and Necessity" (CCN). In accordance with regulation 30 TAC §291.101, the utility is required to demonstrate that regionalization or consolidation with another retail public utility is not economically feasible. In order to demonstrate that regionalization or consolidation is not economically feasible, the TCEQ requires the applicant to send written requests regarding sewer and/or water service to each public sewer system within a two-mile radius of the applicants' system. The following information will be utilized to determine if regionalization or consolidation is/is not economically feasible.

Do you currently provide sewer and/or utility services (Please Check One)?

Yes _____

No _____

Based on economics and other matters would you be willing to provide sewer and/or water utility services capable of handling 100,000 gallons of discharge per day for the proposed CCN area? The proposed area is approximately 5 miles south of downtown Tomball and is generally bounded on the north by Timber Tech Road; on the east by Huffsmith Kohrville Road; on the south by Spring Cypress Road; and on the west by State Highway 249.

Yes _____

No _____

If you are willing to provide sewer and/or water utility services, provide a brief description of the services you are willing to provide and the cost, if any, to update your current system to deliver this service to the proposed CCN area.

This letter has been sent to you on behalf of Inline Utilities, LLC by Source Environmental Sciences, Inc. Please respond to the above address within seven (7) days. Please call me at the number above if you have any questions. Thanks in advance for your prompt assistance with this matter.

Sincerely,

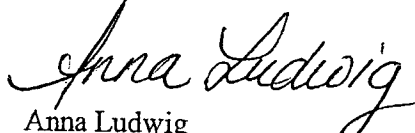
Anna Ludwig
Environmental Consultant

AIR ★ WATER ★ WASTE CONSULTANTS

HARRIS COUNTY MUD 286
1300 POST OAK BLVD STE 1400
HOUSTON, TX 77056-3078

Re: Sewer and Water Utility Service Request

Inline Utilities, LLC is applying to the Texas Commission on Environmental Quality (TCEQ) to amend their "Certificate of Convenience and Necessity" (CCN). In accordance with regulation 30 TAC §291.101, the utility is required to demonstrate that regionalization or consolidation with another retail public utility is not economically feasible. In order to demonstrate that regionalization or consolidation is not economically feasible, the TCEQ requires the applicant to send written requests regarding sewer and/or water service to each public sewer system within a two-mile radius of the applicants' system. The following information will be utilized to determine if regionalization or consolidation is/is not economically feasible.

Do you currently provide sewer and/or utility services (Please Check One)?

Yes _____

No _____

Based on economics and other matters would you be willing to provide sewer and/or water utility services capable of handling 100,000 gallons of discharge per day for the proposed CCN area? The proposed area is approximately 5 miles south of downtown Tomball and is generally bounded on the north by Timber Tech Road; on the east by Huffsmith Kohrville Road; on the south by Spring Cypress Road; and on the west by State Highway 249.

Yes _____

No _____

If you are willing to provide sewer and/or water utility services, provide a brief description of the services you are willing to provide and the cost, if any, to update your current system to deliver this service to the proposed CCN area.

This letter has been sent to you on behalf of Inline Utilities, LLC by Source Environmental Sciences, Inc. Please respond to the above address within seven (7) days. Please call me at the number above if you have any questions. Thanks in advance for your prompt assistance with this matter.

Sincerely,

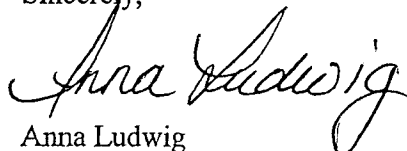

Anna Ludwig
Environmental Consultant

ATTACHMENT 4

GENERAL LOCATION MAP OF PROPOSED CCN AREA

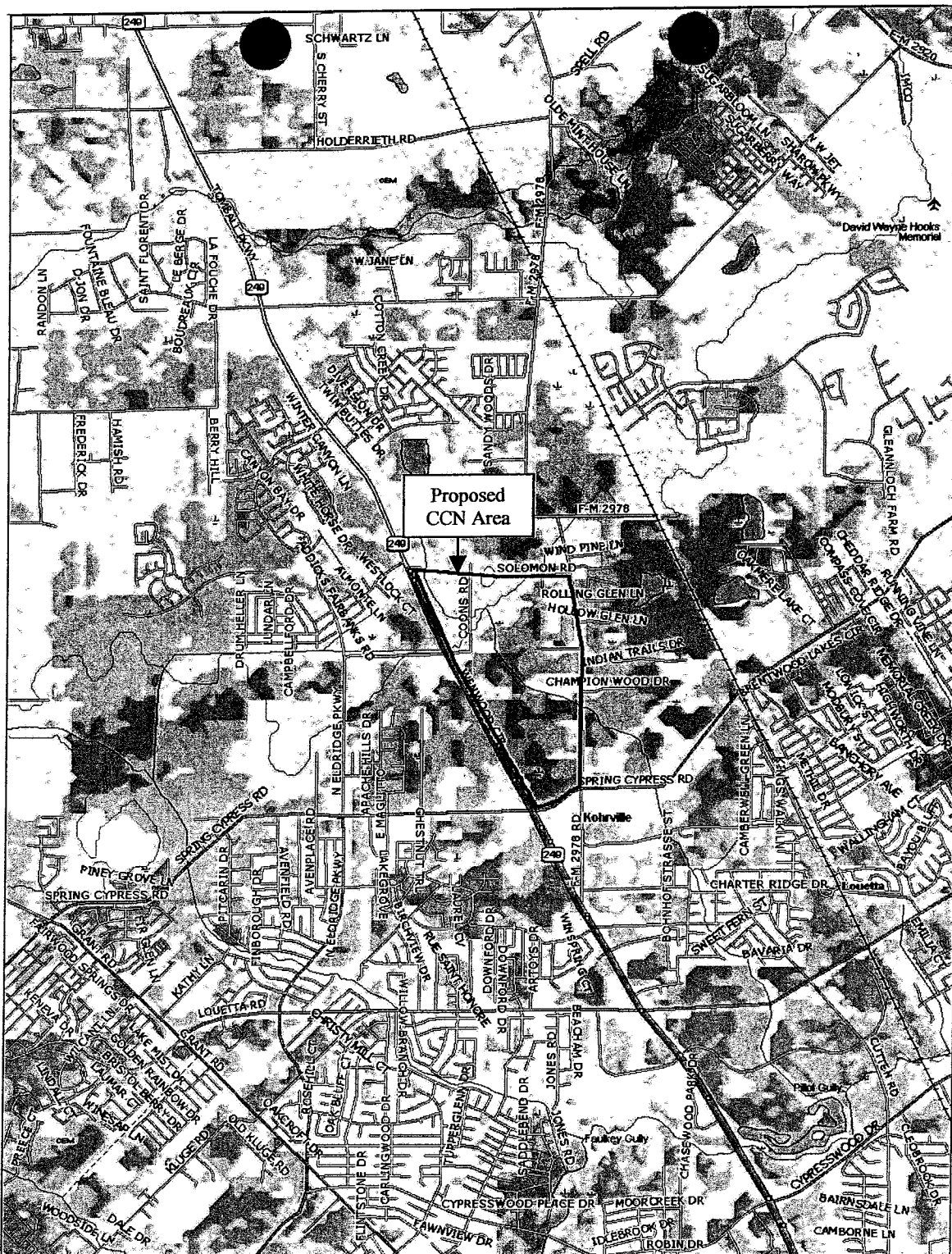

DeLORME

Data use subject to license.

© 2006 DeLorme Topo USA® 6.0.

www.delorme.com



MN (3.8° E)



Data Zoom 12-1

Inline Utilities, LLC
23822 State Highway 249
Tomball, Texas 77375
Harris County
(281) 655-1800

SOURCE 
ENVIRONMENTAL SCIENCES, INC.

**23820 State HWY 249
Tomball, TX 77375
(281) 655-1800**

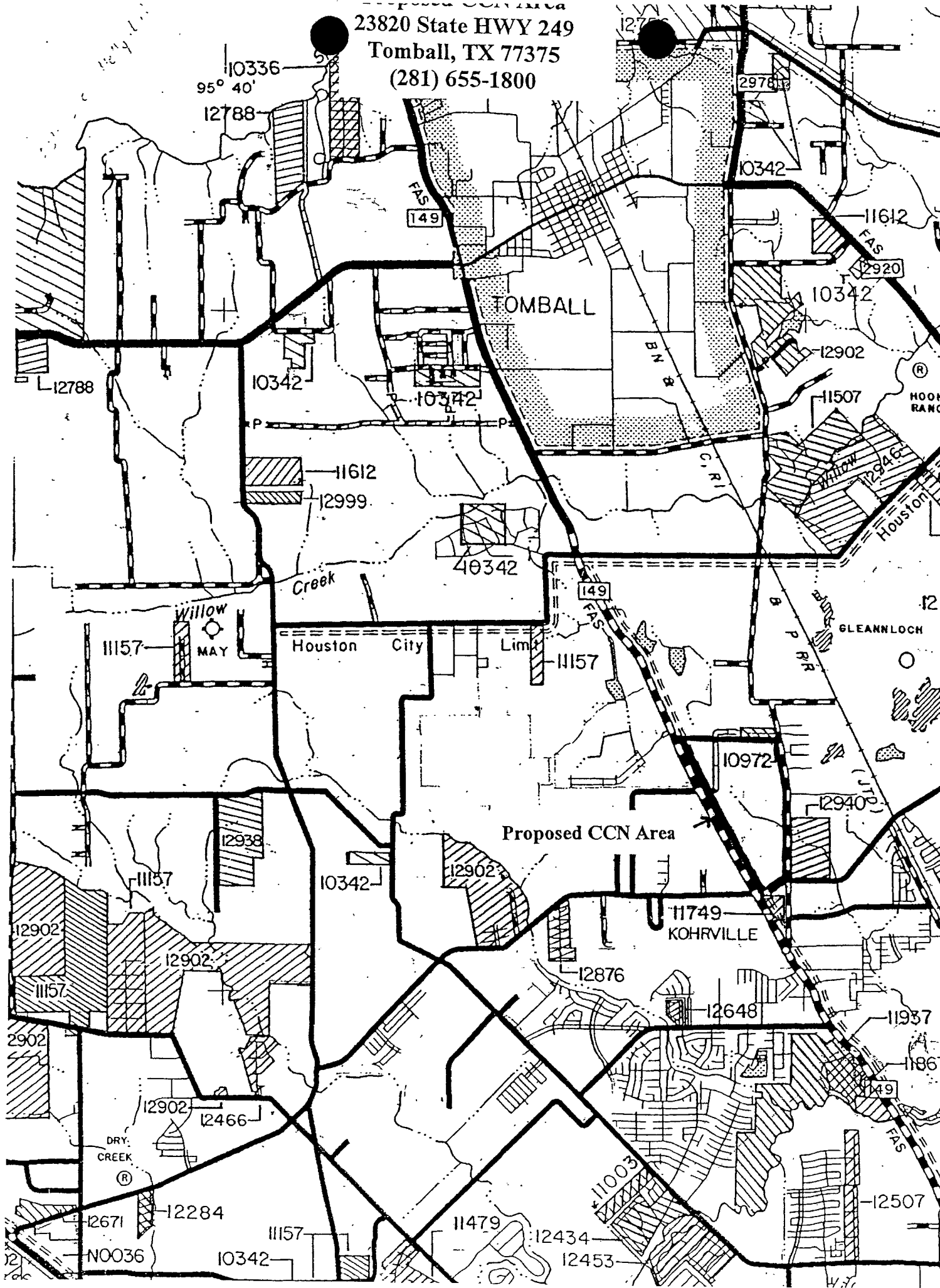

nd 4" x 4"
one. Nan

FND. PK NAIL
(at $S37^{\circ}43'42"E - 0.80'$)

Chain Link Fence
(Call. $N85^{\circ}59'41"W - 427.41'$, H.C.C. File E 633604)
 $N27^{\circ}45'21"W - 428.04'$

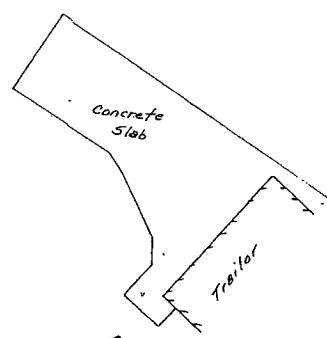

Elec. Service
Elec. Pole
Service Pole

RIGHT-OF-WAY EASEMENT
1909, Chain Link Fence
PORTION OF THIS EAS'T
H.C.C. FILE P623215 & P623226

1" I.R.
W. Cor.

Per H.C.C. File E062253-
120' DRAINAGE EASEMENT

$S03^{\circ}17'40"E$ (Call. $S03^{\circ}14'18"E$)
- 440.71'

30' ROAD RIGHT-OF-WAY (VOL. B529, PG 327, H.C.D.R.)

FND. $S18^{\circ}1'R$

Flow
Power Line
Edge of Pavement
Fnd $1/2" I.R.$

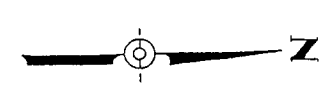

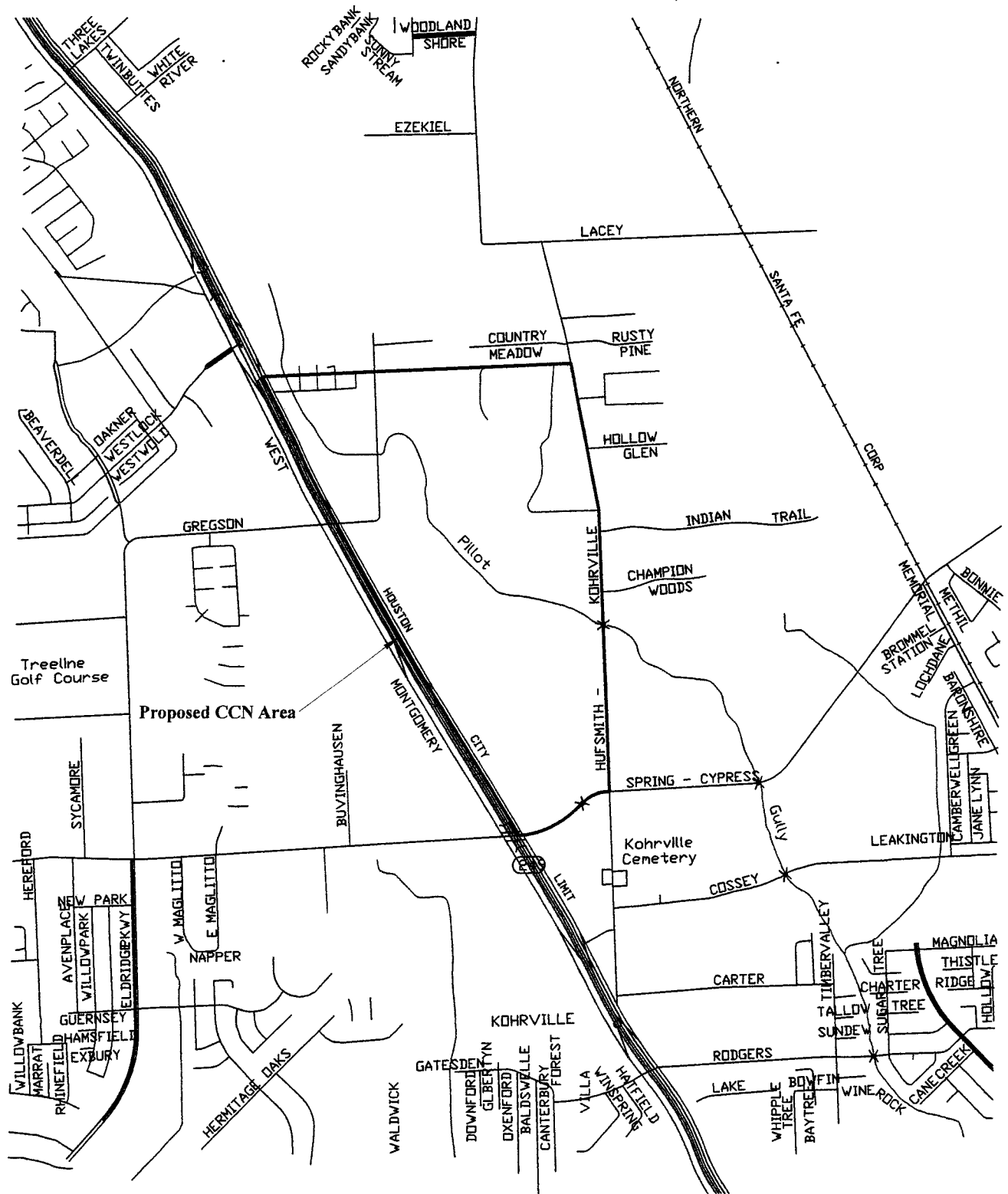

Proposed CCN Area Boundary Map
 Inline Utilities, LLC.
 23822 State HWY 249
 Tomball, TX 77375
 (281) 655-1800

SCALE (ft)
 0 500 1000 2000 3000
 Date of Drawing: 9-4-07

SOURCE
 ENVIRONMENTAL SCIENCES, INC.

TXDOT_Urban_Metadata

May 2002

Texas Department of Transportation (TXDOT)

Digital Map Files

I. Map Content

The transportation information was digitized from USGS 7.5 minute quadrangles for the TXDOT County/Urban Files. Updates are made using TXDOT highway construction plans, aerial photographs, from official city maps and field inventory data. These files contain many of the features found on 7.5 minute quadrangles, except for contour lines, fence lines, jeep trails, electric transmission lines, oil and gas pipelines and control data monuments.

II. Map Projection

TEXAS STATEWIDE MAPPING SYSTEM (NAD 27)

Projection:	Lambert Conformal Conic
Ellipsoid:	Clarke 1866
Datum:	North American 1927
Longitude of Origin:	100 degrees west (-100)
Latitude of Origin:	31 degrees 10 minutes north
Standard Parallel #1:	27 degrees 25 minutes north lat.
Standard Parallel #2:	34 degrees 55 minutes north lat.
False Easting:	3,000,000 feet
False Northing:	3,000,000 feet
Unit of Measure:	feet (international)

III. File Names and Positional Accuracy

(County Number)urban.dgn: The Urban Map Series is the most accurate digital mapping information available from TXDOT. The features in this statewide coverage have been digitized from USGS 7.5 minute quadrangles. The line work and annotation is fixed for publication at the 4"=1 mile or 1320 ft scale. City limits, County Roads and State Maintained Roads are updated annually and all other information is updated prior to a map sheet being published. The Railroads may be displaced laterally as much as 60 feet from the true position when paralleling a road. The hydrology has been generalized

(County Number)uarea.dgn: Urban Area files are created to match the Urban Map Series and contain complex shapes for applying a color fill to such features as water, city limits, and parks.

IV. TXDOT Mapping Levels

TXDOT uses the following level structure for its MicroStation mapping files. These following features are found in (county number)urban.dgn files.

Feature	Level
Highway Number	1
Highway Boulevard	2
Frontage Road / Ramp	3
Highway Boulevard Centerline	4
Highway in City	5
Pedestrian Overpass	6
Blank	7
Highway Rural	8
Bridges on Boulevard Highways	9

TxDOT_Urban_Metadata

Highway Shields	10
Bridge on Highways in Cities	11
Bridge on Rural Highways	12
Blank	13
Culture Names (Most of the Annotation)	14
City Street Boulevards	15
City Street Boulevard Centerline	16
Concrete Ford	17
City Streets	18
Street Names (on Urban files only)	19
County Road Bridges	20
Not County Maintained Roads	21
Earth County Roads	22
All Weather County Roads	23
Paved County Roads	24
Rural Subdivision Boulevard Centerline	25
Rural Subdivision Boulevard	26
Railroad: Main Line, Pattern and Name	27
Railroad Name	28
Railroad: Spur Line, Pattern	29
Blank	30
Railroad Bridge	31
Blank	32
Blank	33
Water Feature Names	34
Flume	35
GIWW Channel Centerline	36
Intermittent Streams	37
Flowing Streams & Small Rivers	38
Lakes	39
Medium Flowing Rivers	40
Large Flowing Rivers	41
Intermittent Lakes	42
Inundation Line	43
GIWW Canal (through water) & Channel Names	44
GIWW Canal (through land) & Barge Symbol	45
Dam	46
Mask for Barge Symbol	47
Escarpment, Bluff	48
Prominent Peak Symbol	49
Border Sheet Match Points	50
State Line Monument	51
Boundary Lines	52
Airport Runways	53
Public Facility Symbols	54
Culture & Government Symbols	55
Blank	56
Town Symbols, City Names and Population	57
City Limit Lines	58
Bubble Inset Lines	59
Asterisks and Mileage between Points	60
Asterisks Masks	61
Blank	62
Non-Plotting Information	63

V. Contacts for Additional Information

If further clarification is needed please contact:

Texas Department of Transportation
 Transportation Planning and Programming
 P. O. Box 149217
 Austin, TX 78714-9217

ATTACHMENT 5

ORIGINAL USGS TOPOGRAPHIC MAP

The Original USGS Topographic Map has been submitted to the TCEQ.



ATTACHMENT 6

PROCESS FLOW DIAGRAM OF WASTEWATER TREATMENT PLANT

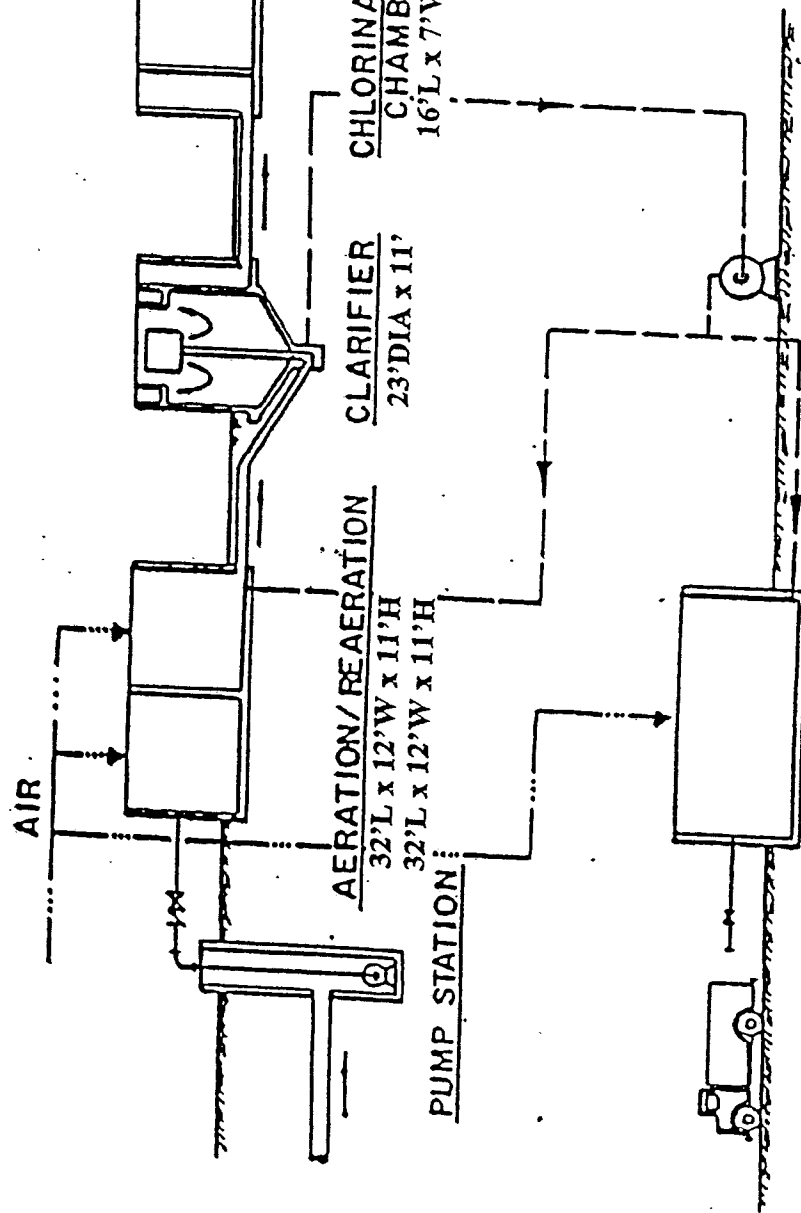

TO DISPOSAL AEROBIC DIGESTER
 $20'L \times 12'W \times 9.67'H$
 $20'L \times 12'W \times 9.67'H$

RETURN SLUDGE PUMP

ATTACHMENT 7
COVER PAGE FOR PERMIT WQ13942-002



TPDES PERMIT NO. 13942-002
[For TCEQ Office Use Only:
EPA ID No. TX0125466]

TEXAS COMMISSION ON ENVIRONMENTAL QUALITY
P.O. Box 13087
Austin, Texas 78711-3087

PERMIT TO DISPOSE OF WASTES
under provisions of
Section 402 of the Clean Water Act
and Chapter 26 of the Texas Water Code

Inline Utilities LLC

whose mailing address is

9850 1/2 Boudreaux Road
Tomball, Texas 77375

is authorized to treat and dispose of wastes from the Inline Utilities LLC Wastewater Treatment Facility, SIC Code 4952

located at 23822 State Highway 249, approximately 850 feet north of the intersection of State Highway 249 and Coons Road in Harris County, Texas

to a Harris County Flood Control District (HCFCD) ditch; thence to Pillot Gully; thence to Cypress Creek in Segment No. 1009 of the San Jacinto River Basin

only according with effluent limitations, monitoring requirements and other conditions set forth in this permit, as well as the rules of the Texas Commission on Environmental Quality (TCEQ), the laws of the State of Texas, and other orders of the TCEQ. The issuance of this permit does not grant to the permittee the right to use private or public property for conveyance of wastewater along the discharge route described in this permit. This includes, but is not limited to, property belonging to any individual, partnership, corporation or other entity. Neither does this permit authorize any invasion of personal rights nor any violation of federal, state, or local laws or regulations. It is the responsibility of the permittee to acquire property rights as may be necessary to use the discharge route.

This permit shall expire at midnight, February 1, 2008.

ISSUED DATE: MAY 15 2003

A handwritten signature in black ink, appearing to read "Margaret H. Hume".

For the Commission