

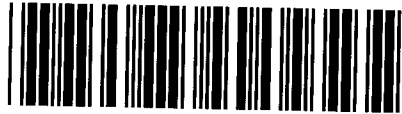

Control Number: 43895



Item Number: 27

Addendum StartPage: 0

PUBLIC UTILITY COMMISSION
OF TEXAS

**APPLICATION OF CONCHO RURAL
WATER CORPORATION TO AMEND
A CERTIFICATE OF CONVENIENCE
AND NECESSITY IN TOM GREEN
COUNTY**

OF TEXAS

2015 DEC 18 PM 1:43

FILED
PUBLIC UTILITY COMMISSION
FILING CLERK

COMMISSION STAFF'S FINAL RECOMMENDATION

COMES NOW the Staff (Staff) of the Public Utility Commission of Texas (Commission), representing the public interest, and files this Final Recommendation, and would show the following:

I. BACKGROUND

On December 4, 2014, Concho Rural Water Corporation (CRWC) filed with the Public Utility Commission of Texas (Commission) an application to amend its water certificate of convenience No. 11361 in Tom Green County, Texas. Order No. 8 was issued on October 29, 2015, which set December 18, 2015 as the deadline for Staff to propose an additional procedural schedule, request a hearing, or file a final recommendation.

II. RECOMMENDATION

Staff recommends that the application by the CRWC be approved, as supported by the attached memorandum from Elisabeth English, Engineering Specialist with the Water Utilities Division. Specifically, Staff recommends that CRWC meets all of the statutory requirements of TWC Chapter 13 and 16 TAC Chapter 24 rules and regulations, and that approving this application to amend the CRWC's water Certificates of Convenience and Necessity is necessary for the service, accommodation, convenience and safety of the public pursuant to 16 TAC § 24.102(c).

DATED: December 18, 2015

Respectfully Submitted,

Margaret Uhlig Pemberton
Division Director - Legal Division

Karen S. Hubbard
Managing Attorney - Legal Division

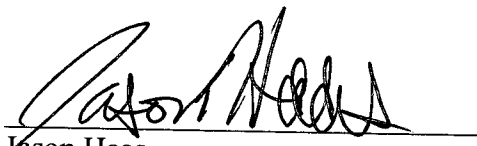
A handwritten signature in black ink, appearing to read "Jason Haas", written over a horizontal line.

Jason Haas
Legal Division
State Bar No. 24032386
(512) 936-7295
(512) 936-7268 (facsimile)
Public Utility Commission of Texas
1701 N. Congress Avenue
P.O. Box 13326
Austin, Texas 78711-3326

CERTIFICATE OF SERVICE

I certify that a copy of this document will be served on all parties of record on December 18, 2015, in accordance with 16 TAC § 22.74.

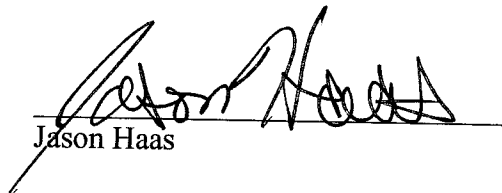
A handwritten signature in black ink, appearing to read "Jason Haas", written over a horizontal line.

PUC Interoffice Memorandum

To: Jason Hass, Attorney
Legal Division

Thru: Tammy Benter, Director
Lisa Fuentes, Manager
Water Utilities Division

From: Elisabeth English, Engineering Specialist
Water Utilities Division

Date: December 18, 2015

Subject: **Docket No. 43895:** *Application of Concho Rural Water Corporation, to amend its Water Certificate of Convenience and Necessity (CCN) in Tom Green County*

On December 1, 2014, Concho Rural Water Corporation (Applicant), filed an application to amend its water Certificate of Convenience and Necessity (CCN) No. 11361 in Tom Green County, pursuant to Texas Water Code §§ 13.242-13.250 (TWC) and 16 Texas Administrative Code §§24.101-24.107 (TAC).

The Applicant, which is an investor-owned utility, is seeking to amend its water CCN for approximately 28 acres in order to provide water service to 25 potential connections, 4 of which are currently being served via the Applicant's water hauling service. The amendment provides area for the Applicant to construct a water transmission line to provide potable water service to customers that have requested service.

Public notice was provided on July 14, 2015, to neighboring systems, landowners, cities and affected parties as required by 16 TAC § 24.106(b)(2). Published notice in Tom Green County was provided in the *San Angelo Gazette* on July 17, and 24, 2015, as required by 16 TAC § 24.106(b)(3). The Applicant filed proof of notice with the Commission on August 21, 2015, pursuant to 16 TAC §§ 24.106(b)(6) and (c). The Applicant was ordered to provide additional notice to an affected party which was provided on September 15, 2015. The comment period ended October 15, 2015, pursuant to 16 TAC § 24.107(b). The Commission did not receive any protests, requests for hearing nor any opt-out requests regarding the application.

In determining whether to grant or amend a CCN, the Commission shall ensure that the Applicant possesses the financial, managerial, and technical capability to provide continuous and adequate service pursuant to TWC § 13.241(a) and 16 TAC § 24.102(a). The Commission shall also consider the nine elements as stated in TWC § 13.246(c) and 16 TAC § 24.102(d). Staff has reviewed the above referenced application, and has found that it has met the requirements, as detailed below.

TWC § 13.241(c) and 16 TAC § 24.102(a)(2)

For water utility service, the Commission shall ensure that the Applicant has a TCEQ approved public water system (PWS) that it is capable of providing drinking water that meets the requirements of Texas Health and Safety Code, Chapter 341 and TCEQ rules and has access to an adequate supply of water. The area subject to this application will be served by the Concho Rural Water Grape Creek PWS (ID No. 2260008), which is a TCEQ approved PWS. The Applicant's PWS does not have any TCEQ issued violations pertaining to 30 TAC 290 Subchapter F, which governs the drinking water quality and reporting requirements for PWS's in Texas. The standards are written to comply with the Federal Safe Drinking Water Act and Primary Drinking Water Regulations. The service provided to the area currently meets the TCEQ water quality requirements and is therefore safe for household usage. The most recent comprehensive

compliance inspection (CCI) was conducted on October 16, 2012, to which violations of 30 TAC 290 Subchapter D were cited. According to TCEQ Central Registry Database the violations are no longer outstanding and resolved.

TWC § 13.246(c)(1) and 16 TAC § 24.102(d)(1)

In considering whether to grant or amend a certificate, the Commission shall consider the adequacy of service currently provided to the requested area. The proposed area is currently being served by a water hauling service operated by the Applicant, Concho Rural Water-Water Hauling (ID No. 2260102), which is a TCEQ approved PWS. The PWS is in compliance with TCEQ regulations.

TWC § 13.246(c)(2) and 16 TAC § 24.102(d)(2)

In considering whether to grant or amend a certificate, the Commission shall consider the need for additional service in the proposed area. The Applicant has received requests for service from commercial properties in the area, which is expected to expand following the transmission line installation.

TWC § 13.246(c)(3) and 16 TAC § 24.102(d)(3)

In considering whether to grant or amend a certificate, the Commission shall consider the effect of granting a certificate on the Applicant, on the landowners in the area, and on any retail public utility of the same kind already serving the proximate area. The amendment will add an additional 28 acres to the Applicant's CCN water service area, which will allow the proposed area to be developed and provide potable water service to those who requested it. No other retail public utilities will be affected by this application. The Commission did not receive any protests, requests for hearing nor any opt-out requests regarding the application.

TWC § 13.246(c)(4) and 16 TAC § 24.102(d)(4)

In considering whether to grant or amend a certificate, the Commission shall consider the ability of the Applicant to provide adequate service, including meeting the standards of the commission, taking into consideration the current and projected density and land use of the area. The Applicant currently operates 7 independent PWS's, all of which are in compliance with TCEQ regulations at this time. The Applicant has also secured a purchase water contract with the City of San Angelo to provide adequate water supply to the proposed area.

TWC § 13.246(c)(5) and 16 TAC § 24.102(d)(5)

In considering whether to grant or amend a certificate, the Commission shall consider the feasibility of obtaining service from an adjacent retail public utility. The Applicant already has water service infrastructure in place adjacent to the proposed area, and is currently servicing areas nearby; additionally, the Applicant is serving 4 customers in the area via water hauling. The developer requested service from the adjacent retail public utility, the City of San Angelo, who was unable to provide service to the area.

TWC § 13.246(c)(6) and 16 TAC § 24.102(d)(6)

In considering whether to grant or amend a certificate, the Commission shall consider the financial ability of the applicant to pay for the facilities necessary to provide continuous and adequate service and the financial stability of the applicant, including, if applicable, the adequacy of the applicant's debt-equity ratio. Based on the information provided by the Applicant in this filing, the Applicant has the financial resources to operate and manage the utility and to provide continuous and adequate service to the current and proposed utility service area. The Applicant has a debt to equity ratio of 0.53. A ratio of less than one, using long term debt and equity or net assets is preferred because it demonstrates that the Applicant can fund operations and capital costs because the Applicant is not highly leveraged and financing would reasonably be available. The Applicant also has a debt service coverage (DSC) ratio of 2.13. A ratio of more than 1.25 is preferred because this means that the utility is able to pay back its debts comfortably. The DSC is calculated using annual net operating income before depreciation and non-cash expenses divided by annual combined long term debt service (payments).

The Applicant is financially sound with respect to its operations and leverage ratios. Furthermore, the Applicant can cover the projected capital expense for constructing the facility at a cost of \$122,000, and the Applicant reported a net income of \$328,844 on its audited financial statements for 2013, which is more than sufficient to cover the cost of construction.

TWC § 13.246(c)(7) and 16 TAC § 24.102(d)(7)

In considering whether to grant or amend a certificate, the Commission shall consider the environmental integrity of the proposed area resulting from the granting of the certificate or amendment. As long as all appropriate construction techniques and approved design criteria are used during the construction of the transmission line, there should be minimal effect to the environmental integrity of the proposed area.

TWC § 13.246(c)(8) and 16 TAC § 24.102(d)(8)

In considering whether to grant or amend a certificate, the Commission shall consider the probable improvement in service or lowering of cost to consumers in that area resulting from the granting of the certificate or amendment. The approval of the CCN and construction of the water transmission line will bring needed infrastructure to the proposed area, which is currently only receiving water through delivery.

TWC § 13.246(c)(9) and 16 TAC § 24.102(d)(9)

In considering whether to grant or amend a certificate, the Commission shall consider the effect on the land to be included in the certificated area. The land will be temporarily disrupted during the construction of the transmission line.

Based on a Staff review of the application, the Applicant meets all of the statutory requirements of TWC Chapter 13 and 16 TAC Chapter 24 rules and regulations. Approving this application to amend the Applicants water Certificate of Convenience and Necessity to the Applicant is necessary for the service, accommodation, convenience and safety of the public pursuant to 16 TAC § 24.102(c). Staff recommends approval of the application.

Staff also recommends that the Applicant file copies of the CCN map along with a written description of the CCN service area in the respective county clerks' offices in Tom Green County pursuant to Texas Water Code § 13.257 (r) and (s).

Concho Rural Water Corporation
Portion of Water Service Area
CCN No. 11361
PUC Docket No. 43895
Amended CCN No. 11361 in Tom Green County

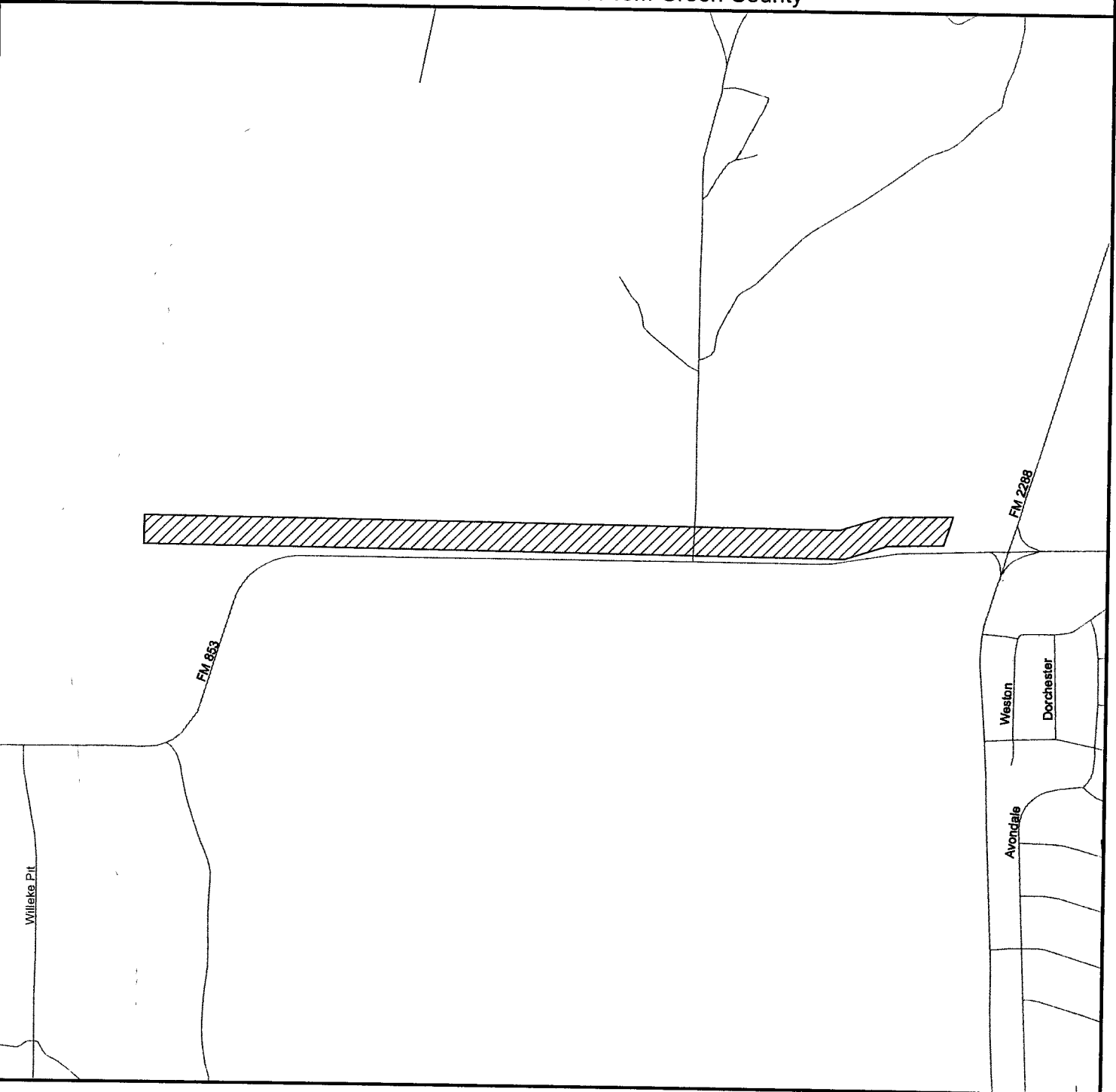

Public Utility Commission of Texas
1701 N. Congress Ave
Austin, TX 78701

Water CCN Service Areas



11361 - Concho Rural Water Corporation

0 500 1,000
Feet



Map by: Komal Patel
Date created: December 1, 2015
Project Path: n:\finalmapping\43895ConchoRuralWater.mxd



WATER UTILITY TARIFF

Docket Number: 43895

Concho Rural Water Corporation
(Utility Name)

8174 US Highway 87 North
(Business Address)

San Angelo, Texas 76901
(City, State, Zip Code)

(325) 658-2961
(Area Code/Telephone)

This tariff is effective for utility operations under the following Certificate of Convenience and Necessity:

11361

This tariff is effective in the following county:

Tom Green

This tariff is effective in the following cities or unincorporated towns (if any):

None

This tariff is effective in the following subdivisions or systems:

See attached list

TABLE OF CONTENTS

The above utility lists the following sections of its tariff (if additional pages are needed for a section, all pages should be numbered consecutively):

SECTION 1.0 -- RATE SCHEDULE.....	2
SECTION 2.0 -- SERVICE RULES AND POLICIES	4
SECTION 3.0 -- EXTENSION POLICY	11
SECTION 4.0 -- DROUGHT CONTINGENCY PLAN.....	15

APPENDIX A -- SAMPLE SERVICE AGREEMENT
APPENDIX B -- APPLICATION FOR SERVICE

Concho Rural Water Corporation

This tariff is effective in the following Subdivisions or Systems:

Allard Est., Ballard, Big Sky, Buffalo Heights, Coopers, Copper Mtn., Evergreen Acres, Frontier Acres, Garden Waters, Grape Creek, Grape Creek Gardens, Garden Waters, Hughes Subdivision, Indian Creek, Lake Concho, Lake Gardens 1&2, Lakewood, Moon Ln., Mountain View, Northwood, Oak Ln, Paradise Valley, Pulliam, Rolling Acres, Sun Ln., Sutter Subdivision, Arden Road	PWS #2260008
Cactus Lane, Fruitland Farm Ct., North Concho, Northview	PWS #2260020
Hiddenview, Pecan Creek, Stone Key Estates, Stonekey, Stonewall Reserve	PWS #2260057
Water Valley	PWS #2260060
Deer Valley Estates	PWS #2260067
River Ranch, The Oaks, Oak Mtn Estates, Oaks North, Ridge Ln	PWS #2260093

SECTION 1.0 -- RATE SCHEDULE

Section 1.01 - Rates

5/8" or 3/4"	<u>\$30.00</u> (Includes 0 gallons)	<u>\$1.75</u> per 1000 gallons, 0-10,000 gallons
1"	<u>\$42.41</u>	<u>\$2.40</u> per 1000 gallons, 10,001-20,000 gallons
1 1/2 "	<u>\$80.59</u>	<u>\$2.90</u> per 1000 gallons, 20,001-30,000 gallons
2"	<u>\$126.59</u>	<u>\$3.40</u> per 1000 gallons, 30,001-40,000 gallons
3"	<u>\$234.20</u>	<u>\$3.90</u> per 1000 gallons, 40,001-50,000 gallons
4"	<u>\$279.00</u>	<u>\$5.25</u> per 1000 gallons, 50,001-over gallons

Upper Colorado River Authority \$2.25 per 1000 gallons
(for Pecan Creek Mobile Home Park and The Oaks Systems only)

FORM OF PAYMENT: The utility will accept the following form(s) of payment:

Cash X, Check X, Money Order X, Credit Card X, Other (specify): Bank Draft
 THE UTILITY MAY REQUIRE EXACT CHANGE FOR PAYMENTS AND MAY REFUSE TO ACCEPT PAYMENTS MADE USING MORE THAN \$1.00 IN SMALL COINS. A WRITTEN RECEIPT WILL BE GIVEN FOR CASH PAYMENTS.

REGULATORY ASSESSMENT..... 1.0%
 PUC RULES REQUIRE THE UTILITY TO COLLECT A FEE OF ONE PERCENT OF THE RETAIL MONTHLY BILL AND TO REMIT TO THE TCEQ.

Section 1.02 - Miscellaneous Fees

TAP FEE..... \$750.00
 TAP FEE COVERS THE UTILITY'S COSTS FOR MATERIALS AND LABOR TO INSTALL A STANDARD RESIDENTIAL 5/8" or 3/4" METER. AN ADDITIONAL FEE TO COVER UNIQUE COSTS IS PERMITTED IF LISTED ON THIS TARIFF.

TAP FEE (Unique costs)..... Actual Cost
 FOR EXAMPLE, A ROAD BORE FOR CUSTOMERS OUTSIDE OF SUBDIVISIONS OR RESIDENTIAL AREAS.

TAP FEE (Large meter)..... Actual Cost
 TAP FEE IS THE UTILITY'S ACTUAL COST FOR MATERIALS AND LABOR FOR METER SIZE INSTALLED.

METER RELOCATION FEE Actual Relocation Cost, Not to Exceed Tap Fee
 THIS FEE MAY BE CHARGED IF A CUSTOMER REQUESTS THAT AN EXISTING METER BE RELOCATED.

SECTION 1.0 -- RATE SCHEDULE (Continued)

METER TEST FEE \$25.00
THIS FEE WHICH SHOULD REFLECT THE UTILITY'S COST MAY BE CHARGED IF A CUSTOMER REQUESTS A SECOND METER TEST WITHIN A TWO-YEAR PERIOD AND THE TEST INDICATES THAT THE METER IS RECORDING ACCURATELY. THE FEE MAY NOT EXCEED \$25.

LATE CHARGE (EITHER \$5.00 OR 10% OF THE BILL) 10%
PUC RULES ALLOW A ONE-TIME PENALTY TO BE CHARGED ON DELINQUENT BILLS. A LATE CHARGE MAY NOT BE APPLIED TO ANY BALANCE TO WHICH THE PENALTY WAS APPLIED IN A PREVIOUS BILLING.

RETURNED CHECK CHARGE \$20.00
RETURNED CHECK CHARGES MUST BE BASED ON THE UTILITY'S DOCUMENTABLE COST.

RECONNECTION FEE
THE RECONNECT FEE MUST BE PAID BEFORE SERVICE CAN BE RESTORED TO A CUSTOMER WHO HAS BEEN DISCONNECTED FOR THE FOLLOWING REASONS (OR OTHER REASONS LISTED UNDER SECTION 2.0 OF THIS TARIFF):

- a) Non payment of bill (Maximum \$25.00) \$25.00
- b) Customer's request that service be disconnected \$35.00

TRANSFER FEE \$25.00
THE TRANSFER FEE WILL BE CHARGED FOR CHANGING AN ACCOUNT NAME AT THE SAME SERVICE LOCATION WHEN THE SERVICE IS NOT DISCONNECTED

CUSTOMER DEPOSIT RESIDENTIAL (Maximum \$50) \$50.00

COMMERCIAL & NON-RESIDENTIAL DEPOSIT 1/6TH OF ESTIMATED ANNUAL BILL

GOVERNMENTAL TESTING, INSPECTION AND COSTS SURCHARGE:
WHEN AUTHORIZED IN WRITING BY TCEQ AND AFTER NOTICE TO CUSTOMERS, THE UTILITY MAY INCREASE RATES TO RECOVER INCREASED COSTS FOR INSPECTION FEES AND WATER TESTING.
[30 TAC 24.21(K)(2)]

LINE EXTENSION AND CONSTRUCTION CHARGES:
REFER TO SECTION 3.0--EXTENSION POLICY FOR TERMS, CONDITIONS, AND CHARGES WHEN NEW CONSTRUCTION IS NECESSARY TO PROVIDE SERVICE.

SECTION 1.0 - RATE SCHEDULE (Continued)

PASS THROUGH PROVISION:

For utilities subject to changes in cost imposed by any non-affiliated provider of purchased water or sewer or a groundwater conservation district having jurisdiction over the Utility, these increases (decreases) shall be passed through as an adjustment to the gallonage charge according to the formula:

Adjusted Gallonage Rate (AG) = $G + [B / (1 - L)]$, Where:

AG = adjusted gallonage charge, rounded to nearest one cent;

G = approved gallonage charge, per 1,000 gallons;

B = change in fee (per 1,000 gallons);

L = water or sewer line loss for preceding 12 months, not to exceed 0.15 (15%)

To implement or modify the pass through provision, the utility must comply with all notice and other requirements of 30 TAC §24.21(b)(2).

SECTION 2.0 -- SERVICE RULES AND POLICIES

The utility will have the most current Public Utility Commission of Texas (PUC or Commission) Commission Rules, Chapter 24, available at its office for reference purposes. The Rules and this tariff shall be available for public inspection and reproduction at a reasonable cost. The latest Rules or Commission approved changes to the Rules supersede any rules or requirements in this tariff.

Section 2.01 - Application for Water Service

All applications for service will be made on the utility's standard application or contract form (attached in the Appendix to this tariff), will be signed by the applicant, any required fees (deposits, reconnect, tap, extension fees, etc. as applicable) will be paid and easements, if required, will be granted before service is provided by the utility. A separate application or contract will be made for each service location.

Section 2.02 - Refusal of Service

The utility may decline to serve an applicant until the applicant has complied with the regulations of the regulatory agencies (state and municipal regulations) and for the reasons outlined in the PUC Rules. In the event that the utility refuses to serve an applicant, the utility will inform the applicant in writing of the basis of its refusal. The utility is also required to inform the applicant that a complaint may be filed with the Commission.

Section 2.03 - Fees and Charges & Easements Required Before Service Can Be Connected

(A) Customer Deposits

If a residential applicant cannot establish credit to the satisfaction of the utility, the applicant may be required to pay a deposit as provided for in Section 1.02 - Miscellaneous Fees of this tariff. The utility will keep records of the deposit and credit interest in accordance with PUC Rules.

Residential applicants 65 years of age or older may not be required to pay deposits unless the applicant has an outstanding account balance with the utility or another water or sewer utility which accrued within the last two years.

Nonresidential applicants who cannot establish credit to the satisfaction of the utility may be required to make a deposit that does not exceed an amount equivalent to one-sixth of the estimated annual billings.

Refund of deposit. - If service is not connected, or after disconnection of service, the utility will promptly refund the customer's deposit plus accrued interest or the balance, if any, in excess of the unpaid bills for service furnished. The utility may refund the deposit at any time prior to termination of utility service but must refund the deposit plus interest for any customer who has paid 18 consecutive billings without being delinquent.

SECTION 2.0 -- SERVICE RULES AND POLICIES

(B) Tap or Reconnect Fees

A new customer requesting service at a location where service has not previously been provided must pay a tap fee as provided in Section 1. A customer requesting service where service has previously been provided must pay a reconnect fee as provided in Section 1. Any applicant or existing customer required to pay for any costs not specifically set forth in the rate schedule pages of this tariff shall be given a written explanation of such costs prior to request for payment and/or commencement of construction. If the applicant or existing customer does not believe that these costs are reasonable or necessary, the applicant or existing customer shall be informed of their right to appeal such costs to the PUC or such other regulatory authority having jurisdiction over the utility's rates in that portion of the utility's service area in which the applicant's or existing customer's property(ies) is located.

Fees in addition to the regular tap fee may be charged if listed specifically in Section 1 to cover unique costs not normally incurred as permitted by 30 TAC 24.86(a)(1)(C). For example, a road bore for customers outside a subdivision or residential area could be considered a unique cost.

(C) Easement Requirement

Where recorded public utility easements on the service applicant's property do not exist or public road right-of-way easements are not available to access the applicant's property, the Utility may require the applicant to provide it with a permanent recorded public utility easement on and across the applicant's real property sufficient to provide service to that applicant. Such easement(s) shall not be used for the construction of production, storage, transmission or pressure facilities unless they are needed for adequate service to that applicant.

Section 2.04 - Utility Response to Applications for Service

After the applicant has met all the requirements, conditions and regulations for service, the utility will install tap, meter and utility cut-off valve and/or take all necessary actions to initiate service. The utility will serve each qualified applicant for service within 5 working days unless line extensions or new facilities are required. If construction is required to fill the order and if it cannot be completed within 30 days, the utility will provide the applicant with a written explanation of the construction required and an expected date of service.

Except for good cause where service has previously been provided, service will be reconnected within one working day after the applicant has met the requirements for reconnection.

SECTION 2.0 -- SERVICE RULES AND POLICIES

Section 2.05 - Customer Responsibility

The customer will be responsible for furnishing and laying the necessary customer service pipe from the meter location to the place of consumption. Customers will not be allowed to use the utility's cutoff valve on the utility's side of the meter. Existing customers may install cutoff valves on their side of the meter and are encouraged to do so. All new customers may be required to install and maintain a cutoff valve on their side of the meter.

No direct connection between a public water supply system and any potential source of contamination or between a public water supply system and a private water source (ex. private well) will be allowed. A customer shall not connect, or allow any other person or party to connect, onto any water lines on his premises.

Section 2.06 - Customer Service Inspections

Applicants for new service connections or facilities which have undergone extensive plumbing modifications are required to furnish the utility a completed customer service inspection certificate. The inspection certificate shall certify that the establishment is in compliance with the Texas Commission on Environmental Quality (TCEQ) Rules and Regulations for Public Water Systems, Section 290.46(j). The Utility is not required to perform these inspections for the applicant/customer, but will assist the applicant/customer in locating and obtaining the services of a certified inspector.

Section 2.07 - Back Flow Prevention Devices

No water connection shall be allowed to any residence or establishment where an actual or potential contamination hazard exists unless the public water facilities are protected from contamination by either an approved air gap, backflow prevention assembly, or other approved device. The type of device or backflow prevention assembly required shall be determined by the specific potential hazard identified in 290.47(i) Appendix I, Assessment of Hazards and Selection of Assemblies of the TCEQ Rules and Regulations for Public Water Systems.

The use of a backflow prevention assembly at the service connection shall be considered as additional backflow protection and shall not negate the use of backflow protection on internal hazards as outlined and enforced by local plumbing codes. When a customer service inspection certificate indicates that an adequate internal cross-connection control program is in effect, backflow protection at the water service entrance or meter is not required.

At any residence or establishment where it has been determined by a customer service inspection, that there is no actual or potential contamination hazard, as referenced in Section 290.47(i) Appendix I, Assessment of Hazards and Selection of Assemblies of the TCEQ Rules and Regulations for Public Water Systems, then a backflow prevention assembly or device is not required. Outside hose bibs do require, at a minimum, the installation and maintenance of a working atmospheric vacuum breaker.

SECTION 2.0 -- SERVICE RULES AND POLICIES

All backflow prevention assemblies or devices shall be tested upon installation by a TCEQ certified backflow prevention assembly tester and certified to be operating within specifications. Backflow prevention assemblies which are installed to provide protection against health hazards must also be tested and certified to be operating within specifications at least annually by a certified backflow prevention assembly tester.

If the utility determines that a backflow prevention assembly or device is required, the utility will provide the customer or applicant with a list of TCEQ certified backflow prevention assembly testers. The customer will be responsible for the cost of installation and testing, if any, of backflow prevention assembly or device. The customer should contact several qualified installers to compare prices before installation. The customer must pay for any required maintenance and annual testing and must furnish a copy of the test results demonstrating that the assembly is functioning properly to the utility within 30 days after the anniversary date of the installation unless a different date is agreed upon.

Section 2.08 - Access to Customer's Premises

The utility will have the right of access to the customer's premises at all reasonable times for the purpose of installing, testing, inspecting or repairing water mains or other equipment used in connection with its provision of water service, or for the purpose of removing its property and disconnecting lines, and for all other purposes necessary to the operation of the utility system including inspecting the customer's plumbing for code, plumbing or tariff violations. The customer shall allow the utility and its personnel access to the customer's property to conduct any water quality tests or inspections required by law. Unless necessary to respond to equipment failure, leak or other condition creating an immediate threat to public health and safety or the continued provision of adequate utility service to others, such entry upon the customer's property shall be during normal business hours and the utility personnel will attempt to notify the customer that they will be working on the customer's property. The customer may require any utility representative, employee, contractor, or agent seeking to make such entry identify themselves, their affiliation with the utility, and the purpose of their entry.

All customers or service applicants shall provide access to meters and utility cutoff valves at all times reasonably necessary to conduct ordinary utility business and after normal business hours as needed to protect and preserve the integrity of the public drinking water supply.

Section 2.09 - Meter Requirements, Readings, and Testing

One meter is required for each residential, commercial, or industrial connection. All water sold by the utility will be billed based on meter measurements. The utility will provide, install, own and maintain meters to measure amounts of water consumed by its customers.

SECTION 2.0 -- SERVICE RULES AND POLICIES

Meters will be read at monthly intervals and as nearly as possible on the corresponding day of each monthly meter reading period unless otherwise authorized by the Commission.

Meter tests. The utility will, upon the request of a customer, and, if the customer so desires, in his or her presence or in that of his or her authorized representative, make without charge a test of the accuracy of the customer's meter. If the customer asks to observe the test, the test will be made during the utility's normal working hours at a time convenient to the customer.

Whenever possible, the test will be made on the customer's premises, but may, at the utility's discretion, be made at the utility's testing facility. If within a period of two years the customer requests a new test, the utility will make the test, but if the meter is found to be within the accuracy standards established by the American Water Works Association, the utility will charge the customer a fee which reflects the cost to test the meter up to a maximum \$25 for a residential customer. Following the completion of any requested test, the utility will promptly advise the customer of the date of removal of the meter, the date of the test, the result of the test, and who made the test.

Section 2.10 - Billing

(A) Regular Billing

Bills from the utility will be mailed monthly unless otherwise authorized by the Commission. The due date of bills for utility service will be at least sixteen (16) days from the date of issuance. The postmark on the bill or, if there is no postmark on the bill, the recorded date of mailing by the utility will constitute proof of the date of issuance. Payment for utility service is delinquent if full payment, including late fees and the regulatory assessment, is not received at the utility or the utility's authorized payment agency by 5:00 p.m. on the due date. If the due date falls on a holiday or weekend, the due date for payment purposes will be the next workday after the due date.

(B) Late Fees

A late penalty of either \$5.00 or 10.0% will be charged on bills received after the due date. The penalty on delinquent bills will not be applied to any balance to which the penalty was applied in a previous billing. The utility must maintain a record of the date of mailing to charge the late penalty.

(C) Information on Bill

Each bill will provide all information required by the PUC Rules. For each of the systems it operates, the utility will maintain and note on the monthly bill a local or toll-free telephone number (or numbers) to which customers can direct questions about their utility service.

(D) Prorated Bills - If service is interrupted or seriously impaired for 24 consecutive hours or more, the utility will prorate the monthly base bill in proportion to the time service was not available to reflect this loss of service.

SECTION 2.0 -- SERVICE RULES AND POLICIES

Section 2.11- Payments

All payments for utility service shall be delivered or mailed to the utility's business office. If the business office fails to receive payment prior to the time of noticed disconnection for non-payment of a delinquent account, service will be terminated as scheduled. Utility service crews shall not be allowed to collect payments on customer accounts in the field. Payment of an account by any means that has been dishonored and returned by the payer or payee's bank, shall be deemed to be delinquent. All returned payments must be redeemed with cash or valid money order. If a customer has two returned payments within a twelve month period, the customer shall be required to pay a deposit if one has not already been paid.

Section 2.12 - Service Disconnection

(A) With Notice

Utility service may be disconnected if the bill has not been paid in full by the date listed on the termination notice. The termination date must be at least 10 days after the notice is mailed or hand delivered.

The utility is encouraged to offer a deferred payment plan to a customer who cannot pay an outstanding bill in full and is willing to pay the balance in reasonable installments. However, a customer's utility service may be disconnected if a bill has not been paid or a deferred payment agreement entered into within 26 days from the date of issuance of a bill and if proper notice of termination has been given.

Notice of termination must be a separate mailing or hand delivery in accordance with the PUC Rules.

(B) Without Notice

Utility service may also be disconnected without notice for reasons as described in the PUC Rules.

Section 2.13 - Reconnection of Service

Utility personnel must be available during normal business hours to accept payments on the day service is disconnected and the following day unless service was disconnected at the customer's request or due to a hazardous condition.

Service will be reconnected within 36 hours after the past due bill, reconnect fees and any other outstanding charges are paid or the conditions which caused service to be disconnected are corrected.

SECTION 2.0 -- SERVICE RULES AND POLICIES

Section 2.14 - Service Interruptions

The utility will make all reasonable efforts to prevent interruptions of service. If interruptions occur, the utility will re-establish service within the shortest possible time. Except for momentary interruptions due to automatic equipment operations, the utility will keep a complete record of all interruptions, both emergency and scheduled and will notify the Commission in writing of any service interruptions affecting the entire system or any major division of the system lasting more than four hours. The notice will explain the cause of the interruptions.

Section 2.15 - Quality of Service

The utility will plan, furnish, and maintain production, treatment, storage, transmission, and distribution facilities of sufficient size and capacity to provide a continuous and adequate supply of water for all reasonable consumer uses. Unless otherwise authorized by the Commission, the utility will maintain facilities as described in the TCEQ Rules and Regulations for Public Water Systems.

Section 2.16 - Customer Complaints and Disputes

If a customer or applicant for service lodges a complaint, the utility will promptly make a suitable investigation and advise the complainant of the results. Service will not be disconnected pending completion of the investigation. If the complainant is dissatisfied with the utility's response, the utility must advise the complainant that he has recourse through the PUC complaint process. Pending resolution of a complaint, the commission may require continuation or restoration of service.

The utility will maintain a record of all complaints which shows the name and address of the complainant, the date and nature of the complaint and the adjustment or disposition thereof, for a period of two years after the final settlement of the complaint.

In the event of a dispute between a customer and a utility regarding any bill for utility service, the utility will conduct an investigation and report the results to the customer. If the dispute is not resolved, the utility will inform the customer that a complaint may be filed with the Commission.

Section 2.17 - Customer Liability

Customer shall be liable for any damage or injury to utility-owned property shown to be caused by the customer.

SECTION 3.0 -- EXTENSION POLICY

Section 3.01 - Standard Extension Requirements

Line Extension and Construction Charges: No Contribution in Aid of Construction may be required of any customer except as provided for in this approved extension policy.

The Utility is not required to extend service to any applicant outside of its certified service area and will only do so under terms and conditions mutually agreeable to the Utility and the applicant, in compliance with PUC rules and policies, and upon extension of the Utility's certified service area boundaries by the PUC.

The applicant for service will be given an itemized statement of the costs, options such as rebates to the customer, sharing of construction costs between the utility and the customer, or sharing of costs between the customer and other applicants prior to beginning construction.

Section 3.02 - Costs Utilities and Service Applicants Shall Bear

Within its certified area, the utility will pay the cost of the first 200 feet of any water main or distribution line necessary to extend service to an individual residential customer within a platted subdivision.

However, if the residential customer requesting service purchased the property after the developer was notified in writing of the need to provide facilities to the utility, the utility may charge for the first 200 feet. The utility must also be able to document that the developer of the subdivision refused to provide facilities compatible with the utility's facilities in accordance with the utility's approved extension policy after receiving a written request from the utility.

Residential customers will be charged the equivalent of the costs of extending service to their property from the nearest transmission or distribution line even if that line does not have adequate capacity to serve the customer. However, if the customer places unique, non-standard service demands upon the system, the customer may be charged the additional cost of extending service to and throughout their property, including the cost of all necessary transmission and storage facilities necessary to meet the service demands anticipated to be created by that property.

Unless an exception is granted by the PUC, the residential service applicant shall not be required to pay for costs of main extensions greater than 2" in diameter for water distribution and pressure wastewater collection lines and 6" in diameter for gravity wastewater lines.

Exceptions may be granted by the PUC if:

- adequate service cannot be provided to the applicant using the maximum line sizes listed due to distance or elevation, in which case, it shall be the utility's burden to justify that a larger diameter pipe is required for adequate service;

SECTION 3.0 -- EXTENSION POLICY (Continued)

- or larger minimum line sizes are required under subdivision platting requirements or building codes of municipalities within whose corporate limits or extraterritorial jurisdiction the point of use is located; or the residential service applicant is located outside the CCN service area.

If an exception is granted, the Utility shall establish a proportional cost plan for the specific extension or a rebate plan which may be limited to seven years to return the portion of the applicant's costs for overriding as new customers are added to ensure that future applicants for service on the line pay at least as much as the initial service applicant.

For purposes of determining the costs that service applicants shall pay, commercial customers with service demands greater than residential customer demands in the certified area, industrial, and wholesale customers shall be treated as developers. A service applicant requesting a one inch meter for a lawn sprinkler system to service a residential lot is not considered nonstandard service.

If an applicant requires service other than the standard service provided by the utility, such applicant will be required to pay all expenses incurred by the utility in excess of the expenses that would be incurred in providing the standard service and connection beyond 200 feet and throughout his property including the cost of all necessary transmission facilities.

The utility will bear the full cost of any over-sizing of water mains necessary to serve other customers in the immediate area. The individual residential customer shall not be charged for any additional production, storage, or treatment facilities. Contributions in aid of construction may not be required of individual residential customers for production, storage, treatment or transmission facilities unless otherwise approved by the Commission under this specific extension policy.

Section 3.03 - Contributions in Aid of Construction

Developers may be required to provide contributions in aid of construction in amounts sufficient to furnish the development with all facilities necessary to provide for reasonable local demand requirements and to comply with TCEQ minimum design criteria for facilities used in the production, transmission, pumping, or treatment of water or TCEQ minimum requirements. For purposes of this subsection, a developer is one who subdivides or requests more than two meters on a piece of property. Commercial, industrial, and wholesale customers will be treated as developers.

Any applicant who places unique or non-standard service demands on the system may be required to provide contributions in aid of construction for the actual costs of any additional facilities required to maintain compliance with the TCEQ minimum design criteria for water production, treatment, pumping, storage and transmission.

Any service extension to a subdivision (recorded or unrecorded) may be subject to the provisions and restrictions of 30 TAC 24.86(d).

SECTION 3.0 -- EXTENSION POLICY (Continued)

When a developer wishes to extend the system to prepare to service multiple new connections, the charge shall be the cost of such extension, plus a pro-rata charge for facilities which must be committed to such extension compliant with the TCEQ minimum design criteria. As provided by 30 TAC 24.85(e)(3), for purposes of this section, commercial, industrial, and wholesale customers shall be treated as developers.

A utility may only charge a developer standby fees for unrecovered costs of facilities committed to a developer's property under the following circumstances:

- Under a contract and only in accordance with the terms of the contract; or
- if service is not being provided to a lot or lots within two years after installation of facilities necessary to provide service to the lots has been completed and if the standby fees are included on the utility's approved tariff after a rate change application has been filed. The fees cannot be billed to the developer or collected until the standby fees have been approved by the commission or executive director.
- for purposes of this section, a manufactured housing rental community can only be charged standby fees under a contract or if the utility installs the facilities necessary to provide individually metered service to each of the rental lots or spaces in the community.

Section 3.04 - Appealing Connection Costs

The imposition of additional extension costs or charges as provided by Sections 3.0 - Extension Policy of this tariff shall be subject to appeal as provided in this tariff, PUC rules, or the rules of such other regulatory authority as may have jurisdiction over the utility's rates and services. Any applicant required to pay for any costs not specifically set forth in the rate schedule pages of this tariff shall be given a written explanation of such costs prior to payment and/or commencement of construction. If the applicant does not believe that these costs are reasonable or necessary, the applicant shall be informed of the right to appeal such costs to the PUC or such other regulatory authority having jurisdiction over the utility's rates in that portion of the utility's service area in which the applicant's property(is) is located.

Section 3.05 - Applying for Service

The Utility will provide a written service application form to the applicant for each request for service received by the Utility's business offices. A separate application shall be required for each potential service location if more than one service connection is desired by any individual applicant. Service application forms will be available at the Utility's business office during normal weekday business hours. Service applications will be sent by prepaid first class United States mail to the address provided by the applicant upon request. Completed applications should be returned by hand delivery in case there are questions which might delay fulfilling the service request. Completed service applications may be submitted by mail if hand delivery is not possible.

SECTION 3.0 -- EXTENSION POLICY (Continued)

Where a new tap or service connection is required, the service applicant shall be required to submit a written service application and request that a tap be made. A diagram, map, plat, or written metes and bounds description of precisely where the applicant desires each tap or service connection is to be made and, if necessary, where the meter is to be installed, along the applicant's property line may also be required with the tap request. The actual point of connection and meter installation must be readily accessible to Utility personnel for inspection, servicing, and meter reading while being reasonably secure from damage by vehicles and mowers. If the Utility has more than one main adjacent to the service applicant's property, the tap or service connection will be made to the Utility's nearest service main with adequate capacity to service the applicant's full potential service demand. Beyond the initial 200 feet, the customer shall bear only the equivalent cost of extending from the nearest main. If the tap or service connection cannot be made at the applicant's desired location, it will be made at another location mutually acceptable to the applicant and the Utility. If no agreement on location can be made, the applicant may refer the matter to the PUC for resolution.

Section 3.06 - Qualified Service Applicant

A "qualified service applicant" is an applicant who has: (1) met all of the Utility's requirements for service contained in this tariff, PUC rules and/or PUC order, (2) has made payment or made arrangement for payment of tap fees, (3) has provided all easements and rights-of-way required to provide service to the requested location, (4) delivered an executed customer service inspection certificate to the Utility, if applicable, and (5) has executed a customer service application for each location to which service is being requested.

The Utility shall serve each qualified service applicant within its certified service area as soon as practical after receiving a completed service application. All service requests will be fulfilled within the time limits prescribed by PUC rules once the applicant has met all conditions precedent to achieving "qualified service applicant" status. If a service request cannot be fulfilled within the required period, the applicant shall be notified in writing of the delay, its cause and the anticipated date that service will be available. The PUC service dates shall not become applicable until the service applicant has met all conditions precedent to becoming a qualified service applicant as defined by PUC rules.

Section 3.07 - Developer Requirements

As a condition of service to a new subdivision, the Utility shall require a developer (as defined by PUC rule) to provide permanent recorded public utility easements as a condition of service to any location within the developer's property.

SECTION 4.0 -- DROUGHT CONTINGENCY PLAN
(Utility must attach copy of TCEQ approved Drought Contingency Plan)

APPENDIX A -- SAMPLE SERVICE AGREEMENT

From 30 TAC Chapter 290.47(b), Appendix B

SERVICE AGREEMENT

- I. **PURPOSE.** The NAME OF WATER SYSTEM is responsible for protecting the drinking water supply from contamination or pollution which could result from improper private water distribution system construction or configuration. The purpose of this service agreement is to notify each customer of the restrictions which are in place to provide this protection. The utility enforces these restrictions to ensure the public health and welfare. Each customer must sign this agreement before the NAME OF WATER SYSTEM will begin service. In addition, when service to an existing connection has been suspended or terminated, the water system will not re-establish service unless it has a signed copy of this agreement.
- II. **RESTRICTIONS** The following unacceptable practices are prohibited by State regulations.
 - A. No direct connection between the public drinking water supply and a potential source of contamination is permitted. Potential sources of contamination shall be isolated from the public water system by an air-gap or an appropriate backflow prevention device.
 - B. No cross-connection between the public drinking water supply and a private water system is permitted. These potential threats to the public drinking water supply shall be eliminated at the service connection by the installation of an air-gap or a reduced pressure-zone backflow prevention device.
 - C. No connection which allows water to be returned to the public drinking water supply is permitted.
 - D. No pipe or pipe fitting which contains more than 8.0% lead may be used for the installation or repair of plumbing at any connection which provides water for human use.
 - E. No solder or flux which contains more than 0.2% lead can be used for the installation or repair of plumbing at any connection which provides water for human use.
- III. **SERVICE AGREEMENT** The following are the terms of the service agreement between the NAME OF WATER SYSTEM (the Water System) and NAME OF CUSTOMER (the Customer).
 - A. The Water System will maintain a copy of this agreement as long as the Customer and/or the premises is connected to the Water System.
 - B. The Customer shall allow his property to be inspected for possible cross-connections and other potential contamination hazards. These inspections shall be conducted by the Water System or its designated agent prior to initiating new water service; when there is reason to believe that cross-connections or other potential contamination hazards exist; or after

any major changes to the private water distribution facilities. The inspections shall be conducted during the Water System's normal business hours.

- C. The Water System shall notify the Customer in writing of any cross-connection or other potential contamination hazard which has been identified during the initial inspection or the periodic re-inspection.
- D. The Customer shall immediately remove or adequately isolate any potential cross-connections or other potential contamination hazards on his premises.
- E. The Customer shall, at his expense, properly install, test, and maintain any backflow prevention device required by the Water System. Copies of all testing and maintenance records shall be provided to the Water System.

IV. ENFORCEMENT If the Customer fails to comply with the terms of the Service Agreement, the Water System shall, at its option, either terminate service or properly install, test, and maintain an appropriate backflow prevention device at the service connection. Any expenses associated with the enforcement of this agreement shall be billed to the Customer.

CUSTOMER'S
SIGNATURE:_____

DATE:_____

**APPENDIX B -- APPLICATION FOR SERVICE
(Utility Must Attach Blank Copy)**