

## Loan Summary

Principal:	\$954000
Interest Rate:	3.57%
Loan Term:	20 years

## Payment Summary

Number of Payments:	240
<b>Monthly Payment:</b>	<b>\$5,567.19</b>
Total Principal Paid:	\$954,000.00
Total Interest Paid:	\$382,126.26
<b>Total Paid:</b>	<b>\$1,336,126.26</b>

## Yearly Amortization Schedule

Payments	Yearly Total	Principal Paid	Interest Paid	Balance
Year 1 (1-12)	\$66,806.31	\$33,289.71	\$33,516.60	\$920,710.29
Year 2 (13-24)	\$66,806.31	\$34,497.79	\$32,308.52	\$886,212.50
Year 3 (25-36)	\$66,806.31	\$35,749.72	\$31,056.60	\$850,462.78
Year 4 (37-48)	\$66,806.31	\$37,047.07	\$29,759.24	\$813,415.71
Year 5 (49-60)	\$66,806.31	\$38,391.51	\$28,414.80	\$775,024.20
Year 6 (61-72)	\$66,806.31	\$39,784.74	\$27,021.58	\$735,239.46
Year 7 (73-84)	\$66,806.31	\$41,228.52	\$25,577.79	\$694,010.94
Year 8 (85-96)	\$66,806.31	\$42,724.71	\$24,081.61	\$651,286.23
Year 9 (97-108)	\$66,806.31	\$44,275.18	\$22,531.13	\$607,011.05
Year 10 (109-120)	\$66,806.31	\$45,881.93	\$20,924.38	\$561,129.12
Year 11 (121-132)	\$66,806.31	\$47,546.98	\$19,259.33	\$513,582.13
Year 12 (133-144)	\$66,806.31	\$49,272.46	\$17,533.85	\$464,309.67
Year 13 (145-156)	\$66,806.31	\$51,060.56	\$15,745.75	\$413,249.11

Year 14 (157-168)	\$66,806.31	\$52,913.55	\$13,892.77	\$360,335.57
Year 15 (169-180)	\$66,806.31	\$54,833.78	\$11,972.54	\$305,501.79
Year 16 (181-192)	\$66,806.31	\$56,823.69	\$9,982.62	\$248,678.10
Year 17 (193-204)	\$66,806.31	\$58,885.82	\$7,920.49	\$189,792.27
Year 18 (205-216)	\$66,806.31	\$61,022.79	\$5,783.53	\$128,769.49
Year 19 (217-228)	\$66,806.31	\$63,237.30	\$3,569.01	\$65,532.18
Year 20 (229-240)	\$66,806.31	\$65,532.18	\$1,274.13	\$0.00
<b>Totals</b>	<b>\$1,336,126.26</b>	<b>\$954,000.00</b>	<b>\$382,126.26</b>	



## Water Utilities Map Viewer

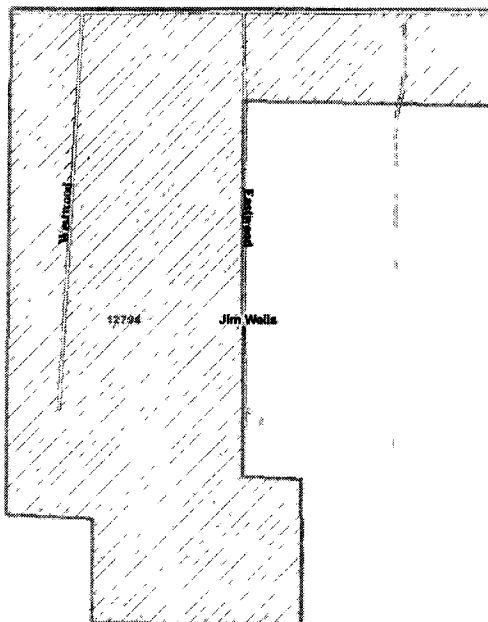

Legend

stis  
 V Facility Lines  
 V Facility Lines  
 V Service Areas  
 V Service Areas  
 es  
 pions  
 istincts  
 stricts

District (DD)  
 or Supply District (FWSD)  
 District (ID)  
 rovement District (LID)  
 Management District (MMD)  
 Ip determining utility

Data

Search by ONE of the following:

City	<input type="text" value="Enter City Name"/>	<input type="button" value="Find City"/>	
County	<input type="text" value="Enter County Name"/>	<input type="button" value="Find County"/>	
Zip Code	<input type="text" value="Enter Zip Code"/>	<input type="button" value="Find Zip Code"/>	
CCN #	<input type="text" value="Water Service Areas"/>	<input type="button" value="Find CCN"/>	
Water District	<input type="text" value="Enter Water District Name"/>	<input type="button" value="Find Water District"/>	
Address	<input type="text" value="Enter Street"/>	<input type="button" value="Find Address"/>	
Intersection	<input type="text" value="Enter Street1"/>	<input type="button" value="Find Intersection"/>	
Lat - Long	<input type="text" value="Enter Latitude"/>	<input type="button" value="Find Lat-Long"/>	

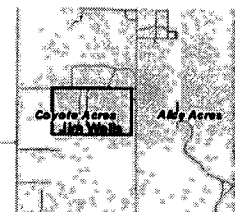



CENSUS DATA FOR ENGLISH ACRES

Legend:

Boundaries

- ☐ State
- ☐ '10 County
- ☐ '10 Census Tract
- ☐ '10 Block Group

Features

- Major Road
- Street
- Stream/Waterbody

Items in grey text are not visible at this zoom level

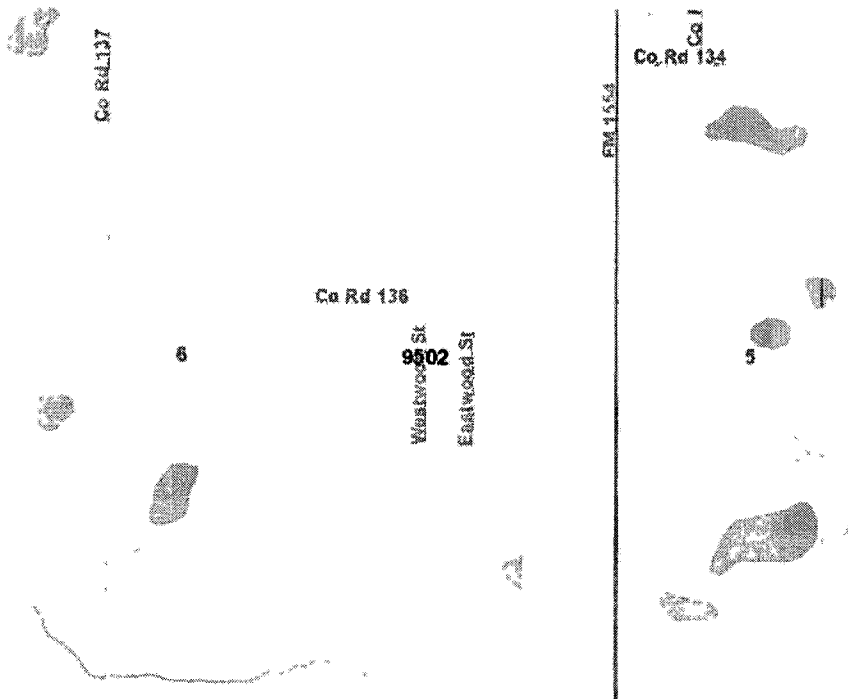

**Disadvantaged Community Calculations - English Acres Infrastructure Upgrades**

A	B	K	L	M	C	D	E	H	F	G	I	J	
	2010 Census Block Group	2010 Census Total Block Group Area (acres)	Service Area within Block Group (acres)	% of Block Group within Service Area (LK)	2010 Census population	2007-2011 ACS 5-year Estimates (AMHI)	2007-2011 ACS 5-year Estimates Average Household Size	Entity's 2010 Population (MxC)	Number of Households (H/E)	Households as a % of Total Households (Connections)	Entity's 2010 AMHI (DxG)	Entity's 2010 Average Household Size (ExG)	County
9502	6	8336	96	1.14%	1255	\$ 44,237	3.44	14	4	0.35%	\$ 154.1	0.0120	Jim Wells
						\$ 44,237	3.44	14	4	0.35%	\$ 154.1	0.0120	

AMERICAN

FactFinder



P1

TOTAL POPULATION  
Universe: Total population  
2010 Census Summary File 1

NOTE: For information on confidentiality protection, nonsampling error, and definitions, see <http://www.census.gov/prod/cen2010/doc/sf1.pdf>.

	Block Group 1, Census Tract 9501, Jim Wells County, Texas	Block Group 2, Census Tract 9501, Jim Wells County, Texas	Block Group 3, Census Tract 9501, Jim Wells County, Texas	Block Group 4, Census Tract 9501, Jim Wells County, Texas	Block Group 1, Census Tract 9502, Jim Wells County, Texas
Total	1,143	3,473	2,772	705	962

	Block Group 2, Census Tract 9502, Jim Wells County, Texas	Block Group 3, Census Tract 9502, Jim Wells County, Texas	Block Group 4, Census Tract 9502, Jim Wells County, Texas	Block Group 5, Census Tract 9502, Jim Wells County, Texas	Block Group 6, Census Tract 9502, Jim Wells County, Texas
Total	1,541	906	1,493	1,775	1,255

	Block Group 1, Census Tract 9503, Jim Wells County, Texas	Block Group 2, Census Tract 9503, Jim Wells County, Texas	Block Group 3, Census Tract 9503, Jim Wells County, Texas	Block Group 4, Census Tract 9503, Jim Wells County, Texas	Block Group 5, Census Tract 9503, Jim Wells County, Texas
Total	1,160	801	1,055	1,022	1,413





B25010

## AVERAGE HOUSEHOLD SIZE OF OCCUPIED HOUSING UNITS BY TENURE

Universe: Occupied housing units

2007-2011 American Community Survey 5-Year Estimates

Supporting documentation on code lists, subject definitions, data accuracy, and statistical testing can be found on the American Community Survey website in the Data and Documentation section.

Sample size and data quality measures (including coverage rates, allocation rates, and response rates) can be found on the American Community Survey website in the Methodology section.

Although the American Community Survey (ACS) produces population, demographic and housing unit estimates, it is the Census Bureau's Population Estimates Program that produces and disseminates the official estimates of the population for the nation, states, counties, cities and towns and estimates of housing units for states and counties.

Census Tract 9502, Jim Wells		
County, Texas		
	Estimate	Margin of Error
Total:	3.44	+/-0.24
Owner occupied	3.55	+/-0.29
Renter occupied	2.93	+/-0.52

Data are based on a sample and are subject to sampling variability. The degree of uncertainty for an estimate arising from sampling variability is represented through the use of a margin of error. The value shown here is the 90 percent margin of error. The margin of error can be interpreted roughly as providing a 90 percent probability that the interval defined by the estimate minus the margin of error and the estimate plus the margin of error (the lower and upper confidence bounds) contains the true value. In addition to sampling variability, the ACS estimates are subject to nonsampling error (for a discussion of nonsampling variability, see Accuracy of the Data). The effect of nonsampling error is not represented in these tables.

While the 2007-2011 American Community Survey (ACS) data generally reflect the December 2009 Office of Management and Budget (OMB) definitions of metropolitan and micropolitan statistical areas; in certain instances the names, codes, and boundaries of the principal cities shown in ACS tables may differ from the OMB definitions due to differences in the effective dates of the geographic entities.

Estimates of urban and rural population, housing units, and characteristics reflect boundaries of urban areas defined based on Census 2000 data. Boundaries for urban areas have not been updated since Census 2000. As a result, data for urban and rural areas from the ACS do not necessarily reflect the results of ongoing urbanization.

Source: U.S. Census Bureau, 2007-2011 American Community Survey

## Explanation of Symbols:

1. An '\*\*\*' entry in the margin of error column indicates that either no sample observations or too few sample observations were available to compute a standard error and thus the margin of error. A statistical test is not appropriate.
2. An '-' entry in the estimate column indicates that either no sample observations or too few sample observations were available to compute an estimate, or a ratio of medians cannot be calculated because one or both of the median estimates falls in the lowest interval or upper interval of an open-ended distribution.
3. An '-' following a median estimate means the median falls in the lowest interval of an open-ended distribution.
4. An '+' following a median estimate means the median falls in the upper interval of an open-ended distribution.
5. An '\*\*\*' entry in the margin of error column indicates that the median falls in the lowest interval or upper interval of an open-ended distribution. A statistical test is not appropriate.
6. An '\*\*\*\*\*' entry in the margin of error column indicates that the estimate is controlled. A statistical test for sampling variability is not appropriate.
7. An 'N' entry in the estimate and margin of error columns indicates that data for this geographic area cannot be displayed because the number of sample cases is too small.
8. An '(X)' means that the estimate is not applicable or not available.



B19013

# MEDIAN HOUSEHOLD INCOME IN THE PAST 12 MONTHS (IN 2011 INFLATION-ADJUSTED DOLLARS)

Universe: Households

2007-2011 American Community Survey 5-Year Estimates

Supporting documentation on code lists, subject definitions, data accuracy, and statistical testing can be found on the American Community Survey website in the Data and Documentation section.

Sample size and data quality measures (including coverage rates, allocation rates, and response rates) can be found on the American Community Survey website in the Methodology section.

Although the American Community Survey (ACS) produces population, demographic and housing unit estimates, it is the Census Bureau's Population Estimates Program that produces and disseminates the official estimates of the population for the nation, states, counties, cities and towns and estimates of housing units for states and counties.

		Census Tract 9502, Jim Wells County, Texas	
Median household income in the past 12 months (in 2011 inflation-adjusted dollars)		Estimate	Margin of Error
		44,237	+/-8,248

Data are based on a sample and are subject to sampling variability. The degree of uncertainty for an estimate arising from sampling variability is represented through the use of a margin of error. The value shown here is the 90 percent margin of error. The margin of error can be interpreted roughly as providing a 90 percent probability that the interval defined by the estimate minus the margin of error and the estimate plus the margin of error (the lower and upper confidence bounds) contains the true value. In addition to sampling variability, the ACS estimates are subject to nonsampling error (for a discussion of nonsampling variability, see Accuracy of the Data). The effect of nonsampling error is not represented in these tables.

The methodology for calculating median income and median earnings changed between 2008 and 2009. Medians over \$75,000 were most likely affected. The underlying income and earning distribution now uses \$2,500 increments up to \$250,000 for households, non-family households, families, and individuals and employs a linear interpolation method for median calculations. Before 2009 the highest income category was \$200,000 for households, families and non-family households (\$100,000 for individuals) and portions of the income and earnings distribution contained intervals wider than \$2,500. Those cases used a Pareto Interpolation Method.

While the 2007-2011 American Community Survey (ACS) data generally reflect the December 2009 Office of Management and Budget (OMB) definitions of metropolitan and micropolitan statistical areas; in certain instances the names, codes, and boundaries of the principal cities shown in ACS tables may differ from the OMB definitions due to differences in the effective dates of the geographic entities.

Estimates of urban and rural population, housing units, and characteristics reflect boundaries of urban areas defined based on Census 2000 data. Boundaries for urban areas have not been updated since Census 2000. As a result, data for urban and rural areas from the ACS do not necessarily reflect the results of ongoing urbanization.

Source: U.S. Census Bureau, 2007-2011 American Community Survey

## Explanation of Symbols:

1. An "\*\*\*" entry in the margin of error column indicates that either no sample observations or too few sample observations were available to compute a standard error and thus the margin of error. A statistical test is not appropriate.
2. An "-" entry in the estimate column indicates that either no sample observations or too few sample observations were available to compute an estimate, or a ratio of medians cannot be calculated because one or both of the median estimates falls in the lowest interval or upper interval of an open-ended distribution.
3. An "-" following a median estimate means the median falls in the lowest interval of an open-ended distribution.
4. An "+" following a median estimate means the median falls in the upper interval of an open-ended distribution.
5. An "\*\*\*\*" entry in the margin of error column indicates that the median falls in the lowest interval or upper interval of an open-ended distribution. A statistical test is not appropriate.
6. An "\*\*\*\*\*" entry in the margin of error column indicates that the estimate is controlled. A statistical test for sampling variability is

Please refer to the  
original file to view  
additional  
documentation.

Align top of FedEx Express® Shipping Label here.

Express

Derby Inc

ORIGIN ID: FEA

SHIP DATE: 01MAR13  
ACTWT: 1.4 LB  
CWT: 0.0000  
DIM: 0.0000 IN  
STILL SENDER

UNITED STATES US  
TO ROSARIO FLORES  
TX WATER DEVELOP. BOARD  
1700 CONGRESS AVE

AUSTIN TX 78701  
(214) 891-0100

FedEx NEW  
Express

8025 2085 944

1 From  
Date

Sender's Name Phone

Company

Address

City State ZIP

2 Your Internal Billing Reference

3 To  
Recipient's Name Phone

Company

Address

Address

City State ZIP

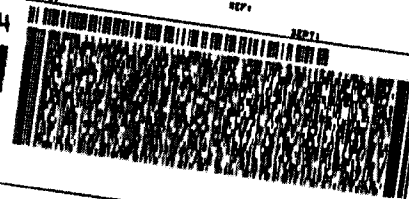

FedEx Express  
E

TRK# 0200 8025 2085 9449

B8 AUSA

MON - 04 MAR 10:30A  
PRIORITY OVERNIGHT  
DSR  
78701  
TX-US AUS



Total Charges Total Weight

644



8025 2085 9449

Align bottom of Peel and Stick Airbill or Pouch here.

## ENTITY INFORMATION/VIOLATIONS

■ [TCEQ Home](#)



## Public Water Systems Details/Data Sheet for ENGLISH ACRES (1250033)



### Responsible Party

Individual: **DON L ENGLISH**

Address: **PO BOX 314**

**MAGNOLIA, TX 77353-0314**

Individual: **LONZO J GALE**

Occurrences were successfully retrieved.

### Customers

#### Reference Number

CN601356124  
CN602811713

#### Name

ENGLISH, DON L  
GERALD ENGLISH ESTATES

#### Role

OWNER  
RESPONSIBLE PARTY

### Properties

Utility CCN/Reg: **(12794) ENGLISH ACRES**

CR Regulated Entity Number: **RN102670783**

CCEDS Status: **ACTIVE NOE EXISTS**

Ownership Type: **INVESTOR**

System Type: **COMMUNITY**

County: **JIM WELLS (125)**

Region: **CORPUS CHRISTI (14)**

All Monitoring Class: **GROUNDWATER**

Owned Monitoring Class: **GROUNDWATER**

Out of Season:

Jan ☐ Feb ☐ Mar ☐ Apr ☐ May ☐ Jun ☐ Jul ☐ Aug ☐ Sep ☐ Oct ☐ Nov ☐ Dec ☐

### Customer Groups

Class	Category	Population Count	Connection Count	Meter Count
RESIDENTIAL	RESIDENTIAL AREA	111	37	0

No occurrences retrieved.

### Capacity

#### Total Storage:

Total Storage: **0.007 MG**

Elevated Storage: **0.000 MG**

Pressure Tank Capacity: **0.00050 MG**

#### Production:

01/09/2013

**Texas Commission on Environmental Quality**

WSDSR

5:26:17PM

## Water System Data Sheet

PWS ID	PWS Name	Central Registry RN
<b>1250033</b>	<b>ENGLISH ACRES</b>	<b>RN102670783</b>

Organization/Customer *	Central Registry CN
<b>GERALD ENGLISH ESTATES</b>	<b>CN602811713</b>
<b>ENGLISH, DON L</b>	<b>CN601356124</b>

\* Regulatory mail will be addressed to this organization / person

Responsible Official **		Title	
<b>LONZO J GALE</b>			
License Type		License Number	
Mailing Address:			
Street Address		C/O or Address Line 2	
City		State	Zip
Business Phone		Other Phone	Other Phone Type

\*\* Regulatory mail will be addressed to this person

<b>No PWS Primary Contact assigned to this PWS</b>
--

<b>No Emergency Contact assigned to this PWS</b>
--

Owner Type	Owner Type Options: AFFECTED COUNTIES, COUNTY, DISTRICT/AUTHORITY, EXEMPT, FEDERAL GOVERNMENT, INVESTOR, MUNICIPALITY, NATIVE AMERICAN, PRIVATE, SUBMETER \ ALLOCATION, STATE GOVERNMENT, NOT RETAIL PUBLIC UTILITIES, WATER SUPPLY CORPORATION, MISC/UNKNOWN
<b>INVESTOR</b>	

System Type	System Type Options: SB 361, COMMUNITY, COMMUNITY (NON-GOVERNMENT OWNED), TRANSIENT/NON-COMMUNITY, NON-PUBLIC, NON-TRANSIENT/NON-COMMUNITY
<b>COMMUNITY</b>	

Customer Class	Customer Category	Population Served	# of Connect	# of Meters	# I/C w/other PWS
<b>RESIDENTIAL</b>	<b>RESIDENTIAL AREA</b>	<b>111</b>	<b>37</b>	<b>0</b>	<b>0</b>

Total Product (MGD)	Average Daily Consump.	Total Storage (MG)	Elev. Storage (MG)	Booster Pump Cap. (MGD)	Aux.Prod.Cap. Max.Pur.Cap.(MGD)	Pressure Tank Cap.(MG)
<b>0.036</b>	<b>0.006</b>	<b>0.007</b>	<b>0.000</b>	<b>0.086</b>	<b>0.000</b>	<b>0.00050</b>

Activity Status	Deactivation Date	Reason
<b>ACTIVE</b>		

Operator Grade	Number
----------------	--------

Last Survey Date	Surveyor	Survey Type	Code	Region	County	Def.Score
<b>12/22/2009</b>	<b>HECTOR GONZALES</b>	<b>SURVEY</b>		<b>14</b>	<b>JIM WELLS</b>	<b>47</b>
<b>12/08/2006</b>	<b>HECTOR GONZALES</b>	<b>SURVEY</b>		<b>14</b>	<b>JIM WELLS</b>	<b>41</b>
<b>11/05/2004</b>	<b>HECTOR GONZALES</b>	<b>SURVEY</b>		<b>14</b>	<b>JIM WELLS</b>	<b>45</b>



(Entry Point)							
Entry Point	EP Name/Source Summation (Activity Status)	Plant Name (Activity Status)	WUD Plant Num	Chemical Mon Type	Chem Sample Point	Distribution Mon Type	Dist Sample Point
001	SAMPLE TAP / GULF COAST(A)	WELL(A)	8313		No		No

Train:	(Unnamed)
--------	-----------

(Treatments)				
Disinfection Zone	Treatment Sequence	Objective	Process	Treatment
	1	D	421	HYPOCHLORINATION(POST)

(Active Sources)						
Source Number	Source Name (Activity Status)	Operational Status	Source Type	Depth	Tested GPM	Rated GPM
G1250033C	3 - CR 136 / FM1(A)	O	G	0	0	0
Drill Date		Well Data				
0/0/2007						
GPS Latitude (decimal)	GPS Longitude (decimal)	GPS Elevation	GPS Date	GPS Cert. No.	Seller	
Not Available	Not Available	Not Available	Not Available	Not Available		

(Inactive/Offline Sources)			
SourceNumber	Name	Status	Depth
G1250033A	1 - CR 136	A	500
G1250033B	2 - CR 136 S OF OLD DAIRY BARN	A	0

Code Explanations	
Monitoring Type Codes: (GW) GROUNDWATER, (GWP) GROUNDWATER - PURCHASED, (GUP) GROUNDWATER UNDER THE INFLUENCE - PURCHASED, (SWP) SURFACE WATER - PURCHASED, (GU) GROUNDWATER UNDER THE INFLUENCE OF SURFACE WATER, (N) NO SOURCES, (SW) SURFACE WATER	
Activity Status Codes: (A) ACTIVE, (C) CCN CANCELLED, (D) DELETED/DISSOLVED, (G) SB 361, (I) INACTIVE, (M) MERGED/ANNEXED, (N) NON-PUBLIC, (P) PROPOSED, (U) UNKNOWN-NO ACTIVITY OR NON-RESPONSIVE, (W) UTILITY WATER SYS XFER	
Operational Status Codes: (C) CAPPED, (D) DEMAND, (E) EMERGENCY, (F) FORMER PWS SOURCE, (I) INACTIVE PWS SYSTEM, (N) NON-DRINKING WATER, (O) OPERATING, (P) PLUGGED, (T) TEST, (Y) PWS NOT ACTIVE AND NOT EXPECTED TO BE SO	
Source Types: (G) GROUND WATER, (S) SURFACE WATER, (U) GROUND WATER UNDER THE INFLUENCE	

- End of Report -

The Texas Commission on Environmental Quality is pleased to provide this information to you free of charge. Please understand that we cannot guarantee the accuracy or completeness of the information being supplied. At the time of your query this data was the most current information available from our database, which is updated weekly. Every effort was made to retrieve it according to your query. Thank-you for using WUD.

■ [TCEQ Home](#)

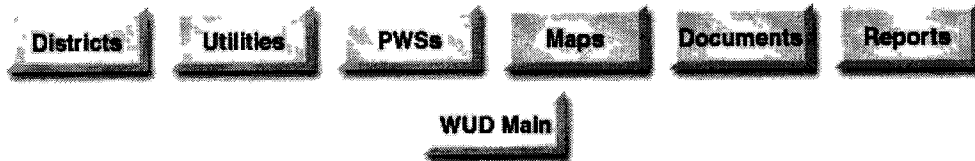

## Violations for ENGLISH ACRES (PWSID: 1250033)

Violation Type	Violation Type Name	Analyte Type	Period Code	Year	Period Begin	Period End
23	<u>MONITORING, ROUTINE MAJOR (TCR)</u>	COLIFORM (TCR)	M07	2007	07/01/2007	07/31/2007
23	<u>MONITORING, ROUTINE MAJOR (TCR)</u>	COLIFORM (TCR)	M06	2007	06/01/2007	06/30/2007
23	<u>MONITORING, ROUTINE MAJOR (TCR)</u>	COLIFORM (TCR)	M05	2007	05/01/2007	05/31/2007
23	<u>MONITORING, ROUTINE MAJOR (TCR)</u>	COLIFORM (TCR)	M04	2007	04/01/2007	04/30/2007
23	<u>MONITORING, ROUTINE MAJOR (TCR)</u>	COLIFORM (TCR)	M03	2007	03/01/2007	03/31/2007
23	<u>MONITORING, ROUTINE MAJOR (TCR)</u>	COLIFORM (TCR)	M02	2007	02/01/2007	02/28/2007
23	<u>MONITORING, ROUTINE MAJOR (TCR)</u>	COLIFORM (TCR)	M01	2007	01/01/2007	01/31/2007
23	<u>MONITORING, ROUTINE MAJOR (TCR)</u>	COLIFORM (TCR)	M11	2006	11/01/2006	11/30/2006
23	<u>MONITORING, ROUTINE MAJOR (TCR)</u>	COLIFORM (TCR)	M11	2005	11/01/2005	11/30/2005
23	<u>MONITORING, ROUTINE MAJOR (TCR)</u>	COLIFORM (TCR)	M10	2005	10/01/2005	10/31/2005
23	<u>MONITORING, ROUTINE MAJOR (TCR)</u>	COLIFORM (TCR)	M09	2005	09/01/2005	09/30/2005
23	<u>MONITORING, ROUTINE MAJOR (TCR)</u>	COLIFORM (TCR)	M08	2005	08/01/2005	08/31/2005
23	<u>MONITORING, ROUTINE MAJOR (TCR)</u>	COLIFORM (TCR)	M07	2005	07/01/2005	07/31/2005
23	<u>MONITORING, ROUTINE MAJOR (TCR)</u>	COLIFORM (TCR)	M01	2003	01/01/2003	01/31/2003
71	<u>CCR COMPLETE FAILURE TO REPORT</u>	CONSUMER CONFIDENCE REPORTS RULE			07/01/2002	12/31/3000
71	<u>CCR COMPLETE FAILURE TO REPORT</u>	CONSUMER CONFIDENCE REPORTS RULE			07/01/2003	12/31/3000
71	<u>CCR COMPLETE FAILURE TO REPORT</u>	CONSUMER CONFIDENCE REPORTS RULE			07/01/2004	12/31/3000
71	<u>CCR COMPLETE FAILURE TO REPORT</u>	CONSUMER CONFIDENCE REPORTS RULE			07/01/2005	12/31/3000
75	<u>PN VIOLATION FOR AN NPDWR VIOLATION</u>	PUBLIC NOTICE RULE			05/01/2003	12/31/3000
75	<u>PN VIOLATION FOR AN NPDWR VIOLATION</u>	PUBLIC NOTICE RULE			11/01/2005	12/31/3000
75	<u>PN VIOLATION FOR AN NPDWR VIOLATION</u>	PUBLIC NOTICE RULE			01/01/2006	12/31/3000
75	<u>PN VIOLATION FOR AN NPDWR VIOLATION</u>	PUBLIC NOTICE RULE			02/01/2006	12/31/3000
75	<u>PN VIOLATION FOR AN NPDWR VIOLATION</u>	PUBLIC NOTICE RULE			12/01/2005	12/31/3000
75	<u>PN VIOLATION FOR AN NPDWR VIOLATION</u>	PUBLIC NOTICE RULE			03/01/2006	12/31/3000
75	<u>PN VIOLATION FOR AN NPDWR VIOLATION</u>	PUBLIC NOTICE RULE			03/01/2007	12/31/3000
75	<u>PN VIOLATION FOR AN NPDWR VIOLATION</u>	PUBLIC NOTICE RULE			05/01/2007	12/31/3000
75	<u>PN VIOLATION FOR AN NPDWR VIOLATION</u>	PUBLIC NOTICE RULE			06/01/2007	12/31/3000
75	<u>PN VIOLATION FOR AN NPDWR VIOLATION</u>	PUBLIC NOTICE RULE			07/01/2007	12/31/3000
75	<u>PN VIOLATION FOR AN NPDWR VIOLATION</u>	PUBLIC NOTICE RULE			08/01/2007	12/31/3000
75	<u>PN VIOLATION FOR AN NPDWR VIOLATION</u>	PUBLIC NOTICE RULE			11/01/2007	12/31/3000
75	<u>PN VIOLATION FOR AN NPDWR VIOLATION</u>	PUBLIC NOTICE RULE			10/01/2007	12/31/3000

■ [TCEQ Home](#)

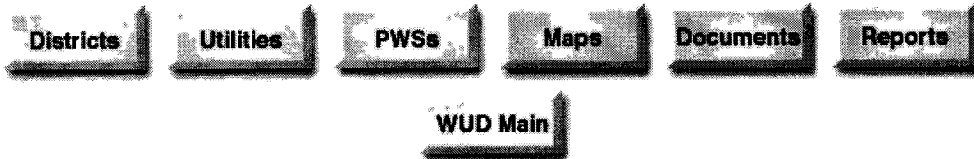

## ? Document for ENGLISH ACRES (12794)

### Document Type

Name: **ANNUAL REPORTS**

Description: **Annual Report**

Document Status: **Closed**



### Values

PROVIDE YEAR OF ANNUAL REPORT	2011
REVENUES WATER-UTILITY SERVICE/SALES	15216
REVENUES WATER-FEES (TAP, RECONNECTION)	\$0.00
OTHER REVENUES: PLEASE IDENTIFY	
OTHER REVENUES: WATER	\$0.00
TOTAL REVENUES WATER	\$15,216.00
REVENUES SEWER-UTILITY SERVICE/SALES	\$0.00
REVENUES SEWER-FEES (TAP, RECONNECTION)	\$0.00
OTHER REVENUES: SEWER	\$0.00
TOTAL REVENUES SEWER	\$0.00
TOTAL WATER & SEWER-UTILITY SERVICE/SALE	\$0.00
TOTAL WATER & SEWER: FEES (TAPS, RECON)	\$0.00
TOTAL WATER & SEWER: OTHER REVENUES	\$0.00
TOTAL WATER & SEWER: TOTAL REVENUES	\$15,216.00
WATER-SALARIES & WAGES	\$0.00
WATER-CONTRACT LABOR	\$15,795.00
WATER-PURCHASED WATER	\$0.00
WATER-CHEMICALS FOR TREATMENT	\$454.00
WATER-UTILITIES (ELECTRICITY)	\$5,310.00
WATER-REPAIRS/MAINTENANCE/SUPPLIES	\$14,079.00
WATER-OFFICE EXPENSES	\$1,135.00
WATER-PROFESSIONAL FEES (ACCOUNTING,LEG)	\$0.00
WATER-INSURANCE	\$0.00
WATER-DEPRECIATION & AMORTIZATION	\$0.00
WATER-MISCELLANEOUS	\$2,085.00
WATER-FEDERAL INCOME TAXES	\$0.00
WATER-PROPERTY AND OTHER TAXES (PAYROLL)	\$0.00
WATER-REGULATORY EXPENSES (RATE CASE)	\$0.00
WATER-OTHER	\$0.00
WATER-TOTAL EXPENSES	\$38,858.00
WASTEWATER-SALARIES & WAGES	\$0.00
WASTEWATER-CONTRACT LABOR	\$0.00
WASTEWATER-PURCHASED WATER	\$0.00
WASTEWATER-CHEMICALS FOR TREATMENT	\$0.00
WASTEWATER-UTILITIES (ELECTRICITY)	\$0.00
WASTEWATER-REPAIRS/MAINTENANCE/SUPPLIES	\$0.00
WASTEWATER-OFFICE EXPENSES	\$0.00
WASTEWATER-PROFESSIONAL FEES (ACCOUNTIN)	\$0.00
WASTEWATER-INSURANCE	\$0.00
WASTEWATER-DEPRECIATION & AMORTIZATION	\$0.00
WASTEWATER-MISCELLANEOUS	\$0.00

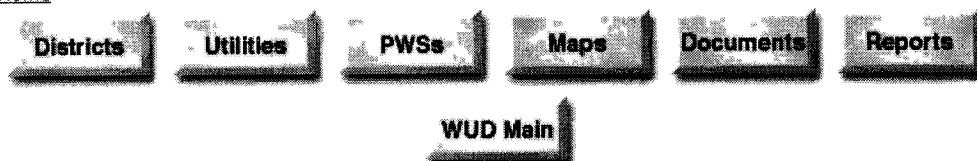
[TCEQ Home](#)

## Utility details for ENGLISH ACRES (12794)

 **Affiliations**  **Documents**

### Properties

CR Regulated Entity Number: **RN101229037**

CCEDS Status: **NO ACTIVE NOE EXISTS**

Utility Type: **WATER UTILITY**

Ownership Type: **INVESTOR**

Primary County: **JIM WELLS**

County Code: **125**

### Customers

**Reference Number**  
CN602811713

**Name**  
GERALD ENGLISH ESTATES

**Role**  
RESPONSIBLE PARTY

### Official Address / Phone

Address: **PO BOX 314**

**MAGNOLIA , TEXAS 77353-0000**

Telephone: **(832) 934-2200**

### PWS for this Utility

<b>PWS Name</b>	<b>PWS ID</b>	<b>Status</b>	<b>District(Number)</b>
<u>ENGLISH ACRES</u>	1250033	A	

Water System occurrences retrieved.

### Counties

<b>Code</b>	<b>County Name</b>	<b>Primary</b>
125	JIM WELLS	Y

### Activity

Activity Status: **ACTIVE**

Start Date: **01/07/2010**

End Date: **12/31/3000**

Activity Date: **01/07/2010**

Activity Reason: **APPLICATION**

[Run Utility Summary Report](#)  
[Show Map](#)

Utility successfully retrieved.

# RATE STRUCTURE

CURRENTLY THE SUSTOMERS ARE PAYING A  
FLAT RATE OF \$71 PER MONTH. THE SAME  
RATE STRUCTURE WILL BE CONTINUED FOR  
A WHILE AND WILL BE REVISED AFTER  
INSTALLATION OF WATER METERS AND  
BASED ON THE SYSTEM REQUIREMENTS.

# CCN MAP



## Water Utilities Map Viewer

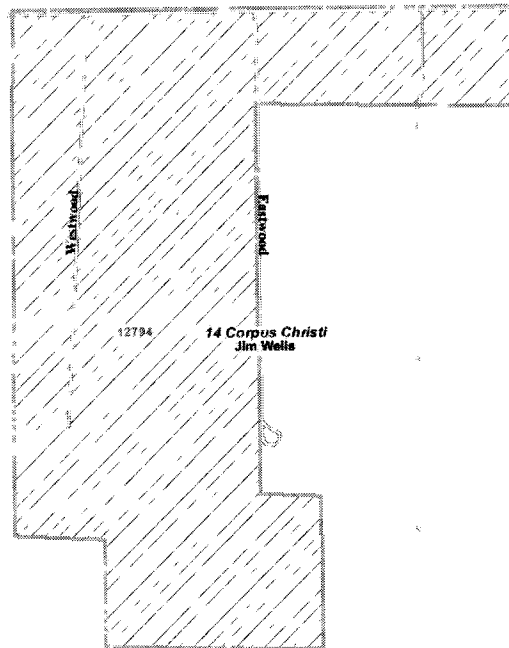

- Layers** **Legend**
- Visible Active
- ☒ ☐ Highways
  - ☒ ☐ Local Streets
  - ☐ ☐ Sewer CCN Facility
  - ☐ ☐ Water CCN Facility
  - ☐ ☐ Sewer CCN Service
  - ☒ ☐ Water CCN Service
  - ☒ ☐ Waterbodies
  - ☒ ☐ Streams
  - ☒ ☐ TCEQ Regions
  - ☐ ☐ Senate - Districts
  - ☐ ☐ House - Districts
  - ☐ ☐ Zip Codes
  - ☐ ☐ Cities
  - ☒ ☐ Counties
  - ☐ ☐ Drainage District (D)
  - ☐ ☐ Fresh Water Supply
  - ☐ ☐ Irrigation District (I)
  - ☐ ☐ Levee Improvement
  - ☐ ☐ Municipal Managen
- Submit form for help determ*
- service providers*
- Download Spatial Data*
- Contact us*

## Search by ONE of the following:

City	<input type="text"/>	Find City	
County	<input type="text"/>	Find County	
Zip Code	<input type="text"/>	Find Zip Code	
CCN #	<input type="text"/>	Find CCN	
Water District	<input type="text"/>	Find Water District	
Address	<input type="text"/>	Find Address	
Intersection	<input type="text"/>	Find Intersection	
Lat - Long	<input type="text"/>	Find Lat - Long	

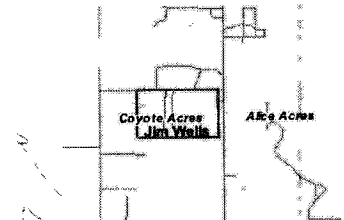

**RECEIVED**  
 FEB 28 2014  
 UTILITIES & DISTRICTS  
 SECTION



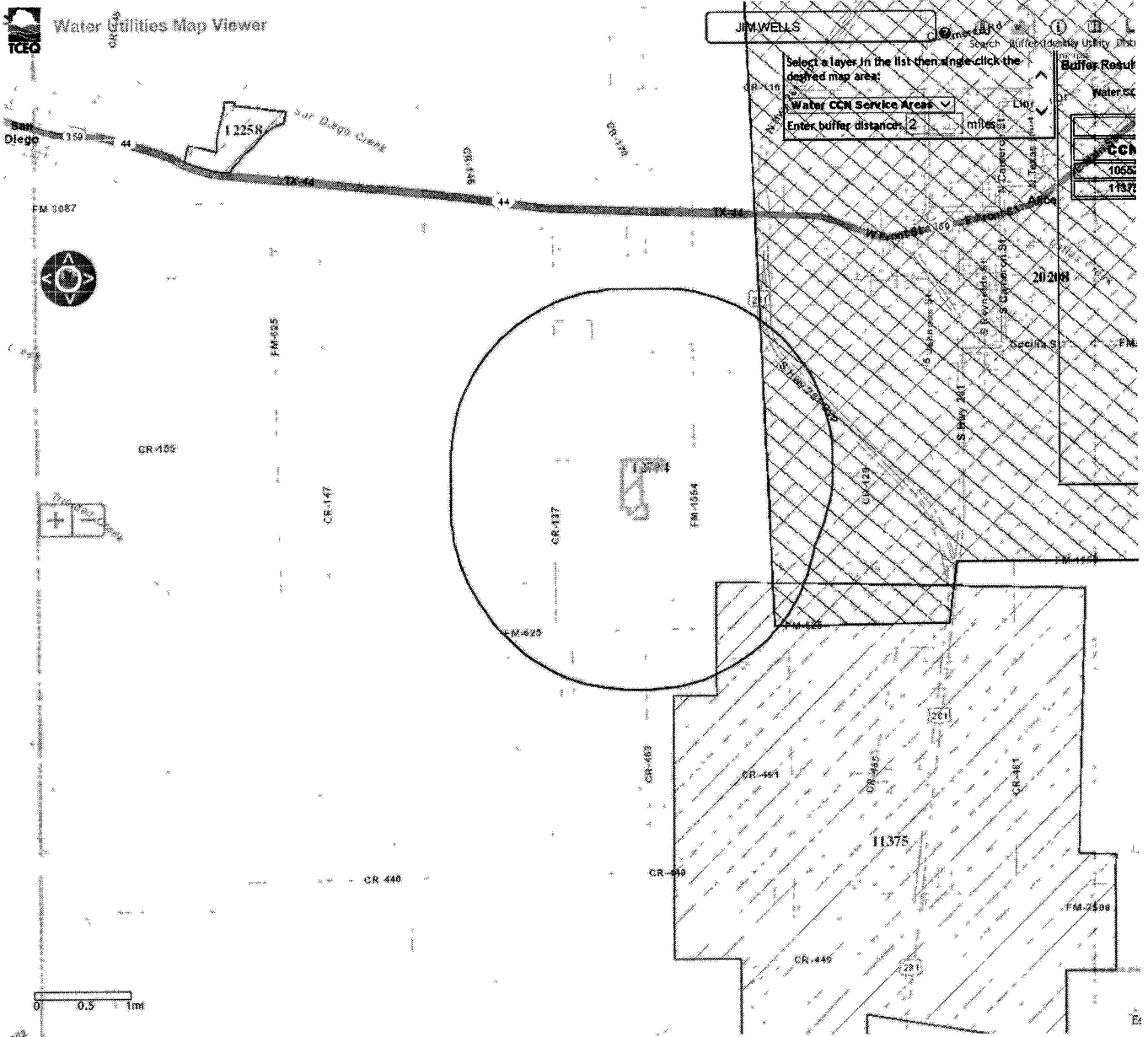

**RECEIVED**  
 FEB 28 2014  
 UTILITIES & DISTRICTS  
 SECTION

To: Administrative Reviewer Date Complete: March 14, 2014

From: Cartographer-Utilities & Districts Section

Subject: Overlap & Notice Check for Administrative Review No. A-026-14/37864-S  
Derby Ing. To acquire English Acres (12794) in Jim Wells county.

- X 1. No new overlap of service areas exists.
2. An overlap:
3. Dual certification:
4. An overlap exists with the city limits of:
- X 5. If this is a Sale, Transfer, or Merger, is additional area being requested? NO
9. Utility notice was sufficient.
- X 10. Utility notice was insufficient. In addition to those systems listed in the application, they will also need to notify:
- TWO MILES:
- City of Alice (10552)
- Jim Wells County FWSD 1 (11375)
- Jim Wells County
- Brush Country GCD
- All cities and etj's within 2 miles of proposed area
- Any other Utility, District or entity that would be required to receive notice
- X 11. Notice:
- On the North by CR136
- On the East by FM1554
12. Other comments:



Kent Steelman

To: Administrative Reviewer

Date Complete: March 14, 2014

From: Cartographer-Utilities & Districts Section

Subject: Overlap & Notice Check for Administrative Review No. A-026-14/37864-S  
Derby Ing. To acquire English Acres (12794) in Jim Wells county.

- X 1. No new overlap of service areas exists.
2. An overlap:
3. Dual certification:
4. An overlap exists with the city limits of:
- X 5. If this is a Sale, Transfer, or Merger, is additional area being requested? NO
9. Utility notice was sufficient.
- X 10. Utility notice was insufficient. In addition to those systems listed in the application, they will also need to notify:
- TWO MILES:
- City of Alice (10552)
- Jim Wells County FWSD 1 (11375)
- Jim Wells County
- Brush Country GCD
- All cities and etj's within 2 miles of proposed area
- Any other Utility, District or entity that would be required to receive notice
- X 11. Notice:
- On the North by CR136
- On the East by FM1554
12. Other comments:

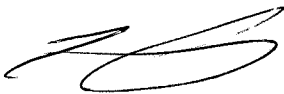

Kent Steelman