



Control Number: 38743



Item Number: 220

Addendum StartPage: 0

SOAH DOCKET NO. 473-11-0945

PUC DOCKET NO. 38743

APPLICATION OF ELECTRIC TRANSMISSION

BEFORE THE STATE OFFICE

TEXAS,LLC, TO AMEND ITS CERTIFICATE OF

CONVENIENCE AND NECESSITY FOR THE

OF

TESLA TO EDITH CLARKE TO CLEAR CROSSING

TO WEST SHACKELFORD 345-KV CREZ

ADMINISTRATIVE HEARINGS

TRANSMISSION LINE IN CHILDRESS, COTTLE,

HARDEMAN, FOARD, KNOX, HASKELL, JONES,

AND SCHACKELFORD COUNTIES

INTERVENOR RONNIE CHAPMAN

STATEMENT OF POSITION

COMES NOW, Ronnie and Linda Chapman oppose the preferred segment B30 link. We already have two 138KV on our property. The proposed 345 KV will run parallel to the 138KV and will run approximately through the middle of a 220 acre field that we use for cotton, wheat, and cattle grazing. With three transmission lines across our property, our property value will be substantially affected. We are in favor of an alternate route, B26 to B29, to B32 to B40 to B40A to B43 to Clear Crossing. However, should the preferred route B30 be selected, we encourage the location of the 345KV transmission line along our west property line and would like to see the 138KV that runs parallel to the proposed 345KV hung under the 345 KV, if possible. (see attached map)

Respectfully submitted,



Ronnie Chapman

9425 FM 266

Haskell, Texas 79521-9343

Prepared December 17, 2010

Our proposal for the 345KV transmission line.

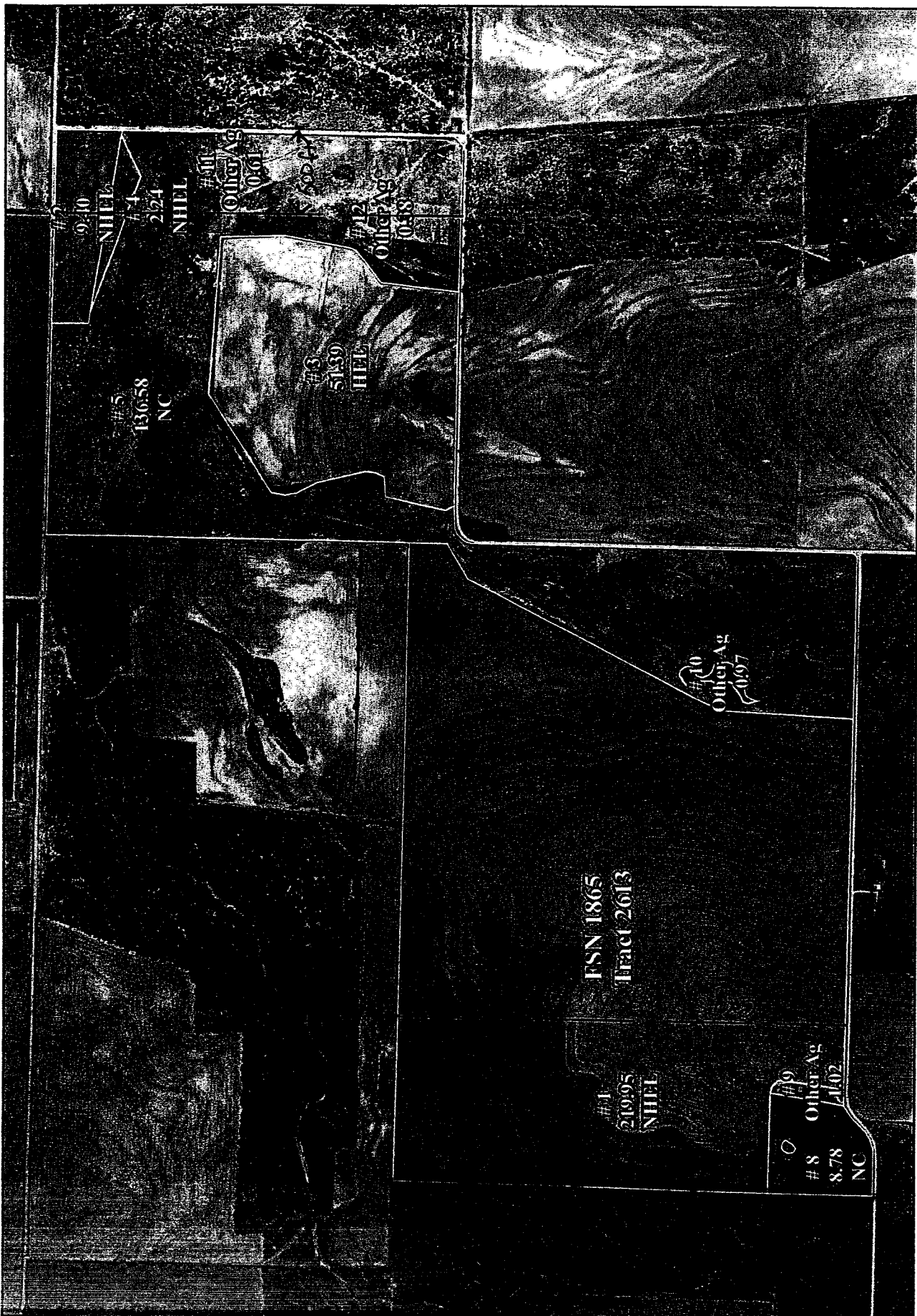

Haskell County FSA

USDA U.S. Department of Agriculture
Texas Farm Service Agency

Tract Acres: 431.40
Crop Acres: 283.00

Wetland Determination Identifiers

- Restricted Use
- Limited Restrictions
- Exempt from Conservation Compliance Provisions

Wetland identifiers do not represent the size, shape, or specific determination of the area. Refer to your original determination (CPA-026 and attached maps) for exact wetland boundaries and labels, or contact NRCS.

1 inch equals 852.115204 feet

