



Control Number: 38597



Item Number: 862

Addendum StartPage: 0

**Docket No. #** 38597

**Comments  
FROM VARIOUS  
PARTIES**

11/2/15

0

862

Thank you for your consideration of our requests.

**INCLUDED: Protest Forms and related info. from 5 contiguous landowners.**

**Protests concern Routes W1, W2 and/or W72 of Docket # 38597**

RINEY – TRACT 1213

HAWKINS – TRACT 1212

HIEB – TRACT 1215

MORRISON – WITHIN TRACT 1212 (2 existing residences/structures within small rectangular area of map next to structure #258)

WILDMAN – TRACT 1219 (Wildman to be mailed in separate packet, but is included in our group)

## Comments in Docket No. 38597

**If you want to be a PROTESTOR only, please complete this form.** Although public comments are not treated as evidence, they help inform the PUC and its staff of the public concerns and identify issues to be explored. The PUC welcomes such participation in its proceedings.

Mail this completed form and 10 copies to:

Public Utility Commission of Texas  
Central Records  
Attn: Filing Clerk  
1701 N. Congress Ave.  
P.O. Box 13326  
Austin, TX 78711-3326

First Name: Terrence Blaine Last Name: Riney  
Phone Number: 214-668-2800 Fax Number: 877-408-5484 / email TBlaineRiney@yahoo.com  
Address, City, State: 3212 Range Creek Rd. Howe, Tx 75459

**I am NOT requesting to intervene in this proceeding. As a PROTESTOR, I understand the following:**

- I am NOT a party to this case;
- My comments are not considered evidence in this case; and
- I have no further obligation to participate in the proceeding.

**Please check one of the following:**

- I own property with a habitable structure located near one or more of the utility's proposed routes for a transmission line.
- One or more of the utility's proposed routes would cross my property.
- Other. Please describe and provide comments. You may attach a separate page, if necessary. \_\_\_\_\_

Please see attached Letter + Map  
Segment W-1 Tract #1213

**Signature of person submitting comments:**

Blaine Riney

Date: 10-01-2010

Concerning Segment: W1 – Tract # 1213

Dear Madam/Sir:

My name is Blaine Riney and I own approximately 57 acres located at 3212 Range Creek Rd, Howe, Texas 75459 (Grayson County). The purpose of this letter is to inform the Board that I am respectfully protesting the construction of the proposed CREZ 345 KV Transmission Line (Docket # 38597). Although I am not within the "Preferred Route", I am greatly concerned of the potential default to the "Alternate Route" by way of the Board's ultimate decision. Our home and workshop sits atop a highly elevated hill and you can see the countryside for miles, in all directions. The proposed W1 route will run directly beside (immediate South) our home, workshop and this highest elevated part of my property. Collectively, my fellow neighbors Hawkins, Heib, Wildman, and Morrison stand beside me in protest as well.

I'd like to briefly explain why I purchased my land as well as my future intentions. It should also be noted that my primary residence is in Plano, Tx.(approx. 40 miles away). Our land is comprised of beautiful pasture, a tree-lined creek rich in various wildlife and an elevated hill that overlooks the entire property, as mentioned above. In 2003, I purchased these 57 acres from my current Range Creek Rd neighbor, Lee Heib. At that time my sons, Jacob and Josh, were 3 and 1 yrs. old. I couldn't wait for them to experience the same joys and benefits that come from being in the country; the same joys that I enjoyed growing up; fishing, hunting, farming, working with cattle, mending and running fence lines, all of the fun things boys love to do. We work and play on this land as a family. The disciplines, life-lessons and bonding experiences are invaluable for my boys. When they are grown, they will have the opportunity to bring their sons or daughters to this land to carry on these traditions.

In the near future we plan to expand the existing home to accommodate more visiting families and to host our infamous "Riney Reunions". This won't be possible, nor a safe/feasible decision, if this power-line is in place. God willing, our finances will cooperate and we can continue to cultivate our land, raise our boys to men and ultimately see our grandchildren experience this land.

All of this being said, there is a 100% chance that I would not have purchased this land had there been a 345Kv power line existing; I would have not even been interested in driving out to look at it with the realtor. The prevailing concerns I have pertain to health (family and animals), aesthetics and value. Although there are some that minimize the potential health hazards, countless studies worldwide exist that lean to the contrary. These studies cannot just be ignored. I cannot picture myself and my family trying to enjoy our activities under these massive lines; in fact, we wouldn't. As previously stated, the residence/home and workshop are on the most beautiful part of the property and lay the absolute closest to the proposed lines. Therefore, our ability to utilize this property would be rendered useless.

In addition, should we ever run into financial hardships and need to sell our land, the ability to recover our costs wouldn't even exist. Can you imagine how many buyers in the marketplace would desire to buy a "*once beautiful piece of countryside*" under a massive 345Kv line? Simply, there wouldn't be any buyers and my family would be left a severe financial liability.

It is evident through my research and conversations that these powerlines are undesirable. I respectfully ask that you consider more populated areas that contain developed infrastructure with paved streets/highways, water towers, radio towers and other existing power lines; places where existing easements could be utilized. I hope that you will consider my request, as well as my neighbors' requests, to not proceed with the W-1 line in the Range Creek Rd area.

Thank you for your attention and consideration.

Cordially,

Blaine Riney

Lee Heib

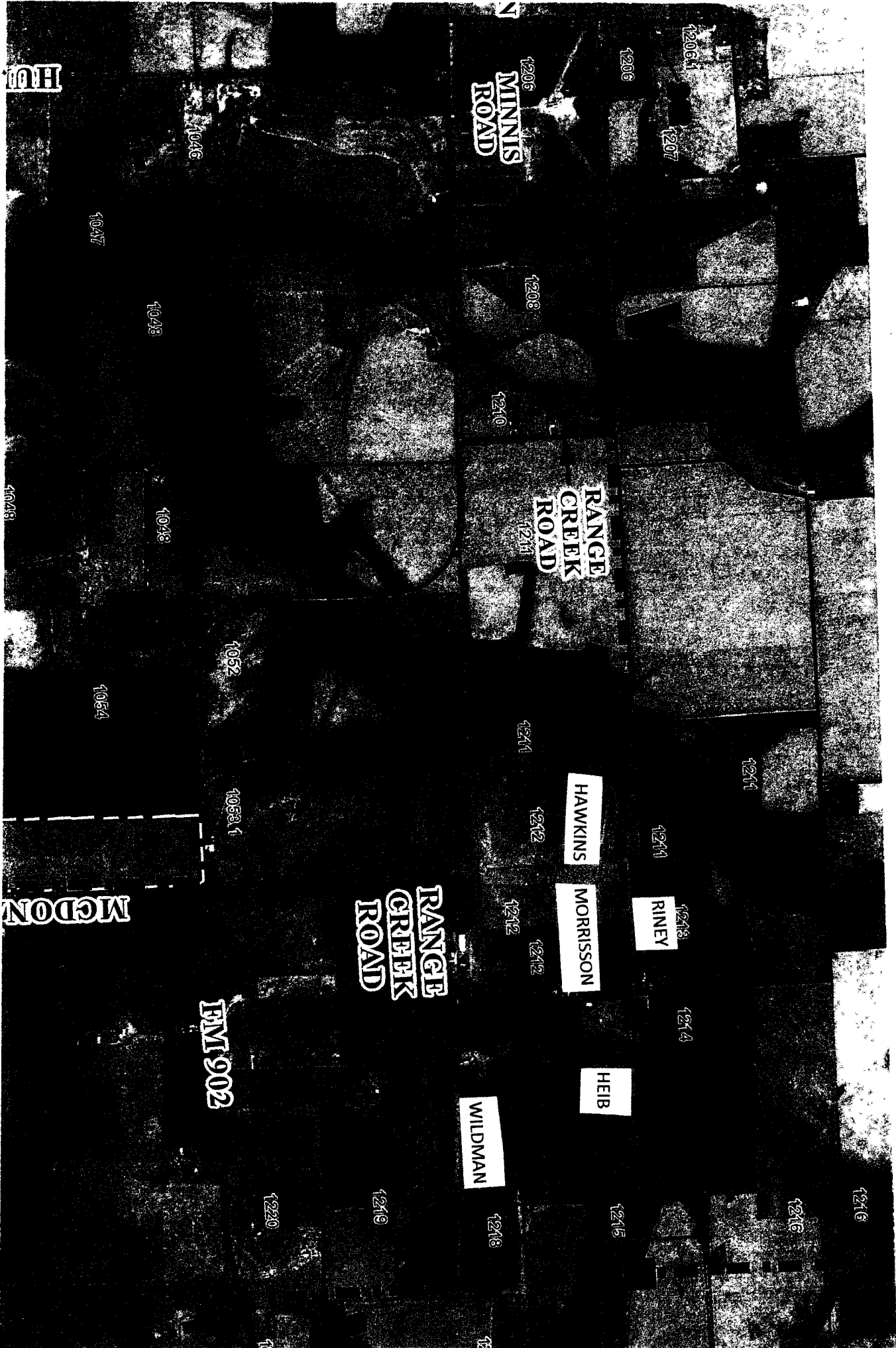

COMMENTS  
~~Request to Intervene~~ in PUC Docket No. 38597

The following information must be submitted by the person requesting to intervene in this proceeding. This completed form will be provided to all parties in this docket. ~~If you DO NOT want to be an intervenor, but still want to file comments, please complete the "Comments" page.~~

Mail this completed form and 10 copies to:

Public Utility Commission of Texas  
Central Records  
Attn: Filing Clerk  
1701 N. Congress Ave.  
P.O. Box 13326  
Austin, TX 78711-3326

PROTEST ONLY

First Name: John Last Name: HAWKINS  
Phone Number: 214-384-6627 Fax Number: 972-931-5156  
Address, City, State: 17480 Dallas PARKWAY # 217 Dallas 75287

~~I am requesting to intervene in this proceeding. As an INTERVENOR, I understand the following:~~

PROTESTOR

- ~~■ I am a party to the case;~~
- ~~■ I am required to respond to all discovery requests from other parties in the case;~~
- ~~■ If I file testimony, I may be cross-examined in the hearing;~~
- ~~■ If I file any documents in the case, I will have to provide a copy of that document to every other party in the case; and~~
- ~~■ I acknowledge that I am bound by the Procedural Rules of the Public Utility Commission of Texas (PUC) and the State Office of Administrative Hearings (SOAH).~~

Please check one of the following:

- I own property with a habitable structure located near one or more of the utility's proposed routes for a transmission line.
- One or more of the utility's proposed routes would cross my property.
- Other. Please describe and provide comments. You may attach a separate page, if necessary. \_\_\_\_\_

\_\_\_\_\_  
\_\_\_\_\_  
\_\_\_\_\_  
\_\_\_\_\_

Signature of person requesting intervention:

John Hawkins

Date: Oct 1, 2010



October 1, 2010

Public Utility Commission of Texas

Central Records

Attn. Filing Clerk

1701 N. Congress Ave.

P.O. Box 13326

Austin, Texas 78711

Re: PUC Docket No. 38597

Dear Sirs,

I am writing as an protestor in the above referenced case. My property is referred to on your maps as number 1212, Segment W1 and is located on Range Creek Road, north of Highway 902. This transmission line will dramatically affect the livability and enjoyment of this property forever. We would respectfully request you put the line on a major thoroughfare where residences will not be affected as much. Thank you for your consideration of this request.

Sincerely,

John S. Hawkins

JSH Grayson Properties

17480 Dallas Parkway Suite 217

Dallas, Texas 75287

# Comments in Docket No. 38597

If you want to be a PROTESTOR only, please complete this form. Although public comments are not treated as evidence, they help inform the PUC and its staff of the public concerns and identify issues to be explored. The PUC welcomes such participation in its proceedings.

Mail this completed form and 10 copies to:

Public Utility Commission of Texas  
Central Records  
Attn: Filing Clerk  
1701 N. Congress Ave.  
P.O. Box 13326  
Austin, TX 78711-3326

First Name: LEE Last Name: HIES

Phone Number: (214) 802-6701 Fax Number: \_\_\_\_\_

Address, City, State: 3377 RANGE CREEK RD. HOWE, TX 75459

I am NOT requesting to intervene in this proceeding. As a PROTESTOR, I understand the following:

- I am NOT a party to this case;
- My comments are not considered evidence in this case; and
- I have no further obligation to participate in the proceeding.

Please check one of the following:

- I own property with a habitable structure located near one or more of the utility's proposed routes for a transmission line.
- One or more of the utility's proposed routes would cross my property.
- Other. Please describe and provide comments. You may attach a separate page, if necessary. \_\_\_\_\_

SEE ATTACHED PAGE 2 & 3

SEGMENT W1, W2, W72

TRACT # 1715

Signature of person submitting comments:

[Handwritten Signature]

Date: 10/4/10

Comments In Docket No. 38597

C. Lee Hieb

3377 Range Creek Rd.

Howe, TX 75459

Comments:

W-72 and W-2 would run North and South on my property. W-1 would run approximately 300 feet North of my recently completed living quarters with attached extended workshop. This route proposal would adversely affect me and my family.

Within three years, I plan to utilize my drawings for the "house of my dreams" to be built on this parcel for my retirement home. Your proposed plan of W-1 would be right on top of my new home. I have worked a lifetime saving for this opportunity and paying off this land debt. This proposed route is not acceptable as concerns my retirement goals.

I have attached mapping information exhibiting my existing habitat location (location #1) and my proposed new home location (location #2).

I thank you in advance for your time and consideration regarding my request for an alternative route proposal.

Sincerely,

A handwritten signature in black ink, appearing to read 'C. Lee Hieb', written in a cursive style.

C. Lee Hieb

Enclosure: Map

30F3

1206  
MINNIS  
ROAD

RANGE  
CREEK  
ROAD  
1211

RANGE  
CREEK  
ROAD

BMI 902

MCDON

30F3

1047

1046

1045

1048

1054

1052

1053 1

1220

1219

1218

1215

1216

1216

1213

1214

1211

1211

1211

1212

1212

1212

1210

1208

1206

1207

1208 1

BMI

## Comments in Docket No. 38597

**If you want to be a PROTESTOR only, please complete this form.** Although public comments are not treated as evidence, they help inform the PUC and its staff of the public concerns and identify issues to be explored. The PUC welcomes such participation in its proceedings.

Mail this completed form and 10 copies to:

Public Utility Commission of Texas  
Central Records  
Attn: Filing Clerk  
1701 N. Congress Ave.  
P.O. Box 13326  
Austin, TX 78711-3326

First Name: Sue ~~MORRISON~~ Last Name: MORRISON  
Phone Number: 903-771-8363 Fax Number: N/A  
Address, City, State: 3498 Range Creek Howe Texas 75459

**I am NOT requesting to intervene in this proceeding. As a PROTESTOR, I understand the following: \***

- I am NOT a party to this case;
- My comments are not considered evidence in this case; and
- I have no further obligation to participate in the proceeding.

**Please check one of the following:**

- I own property with a habitable structure located near one or more of the utility's proposed routes for a transmission line.
- One or more of the utility's proposed routes would cross my property.
- Other. Please describe and provide comments. You may attach a separate page, if necessary. \_\_\_\_\_

HEALTH ISSUES ARE A CONCERN TO ME AND  
ALSO I DO NOT PREFER TO LOOK AT A  
TRANSMISSION LINE THAT CLOSE TO MY HOUSE  
(within tract 1212)

**Signature of person submitting comments:**

Sue Morrison

Date: 10/3/2010