



Control Number: 38354



Item Number: 2299

Addendum StartPage: 0

SOAH DOCKET NO. 473-10-5546

PUC DOCKET NO. 38354

RECEIVED  
10 SEP 16 AM 9:48  
PUBLIC UTILITY COMMISSION  
FILING CLERK

Answers to Commission Staff's First Set of Requests are as follows:

Staff 1-1 Yes, we have a mobile home within 500 yards of proposed b13ab, Z1, Z3 and b75. Mobile home is located within 500 yards just west of RR 2084. See attached map for approximate location of mobile home. Answer provided by Arlen Swanzy.

Staff 1-2 Yes, proposed transmission line b13ab, Z1, Z2 and b75, transmission line b11a cross our property at different locations. B75 follows RR 2084 through our property. Answer provided by Arlen Swanzy.

Staff 1-3 No. Answer provided by Arlen Swanzy.

Staff 1-4 No. Answer provided by Arlen Swanzy

Staff 1-5 Yes, we have one water wind mill located within 200 yards of the mobile home listed previously. Answer provided by Arlen Swanzy.

Staff 1-6 No. Answer provided by Arlen Swanzy.

Staff 1-7 No. Answer provided by Arlen Swanzy.

2299

**Staff 1-8** The transmission lines would substantially reduce our “usable” land for any type of dwelling. The visual landscape would drastically change also. Answer provided by Arlen Swanzy.

**Staff 1-9** No, we did not attend open house. Yes, we did provide written comments in request to intervene in PUC Docket No. 38354 (see copies). Answer provided by Arlen Swanzy.

**Staff 1-10** Do not have copy of Attachment No. 3 (sheets 1-28) showing property boundaries. However we have printed and enclosed map showing our property boundaries with the proposed power lines. See attached. Answer provided by Arlen Swanzy.

**Staff 1-11** Ranching and hunting. Power transmission lines will restrict and reduce income provided by both. Answer provided by Arlen Swanzy.

**Staff 1-12** Yes, due to the layout of our property lines and the location of several transmission line routes on our property, the transmission lines would substantially reduce our “usable” land for any type of dwelling. The visual landscape would drastically change also. We request that any transmission lines located on the property be located near property lines and not dissect the property. Answer provided by Arlen Swanzy.

**Staff 1-13** Arlen and Trudy Swanzy. Answer provided by Arlen Swanzy.

**Staff 1-14** See attached property maps with proposed re-routes of transmission lines located on property. Answer provided by Arlen Swanzy.

## Request to Intervene in PUC Docket No. 38354

The following information must be submitted by the person requesting to intervene in this proceeding. This completed form will be provided to all parties in this docket. If you DO NOT want to be an intervenor, but still want to file comments, please complete the "Comments" page.

Mail this completed form and 10 copies to:

Public Utility Commission of Texas  
Central Records  
Attn: Filing Clerk  
1701 N. Congress Ave.  
P.O. Box 13326  
Austin, TX 78711-3326

First Name: ARLEN & TRUDY Last Name: SWANZY  
Phone Number: 817-239-1680 Fax Number: N/A  
Address, City, State: 3412 VISTA CHASE CT.  
ARLINGTON, TX 76001

I am requesting to intervene in this proceeding. As an INTERVENOR, I understand the following:

- ☒ I am a party to the case;
- ☒ I am required to respond to all discovery requests from other parties in the case;
- ☒ If I file testimony, I may be cross-examined in the hearing;
- ☒ If I file any documents in the case, I will have to provide a copy of that document to every other party in the case; and
- ☒ I acknowledge that I am bound by the Procedural Rules of the Public Utility Commission of Texas (PUC) and the State Office of Administrative Hearings (SOAH).

Please check one of the following:

- ☐ I own property with a habitable structure located near one or more of the utility's proposed routes for a transmission line.
- ☒ One or more of the utility's proposed routes would cross my property.
- ☐ Other. Please describe and provide comments. You may attach a separate page, if necessary.

These  
utility lines would substantially  
reduce our "usable" land for any  
type of dwelling. The usual  
landscape would drastically change also.

Signature of person requesting intervention:

Judy Swanzy

Date:

8/23/2010

XXXXX DELETE PROPOSED ROUTE

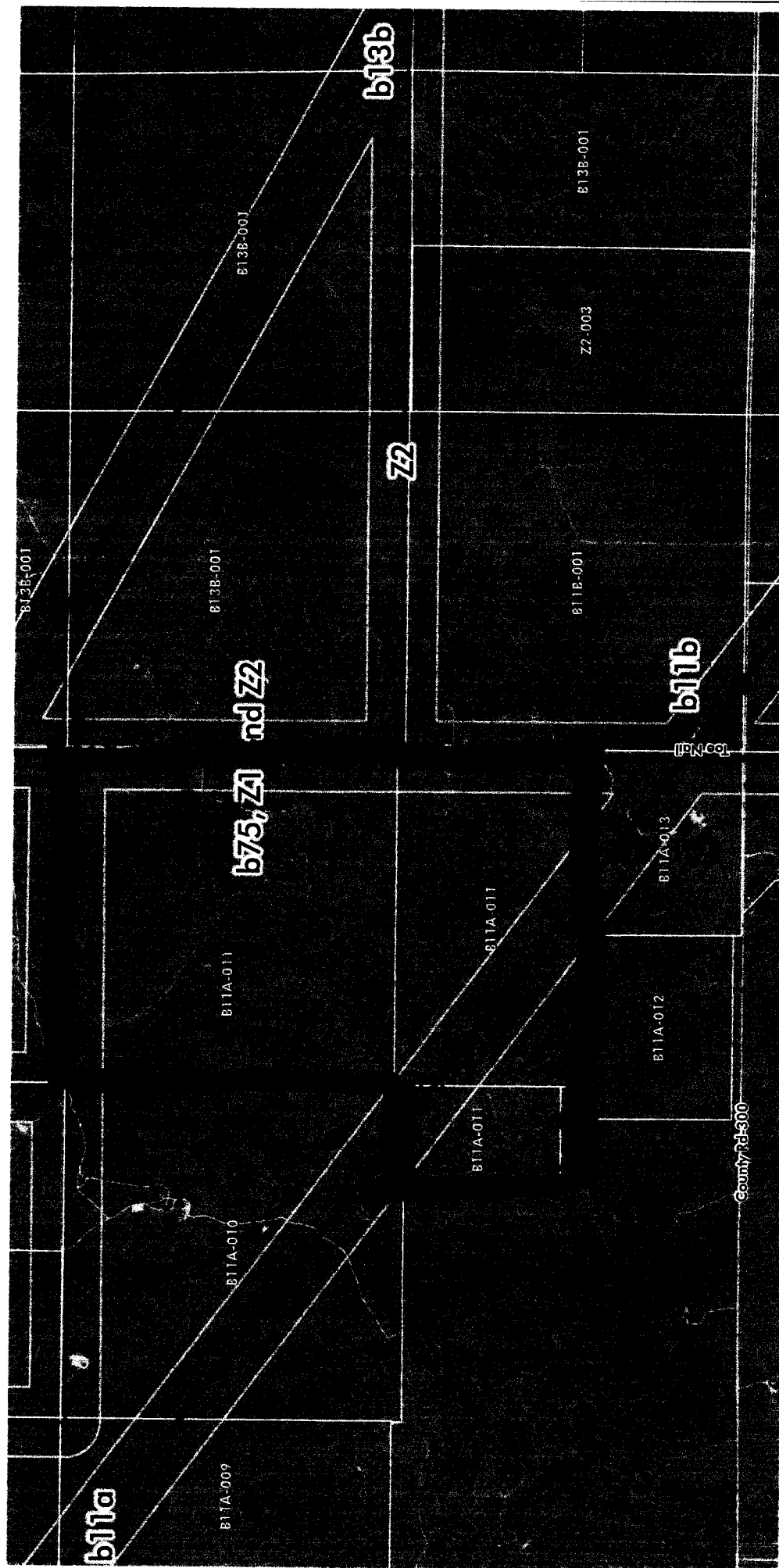

By ARLEN SWANZY