

(Camp Springs Road). The line turns west and parallels the north side of FM 1673 for approximately 29,500 feet to MWEC's Plainview substation located north of the Price Daniels Prison Unit on the east side of Snyder.

Alternate Route : This segment will exit the east side of WTU's Roby substation located on the northwest corner of N 3rd Street and Angelo Street in Roby. The line will then extend north for approximately 1,300 feet along the west side of Angelo Street. The line will then turn west for approximately 2,800 feet and crossing Highway 70. The line will then turn south for approximately 1,100 feet to a point on the west side of the intersection of Lawrence Street and N 4th Street. The line will then turn in a westerly direction and parallel a dirt road for approximately 7,200 feet to a point where it crosses a dirt road and then the line continues in a westerly direction for another 7,000 feet as it parallels a waterway until it intersects Highway 180. The line then continues west paralleling the north right of way for 1,000 feet. The line then crosses to the south side of Highway 180 and continues for approximately 16,000 feet in a westerly direction. The line then crosses to the north side of Highway 180 and continues in a westerly direction for approximately 8,000 feet and crossing Highway 1657. The line then crosses to the south side of Highway 180 and continues for approximately 5,400 feet in a westerly direction. The line then crosses to the north side of Highway 180 and continues in a westerly direction for approximately 5,500 feet. The line then crosses to the south side of Highway 180 and continues for approximately 10,700 feet in a westerly direction to the west side of FM 611. At this point, there is an approximately 800 foot tap line to the south to the location of WTU's new Hobbs substation. The line then crosses to the north side of Highway 180 on the west side of Highway 180 and continues in a westerly direction for approximately 30,200 feet. The line then crosses to the south side of Highway 180 and continues for approximately 2,800 feet in a westerly direction. The line then crosses to the north side of Highway 180 and continues in a westerly direction for approximately 23,800 feet to the east side of County Road 1101. The line then turns and parallels the east side of County Road 1101 for approximately 9,500 feet where it crosses to the west side of County Road 1101 and continues north for 500 feet to the north side of FM 1673 (Camp Springs Road). The line turns west and parallels the north side of FM 1673 for approximately 18,500 feet to MWEC's Plainview substation located north of the Price Daniels Prison Unit on the east side of Snyder.

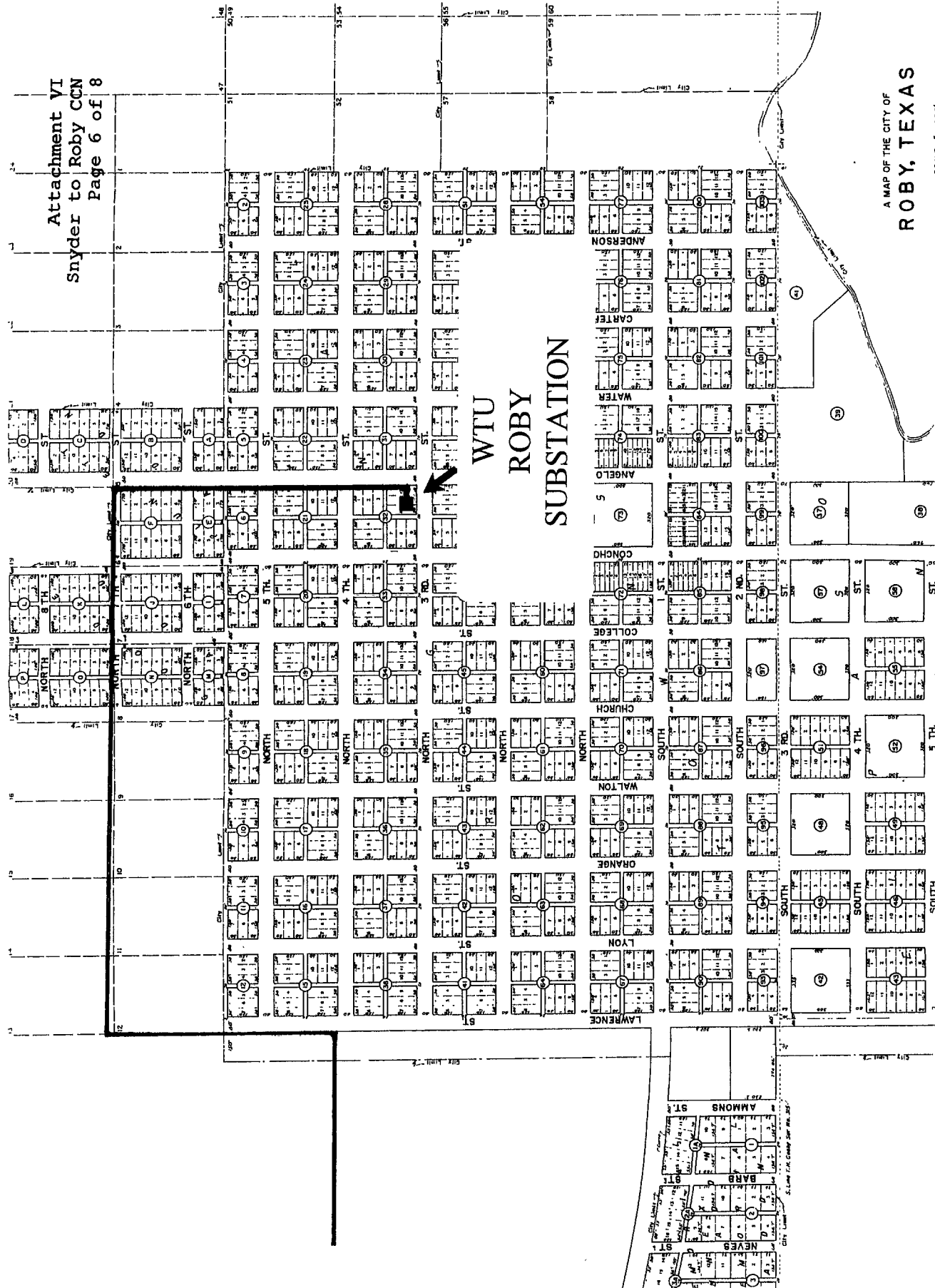

OVERSIZED MAP(S)

**TO VIEW
OVERSIZED MAP(S),
PLEASE GO TO
CENTRAL RECORDS.**

(512) 936-7180

OVERSIZED MAP(S)

**TO VIEW
OVERSIZED MAP(S),
PLEASE GO TO
CENTRAL RECORDS.**

(512) 936-7180

Attachment VII.

VII. Question 22

Listing of directly affected landowners on the proposed route.

Scurry County-Fisher County Preferred Route Landowner List

03-Jan-97

Preferred Route Landowner List

Parcel	Landowner	Legal Description	Preferred Route
1000	J. W. Warren	H&TC - BLK 2 - West part of Section 27	Yes
491 C.R. 304	Roby	TX 79543 Fisher County	
1009	Bobby W. Moore	H&TC - BLK 2 - NE part of Section 27	Yes
184 C.R. 309	Roby	TX 79543 Fisher County	
1012	Barton C. Willingham	H&TC - BLK 3 - Part of W/2 in Section 48	Yes
14427 E. Hwy 180	Hermleigh	TX 79526 Scurry County	
1037	W. T. Martin	H&TC - BLK 3 - Section 72	Yes
1910 Lakeview	Sweetwater	TX 79556 Fisher County	
1040	Louroy Stewart	H&TC- BLK 3 - NW/4 in Section 48	Yes
7550 Chelsea PL	Beaumont	TX 77706 Fisher County	
1041	Helen Stewart Akers	H&TC- BLK 3 - NW/C of NW/4 in Section 48	Yes
1218 10th Street	Anson	TX 79501 Fisher County	

Preferred Route Landowner List

Parcel	Landowner	Legal Description	Preferred Route
1042	Billy J. Hundall c/o W. M. Wall 3600 Hill Snyder	H&TC- BLK 3 - NE/C of NE/4 in Section 29	Yes
1043	Charley Johnson	TX 79549 Scurry County H&TC- BLK 3 - Section 48	Yes
1044	1715 Hwy 180 W Hermleigh J. A. Nettleton	TX 79526 Fisher County H&TC- BLK 3 - Section 48	Yes
1045	1700 US Hwy 180 W Hermleigh Leesa L. Johnson	TX 79526 Fisher County H&TC- BLK 3 - Section 48	Yes
1047	Rt 2 Box 119 B Hermleigh Britt Stuart	TX 79576 Fisher County H&TC- BLK 3 - Section 69	Yes
1048	Rt 1 Box 22 Roby Harold H. Mason	TX 79543 Fisher County H&TC- BLK 3 - Section 69	Yes
1049	P.O. Box 122 Hermleigh Richard C. Carney	TX 79526 Fisher County H&TC- BLK 3 - Section 69	Yes
	1213 Pecos Hobbs	NM 88240 Fisher County	

Preferred Route Landowner List

Parcel	Landowner	Legal Description	Preferred Route
1050	Helen & Dr. F. E. Tutt c/o Helen Tutt 13525 Hwy 180 E Hermleigh	H&TC- BLK 3 - Section 70 TX 79526 Fisher County	Yes
1051	Jackie W. Etheredge	H&TC- BLK 3 - Section 73	Yes
	Rt 1 Box 1071 Rotan	TX 79546 Fisher County	
1052	Lois Jane Rains	H&TC- BLK 3 - Section 74	Yes
	Rt 2 Box 117 Rotan	TX 79546 Fisher County	
1053	Arlon Skinner c/o Ivin Martin 301 W. Sammey Baugh Ave Rotan	H&TC- BLK 3 - Section 75 TX 79546 Fisher County	Yes
1054	Beth F. Gilbert Farms	H&TC- BLK 3 - Section 75	Yes
	4830 Crooked Ln Dallas	TX 75229 Fisher County	
1055	Nelson G. Smith	H&TC- BLK 3 - Section 78	Yes
	905 E Johnston Rotan	TX 79546 Fisher County	
1056	Bobbie Noles Sumerline	H&TC- BLK 2 - Section 24	Yes
	5201 Rebecca Lane Abilene	TX 79606 Fisher County	

Preferred Route Landowner List

Parcel	Landowner	Legal Description			Preferred Route
1057	William George			H&TC- BLK 2 - Section 24	Yes
	726 Loveville Rd Apt #801				
	Hockessen	DE	19707	Fisher County	
1058	Gene Terry			H&TC- BLK 2 - Section 25	Yes
	Rt 1 Box 201				
	Roby	TX	79543	Fisher County	
1059	Mrs. W. W. Morton			H&TC- BLK 2 - Section 25	Yes
	c/o Jack Morton				
	P.O. Box 362				
	Roby	TX	79543	Fisher County	
1060	Mrs. James H. Hillard			H&TC- BLK 2 - Section 25	Yes
	Rt 1				
	Roby	TX	79543	Fisher County	
1061	James Ross Hillard			H&TC- BLK 2 - Section 25	Yes
	Rt 2 Box 112B				
	Sweetwater	TX	79556	Fisher County	
1062	Jay Linn and Joe Don Helm			H&TC- BLK 2 - Section 26	Yes
	Rt 1 Box 61				
	Roby	TX	79543	Fisher County	
1063	M.O. Campbell			H&TC- BLK 2 - SW/4 of Section 26	Yes
	97 Towering Pines				
	The Woodlands	TX	77381	Fisher County	

Preferred Route Landowner List

Parcel	Landowner	Legal Description	Preferred Route
1064	Mrs. Eltha Ragan	H&TC- BLK 2 - Section 26	Yes
1065	3302 Woodhollow Abilene Mamie Kemp c/o Kay Taylor 210 Avenue M Abernathy Marjory Lee	TX 79606 Fisher County H&TC - BLK 2 - Section 21 TX 79311 Fisher County H&TC - BLK 3 - NW/C of NW/4 in Section 48	Yes
1073	3101 Hill Ave. Snyder M. O. Campbell	TX 79549 Fisher County H&TC - BLK 2 - Section 27	Yes
1077	97 Towering Pines The Woodlands Barton C. Willingham	TX 77381 Fisher County H&TC - BLK 3 - Part of W/2 in Section 48	Yes
1079	398 FM 611 North Hermleigh Mildred L. Rhoton	TX 79526 Fisher County H&TC - BLK 2 - NW/4 & E prt of SW/4 in Section 26	Yes
1080	4114 Jacksboro Snyder Willingham Land Co. c/o Barton Willingham 398 FM 611 N Hermleigh	TX 79549 Fisher County H&TC - BLK 3 - Section 69	Yes

Preferred Route Landowner List

Parcel	Landowner	Legal Description	Preferred Route
1081	Archie Rivers	H&TC - BLK 2 - Section 27	Yes
	P.O. Box 13 Roby	TX 79543 Fisher County	
1082	Juanita Cochran	H&TC - BLK 3 - Section 46	Yes
	Rt 1 Box 118 Hermleigh	TX 79526 Fisher County	
1083	Raymond Hefner Est. c/o Virginia Hefner 1001 Lou Ave. Sweetwater	H&TC - BLK 3 - Section 45	Yes
	Eugene Hudnall	TX 79556 Fisher County	
1084	Rt 1 Box 1067 Rotan	H&TC - BLK 3 - Prt of Section 74, 75 & 76	Yes
	Jeronimo Gaono	TX 79546 Fisher County	
1085	200 C.R. 408 Roby	H&TC - BLK 2 - SE/C of Section 27	Yes
	Scott Feagan	TX 79543 Fisher County	
1086	P.O. Box 33 Roby	H&TC - BLK 2 - Section 27	Yes
	Jessie Moore	TX 79543 Fisher County	
1087	461 FM 419 S Roby	H&TC - BLK 2 - Section 27	Yes
		TX 79543 Fisher County	

Preferred Route Landowner List

Parcel	Landowner	Legal Description	Preferred Route
1088	W. T. Martin	H&TC- BLK 3 - Section 73	Yes
	1910 Lakeview Sweetwater	TX 79556 Fisher County	
1089	Beth Gilbert Farms	H&TC- BLK 3 - Section 77	Yes
	4830 Crooked Lane Dallas	TX 75229 Fisher County	
1091	Virginia Hefner	H&TC- BLK 3 - E/2 of Section 45	Yes
	1001 Lou Ave Sweetwater	TX 79556 Fisher County	
1093	T. A. Rosson Sr.	H&TC- BLK 3 - South part of Section 25	Yes
	700 FM 419 Sweetwater	TX 79556 Fisher County	
1094	Connie Tutt	H&TC- BLK 3 - Section 71	Yes
	Rt 1 Box 1076 Rotan	TX 79546 Fisher County	
1097	Clay Helms	H&TC- BLK 3 - E/2 of Section 44	Yes
	Rt 2 Box 6 C Rotan	TX 79546 Fisher County	
1098	Richard Wright	H&TC- BLK 3 - SW/4 of SW/4 in Section 43	Yes
	Rt 1 Box 1082 Rotan	TX 79546 Fisher County	

Preferred Route Landowner List

Parcel	Landowner	Legal Description	Preferred Route
1099	S.A. Willingham Trust c/o Andrew Willingham 16145 Parish Hall St. Big Spring	H&TC- BLK 3 - W/2 of Section 44 TX 777379 Fisher County	Yes
1100	Clara H. Womack	H&TC-Blk 3-Sec 71	Yes
	2721 53rd Street Lubbock	TX 79413 Fisher County	
11000	Jerry Hoodenpyle	Gillespie-Section 24- Tract 318- A - 29	Yes
	P.O. 332 Roby	TX 79543 Fisher County	
11001	Robert Schroedter	Gillespie-Section 17-Tract 318-A-29	Yes
	P.O. Box 38 Roby	TX 79543 Fisher County	
11002	Lois Scherwitz Donnie Allen P.O. Box 660 Sweetwater	Gillespie-Section 17-Tract 318-A-29 TX 79556 Fisher County	Yes
11003	Pauline Norwood	Gillespie-Section 18-Tract 318-A-29	Yes
	1410 Orange Abilene	TX 79601 Fisher County	
11004	Kiefer Cauble	Gillespie-Section 18-Tract 318-A-29	Yes
	Rt 1 Box 57 Roby	TX 79543 Fisher County	

Preferred Route Landowner List

Parcel	Landowner	Legal Description		Preferred Route
11005	Ray Hale	Gillespie-S/2 of Section 19-Tract 318-A-29		Yes
	581 East North 21st St. Abilene	TX	79601 Fisher County	
11006	Danny Terry	Gillespie-Section 22-Tract 318-A-29		Yes
	Rt 1 Box 20 Roby	TX	79543 Fisher County	
11007	Alton Pyburn	Gillespie-Section 23-Tract 318-A-29		Yes
	2500 South 25th St. Abilene	TX	79605 Fisher County	
13000	Charles Webb	H&TC- BLK 2 - Section 19		Yes
	Rt 1 Box 205 Roby	TX	79543 Fisher County	
13001	James Ellis c/o Richard Arens 2001 Kirby Drive #133 Houston	H&TC - BLK 2 - Section 20		Yes
13002	Pauline Webb	H&TC- BLK 2 - Section 19		Yes
	P.O. Box 176 Robert Lee	TX	76945 Fisher County	
13004	T. W. Cooper	H&TC- BLK 2 - Section 20		Yes
	923 NE Ave F Andrews	TX	79714 Fisher County	

Preferred Route Landowner List

Parcel	Landowner	Legal Description		Preferred Route
13005	M.O. Campbell	T.H. Cosby-Tract 315		Yes
	97 Towering Pines The Woodlands	TX	77381 Fisher County	
13006	Rodney Huddleston	T.H. Cosby- Tract 315		Yes
	Rt. 1 Box 1515 Palestine	TX	75801 Fisher County	
13007	Homer & Jane Nowlin	T.H. Cosby-Tract 315		Yes
	147 C.R. 305 Roby	TX	79543 Fisher County	
13008	Mrs. Clyde Farrar	T.H. Cosby 315		Yes
	P.O. Box 79149 Saginaw	TX	79479 Fisher County	
13009	Max Stuart	T.H. Cosby		Yes
	P.O. Box 36 Roby	TX	79543 Fisher County	
13010	Gary Stuart	H&TC- BLK 2 - S/2 of N/2 in Section 19		Yes
	Rt 1 Box 209 Roby	TX	79543 Fisher County	
13011	Richard Gaona	T.H. Cosby		Yes
	Rt 1 Box 56A Roby	TX	79543 Fisher County	

Preferred Route Landowner List

Parcel	Landowner	Legal Description	Preferred Route
13012	Neill Jenkins c/o Donald Pierson 1320 S University Dr. #808 Ft. Worth	H&TC- BLK 2 - Section 20 TX 76107 Fisher County	Yes
2001	Bruce T. May 15754 West Wedge Way Morrison	H&TC- BLK 2 - E/2 of Section 88 & W/2 in Section 17 CO 80465 Scurry County	Yes
2002	Olin Douglas May 38 Woodward Ave Sausalito	H&TC- BLK 2 - E/2 of Section 88 & W/2 of Section 17 CA 94965 Scurry County	Yes
2003	H.G. Jr. and Myrle Gafford 3961 E. Hwy 80 Snyder	H&TC - BLK 2 - W/2 in Section 88 TX 79549 Scurry County	Yes
2004	Rodger and Doris Blackard 6738 Pleasant Hill Road Snyder	H&TC- BLK 2 - S/2 in Section 87 & E/2 in Section 17 TX 79549 Scurry County	Yes
2005	Joe K. and Ava M. Lopour 4202 Ave U Snyder	H&TC- BLK 2 - Section 87 TX 79549 Scurry County	Yes
2006	Randy W. Head P.O. Box 577 Snyder	H&TC- BLK 3 - Section 18 TX 79500 Scurry County	Yes

Preferred Route Landowner List

Parcel	Landowner	Legal Description	Preferred Route
2007	Devane Jones	H&TC- BLK 3 - E/2 of N/2 in Section 18	Yes
	4215 Stillwood Odessa	TX 70762 Scurry County	
2008	Geral G. Greene Estate c/o John Greene Box 1396 Snyder	H&TC- BLK 2 - S/2 of SW/4 of SW/4 - Section 84 TX 79550 Scurry County	Yes
2009	American Telephone & Telegraph Central Region Property Tax P.O. Box 809113 Dallas	H&TC- BLK 3 - Part of the W/2 in Section 17 TX 75380 Scurry County	Yes
2010	Midwest Electric Coop P.O. Box 1600 Rowlett	H&TC- BLK 2 - Part of SW/4 of Section 88 TX 75088 Scurry County	Yes
2011	Alma Nell Waterman 414 Rolling Hills CR Coppell	H&TC- BLK 2 - Section 83 TX 75019 Scurry County	Yes
2012	Sadie Fern Butler 1207 Wellington Duncanville	H&TC- BLK 2 - Section 83 TX 75137 Scurry County	Yes
2013	Thomas J. and Nancy Hillis 2300 Cindy Lane Austin	H&TC- BLK 2 - Section 83 TX 79727 Scurry County	Yes

Preferred Route Landowner List

Parcel	Landowner	Legal Description	Preferred Route
2014	R. C. and Kyleen Pavlovsky	H&TC- BLK 2 - W/2 of the W/2 in Section 83	Yes
	8226 Camp Spring Road Snyder	TX 79549 Scurry County	
2015	Billy John and Marie Voss	H&TC- BLK 2 - W/2 of SE/4 in Section 83	Yes
	1500 Voss Lane Snyder	TX 79549 Scurry County	
2017	Bill J. and Frankie J. Estep	H&TC- BLK 3 - Part of NE/4 in Section 16	Yes
	8551 Camp Spring Road Snyder	TX 79549 Scurry County	
2018	David Higgins	H&TC- BLK 3 - Part of NE/4 in Section 16	Yes
	8753 Camp Spring Road Hermleigh	TX 79526 Scurry County	
2019	John W. Jordan	H&TC- BLK 3 - Part of NE/4 in Section 16	Yes
	66 CR 1101 Hermleigh	TX 79526 Scurry County	
2020	Ona Mae Spence	H&TC- BLK 3 - NE/4 in Section 16	Yes
	2702 33rd St Snyder	TX 79549 Scurry County	
2021	Jimmy K. and Janet Spence	H&TC- BLK 3 - NE/4 in Section 16	Yes
	P.O. Box 1157 Snyder	TX 79550 Scurry County	

Preferred Route Landowner List

Parcel	Landowner	Legal Description		Preferred Route
2022	Carl and Nona L. Williams	H&TC- BLK 3 - NW/4 in Section 15		Yes
	9361 Camp Spring Road Hermleigh	TX	79526 Scurry County	
2023	Roy Gettel	H&TC- BLK 2 - Part of the E/2 of Section 88		Yes
	417 Springwood Drive Big Springs	MO	64015 Scurry County	
2028	Eicke and Penny Perry	H&TC- BLK 2 - Section 80		Yes
	2706 47th St. Snyder	TX	79549 Scurry County	
2029	Charles Harrell	H&TC- BLK 2 - Section 79 & 80		Yes
	621 CR 1154 Hermleigh	TX	79526 Scurry County	
2070	Virgil Wayne Jones	H&TC - BLK 3 - Part of N/2 in Section 18		Yes
	3700 Blossom Lane Odessa	TX	79762 Scurry County	
2071	Betty Moore	H&TC - BLK 2 - Section 83		Yes
	1103 Shady Oaks Lane Brownfield	TX	79316 Scurry County	
2073	Texas Department of Correction	H&TC - BLK 3 - Section 19		Yes
	P.O. Box 99 Huntsville	TX	77340 Scurry County	

Preferred Route Landowner List

Parcel	Landowner	Legal Description	Preferred Route
2075	Frankie Wall	H&TC - BLK 3 - NW/4 in Section 16	Yes
	3600 Hill Ave Snyder	TX 79549 Scurry County	
3000	Snyder Co-op Gin Co	H&GN-BLK 3 - Section 153	Yes
	1904 E Hwy 180 Snyder	TX 79549 Scurry County	
3001	Bryan Ritchey	H&GN-BLK 3 - W/2 in Section 126	Yes
	2250 Thompson Rd Snyder	TX 79549 Scurry County	
3002	Development Corp of Snyder Inc.	H&GN- BLK 3 - W/2 of SW/4 in Section 75	Yes
	3610 College Ave. Snyder	TX 79549 Scurry County	
3003	Floyd B. Hollis	H&GN-BLK 3 - Section 126	Yes
	3604 Hill Ave Snyder	TX 79549 Scurry County	
3004	E. L. (Skeet) Jones	H&GN-BLK 3 - Section 126	Yes
	2807 37th St. Snyder	TX 79549 Scurry County	
3005	W. C. and Patsy Graves	H&GN- BLK 3 in Section 95	Yes
	2588 S Hwy 208 Snyder	TX 79549 Scurry County	

Preferred Route Landowner List

Parcel	Landowner	Legal Description			Preferred Route
3006	D. L. Irwin		H&GN-BLK 3 - SE/4 in Section 126	Yes	
3007	2901 Brick Plant Rd Snyder	TX	79549 Scurry County	Yes	
	Snyder National Bank c/o Clovis & Linda Head		H&GN-BLK 3 - Section 126		
	P.O. Box 184 Burnet	TX	78611 Scurry County		
	Katol Investments, Inc. c/o Bruce Kallemeyn P.O. Box 209 Snyder	TX	79550 Scurry County		
3009	E. D. Walton		H&GN-BLK 3 - Section 95	Yes	
3010	3104 Auston Ave Snyder	TX	79549 Scurry County	Yes	
	The Oliver Burnham Trust		H&GN-BLK 3 - Section 95		
3011	12227 CR 370 Snyder	TX	79549 Scurry County	Yes	
	Wayland and Wanda Cody		H&GN-BLK 3 - Section 95		
3012	316 31st St. Snyder	TX	79549 Scurry County	Yes	
	Snyder ISD		H&GN-BLK 3 - Section 95		
	Snyder	TX	79549 Scurry County		

Preferred Route Landowner List

Parcel	Landowner	Legal Description		Preferred Route
3013	Myron Fenton	H&GN-BLK 3 - Section 95		Yes
	2310 College Ave. Snyder	TX	79549 Scurry County	
3014	Mack Leon Taylor	Helms Heights- Lot 4&5 - BLK 10 - Section 95		Yes
	1254 Salvage Fort Worth	TX	76134 Scurry County	
3015	Herbert Urdy Estate c/o Lonnie Urdy 4545 N Maryvale Pkwy #112 A Phoenix	AZ	85031 Scurry County	Yes
3016	Hoyle G. Bishop	H&GN- BLK 3 - NW/4 in Section 74		Yes
	2115 S Hwy 84 Snyder	TX	70549 Scurry County	
3017	Kateak Inc. Willow Park Inn 4410 Hwy 377 Brownwood	TX	76801 Scurry County	Yes
3018	Clint McCowen	H&GN- BLK 3 - Section 74		Yes
	1421 E Hwy 180 Snyder	TX	79549 Scurry County	
3019	Atchison Topeka & Santa Fe RR	H&GN- BLK 3 - Section 74		Yes
	P.O. Box 1738 Topeka	KS	66601 Scurry County	

Preferred Route Landowner List

Parcel	Landowner	Legal Description		Preferred Route
3020	Odell Graham	H&GN- BLK 3 - E/2 of SW/4 in Section 75		Yes
	1454 Hwy 180 E			
	Snyder	TX	79549 Scurry County	
3021	Elois Pruitt	H&GN- BLK 3 - Section 126		Yes
	P.O. Box 835			
	Snyder	TX	79550 Scurry County	
3022	Brenda McNeill	H&GN- BLK 3 - West part in Section 126		Yes
	623 National St			
	Santa Cruz	CA	95060 Scurry County	
3023	Frank B. Pruitt	H&GN- BLK 3 - Section 126		Yes
	P.O. Box 835			
	Snyder	TX	79550 Scurry County	
3024	Sandra V. Graves etal	H&GN- BLK 3 - NE/4 of Section 95		Yes
	1195 Graves Rd			
	Snyder	TX	79549 Scurry County	
3025	David Gill			Yes
	Texas Utilities			
	Energy Plaza, 1601 Bryan St.			
	Dallas	TX	75201	
7000	Frankie Wall	H&TC- BLK 3 - NW/4 in Section 28		Yes
	3600 Hill Ave			
	Snyder	TX	79549 Scurry County	

Preferred Route Landowner List

Parcel	Landowner	Legal Description		Preferred Route
7001	Bobby Jack Shroyer	H&TC- BLK 3 - NW/4 in Section 27		Yes
	3206 Ave A Snyder	TX	79549 Scurry County	
7002	SPT Feedlot Inc.	H&TC- BLK 3 - NE/4 in Section 27		Yes
	1465 S FM 1614 Hermleigh	TX	79526 Scurry County	
7003	Ray and Betty Courtney	H&TC - BLK 3 - SE/4 - Section 27		Yes
	12524 E. Hwy 180 Hermleigh	TX	79526 Scurry County	
7004	John Irvine	H&TC - BLK 3 - SW/4 - Section 27		Yes
	Rt. 1, Box 181 A Hermleigh	TX	79526 Scurry County	
7005	James R. and Rosemary D. Ratliff	H&TC - BLK 3 - S/2 - Section 28		Yes
	810 E. Lee Rotan	TX	79546 Scurry County	
7006	Orville Taylor	H&TC - BLK 3 - S/2 of NW/4 in Section 13		Yes
	3401 Jacksboro Ave Snyder	TX	79549 Scurry County	
7007	Kathy Harrell Voss	H&TC - BLK 3 - N/2 in Section 14 and NE/4 in Section 15		Yes
	10239 Camp Spring Road Hermleigh	TX	79526 Scurry County	

Preferred Route Landowner List

Parcel	Landowner	Legal Description		Preferred Route
7008	F. E. & Jimidene Tutt	H&TC - BLK 3 - NE/C of NE/4 in Section 49		Yes
	13525 East Hwy 180 Hermleigh	TX	79526 Scurry County	
7009	Charles H. Henderson Estate	H&TC- BLK 3 - E/2 in Section 26		Yes
	11398 E Hwy 180 Hermleigh	TX	79526 Scurry County	
9000	Max Stuart	T.H. Cosby		Yes
	P.O. Box 36 Roby	TX	79543 Fisher County	
9001	Richard Melton	T.H. Cosby		Yes
	225 Avenida Deleon Abilene	TX	79602 Fisher County	
9007	Talmdage Neves	T.H. Cosby- Tract F-Lots 1, 2 and 3		Yes
	P.O. Box 9 Roby	TX	79543 Fisher County	
9008	Nelda M. Dickson	T.H. Cosby- Tract E&F- Plunkett Add-Lts 4,5,&6		Yes
	P.O. Box 630 Sweetwater	TX	79556 Fisher County	
9009	A.D. Dodson c/o R.W. Dodson 16211 Cypress Court Dumfries	VA	22026 Fisher County	Yes

Preferred Route Landowner List

Parcel	Landowner	Legal Description	Preferred Route
9010	Bryan Justiss	T.H. Cosby-Tract 21-Lts 1,2,&3 and 10,11&12; Tract 6-Lts 2,3 &4; Tract F-Lts 4,5&6	Yes
	555 Co Rd 113 Roby	TX 79543 Fisher County	
9011	Raymond Driver	T.H. Cosby-Tract 21-Lts 4,5,&6	Yes
	512 N Concho Roby	TX 79543 Fisher County	
9012	Terry Palmer	T.H. Cosby-Tract 67-Lts 4,5,&6	Yes
	612 W N 1st Roby	TX 79543 Fisher County	
9013	Brzezinski Trust-Oasis Motel c/o F & S Brzezinski Box 1258 Lakeside	T.H. Cosby-Tract 67-Lts 7, 8, &9 CA 92040 Fisher County	Yes
9014	Silvestra Solis	T.H. Cosby-Tract 64 & 41	Yes
	301 N Lyon Roby	TX 79543 Fisher County	
9015	Dowe H. Mayfield Jr.	T.H. Cosby-Tract 38-Lts 4,5,&6	Yes
	3411 95th St. Lubbock	TX 79423 Fisher County	
9016	Allan Armwine	T.H. Cosby-Tract 38-Lts 7,8, &9	Yes
	P.O. Box 264 Roby	TX 79543 Fisher County	

Preferred Route Landowner List

Parcel	Landowner	Legal Description	Preferred Route
9017	Eugene Shipp	T.H. Cosby-Tract 15-Lts 1-12 and Tract 12-Lts 2-7	Yes
	509 N Lyon Roby	TX 79543 Fisher County	
9018	Jerry Hoddenpyle	T.H. Cosby-Out lots	Yes
	P.O. Box 332 Roby	TX 79543 Fisher County	
9019	Stuart Carey Blue Haven Motel 804 W S 1st Roby	T.H. Cosby-Tract 1A-Lts 11,12,&13 TX 79543 Fisher County	Yes
9020	Michael V. Terry	T.H. Cosby-Tract 1A	Yes
	P.O. Box 458 Roby	TX 79543 Fisher County	
9021	Mrs. Cecil A. McCrea Estate Mallard Enterprises 500 Davidson Rd Nashville	T.H. Cosby-Tract 6-Lts 5,6,&7 TN 37205 Fisher County	Yes
9022	Helen Yeates	T.H. Cosby-	Yes
	P.O. Box 56 Roby	TX 79543 Fisher County	
9023	Bessie Bolden c/o Doris Gentry 210 W Burnside Rotan	T.H. Cosby-Tract 31 - Lots 4, 5 and 6 TX 79546 Fisher County	Yes

Preferred Route Landowner List

Parcel	Landowner	Legal Description	Preferred Route
9024	Guadalupe Moreno	T.H. Cosby-Tract 21-Lots 8 & 9 with 100ft Lots 10, 11 & 12	Yes
	105 E N 4th St. Roby	TX 79543 Fisher County	
9025	Jack McClure	T.H. Cosby-Tract 22	Yes
	P.O. Box 61 Roby	TX 79543 Fisher County	
9026	Roby CISD	T.H. Cosby-Tract 31	Yes
	P.O. Box 516 Roby	TX 79543 Fisher County	
9027	Garland Belvin	T.H. Cosby-Tract 5 - Lots 5, 6 and 7	Yes
	50 Fleeman Road Lawrenceburg	TN 38464 Fisher County	
9028	Lance Green	T.H. Cosby-Tract 48- Lots 1, 2, 3, and 4	Yes
	P.O. Box 251 Roby	TX 79543 Fisher County	
9029	Thomas Frank Leach	T.H. Cosby-Tract F - Lots 10, 11 and 12 - Plunkett Roby	Yes
	P.O. Box 183 Roby	TX 79543 Fisher County	
9030	Martin and Jerelene Palmer	T.H. Cosby-Tract 48 - Lot 5	Yes
	P.O. Box 116 Roby	TX 79543 Fisher County	

Preferred Route Landowner List

Parcel	Landowner		Legal Description	Preferred Route
9031	City of Roby		T.H. Cosby-Tract 48 - Lot 6	Yes
	P.O. Box F Roby	TX 79543	Fisher County	
9032	Kiefer Cauble		T.H. Cosby-Tract 47 - Lots 1, 2 and 3	Yes
	407 St. Hwy 70 South Roby	TX 79543	Fisher County	
9033	Ernest Hills		T.H. Cosby-Tract 47 - Lots 4 & 5	Yes
	P.O. Box 202 Roby	TX 79543	Fisher County	
9034	Alford Carey dba Carey Texaco P.O. Box 10 Roby	TX 79543	T.H. Cosby-Tract 32 - Lots 1, 2 and 3	Yes
9035	Primitive Baptist Church Mrs. J. L. McKimney Rt 1 Roby	TX 79543	T.H. Cosby-Tract 32 - Lots 4, 5, and 6	Yes
9036	Teresa Chavarria	TX 79543	THC-BLK J-Lots 5 & 6	Yes
	P.O. Box 491 Roby	TX 79543	Fisher County	
9037	Calvin Neves		THC-BLK 7-Lots 5,6,& 7	Yes
	P.O. Box 244 Roby	TX 79543	Fisher County	

Preferred Route Landowner List

Parcel	Landowner		Legal Description	Preferred Route
9038	Curtis Chapmon		THC-BLK 7-Lot 4	Yes
	P.O. Box 223 Roby	TX 79543	Fisher County	
9039	Barbara Harris and Jacky Ward		THC-Blk 8-Lot 2,3,4,5,6, & 7	Yes
	16209 S Forrest Park Odessa	TX 79766	Fisher County	

Attachment VIII.

VIII. Question 22 Copies of notice letters to Cities of Roby and Snyder and
County Judges of Fisher and Scurry Counties.



WEST TEXAS UTILITIES COMPANY

P.O. BOX 841 / ABILENE, TEXAS 79604 / (915) 674-7000

January 8, 1997

The Honorable Mayor Cecil J. King
P.O. Box F
Roby, Texas 79543

Dear Mayor King,

West Texas Utilities Company (WTU) is filing an application with the Public Utility Commission of Texas (PUCT or Commission) to amend its Certificate of Convenience and Necessity (CCN) to construct 69,000 volt transmission lines in Fisher and Scurry Counties, Texas. A copy of the map included in WTU's filing is attached to this letter for your information.

WTU and Midwest Electric Cooperative (MVEC) have entered into an agreement for electrical power delivery at four delivery points in Fisher and Scurry Counties. One of the delivery points is MVEC's existing Plainview delivery point with TUEC. A second delivery point will be at MVEC's new SN TX substation that will be constructed east of Snyder. The third delivery point will be at a new WTU substation that will be constructed south of the intersection of Highway 180 and FM 611 south of the Hobbs Community. The fourth delivery point will be a new WTU substation northwest of the Longworth Community on the southeast corner of the intersection of Highway 70 and County Road 118. The proposed transmission line segments will provide service to the new substations and bi-directional service to the existing Plainview substation. A description of the line route for each of the three segments is provided on the enclosed page.

The estimated cost of the project is \$ 4,329,000.

Persons with questions about this project should contact Larry Roberson, Project Manager at 918-594-4131. Persons who wish to intervene in the proceeding or comment upon action sought, should contact the Public Utility Commission of Texas, P.O. Box 13326, Austin, Texas 78711-3326, or you may call the Commission's Office of Consumer Affairs at (512) 936-7120. Hearing- and speech-impaired individuals with text telephones (TTY) may contact the Commission at (512) 936-7136. The deadline for intervention in the proceeding is March 19, 1997 (70 days after the date the application was filed with the commission).

Sincerely,

A handwritten signature in cursive script that reads "Eric Blakey".

Eric Blakey
Regulatory Consultant
West Texas Utilities Company

A MEMBER OF THE CENTRAL AND SOUTH WEST SYSTEM



DESCRIPTION OF LINE ROUTES

West Texas Utilities Company (WTU) is proposing to construct three segments of 69,000 volt single pole transmission line in accordance with its contract with Midwest Electric Cooperative, Inc. (MVEC) to provide wholesale power at four delivery points for MVEC. A description of each of the three segments is as follows:

Longworth Segment:

Proposed Route : This segment will tap WTU's existing Roby to Eskota 69,000 volt transmission line on the south side of County Road 118 approximately 1.5 miles north of the Longworth Community and extend west on the south side of County Road 118 for a distance of approximately 5,000 feet to the intersection with Highway 70 to WTU's new Longworth substation that will be located on the southeast corner of the intersection.

Alternate Route : This segment will tap WTU's existing Roby to Eskota 69,000 volt transmission line on the north side of County Road 120 approximately .5 miles north of the Longworth Community and extend west on the north side of County Road 120 for a distance of approximately 6,400 feet to the intersection with Highway 70 to WTU's new Longworth substation that will be located on the northeast corner of the intersection.

TUEC 37th Street substation in Snyder to MVEC' SN TX substation:

Preferred Route : This segment will exit Texas Utilities Electric Company's (TUEC) substation located on the south side of 37th Street and west of Ave E in the south part of Snyder, Texas. The proposed line will extend south from the substation on the west side of Avenue E for a distance of approximately 1,200 feet paralleling TUEC's existing 69,000 volt transmission line. The proposed line will then turn southeast and parallel the north side of the Roscoe Snyder and Pacific Railway railroad right of way for approximately 3,200 feet. The line will then extends approximately 5,000 feet in a east northeasterly direction to a point where it crosses Highway 208 approximately 2,000 feet south of the intersection of Highways 208 and 401. The line then extends in a northeasterly direction along a low water drainage area on the edge of cultivated fields for approximately 5,800 feet to a point about 150 feet south of Highway 180. In this section, the line will cross Highways 84 and 401 and the AT&SF railroad. The line will then turn north for approximately 2,900 feet crossing Highway 180 and paralleling the east boundary of the SN TX Industrial Park. The line will then turn east for approximately 500 feet on the south edge of the SN TX Industrial Park to the Midwest Electric Cooperative SN TX substation.

Alternate Route : This segment will exit Texas Utilities Electric Company's (TUEC) substation located on the south side of 37th Street and west of Ave E in the south part of Snyder, Texas. The proposed line will extend south from the substation on the west side of Avenue E for a distance of approximately 1,200 feet paralleling TUEC's existing 69,000 volt transmission line. The proposed line will then turn southeast and parallel the north side of the Roscoe Snyder and Pacific Railway railroad right of way for approximately 1,300 feet. The line will then extends approximately 6,400 feet in a east direction to a point where it crosses Highway 208 approximately 1,000 feet south of the intersection of Highways 208 and 401. The line continues in an easterly direction for another 900 feet to a point and then turns south for approximately 800 feet. The line then extends in a northeasterly direction along a low water drainage area on the edge of cultivated fields for approximately 5,000 feet to a point about 150 feet south of Highway 180. In this section, the line will cross Highways 84 and 401 and the AT&SF railroad. The line will then turn north for approximately 2,900 feet crossing Highway 180 and paralleling the east boundary of the SN TX Industrial Park. The line will then turn east for approximately 500 feet on the south edge of the SN TX Industrial Park to the Midwest Electric Cooperative SN TX substation.

WTU's Roby substation to MVEC's Plainview substation:

Proposed Route : This segment will exit the east side of WTU's Roby substation located on the northwest corner of N 3rd Street and Angelo Street in Roby. The line will then extend north for approximately 1,300 feet along the west side of Angelo Street. The line will then turn west for approximately 2,800 feet and crossing Highway 70. The line will then turn south for approximately 1,100 feet to a point on the west side of the intersection of Lawrence Street and N 4th Street. The line will then turn in a westerly direction and parallel a dirt road for approximately 7,200 feet to a point where it crosses a dirt road and then the line continues in a westerly direction for another 7,000 feet as it parallels a waterway until it intersects Highway 180. The line then continues west paralleling the north right of way for 1,000 feet. The line then crosses to the south side of Highway 180 and continues for approximately 16,000 feet in a westerly direction. The line then crosses to the north side of Highway 180 and continues in a westerly direction for approximately 8,000 feet and crossing Highway 1657. The line then crosses to the south side of Highway 180 and continues for approximately 5,400 feet in a westerly direction. The line then crosses to the north side of Highway 180 and continues in a westerly direction for approximately 5,500 feet. The line then crosses to the south side of Highway 180 and continues for approximately 10,700 feet in a westerly direction to the west side of FM 611. At this point, there is an approximately 800 foot tap line to the south to the location of WTU's new Hobbs substation. The line then crosses to the north side of Highway 180 on the west side of Highway 180 and continues in a westerly direction for approximately 28,700 feet. The line then turns in a northwesterly direction and continues for approximately 5,000 feet to a point west of FM 1614 where it turns west and continues for approximately 5,800 feet. The line then turns in a northwesterly direction and continues for approximately 10,300 feet to the north side of FM 1673

(Camp Springs Road). The line turns west and parallels the north side of FM 1673 for approximately 29,500 feet to MWEC's Plainview substation located north of the Price Daniels Prison Unit on the east side of Snyder.

Alternate Route : This segment will exit the east side of WTU's Roby substation located on the northwest corner of N 3rd Street and Angelo Street in Roby. The line will then extend north for approximately 1,300 feet along the west side of Angelo Street. The line will then turn west for approximately 2,800 feet and crossing Highway 70. The line will then turn south for approximately 1,100 feet to a point on the west side of the intersection of Lawrence Street and N 4th Street. The line will then turn in a westerly direction and parallel a dirt road for approximately 7,200 feet to a point where it crosses a dirt road and then the line continues in a westerly direction for another 7,000 feet as it parallels a waterway until it intersects Highway 180. The line then continues west paralleling the north right of way for 1,000 feet. The line then crosses to the south side of Highway 180 and continues for approximately 16,000 feet in a westerly direction. The line then crosses to the north side of Highway 180 and continues in a westerly direction for approximately 8,000 feet and crossing Highway 1657. The line then crosses to the south side of Highway 180 and continues for approximately 5,400 feet in a westerly direction. The line then crosses to the north side of Highway 180 and continues in a westerly direction for approximately 5,500 feet. The line then crosses to the south side of Highway 180 and continues for approximately 10,700 feet in a westerly direction to the west side of FM 611. At this point, there is an approximately 800 foot tap line to the south to the location of WTU's new Hobbs substation. The line then crosses to the north side of Highway 180 on the west side of Highway 180 and continues in a westerly direction for approximately 30,200 feet. The line then crosses to the south side of Highway 180 and continues for approximately 2,800 feet in a westerly direction. The line then crosses to the north side of Highway 180 and continues in a westerly direction for approximately 23,800 feet to the east side of County Road 1101. The line then turns and parallels the east side of County Road 1101 for approximately 9,500 feet where it crosses to the west side of County Road 1101 and continues north for 500 feet to the north side of FM 1673 (Camp Springs Road). The line turns west and parallels the north side of FM 1673 for approximately 18,500 feet to MWEC's Plainview substation located north of the Price Daniels Prison Unit on the east side of Snyder.

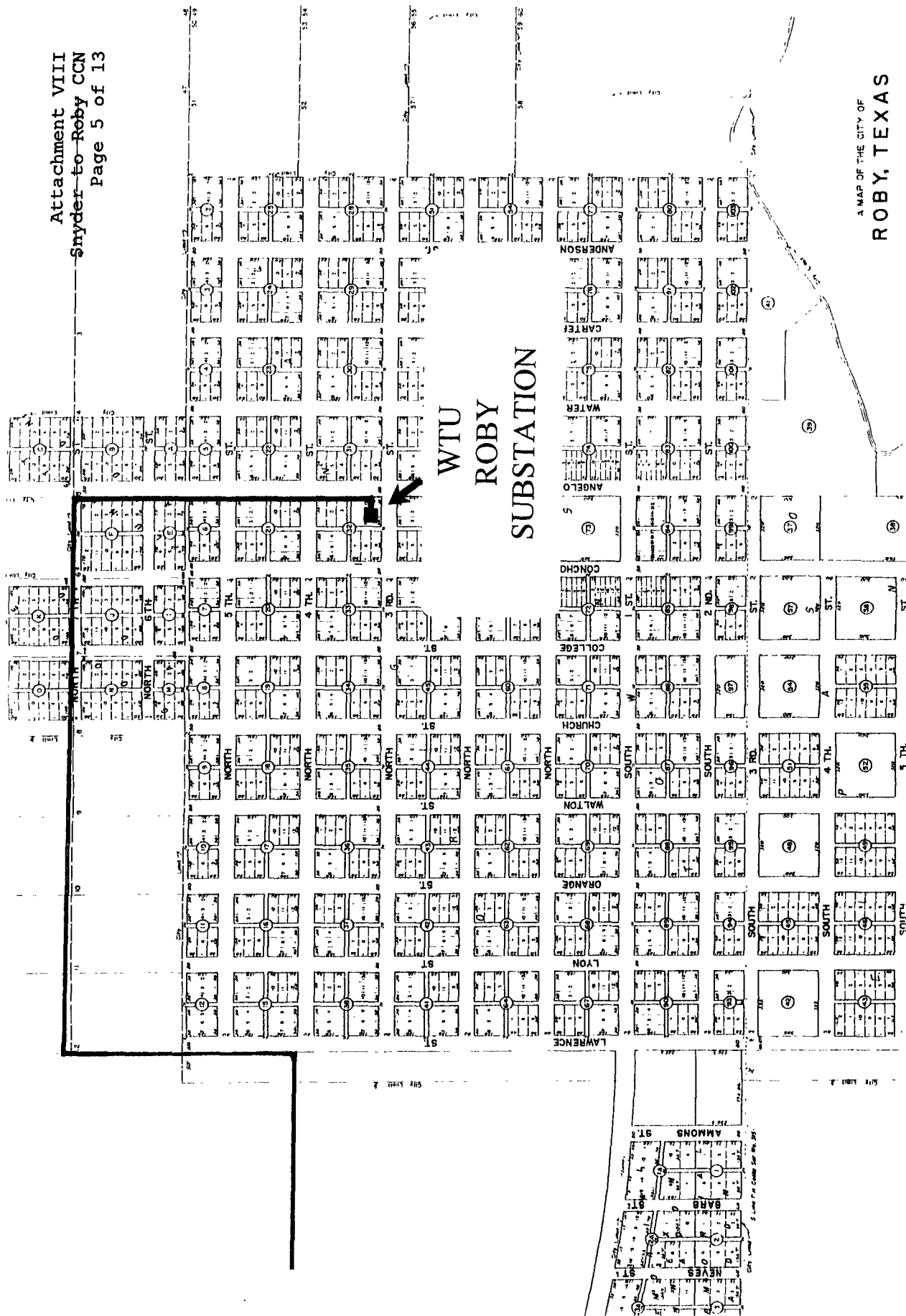

OVERSIZED MAP(S)

**TO VIEW
OVERSIZED MAP(S),
PLEASE GO TO
CENTRAL RECORDS.**

(512) 936-7180

OVERSIZED MAP(S)

**TO VIEW
OVERSIZED MAP(S),
PLEASE GO TO
CENTRAL RECORDS.**

(512) 936-7180



WEST TEXAS UTILITIES COMPANY

P.O. BOX 841 / ABILENE, TEXAS 79604 / (915) 674-7000

January 8, 1997

The Honorable Mayor David Holt
P.O. Box 1341
Snyder, Texas 79550

Dear Mayor Holt,

West Texas Utilities Company (WTU) is filing an application with the Public Utility Commission of Texas (PUCT or Commission) to amend its Certificate of Convenience and Necessity (CCN) to construct 69,000 volt transmission lines in Fisher and Scurry Counties, Texas. A copy of the map included in WTU's filing is attached to this letter for your information.

WTU and Midwest Electric Cooperative (MVEC) have entered into an agreement for electrical power delivery at four delivery points in Fisher and Scurry Counties. One of the delivery points is MVEC's existing Plainview delivery point with TUEC. A second delivery point will be at MVEC's new SN TX substation that will be constructed east of Snyder. The third delivery point will be at a new WTU substation that will be constructed south of the intersection of Highway 180 and FM 611 south of the Hobbs Community. The fourth delivery point will be a new WTU substation northwest of the Longworth Community on the southeast corner of the intersection of Highway 70 and County Road 118. The proposed transmission line segments will provide service to the new substations and bi-directional service to the existing Plainview substation. A description of the line route for each of the three segments is provided on the enclosed page.

The estimated cost of the project is \$ 4,329,000.

Persons with questions about this project should contact Larry Roberson, Project Manager at 918-594-4131. Persons who wish to intervene in the proceeding or comment upon action sought, should contact the Public Utility Commission of Texas, P.O. Box 13326, Austin, Texas 78711-3326, or you may call the Commission's Office of Consumer Affairs at (512) 936-7120. Hearing- and speech-impaired individuals with text telephones (TTY) may contact the Commission at (512) 936-7136. The deadline for intervention in the proceeding is March 19, 1997 (70 days after the date the application was filed with the commission).

Sincerely,

A handwritten signature in cursive script that reads "Eric Blakey".

Eric Blakey
Regulatory Consultant
West Texas Utilities Company

A MEMBER OF THE CENTRAL AND SOUTH WEST SYSTEM



NOTE:

SAME ATTACHMENTS PROVIDED AS PREVIOUS LETTER



WEST TEXAS UTILITIES COMPANY

P.O. BOX 841 / ABILENE, TEXAS 79604 / (915) 674-7000

January 8, 1997

The Honorable Marshall Bennett
Fisher County Judge
P.O. Box 306
Roby, Texas 76834

Dear Judge Bennett,

West Texas Utilities Company (WTU) is filing an application with the Public Utility Commission of Texas (PUCT or Commission) to amend its Certificate of Convenience and Necessity (CCN) to construct 69,000 volt transmission lines in Fisher and Scurry Counties, Texas. A copy of the map included in WTU's filing is attached to this letter for your information.

WTU and Midwest Electric Cooperative (MVEC) have entered into an agreement for electrical power delivery at four delivery points in Fisher and Scurry Counties. One of the delivery points is MVEC's existing Plainview delivery point with TUEC. A second delivery point will be at MVEC's new SN TX substation that will be constructed east of Snyder. The third delivery point will be at a new WTU substation that will be constructed south of the intersection of Highway 180 and FM 611 south of the Hobbs Community. The fourth delivery point will be a new WTU substation northwest of the Longworth Community on the southeast corner of the intersection of Highway 70 and County Road 118. The proposed transmission line segments will provide service to the new substations and bi-directional service to the existing Plainview substation. A description of the line route for each of the three segments is provided on the enclosed page.

The estimated cost of the project is \$ 4,329,000.

Persons with questions about this project should contact Larry Roberson, Project Manager at 918-594-4131. Persons who wish to intervene in the proceeding or comment upon action sought, should contact the Public Utility Commission of Texas, P.O. Box 13326, Austin, Texas 78711-3326, or you may call the Commission's Office of Consumer Affairs at (512) 936-7120. Hearing- and speech-impaired individuals with text telephones (TTY) may contact the Commission at (512) 936-7136. The deadline for intervention in the proceeding is March 19, 1997 (70 days after the date the application was filed with the commission).

Sincerely,

A handwritten signature in cursive script that reads "Eric Blakey".

Eric Blakey
Regulatory Consultant
West Texas Utilities Company

A MEMBER OF THE CENTRAL AND SOUTH WEST SYSTEM



NOTE:

SAME ATTACHMENTS PROVIDED AS PREVIOUS LETTER



WEST TEXAS UTILITIES COMPANY

P.O. BOX 841 / ABILENE, TEXAS 79604 / (915) 674-7000

January 8, 1997

The Honorable Ricky Fritz
Scurry County Judge
County Court House
Snyder, Texas 79549

Dear Judge Fritz,

West Texas Utilities Company (WTU) is filing an application with the Public Utility Commission of Texas (PUCT or Commission) to amend its Certificate of Convenience and Necessity (CCN) to construct 69,000 volt transmission lines in Fisher and Scurry Counties, Texas. A copy of the map included in WTU's filing is attached to this letter for your information.

WTU and Midwest Electric Cooperative (MVEC) have entered into an agreement for electrical power delivery at four delivery points in Fisher and Scurry Counties. One of the delivery points is MVEC's existing Plainview delivery point with TUEC. A second delivery point will be at MVEC's new SN TX substation that will be constructed east of Snyder. The third delivery point will be at a new WTU substation that will be constructed south of the intersection of Highway 180 and FM 611 south of the Hobbs Community. The fourth delivery point will be a new WTU substation northwest of the Longworth Community on the southeast corner of the intersection of Highway 70 and County Road 118. The proposed transmission line segments will provide service to the new substations and bi-directional service to the existing Plainview substation. A description of the line route for each of the three segments is provided on the enclosed page.

The estimated cost of the project is \$ 4,329,000.

Persons with questions about this project should contact Larry Roberson, Project Manager at 918-594-4131. Persons who wish to intervene in the proceeding or comment upon action sought, should contact the Public Utility Commission of Texas, P.O. Box 13326, Austin, Texas 78711-3326, or you may call the Commission's Office of Consumer Affairs at (512) 936-7120. Hearing- and speech-impaired individuals with text telephones (TTY) may contact the Commission at (512) 936-7136. The deadline for intervention in the proceeding is March 19, 1997 (70 days after the date the application was filed with the commission).

Sincerely,

A handwritten signature in cursive script that reads "Eric Blakey".

Eric Blakey
Regulatory Consultant
West Texas Utilities Company

A MEMBER OF THE CENTRAL AND SOUTH WEST SYSTEM



NOTE:

SAME ATTACHMENTS PROVIDED AS PREVIOUS LETTER

Attachment IX.

IX. Question 22

Copy of the notice and map sent to individual directly affected landowners on the alternate route.



WEST TEXAS UTILITIES COMPANY

P.O. BOX 841 / ABILENE, TEXAS 79604 / (915) 674-7000

January 8, 1997

Carole Haynes
P.O. Box 82
Hermleigh, TX 79526

Dear Ms. Haynes,

West Texas Utilities Company (WTU or Company) has filed an application with the Public Utility Commission of Texas (PUCT or Commission) to construct new transmission lines in Fisher and Scurry Counties, Texas. PUCT rules require WTU to notify you of this application, and to provide you the following statement: **"Your land may be directly affected in this proceeding. If the preferred route or one of the alternative routes requested under the certificate is approved by the Public Utility Commission of Texas, the utility will have the right to build the facility which may directly affect your land. This proceeding will not determine the value of your land or the value of an easement if one is needed by the utility to build the facility. If you have questions about this project, you should contact Eric Blakey, Regulatory Consultant, at 915-674-7214. If you wish to participate in this proceeding by becoming a party or to comment upon action sought, you should contact the Public Utility Commission of Texas, P.O. Box 13326, Austin, Texas 78711-3326, or call the Public Utility Commission Public Information Office at (512) 936-7140 or (512) 936-7136 for the text telephone. If you wish to participate in this proceeding by becoming a party, the deadline for intervention in the proceeding is March 19, 1997, and you must send a letter requesting intervention to the Commission which is received by that date."**

This new transmission line is necessary for WTU to deliver power to Midwest Electric Cooperative (MVEC) at four locations in Fisher and Scurry Counties. After a thorough analysis of the optional routes available, WTU has proposed its "preferred" route for the PUCT's consideration. Under this proposal, WTU would construct approximately 31.6 miles of new transmission line to serve MVEC. WTU has also provided information about "alternative" routes for the PUCT's consideration. Your land would be directly affected by this alternative route.

A MEMBER OF THE CENTRAL AND SOUTH WEST SYSTEM



Central Power and Light
Corpus Christi, Texas

Public Service Company of Oklahoma
Tulsa, Oklahoma

Southwestern Electric Power
Shreveport, Louisiana

West Texas Utilities
Abilene, Texas

For purposes of this notice, land is directly affected if an easement would be obtained over all or any portion of it, or if it contains a habitable structure within 200 feet of the proposed facility.

A description of both the proposed and alternative line routes for each of the three segments, as well as a copy of the maps that were filed with the Company's application at the PUCT, are enclosed within. The estimated cost of the project is \$4,329,000.

If you have any questions about the proposed application or need additional information, please contact me at (915) 674-7214.

Sincerely,

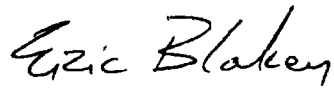
A handwritten signature in cursive script that reads "Eric Blakey".

Eric Blakey
Regulatory Consultant
West Texas Utilities Company

DESCRIPTION OF LINE ROUTES

West Texas Utilities Company (WTU) is proposing to construct three segments of 69,000 volt single pole transmission line in accordance with its contract with Midwest Electric Cooperative, Inc. (MVEC) to provide wholesale power at four delivery points for MVEC. A description of each of the three segments is as follows:

Longworth Segment:

Proposed Route : This segment will tap WTU's existing Roby to Eskota 69,000 volt transmission line on the south side of County Road 118 approximately 1.5 miles north of the Longworth Community and extend west on the south side of County Road 118 for a distance of approximately 5,000 feet to the intersection with Highway 70 to WTU's new Longworth substation that will be located on the southeast corner of the intersection.

Alternate Route : This segment will tap WTU's existing Roby to Eskota 69,000 volt transmission line on the north side of County Road 120 approximately .5 miles north of the Longworth Community and extend west on the north side of County Road 120 for a distance of approximately 6,400 feet to the intersection with Highway 70 to WTU's new Longworth substation that will be located on the northeast corner of the intersection.

TUEC 37th Street substation in Snyder to MVEC' SN TX substation:

Preferred Route : This segment will exit Texas Utilities Electric Company's (TUEC) substation located on the south side of 37th Street and west of Ave E in the south part of Snyder, Texas. The proposed line will extend south from the substation on the west side of Avenue E for a distance of approximately 1,200 feet paralleling TUEC's existing 69,000 volt transmission line. The proposed line will then turn southeast and parallel the north side of the Roscoe Snyder and Pacific Railway railroad right of way for approximately 3,200 feet. The line will then extends approximately 5,000 feet in a east northeasterly direction to a point where it crosses Highway 208 approximately 2,000 feet south of the intersection of Highways 208 and 401. The line then extends in a northeasterly direction along a low water drainage area on the edge of cultivated fields for approximately 5,800 feet to a point about 150 feet south of Highway 180. In this section, the line will cross Highways 84 and 401 and the AT&SF railroad. The line will then turn north for approximately 2,900 feet crossing Highway 180 and paralleling the east boundary of the SN TX Industrial Park. The line will then turn east for approximately 500 feet on the south edge of the SN TX Industrial Park to the Midwest Electric Cooperative SN TX substation.

Alternate Route : This segment will exit Texas Utilities Electric Company's (TUEC) substation located on the south side of 37th Street and west of Ave E in the south part of Snyder, Texas. The proposed line will extend south from the substation on the west side of Avenue E for a distance of approximately 1,200 feet paralleling TUEC's existing 69,000 volt transmission line. The proposed line will then turn southeast and parallel the north side of the Roscoe Snyder and Pacific Railway railroad right of way for approximately 1,300 feet. The line will then extend approximately 6,400 feet in a east direction to a point where it crosses Highway 208 approximately 1,000 feet south of the intersection of Highways 208 and 401. The line continues in an easterly direction for another 900 feet to a point and then turns south for approximately 800 feet. The line then extends in a northeasterly direction along a low water drainage area on the edge of cultivated fields for approximately 5,000 feet to a point about 150 feet south of Highway 180. In this section, the line will cross Highways 84 and 401 and the AT&SF railroad. The line will then turn north for approximately 2,900 feet crossing Highway 180 and paralleling the east boundary of the SN TX Industrial Park. The line will then turn east for approximately 500 feet on the south edge of the SN TX Industrial Park to the Midwest Electric Cooperative SN TX substation.

WTU's Roby substation to MVEC's Plainview substation:

Proposed Route : This segment will exit the east side of WTU's Roby substation located on the northwest corner of N 3rd Street and Angelo Street in Roby. The line will then extend north for approximately 1,300 feet along the west side of Angelo Street. The line will then turn west for approximately 2,800 feet and crossing Highway 70. The line will then turn south for approximately 1,100 feet to a point on the west side of the intersection of Lawrence Street and N 4th Street. The line will then turn in a westerly direction and parallel a dirt road for approximately 7,200 feet to a point where it crosses a dirt road and then the line continues in a westerly direction for another 7,000 feet as it parallels a waterway until it intersects Highway 180. The line then continues west paralleling the north right of way for 1,000 feet. The line then crosses to the south side of Highway 180 and continues for approximately 16,000 feet in a westerly direction. The line then crosses to the north side of Highway 180 and continues in a westerly direction for approximately 8,000 feet and crossing Highway 1657. The line then crosses to the south side of Highway 180 and continues for approximately 5,400 feet in a westerly direction. The line then crosses to the north side of Highway 180 and continues in a westerly direction for approximately 5,500 feet. The line then crosses to the south side of Highway 180 and continues for approximately 10,700 feet in a westerly direction to the west side of FM 611. At this point, there is an approximately 800 foot tap line to the south to the location of WTU's new Hobbs substation. The line then crosses to the north side of Highway 180 on the west side of Highway 180 and continues in a westerly direction for approximately 28,700 feet. The line then turns in a northwesterly direction and continues for approximately 5,000 feet to a point west of FM 1614 where it turns west and continues for approximately 5,800 feet. The line then turns in a northwesterly direction and continues for approximately 10,300 feet to the north side of FM 1673

(Camp Springs Road). The line turns west and parallels the north side of FM 1673 for approximately 29,500 feet to MWEC's Plainview substation located north of the Price Daniels Prison Unit on the east side of Snyder.

Alternate Route : This segment will exit the east side of WTU's Roby substation located on the northwest corner of N 3rd Street and Angelo Street in Roby. The line will then extend north for approximately 1,300 feet along the west side of Angelo Street. The line will then turn west for approximately 2,800 feet and crossing Highway 70. The line will then turn south for approximately 1,100 feet to a point on the west side of the intersection of Lawrence Street and N 4th Street. The line will then turn in a westerly direction and parallel a dirt road for approximately 7,200 feet to a point where it crosses a dirt road and then the line continues in a westerly direction for another 7,000 feet as it parallels a waterway until it intersects Highway 180. The line then continues west paralleling the north right of way for 1,000 feet. The line then crosses to the south side of Highway 180 and continues for approximately 16,000 feet in a westerly direction. The line then crosses to the north side of Highway 180 and continues in a westerly direction for approximately 8,000 feet and crossing Highway 1657. The line then crosses to the south side of Highway 180 and continues for approximately 5,400 feet in a westerly direction. The line then crosses to the north side of Highway 180 and continues in a westerly direction for approximately 5,500 feet. The line then crosses to the south side of Highway 180 and continues for approximately 10,700 feet in a westerly direction to the west side of FM 611. At this point, there is an approximately 800 foot tap line to the south to the location of WTU's new Hobbs substation. The line then crosses to the north side of Highway 180 on the west side of Highway 180 and continues in a westerly direction for approximately 30,200 feet. The line then crosses to the south side of Highway 180 and continues for approximately 2,800 feet in a westerly direction. The line then crosses to the north side of Highway 180 and continues in a westerly direction for approximately 23,800 feet to the east side of County Road 1101. The line then turns and parallels the east side of County Road 1101 for approximately 9,500 feet where it crosses to the west side of County Road 1101 and continues north for 500 feet to the north side of FM 1673 (Camp Springs Road). The line turns west and parallels the north side of FM 1673 for approximately 18,500 feet to MWEC's Plainview substation located north of the Price Daniels Prison Unit on the east side of Snyder.